

TWIN BED

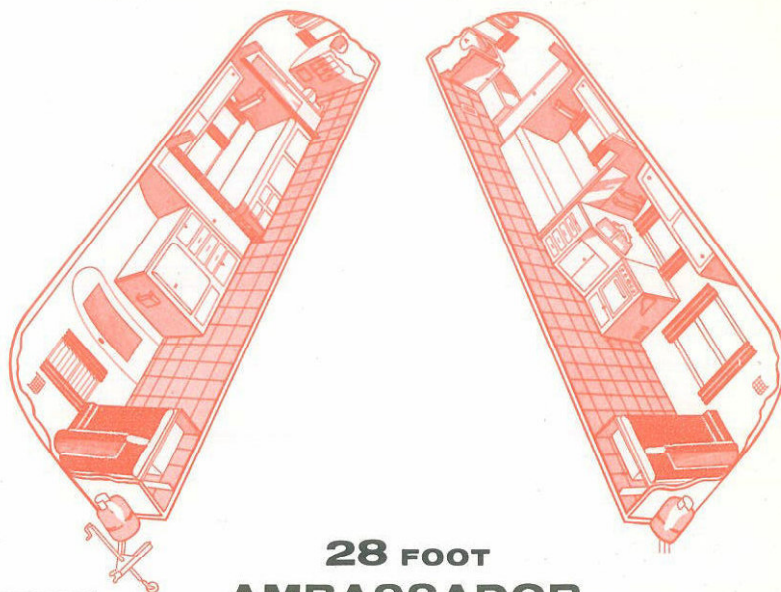

28 FOOT
AMBASSADOR

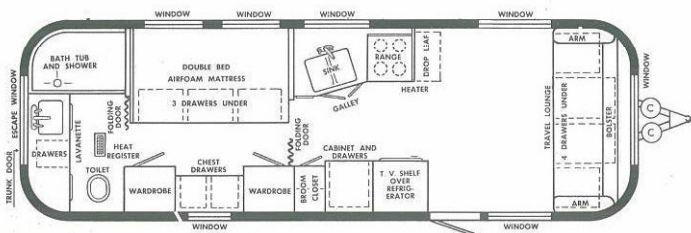

DOUBLE BED

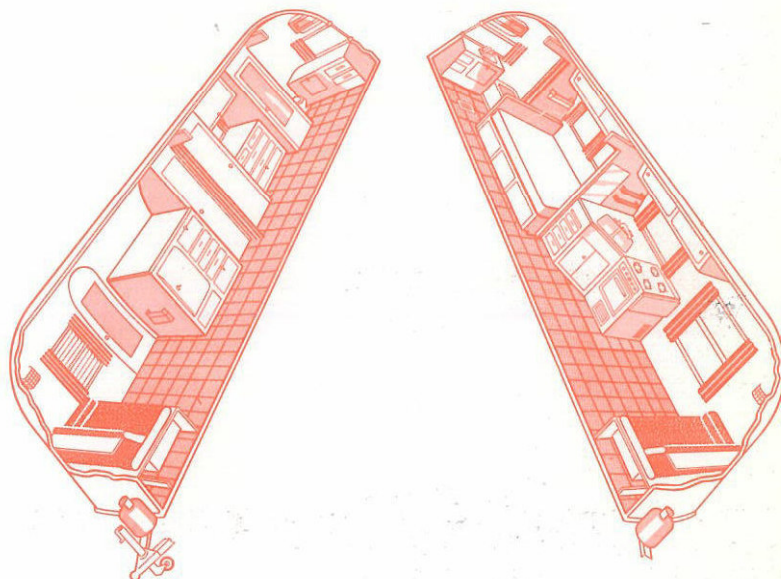

ONLY AIRSTREAM HAS ALL THESE QUALITY FEATURES . . .

- all steel undercarriage
- hand riveted double shell structural alloy aluminum body
- all-over 2 in. aircraft type fiberglas insulation
- 6 in. airfoam mattresses on all beds
- shock absorbers on all wheels
- exclusive dura-torque® axle
- airstream safety-seal® heater with 12v-110v blower, heater duct to rear and thermostat
- genuine hardwood furniture

Overall length — 28 ft.
 Body length — 25 ft.
 Outside width at floor—7 ft.-4 in.
 Overall weight — 3900 lbs.
 Hitch weight — 470 lbs.
 Height to top of hitch ball—19"
 Tandem wheels with 4 wh'l brakes.
 Rear bathroom, Marine type flushing toilet, bathtub, imported water-saver shower and lavanette with swing faucet.
 Airfoam Travel Lounge in front, convertible to double bed.
 8 cu. ft. ice-electric refrigerator with freezer.
 Electric water heater.
 Deluxe travel range, 4 burner, oven, and large broiler.

Two folding doors.
 Drop-leaf table.
 Double sinks, swing faucet.
 Drainage drop out cover cap.
 Drainage drop out elbow.
 Inlaid linoleum tiled floor.
 9 clearview full-opening windows (8 in double bed model), plus 2 jalousie windows, all with removable screens.
 3 roof vents. Large plastic Astro-Dome vent in front.
 Three 12 volt battery lights.
 18 ft. awning rail.
 Double butane tanks, rack and double regulator.
 Weatherproof 110-Volt outlet.
 12 volt charge line.

6 way connector cord.
 Trunk compartment.
 Touch control, built-in step.
 Warp-free hollow core cabinet doors.
 Imported "Sta-Closed" closet catches.
 12 Volt Electric brakes can be coordinated with foot brake pedal in car.
 Molded steel bumper.
 700 x 15, 6 ply truck type tubeless tires.

OPTIONAL CONVENIENCE FEATURES

In addition, to pressure water system, septic tank, gas refrigerator and gas water heater . . . a great number of other optional extras are available to make your Airstream even more self-contained and convenient. See your dealer for full particulars.

Airstream's construction, equipment and layouts have been literally travel-tested over millions of miles of paved and unpaved roads in all parts of the world with the famous Wally Byam Caravans. The ultimate Airstream testimonial was provided this past year when thirty-five Airstreams traveled more than 11,000 miles from Capetown, South Africa to Cairo, Egypt.

SINCE 1932 THE WORLD'S FINEST LIGHTWEIGHT TRAVEL TRAILERS