

REVOLUTION LE

CLASS A DIESEL

AERO Graphics*



Black Gold



Midnight Blue



Onyx



Pearl

SHOCKWAVE Graphics*



Red Wine



White Shadow



Desert Sand



Gold Starfire

*Each graphic scheme is available in eight colors. See your Fleetwood dealer or visit www.fleetwoodrv.com to view all graphics and color choices.



Driven to Explore

INTERIOR DECORS

Aged Bronze

LIVING/DINING ROOM



Dinette Cushions



Accent Fabric



Ultraleather™ Driver & Front Passenger Seats, Sofa

BEDROOM



Bedspread & Pillow Shams



Accent Fabric

After Midnight

LIVING/DINING ROOM



Dinette Cushions



Accent Fabric



Ultraleather™ Driver & Front Passenger Seats, Sofa

BEDROOM



Bedspread & Pillow Shams



Accent Fabric

Obsidian

LIVING/DINING ROOM



Dinette Cushions



Accent Fabric



Ultraleather™ Driver & Front Passenger Seats, Sofa

BEDROOM



Bedspread & Pillow Shams



Accent Fabric

Wood Finishes



Rich Mahogany



Natural Cherry



Regency Cherry

FLOOR PLANS

40E
Triple Slide-Out

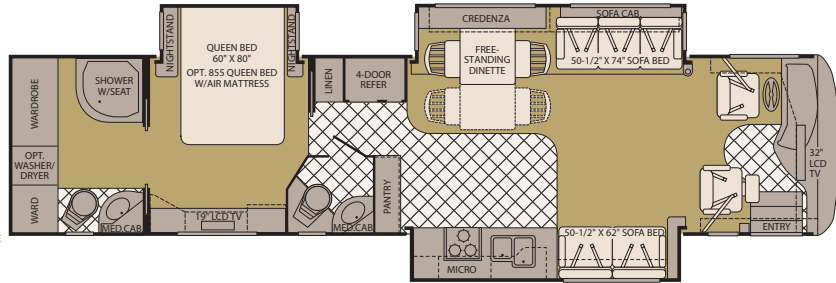

Interior Storage Capacity: 147 cu. ft.
Exterior Storage Capacity: 212 cu. ft.

Available Options: 107, 115, 126, 128, 131, 160, 200, 830, 832, 855

42K
Full-Wall Slide
Triple Slide-Out

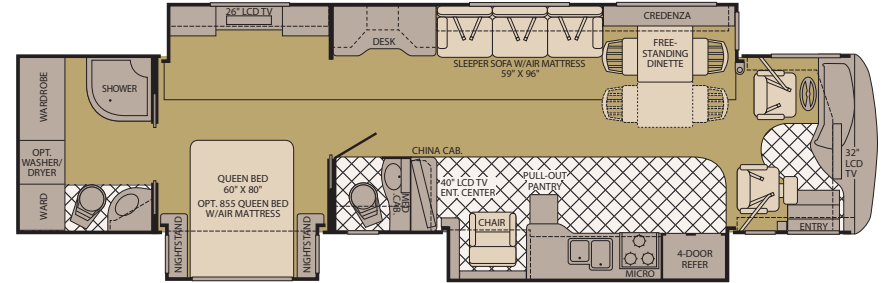

Interior Storage Capacity: 175 cu. ft.
Exterior Storage Capacity: 212 cu. ft.

Available Options: 107, 115, 126, 128, 131, 830, 832, 855, 856, 878

40R
Full-Wall Slide
Triple Slide-Out

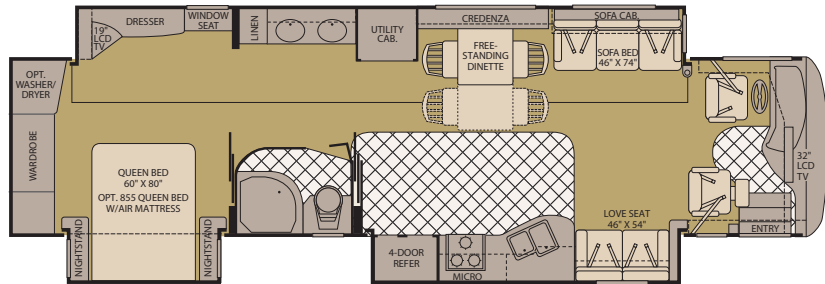

Interior Storage Capacity: 165 cu. ft.
Exterior Storage Capacity: 205 cu. ft.

Available Options: 107, 115, 126, 128, 131, 160, 200, 821, 830, 832, 855, 856

42N
Quad Slide-Out

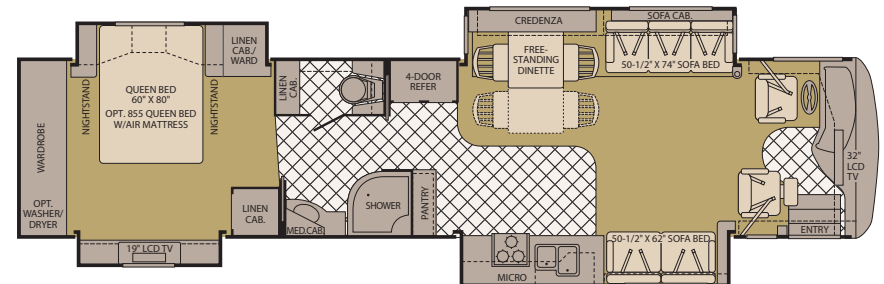

Interior Storage Capacity: 209 cu. ft.
Exterior Storage Capacity: 212 cu. ft.

Available Options: 107, 115, 126, 128, 160, 200, 830, 832, 855, 856, 879

OPTIONS

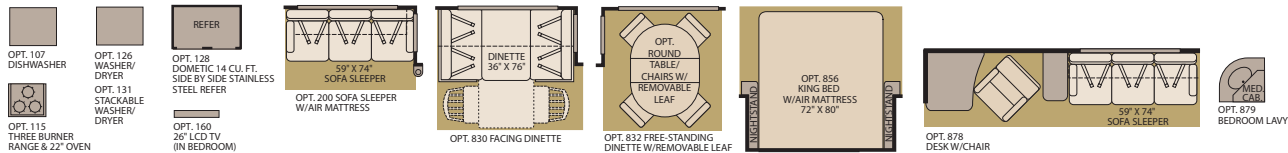

REVOLUTION LE

STANDARD FEATURES

INTERIOR

THROUGHOUT

- 25,000/34,000 Btu Dual Furnaces
- 84" Interior Ceiling Height
- Choice of Regency Cherry, Natural Cherry or Rich Mahogany Wood Finish
- Complete TuffPEX Plumbing System
- Day/Night Pleated Shades
- Deluxe Roller Bearing, Full Extension Drawer Guides & Transit-Ship Locks
- Denso Climate Control System
- Direct Spark Ignition 10 Gallon Water Heater 120V/Propane
- Dual Roof Mounted A/C High Efficiency w/Front Solar Panel (3 on 42K & 42N)
- Fabrica® Carpeting
- Hardwood Cabinet Doors/Drawers
- Padded Vinyl Ceiling
- Power Vent w/Rain Sensors (All Vents, Galley, Bath & Shower Area)
- Raised Panel Upper Cabinet Doors
- Solid Wood Drawers
- Centralized Control Panel Display Center at Entry
- Tank Level Monitor (Interior Only)
- Tile Floor at Front Entry
- Whole Coach Water Filtration System
- Wood Finish Return Air Intake for Furnace

DRIVER CONVENIENCE

- (2) Auxiliary 12V Dash Receptacles
- Power Driver/Front Passenger Sun Visors
- Adjustable Brake & Throttle Pedals
- Auxiliary Fog Lights
- Auxiliary Driving Lights
- Auxiliary Start Switch
- Battery Disconnect System
- CB Radio Ready
- Driver Side Manual Pull Down Shade
- Driver/Front Passenger Map Lights
- Flexsteel® Ultraleather™ Driver Seat w/Manual Lumbar/6 Way Power/Heat/Adjustable Armrest (Integrated Lap and Shoulder Belts)
- Wider Flexsteel® Ultraleather™ Passenger Seat w/6 Way Power/Electric Footrest (Integrated Lap and Shoulder Belts)
- I.C.C. Light Switch
- Electric Step Well Cover w/Lighted Step Well Area
- Rear Vision System w/One-Way Audio (Camera & Monitor)
- Soft Touch Smart Wheel
- Tilt & Telescoping Steering Wheel w/Adjustable Dash Gauge Package
- AM/FM/CD Pioneer® Radio w/Color Back Up Monitor and Touch Screen GPS

GALLEY

- Base Cabinet Storage for the Range & Galley Sink Covers
- Ceramic Tile Backsplash
- Ceramic Tile Flooring w/Accent (Laid Diagonally)
- GE® Convection Microwave Oven w/Built-in Range Hood
- Hardwood Dinette Table, 2 Free-Standing Chairs & 2 Folding Chairs

- High Rise Galley Faucet w/Pull-Out Sprayer
- Large 70/30 Split Solid Surface Sink
- Norcold® 12 cu.ft. 4 Door Stainless Steel Refrigerator w/Ice Maker and Water Dispenser
- Recessed 3 Sealed Burners Cook Top (Stainless Steel)
- Satin Polished Solid Surface Galley Counter Top
- Satin Polished Solid Surface Range & Sink Covers
- Coffe Ceilings w/Halogen Lighting on Dimmer Switch

LIVING ROOM

- Samsung® 32" LCD HDTV in Front Overhead
- Flexsteel® Ultraleather™ Love Seat
- Flexsteel® Ultraleather™ Sofa Bed
- Samsung® Home Theater System w/DVD Player and 5.1 Dolby® Surround Sound Speakers
- TracVision® Domed Digital Satellite System
- Coffe Ceilings w/Halogen Lighting on Dimmer Switch

BEDROOM

- Samsung® 19" LCD HDTV (26" in 42K)
- Samsung® DVD Player
- 60" X 80" Queen Bed Mattress
- Cedar Lined Wardrobe
- Day/Night Pleated Shades
- DSS 2nd Receiver Ready Bedroom Area (Coax Cable)
- Satin Polished Solid Surface Nightstand and Base Cabinet Counter Tops
- Coffe Ceilings w/Halogen Lighting on Dimmer Switch

BATHROOM

- Ceramic Tile Flooring
- Deluxe Medicine Cabinet
- Flip Down Shower Seat (40E)
- Moen® Hand Held Shower Head
- Residential China Bowl Flush Toilet w/Hand Sprayer (Select Models)
- Satin Polished Solid Surface Lavy Top w/Porcelain Bowl & Moen® Faucet
- Shower Door w/Obscure Glass
- Skylight in Shower
- Vacuum Flushed Toilet (Select Models)

SAFETY/CONVENIENCE

- Multiple Seatbelt Locations
- Carbon Monoxide Detector/Alarm
- Centralized Control Panel Display Center
- Energy Management System (EMS) w/Soft Start
- Fire Extinguisher
- Propane Detector/Alarm
- Smoke Detector/Alarm

EXTERIOR

THROUGHOUT

- (4) Aluminum Wheels
- (4) Mud Flaps
- 2000 Watt Pure Sine Wave Inverter w/Remote
- 50 Amp Service
- Battery Monitor
- "Bus Style" Large One-Piece Windshield
- Chrome "Bus Style" Heated Mirrors w/Remote Adjustment & Turn Signal Indicators

- Domed One-Piece Fiberglass Roof w/Radius Corners
- Dual Holding Tank San-T-Flush™ System
- Dual Pane Windows w/Screens
- Electric Patio Awning
- Electronic Battery Control Center
- Energy Management System (50 Amp)
- Exterior Convenience Light at Dump Valves
- Fiberglass Front/Rear Caps w/High Mounted Taillights
- Electric Front Entry Door Awning
- Large Windshield Washer Bottle w/Sprayer Nozzles
- Multi Point Water Pump Switching
- Onan® 8.0 KW Quiet Diesel Generator
- Sound Insulation Front & Rear
- Top Mounted Intermittent Wipers
- Utility Light Front & Rear
- Variable Speed Aquatec Water Pump
- Window Awnings (Bedroom & Front Roadside Windows)
- Sloped Roof on Slide out Boxes

AUTOMOTIVE

- (2) 12V Chassis Batteries (1000 Cold Cranking Amps Each Battery)
- (4) 12 Volt House Maintenance Free AGM Batteries (Group 27)
- 15,000 lb Weight Distributing Hitch Receiver w/7 Pin Electrical Hook-up†
- 160 Amp Alternator
- 4 Point Automatic Levelers
- Allison® 3000 MH, 6 Speed Automatic Transmission
- Anti-Lock Brake System (ABS)
- Full Air Brakes w/Automatic Slack Adjusters
- I-Beam Suspension w/Bilstein® Shocks
- Side Radiator Configuration
- Spartan® Modular Chassis w/400HP ISL Cummins® Engine

BODY STRUCTURE

- Aluminum Interlocking Floor/Wall/Ceiling Framing
- Heated Water & Holding Tank Compartments
- Liberty Chassis w/Patent Pending (Fleetwood Exclusive)
- Steel Surface on Front Bulkhead/Engine Frame
- Vacu-bond® Insulated Storage Area
- Vacu-bond® Sidewall, Roof & Floor Construction

SAFETY/CONVENIENCE

- (4) Turn Signal Lamps on Each Side of Coach
- 30" Front Entry Door w/Dead Bolt
- Front & Rear Docking Lights
- Illuminated Entry Assist Handle
- Porch Lights (2)
- Power Entry Step
- Automotive Safety Glass
- Daytime Running Lights

STORAGE

- Exterior Side Hinged Storage Doors (on Select Doors)
- Lighted Luggage Compartments
- Pass-Through Compartments

OPTIONS

INTERIOR

- Automatic Generator Start System
- Central Vacuum System w/Accessory Kit
- Vented Washer/Dryer Unit
- Stackable Washer/Dryer Unit (Select Models)
- Satellite Receiver Package
- Water Heater 16 Gallon Output

DRIVER CONVENIENCE

- Rear Vision System with Side Cameras
- Spotlight w/Remote

LIVING ROOM

- Ultraleather™ Sofa Sleeper w/Air Mattress

GALLEY

- Dometic® Side-by-Side Stainless Steel Refrigerator
- Facing Dinette
- Free-Standing Table & Chairs
- Recessed 3 Sealed Burner, Stainless Steel Range w/Oven & Solid Surface Covers
- Dishwasher

BEDROOM

- 72" X 80" King Bed Mattress (Select Models)
- Bedroom Ceiling Fan (Select Models)
- Dual Control Mattress
- Second Sink (42N)
- Samsung® 26" LCD HDTV

EXTERIOR

- (14) Exterior Graphics Packages (Electric Awning Included in Graphic Package)
- A Tray Package (2) 90"
- B Tray Package (2) 54", (2) 36"
- C Tray Package (1) 90", (1) 54", (1) 36"
- D Tray Package (1) 54", (1) 36"
- Dual Roof Mounted A/C High Efficiency w/Heat Pump and Front Solar Panel
- Exterior Entertainment Center (Samsung® 19" LCD HDTV w/Slide-Out Tray)
- In-Motion TracVision® Domed Digital Satellite System
- Rear Rock Guard w/Logo
- Electric Power Cord Reel (Standard on 42N & 42K)
- Neutral Loss Protection
- SaniCon Waste Pump

FLEETWOOD ADVANTAGES

- **Best in Class Ride Quality, Thanks to the Liberty Chassis**
- **Best in Class Exterior Styling and Graphics**
- **Best in Class Interior Décor and Woods**
- **Best in Class Floor Plans Including Full-Wall Slides and Rear Bath and a Half**

WEIGHTS & MEASUREMENTS

SPARTAN® CHASSIS

MODELS	40E	40R	42K	42N
Engine Displacement (Liters)	8.9	8.9	8.9	8.9
Wheelbase (Inches)	278"	278"	302"	302"
GVWR (lbs) ¹	34,600	34,600	44,600	44,600
Front GAWR (lbs) ²	14,600	14,600	14,600	14,600
Rear GAWR (lbs) ²	20,000	20,000	20,000	20,000
Tag Axle (lbs) ²	N/A	N/A	10,000	10,000
GCWR (lbs) ³	49,600	49,600	59,600	59,600
Hitch Rating Weight (lbs) ¹	15,000	15,000	15,000	15,000
Tongue Weight (lbs) ¹	1,500	1,500	1,500	1,500
Fuel Capacity (gal)	125	125	125	125

DIMENSIONS & CAPACITIES

MODELS	40E	40R	42K	42N
Overall Length ⁴	40' 11.5"	40' 11.5"	42' 11.5"	42' 11.5"
Overall Height (with A/C)	12' 10"	12' 10"	12' 10"	12' 10"
Overall Width (maximum) ^{5, 6}	101"	101"	101"	101"
Interior Height (maximum)	84"	84"	84"	84"
Interior Width (maximum)	96"	96"	96"	96"
Fresh Water Holding Tank (gal)	100	100	100	100
Grey Water Holding Tank (gal)	70	70	70	60
Black Water Holding Tank (gal)	40	40	40	40
Appliance Propane Tank (gal) (WC) ⁷	30.6	30.6	30.6	30.6
Water Heater Tank (gal)	10	10	10	10

Liquid Weight Reference: Water (gal) = (8.3 lbs/3.8kgs) Fuel (gal) = 7.1 lbs/3.2 kgs) Propane (gal) = (4.2 lbs/1.9 kgs)

Metric Conversion: Multiply pounds x 0.453 to obtain kilograms. Multiply gallons x 3.785 to obtain liters. Multiply liters x 61 to obtain cubic inches.

CHASSIS

Model: Spartan®

Alternator: 160 Amp Leece Neville

Engine: 8.9 Liter Cummins® ISL 400HP

Transmission: Allison® 3000MH, 6-Speed w/Electronic Shifter

Torque: 1200 lbs-ft

Tires: Michelin® 295/80R 22.5H

- GVWR (Gross Vehicle Weight Rating) is the maximum permissible weight of this fully loaded motor home. The GVWR is equal to or greater than the sum of the (UVW) unloaded vehicle weight plus the (OCCC) occupant cargo carrying capacity*.
- GAWR (Gross Axle Weight Rating) is the maximum permissible loaded weight a specific axle is designed to carry.
- GCWR (Gross Combined Weight Rating) is the value specified by the motor home manufacturer as the maximum allowable loaded weight of this motor home with its towed vehicle. Towing and braking capacities may be different. Refer to Fleetwood and chassis manufacturer's manuals for complete information.
- Length measured from front bumper to rear bumper (excludes accessories).
- Excludes safety equipment and awnings.
- Motor homes feature a body-width over 96" which will restrict your access to certain roads. Before purchasing, you should research any state and/or province road laws which may affect your usage.
- Tank manufacturer's listed water capacity (WC). Actual propane capacity is 80% of water listing as required by the safety code.

† The chassis manufacturer recommends the installation of a supplemental brake control system to activate the brakes on the vehicle or trailer you are towing. Hitch receiver ratings expressed are maximum for the hitch receiver installed and may require the purchase of additional equipment that is dependent on the weight of the towed load. Consult with hitch receiver manufacturer for further information.

N/A = not available at time of printing.

* UVW and OCCC are found on the label containing the federal certification tag in each RV.

IMPORTANT — PLEASE READ: Product information, photography and illustrations included in this publication were as accurate as possible at the time of printing. For further product information and changes, please visit our website at www.fleetwoodrv.com or contact your local Fleetwood dealer. Prices, materials, design and specifications are subject to change without notice. All weights, fuel, liquid capacities and dimensions are approximate. Fleetwood has designed its recreational vehicles to provide a variety of uses for its customers. Each vehicle features optimal seating, sleeping, storage and fluid capacities. The user is responsible for selecting the proper combination of loads (i.e. occupants, equipment, fluids, cargo, etc.) to ensure that the vehicle's capacities are not exceeded.