



AMERICAN EAGLE-Floor Plans, Standard Features and Options

# *American Eagle*

AMERICAN EAGLE-Class A Diesel-2006



## Floor Plans

### 40J

#### Triple Slide-Out

Sleeping Accommodations: 5\*

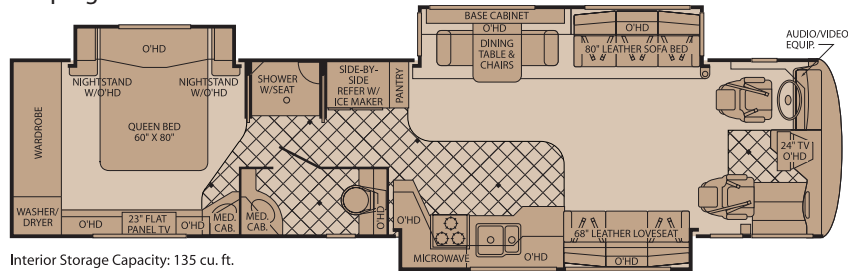

Interior Storage Capacity: 135 cu. ft.  
Exterior Storage Capacity: 110 cu. ft.

### 40L

#### Quad Slide-Out

Sleeping Accommodations: 5\*

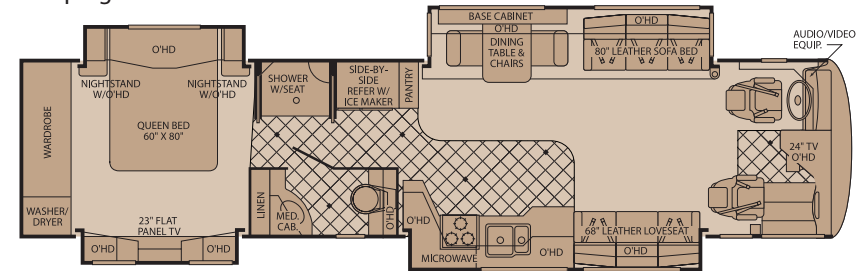

Interior Storage Capacity: 146 cu. ft.  
Exterior Storage Capacity: 110 cu. ft.

### 40V

#### Triple Slide-Out

Sleeping Accommodations: 4\*

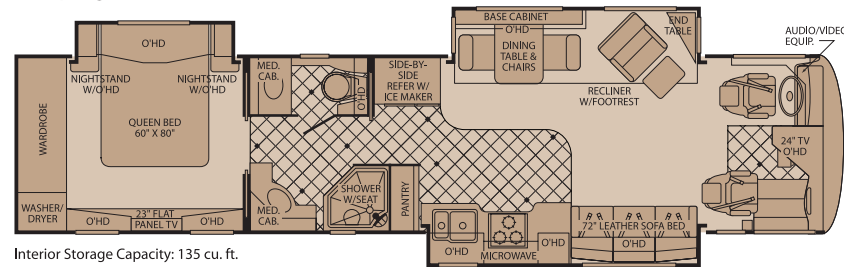

Interior Storage Capacity: 135 cu. ft.  
Exterior Storage Capacity: 110 cu. ft.

## Options

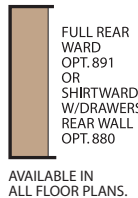

AVAILABLE IN ALL FLOOR PLANS.

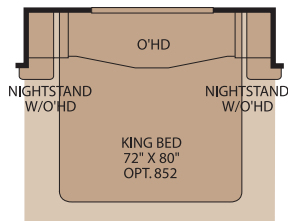

AVAILABLE IN ALL FLOOR PLANS.

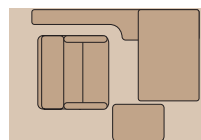

DESK W/FREE-STANDING EURO LEATHER RECLINER W/OTTOMAN OPT. 870  
AVAILABLE IN FLOOR PLANS: 40J, 40L, 40W, 42R

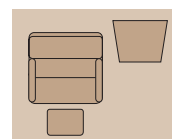

LEATHER RECLINER W/FOOTREST AND END TABLE OPT. 494  
AVAILABLE IN FLOOR PLANS: 40J, 40L, 40W, 42R

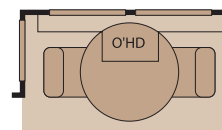

FREE-STANDING DINETTE W/BAY WINDOWS OPT. 831  
AVAILABLE IN FLOOR PLANS: 40J, 40L, 40V, 42R

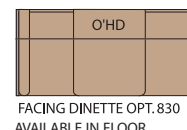

FACING DINETTE OPT. 830  
AVAILABLE IN FLOOR PLANS: 40J, 40L, 40V, 42B, 42R

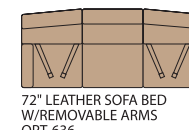

72" LEATHER SOFA BED W/REMOVABLE ARMS OPT. 636  
AVAILABLE IN FLOOR PLANS: 40V, 40W, 42B



80" LEATHER SOFA W/AIR MATTRESS OPT. 210  
AVAILABLE IN FLOOR PLANS: 40J, 40L, 42R



84" LEATHER SOFA BED W/AIR MATTRESS OPT. 210  
AVAILABLE IN FLOOR PLAN: 42B



## Floor Plans

### 40W

#### Double Slide-Out

Sleeping Accommodations: 5\*

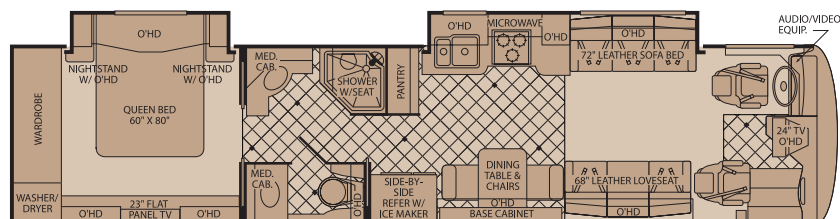

Interior Storage Capacity: 135 cu. ft.  
Exterior Storage Capacity: 110 cu. ft.

### 42B

#### Triple Slide-Out

Sleeping Accommodations: 6\*

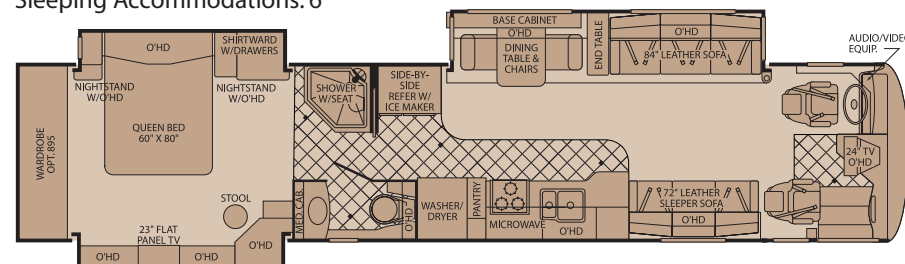

Interior Storage Capacity: 165 cu. ft.  
Exterior Storage Capacity: 70 cu. ft.

### 42R

#### Quad Slide-Out

Sleeping Accommodations: 5\*

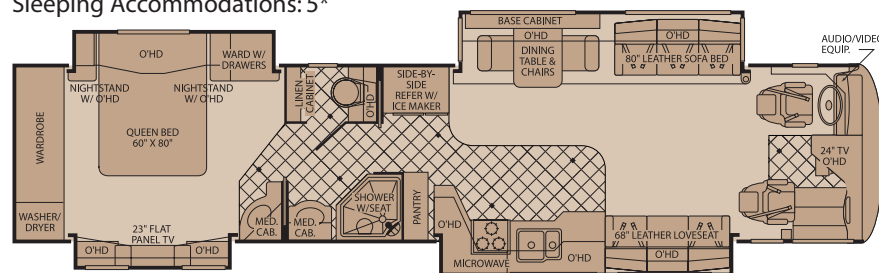

Interior Storage Capacity: 165 cu. ft.  
Exterior Storage Capacity: 70 cu. ft.

*\*Sleeping accommodations are based on designed sleeping areas and may be greater than Sleeping Capacity Weight Rating (SCWR) found on the Cargo Carrying Capacity label located in each RV. Sleeping accommodations are based on standard layout. Optional furniture may increase or decrease sleeping accommodations.*

*Seatbelt configuration may vary depending on options chosen.*

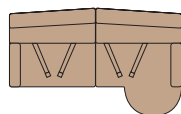

68" LEATHER J LOVESEAT  
OPT. 816  
72" LEATHER J LOVESEAT  
OPT. 816

68" AVAILABLE IN FLOOR  
PLANS: 40J, 40L, 40W, 42R  
72" AVAILABLE IN FLOOR  
PLAN: 42B



68" LEATHER LOVESEAT  
W/REMOVABLE ARMS  
OPT. 637  
AVAILABLE IN FLOOR  
PLANS: 40J, 40L,  
40W, 42R



LEATHER LOVE SEAT  
OPT. 814  
AVAILABLE IN  
FLOOR PLAN: 40V

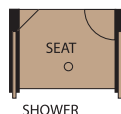

SHOWER  
W/POCKET  
DOOR WALL  
OPT. 178  
AVAILABLE IN  
FLOOR PLAN:  
42B



LEATHER EXTRA  
WIDE SEAT  
W/POWER  
FOOTREST  
OPT. 958  
AVAILABLE IN ALL  
FLOOR PLANS.



WASHER/  
DRYER READY  
OPT. 129  
AVAILABLE  
IN ALL  
FLOOR  
PLANS.

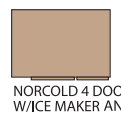

NORCOLD 4 DOOR  
W/ICE MAKER AND  
WATER DISPENSER  
ON DOOR  
OPT. 143  
AVAILABLE IN  
ALL FLOOR  
PLANS.



DISHWASHER  
OPT. 107  
AVAILABLE IN  
FLOOR PLANS:  
40J, 40L, 42B,  
42R



CERAMIC  
2 BURNER  
COOKTOP  
OPT. 111  
AVAILABLE  
IN ALL  
FLOOR  
PLANS.

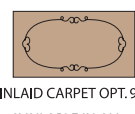

INLAID CARPET OPT. 904  
AVAILABLE IN ALL  
FLOOR PLANS.



32" BEDROOM  
FLAT PANEL TV  
OPT. 162  
AVAILABLE IN  
ALL FLOOR  
PLANS.

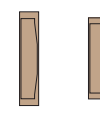

DUAL 37" FRONT  
AND 32" BEDROOM  
FLAT PANEL  
TV PACKAGE  
OPT. 356  
AVAILABLE IN  
ALL FLOOR  
PLANS.

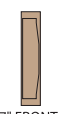

37" FRONT  
FLAT PANEL TV  
OPT. 161  
AVAILABLE IN  
ALL FLOOR  
PLANS.



## Weights and Measurements

WEIGHTS	40J	40L	40V	40W	42B	42R
<b>GVWR (lbs)<sup>1</sup></b>	34,600	34,600	34,600	34,600	44,600	44,600
<b>Front GAWR (lbs)<sup>2</sup></b>	14,600	14,600	14,600	14,600	14,600	14,600
<b>Rear GAWR (lbs)<sup>2</sup></b>	20,000	20,000	20,000	20,000	20,000	20,000
<b>Tag Axle GAWR (lbs)<sup>2</sup></b>	n/a	n/a	n/a	n/a	10,000	10,000
<b>Base Weight (lbs)<sup>3</sup></b>	28,900	29,000	28,700	27,900	34,400	34,400
<b>GCWR (lbs)<sup>4</sup></b>	49,600	49,600	49,600	49,600	59,600	59,600
<b>Hitch Rating Weight (lbs)<sup>†</sup></b>	15,000	15,000	15,000	15,000	15,000	15,000
<b>Tongue Weight (lbs)<sup>†</sup></b>	1,500	1,500	1,500	1,500	1,500	1,500

### DIMENSIONS AND CAPACITIES

<b>Wheelbase</b>	266"	266"	266"	266"	302"	290"
<b>Overall Length<sup>5</sup></b>	39' 11.5"	39' 11.5"	39' 11.5"	39' 11.5"	42' 11.5"	41' 11.5"
<b>Overall Height (w/AC)</b>	12' 8"	12' 8"	12' 8"	12' 8"	12' 8"	12' 8"
<b>Overall Width (maximum)<sup>6,7</sup></b>	101.5"	101.5"	101.5"	101.5"	101.5"	101.5"
<b>Interior Height (maximum)</b>	82"	82"	82"	82"	82"	82"
<b>Interior Width (maximum)</b>	96"	96"	96"	96"	96"	96"
<b>Fresh Water Holding Tank (gal)</b>	95	95	95	95	120	120
<b>Grey Water Holding Tank (gal)</b>	70	70	70	70	70	60
<b>Black Water Holding Tank (gal)</b>	40	40	40	40	40	40
<b>Appliance Propane Tank (gal) (WC)<sup>8</sup></b>	38	38	38	38	38	38
<b>Water Heater Tank (gal)</b>	10	10	10	10	10	10
<b>Fuel Capacity (gal)</b>	125	125	125	125	150	150

**Liquid Weight Reference:** Water (gal) = (8.3 lbs/3.8 kgs) Fuel (gal) = (7.1 lbs/3.2 kgs) Propane (gal) = (4.2 lbs/1.9 kgs)

**Metric Conversion:** Multiply pounds x 0.453 to obtain kilograms. Multiply gallons x 3.785 to obtain liters.

CHASSIS (40 FT MODELS)	CHASSIS (42 FT MODELS)
<b>Frame:</b> Liberty Chassis	<b>Frame:</b> Liberty Chassis
<b>Engine:</b> Cat® C9 400 HP, 8.8L	<b>Engine:</b> Cat® C13 525 HP, 12.5L
<b>Torque:</b> 1100 lb-ft @ 1400 RPM	<b>Torque:</b> 1650 lb-ft @ 1200 RPM
<b>Transmission:</b> Allison® 3000 MH, 6 Speed w/Electronic Shifter	<b>Transmission:</b> Allison® 4000 MH, 6 Speed w/Electronic Shifter
<b>Alternator Amps:</b> 200 Amp Leece Neville	<b>Alternator Amps:</b> 200 Amp Leece Neville
<b>Tires:</b> 295/80R 22.5 H Goodyear® Radial	<b>Tires:</b> 295/80R 22.5 H Goodyear® Radial

1. GVWR (Gross Vehicle Weight Rating) is the maximum permissible weight of this fully loaded motor home. The GVWR is equal to or greater than the sum of the unloaded vehicle weight plus the cargo carrying capacity.

2. GAWR (Gross Axle Weight Rating) is the maximum permissible loaded weight a specific axle is designed to carry.

3. Base Weight is the estimated weight of the motor home without fuel, options, water, cargo or passengers.

4. GCWR (Gross Combined Weight Rating) is the value specified by the motor home manufacturer as the maximum allowable loaded weight of this motor home with its towed vehicle. Towing and braking capacities may be different. Refer to Fleetwood and chassis manufacturer's manuals for complete information.

5. Length taken from front bumper to rear bumper (excludes accessories).

6. Excludes safety equipment and awnings.

7. Motor homes feature a body-width over 96" which will restrict your access to certain roads. Before purchasing, you should research any state and/or province road laws which may affect your usage.

8. Tank manufacturer's listed water capacity (WC). Actual propane capacity is 80% of water listing as required by the safety code.

N/A=Not Applicable.

† The chassis manufacturer recommends the installation of a supplemental brake control system to activate the brakes on the vehicle or trailer you are towing. Hitch receiver ratings expressed are maximum for the hitch receiver installed and may require the purchase of additional equipment that is dependant on the weight of the towed load. Consult with hitch receiver manufacturer for further information.

**IMPORTANT — PLEASE READ:** Product information, photography and illustrations included in this publication were as accurate as possible at the time of printing. For further product information and changes, please visit our website at [www.fleetwoodrv.com](http://www.fleetwoodrv.com) or contact your local Fleetwood dealer. Prices, materials, design and specifications are subject to change without notice. All weights, fuel, liquid capacities and dimensions are approximate. Fleetwood has designed its recreational vehicles to provide a variety of uses for its customers. Each vehicle features optimal seating, sleeping, storage and fluid capacities. The user is responsible for selecting the proper combination of loads (i.e. occupants, equipment, fluids, cargo, etc.) to ensure that the vehicle's capacities are not exceeded.



## Liberty Chassis

### American Coach Exclusive.

In true American Coach Fashion, American Coach set out to design a superior, one-of-a-kind chassis that would be able to overcome the structural challenges created by designing floor plans with triple and quad slide-outs. The result: The Liberty Chassis. This exclusive American Coach design (patent pending) strengthens the structural integrity of the driving platform by creating a strong and rigid frame that resists flexing and provides a comfortable and unforgettable driving experience.

- ❶ **Huge 15,000 lbs. Towing Capacity.** Easily tows your favorite vehicle.
- ❷ **Laminated Storage Liners.** Easy to maintain, neat, clean look, durable.
- ❸ **Electro-Coated Structure.** Protects against corrosion. Enhances longevity, quality and reliability.
- ❹ **All Steel Structure.** Enhances driving experience, strength and longevity.
- ❺ **Center-Mounted Fuel Tank.** Assists in weight distribution.
- ❻ **Independent Front Suspension w/55 Degree Turning Radius.** Optimum handling, enhances driving experience.

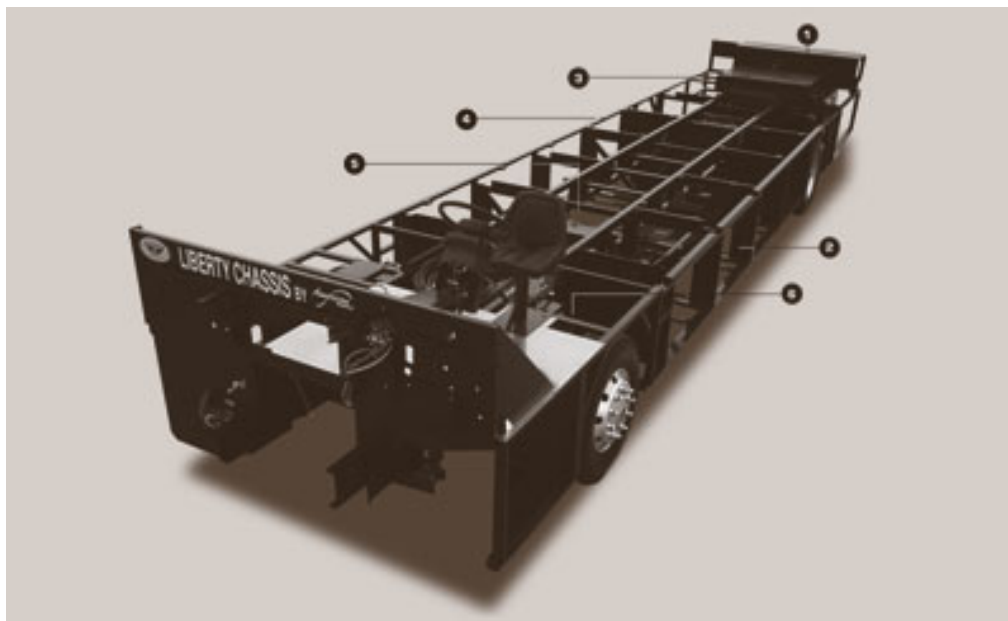

### Setting the Standard in Motor Home Quality.

**American Coach prototypes are exposed to thousands of miles of durability testing. Those components that don't survive are redesigned until they do.** This sets our standard in safety and durability.

**Numerous floor plan choices. American Coach offers a wide variety of floor plans including double, triple and quad slides.** This provides many choices to accommodate each customer's distinct needs.

**Vacu-bond® Roof, Sidewalls and Floor. The Vacu-bond® process adds a great deal of structural integrity by laminating the sidewalls, floors and roof into a strong composite structure.** This construction method is considered superior when compared to most competitors.

**More Power. The 40' Eagle comes equipped with a Cat® C9 with 400 HP engine with 1100 lb-ft of torque @ 1400 RPM. The 42' Eagle comes equipped with a Cat® C13 with 525HP engine with 1650 lb-ft of torque @ 1200 RPM.** This gives you plenty of power to tour the country at any pace you like.

**The Pneumatic Entry Door Air Locks is a unique feature that minimizes air intrusion, and wind noise when you are on the go.** Avionics® has designed a superior entry door for American Coach.

**Name Brand Components. Spartan®, Sony®, Dupont®, Avionics®, Flexsteel®, Fabrica®, Moen®, Onan®, Norcold® and Dometic® to name a few.** We gather the best name brands in the industry to create a superior coach for you.

# Standard Features

## Interior

### THROUGHOUT

- **Centralized Control Panel Display Center**
- **Deluxe Roller Bearing, Full Extension Drawer Guides**
- **Energy Management System (50 Amp)**
- **Fabrica® Carpeting**
- **Interior Multi Plexed Switches**
- **Solid Hardwood Drawers w/Dovetail Joints**
- **TuffPEX® Plumbing System**
- **Whole Coach Water Filtration System**
- 3-Speed Power Vent w/Rain Sensor (All Vents)
- (2) 15.0 M Low Profile Roof Air Conditioners (40' Models)
- (3) 15.0 M Low Profile Roof Air Conditioners (42' Models)
- 12V Halogen Ceiling Lighting

### DRIVER CONVENIENCE

- **Adjustable Brake & Throttle Pedals**
- **Compass & Exterior Temperature Gauge**
- **Flexsteel® Leather 6-Way Power Driver Seat w/Heat/Power Lumbar**
- **Flexsteel® Leather 6-Way Power Passenger Seat**
- **Power Driver/Front Passenger Sun Visors**
- **Smart Wheel**
- **Tilt/Telescoping Steering Wheel**

### LIVING ROOM

- **24" Sony® Wega TV**
- **Pre-Programmed Harmony® Remote Control (Controls All Electronics)**
- **Sony® Home Theater System**

### BATHROOM

- **Diagonally Laid Porcelain Tile Floor w/Deco Tile Inserts - Bathroom**
- **Moen® Hand Held Shower Head**
- **Solid Surface Lavy Countertop w/Solid Surface Sink & Delta® Faucet**

### SAFETY/CONVENIENCE

- Carbon Monoxide Detector/Alarm
- Fire Extinguisher

- Choice of Anderson Walnut, Regency Cherry, Clear White Maple or Butterscotch Glaze Cabinetry
- Day/Night Pleated Shades
- Decorative Window Treatments
- Diagonally Laid Porcelain Tile w/Deco Tile Inserts at Front Entry
- Direct Spark Ignition 10 Gallon Water Heater 120V/Propane
- Dual 2-Stage High Efficient Furnaces w/Thermostat & Auto Ignition (15/22 M / 23/34 M)
- Entry Step Switch at Entry Wall
- ESP-Energy System Protect (5,000 Joules of Surge Protection)
- Front Overhead Cabinet for Electronics Storage
- Hand Laid Wallpaper in Living Room, Galley, Lavy and Bedroom
- Lined Shelves

### • Visteon® AM/FM Radio & Single CD Player

- (2) Auxiliary 12V Dash Receptacles
- Back Lighted Instrument Panel
- Battery Disconnect Switches
- CB Radio Ready (Power & Antenna)
- Cruise Control
- Denso® Climate Control System
- Driver Side Pull Down Shade
- Driver/Front Passenger Map Lights
- Front Windshield Privacy Curtain
- Hydraulic Step Well Cover
- w/Lighted Step Well Area

- Flexsteel® Leather Loveseat (40W, 40J, 40L & 42R)
- Flexsteel® Leather Recliner (40V Model Only)
- Flexsteel® Leather Sofa Bed

- Bronze Bath Accessories
- Etched Glass Shower Door
- Fiberglass Shower Enclosure w/Molded Seat (Select Models)
- Hardwood Assist Handle (Enclosed Toilet)
- Medicine Overhead Cabinet

- Propane Detector/Alarm

- Magnum™ Energy 2500-Watt Inverter Charger
- Magnum™ Energy Battery Monitor
- Multi-Point Water Pump Switching
- Park Telephone Ready
- Power TV Antenna w/Warning Alarm & (2) Jacks
- Rigid Furnace Ducting
- Sensa Tank RV 100 Tank Level Monitoring System (Interior & Exterior Monitor)
- Skylight Cover (Select Models)
- Solar Charging Panel
- Solid Core Raised Panel Cabinet Doors
- TV Cable Ready
- Vinyl Padded Ceiling w/Decorative Air Plenum
- Washer/Dryer (Vented)

- I.C.C. Light Switch
- Low Level Washer Fluid Indication Light
- Manual Air Dump Override Switch
- Passenger Solid Surface Drink Holder
- Power Driver Window
- Rear Vision System w/Audio (Camera & Monitor)
- Remote Auxiliary Start Switch
- Top Mounted Intermittent Windshield Wipers
- w/Sprayer Nozzles

- Hardwood Front TV Overhead Cabinetry
- TracVision® "In-Motion" Domed Digital Satellite System

- Residential China Bowl Flush Toilet w/Hand Sprayer
- Shower Caddy (Solid Surface or Molded into the Shower Enclosure)
- Shower Doors w/Positive Latch
- Skylight in Shower

- Smoke Detector/Alarm

### GALLEY

- **Delta® High Rise Galley Faucet**
- **Diagonally Laid Porcelain Tile Flooring w/Deco Tile Inserts - Galley**
- **Dometic® 120V/Propane 12 Cu. Ft. Side By Side Refrigerator w/Icemaker/Brushed Aluminum Finish**
- **Large Solid Surface 50/50 Double Bowl Galley Sink**

### BEDROOM

- **23" Sony® Flat Panel TV**
- **60" x 80" (Full Queen-Size) Innerspring Padded Pillow Top Mattress**
- **Cedar Lined Wardrobe**
- **Remote Generator Start**
- **Solid Surface Nightstand Countertops**

## Options Interior

### THROUGHOUT

- 16 Gallon High Output Water Heater
- Central Vacuum System w/Accessory Kit
- Flexsteel® 6-Way Power Passenger Spacious Seat w/Heat Power Lumbar/Electric Footrest
- Hydronic Heating System (N/A on 40L Model)

### DRIVER CONVENIENCE

- Color GPS Navigation System
- Color GPS Navigation System w/Trip Tek
- Eaton Vorad Collision Avoidance System (42' Models Only)
- Trip Tek
- Visteon® AM/FM CD-6 Radio In Dash w/Sirius® Satellite Radio (Includes 6-Month Subscription)

### GALLEY

- Dishwasher (Select Models)
- Galley to Entry Tile Flooring (Fabrica® Area Rugs Included w/Option/Carpeting Still Available Under Flush Floor Areas) (N/A on 40L Model)
- Insta-Hot Hot & Cold Water Dispenser

- **Solid Surface Dinette Table w/Slide Out Extension & (4) Decorative Chairs**
- 120V Outlet & Telephone Jack at Dinette
- Additional Receptacles in Galley
- Brushed Chrome Soap Dispenser
- Built-In Range Hood w/Light/Fan
- Cabinet Storage for Sink and Range Covers
- Dinette Base Cabinet w/Storage

- 120V/12V AC/DC Central Electrical Panel
- Bedroom Overhead Cabinet
- Day/Night Pleated Shades
- Hand Laid Wallpaper w/Decorative Border
- Padded Fabric Headboard
- Remote Keyless Entry

- Norcold® 120V/Propane 12 cu. ft. (4) Door Refrigerator w/Icemaker & Water Dispenser/Brushed Aluminum Finish
- Nuheat® Heated Tile Floor (Galley Only)
- Nuheat® Heated Tile Floor (Galley To Entry)(N/A on 40L Model)
- Recessed KitchenAid® 2-Burner Cook Top

### BEDROOM

- 32" Flat Panel TV Package
- Bedroom Ceiling Fan
- Full Length Wardrobe at Rear Wall
- Heat Pump AC
- King Air Mattress w/Digital Remote
- King Bed (72" x 80")
- Queen Air Mattress w/Digital Remote
- Shirt Wardrobe w/Drawers at Rear Wall
- Shower w/Pocket Door Wall (42B Only)
- Washer/Dryer Ready (Delete W/D, Add 2 Shelves)

### LIVING ROOM

- 32" & 37" Sony® Flat Panel TV's, Sony® Home Theater System, HD Components, Second HD DSS

- Galley Tile/Solid Surface Backsplash
- GE Advantium® Microwave/Convection Oven w/Brushed Aluminum Finish
- Recessed 3 Burner Range w/Oven w/Brushed Aluminum Finish
- Silverware Tray
- Solid Surface Countertop w/Spill Proof Edge
- Solid Surface Sink & Range Covers

- Second Phone Jack
- Second Solid Surface Lavy Sink w/Solid Surface Top (Select Models)
- Security Safe
- Shoe Storage in Wardrobe Closet
- Solid Wood Panel Bath/Bedroom Doors
- Wardrobe Light

- Receiver and Bose® 3-2-1 Home Theater System in Bedroom
- 37" Flat Panel TV Package
- 58" Flexsteel® Leather Love Seat (Select Models)
- 68" Flexsteel® Leather Sofa w/Removable Arms (Select Models)
- 68" Flexsteel® Loveseat w/Removable Arms (Select Models)
- 72" Flexsteel® Sofa Bed w/Removable Arms (Select Models)
- 80" Flexsteel® Leather Sofa Bed w/Air Mattress (Select Models)
- 84" Flexsteel® Leather Sofa Bed w/Air Mattress (Select Models)
- Desk w/Flexsteel® Free Standing Leather Euro Chair w/Ottoman (Select Models)
- Fabrica® Inlaid Carpet - Living Room
- Facing Dinette (Select Models)
- Flexsteel® Free Standing Leather Recliner w/Footrest (Includes End Table) (Select Models)
- Free Standing Dinette w/Bay Windows (Select Models)

Bold Denotes American Coach Key Features



## Standard Features

### Exterior

#### THROUGHOUT

- **Aluminum Wheels**
- **Chrome "Bus Like" Heated Mirrors w/Remote Adjustment & Turn Signal Indicators**
- **Dual Pane Windows w/Screens**
- **Electric Patio Awning**
- **Onan® 7.5kW Quiet Diesel Generator w/Hydraulic Power Slide-Out (40' Models)**
- **Onan® 10.0kW Quiet Diesel Generator w/Hydraulic Power Slide-Out (42' Models)**
- **Power Deluxe Double Entry Step**
- (2) 12V Chassis Batteries-1000 cca Per Battery
- (4) 12V Maintenance Free AGM House Batteries
- (4) Turn Signal Repeaters Per Side of Coach
- 25' Fresh Water Hose
- 295/80R LRH 22.5" Radial Tires
- 50' Air Service Line
- Automatic Generator Start Switch
- Boxed Slide-Out Awnings
- Chrome Hitch Cover, Pin & Clip
- Color Coded Awnings & Awning Arms
- Domed One-Piece Fiberglass Roof w/Radius Corners
- Dual Holding Tank San-T-Flush™ System
- Electric Entry Door Awning
- Electronic Battery Control Center
- Entry Screen Door
- Exterior Convenience Light at Dump Valves
- Fiberglass Front & Rear Quarter Panels
- Floor Mounted Propane Tank, 38 Gallons
- Fresh Water Gravity Fill
- Full Width Rear Rock Guard w/Logo
- Gelcoat Fiberglass Exterior Sidewalls
- Hadley® Air Horns
- Holding Tanks w/Low Point Drain Valves
- Integrated Rear Upper Fiberglass Wing Deflector
- Large Passenger Window
- Large Windshield Washer Bottle
- Mud Flaps, Front & Rear
- Patio Receptacles
- Pneumatic Door Locks
- Polished Stainless Steel Bumpers - Front & Rear
- Porch Light
- Power Cord Reel w/50 Amp Service
- Protective Vinyl Front Cover
- Spray Wand w/Soap Dispenser & Paper Towel Holder
- Stainless Brushed Polished Kick Plate Under Entry Door
- Two Piece Rear Ladder
- Utility Light, Front & Rear
- Variable Speed Aquatec Water Pump
- Water Heater By/Pass Check Valve
- Water Pump Switches
- Window Awnings (Bedroom & Front Roadside Windows)
- Xenon High Intensity Headlights

#### BODY STRUCTURE

- **Bonded One-Piece Windshield w/Steel Frame**
- **Lightweight Aluminum Wall Construction**
- **Vacu-bond® Sidewall, Roof & Floor Construction**
- Full Fiberglass Front & Rear Caps
- Heated Water & Holding Tank Compartments
- Insulated Storage Area
- Interlocking Aluminum Hull Construction Extrusions

#### AUTOMOTIVE

- **4-Point Automatic Leveling Jacks**
- **Anti-Lock Brake System (ABS)**
- **Trailer Hitch Receiver 15,000 lbs†**
- Air Ride Suspension w/Bilstein® Shocks/Spartan®
- Allison® 3000 MH, 6-Speed Automatic Transmission (w/400 HP Engines)
- Allison® 4000 MH, 6-Speed Automatic Transmission (w/525 HP Engines)
- Chassis Service Panel
- Engine Brake On-Off (Lo-Mid-Hi) (C13)
- Exhaust Brake On-Off (C9)

#### STORAGE

- **30" Front Entry Door w/Dead Bolt & Pneumatic (Air) Locks**
- **Exterior Side Hinged Storage Doors w/Lockable Latch System & Drop Pin Retention System (Most Locations)**
- **Power Luggage Door Locks w/Key Fob**
- (4) 120V Electrical Outlets in Exterior Luggage Compartments
- Luggage Compartment Lights

#### SAFETY/CONVENIENCE

- **Keyless Entry Remote**
- **Tire Pressure Check Gauge**
- 3 Point Integrated Seat Belts at Driver & Front Passenger Seats
- Auxiliary Fog Lamps
- Back-Up Alarm
- Deluxe Lighted Entry Assist Handle w/Logo
- Docking Lights, Front & Rear
- Entry Door Awning

## Options Exterior

#### THROUGHOUT

- (18) Exterior Graphic Packages
- A Tray Package (2) 90" (N/A on 42' w/ Hydro Hot, or 40L)
- B Tray Package (2) 54" & (2) 36" (N/A on 42' w/ Hydro Hot, or 40L)
- C Tray Package (1) 90", (1) 54", (1) 36" (N/A on 42' w/ Hydro Hot, or 40L)
- Carefree Patio Awning Wind Sensor w/Remote
- D Tray Package (1) 54", (1) 36" (N/A on 42' w/ Hydro Hot)
- Diamond Shield Front Fascia Protective Cover
- E Tray Package (1) 90" & (1) 54" (Available w/Hydro Hot Only)
- Exterior Entertainment Center (24" Wega TV w/Swivel Slide Tray w/ Top Mount Hinged Door) (Location is Under S/O Box on Select Models)
- Girard Electric Awning Package (All Electric-Bedroom, Front Roadside & Patio)
- Lexan® Front Acrylic Shield
- Norcold® 12V/120V Chest Refrigerator/Freezer AC/DC
- Power Water Hose Reel
- Powertec 8.0 kW Diesel Generator
- w/Power Slide-Out (40' Models)
- Security Vision w/(2) Cameras
- Spot Light
- Touch Pad Entry Combo System
- VIP Factory Delivery

#### BODY STRUCTURE

- Air & Hydraulic Leveling System
- Spartan® IFS Chassis w/Cat® C13 w/525HP (42' Models)
- Spartan® IFS Chassis w/Cat® C9 w/400HP (40' Models)

## American Coach Advantages

- **15,000 lb. Trailer Hitch Receiver\***
- **55 Degree Turning Radius (In Both Directions)\***
- **American Coach Design, Flexsteel® Furniture\***
- **Built in Dash Storage Cabinetry with Snack Tray\***
- **Complete TuffPEX® Plumbing System\***
- **Denso® Dash A/C System with Approximately 17,000 BTU Cooling\***
- **ESP-Energy System Protect (5,000 Joules of Surge Protection)\***
- **Fabrica® Carpet**
- **Independent Front Suspension (Standard)**
- **Liberty Chassis (Patent Pending) w/Electro Coated Platform\***
- **Maintenance Free (4) Absorbed Glass Mat 12- Volt Batteries (AGM)\***
- **Power Driver Window\***
- **Radius, Interlocking Aluminum Framed and Vacu-Bonded® Roof Structure\***
- **Roof Mounted Engine Air Intake**
- **Solid Surface Countertops**
- **VIP Factory Delivery (optional)**
- **Wide Entry Door, with Pneumatic Entry Door Locks and "Doggy" Window\***

**Bold Denotes American Coach Key Features**

**\* Denotes American Coach Exclusives**

† The chassis manufacturer recommends the installation of a supplemental brake control system to activate the brakes on the vehicle or trailer you are towing. Hitch receiver ratings expressed are maximum for the hitch receiver installed and may require the purchase of additional equipment that is dependant on the weight of the towed load. Consult with hitch receiver manufacturer for further information.



## What Drives You?

Maybe it's feeling like you're the only one on Earth. Perhaps it's the unique sense of closeness with the great outdoors. Or, it might be the joy that comes from spending quality time with family and friends. Whatever the reason, we know that you have a strong drive to experience everything that comes with spending time on the road. And for more than 50 years, we've shared that passion with you. Because we're RV enthusiasts ourselves, you can see our passion in the vehicles we design and build. Own a Fleetwood, and you'll feel like you're not just traveling, but embarking on an experience unlike any other. Set your own course for adventure and get out there and explore the world around you. Once you do, you'll see what it is that drives us — it's you.



**RV OWNERCARE\*** is a limited one-year/15,000-mile coach warranty and three-year/50,000-mile structural warranty, whichever occurs first, and it is fully transferable for the first 12 months. RV OWNERCARE is one of the RV industry's most comprehensive programs and includes systems, appliances, components and construction, with no deductible and no service charge. RV OWNERCARE coverage is provided from a company that will be around in the future to service your needs. See your nearest American Coach dealer for a full explanation of benefits and restrictions.

**FLEETWOOD TRAVELCADE CLUB** As a Fleetwood owner, you're eligible to become a member of our owners' group, Fleetwood Travelcade Club. It's a perfect way to meet other Fleetwood owners who love to travel across America and share in the RV lifestyle. Call (877) 577-2560 or visit [www.fleetwood.com/clubs](http://www.fleetwood.com/clubs) to learn more and join the fun! American Coach owners can join two great clubs. For more information visit American Coach Association at [www.americancoachassoc.com](http://www.americancoachassoc.com) or American Coach Chapter of FMCA [www.americancoach-fmca.com](http://www.americancoach-fmca.com).

**FLEETWOODRV.COM** To locate a dealer near you, visit our website or call 1-800-444-4905. We can also be contacted at Fleetwood Customer Relations, P.O. Box 7638, Riverside, CA 92513-7638.

**IMPORTANT—PLEASE READ** Product information, photography and illustrations included in this publication were as accurate as possible at the time of printing. For further product information and changes, please visit our website at [www.fleetwoodrv.com](http://www.fleetwoodrv.com) or contact your local Fleetwood dealer. Prices, materials, design and specifications are subject to change without notice. All weights, fuel, liquid capacities and dimensions are approximate. Fleetwood has designed its recreational vehicles to provide a variety of uses for customers. Each vehicle features optimal seating, sleeping, storage and fluid capacities. The user is responsible for selecting the proper combination of loads (i.e.: occupants, equipment, fluids, cargo, etc.) to ensure that the vehicle's capacities are not exceeded.

Your local American Coach dealer is:

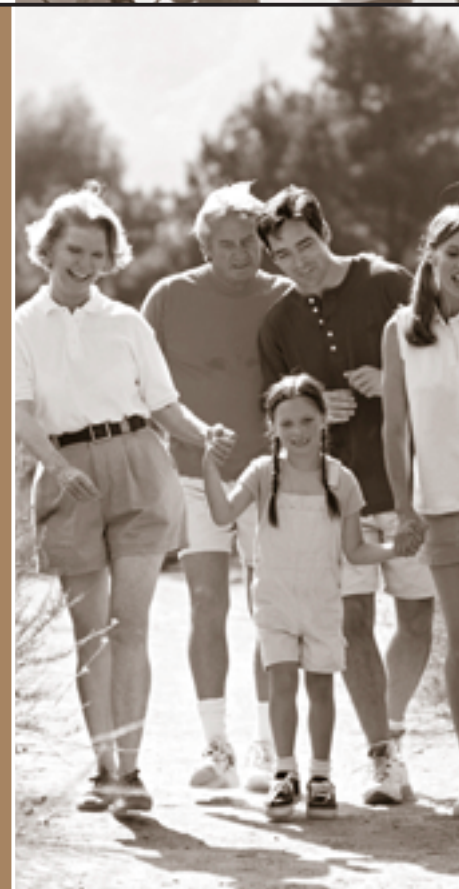

[www.fleetwoodrv.com](http://www.fleetwoodrv.com)

\*For complete info see your American Coach dealer. ©2005, Fleetwood Enterprises, Inc.  
Printed in the USA. Inventory control number AE06F2 10/05.

