

# CAMEO

By Carriage

2009



THE WORLD'S FINEST FIFTH WHEELS SINCE 1968



The 2009 Cameo 36FWS with the industry's only full-wall slide-out. Featured in Breckenridge décor with Glazed Maple wood, the spacious kitchen, easy refrigerator access and walk-through bath are just a few of the features that RVers look for, while the household names such as DuPont Corian and Samsung electronics are the brands RVers trust.



[WWW.CARRIAGEINC.COM](http://WWW.CARRIAGEINC.COM)





For 40 years Carriage has been building full-time friendly fifth wheels that are built to last. We are proud of our heritage and the picture inserts with this brochure provide a look back at old units and our 40-year old history. We are proud of our past yet continue to be an innovator toward the future.

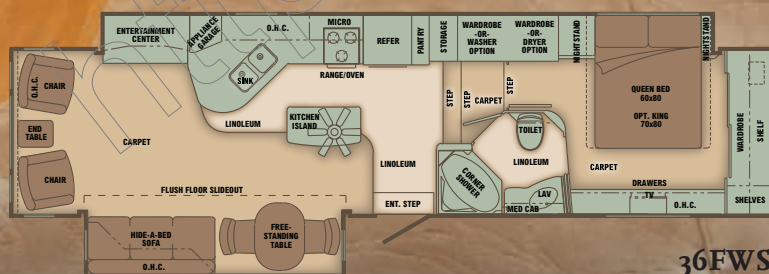

36FWS





Our 37RE3, featured in Espresso décor and Cherry wood, also showing our optional split-level island with bar stools. The Samsung LCD TV rises up or down from the rear entertainment center with the push of a button to stay concealed when the view from the large rear windows demands to be seen.

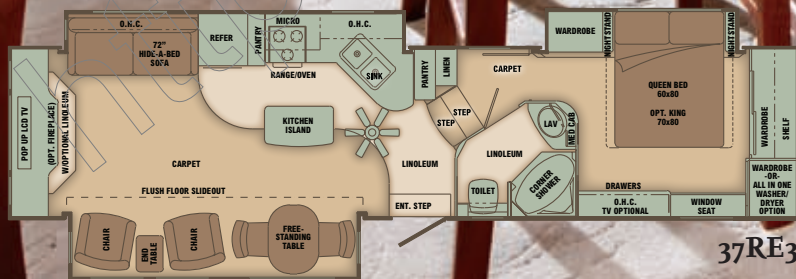





THE LARGEST BATHROOM VANITY IN THE INDUSTRY!



THE POCKET DOORS ALLOW TOTAL PRIVACY IN THE BEDROOM, WHILE THE WINDOW OVER THE BED ALLOWS FOR AN INCREDIBLE CROSS-DRAFT WHEN DESIRED.



This page features our new 37KS3, which with the bathroom vanity as part of the slide-out allows for the most spacious bath deck in the RV industry. The sink also has more space than most houses, and storage is abundant throughout the entire bedroom. Shown in Breckenridge and Cherry.







The 35SB3, here in Cherry wood and Rosemary décor, revolutionized side baths in our industry when introduced 2 years ago. With the dimming halogen lights, wood-trimmed window boxes and private bathroom, you walk in and feel right at home...on the road.







EXPRESSO/CHERRY



CELERY/GLAZED MAPLE



BRECKENRIDGE/CHERRY

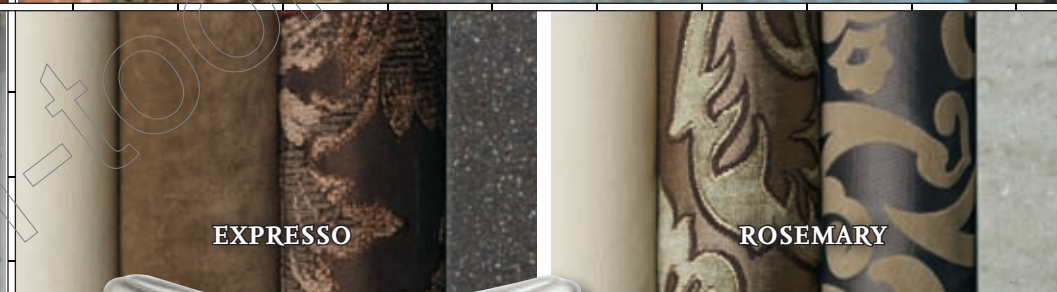

EXPRESSO

ROSEMARY



Detail of Cameo Cabinet Hardware

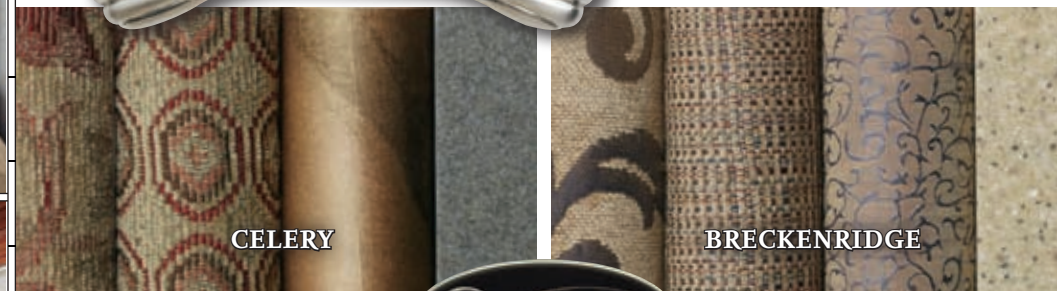

CELERY

BRECKENRIDGE



ROSEMARY/CHERRY



GLAZED MAPLE

CHERRY





## Roof Construction - R16

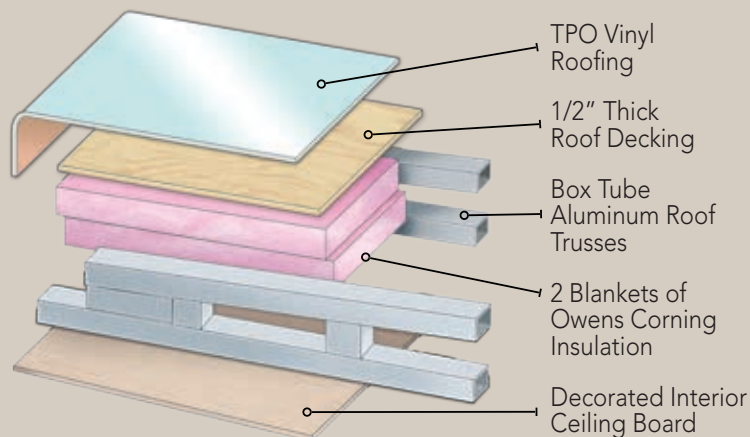

### CARRIAGE "H-SEAL"

**FEATURE:** Two seals double the chance at sweeping away moisture and debris while sealing off the elements twice as much as our competitors.

**BENEFIT:** Two seals are better than one. Our seals are also made of a denser material that will seal tighter than the competition.



### ALUMINUM ROOF TRUSSES 16" ON CENTER, WITH A 5" CAVITY AND A 3" CROWN

**FEATURE:** Household construction with household fiberglass insulation.

**BENEFIT:** 16" centers and 1/2" decking allow for a walkable roof, while the insulation maximizes the AC efficiency. Lighter weight than wood/Steel trusses with no chance of rotting or rusting. Also breathes the best, with no condensation buildup.



### ALUMINUM STUDS WELDED ON 16" CENTERS

**FEATURE:** We design and build our walls to have a superior strength and durability. Every aluminum stud is welded on 16" centers.

**BENEFIT:** This construction technique provides improved support for interior overhead cabinets, reduces the damaging flex that may occur in walls built with studs randomly placed and minimizes the possibility of cracks in the sidewall material.

## Floor CONSTRUCTION - R-24

### MAIN FLOOR:

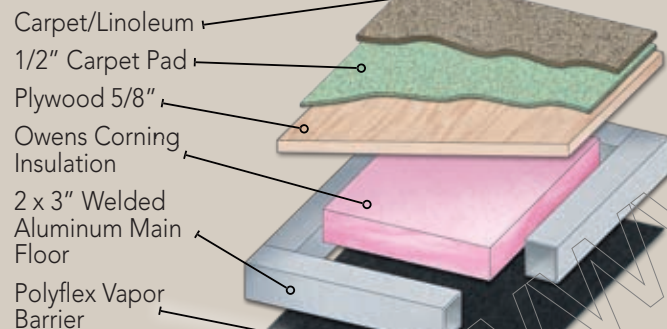

### SUB FLOOR:

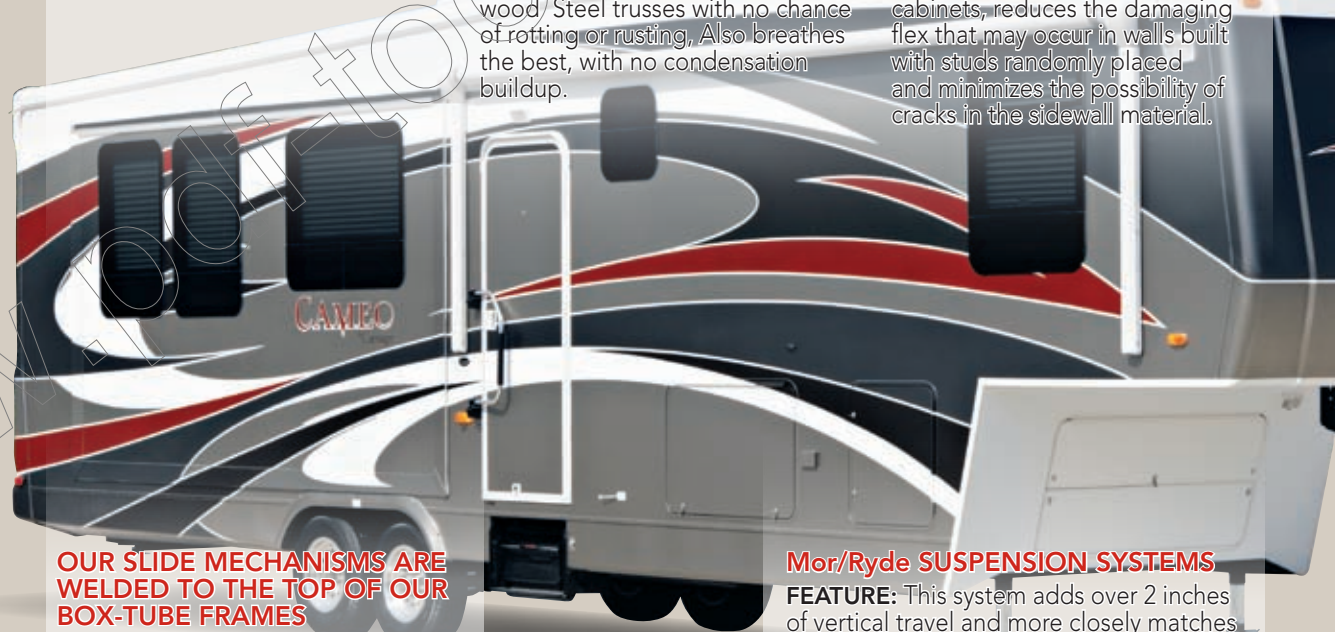
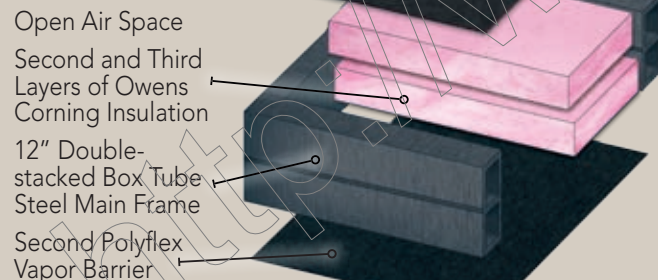

### OUR SLIDE MECHANISMS ARE WELDED TO THE TOP OF OUR BOX-TUBE FRAMES

**FEATURE:** No "holes" are cut into mainframe that will weaken the structure of your coach.

**BENEFIT:** With a more superior frame than the competition, Carriage's frames become the strongest, after the competition torches 2, 4, 6, or even 8 holes to get their slide mechanisms to extend out past their frames.

### Mor/Ryde SUSPENSION SYSTEMS

**FEATURE:** This system adds over 2 inches of vertical travel and more closely matches the suspension of the tow vehicle.

**BENEFIT:** Better ride quality, a 30% improvement of smoothing out road abnormalities, making it easier on you and the contents of your coach.



Cameo shown with optional paint



## OWENS CORNING FIBERGLASS INSULATION

**FEATURE:** Spun fiberglass insulation is recognized as the premium insulating material in both the residential and RV industries.

**BENEFIT:** Fiberglass insulation traps dead air more efficiently than styrofoam insulation and breathes easier than styrofoam, increasing insulation capabilities.



## SIDEWALL CONSTRUCTION - R-8

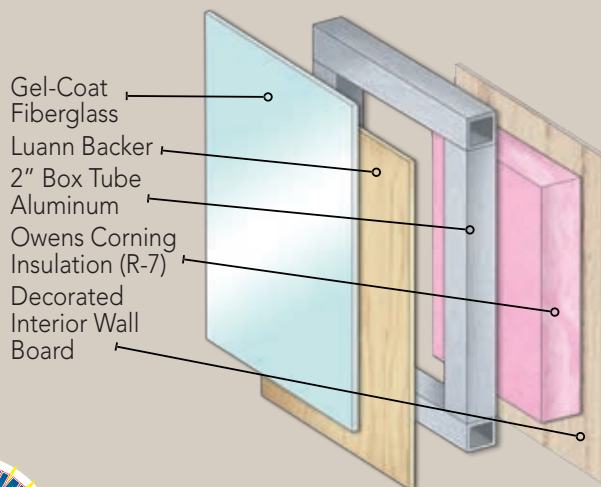

### CARRIAGE EXCLUSIVE WARRANTY. THE BEST WARRANTY AVAILABLE PERIOD

**FEATURE:** 2yr/5yr warranty. This is the best warranty in the RV industry.

**BENEFIT:** no exclusions for full timers. Unlike our competition, we want you to enjoy our coaches year-round.

### WE DESIGN AND MANUFACTURE OUR FRAMES

**FEATURE:** In-house frame shop allows us to build a frame for a floor plan, not the opposite.

**BENEFIT:** We offer a stronger frame than the standard I-beam or C-Channel frame our competitors use. We also have the confidence to offer an exclusive 5 or 7yr frame warranty. The BEST warranty in the RV Industry.



### Mor/Ryde PIN BOX

**FEATURE:** rubber equalizer built into the king pin.

**BENEFIT:** Eases the front-to-back chatter and "porpoise" motion typically found pulling a fifth wheel.



## CARRIAGE TRAVEL CLUB

Enjoy RVing with fellow Carriage owners with our thousands of Travel Club members. Free first year membership with your new Cameo, the club has regional clubs and gatherings as well a newsletter and access to our on-campus 20-site campground, service center and an annual "Grand National" rally. One of the longest lasting and largest enrolled clubs in the industry, The Carriage Travel Club will add memories to your RVing experience and allow you to create new ones.



## 11 GREAT QUESTIONS—DOES THE COMPETITION HAVE...

1. Box tube steel chassis?
2. Halogen dimming lights in 3 zones?
3. 40 years of high-end RV tradition?
4. The industry's only 2/5 full time warranty?
5. Plywood floors, 5/8" thick?
6. Dual floor construction w/no holes in frame?
7. TRUE gel-coat fiberglass standard?
8. Fiberglass insulation or Styrofoam?
9. 16" sidewall centers?
10. Household materials or RV knockoffs?
11. Frameless flush-mounted windows?



YOUR CAMEO HAS ALL OF THESE GREAT ITEMS!

### WE DIDN'T PATENT IT, WE PIONEERED 40 YEARS OF 80°+ DEGREE TURNING

**FEATURE:** CAMEO R-Value in front cap is R-16, unlike the competition we don't reduce the R value.

**BENEFIT:** Tight turns when necessary but without sacrificing insulation in the R-16 front cap





## CARRIAGE MAKES RVING EASY



### REAR JACKS

**FEATURE:** Power electric rear jacks standard on 2009 Cameos

**BENEFIT:** Ease of setup and stabilization at the push of a button.

Also note power electric front jacks with snap pins.



### WASTEMASTER SYSTEM

**FEATURE:** Integrated 25' hose and valve waste disposal system.

**BENEFIT:** Cleanliness and Convenience when dumping tanks. Extremely sanitary and environmentally friendly also.



### DOCKING CENTER

**FEATURE:** All-in-one exterior hookup station.

**BENEFIT:** Makes camp setup easier and hides ugly connections with the under mounted access panel.



### AWNING AND ACCESS

**FEATURE:** Power electric awning, a peep-hole at the entrance door and 10" step treads

**BENEFIT:** The easiest awning in the industry, privacy and big-foot-ready entry steps all make RVing simple.



### WINDOWS

**FEATURE:** Frameless windows from HEHR

**BENEFIT:** No trim rings that can dry-rot, no black streaks and the best look at the campground.

## STORAGE: IS THE INDUSTRY'S MOST ENOUGH FOR YOU?



### CARRIAGE REAR EXCLUSIVE! FULL PASS THROUGH BASEMENT

**FEATURE:** Exclusive rear exterior storage featuring a fully carpeted storage area with three access doors.

**BENEFIT:** Provides up to 60% more storage area than many of our competitors. This also makes the Carriage fifth wheels the only fifth wheels on the market that you can balance the cargo load between the front and the rear of the unit, while also increasing towability.

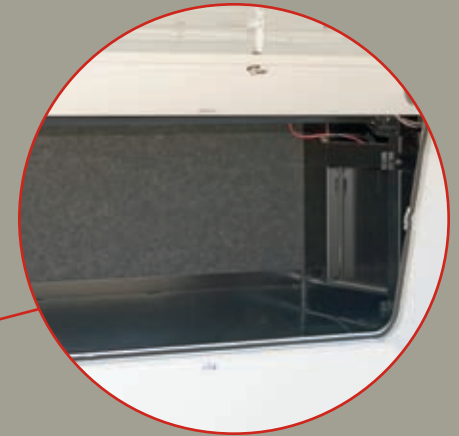

### FRONT BASEMENT

**FEATURE:** Double door front basement

**BENEFIT:** Wide storage with drop down bottom door for full access

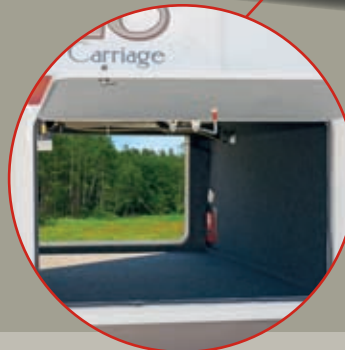

### FULL PASS THROUGH BASEMENT

**FEATURE:** Pass-through main basement with insulated doors

**BENEFIT:** Unencumbered storage with no saddle bags, no wires and no plumbing in the way of your gear



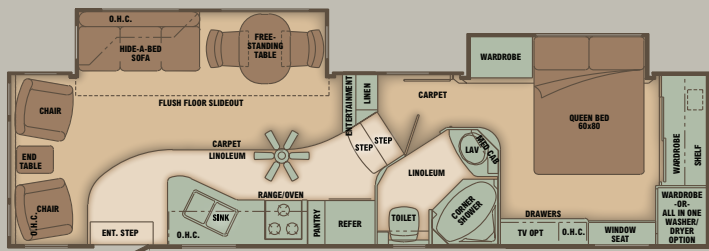

32SB2

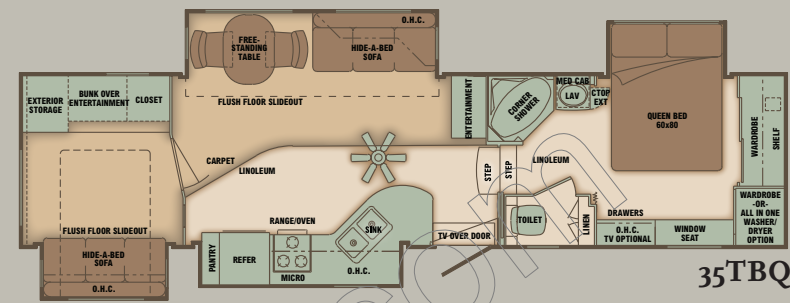

35TBQ

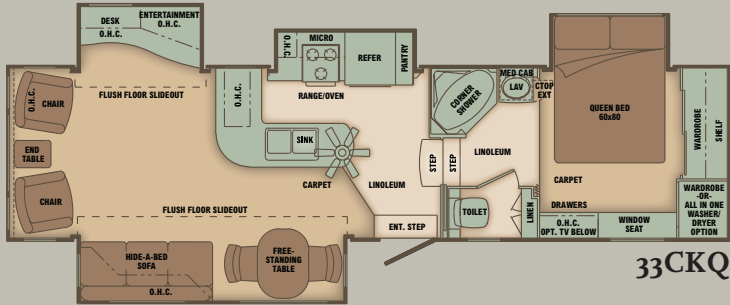

33CKQ

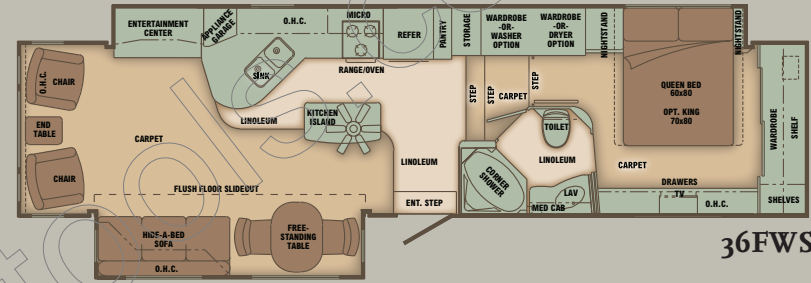

36FWS

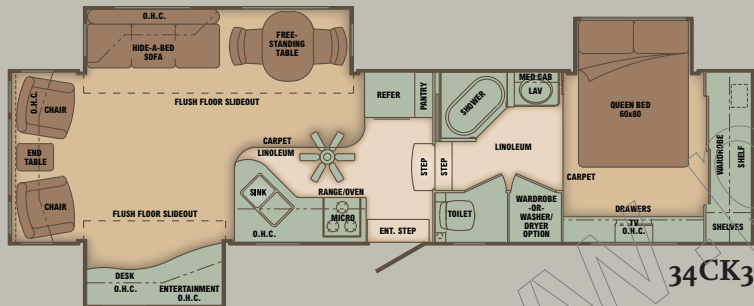

34CK3

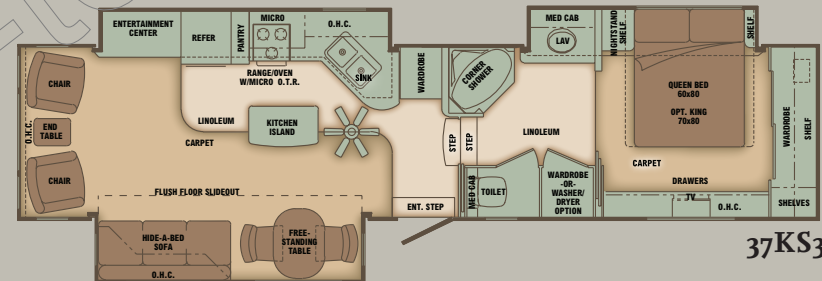

37KS3

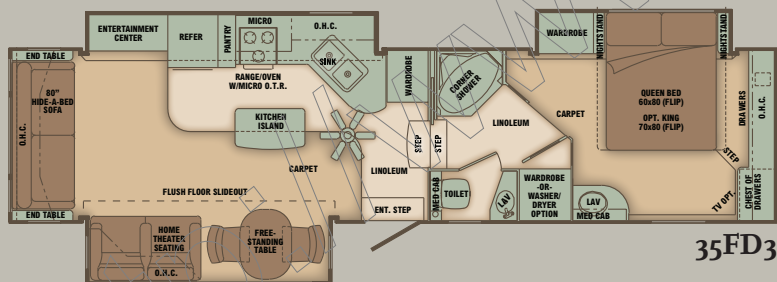

35FD3

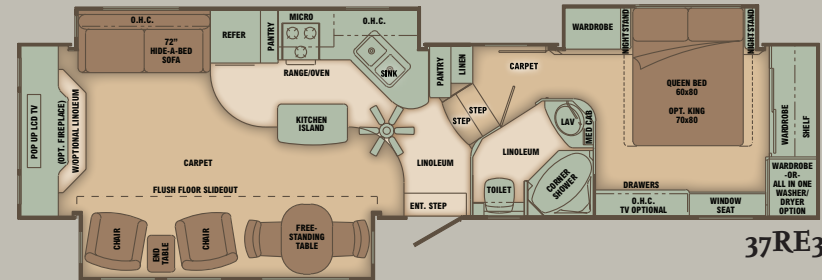

37RE3

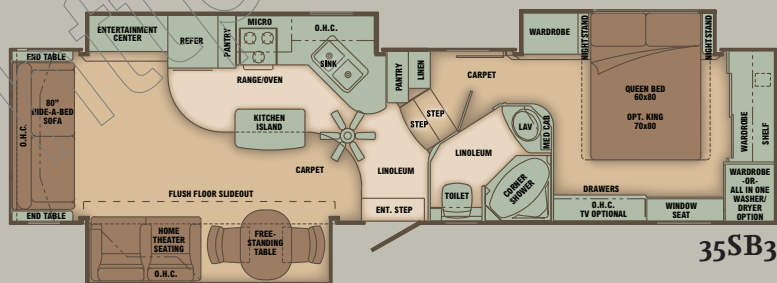

35SB3

CAMEO LXI - Fifth Wheel	F32SB2	F33CKQ	F34CK3	F35FD3	F35TBQ	F35SB3	F36FWS	F37RE3	F37KS3
Approx. Exterior length	32' 11"	33' 11"	34' 11"	35' 11"	35' 11"	35' 11"	36' 11"	37' 5"	37' 5"
Approx. Exterior width	96"	96"	96"	96"	96"	96"	96"	96"	96"
Approx. Exterior Height w/AC	12' 8"	12' 8"	12' 8"	12' 8"	12' 8"	12' 8"	12' 8"	12' 8"	12' 8"
Approx. Dry Axle Weight (lb)*	8,300	9,825	9,600	9,925	10,245	9,830	10,425	10,220	10,600
Approx. Hitch Weight (lb)*	2,230	2,125	1,900	2,125	2,205	2,135	2,825	2,280	2,400
Approx. Total Dry Weight (lb)*	10,530	11,950	11,500	12,050	12,450	11,965	13,250	12,500	13,000
Approx. Average Load Capacity (lb)*	4,469	3,049	3,499	2,949	2,549	3,034	1,749	2,499	1,999
Axles (number of)	2	2	2	2	2	2	2	2	2
Fresh Water Capacity w/ water heater **	82 Gal.	82 Gal.	82 Gal.	82 Gal.	82 Gal.	82 Gal.	82 Gal.	82 Gal.	82 Gal.
Black/Gray Holding Tank Capacity	45/45 Gal.	45/45 Gal.	45/45 Gal.	45/45 Gal.	45/45 Gal.	45/45 Gal.	45/45 Gal.	45/45 Gal.	45/45 Gal.

\* Above listed weights are actual units that include all slide out rooms and all popular options ordered on most coaches. These weights are provided as a guideline only. The actual weight of each individual unit (all units are weighed as they come off the production line) is posted inside each vehicle.

\*\* Fresh water capacity includes the combined capacity of the fresh water tanks and the water heater.



## INTERIOR

- Arlington Cherry wood
- Shadowless day/night shades
- Hardwood stiled cabinetry
- Ball bearing roller drawer guides
- Hide-a-bed sofa with air bladder mattress
- Wood trimmed window interiors
- Deluxe crown molding
- Free standing wooden end table
- Free standing table with leaf, 4 chairs, 2 folding
- Brushed nickel cabinet hardware and lighting accents

## OPTIONS

- Glazed Maple wood
- Fireplace (N/A 32SB2, 35TBQ)
- Arizona Room slideout
- Black-out Day/Night shades
- 70" home theatre group with center console & 80" rear sofa (37KS3, 36FWS)
- Central vacuum system

## SYSTEMS

- 50 amp service with/marine power cord
- 60 amp AC/DC power converter with charger
- 35,000 BTU Floor-ducted forced air furnace with electronic ignition
- Dual 30# LP gas bottles with auto change over
- Full systems monitor panel
- Holding tanks: heated & insulated with fully enclosed underbelly
- Docking Center (water hookups, cable, phone and satellite jacks, coil hose with sprayer and hot/cold water, pump switch, light)
- Enclosed heated and insulated holding tanks and valves with separate heat duct
- 10 gal. gas/electric water heater with DSI
- Ceiling fan

## OPTIONS

- Generator prep with auto change over
- Generator Onan 5500 Microquiet
- Prep for 2nd A/C-breaker, wiring, framing
- Washer/dryer prep
- Washer/dryer: 2 pc. Kenmore (34CK3, 35FD3, 37KS3)
- Washer/dryer: Splendide combo-all floor plans
- Washer/dryer: Splendide Arison side by side (36FWS)
- Fantastic® vent with wall switch
- Fantastic® vent with thermostat & rain sensor
- 3M whole house water filter (prep standard)
- Low profile A/C ducted with heat pump
- Battery disconnect
- 13,500 BTU Carrier bedroom AC

## CONSTRUCTION/SAFETY & RUNNING GEAR

- Aluminum superstructure (heavy gauge welded 2" studs)
- 5/8" exterior grade plywood flooring
- 1/2" roof decking
- 5" aluminum trussed roof on 16" centers or less
- Owens-Corning® insulation floors, walls & roof (inc. slide floors)
- 12" box-tube steel main frame
- MOR/ryde rubber suspension
- Heavy duty four wheel electric brakes (2" x 12")
- Aluminum wheels
- Power electric rear stabilizer jacks
- TPO vinyl roof
- Snap pins @ front jack legs
- Extended pin box
- Spare tire – crank up
- OPTIONS**
- Raise axles for 4-WD truck
- Astro-foil insulation package
- Nev-R-Lube axles
- MOR/ryde pin box

## EXTERIOR

- Safety glass windows with GL20 solar tinted glass
- 2 Security lights at front corners
- 12V patio light & step light with wall switch
- Lights in outside storage compartments
- Roof Ladder
- Mid-ship turn signals
- High-gloss gelcoat fiberglass sidewalls
- Molded fiberglass front and rear caps; high gloss gel coat
- Carefree Travel-R electric patio awning
- 40th Anniversary medallion
- Felt lined exterior compartments

## OPTIONS

- Dual Pane windows with GL20 solar tint glass
- Custom paint exterior
- Accessory receiver with bike rack
- Slideout cargo tray (N/A 33CKQ, 36FWS)
- Rear back-up sensors with remote display
- Sun control box awning over Arizona room

## ENTERTAINMENT

- TV antenna with power booster
- Cable TV & phone jack hook-up
- Satellite prep (RG-6 cable)
- 2nd Satellite prep (RG-6) to bedroom
- TV/cable/110V jacks/outlets with shelf in bedroom
- \*See Luxury Package for electronics detail
- Exterior E-center prep in basement

## OPTIONS

- Hinged TV bracket with hidden storage (35FD3, 35SB3, 36FWS, 37RE3, 37KS3)

## KITCHEN

- DuPont Corian countertops
- Built-in range hood with power exhaust fan & light
- Bi-fold range cover
- Kitchen island cabinet (35FD3, 35SB3, 36FWS, 37RE3, 37KS3)
- Microwave oven
- 8cuft Norcold refrigerator
- Free standing table with leaf, 4 chairs, 2 folding

## OPTIONS

- 10cuft Norcold refrigerator (all models)
- 12cuft Norcold refrigerator (N/A 32SB2)
- Convection microwave oven (vented to exterior)
- HPL "wood look" flooring
- Split level island cabinet with 2 bar stools

## BATHROOM

- 12V power vent
- Porcelain stool
- Skylight over shower
- Heat and AC ducts in stool room
- Removable brushed nickel shower head and hardware

## BEDROOM

- Under bed storage in all models, drawer or piston lift
- 312 coil innerspring mattress; true 60 x 80 queen
- Flat bedroom/bath floor
- Comforter with pillows
- Individual halogen reading lights at bed
- Privacy door or folding door in bedroom
- Full stand-up bedroom
- Halogen bedroom lights on dimmer switch
- Fully padded headboard
- 3-Tier bookshelf with alarm clock shelf and 4-110V outlets
- 5-foot wide window above headboard with cross draft

## OPTIONS

- King bed (35FD3-flip, 35SB3, 36FWS, 37RE3, 37KS3)
- 19" Samsung LCD TV

## "BEST BUILT" PACKAGE

- Front snap pins
- Rear ladder
- Black tank flush
- 8 Cu Ft Norcold Refrigerator
- Rear second basement
- Insulated and enclosed underbelly
- Extended pin box
- Frameless HEHR windows
- Wastewater tank drain system
- Porcelain stool

## "LUXURY" PACKAGE

- Exterior E-center prep in basement
- 32" Samsung LCD TV (26" Samsung in 32SB2 and 35TBQ)
- Samsung AM/FM/CD/DVD Home Theatre System 5.1 with subwoofer
- 2 Leather swivel recliners or Theater seating (floorplan applicable)
- Window in stool room
- 15K Carrier high-capacity AC
- 3-Zone halogen lighting with dimmer switches

## "PERFORMANCE" PACKAGE

- Corian countertops-kitchen and bath
- E-Z lube axles, MOR/ryde rubber equalizer suspension system
- Rear Power Stabilizer Jacks
- Aluminum wheels
- Shadowless day/night shades

## INSULATION VALUES

- Floor R-24
- Roof/Ends R-16
- Walls R-8
- Slideout and slideout floors R-8
- Astro-foil insulation package



POST OFFICE BOX 246  
MILLERSBURG, INDIANA 46543  
(574)-642-3622  
WWW.CARRIAGEINC.COM

CARRIAGE INC. IS PROUD  
TO USE PRODUCTS FROM THESE  
MANUFACTURERS



Williamsburg Furniture

YOUR NEAREST CARRIAGE DEALER:

PRODUCT DISCLOSURE AND DISCLAIMER – The product information contained herein is believed to be accurate at the time of posting. However, during the model year, it may be necessary to make revisions. Carriage, Inc., reserves the right, at any time, and without prior notification, to make all such changes, including changes in prices, colors, materials, equipment and specifications, as well as the addition of new features and the discontinuance of existing features. Selected decorator items used in photographs are not part of the product. Therefore, please consult with your Carriage, Inc., dealer to confirm the existence of any materials, design or specifications that are material to your purchase decision. Carriage, Inc., assumes no responsibility for any error in type, print, or reproduction of specifications, designs and specifications of outside suppliers, or colors utilized in printing.