



# FREEDOM Freedom Express TO EXPLORE

ULTRA LIGHT TRAVEL TRAILERS • DEEP SLIDES • TOY HAULERS • EXPANDABLES

  
**Coachmen**  
Recreational Vehicles  
A Division of Thor Industries, Inc.





## Find Your Freedom – Ultra Lightweight Towability & Convenience

Lightweight Freedom Express has been designed for ease of towing with today's half ton trucks, cross overs and mid-sized SUVs. All tanks are located under the floor to lower the center of gravity for increased storage capacity and improved handling.

**257 BHS** This lightweight bunkhouse floorplan features double/double bunks in the back, a private bedroom suite up front and a camp kitchen outside. The deep slide U-dinette is roomy enough to seat the whole family in comfort. Shown in Cobblestone decor.



**246 RKS** This popular rear kitchen model with a jack knife sofa and wardrobe slide has plenty of storage with multiple wardrobes. Sandstone decor shown.

**248 RBS** This spacious model features a rear bath, outside kitchen, plus a private front bedroom suite. Truffle decor shown.





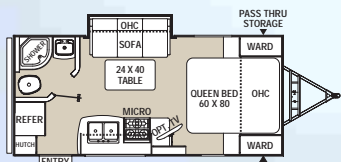

**192 RBS**

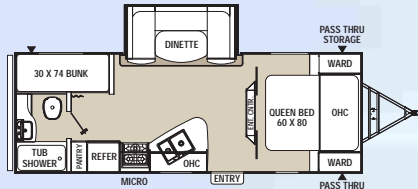

**236 BHS**

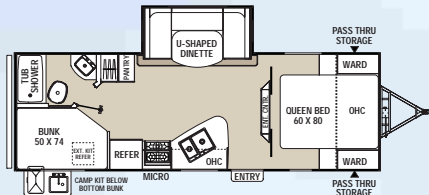

**257 BHS**

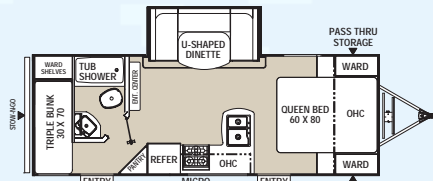

**229 TBS**

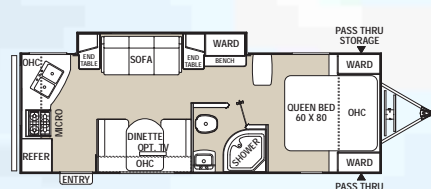

**246 RKS**

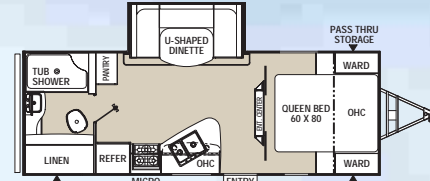

**231 RBDS**

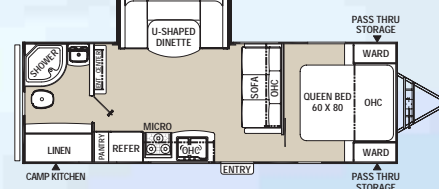

**248 RBS**

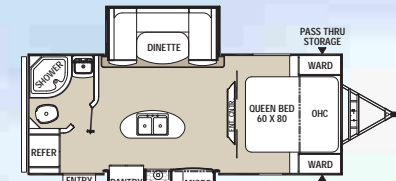

**233 RBS**

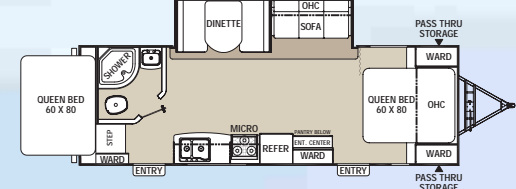

**254 DSX**

**Ultra Lights** Freedom Express sidewalls are built with Azdel substrate. It's 50% lighter than wood and is impervious to moisture, rot and mildew plus it improves insulation.

Freedom Express	192 RBS	229 TBS	231 RBDS	233 RBS	236 BHS	246 RKS	248 RBS	254 DSX	257 BHS
Shipping Weight*	3,535	4,643	4,684	4,471	4,637	4,310	5,047	5,112	4,873
Hitch Weight	392	689	585	635	634	500	705	762	667
Carrying Capacity	2,363	2,315	2,466	2,487	2,321	2,648	2,411	2,346	2,585
Exterior Length (Bumper to Hitch)	22' 6"	26' 9"	26' 10"	24' 11"	27' 3"	28' 3"	28' 11"	29' 7"	28' 7"
Exterior Height (Includes A/C)	10' 3"	10' 9"	10' 9"	10' 9"	10' 9"	10' 4"	10' 9"	10' 9"	10' 9"
Interior Height (Coach)	81"	81"	81"	81"	81"	81"	81"	81"	81"
Awning Length	14'	16'	14'	16'	18'	18'	16'	18'	20'
Fresh Water Capacity (gal.)	36	49	49	36	49	49	49	49	49
Grey Water Capacity (gal.)	30	33	33	30	33	33	33	33	33
Waste Water Capacity (gal.)	30	33	33	30	33	33	33	33	33
Tire Size	ST205/75R14C	ST205/75R14C	ST205/75R14C	ST205/75R14C	ST205/75R14C	ST205/75R14C	ST205/75R14C	ST205/75R14C	ST205/75R14C

\*Shipping weights do not include options.

a huge U-dinette, sofa facing entertainment center,



This innovative silverware drawer under the sink, and in the outside kitchen has a simple to remove insert that's easy to clean and is a Freedom Express exclusive feature.



The 248 RBS features extra large linen storage.

With a lower center of gravity and aerodynamic radius front body styling, Freedom Express is easy to maneuver creating a more enjoyable traveling experience for the driver.





The Liberty Edition luxury upgrade is available on Deep slide models (Maple Leaf Edition in Canada). It includes high end amenities usually reserved for travel trailers and fifth wheels costing thousands of dollars more.



**293 RLDS** Shown in Slate decor.

**LIBERTY EDITION**  
—  —  
by FREEDOM EXPRESS

**MAPLE LEAF EDITION**  
—  —  
by FREEDOM EXPRESS



**312 BHDS** This generous deep slide bunkhouse model accommodates 11 people, and features a fireplace/entertainment center and oversized U-dinette. Shown in Autumn decor.



## Total Freedom – Ultra Light Selection

When there's a chance to escape from your busy life, Freedom Express makes it hassle free, fun and easy. These models are value packed with industry leading features and conveniences including Congoleum® designer flooring, seamless countertops with waterfall edges, full extension ball bearing drawer glides and our exclusive removable silverware drawer.

Our 38" Deep Slide models offer expansive single, double and triple slide living areas. Choose from the industry's best bunk and rear lounge floorplans, plus Toy Hauler models.

**293 RLDS** This triple slide rear living model offers extra living space for entertaining; and clean up is a breeze with a Dyson sweeper on board. An outside grill and mini refrigerator extend the outdoor fun. Shown in Slate decor.

**320 BHDS** This oversized pantry provides plenty of storage space. Shown in Slate decor.



**320 BHDS** This bunkhouse model is loaded with storage. The large entry closet provides plenty of shelving for shoes, extra gear and a waste basket.





Accommodate friends and family in complete comfort with this spacious U-dinette/sofa slide combination shown in Sunset decor with the Premier Package. Available on **281 RLDS**, **297 RLDS** and **298 RLDS**.

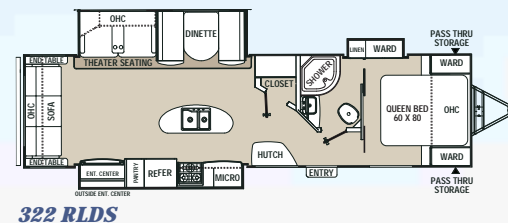
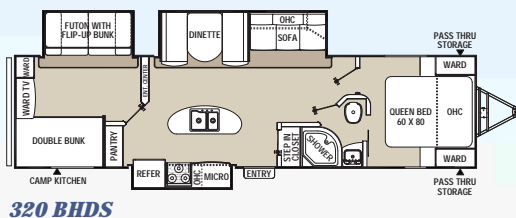
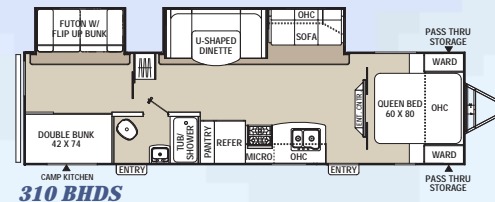
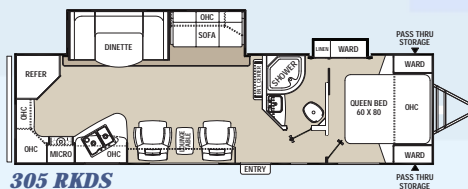
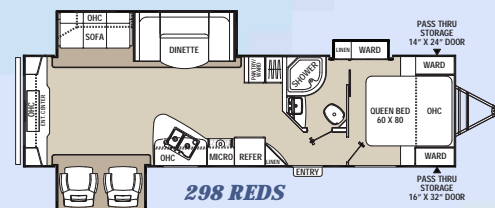
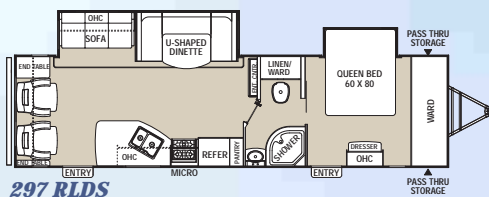
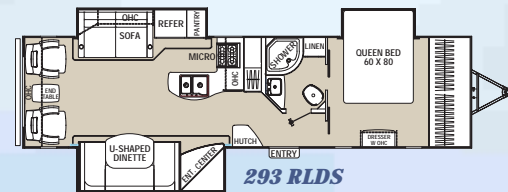
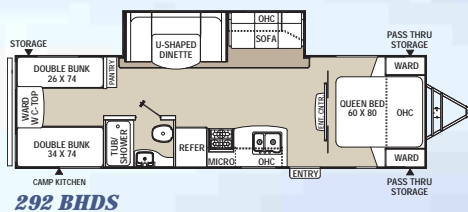
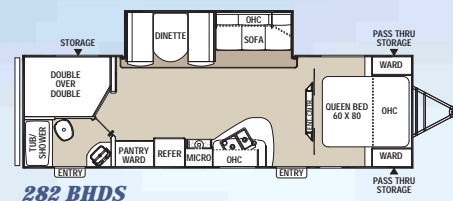
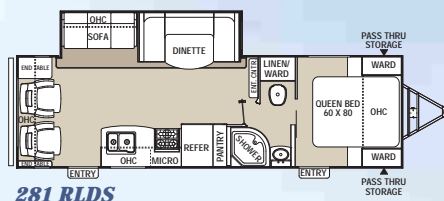

**LIBERTY EDITION** — Freedom Express **MAPLE LEAF EDITION** — Freedom Express

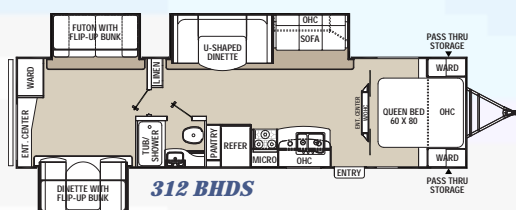

**320 BHDS** Convenient outside kitchen with standard TV hook-ups.

Deep Slides	281 RLDS	282 BHDS	292 BHDS	293 RLDS	297 RLDS	298 REDS	305 RKDS	310 BHDS	312 BHDS	320 BHDS	322 RLDS
Shipping Weight*	5,550	5,572	5,492	7,194	6,499	6,876	6,199	6,597	7,122	7,374	7,200
Hitch Weight	712	737	740	985	898	832	774	865	870	841	912
Carrying Capacity	1,908	2,086	1,306	2,764	3,953	2,982	3,259	3,061	3,336	3,643	2,558
Exterior Length (Bumper to Hitch)	31' 8"	31' 11"	33' 5"	35' 11"	35' 2"	35' 2"	34' 6"	35' 7"	36' 9"	36' 11"	35' 11"
Exterior Height (Includes A/C)	10' 9"	10' 9"	10' 9"	11' 2"	11'	11'	11'	11'	11' 2"	11' 2"	11' 2"
Interior Height (Coach)	81"	81"	81"	81"	81"	81"	81"	81"	81"	81"	81"
Awning Length	18'	18'	18'	12' and 10'	20'	18'	20'	18'	18'	20'	20'
Fresh Water Capacity (gal.)	49	49	49	49	49	49	49	49	49	49	49
Grey Water Capacity (gal.)	33	33	33	33	33	33	63	33	33	66	33
Waste Water Capacity (gal.)	33	33	33	33	33	33	33	33	33	33	33
Tire Size	ST205/75R14C	ST205/75R14C	ST205/75R14C	ST225/75R15D	ST225/75R15D	ST225/75R15D	ST225/75R15D	ST225/75R15D	ST225/75R15D	ST225/75R15D	ST225/75R15D

\*Shipping weights do not include options.





<b>Freedom Express Blast</b>	<b>271 BL</b>	<b>301 BLDS</b>
Shipping Weight	5,566	6,459
Hitch Weight	799	950
Carrying Capacity	3,434	3,399
Exterior Length (Bumper to Hitch)	30' 11"	33' 7"
Exterior Height (Includes A/C)	11' 9"	11' 10"
Interior Height (Coach)	90"	90"
Awning Length	20'	18'
Fresh Water Capacity (gal.)	98	98
Grey Water Capacity (gal.)	33	33
Waste Water Capacity (gal.)	33	33
Tire Size	ST225/75R15D	ST225/75R15D



*The Deep Slide **301BLDS** has a 10' enclosed garage with a slider patio door, raised roof line and a beavertail ramp transition.*

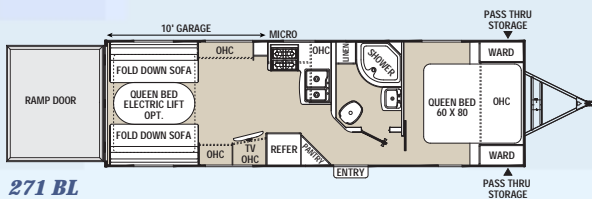

**271 BL**  
Find your freedom! This versatile, lightweight 10' open garage model is perfect for taking your show on the road. Shown in Cobblestone decor.

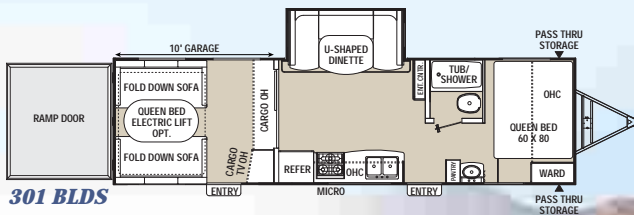

## Toy Haulers

Whether you're hauling mini-bikes or motocross, four wheelers or Fat Boys, there's a Freedom Express Toy Hauler for you. The 271BL has a front walk-around queen bed, large bathroom with abundant storage and a 10' open garage to haul all of your toys. The Deep Slide 301BLDS has a 10' enclosed garage with a slider patio door. Both models have raised roof lines and a beavertail ramp transition.





**23 TQX** Freedom Express Expandables feature exceptional floor space, storage and counter space – remarkable for an expandable! This triple-tent 23 TQX is shown in Cobblestone decor.



**21 TQX** This triple-tent model is shown in Truffle decor.

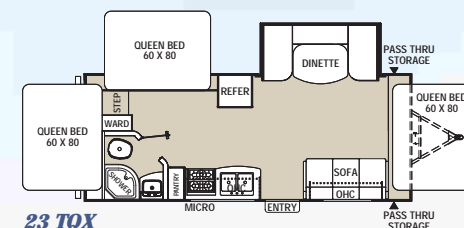
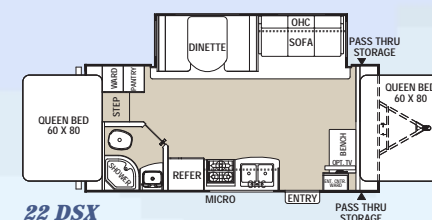
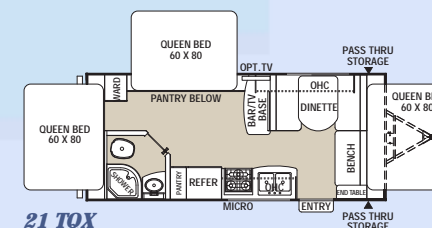

## Expandables

Pack all the livability of a 28'-33' travel trailer into the towability (and price) of a 21'-23' trailer. Freedom Express Expandables are easy to tow and come with the Secure-Lok tent system which eliminates the hassle of Velcro or bungs, making set-up and tear-down a snap – even for one person.



Freedom Express Expandables	21 TQX	22 DSX	23 TQX
Shipping Weight*	3,335	4,135	4,293
Hitch Weight	430	550	635
Carrying Capacity	2,463	2,863	2,665
Exterior Length (Bumper to Hitch)	22' 7"	22' 2"	24' 3"
Exterior Height (Includes A/C)	10' 3"	10' 9"	10' 9"
Interior Height (Coach)	81"	81"	81"
Awning Length	14'	16'	18'
Fresh Water Capacity (gal.)	36	36	36
Grey Water Capacity (gal.)	30	30	30
Waste Water Capacity (gal.)	30	30	30
Tire Size	ST205/75R14C	ST205/75R14C	ST205/75R14C

\*Shipping weights do not include options.



## Construction Features

**21 TQX** Freedom Express Expandables feature exceptional floor space, storage and counter space – remarkable for an expandable!



**21 TQX** This roomy Expandable features three fold-out queen beds, plenty of storage – all at a weight less than 4,000 lbs.!



1. 3M breathable graphics
2. Tinted, safety glass windows
3. Crowned trusses
4. Aluminum reinforced with 3/8" roof decking
5. EDPM rubber roofing
6. Azdel Composite Panels
7. Aerodynamic front profile
8. Dual 20 lb. LP gas tanks
9. Welded Aluminum structure, vacuum-bonded sidewalls and flooring
10. Smooth exterior fiberglass skin
11. Aluminum framed openings
12. Fully enclosed, heated under belly (25' and above)
13. Fully welded tubular aluminum floor structure
14. Happijac SureTrac™ rack and pinion slide systems
15. Congoleum Designer Carefree Resilient Flooring
16. Powder E-coated, welded I-beam frame
17. Super-Lube® axle hubs
18. Stable-Ryd® spread axle design (25' and above)
19. Nitrogen filled radial tires

## The Ultimate in Towability

### Lightweight

- ⌚ Laminated sidewalls and floor
- ⌚ Azdel behind the fiberglass
- ⌚ Bow trusses aluminum and wood
- ⌚ Rod & angle crossmembers in frame
- ⌚ All tanks mounted under floor to lower center of gravity and improve interior storage.

### Aerodynamic

- ⌚ Aerodynamic front profile (Cuts through the air)
- ⌚ Enclosed underbelly reduces turbulence/drag. (Select models)

### Stable-Ryd® Suspension

- ⌚ Spread axle improves weight distribution.
- ⌚ Wide track axles provide a wider, more secure stance on the road.
- ⌚ Spread axle design allows us to reduce the tongue weight for optimum performance.
- ⌚ Spread axle design reduces sway caused by crosswinds.



- ⌚ 50% Lighter than wood
- ⌚ No rot, mold or water damage
- ⌚ R-2 thermal insulation
- ⌚ Odorless, no formaldehyde
- ⌚ Sound & energy absorbing
- ⌚ Impact & puncture resistant
- ⌚ Made in USA

## Freedom Express is Truly Green



Freedom Express is TRA gold level rated. As a certified green RV, Freedom Express utilizes effective production techniques in combination with healthy materials, plus efficient usage of energy and water to produce a high quality RV with less environmental impact.

# Lightweight Towability and Enhanced Aerodynamics

Freedom Express Ultra-Light travel trailers are ideal for half-ton tow vehicles and optimized fuel efficiency. Designed with fully laminated, aluminum framed walls and floor, Freedom Express travel trailers and hybrid expandables are incredibly lightweight and durable.

## Freedom Express & Deep Slide Standard Features & Options

FE = Freedom Express Ultra Lites   LE = Liberty/Maple Leaf Edition Ultra Lites   DS = Deep Slide Models   EXP = Expandable Models   TH = Toy Hauler

	FE	LE
<b>INTERIOR &amp; DÉCOR</b>		
Cierra Cherry Colored Cabinetry and Arched Overheads	X	X
Maple Hardwood Cabinet Doors and Drawer Faces	X	X
Furniture Grade, Pocket Drilled and Screwed Stile and Rail Cabinet Front Construction	X	X
Mortise and Tenon Cabinet Door Construction	X	X
Full Extension Roller Bearing Drawer Guides	X	X
Three Designer Decors - Cobblestone, Sandstone, Truffle	X	N/A
Three Designer Decors - Autumn, Sunset, Slate	N/A	X
Designer Hard Valance Window Treatments	X	X
Pleated Night Shades (N/A in kitchen)	X	X
Optic-Lense Lighting Package	X	X
Range Hood with 12V Exhaust and Light	X	X
Sealed/Seamless Countertops	X	X
LG Solid Surface Kitchen Countertops with Undermount Sink	N/A	X
Brushed Nickel Hardware	X	X
High-Rise Kitchen Faucet	X	X
60/40 Stonecast Composite Kitchen Sink	X	X
Silverware Drawer with Removable Tray	X	X
Jackknife Sofa	X	N/A
43" Deep Convertible Booth Dinettes (Select models)	X	X
87" Convertible U-Dinettes (Select models)	X	X
Dinette Storage Access Doors	X	X
Hide-A-Bed Sofa (Most Deep Slide models)	OPT	STD
Accent Wall in Master Bedroom	X	X
"Deep Sleep" Mattress 60" x 80"	X	X
Two Full-Length Mirrored Closets in Master, and Over-Bed Cabinets with Integrated Reading Lights	X	X
Two Nightstands with 110V Outlets (Most models)	X	X
Storage Under Master Bed and Bunks (Select models)	X	X
Wooden Privacy Slider Doors to Master Suite In Place of Curtain or Accordion Door (Most models)	X	X
Entertainment Tower with Rotating TV for Bedroom Viewing (Select models)	X	X
Exhaust Vent with Fan in Bathroom	X	X
Vent in Bedroom	X	X
Charging Station	X	X
Wood Medicine Cabinet with Bathroom Mirror	X	X
Foot Pedal Toilet	X	X

	FE	LE
Porcelain Toilet	N/A	X
Interior Speakers with Selector Switch	X	X
55 Amp Power Converter	X	X
GFI Receptacles in Bathroom and Kitchen	X	X
LP Leak Alarm	X	X
Fire Extinguisher	X	X
Smoke and Carbon Dioxide Detector	X	X
Multiple Egress Windows with Screen and Prop Rod	X	X
Shoe Storage (Select models)	X	X
Ducted Air Conditioning (25' and above)	X	X
Cable Support Tent Ends - 1000# Capacity (EXP)	EXP	N/A
Frame Mounted Tie-Down D-Rings In Floor	TH	TH
Adjustable High/Low Fresh Air Vents	TH	TH
Zippered Roll-up Screen Wall with Privacy Panels at Ramp Door	TH	TH
Two Jackknife Sofas In Cargo Area	TH	TH
Large Indoor/Outdoor folding Table	TH	TH
Raised Roof Line - 90" Interior Cargo Height	TH	TH
Beavertail Ramp Transition	TH	TH
Sliding Patio Door Between Cargo and Living Areas (301 BLDS Only)	TH	TH
Helmet/Gear Storage in Cargo Area	TH	TH
<b>EXTERIOR</b>		
Aerodynamic Front Profile	X	X
Dual 20# LP bottles	X	X
LP Bottle Cover w/Valve Access	X	X
60" A-frame	X	X
Dual Battery Rack	X	X
Insulated, Painted Radius Entry Door with Screen Door	X	X
Amber Patio Light	X	X
Double Entry Step	X	X
Triple Entry Step	X	X
Wide Stance Stable-Ryd Spread Axle Design (25' and above)	X	X
Premium Aluminum Rims	X	X
Nitrogen Filled Radial Tires	X	X
3M Digitally Printed, Breathable Graphics	X	X
Black Framed, Tinted, Safety Glass Windows	X	X
Door Side Cable TV Connection	X	X
Super Lube Axles	X	X

	FE	LE
Dehco TV/Stereo Antenna	X	X
Marine Grade Exterior Speakers	X	X
Lighted Expanded Pass-through Storage (Most models)	X	X
Water Heater Bypass	X	X
30 Amp Power Cord with Storage Compartment	X	X
Heavy Duty Welded Safety Chains	X	X
Four-Wheel Electric Brakes	X	X
Breakaway Safety Cable	X	X
Exterior GFI Outlet Near Awning	X	X
High-Capacity Roto-Cast Holding and Fresh Water Tanks	X	X
Hinge Mounted Spring Assist Ramp Door System	TH	TH
Integrated Bar and Latch Locking System on Ramp Door	TH	TH
HappiJac Double Hat Rail, Rack and Pinion 12V Slide System (18" slides)	X	X
LCI Rack and Pinion 12V Slide System with Full Width Welded Ram (38" slides)	X	X
Schwintek Slide System (Some models)	X	X
A-Frame Mounted Generator/Storage Rack (N/A on Liberty/Maple Leaf Editions)	TH	N/A
Electric Awning (IPO Manual)	X	X
<b>CONSTRUCTION</b>		
Powder E-Coated Welded I-Beam Frame with Full Width Outriggers	X	X
Alumicage Welded Aluminum Structure, Vacuum Bonded Floor and Sidewalls	X	X
Azdel Composite (IPO Iuan behind fiberglass)	X	X
Smooth Fiberglass Exterior Skin	X	X
Aluminum Framed Openings	X	X
Powder E-Coated Steps and Axles	X	X
Floorplan Specific Cambered Frame Design	X	X
Full Walk-on, Crowned, Aluminum Reinforced Roof with EPDM Membrane over 3/8" Roof Decking	X	X
Double Wiper Seals on All Slideouts	X	X
Enclosed and Heated Underbelly (25' and above)	X	X
<b>STANDARD EXTRAS</b>		
Green Certification	X	X
Seal Tech and Rain Bay Testing on Every Unit	X	X
One-Year Free Membership to Coachnet Roadside Assistance	X	X
One-Year Free Membership to Coachmen Owner's Association (C.O.A.)	X	X



# Freedom Express Options & Packages

	FE	LE
<b>OPTIONS</b>		
• 15,000 BTU A/C	X	X
• 50 Amp Service with Second A/C Prep	X	X
• Push-button Power Stabilizer Jacks (25' and above)	X	X
• Power Tongue Jack	OPT	STD
• Coleman Slide-Out High Output Grill (Select models)	X	X
• Hide-A-Bed (Deep slides only)	X	STD
• Recliners	N/A	X
• Frameless Windows	X	X
• Liberty/ Maple Leaf Edition Luxury Upgrade (DS only- description below)	N/A	X
• Electric Queen Track Bed	TH	TH
• Second Electric Queen Track Bed	TH	TH
• Canadian Compliance	X	X

## **LIBERTY/MAPLE LEAF EDITION**      **N/A**      **X**

- Raised Panel Sierra Glazed Maple Doors
- Raised Panel Refer Inserts
- LG Solid Surface Kitchen Countertop with Undermount Sink and Sink Covers
- Hinged Door, Slider Door, and Pots and Pans Drawer Under Dinette
- Three Upgrade Décors - Autumn, Slate, Sunset
- Porcelain Toilet with Foot Flush
- Kitchen Feature Wall/Backsplash - Glass
- Central Control Panel for Switches and Gauges
- Congoleum Designer Carefree Premium Floorcovering
- 32" LCD TV (39": 298 REDS, 322 RLDS)
- Hide-A-Bed
- Freedom Sky View Window with Pleated Shade and Hi-Intensity Puck Lights over Dinette
- Sconce Light in Slide Out
- LED Accent Lights in Kitchen
- Painted Fiberglass Cap with LED Hitch and Marker Lights
- Special Liberty/Maple Leaf Edition Graphics with Charcoal Skirt Metal
- Slam Latch Baggage Doors on Pass Through Storage
- Enclosed and Heated Gate Valves
- Camp Side Security Light
- Black Tank Flush System
- Power Tongue Jack
- RG6 TV Hook-up Camp Side
- Black and Tan Exterior

## **25' Models and Above**      **FE**      **LE**

### **FREEDOM VALUE PACKAGE (Required)**      **X**      **X**

- Black and Tan Exterior
- Aluminum Wheels
- Power Awning
- 24", 32" or 39" LED TV
- AM/FM/CD/DVD/Bluetooth
- 4 Interior, 2 Exterior Speakers
- Skylight
- Stonecast Sink
- Night Shades Throughout
- Metal Skirting
- Color Matched Fenders
- Folding Entry Assist Handle
- Ducted Ceiling Air Conditioning (25' and above)
- Heated Enclosed 33/33 Holding Tanks (25' and above)
- 49 Gallon Fresh Water Holding Tank (25' and above)
- Spread Axle Design (25' and above)
- 6 Gallon Gas/Electric DSI Hot Water Heater
- Tinted Safety Glass Windows
- TV Antenna with Booster
- Exterior Shower Station
- Spare Tire Kit
- Front Diamond Plate
- EZ Lube Axles
- RVIA
- Congoleum Flooring
- Mortise and Tenon Cabinet Doors
- Microwave
- Oven with 3 Burner Cooktop
- 6 Cu. Ft. Two Door Refrigerator
- Ducted Furnace (25' and above)
- Silverware Drawer
- 60"x 80" Queen Bed
- LED Interior Lighting Throughout
- Electronic Charging Station
- Sink Covers

### **PREMIER PACKAGE**      **N/A**      **X**

#### **Available on Liberty and Maple Leaf Editions only**

- 26" Electric Fireplace with Slate and Walnut Look Surround
- Large 8 Cu. Ft. Refrigerator
- Energy Efficient LED Lighting over Dinette
- Coffered Ceiling with LED Accent Lights
- 4" LED Recessed Light in living Area
- LED Surface Mounts Overheads and Bedrooms
- LED Rope Light at Awning Entry Step and Pass-through Storage
- Durable 24" x 48" Resin Outdoor Table

## **25' Models and Below**      **FE**      **LE**

### **FREEDOM VALUE PACKAGE (Required)**      **X**      **N/A**

- Black and Tan Exterior
- Aluminum Wheels
- Power Awning
- 24" or 32" LED TV (32" on Entertainment Center Models)
- AM/FM/CD/DVD/Bluetooth
- 4 Interior, 2 Exterior Speakers
- Skylight
- Stonecast Sink
- Night Shades Throughout
- Metal Skirting
- Color Matched Fenders
- Folding Entry Assist Handle
- 6 Gallon Gas/Electric DSI Hot Water Heater
- Tinted Safety Glass Windows
- TV Antenna with Booster
- Exterior Shower Station
- Spare Tire Kit
- Front Diamond Plate
- EZ Lube Axles
- RVIA
- Congoleum Flooring
- Mortise and Tenon Cabinet Doors
- Microwave
- Oven with 3 Burner Cooktop
- 6 Cu. Ft. Two Door Refrigerator
- 18,000 BTU Furnace
- Silverware Drawer
- Evergreen Queen Mattress (Select models)
- 60"x 80" Queen Bed
- LED Interior Lighting Throughout
- Electronic Charging Station
- Sink Covers

### **ENTERTAINMENT PACKAGE**      **X**      **N/A**

#### **Optional upgrade on standard Freedom Express models**

- LED 4" Recessed Lights in Living Area
- LED Pancake Lights at Overhead Cabinets and Bedroom
- White LED Awning Light
- LED Step Light
- LED Lights Throughout Coach
- 24" x 48" Resin Outdoor Table

## Standard Decor



## Liberty Edition Decor Upgrade



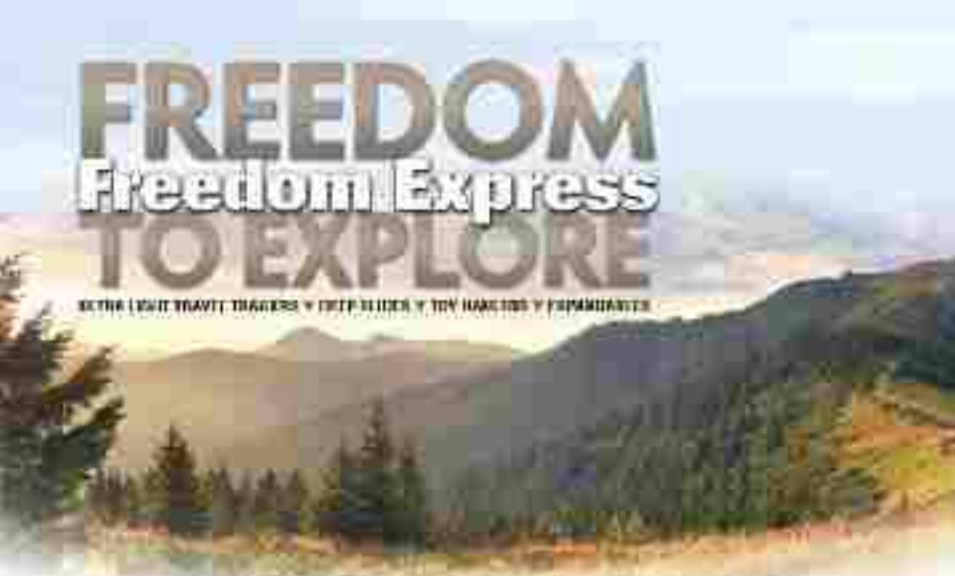

**Find out why Freedom Express has become one of the most demanded ultra light towable RV brands on the market today!**



### **Travel Easy™ Roadside Assistance**

RVing is easier with Coachmen's Travel Easy™ Roadside Assistance provided FREE the first year of ownership to those who purchase a New Coachmen RV. Administered by Coach-Net, this service provides you with 24/7 operational, technical and emergency road service coverage. Also included is towing, fuel delivery, jump starts, lockout service, tire changes, mobile mechanic and unlimited technical assistance. Anywhere. Anytime. Travel Easy™ is the security of knowing that help is an easy phone call away.



### **Big benefits for new owners – FREE One Year Membership in the Coachmen Owners Association!**

Coachmen is proud to sponsor the largest manufacturer sponsored camping club in North America...Coachmen Owners' Association (COA). COA provides you a world of ways to enjoy your RV. This is FUN ON OVERDRIVE and provides: Free Trip Routing, Exciting Tours & Rallies, Free Campground Directory, Local/State Club Activities, Easy RVing Magazine Free, Theme Park Discounts, Fuel Discounts, Free onebigplanet® Memberships with discounts at 180,000 merchants and Much More! Every new Coachmen RV buyer is eligible for a 1 Year FREE membership in the Coachmen Owners' Association. It all adds up to an easy ownership experience!



423 N. Main Street • P.O. Box 30 • Middlebury, IN 46540  
To learn more about Coachmen RV and our products and see how Coachmen is making the easy life easier, visit [www.coachmenrv.com](http://www.coachmenrv.com) or call 1.800.353.7383.



**Forest River, Inc. encourages our customers to purchase their Forest River products from a local dealership whenever possible for the following reasons:**

- 1) Forest River, Inc. dealers are independently owned and operated businesses so priority service and scheduling is at their discretion and is often provided to customers that purchased their unit at that dealership.
- 2) Purchasing locally allows customers to establish meaningful relationships with a dealer, enhancing the RV experience through assistance with product questions, user tips or RV regulations for your state or country, and much more!
- 3) Canadian customers must meet requirements to bring an RV purchased out of the country to their home. These requirements may involve additional inspections and certifications, taxes and fees. Your local Canadian Dealer is a professional at meeting these requirements.
- 4) Scheduling timely warranty repairs and adjustments through a local dealership provides far greater flexibility and convenience to you, the customer!

It is the goal of Forest River, Inc. that all of our RV owners fully enjoy the RV experience and that customer satisfaction meets or exceeds their expectations!



**Learn More**  
Scan this barcode using a QR Reader on your smart phone to learn more about Forest River.



A Berkshire Hathaway company.

All information contained in this brochure is believed to be accurate at the time of publication. However, during the model year, it may be necessary to make revisions and Coachmen reserves the right to make all such changes without notice, including prices, colors, materials, equipment and specifications as well as the addition of new models and the discontinuance of models shown in this brochure. Therefore, please consult with your Coachmen dealer and confirm the existence of any materials, design or specifications that are material to your purchase decision. All units are shipped F.O.B. point of manufacture. ©Freedom Express by Coachmen, a Division of Forest River, Inc., a Berkshire Hathaway company. All Rights Reserved. 1/15