

1993

Four Winds

*XL Series Laminated Travel Trailers
and Fifth Wheels*

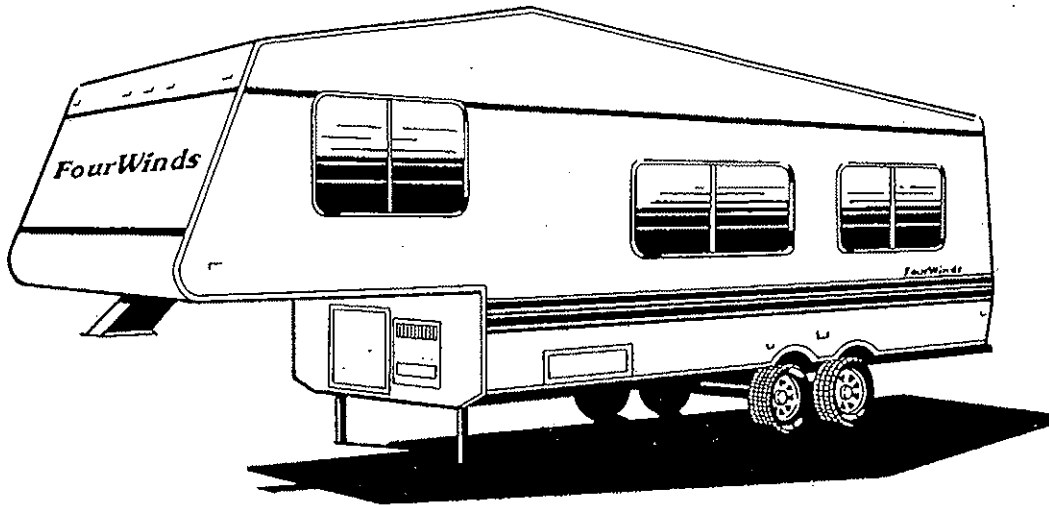
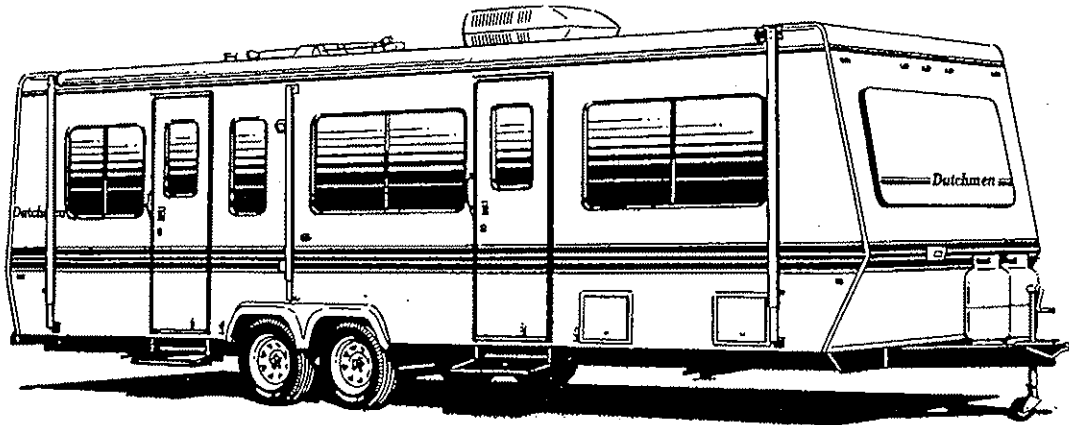

*The ultimate camping machine
where quality, value, reliability
and style come together.*

Travel Trailer Floor Plans

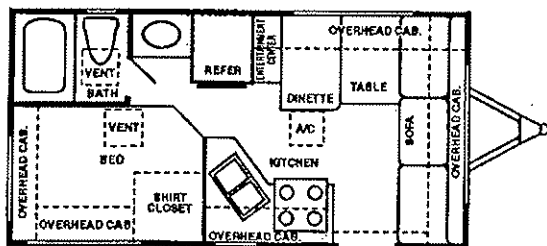

19A

Available with Option 2

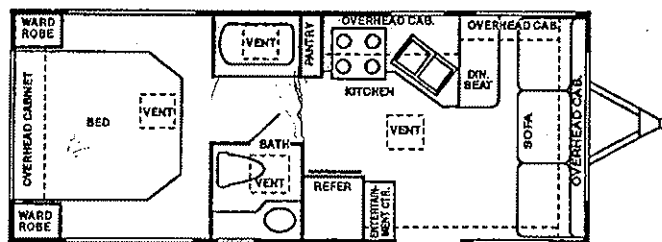

24Q

Available with Options 3, 4, 5, 6, & 7

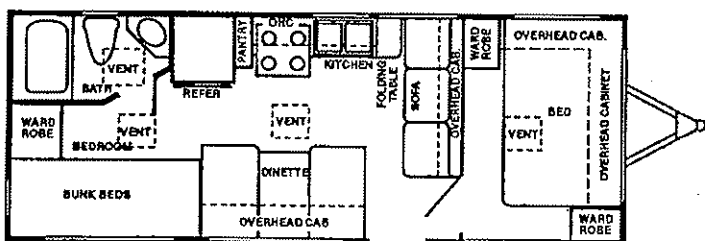

26DD

Available Option 1

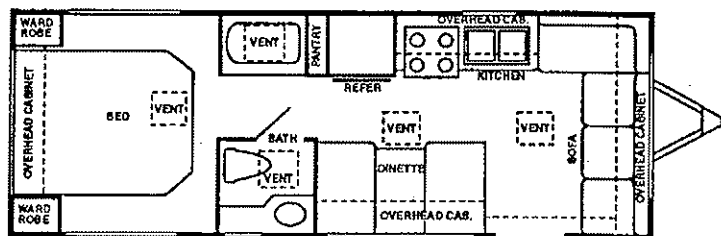

26L

Available Options 3, 4, 5, 6, & 7

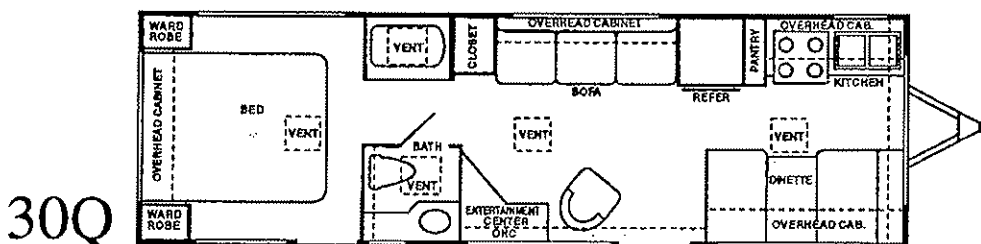

30Q

Available Options 3, 4, 5, 6, & 7 w/o rear door

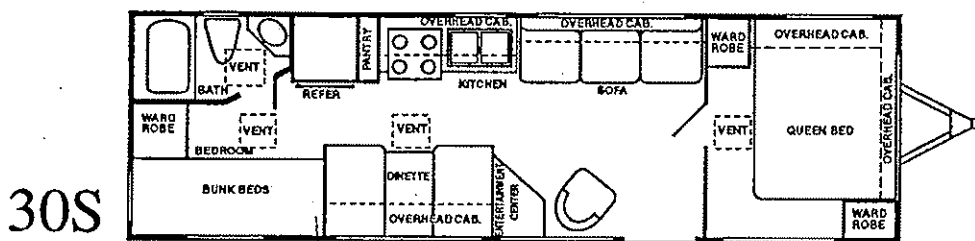

30S

Available Options 1, 2, 3, 4, 5, 6, & 7

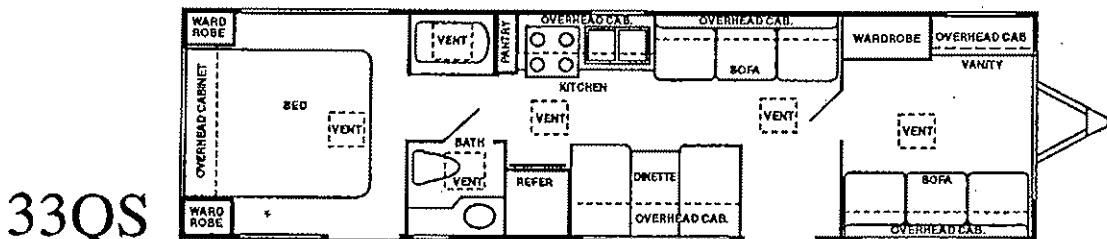

33QS

Available Options 3, 4, 5, 6, & 7 in front & Options 3, 4, 5, 6, & 7 w/o rear door

Travel Trailer Floor Plan Options

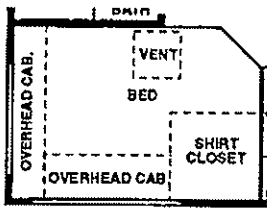

Option 1 w/rear bath only

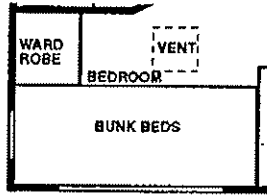

Option 2 w/rear bath only

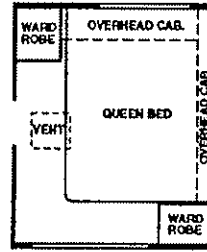

Otion 3

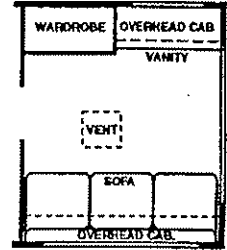

Option 4

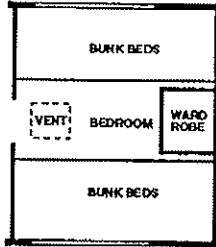

Option 5

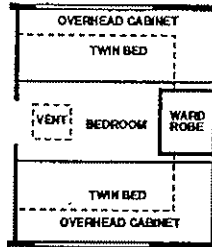

Option 6

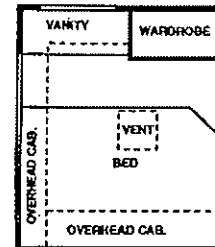

Otion 7

Fifth Wheel Floor Plans

24FRK

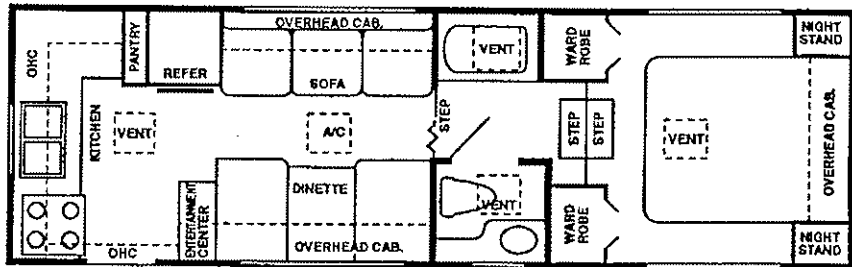

26FRK

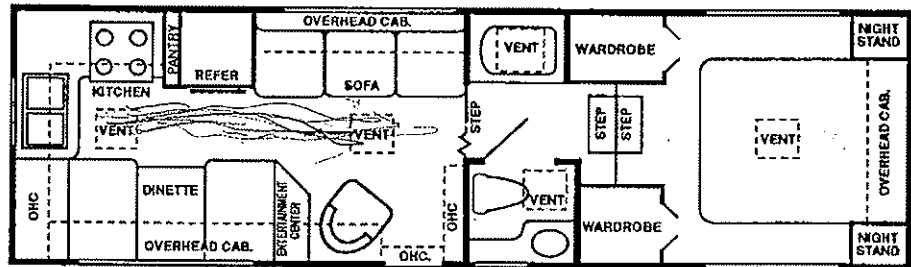

29FRK

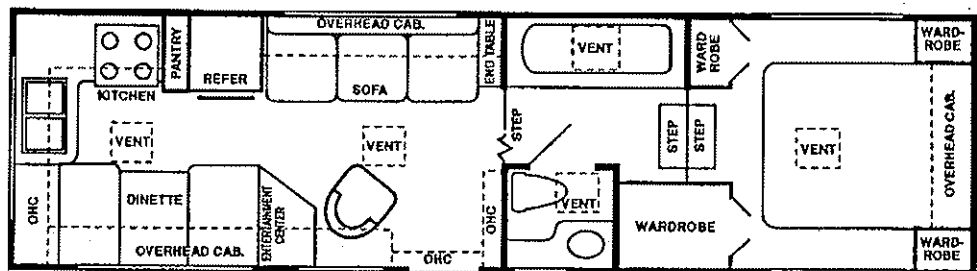

Travel Trailer Specifications

Model	19A	24Q	26DD	26L	30Q	30S	33QS
Fresh Water Capacity (gal)	32	32	32	32	45	45	45
Combined Waste Water Capacity(gal)	48	48	48	48	48	48	48
Water Heater (gal)	6.2	6.2	6.2	6.2	6.2	6.2	6.2
LP Gas Capacity (gal)	14	14	14	14	14	14	14
Dry Weight (lbs)*	4200	4690	5000	5190	5520	5560	5930
Hitch Weight (lbs)*	160	300	430	450	790	470	680
GVWR (lbs)	7800	7800	7800	7800	7800	7800	7800
Interior Height (inches)	80	80	80	80	80	80	80
Furnace (1000 BTU's)	25	25	31	31	31	31	31
Exterior Height (w/o A/C)	8'-10"	8'-10"	8'-10"	8'-10"	8'-10"	8'-10"	8'-10"
Overall Length (actual)	19'-5"	24'-2"	25'-10"	25'-10"	29'-8"	29'-8"	32'-5"
Overall Width (inches)	93	93	93	93	93	93	93

*Weights are approximate and include Roof A/C, Microwave, and all standard equipment.

Fifth Wheel Specifications

Model	24FRK	26FRK	29FRK
Fresh Water Capacity (gal)	32	32	45
Combined Waste Water Capacity(gal)	48	48	48
Water Heater (gal)	6.2	6.2	6.2
LP Gas Capacity (gal)	14	14	14
Axle Weight (lbs)*	4200	4670	4910
Pin Weight (lbs)*	1340	1540	1740
GVWR (lbs)	7800	7800	7800
Furnace (1000 BTU's)	25	31	31
Overall Width (inches)	93	93	93

*Weights are approximate and include Roof A/C, Microwave, and all standard equipment.

Standard & Optional Features

INTERIORS: Blue • Taupe • Mauve • Teal

CHASSIS

Tandem axle with 4 wheel electric brakes - Oversize radial tires - welded steel tube chassis - 5-1/2" Z channel cross members - Rear hose storage bumper with cover - Battery rack and harness.

CONSTRUCTION FEATURES

RVIA & CSA listed - 2" welded tubular steel floor frame - High density polystyrene insulated, fully laminated floor system - Laminated aluminum underbelly - 1-1/2" Laminated aluminum frame walls - 2" Laminated roof, double studded at air conditioner vent - Laminated seamless aluminum roof deck - High density extruded insulated polystyrene aluminum frame walls, roof.

EXTERIOR FEATURES

Deluxe fiberglass exterior - Extra large radius anodized windows - Front and rear rock guard awnings (most models) - Emergency escape window - Heat exhausts located off camp side - Centralized camp hook-ups - L.P. bottle covers - Stabilizer jacks at all four corners - Deadbolt lock on entry door - Streak resistant foam seal at windows and doors - Exterior porch light - Hitch light - 110 volt waterproof receptacle - 3M metallic exterior graphics - ABS molded wheel well flares - Awning rail - Entry assist handle.

INTERIOR FEATURES

Rail style cabinets with radius corner construction - Solid Oak cabinet doors and drawer fronts with etched glass in overheads - Style-constructed cabinetry - Impact resistant brass-tone edged counter tops - Full six feet eight inches of interior height (full width, not just the center) - Separate dinette not raised off floor for convenient access - Family-style folding table for the dinette (no troublesome, shaky pedestal legs) - Deluxe carpet & pad throughout - Inner spring support mattress with easy care fabric covering - Reversible sham and bedspread with pillows - Deep stainless steel sink with a residential long-neck faucet - Counter top coordinated sink cover for more counter space - Designer vinyl back splash - Smoke detector - Decorator picture - Generous overhead storage - Queen size bed - Cabover with shelf - Fire extinguisher - Lockable support assists - Dinette table converts to bed - Linen walls throughout - Plush velvet upholstery with designer pattern & trim - Color co-ordinated drapes with fabric action valance packages and bi-fold shades - Deluxe carpet with pad - Lined, hand fitted cabinets (no gimp molding) - Steel framed sofa - Wood notched drawers with steel slides, nylon rollers - Extra wide bath door (most models) - Bed lift struts (island bed models) - Slide out canned goods pantry (most models).

ELECTRICAL

TV antenna with signal booster and amplifier - Holding tank monitor panel - Second TV outlet in bedroom - 45 Amp power center with 12 volt generator/charger, fuses and 110 volt breakers - 12 volt demand water pump - Pre-wired for roof air - Easy store electric supply cord - Ground fault circuit interrupted - Outside receptacle - 110 volt receptacles - Well illuminated interiors.

APPLIANCES

Large double-door European style black front refrigerator - Deluxe black glass 4-burner gas range with oven - Enamel lighted power range hood - 6.2 gallon fast recovery LP D.S.I. water heater - 1380 watt 1.2 cubic foot microwave - 110 volt receptacles.

BATH FEATURES

Full tub/shower combination with tub enclosure - Folding shower door - Power bath fan - Marine type toilet with vented holding tank - Lavatory with base cabinet storage - Oak framed mirrored medicine cabinet - Bath convenience accessories (towel ring, soap dish, paper holder, tooth brush holder) - 110 volt G.F.I. receptacle.

HEATING & SYSTEMS

Electronic ignition, forced air LP gas furnace with wall thermostat - Dual 30 lb. propane tanks - Ceiling ducted thermostatically controlled air conditioning system - Fully enclosed, insulated, heated holding tanks - Above floor heated fresh water system with tank, 12 volt demand water pump - Low point drains and water heater by-pass for winterizing - Copper water fittings (not plastic) - Outside fresh water drain.

OPTIONAL FEATURES

13500 BTU roof air conditioner - Deluxe awning with enameled hardware - Second bifold door - Shower door - Safety glass - AM/FM cassette stereo - Spare tire with carrier - Safety chains - Optional bedroom arrangements - Free standing dinette (some models).

MANUFACTURER'S NOTE:

We reserve the right to make any changes at any time. All dimensions given are nominal.

Four Winds International Corporation
 55667 C.R. 15 P.O. Box 1486 Elkhart, IN 46515-1468
 Phone: 219-266-1111 Fax 219-293-5256

FOUR WINDS INTERNATIONAL CORPORATION



FACSIMILE TRANSMITTAL SHEET

TO: Eddie	FROM: John Vrydaghs	
COMPANY: Dutchmen	DATE: 11/21/03	
FAX NUMBER: 537-0496	TOTAL NO. OF PAGES INCLUDING COVER: 6	
PHONE NUMBER:	UNIT SERIAL NUMBER:	CHASSIS VIN NUMBER:
RE: Four Winds TT Info	YOUR R.O. NUMBER:	

NOTES/COMMENTS:

Eddie,

I found 1993, but not 1992 info.

Hope this helps!

A handwritten signature in black ink, appearing to be 'John V.', with a long, sweeping underline.

John V.

CLAIMS TO: P.O. BOX 1486 ELKHART, IN 46515-1486
PARTS RETURN ADDRESS: 520 C.R. 15 ELKHART, IN 46516
PHONE 574-266-1111 EXT. 209
FAX 574-294-3618
EMAIL: JVRDAGHS@4WINDS.COM OR JOHNV@4WINDS.COM