



Dutchmen

Fold Down Campers



*Continuing the Tradition of
Craftsmanship, Quality and Value...*

Dutchmen Fold Down Campers

Dutch Craftsmanship, Quality & Value

801

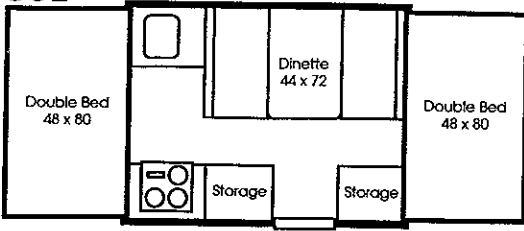

	801	1001
Interior length open	17'	21'
Interior width	6'8"	6'8"
Interior height open	6'7"	6'7"
Height closed	4'4"	4'4"
Sleeping capacity	6	6
Trailer size closed	12' x 7'1"	14' x 7'1"
Approx. dry weight - axle	1055#	1260#
Approx. dry weight - hitch	155#	160#
Approx. total weight	1190#	1420#
GVWR	1955#	2360#

1001

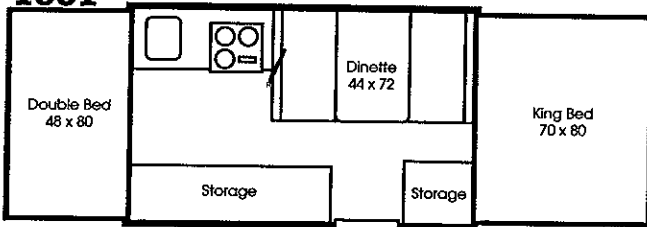

	1002	1003
Interior length open	21'	21'
Interior width	6'8"	6'8"
Interior height open	6'7"	6'7"
Height closed	4'4"	4'4"
Sleeping capacity	8	8
Trailer size closed	14' x 7'1"	14' x 7'1"
Approx. dry weight - axle	1250#	1250#
Approx. dry weight - hitch	160#	160#
Approx. total weight	1410#	1410#
GVWR	2360#	2360#

1002

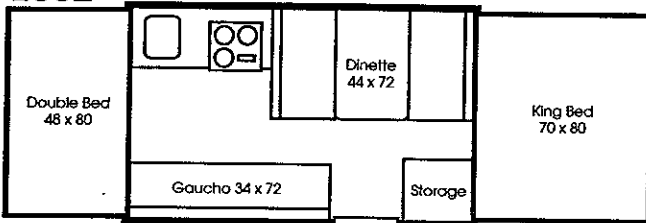

1003

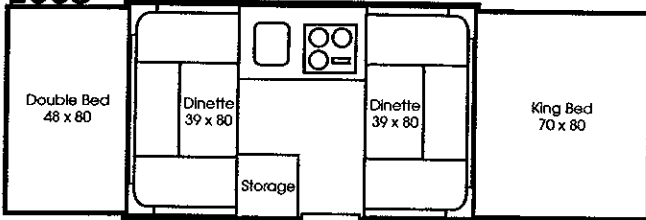

1001 XS

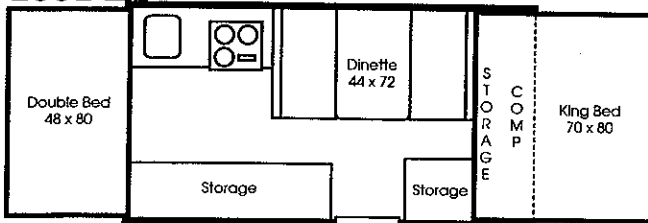

	1001 XS	1002 XS
Interior length open	21'	21'
Interior width	6'8"	6'8"
Interior height open	6'7"	6'7"
Height closed	4'4"	4'4"
Sleeping capacity	6	8
Trailer size closed	16' x 7'1"	16' x 7'1"
Approx. dry weight - axle	1445#	1435#
Approx. dry weight - hitch	125#	125#
Approx. total weight	1570#	1560#
GVWR	2360#	2360#
Extra Storage Capacity	21 Cu. Ft.	21 Cu. Ft.

1002 XS

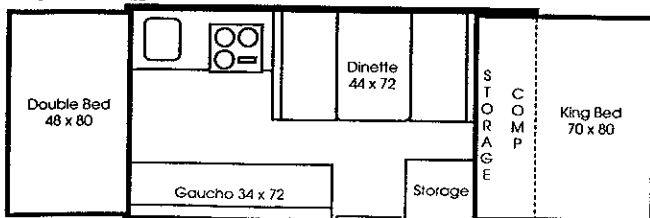

1202

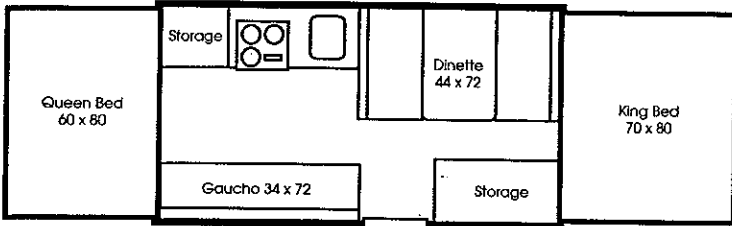

	1202
Interior length open	24'
Interior width	6'8"
Interior height open	6'7"
Height closed	4'4"
Sleeping capacity	8
Trailer size closed	16' x 7'1"
Approx. dry weight - axle	1430#
Approx. dry weight - hitch	170#
Approx. total weight	1600#
GVWR	2370#

1203

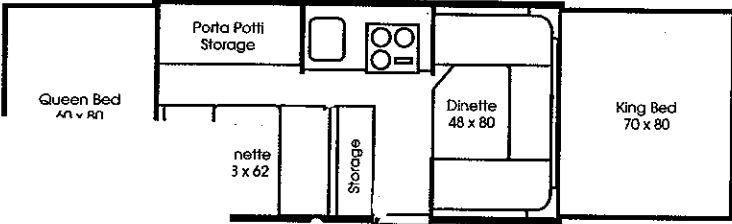

	1203	1204
Interior length open	24'	24'
Interior width	6'8"	6'8"
Interior height open	6'7"	6'7"
Height closed	4'4"	4'6"
Sleeping capacity	8	6
Trailer size closed	16' x 7'1"	16' x 7'1"
Approx. dry weight - axle	1610#	1620#
Approx. dry weight - hitch	190#	190#
Approx. total weight	1800#	1810#
GVWR	2390#	2500#

1204

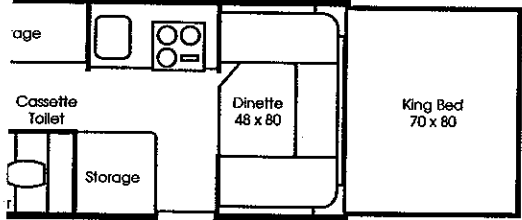

Crank-up Lift System

- The drive system is enclosed for protection from weather and road conditions.
- The underneath location of the system allows for easy inspection and maintenance. Grease zerks are located top and bottom of the main tube to allow yearly maintenance.
- A single cable capable of 3,200 lbs. tensile strength rotates around the rear cable pulley and pushes the four flexible steel push rods up the lifter posts.
- Flexible steel push rods.
- Four stage plated lift post.
- Lifetime warranty - see dealer for details.

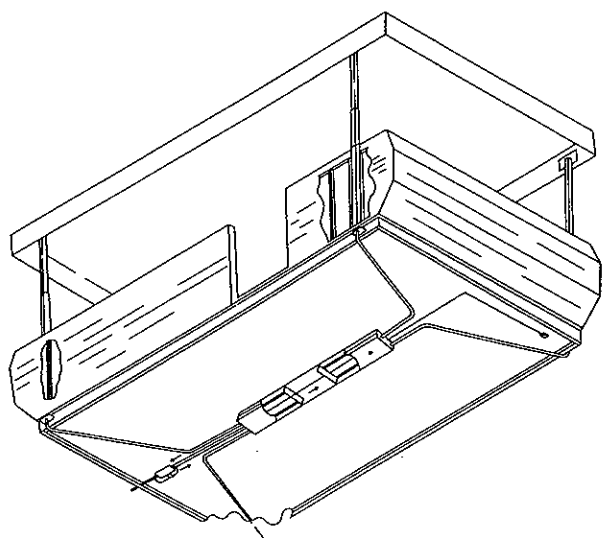

Models shown on cover are #1203 and #1001

CHECK IT OUT BEFORE YOU BUY...

Shop and Compare ... Only Dutchmen offers all these features as standard:

- Seamless Roof
- Privacy Curtains
- Storage Bumper
- Spare Tire, Carrier & Cover
- Step
- 10 Gal. Water Tank (15 in 1204)
- Fiberglass Exterior
- Awning
- Porta Potti Storage (N/A 1003)
- Battery Prep
- Bottle Cover
- Dome Light Safety Switch
- 3 Burner In/Out Range
- Oak Framed Doors
- 12 Amp Converter
- Outside Storage Compartment
- 6" Tapered Rail Frame
- 12" Tires (13" on 1204)
- Air Conditioner Prep
- Outside Receptacle
- 14" x 14" Roof Vent
- Clothes Bar
- Oversized Dinettes
- Oversized Beds

ACCOMMODATIONS

- All models sleep six (1002, 1002XS, 1202 & 1203 sleep eight)
- Adult sized dinettes, bunks and gauchos
- 4" reversible cushions on bunks, dinette and gauchos
- Lined decorator curtains, with tie backs at walls
- Privacy curtains for bunks
- Inside-outside dinette table
- Tinted vinyl windows
- Oak framed cabinet doors with positive catches
- Storage cabinets
- Porta potti storage (N/A 1003)
- Clothes bar
- Laminated counter tops
- Cassette toilet 1204

APPLIANCES

- 3 burner inside/outside range
- Built-in 35# (60 quart) ice box
- Splash guard for range
- 6 Gallon water heater (1204 only)

GENERAL WARRANTY INFORMATION

- Lifter System Lifetime*
- Floor 10 yrs.*
- Fiberglass Skin 10 yrs.*
- Tent 5 yrs.*
- General Camper Coverage (Except Tires & Appliances) 5 yrs.*

*Refer to specific written warranty statement

CONSTRUCTION

- Exclusive 6" tapered rail, steel channel frame
- Steel storage bumper
- Adjustable stabilizer jacks
- Front jack with dolly wheel
- Wide track torsion axle with independent suspension
- 5.30 x 12" automotive type tires (13" on 1204)
- Spare tire, carrier and cover
- 2" ball coupler
- Exterior mounted, enclosed lifter system with grease fittings
- 5 piece sectionalized tent constructed of 10.10 oz. canvas & 13 oz. supported vinyl
- Fiberglass, vacuum-bonded, foam core roof - seamless
- Fiberglass, vacuum-bonded, front, rear and sidewalls
- Step, self storing

EQUIPMENT

- 14" x 14" roof vent
- Outside storage compartment door
- 10 gallon fresh water storage tank (15 gallon on 1204)
- Two stage water faucet
- Stainless steel sink
- Brass city water hook-up
- 20# LP bottle with cover and regulator
- Air conditioner prep
- Awning

ELECTRICAL

- 25', 30 amp power cord
- 12 amp power converter with circuit breakers
- 12 volt water pump (1204)

- 5 way car connector (6 way with brakes)
- 110 volt outlets
- Outside 110 volt outlet
- Amber patio light
- Battery wiring
- Dome light safety switch
- Two 12 volt ceiling lights
- Eleven clearance lights

OPTIONS

- Refrigerator
- Brakes, electric
- Double 20# bottles
- Furnace, 16,000 btu
- Screen room
- Canadian code

See your Dutchmen dealer for all the details:

NOTE: At Dutchmen we constantly improve our product; as a result all specifications and dimensions are subject to change without notice.

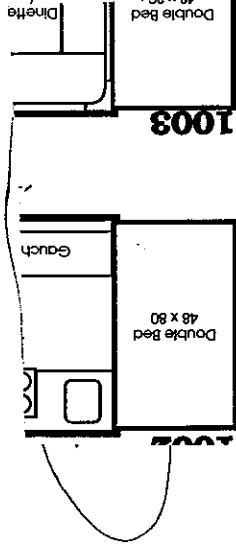

DUTCHMEN MFG., INC.

DUTCHMEN Accessories & Options

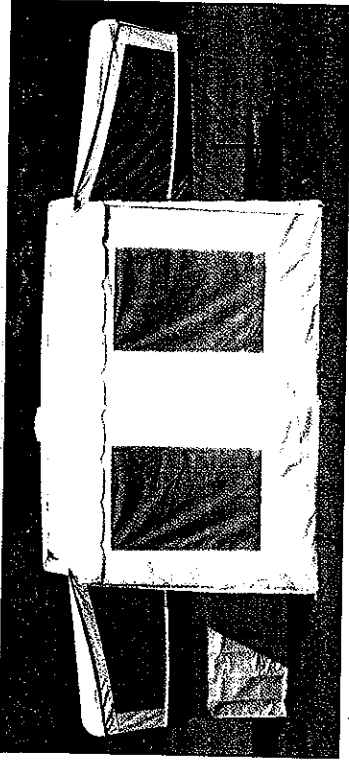

Add-a-Room gives you up to 70 sq. ft. of living space with greater privacy. A screen room adds a delightful screened-in porch to your camper for shade by day and insect-free relaxation in the evening.



A cloth wardrobe allows you to hang clothing neatly while you're camping, yet folds up easily when you're traveling or the unit is in storage.

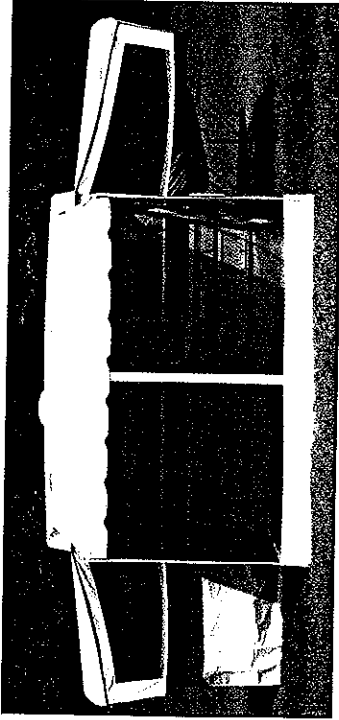

An easily attached cargo net not only adds extra storage capacity, but also keeps items safely out of reach of small children.

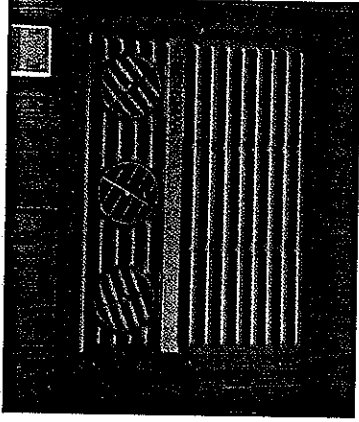

A Cool Cat heat pump will bring a new level of comfort to your camping.

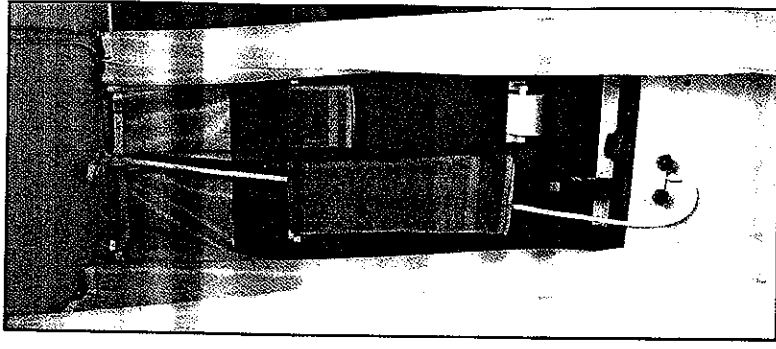

Dutchmen's hot water lines allow you to wash dishes and shower just like home. (Optional) And the exterior shower will keep dirt outside where it belongs.

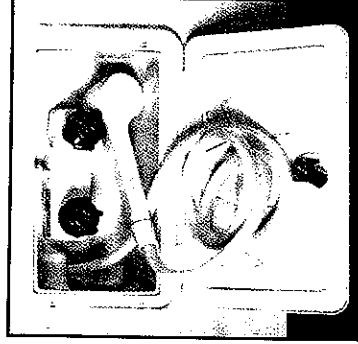

We've carefully designed Dutchmens to give you as much storage space as possible. Our extra-storage models give you even more space in these exterior storage compartments, perfect for outdoor and sporting goods.

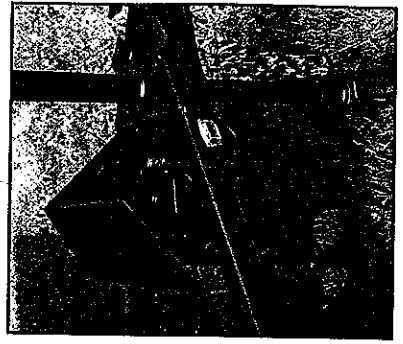

An electric winch makes setting up your Dutchmen fast, nearly effortless, and easy on the back.

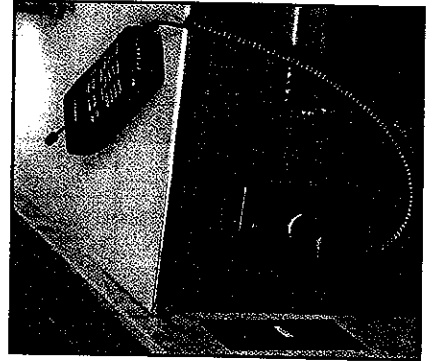
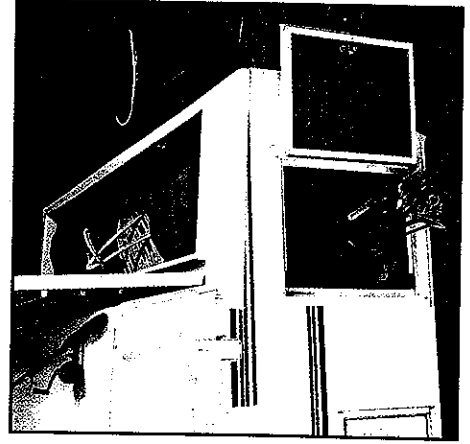

An accessory power port allows unlimited use of your cellular phone or other accessories while you camp.