



# DUTCHMEN



## UTCHMEN "DUCK"

Fold Down  
Campers



'95-'96

Dutch Craftmanship,  
Quality & Value...





# Dutchmen "Classic" Fold Down Campers

## Dutch Craftsmanship, Quality & Value

**801**

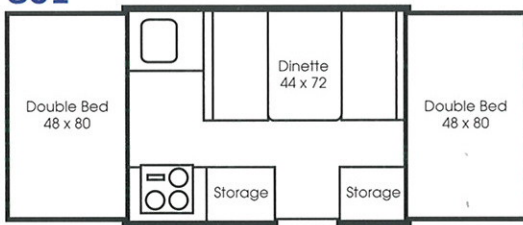

**801**

**1001**

Interior length open	17'	21'
Interior width	6'8"	6'8"
Interior height open	6'7"	6'7"
Height closed	4'4"	4'6"
Sleeping capacity	6	6
Trailer size closed	12' x 7'1"	14' x 7'1"
Approx. dry weight - axle	1055#	1260#
Approx. dry weight - hitch	155#	160#
Approx. total weight	1190#	1420#
GVWR	1955#	2360#

**1001**



**1203**

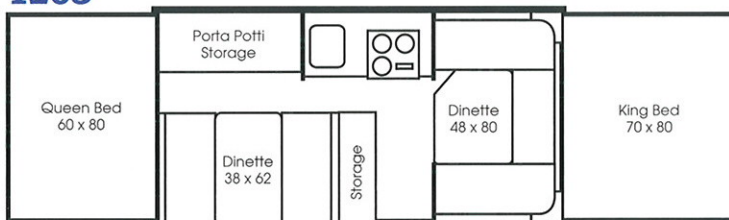

**1203**

**1204**

Interior length open	24'	24'
Interior width	6'8"	6'8"
Interior height open	6'7"	6'7"
Height closed	4'6"	4'6"
Sleeping capacity	8	6
Trailer size closed	16' x 7'1"	16' x 7'1"
Approx. dry weight - axle	1610#	1620#
Approx. dry weight - hitch	190#	190#
Approx. total weight	1800#	1810#
GVWR	2390#	2500#

**1204**



**747**



**747**

Interior length open	24'
Interior width	6'8"
Interior height open	6'7"
Height closed	4'6"
Sleeping capacity	8
Trailer size closed	18' x 7'1"
Approx. dry weight - axle	1840#
Approx. dry weight - hitch	120#
Approx. total weight	1960#
GVWR	2620#

# THE DUCK BY DUTCHMEN

## Extra Value Fold Down Campers

### 801 D

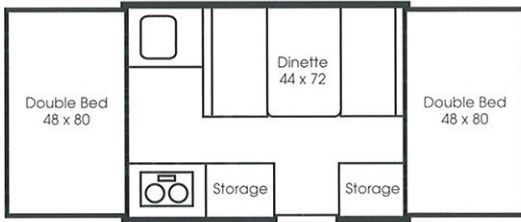

### 1004 D

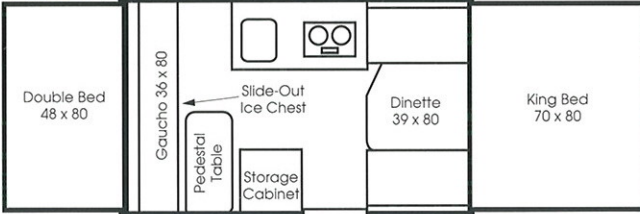

### 1006 D

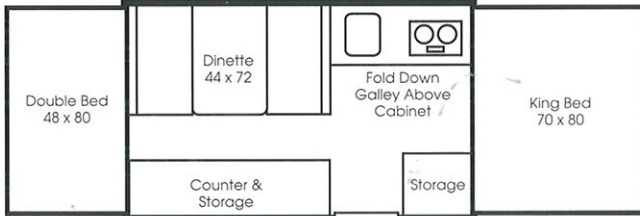

### 1002 XS D

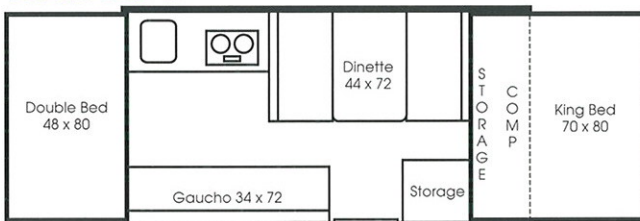

### 1205 D

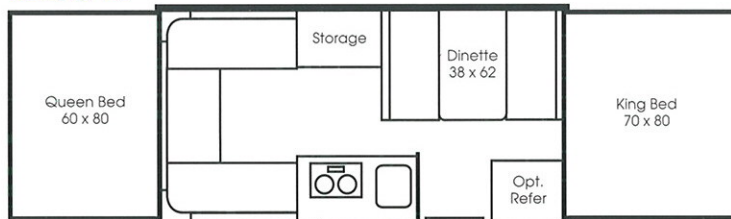

### 801 D

Interior length open  
Interior width  
Interior height open  
Height closed  
Sleeping capacity  
Trailer size closed  
Approx. dry weight - axle  
Approx. dry weight - hitch  
Approx. total weight  
GVWR

17'  
6'8"  
6'7"  
4'4"  
6  
12' x 7'1"  
958#  
140#  
1098#  
2230#

### 1004 D

21'  
6'8"  
6'7"  
4'4"  
8  
14' x 7'1"  
1160#  
145#  
1305#  
2235#

### 1006 D

Interior length open  
Interior width  
Interior height open  
Height closed  
Sleeping capacity  
Trailer size closed  
Approx. dry weight - axle  
Approx. dry weight - hitch  
Approx. total weight  
GVWR

21'  
6'8"  
6'7"  
4'4"  
6  
14' x 7'1"  
1160#  
145#  
1305#  
2235#

### 1002 XS D

Interior length open  
Interior width  
Interior height open  
Height closed  
Sleeping capacity  
Trailer size closed  
Approx. dry weight - axle  
Approx. dry weight - hitch  
Approx. total weight  
GVWR  
Extra Storage Capacity

21'  
6'8"  
6'7"  
4'4"  
8  
16' x 7'1"  
1335#  
125#  
1460#  
2215#  
21 Cu. Ft.

### 1205 D

24'  
6'8"  
6'7"  
4'4"  
8  
16' x 7'1"  
1520#  
165#  
1685#  
2255#  
21 Cu. Ft.

- The drive system is enclosed for protection from weather and road conditions.
- The underneath location of the system allows for easy inspection and maintenance. Grease zerks are located top and bottom of the main tube to allow yearly maintenance.
- A single cable capable of 3,200 lbs. tensile strength rotates around the rear cable pulley and pushes the four flexible steel push rods up the lifter posts.
- Flexible steel push rods.
- Four stage plated lift post.
- Lifetime warranty - see dealer for details.

Models shown on cover are 1203 and 1006D

## Crank-up Lift System

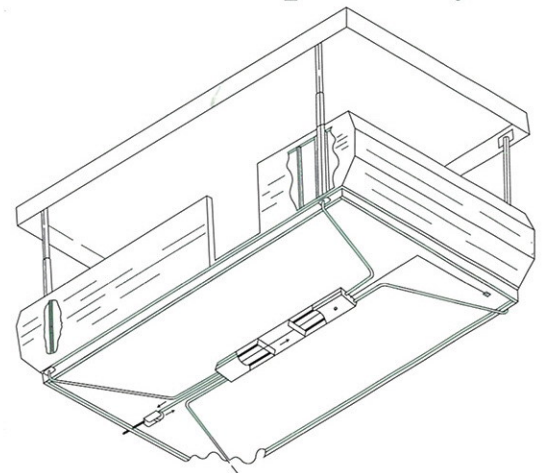



# CHECK IT OUT BEFORE YOU BUY ...

**Shop and Compare ... Only Dutchmen Classic offers all these features as standard:**

- |   |  |  |   |
|---|--|--|---|
| <input type="checkbox"/> Fiberglass Roof - No Center Seam | <input type="checkbox"/> Awning                            | <input type="checkbox"/> Hardwood Framed Doors       | <input type="checkbox"/> 14" x 14" Roof Vent              |
| <input type="checkbox"/> Privacy Curtains                 | <input type="checkbox"/> Porta Potti Storage (Most Models) | <input type="checkbox"/> 6" Tapered Rail Frame       | <input type="checkbox"/> Up to 8 Interior Storage Pockets |
| <input type="checkbox"/> Storage Bumper                   | <input type="checkbox"/> Battery Prep                      | <input type="checkbox"/> 12" Tires (8' & 10' Models) | <input type="checkbox"/> Clothes Bar                      |
| <input type="checkbox"/> Spare Tire, Carrier & Cover      | <input type="checkbox"/> Bottle Cover                      | <input type="checkbox"/> 13" Tires (12' and Above)   | <input type="checkbox"/> Oversized Dinettes               |
| <input type="checkbox"/> Self Storing Step                | <input type="checkbox"/> Dome Light Safety Switch          | <input type="checkbox"/> A/C Prep (Elec.)            | <input type="checkbox"/> Oversized Beds                   |
| <input type="checkbox"/> 10 Gal. Water Tank (15 in 1204)  | <input type="checkbox"/> 3 Burner In/Out Range             | <input type="checkbox"/> A/C - Snowload Bars         | <input type="checkbox"/> 5/8" Plywood Bunk Ends           |
| <input type="checkbox"/> Fiberglass Exterior Skin         |  | <input type="checkbox"/> Outside Receptacle          |   |

## SPECIFICATIONS

### ACCOMMODATIONS

CLASSIC DUCK	
✓	• All models sleep six, some sleep eight
✓	• Adult sized dinettes
✓	• Reversible cushions on bunks, dinette and gauchos
✓	• 4" bunk cushions
N/A	• 3" bunk cushions
✓	• Lined decorator curtains with tie backs
✓	• Privacy curtains for bunks
✓	• Inside/outside dinette table
✓	• Tinted vinyl windows
N/A	• Hardwood framed cabinet doors with positive catches
✓	• Storage cabinets
✓	• Porta potti storage (most models)
✓	• Clothes bar
✓	• Laminated counter tops
✓	• Cassette toilet (1204)
N/A	• Interior storage pockets

### APPLIANCES

CLASSIC DUCK	
✓	• 3 burner inside/outside range
N/A	• 2 burner inside/outside range
✓	• Built-in 35# (60 quart) ice box
✓	• Splash guard for range
✓	• 6 Gallon water heater (1204)
N/A	• Slide out ice chest (1004D)
CONSTRUCTION	
✓	• Exclusive 6" tapered rail, steel channel frame
N/A	• 3" tubular steel frame (4" on 12)
✓	• Storage bumper
4	• Adjustable stabilizer jacks
2	• Front jack with dolly wheel
✓	• Wide track torsion axle system
N/A	• Wide track leaf spring suspension
✓	• 5.30 x 12" automotive type tires
✓	• B78 x 13" automotive type tires (10' and above)
✓	• Spare tire, carrier and cover
✓	• 2" ball coupler
✓	• Exterior mounted, enclosed lifter system w/grease fittings
✓	• 5 piece sectionalized tent constructed of 13 oz. supported vinyl
✓	• 5/8" Plywood bunk ends

### CONSTRUCTION (cont'd)

CLASSIC DUCK	
✓	• Fiberglass, vacuum-bonded, foam core roof - no center seam
N/A	• Aluminum vacuum-bonded, foam core roof
✓	• Fiberglass, vacuum-bonded, front, rear and sidewalls
✓	• Seamless one-piece floor - undercoated
✓	• Self storing step
✓	• Polyethylene wheel wells
EQUIPMENT	
✓	• 14" x 14" roof vent
N/A	• Outside storage compart. door
✓	• 10 gallon fresh water storage tank (15 gallon on 1204)
✓	• Two stage water faucet
✓	• Stainless steel sink
✓	• Brass city water fill
✓	• 20# LP bottle with w/regulator
✓	• LP bottle cover
✓	• A/C prep (Elec.)
✓	• A/C - Snowload bars
✓	• Awning

### ELECTRICAL

CLASSIC DUCK	
✓	• 25, 30 amp power cord
✓	• 12 volt water pump (1204)
✓	• 12 volt power converter
✓	• 5 way car connector (6 way with brakes)
✓	• 110 volt outlets
✓	• Amber patio light
N/A	• Battery wiring
✓	• Dome light safety switch
✓	• 12 volt ceiling lights
✓	• Eleven clearance lights
OPTIONS	
✓	• Refrigerator
✓	• Double 20# bottles
✓	• Furnace (16,000 BTU)
✓	• Screen room
✓	• Canadian code
✓	• Divider drape (1204)

NOTE: At Dutchmen we constantly improve our product, as a result all specifications and dimensions are subject to change without notice.

See your Dutchmen dealer for all the details:

### GENERAL WARRANTY INFORMATION

- Lifter System
  - Floor
  - Fiberglass Skin
  - Tent
  - General Camper Coverage (Except Tires & Appliances)
- Lifetime\*  
10 yrs.\*  
10 yrs.\*  
5 yrs.\*  
5 yrs.\*

\*Refer to specific written warranty statement



**DUTCHMEN MFG., INC.**

