



# DUTCHMEN

Fold Down



# "DUCK"

Camper

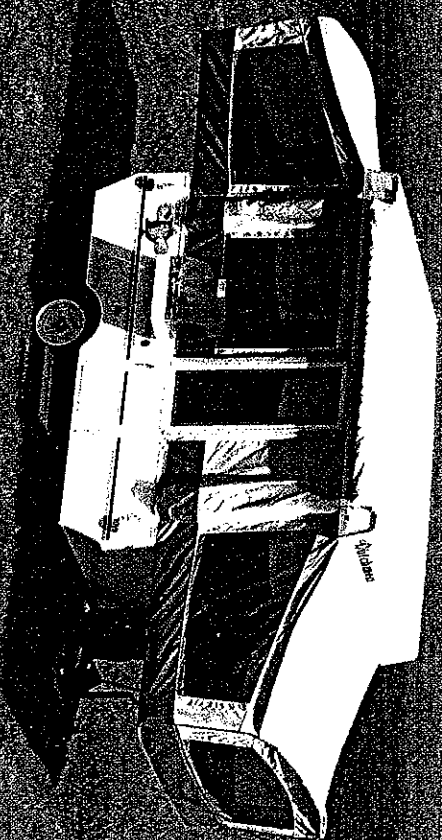
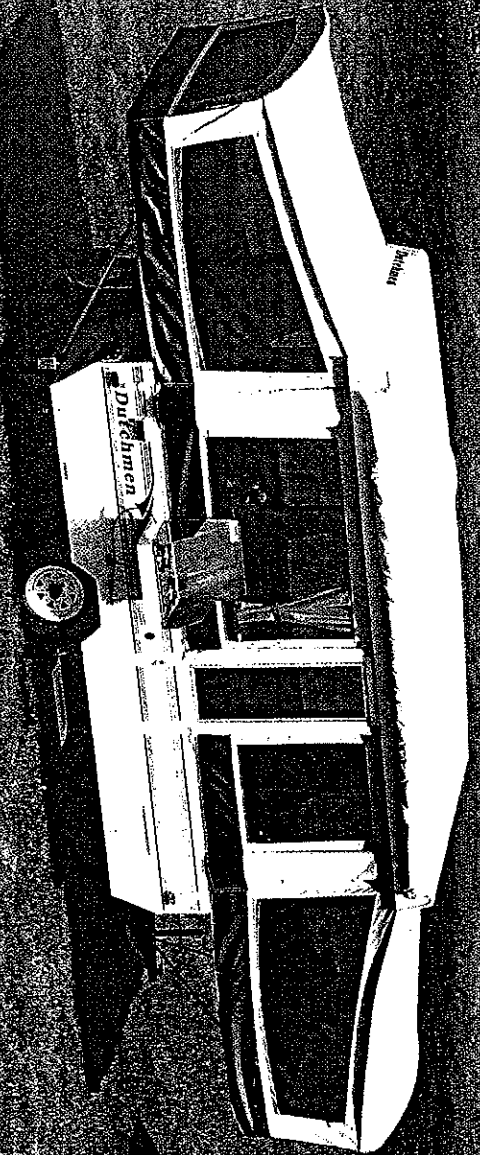

*Dutch Craftsmanship,  
Quality & Value...*

# Dutchmen "Classic" Fold Down Campers

## Dutch Craftsmanship, Quality & Value

**801**

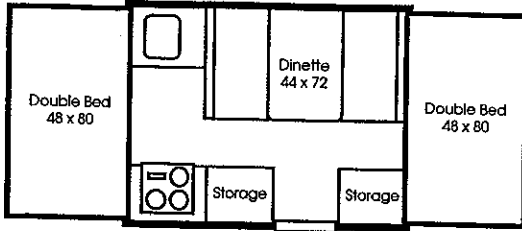

Interior length open	17'
Interior width	6'8"
Interior height open	6'7"
Height closed	4'4"
Sleeping capacity	6
Trailer size closed	12' x 7'1"
Approx. dry weight - axle	1055#
Approx. dry weight - hitch	155#
Approx. total weight	1190#
GVWR	1955#

**1001**

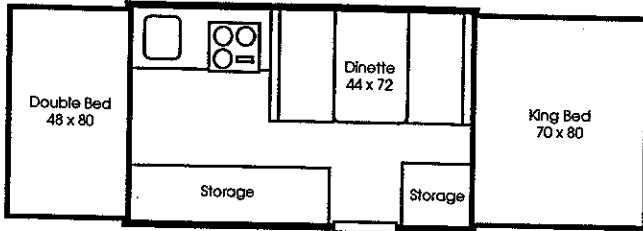

	1001	1007
Interior length open	21'	21'
Interior width	6'8"	6'8"
Interior height open	6'7"	6'7"
Height closed	4'6"	4'6"
Sleeping capacity	6	8
Trailer size closed	14' x 7'1"	14' x 7'1"
Approx. dry weight - axle	1260#	1266#
Approx. dry weight - hitch	160#	188#
Approx. total weight	1420#	1454#
GVWR	2360#	2360#

**1007**

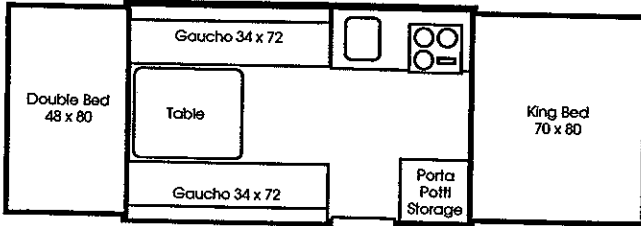

**1203**

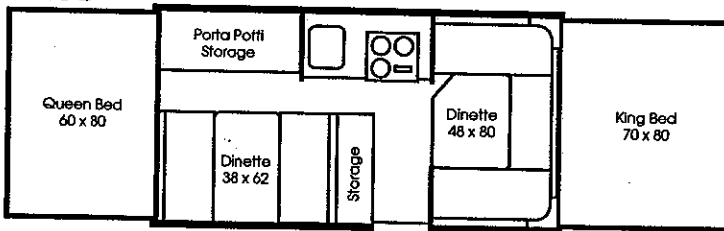

	1203	1204
Interior length open	24'	24'
Interior width	6'8"	6'8"
Interior height open	6'7"	6'7"
Height closed	4'6"	4'6"
Sleeping capacity	8	6
Trailer size closed	16' x 7'1"	16' x 7'1"
Approx. dry weight - axle	1610#	1620#
Approx. dry weight - hitch	190#	190#
Approx. total weight	1800#	1810#
GVWR	2390#	2500#

**1204**

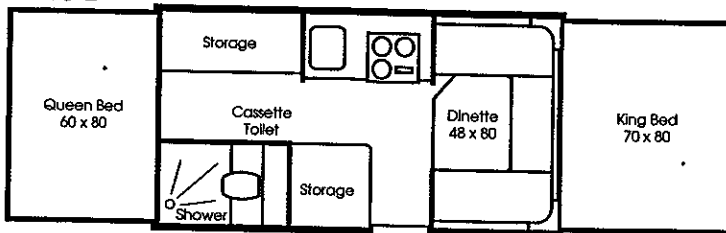

**747**

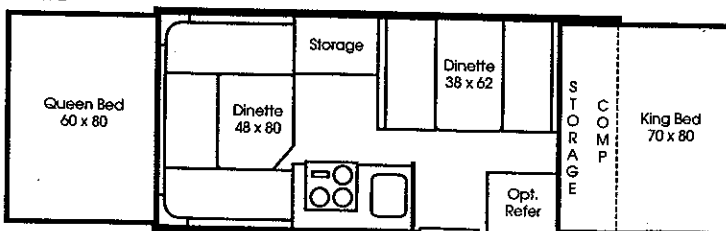

	747
Interior length open	24'
Interior width	6'8"
Interior height open	6'7"
Height closed	4'6"
Sleeping capacity	8
Trailer size closed	18' x 7'1"
Approx. dry weight - axle	1840#
Approx. dry weight - hitch	120#
Approx. total weight	1960#
GVWR	2620#
Exterior storage capacity	21 Cu. Ft.

**801 D**

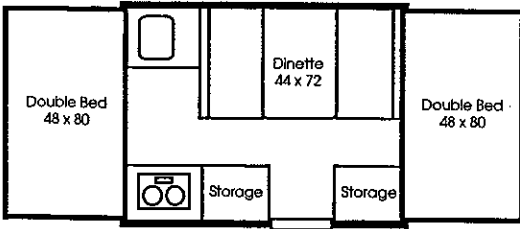

**1004 D**

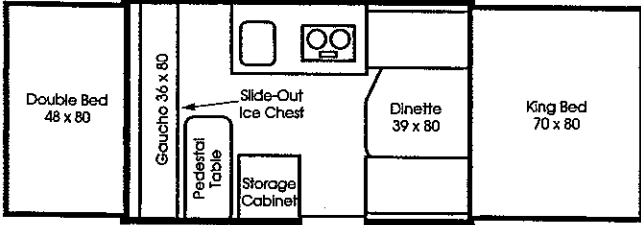

**1006 D**

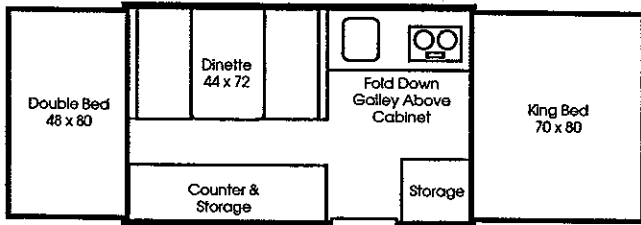

**1002 XS D**

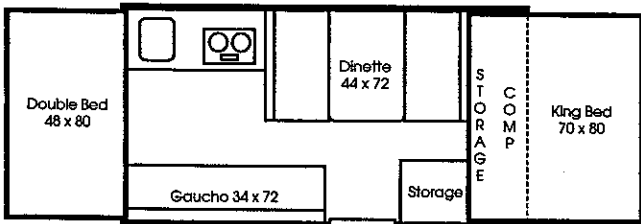

**1205 D**

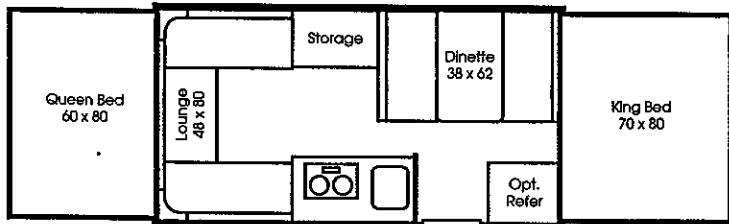

**801 D**      **1004 D**

Interior length open	17'	21'
Interior width	6'8"	6'8"
Interior height open	6'7"	6'7"
Height closed	4'4"	4'4"
Sleeping capacity	6	8
Trailer size closed	12' x 7'1"	14' x 7'1"
Approx. dry weight - axle	958#	1160#
Approx. dry weight - hitch	140#	145#
Approx. total weight	1098#	1305#
GVWR	2230#	2235#

**1006 D**

Interior length open	21'
Interior width	6'8"
Interior height open	6'7"
Height closed	4'4"
Sleeping capacity	6
Trailer size closed	14' x 7'1"
Approx. dry weight - axle	1160#
Approx. dry weight - hitch	145#
Approx. total weight	1305#
GVWR	2235#

**1002 XS D**      **1205 D**

Interior length open	21'	24'
Interior width	6'8"	6'8"
Interior height open	6'7"	6'7"
Height closed	4'4"	4'4"
Sleeping capacity	8	8
Trailer size closed	16' x 7'1"	16' x 7'1"
Approx. dry weight - axle	1335#	1520#
Approx. dry weight - hitch	125#	165#
Approx. total weight	1460#	1685#
GVWR	2215#	2255#
Extra storage capacity	21 Cu. Ft.	

- The drive system is enclosed for protection from weather and road conditions.
- The underneath location of the system allows for easy inspection and maintenance. Grease zerks are located top and bottom of the main tube to allow yearly maintenance.
- A single cable capable of 3,200 lbs. tensile strength rotates around the rear cable pulley and pushes the four flexible steel push rods up the lifter posts.
- Flexible steel push rods.
- Four stage plated lift post.
- Lifetime warranty - see dealer for details.

**Crank-up Lift System**

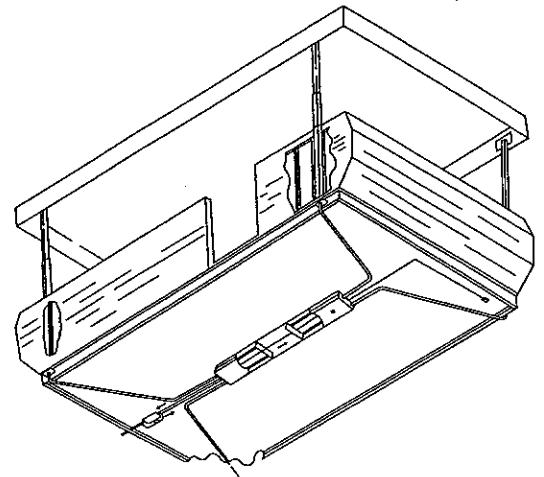

Models shown on cover are 1203 and 1006D

# CHECK IT OUT BEFORE YOU BUY ...

Shop and Compare ... Only Dutchmen Classic offers all these features as standard:

- Fiberglass Roof - No Center Seam
- Privacy Curtains
- Storage Bumper
- Spare Tire, Carrier & Cover
- Self Storing Step
- 10 Gal. Water Tank (15 in 1204)
- Fiberglass Exterior Skin
- Awning
- Porta Potti Storage (Most Models)
- Battery Prep
- Bottle Cover
- Dome Light Safety Switch
- 3 Burner In/Out Range
- Hardwood Framed Doors
- 6" Tapered Rail Frame
- 12" Tires (8' Models)
- 13" Tires (10' and Above)
- A/C Prep (Elec.)
- A/C - Snowload Bars
- Outside Receptacle
- 14" x 14" Roof Vent
- Up to 8 Interior Storage Pockets
- Clothes Bar
- Oversized Dinettes
- Oversized Beds
- % Plywood Bunk Ends

## ACCOMMODATIONS

CLASSIC DUCK	
✓	All models sleep six, some sleep eight
✓	Adult sized dinettes
✓	Reversible cushions on bunks, dinette and gauchos
✓	4" bunk cushions
✓	3" bunk cushions
✓	Lined decorator curtains with tie backs
✓	Privacy curtains for bunks
✓	Inside/outside dinette table
✓	Tinted vinyl windows
✓	Hardwood framed cabinet doors with positive catches
✓	Storage cabinets
✓	Porta potti storage (most models)
✓	Clothes bar
✓	Laminated counter tops
✓	Cassette toilet (1204)
✓	Interior storage pockets

## APPLIANCES

CLASSIC DUCK	
✓	3 burner inside/outside range
✓	2 burner inside/outside range
✓	Built-in 35# (60 quart) ice box
✓	Splash guard for range
✓	6 Gallon water heater (1204)
✓	Slide out ice chest (1004D)

## SPECIFICATIONS

### CONSTRUCTION (cont'd)

CLASSIC DUCK	
✓	Fiberglass, vacuum-bonded, foam core roof - no center seam
✓	Aluminum vacuum-bonded, foam core roof
✓	Fiberglass, vacuum-bonded, front, rear and sidewalls
✓	Seamless one-piece floor - undercoated
✓	Self storing step
✓	Polyethylene wheel wells

### ELECTRICAL

CLASSIC DUCK	
✓	25', 30 amp power cord
✓	12 volt water pump (1204)
✓	12 volt power converter
✓	5 way car connector (6 way with brakes)
✓	110 volt outlets
✓	Amber patio light
✓	Battery wiring
✓	Dome light safety switch
✓	12 volt ceiling lights
✓	Eleven clearance lights

### CONSTRUCTION

CLASSIC DUCK	
✓	Exclusive 6" tapered rail, steel channel frame
✓	3" tubular steel frame (4" on 12)
✓	Storage bumper
✓	Adjustable stabilizer jacks (801/2)
✓	Front jack with dolly wheel
✓	Wide track torsion axle system
✓	Wide track leaf spring suspension
✓	5.30 x 12" automotive type tires
✓	B78 x 13" automotive type tires (10' and above)
✓	Spare tire, carrier and cover
✓	2" ball coupler
✓	Exterior mounted, enclosed lifter system w/grease fittings
✓	5 piece sectionalized tent constructed of 13 oz. supported vinyl
✓	% Plywood bunk ends

### EQUIPMENT

CLASSIC DUCK	
✓	14" x 14" roof vent
✓	Outside storage compart. door tank (15 gallon on 1204)
✓	Two stage water faucet
✓	Stainless steel sink
✓	Brass city water fill
✓	20# LP bottle with w/regulator
✓	LP bottle cover
✓	A/C prep (Elec.)
✓	A/C - Snowload bars
✓	Awning

### OPTIONS

CLASSIC DUCK	
✓	Refrigerator
✓	Double 20# bottles
✓	Furrace (16,000 BTU)
✓	Screen room
✓	Canadian code
✓	Divider drape (1204)

NOTE: At Dutchmen we constantly improve our product; as a result all specifications and dimensions are subject to change without notice.

- ### GENERAL WARRANTY INFORMATION
- Lifter System Lifetime\* 10 yrs.\*
  - Floor 10 yrs.\*
  - Fiberglass Skin 5 yrs.\*
  - Tent 5 yrs.\*
  - General Camper Coverage (Except Tires & Appliances) 5 yrs.\*
- \*Refer to specific written warranty statement



**DUTCHMEN MFG., INC.**

813 W. Brooklyn Street  
Syracuse, IN 46567

**THOR**  
AMERICA'S BEST RV VALUE

See your Dutchmen dealer for all the details: