

Dutchmen Zephyr



"Ultra-Lite Travel Trailer"



Dutchmen Zephyr



Printed on Recycled Paper

	21FDT	21FD	25FD	25QB	27BH
UVW	3442	3400	4024	4028	4124
GVWR	4778	4718	5326	5334	5356
Load Capacity	1336	1318	1302	1306	1232
Hitch Weight	378	318	326	334	356
Traveling Length	21'8"	21'8"	25'8"	25'8"	27'8"

These weights include these options: Microwave, oven, awning, air, skylight, bifold shower door, stabilizer jacks, sink cover, stove cover.

Standard Features:

- Full 7-1/2" (90") width frame
- 1-1/2" x 1-1/2" aluminum framed laminated walls
- 20-25M/BTU Hydro-flame furnace
- 5 cu. ft. Norcold single door refrigerator
- 3-burner cook-top
- 13" radial tires - ST175-80R13 Load Range "C"
- Welded steel conventional bumper
- 2200-2500# torsion axles on all models
- Mini-blinds

- 45-amp converter
- AM/FM stereo
- Tinted radius clamp ring windows for ultimate in UV protection
- Dual LP tanks w/Regulator and Changeover 5 (gals.)
- Dual waste water holding tanks - 44 gals.
- Demand water system w/12V pump - 28 (approx. gals.)

Options

- Awning
- 13.5 BTU A/C

- Stabilizer Jacks (4)
- 13" Spare tire
- Wheel Rings
- Safety glass all windows
- 12V CD player
- Skylight in living room/Kitchen area
- Skylight over tub
- Bi-fold shower door
- 6 gal. gas/electric water heater with DSI
- Oven replacing 3 burner cooktop
- Microwave
- Sink Cover
- Stove Cover

21 FDT

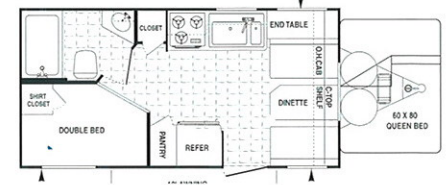

21 FD

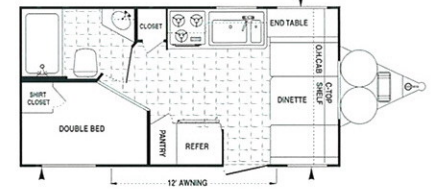

25 FD

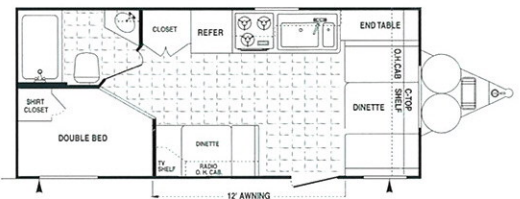

25 QB

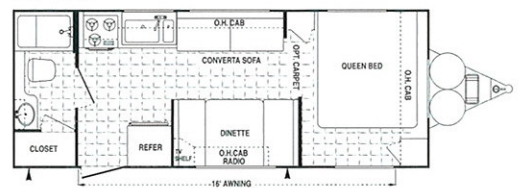

27 BH

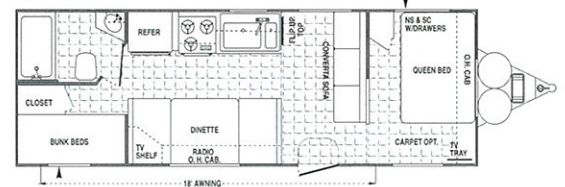

Dutchmen Manufacturing

305 Steury Avenue

Goshen, IN 46526

219-534-1224

Product information and specifications in this brochure were as accurate as possible at time of printing. Since we continually strive to improve our products, actual products may differ. Prices and specifications are subject to change without notice. All capacities are approximate and dimensions are nominal. Some features or options may be different or unavailable in Canada.

Warning: This information is intended as a guide only. Weights of individual vehicles may vary. Consult your owner's manual for complete loading, weighing and towing instructions.

Dealer

© 2000 Thor Industries