



2005

TUNDRA

Super-Lite Travel Trailers & Fifth Wheels

Never Stop Exploring



THE LEADER IN ULTRA LITE TECHNOLOGY

TUNDRA

2005 "Super-Lite" Travel Trailers & Fifth Wheels



27FB shown in Johanson Mulberry

Designed to be towed by most half-ton trucks, Tundra is the new standard in "Super-Lite" recreational vehicle technology. Our "Super-Lite" construction starts with a six-way welded aluminum framed superstructure. The walls, roof, and floor are insulated with high density foam and are laminated to the superstructure. This "Super-Lite" construction process is designed to maximize living space and storage without adding the weight you will find in most recreational vehicles.

But, there is more to a recreational vehicle than the construction. Tundra's interiors are as impressive as its revolutionary design. Tundra features unique floorplans with large living areas, kitchens, baths and bedrooms. Stunning high-end designer décors, residential-style furnishings, and brand name appliances are a few of the many features that define Tundra. Compare our features to the competition and we are sure you will agree that Tundra is your best value when it comes to "Super-Lite" travel trailers and fifth wheels.

Never Stop Exploring



Tundra's bathrooms feature a standard skylight, Fiberlink bathtub, ABS shower surround, 12V power vent and medicine cabinet. Some floorplans feature a neo angle shower with glass shower door. *See floorplans

Our 44" Dinette Plus is larger than most of the competition. A free standing dinette with four chairs is available as an option on most floorplans.



31BH



Tundra's durable, one-piece, thermoformed raised panel cabinet doors are lightweight and easy to clean.

Tundra floorplans feature spacious galleys with ample countertop and storage space. A double door refrigerator, large oven with cooktop, large microwave oven and a range hood with light and fan are standard features on all Tundra models. Plus, many floorplans include a bonus storage pantry and a large pots and pans drawer.



TUNDRA

2005 Super-Lite Travel Trailers

Tundra Super-Lites: 1,000 - 1,500 pounds lighter than the competition!

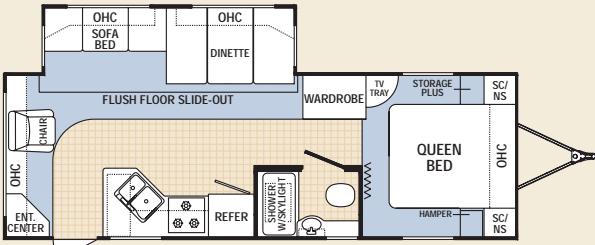

26RL-DSL

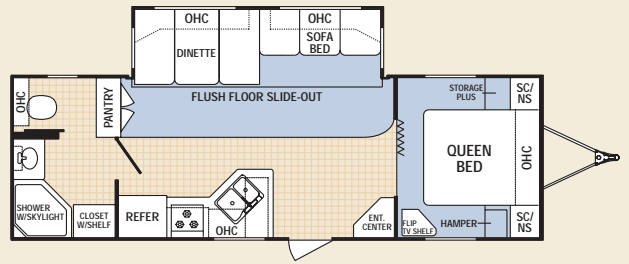

27FB-DSL

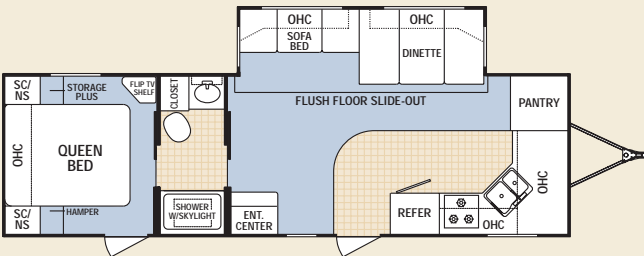

27FK-DSL

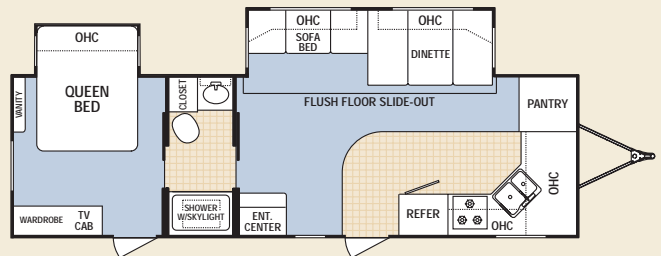

27FK-DSL (with optional bed slide)

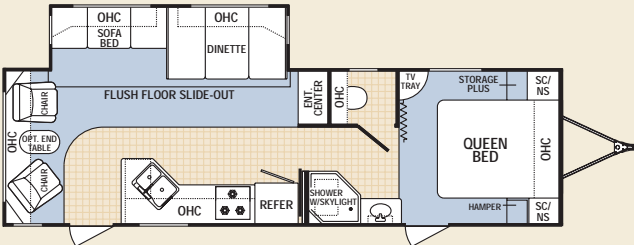

30RL-DSL

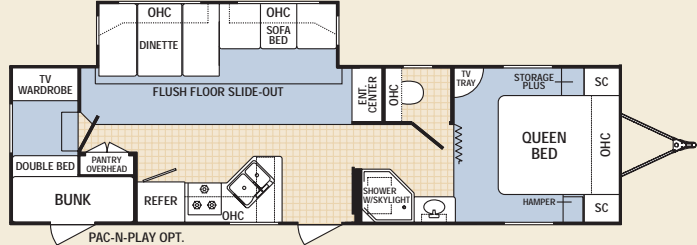

31BK-DSL (available with Pac-n-Play storage option)

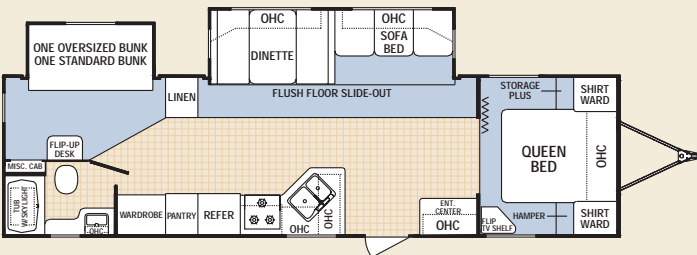

31BH-DSL

Bedroom slides now available in Super-Lites!

Tundra is the first company to offer bedroom slides in Super-Lite Travel Trailers. The 27FK-DSL is available with an optional queen bed slide. The 31BH-DSL features a bunk over double bed slide room as a standard feature (shown below).



TUNDRA Offers More Standard Features

- 13.5 BTU roof air conditioning
- Awning
- Microwave oven
- 3 Burner range with oven
- Large double door refrigerator
- Corner stabilizer jacks
- 30 lb. LP tanks with cover
- Dark tinted windows
- Large patio light speakers
- AM/FM/CD player with speakers
- Stove cover
- Sink covers

2005 Super-Lite Fifth Wheels

New! Only weighs
4,672 lbs!

Designed for half-ton trucks
(Refer to your truck owners manual for tow rating)

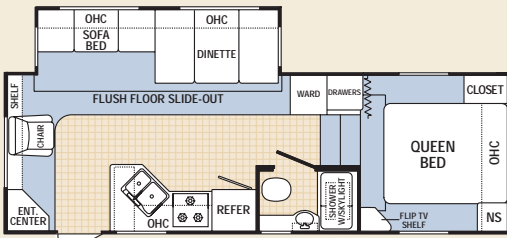
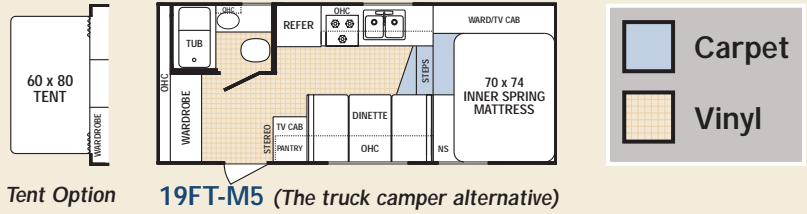

24RL-M5

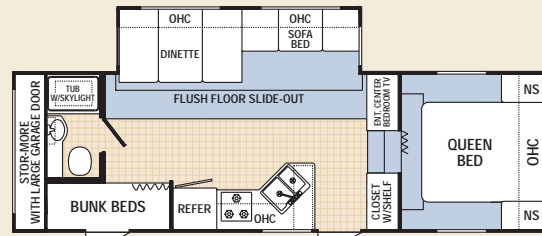

24RGB-M5 (available with Pac-n-Play storage option)

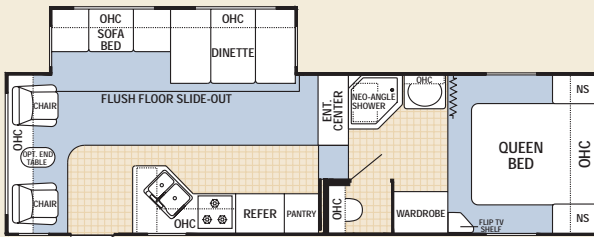

27RL-M5

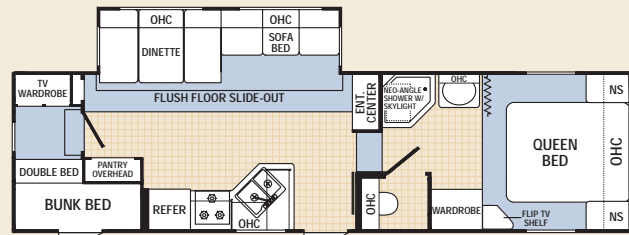

28BH-M5 (available with Pac-n-Play storage option)

TUNDRA TRAVEL TRAILERS

FIFTH WHEELS

	26RL-DSL	27FB-DSL	27FK-DSL	27FK-DSL W/ BS OPT.	30RL-SL	31BK-DSL	31BH-DSL	19FT-M5	24RL-M5	24RGB-M5	27RL-M5	28BH-M5
Axle Weight	4700	4828	4898	5448	5224	5338	5336	3988	4973	4970	5628	5826
Dry Hitch Weight	535	683	837	705	715	861	919	833	983	1119	1275	1201
Unloaded Vehicle Weight	5236	5512	5736	6154	5940	6200	6256	4672	5957	6090	6904	7028
GVWR	7700	7700	7700	7700	7700	7700	7700	6240	8400	8400	8400	10560
Cargo Capacity	2464	2188	1964	1546	1760	1500	1444	1568	2443	2310	1496	3532
Exterior Length	29'9"	29'9"	32'9"	32'9"	32'11"	35'1"	35'1"	28'9"	26'11"	30'3"	31'1"	33'8"
Exterior Width	8'	8'	8'	8'	8'	8'	8'	8'	8'	8'	8'	8'
Exterior Height	10'8"	10'8"	10'8"	10'8"	10'8"	10'8"	10'8"	10'6"	12'1"	12'1"	12'1"	12'1"
Fresh Water Tank	46	46	46	46	46	46	46	46	46	46	46	46
Grey Water Tank	34	68	68	68	34	68	34	34	34	34	68	68
Black Water Tank	34	34	34	34	34	34	34	22	34	34	34	34
Tire Size	ST205/ 75R15(C)	ST205/ 75R15(C)	ST205/ 75R15(C)	ST205/ 75R15(C)	ST205/ 75R15(C)	ST205/ 75R15(C)	ST205/ 75R15(C)	ST205/ 75R15(C)	ST205/ 75R15(C)	ST205/ 75R15(C)	ST205/ 75R15(C)	ST205/ 75R15(D)
Furnace Size	30,000	30,000	30,000	30,000	30,000	30,000	30,000	30,000	30,000	30,000	30,000	30,000

Vehicle loading – Every effort has been made to provide the greatest number of options for the recreation vehicle owner. Along with these choices comes the responsibility to manage the loads that are imposed by the choices that they remain within the manufacturer's specified chassis weight limits. Do not overload the recreation vehicle. Net carrying capacity (NCC) is determined by subtracting unloaded vehicle weight (UVW) from gross vehicle weight (GVWR) and includes fluids, options and cargo. Liquid capacities and weights are approximations only. **Warning** – This information is intended as a guide only. Weights of individual vehicles may vary. Consult your owner's manual for complete loading, weighing and towing instructions.

*Axle weight, UVW and Dry Hitch Weight are base weights of units without options. Each unit includes a weight label which lists specific weight information for that unit.

Photographs may contain some features that are optional on your vehicle. Since we continually strive to improve our products, actual products may differ. Prices and specifications are subject to change without notice. All capacities are approximate and dimensions are nominal. Some features shown are optional and may be different or unavailable in Canada.

TUNDRA

Super-Lite Construction

CHASSIS

1. Folding entry step – low step height for easy entry
2. Ultra-lube hubs. Grease Zerk makes wheel bearings easy to lube. Extends life of bearings
3. All tanks mounted in frame. Lowers the center of gravity, and saves valuable interior storage space
4. 46 Gallon fresh water tank with Quick Drain feature. Tank design prevents water from standing in tanks during storage. One of the largest fresh water tanks in the industry!
5. Optional enclosed underbelly protects tanks and floor from the hazards of the road (Part of the Alaska Package)
6. DSL travel trailers and fifth wheels feature steel I-beam frames with E-coat paint finish

7. Twin 30 lb. LP tanks with optional ABS cover

8. Integrated heavy duty safety chains

WALLS

5-Ply construction. Fully laminated, aluminum framed construction.

9. Tubular aluminum welded frame – reinforced around door
10. Dark tinted radius corner windows
11. Insulated baggage doors with key locks and finger pulls
12. ABS fender skirts
13. Decorative wall board
14. Luan wood backer
15. High density structural foam insulation
16. Luan plywood backer
17. Smooth fiberglass with premium graphics package
18. Pass-through storage compartment (where available)
19. Aerodynamic front profile

ROOF

5-Ply construction. Fully laminated, aluminum framed construction.

20. Tubular aluminum radius framed roof reinforced at A/C
21. Luan wood backer
22. One-piece EPDM rubber roof with 12 year manufacturer's material warranty
23. High density structural foam insulation
24. Luan wood backer
25. Decorative ceiling board

FLOOR

5-Ply construction. Fully laminated, aluminum framed floor structure.

26. Residential vinyl flooring – full length of coach
27. Residential carpet with pad (most models)
28. Two layers of floor decking over aluminum frame and foam
29. High density structural foam
30. Plywood base with polypropylene waterproof vapor barrier
31. Tubular aluminum framed floor, reinforced at tanks

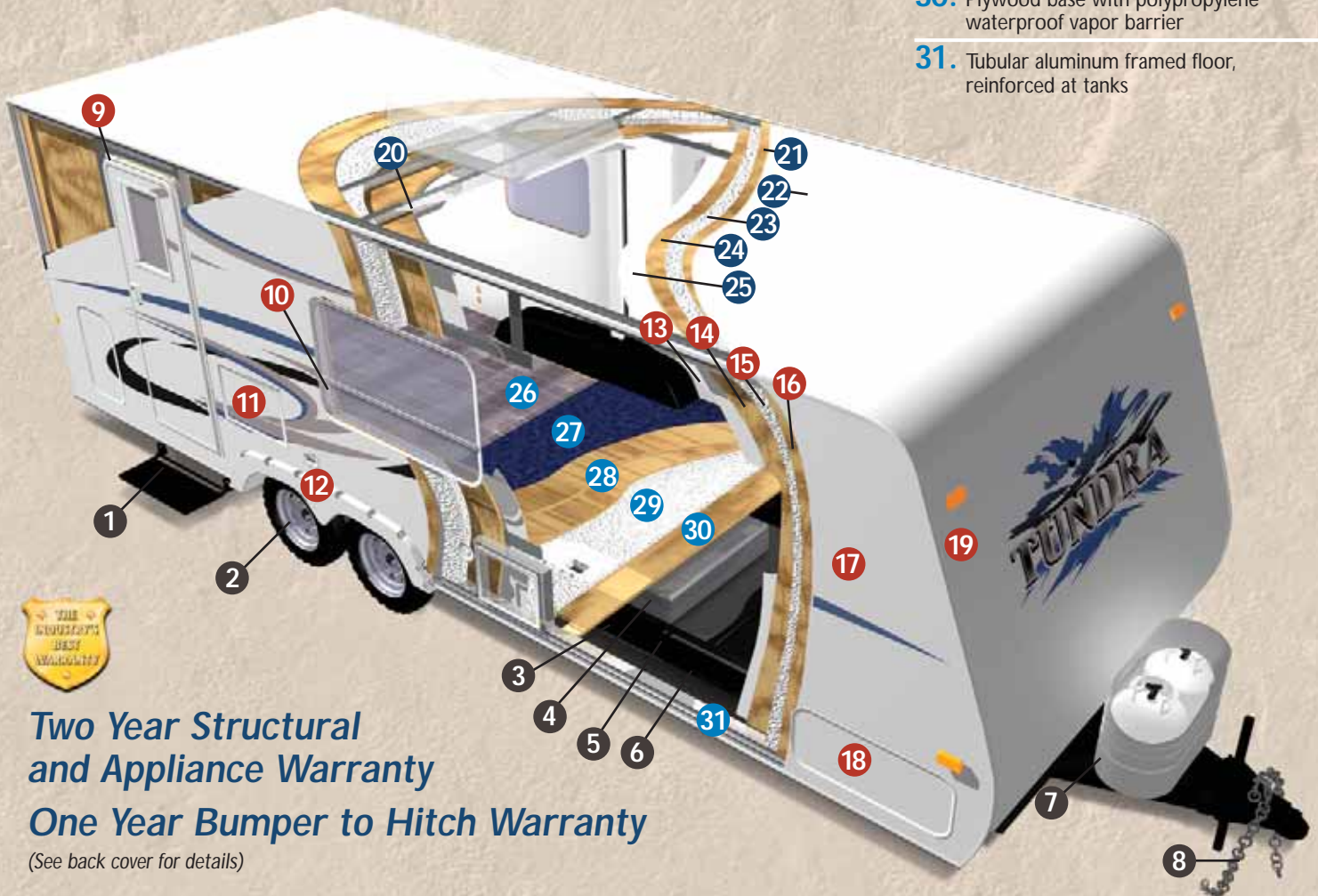

**Two Year Structural
and Appliance Warranty**
One Year Bumper to Hitch Warranty

(See back cover for details)

Premium Standard Features



Tundra's dinette seat, bunk beds, queen beds and pass-through storage compartments are aluminum framed. They are lighter and more durable than the competitors' wood frame structures.



All fresh water tanks are mounted in the frame, which lowers the center of gravity and saves valuable interior storage space. The 46 gallon fresh water tank features a quick drain design that prevents water from standing in the tanks during storage. This is the largest fresh water tank in the industry!

80% Dark tint windows keep your Tundra cool on warm days.



Oversized, pass-through storage compartment is carpeted and includes a convenience light. (most models)



Alaska Upgrade Package



Upgrade your Tundra! The Alaska Upgrade Package includes aluminum rims, an enclosed underbelly and 12V heat pads on the fresh water grey and black water tanks.

The enclosed underbelly enhances the aerodynamics of Tundra and protects the fresh water, holding tanks and floor from the hazards of the road.



Popular Options

- A. Industry Exclusive! - AudioLite™ Speakers**
Tundra features AudioLITE™ exterior speakers by Intier.® Utilizing the latest "NXT surface sound technology," AudioLITE speakers provide crisp, undistorted sound. Plus, they are impact resistant and waterproof.
- B. Offroad Tires**
Tundra is available with Dunlop Rover LT235/75R15 mud and snow tires for off road use.
- C. Bike Carrier**
Tundra's easy to use bike carrier mounts on the travel trailer's "A-frame." It securely holds three adult or children's bicycles. The option also includes a 2" trailer hitch mount that allows you to use the bike rack on your truck, van or SUV.
- D. Exterior Grill**
Take your cooking outside with Tundra's exterior barbecue grill. (optional)
- E. Water Heater Upgrade**
Upgrade your Tundra with the six gallon gas/electric water heater with direct spark ignition (DSI).
- F. 2-Way Radio Package**
Audiovox two-way radios include 4-five mile range radios and a 12V charger base station. (optional)
- G. Day/Night Shades**
These fabric blinds include a light filtering shade that provides privacy and allows day light in during the day and a room darkening shade for privacy at night.
- H. Exterior Shower**
Tundra's exterior shower features hot and cold water, a quick connect coil hose and a sprayer.
- I. Hide-A-Bed Sofa**
Tundra's optional sofa/bed easily converts from a comfortable overstuffed sofa to a full size bed in seconds.

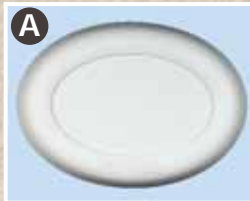

TUNDRA

2005 Super-Lite Travel Trailers & Fifth Wheels

STANDARD FEATURES

Standard Exterior Features

- Super-lite aerodynamic design
- I-beam cambered chassis
- Leaf spring axles and suspension
- Fully laminated roof with 5" crown aluminum trusses (N/A 19FT-M5)
- EPDM one piece seamless rubber roof with 12 year supplier warranty
- Welded 6-sided aluminum/laminated superstructure (roof, floor and walls)
- Electric slide-out motor
- Four corner stabilizer jacks
- A&E 8500 series awning
- Slider windows on side of slide-out room
- Radius corner entry door with dead bolt lock
- Color ABS fender skirts
- Folding entry step
- High-end designer graphics
- Rain gutters with corner downspouts
- Dark-tinted, radius clamp ring windows
- Step light with switch (exterior)
- Entry assist handle at door
- "Storage Plus" pass through exterior storage with light
- Ozite carpet in pass through storage areas
- Two 30 lb. LP tanks
- ABS LP bottle cover (travel trailers)
- Break-away trailer switch
- 120V Exterior outlet

- Courtesy light at hitch
- Large scare light with switch
- Electric front jacks (fifth wheels)

Standard Appliances and Electrical

- Norcold double-door gas/electric refrigerator
- 3-Burner range with large oven
- Large microwave oven
- TV antenna with cable prep
- AM/FM/CD player with four speakers
- 13.5 BTU air conditioning with remote wall thermostat
- Range hood with 12V light and exhaust fan
- Systems monitor panel
- Forced air DSI furnace with wall thermostat
- Ducted heat
- Solid state converter with built in battery charger
- Data port telephone/computer jack
- Carbon Monoxide detector
- LPG leak detector
- Fire extinguisher
- Smoke detector
- Designer 12V interior lights
- 30 Amp power cord with storage compartment
- Demand water pump

Standard Interior Features

- Raised panel thermofoil cabinet doors
- Premium interior fabrics
- Residential tile-like linoleum

- 5" Thick, reversible arched back dinette seats
- Stain resistant, vinyl-backed dinette seats
- Mini blinds throughout
- Designer style window treatments
- Upgraded sofa with roll-over design
- Coat and towel hooks
- Skylight roof vents
- TV shelf/cabinet
- Glass decorator light over dinette table (most models)
- Inside exit assist handle at door

Kitchen Features

- Stove cover
- Residential single lever faucet
- Trash bag holder below sink
- Double-bowl acrylic sink
- Dual sink covers

Bedroom Features

- Decorator lights in the bedroom
- Décor coordinated bedspread and headboard
- Body pillow in bedroom
- Wardrobe closets

Bath Features

- Power roof vent in bathroom
- Shower curtain
- Skylight
- Bathroom medicine cabinet (most models)
- 6-Panel bath door
- Fiberlink bathtub with standard tub surround

Why A Thor Product Is Your Best RV Value:



Thor Industries, Inc., listed on the New York Stock Exchange, proudly

traces its history back over seventy years to the pioneering days of the RV industry with the founding of Airstream, the industry's oldest and most renowned brand. Our total commitment to quality and our philosophy of putting our customers first has led to our continuous growth. Today, Thor is the largest builder of RVs. Thor's strong financial condition and years of solid growth are your assurance that we will be here to serve you for years to come. We think this extra peace of mind is important when you are making a significant investment. Because our customers are always #1 with us, we work harder than other manufacturers to satisfy you.

The Industry's Best Warranty – By Far!



We're so confident in the design and construction of our products that they are covered by Thor's Limited Warranty program. Your warranty includes:

- One Year Bumper to Hitch Limited Warranty
- Two Year Structural and Appliance Limited Warranty

*See owner's manual for complete warranty details.

TUNDRA

2164 Caragana Court ■ Goshen, IN 46526
(574) 534-1224 ■ Fax: (574) 975-0556
www.tundra-rv.com

© Thor Industries, Inc.

TUN 1/05

Décor Choices A. Main Fabric B. Accent Fabrics

Johanson Mulberry

Adage Blue

Bryn Amethyst

Sunset Taupe



Your Local Dealer: