

The all NEW Rainier Travel Trailer Series

Only Available at

POULSBO RV

www.poulsborv.com



Discover the difference!

Auburn
3905 Auburn Way N
Auburn, WA 98002
800-568-1678

Kent
23051 Military Rd S
Kent, WA 98032
800-562-2323

Everett
12218 Hwy 99 S
Everett, WA 98204
800-556-3878

Mount Vernon
517 Jacks Road Lane
Mount Vernon, WA 98273
888-413-1112

Poulsbo
19705 Viking Ave
Poulsbo, WA 98370
800-768-5726

Vancouver
17611 N E Union Rd
Ridgefield, WA 98642
866-573-2828



- Great Styling, And Incredible Quality
 - Aluminum Side Wall Framing
 - Northwest Graphics Package
 - Smooth Fiberglass Exterior
- NEW Rainier Travel Trailer series!
Poulsbo RV is pleased to announce the all



Discover the difference!

POULSBO RV
23051 Military Road, South
Kent, WA 98032

Only Available at Poulsbo RV, for a limited time only.

POULSBO RV



Poulsbo RV is pleased to announce the all NEW Rainier Travel Trailer series. **Discover the Rainier difference where you always get more for less!** You'll be delighted to find a smooth fiberglass exterior brandishing a dynamic Northwest graphics package, aluminum side framing, and great styling.

Get More for Less!

The travel trailer you have been waiting for!

Limited Quantity Available!



Premium Standard Features

- Mountain Package
- High Gloss fiberglass exterior
 - Welded aluminum-framed sidewalls
 - 30 lb. LP bottles
 - Patio light
 - 15" tires
 - Rain gutters with down spouts
 - LP leak detector
 - Smoke detector
 - Carbon monoxide detector
 - Roof vent in bath
 - Roto-molded holding tanks
 - Hardwood-framed cabinet doors
 - Mini-blinds throughout
 - Residential flip sofa bed
 - Designer bedspread and headboard
 - Designer valance window coverings
 - Shower curtain

Rainier Package

- 13.5 BTU A/C (NA on R18RB and R25FB)
- Microwave oven with glass turn-plate
- AM/FM/CD stereo system
- A&E awning
- 6 Gallon gas DSI water heater
- 3 Burner range and oven with auto ignition
- Skylight in tub/shower
- TV antenna with cable and satellite hook-up
- Double door 6 cu.ft. refrigerator
- Front and rear stabilizer jacks on R26FB-DSL

Additional Standard Exterior Features

- 5/8" Tongue and groove plywood floor
- R-7 fiberglass insulation
- One-piece rubber roof
- Seamless rotocast wheel wells
- Screen door with kick plate
- Flush combo entry latch/dead-bolt lock
- Leaf spring axles
- Tandem axles with electric brakes
- Rear bumper with sewer hose storage
- 30 amp power cord
- 26" main entry door
- Protected and wrapped Polymax underbelly
- Premium Rainier graphics package

Additional Standard Interior Features

- Decorative wall border
- Fire extinguisher
- Full tub surround (on 26FB-DSL)
- Residential drawer glides
- Residential tile-like linoleum
- Large double bowl sink in kitchen
- High-rise galley faucet
- 55 amp converter with built-in charger
- 12v demand water system
- Range hood with 12v fan and light
- Medicine cabinet with mirror

Decor Choices



Janine Rose



Steel Blue



Built by the finest craftsmen in the Northwest



Spacious Interior

Product information, specifications, and photography in this brochure were as accurate as possible at time of printing. Photographs may contain some features that are optional on your vehicle. Since we continually strive to improve our products, actual products may differ. Prices and specifications are subject to change without notice. All capacities are approximate and dimensions are nominal. Some features shown are optional and may be different or unavailable in Canada. All logos and brand names shown in this brochure are registered trademarks of Dutchmen Mfg. Inc. Vehicles are designed for recreational use only and not intended for use as a primary residence.

Vehicle loading - Every effort has been made to provide the greatest number of options for the recreation vehicle owner. Along with these choices comes the responsibility to manage the loads that are imposed by the choices that they remain within the manufacturer's specified chassis weight limits. Do not overload the recreation vehicle. Net carrying capacity (NCC) is determined by subtracting unloaded vehicle weight (UVW) from gross vehicle weight (GVWR) and includes fluids, options and cargo. Liquid capacities and weights are approximations only. Warning - This information is intended as a guide only. Weights of individual vehicles may vary. Consult your owner's manual for complete loading, weighing and towing instructions. Photographs may contain some features that are optional on your vehicle. Since we continually strive to improve our products, actual products may differ. Prices and specifications are subject to change without notice. All capacities are approximate and dimensions are nominal. Some features shown are optional and may be different or unavailable in Canada.



Model: R18RB

Unloaded Vehicle Weight	4,180
Hitch Dry Weight	360
GVWR	7,360
Net Cargo Capacity	2,652



Model: R25FB

Unloaded Vehicle Weight	4,260
Hitch Dry Weight	660
GVWR	7,660
Net Cargo Capacity	2,872

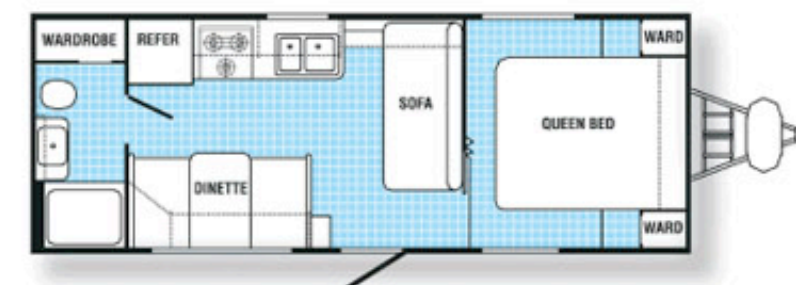

Model: R24Q B-SSL

Unloaded Vehicle Weight	4,820
Hitch Dry Weight	440
GVWR	7,440
Net Cargo Capacity	2,092

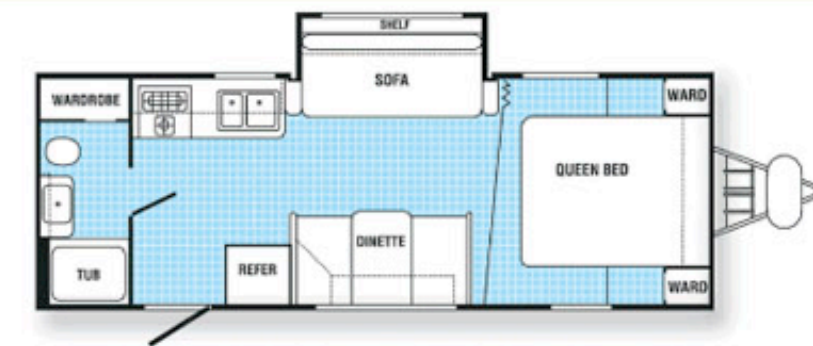

Model: R26FB-DSL

Unloaded Vehicle Weight	6,280
Hitch Dry Weight	660
GVWR	9,460
Net Cargo Capacity	2,652

