

THE LEADER IN ULTRA-LITE TECHNOLOGY

KODIAK
Expandables
by Skamper

2009

Kodiak - the leader in Ultra-Lite technology. With units light enough to be towed by SUV's and light trucks, we are sure to have the model that best fits your family's needs.

We are focused on creating innovative products exclusively for the ultra-lite market. Our products are loaded with standard equipment and industry-leading features. Plus, our attention to detail in design, construction and service after the sale is why our customers return when it is time for their next recreation vehicle.

If you are considering an ultra-lite, make sure you are choosing the best. Make sure you choose Kodiak.

The original and still the best ultra-lite in North America.

KEY STANDARD FEATURES

Aerodynamic Ultra-Lite Design for Better Fuel Economy!

6-Way welded aluminum cage ultra-lite construction

6-Way lamination - walls floor and roof

Enclosed and heated underbelly

Radius corner safety glass windows standard

Flush mount radius corner baggage doors

Diamond plate front rock guard

EPDM one piece seamless rubber roof

Dual battery racks

Dual 20 lb LP tanks

Aluminum dinette constructions - saves weight

Real solid wood kitchen drawers with residential drawer glides

Stainless steel sinks with hi rise faucet design

Standard exterior shower with hot and cold water

Nitrogen filled radial tires

Acu-weight System - every unit weighed as it leaves the factory - Real Weights!



ULTRA-LITE EXPANDABLE FLOORPLANS

**ALL FLOORPLANS
1/2 TON
TOWABLE**

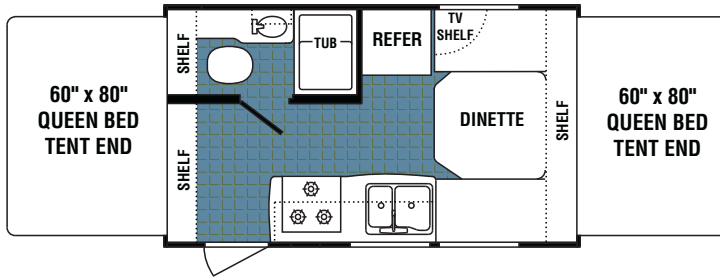

160

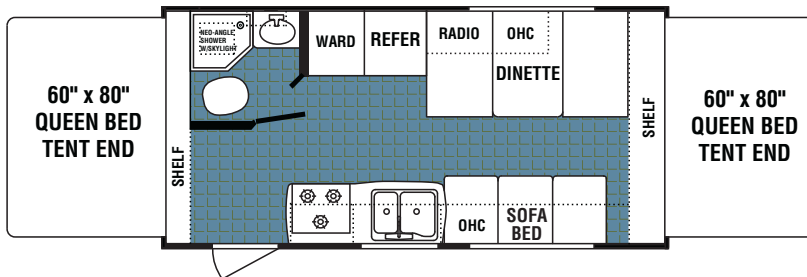

185

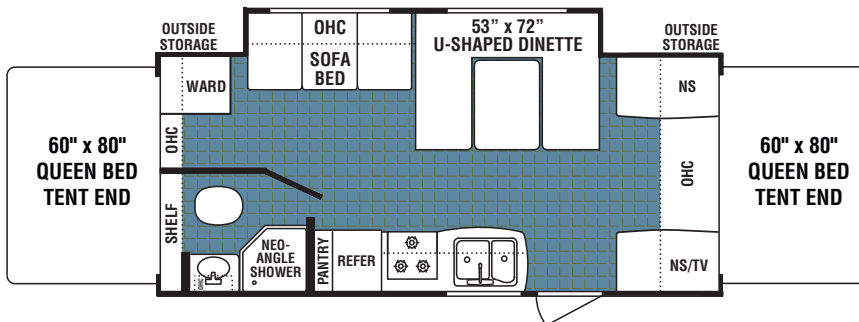

214

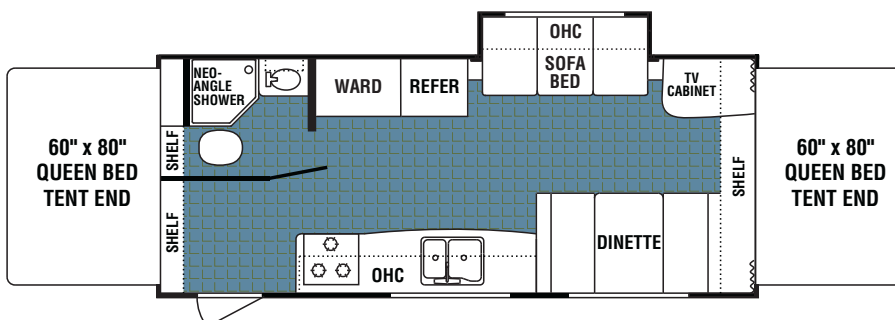

235

ULTRA-LITE EXPANDABLE FLOORPLANS

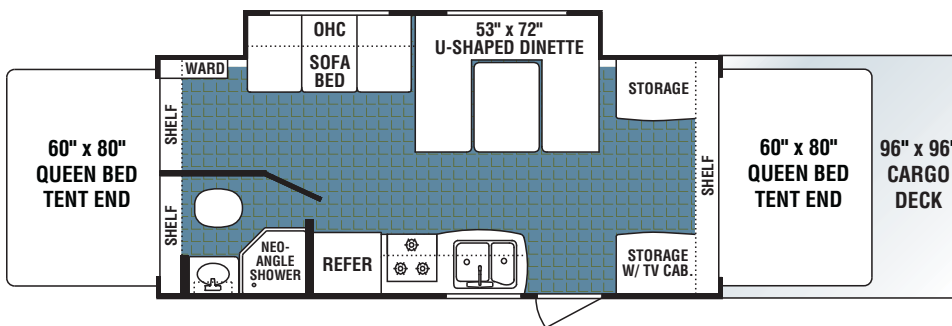
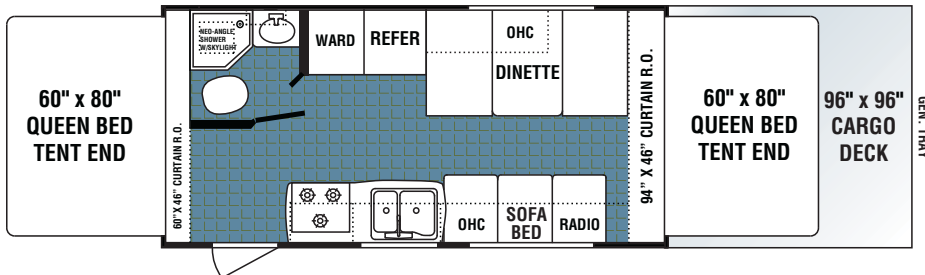
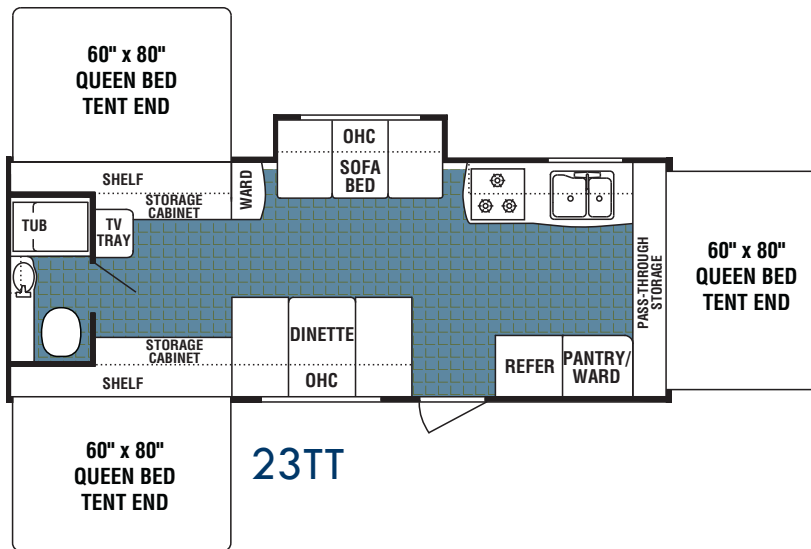

WEIGHTS & SPECIFICATIONS

	160	185	214	235	23TT	185THV	214THV
*Axle Weight	2528	3206	3696	3524	3857	3754	4690
*Dry Hitch Weight	334	286	373	362	517	612	419
*Unloaded Vehicle Weight	2862	3492	4069	3886	4374	4366	5109
Net Cargo Capacity	888	1508	1231	1414	1626	2634	2391
Exterior Length (closed)	17'6"	20'4"	24'1"	24'4"	26'4"	29'6"	32'10"
Exterior Height with A/C	9'8"	9'8"	9'8"	9'8"	9'8"	10'4"	10'8"
Exterior Width	8'	8'	8'	8'	8'	8'	8'
Fresh Water Tank	38	38	38	38	38	38/38	38/38
Gray Water Tank	39	39	39	39	39	39	39
Black Water Tank	22	22	28	22	28	22	28
Furnace Size (BTUs)	18,000	18,000	19,000	19,000	19,000	19,000	19,000

Tire Size (all models, NA THV):
ST205/75D14(C)

Tire Size THV: LT235/75R15(C)

Interior Height (all Kodiak models):
6'4"

KODIAK

Expandables
by Skamper

WHAT'S NEW FOR 2009

Exterior Changes

New Ultra-Lite 8" steel I-beam chassis

New Equa-Flex suspension system

2 5/16" coupler

New 4" square bumper with sewer hose storage - Bike rack ready

New larger exterior storage compartments

New Thule "Smart RV" TV mounts on exterior of coach - includes duplex 110volt outlet and RG6 satellite ready cable jack - mounted at eye-level for picnic table use

Interior Changes

New neo-angle showers replaces tubs in most models - increases shower room

New interior designer decors with upgraded fabrics and appointments

New Thule "Smart RV" TV mounts on inside

New thicker bunk matts

Enhanced storage in 214

New Options

A&E electric awning (most models)

DECORS



GREEN TEA



GOLD RUSH



ISLAND JAVA



STEEL BLUE

www.Kodiak-RV.com

Dutchmen Manufacturing, Inc. 2164 Caragana Court Goshen, Indiana 46526 Ph. 574-534-1224