

**KODIAK** ULTRA-LITE TRAVEL TRAILERS AND EXPANDABLES

# KODIAK

Where Ultra-Lite Meets Luxury

**DSI**

17<sup>th</sup> Annual RVDA DEALER  
SATISFACTION INDEX

**Award  
Winner!**





# KODIAK

Kodiak - the leader in Ultra-Lite technology - features innovative floor plans ranging from 16' to 31'. With units light enough to be towed by SUVs, minivans, crossover vehicles and light trucks, we are sure to have the model that best fits your family's needs.

Just because Kodiak is an Ultra-Lite, it doesn't mean your trailer is light on storage. With spacious counter tops, cabinet space and oversized pass-through exterior storage, it's easy to take everything along on your next adventure.



Kodiak Ultra-Lite  
Model 284BHSL in Buckshot



**The Kodiak Advantage**  
LOOK FOR  
THE KODIAK ADVANTAGE LOGO  
THROUGHOUT THIS BROCHURE  
FOR INDUSTRY LEADING  
FEATURES & INNOVATIONS



**DEEP SLIDE  
FLOOR PLANS WITH  
84" U-SHAPED DINETTE**



# *Dream Kitchen* by KODIAK



**SOLID SURFACE  
COUNTER TOPS**



Extra deep storage drawers, dedicated pots & pans storage plus full extension steel roller ball drawer glides are standard on Kodiak.

## *Dream Kitchen*

Kodiak's all new custom cabinetry design increases storage space by over 40%. Overhead cabinets are wider, taller and deeper. Plus our exclusive counter top design offers more usable space than the competition!

## *Premium Entertainment System*



Kodiak's premium entertainment system features an AM/FM /CD/DVD player with MP3 input. Interior and exterior speakers are also included. The flat screen LCD HD TV is an optional feature.

## *Central Control Station*

All switches and monitor panel centrally located for easy use.



## Master Bedroom



Large hanging wardrobe space, dual reading lights, upgraded Everdream mattress and a designer bedding package is standard with Kodiak.

## Bear Cave Storage

Kodiak's Bear Cave Storage is the largest in the Ultra-Lite products. The pass-through V-shaped cargo compartment increases storage by 30 percent.

With Kodiak —you can take it with you!



**SLAM LATCH DOORS**



## The Kodiak Advantage More Features! More Value!

## Exterior Cook Stations



All Kodiak 8' Wide and Deep Slide Models include an exterior cook station. The 284BHSL shown above includes a wash basin, 2 burner cook top and outside refrigerator. Other floor plans include a slide out cook top that is easy to set up and use. See floor plans for more details. Styles vary by model.



**POWER AWNING**



**UPGRADED EVERDREAM MATTRESS**



**DETACHABLE POWER CORD**



**NIGHT SHADES**



**SPRAY PORT**





## 6 WAY WELDED ALUMINUM SUPER STRUCTURE



# Bear Cage Construction



## 5 WAY LAMINATION



### ROOF - 5" THICK TRUSS STYLE ALUMINUM FRAME CONSTRUCTION

- 1 EPDM Rubber Roof with 12 Year Manufacturer's Warranty
- 2 Luan Wood Backer
- 3 Tubular Aluminum Welded Framed Roof
- 4 High Density Structural Foam
- 5 Decorative Ceiling Finish
- 6 13,500 BTU Roof Ducted A/C
- 7 A/C Ducting System with Taped Seams

### FLOOR - FULLY LAMINATED WELDED ALUMINUM FRAME CONSTRUCTION

- 1 Residential Carpeting in Slide Room
- 2 Wood Plank Beauflor Flooring - 10 Year Warranty
- 3 Dual Layers of Floor Decking
- 4 Tubular Welded Aluminum Framed Floor
- 5 High Density Structural Foam
- 6 Polypropylene Waterproof Vapor Barrier

### CHASSIS - STEEL I-BEAM POWDER COATED CHASSIS

- 1 Folding Entry Steps
- 2 Four Corner Stabilizer Jacks
- 3 Large Heated Tanks Mounted Below Floor
- 4 "Polar Package" Enclosed and Heated Underbelly
- 5 Radial Tires
- 6 Easy-Lube Hubs
- 7 LP Tanks with ABS Cover

### WALLS - FULLY LAMINATED, WELDED ALUMINUM FRAME CONSTRUCTION

- 1 High Gloss Fiberglass Exterior
- 2 Luan Wood Backer
- 3 Tubular Aluminum Welded Frame Walls
- 4 High Density Structural Foam Insulation
- 5 Decorative Wall Finish
- 6 Tinted Safety Glass Windows
- 7 Insulated Baggage Doors with Slam Latches
- 8 TPO Fender Skirts
- 9 XL-Folding Entry Assist Handle
- 10 Aerodynamic Front Profile for Better Fuel Economy
- 11 Diamond Plate Rock Guard
- 12 Adjustable Power Awning

## Decor Choices



Rullio Eggplant



Buckshot



Peppercorn

# KODIAK



## Aerodynamic Profile



### Ultra -Lite Design Better Fuel Economy

Kodiak is specifically designed to be towed by most light trucks and sport utility vehicles. The aerodynamic profile is designed to push air up the front wall and over the roof to improve towing and fuel economy.

## Enclosed and Heated Underbelly

Kodiak's enclosed and heated underbelly protects your water tanks and floor from damage while traveling. Plus, the underbelly is heated to prevent tanks from freezing.



## Popular Options



### FLAT SCREEN HDTV



### ALUMINUM WHEELS



### POWER JACK



# Bear's Den Tent Ends

Kodiak's Bear's Den Tent Ends feature increased headroom and sleeping space. A full 60" x 80" Everdream mattress is a standard feature. Tent ends feature a 1200 pound capacity.



## Expandables

For active families on the go. Kodiak Expandables add sleeping space without the additional length and weight of traditional travel trailers. Lightweight and easy to tow!

161E

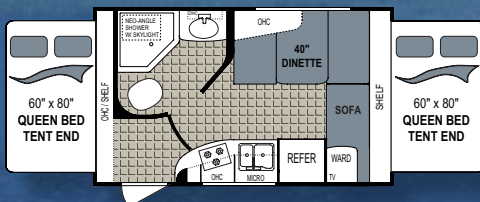

181E

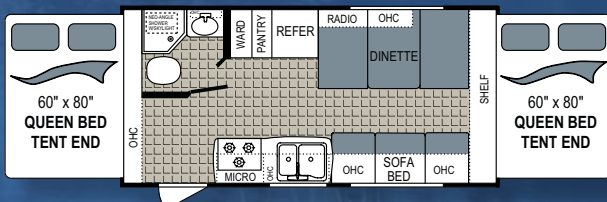

210ES

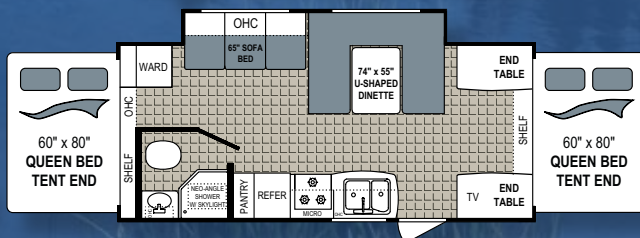

## Floor Plans 7' Wide

167QBSL

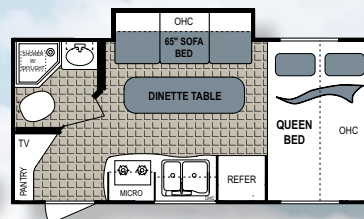

177QBSL

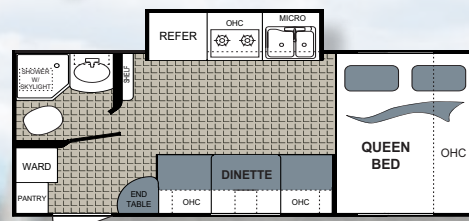

187QB

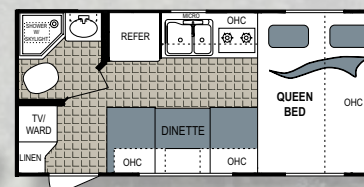

FLOOR PLANS  
START AT ONLY  
3000 LBS.

ACU-WEIGHT

This unit only weighs

3086 lbs.

R. Thwaites

Certified Inspector

## Real Weights!

Did you know that every Kodiak is weighed at the factory as it leaves the production line? Our certified Acu-Weight includes options!

Most competitors publish only a base weight that does not include options. Make sure that you know what the "real" weight of the unit is before you buy your next Ultra-Lite trailer.

## WEIGHTS & SPECIFICATIONS

2011 Model Name	Hitch (lbs)	Unload Weight (lbs)	Cargo Capacity (lbs)	Overall Height	Overall Length	Fresh Water (gal)	Black Water (gal)	Grey Water (gal)	Furnace Size BTU	Tire Size and Ply Rating
161E	426	3086	664	9' 10"	17' 9"	52	28	39	19,000	ST205/75R14(C)
167QBSL	290	3254	1446	9' 10"	19' 7"	52	22	39	19,000	ST205/75R14(C)
177QBSL	266	3254	1446	9' 10"	20' 5"	52	22	39	19,000	ST205/75R14(C)
181E	324	3520	1480	9' 10"	20' 8"	52	22	39	19,000	ST205/75R14(C)
187QB	222	2906	1794	9' 10"	19' 2"	52	22	39	19,000	ST205/75R14(C)
200QB	322	3874	1526	10'	24' 2"	52	28	39	19,000	ST205/75R14(C)
210ES	498	4092	1408	9' 10"	23' 11"	52	22	39	19,000	ST205/75R14(C)
220BHKS	474	4294	1106	10'	24' 9"	52	22	39	19,000	ST205/75R14(C)
221RBSL	572	4604	1396	10' 7"	24' 8"	52	28	39	19,000	ST205/75R14(C)
240KSSL	736	5214	1386	10' 7"	29' 1"	52	22	39	30,000	ST205/75R14(C)
241RBSL	396	4412	1588	10'	27' 2"	52	28	39	19,000	ST205/75R14(C)
242RESL	452	4964	1636	10' 7"	27' 7"	52	22	39	30,000	ST205/75R15(C)
250BHSL	558	4398	2202	10'	27' 11"	52	28	39	30,000	ST205/75R14(C)
263RLSL	690	5641	1959	10' 7"	31'	52	28	39	30,000	ST205/75R15(C)
284BHSL	686	5708	1892	10' 7"	31' 10"	52	28	39	30,000	ST205/75R14(C)
290BHSL	756	5978	1622	10' 7"	33' 4"	52	22	39	30,000	ST205/75R14(C)

\* Fresh water capacity includes water heater

## Floor Plans 8' Wide

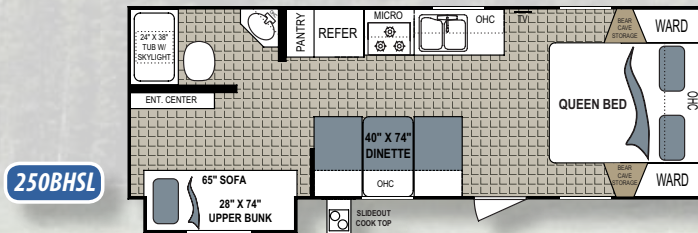
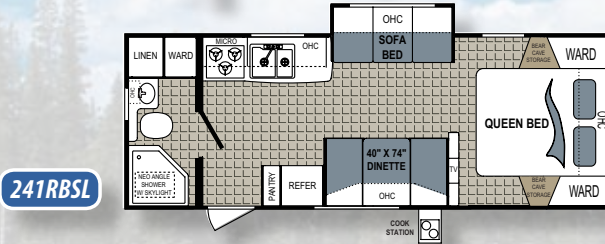
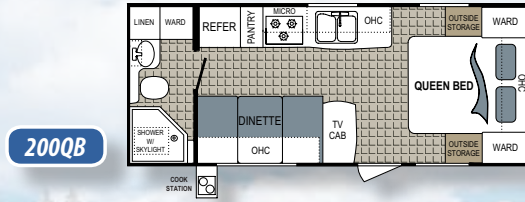

## 8' Wide Rear Slide Models

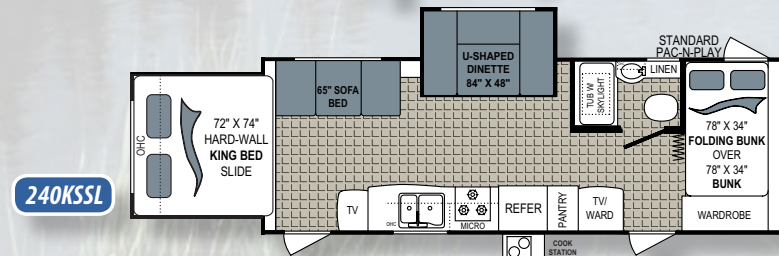
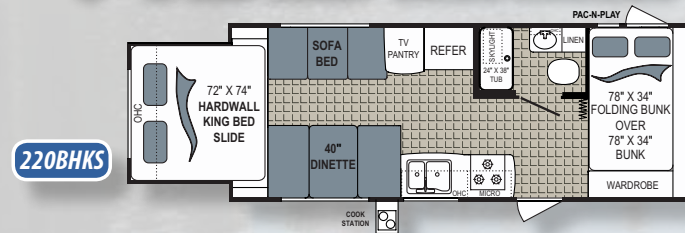

## 8' Wide Deep Slide Models

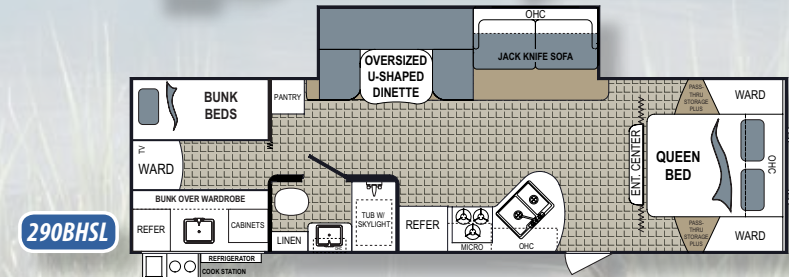
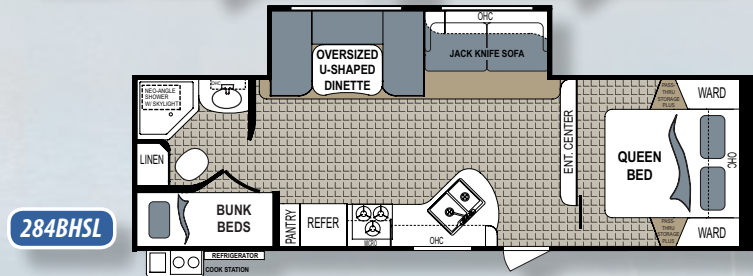
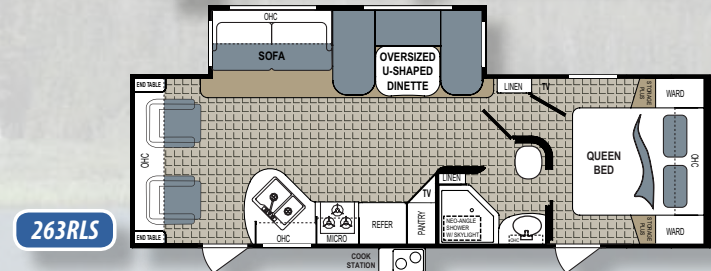
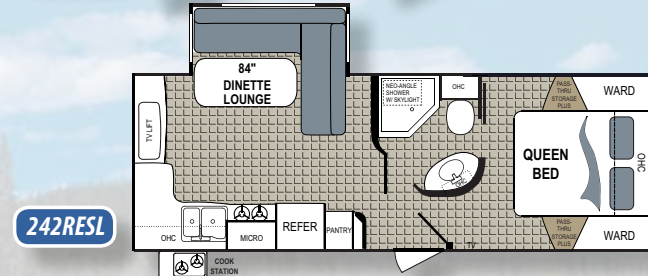
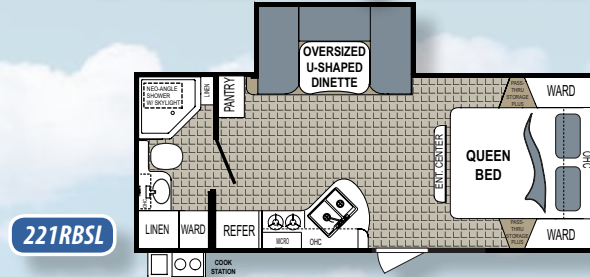



# STANDARD AND OPTIONAL FEATURES

## STANDARD FEATURES

### FUEL SAVER FRONT PROFILE

- Aerodynamic Front Profile Designed for Maximum Aerodynamics
- Streamlined Profile Reduces Air Turbulence for a more Stable Ride
- Improves Fuel Efficiency

### BEAR CAGE CONSTRUCTION

- 6 Sided Welded Aluminum Cage Construction
- 5 Way Lamination - Roof, Floor, Sidewalls and Rear Wall
- Fully Laminated, Aluminum Framed Roof
- 5" Laminated Crowned Roof with Ducted A/C (8' Wide TT's)
- 2" Thick Aluminum Framed Laminated Roof (7' Wide TT and Expandable)
- High Gloss Gel Coated Filon Fiberglass Exterior

### POLAR PACKAGE

- Heated and Enclosed Underbelly Protects Bottom of Trailer from Road Debris and Damage ↔\*
- Enhances Aerodynamics of Trailer
- Beauflor Flooring - Cold, Crack Resistant

### EZ LUBE CUSTOM STANCE SUSPENSION

- Heavy Duty Axles
- 4 Wheel Electric Drum Brakes
- Easy Lube Hubs on Axles ↔\*
- Radial Tires (Required Option) ↔\*
- 14" Tires (Expandable & 7' Wides)
- 15" Tires (8' Wides)

### BEAR CAVE STORAGE

- Oversized Pass Thru Storage
- Slam Latch Cargo Doors (N/A Expandables)
- Storage Light
- 110V Outlet
- Cable Hookup

### ACU-WEIGHT CERTIFICATION

- Real Weights - All Units Weighed before Leaving the Factory
- Weights Include Options - See Decal in Unit for Exact Weight of your Unit

## EXTERIOR CONSTRUCTION

### EXTERIOR COOK STATIONS

- Slide Out 2 Burner Outdoor Stove with LP Quick Connect (8' Wide TT's)
- LP Quick Connect only (7' Wides and Expandables)

## FRAME

- Lightweight I-Beam Frame
- 4" Square Rear Bumper with Sewer Hose Storage
- Dual Battery Tray
- 2 5/16" Coupler
- Hitch Light
- Break-Away Trailer Switch
- Heavy Duty Safety Chains
- Four Corner Stabilizer Jacks ↔\*
- 12V Electric Slide-Out Motor with Override
- Spare Tire with Cover ↔\*
- Two 20 Lb. Lp Bottles with ABS Cover
- Double Folding Entry Step

## ROOF

- Fully Laminated, Aluminum Framed Roof
- EPDM One-Piece Seamless Rubber Roof
- Rain Gutter with Extended Corner Downspouts

## VIEW MASTER WINDOWS

- Large Picture Windows at Dinette
- Tinted, Radius Corner, Clamp Ring Safety Glass Windows

## OTHER EXTERIOR FEATURES

- Large Adjustable Power Awning ↔\*
- Diamond Plate Rock Guard ↔\*
- Molded Fender Skirts (8' Wide TT's and Expandables)
- Pac-N-Play Exterior Storage (See Floor Plans)
- Exterior Wash Station with Quick Connect Hose
- Deluxe Folding Entry-Assist Handle at Door (8' Wide TT's) \*
- 120V Exterior Outlet
- Radius Corner Entry Door
- Flush Combo Entry Latch/Dead Bolt Lock
- Exterior Security Light

## INTERIOR FEATURES

### STORE MORE CABINETRY

- New Cabinet Design - More Storage Space - Full Access Cabinets, Larger Drawers
- Glazed Cherry Finish Hardwood Cabinet Door and Drawer Fronts Throughout
- Large Galley Storage Pantry (See Floor Plans for Availability)
- Large Pots and Pan Storage (See Floor Plans for Availability)
- Solid Wood Drawers with Full Extension Drawer Glides

### SOLID SURFACE COUNTER TOPS ↔\*

- Stainless Steel Under Mount Sink
- Pullout Faucet

## MEDIA CENTER PREMIUM ENTERTAINMENT SYSTEM

- TV Prep - All Models
- 12V AM/FM/CD/DVD Stereo with MP3 Input ↔\*
- Interior And Exterior Speakers ↔\*
- TV Antenna
- Wired for Cable
- Bedroom TV Prep for Flat Panel TV's

## CENTRAL CONTROL STATION

- Convenient Location for Main Switches and Monitor panel
- Slide Out Controls
- Water Pump Switch
- Interior and Exterior Light Switches
- Water Heater Controls
- (Control Station N/A 7' Wide Models)

## OTHER INTERIOR FEATURES

- Residential Furniture Design With High Grade Fabrics
- 74" X 54" Oversized U-Shaped Dinette - (See Floor Plans)
- Fabric Night Shades throughout (8' Wide TT's) ↔\*
- Designer Window Treatments
- Designer Wall Border
- Stainless Steel Sink
- Hi-Rise Galley Pullout Faucet (Most Models)
- Systems Monitor Panel
- Fire Extinguisher ↔\*
- LP/Carbon Monoxide/Smoke Detector ↔\*

## BATHROOM FEATURES

- Fiberlink Bathtub or Shower (See Floor Plans)
- Tub/Shower Surround ↔\*
- Skylight Over Tub/Shower ↔\*
- Shower Curtain - See Floor Plans
- Glass Shower Door with Neo-angle Shower (See Floor Plans)
- Foot Flush Toilet ↔\*
- Wood Medicine Cabinet with Mirror
- Power Roof Vent
- Toilet Tissue Holder
- Towel Hooks

## BEARS DEN - EXPANDABLE TENT ENDS

- New Tent Design with Self-Supporting Bunk Ends - 1,200 Pound Capacity
- 5" Thick Futon Mattress - Expandables
- Key-Locking "Easy Latch" Tent Doors
- 60" X 80" Beds in Tents
- Bunk End Lights With Fan - Expandables
- Everdream Upgraded Mattress (7' & 8' Wide TT's)

## BEDROOM FEATURES - 8 WIDES

- Designer Bedroom Package with Bedspring, Headboard and Window Treatments
- Roof Vent in Bedroom

## APPLIANCES, ELECTRICAL, PLUMBING & LIGHTING

- Double Door 6.3 Cu. Foot Gas/Electric Refrigerator ↔\*
- Black Panel Refrigerator Front
- Microwave with Carousel ↔\*
- 3 Burner Range with 17" Oven (8' Wide TT's and Expandables) ↔\*
- 2 Burner Cook Top (7' Wide TT's)
- Range Hood With 12V Light and Exhaust Fan
- 13.5K Air Conditioner with Quick Cool Vent ↔\*
- In-Roof Ducting for A/C (8' Wide TT's)
- Insulated and Foil Wrapped AC Ducting (8' Wide TT's)
- Detachable 30 AMP Power Cord
- 6 Gallon Gas/Electric Water Heater with DSI ↔\*
- Water Bypass Kit
- Hot and Cold Water Low Point Drains
- 52 Gallon Fresh Water Tanks (8' Wide TT's and Expandables)
- Solid State Converter with Built-in Battery Charger

## OPTIONS

- Aluminum Rims
- Power Front Jack
- 19", 26" and 32" Flat Screen HD LCD TV (8' Wide TT's) \*

## PACKAGES

- \* Ultimate Package
- ↔ Advantage Package
- ← Premium Package



**Dutchmen**

P.O. BOX 2164  
2164 Caragana Court  
Goshen, Indiana 46527

Sales: 574.537.0600  
Fax: 574.975.6274  
**www.kodiak-rv.com**

**Your Local Dealer**



Follow "DutchmenRV" on



We are proud to have been selected by the RV Dealers Association as the winner of the 17th Annual DSI Quality Circle Award. Dealers from across North America have awarded us @with the honor because of our commitment to producing an innovative product that excels in quality, reliability, warranty and parts support. We are committed to producing the best travel trailers and fifth wheels in the industry. The dealers have voted and have chosen our travel trailers and fifth wheels as the best. We are confident you will too.

Some Features Listed Above May Be Part of a Value Package - Contact Your Local Dealer for the Details  
Product information, specifications and photography in this brochure were as accurate as possible at time of printing. Prices and specifications are subject to change without notice. All capacities are approximate and dimensions are nominal. Some features are optional.