

# ISLAND TRAIL

ISLAND TRAIL



2810BHS



# ISLAND TRAIL





**Where high-end looks and features meet affordability.**

Island Trail's residential-styled furniture and two-toned walls add a sense of comfort and warmth.

Mega-slides are over a foot wider and offer a 6' ceiling height.

Our spacious sliderooms include an oversized 83" x 48" u-shaped convertible dinette and 68" fold-down sofa.



Island Trail 2810BHS, shown in Peppercorn



Island Trail 2810BHS, shown in French Roast



Island Trail 2810BHS





Island Trail 3117RLDS



Island Trail 2810BHS

Island Trail's kitchens are versatile, offering tons of storage space, larger cabinets, multiple drawers, a 2-door pantry and generous countertops.



Heavy Duty Steel  
Roller Ball-Bearing  
Drawer Guides



Solid Wood Cherry-Glazed  
Cabinet Doors

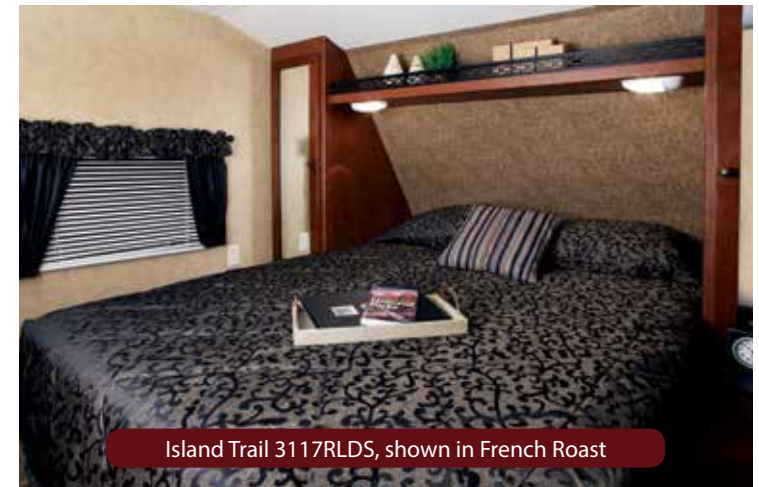

Island Trail 3117RLDS, shown in French Roast

Hanging wardrobe closets and true queen walkaround bed with 60" x 80" mattress.



Island Trail 2810BHS

Island Trail offers roomy closets and storage shelves.



## Acu-Weight Certification

*All units weighed  
at the factory —  
Includes Options!*

## PREMIUM CONSTRUCTION

### WALL CONSTRUCTION

- ① .024 Gauge Heavy Duty Aluminum Finish
- ② 16" on Center Wall Studs
- ③ Steel Hurricane Straps - Tie Walls to Roof & Floor
- ④ R7 Fiberglass Insulation
- ⑤ Durable Vinyl Decor Board
- ⑥ Deep Tint Safety Glass Windows
- ⑦ Patio Awning
- ⑧ Diamond Plate Rock Guard
- ⑨ ABS LP Bottle Cover with Quick Access (Option)
- ⑩ "Super Slide" - 40" Deep Slide Rooms (See Floorplans)
- ⑪ Aerodynamic Front Profile

### ROOF CONSTRUCTION

- ① TPO Roof with 12 Year Manufacturer's Warranty
- ② 3/8" "Walk-On" Roof Decking
- ③ 5" Truss-Style Crowned Roof Rafters - 16" on Center
- ④ R7 Fiberglass Insulation
- ⑤ Vinyl Decorator Ceiling Board
- ⑥ 13,500 BTU Roof Ducted A/C
- ⑦ Foam Core A/C Ducting System

**Includes:  
Radial Tires &  
E-Z Lube Axles**

### FLOOR CONSTRUCTION

- ① 10" Steel I-Beam Powder Coated Chassis on Deep Slides
- ② Rear Stabilizer Jacks
- ③ Folding Entry Door Steps
- ④ Radial Tires (Mandatory Option)
- ⑤ Heated and Enclosed Underbelly
- ⑥ Water Resistant Floor Liner
- ⑦ 12" on Center Floor Joists
- ⑧ Aluminum Heat Ducting in Floor
- ⑨ R7 Fiberglass Insulation
- ⑩ 5/8" Tongue and Groove Floor Decking
- ⑪ Congoleum Residential Vinyl Flooring
- ⑫ Residential Carpeting

## MEGA STORAGE



Our pass-thru storage compartments are up to 3 times larger than the competition.

## AERODYNAMIC FRONT PROFILE



Island Trail's aerodynamic profile is designed to push air up the front wall and over the roof to improve towability and fuel economy.

**Improves  
Aerodynamics  
Protects Tanks  
and Floor**

**Enclosed &  
Heated Underbelly**





## MINIS

## 1400RB

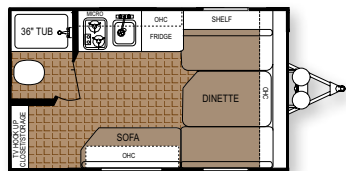

Hitch Weight (lbs).....	291	Fresh Water Capacity .....	27
Unloaded Weight (lbs) .....	2,639	Black Water Tank(s) .....	28
Cargo Capacity (lbs) .....	761	Gray Water Tank(s) .....	28
Overall Height w/Opt AC.....	10'	Furnace BTU Output .....	18,000
Overall Length.....	17' 6"		

## 1500BH

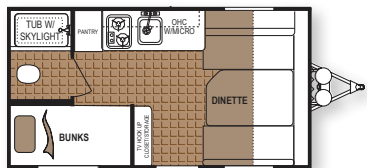

Hitch Weight (lbs).....	317	Fresh Water Capacity .....	27
Unloaded Weight (lbs) .....	2,715	Black Water Tank(s) .....	28
Cargo Capacity (lbs) .....	1,085	Gray Water Tank(s) .....	28
Overall Height w/Opt AC.....	9' 11"	Furnace BTU Output .....	18,000
Overall Length.....	18' 9"		

## 1600QB

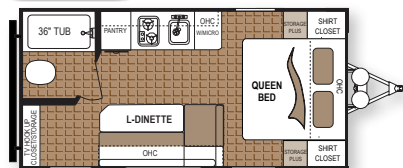

Hitch Weight (lbs).....	352	Fresh Water Capacity .....	27
Unloaded Weight (lbs) .....	3,072	Black Water Tank(s) .....	28
Cargo Capacity (lbs) .....	728	Gray Water Tank(s) .....	28
Overall Height w/AC .....	9' 9"	Furnace BTU Output .....	18,000
Overall Length.....	21' 5"		

## 2470BHS

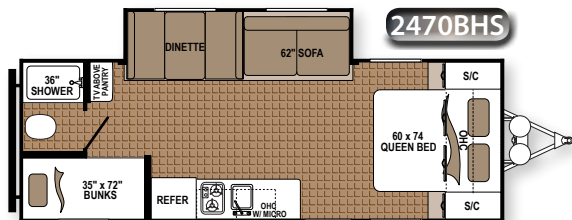

Hitch Weight (lbs).....	TBD	Fresh Water Capacity .....	26.5
Unloaded Weight (lbs) .....	TBD	Black Water Tank(s) .....	28
Cargo Capacity (lbs) .....	TBD	Gray Water Tank(s) .....	28
Overall Height w/AC .....	10' 1"	Furnace BTU Output .....	18,000
Overall Length.....	27' 6"		

## 1700DB

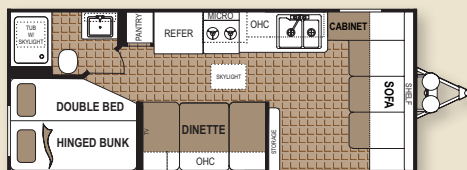

Hitch Weight (lbs).....	464	Fresh Water Capacity .....	52
Unloaded Weight (lbs) .....	4,052	Black Water Tank(s) .....	42
Cargo Capacity (lbs) .....	3,548	Gray Water Tank(s) .....	42
Overall Height w/AC .....	10' 7"	Furnace BTU Output .....	18,000
Overall Length.....	23' 10"		

## 1900RB

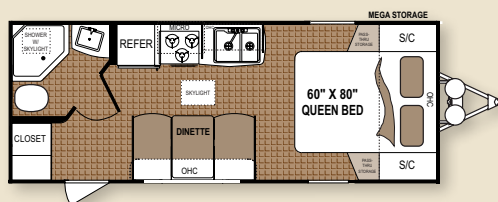

Hitch Weight (lbs).....	504	Fresh Water Capacity .....	52
Unloaded Weight (lbs) .....	4,096	Black Water Tank(s) .....	42
Cargo Capacity (lbs) .....	3,504	Gray Water Tank(s) .....	42
Overall Height w/AC .....	10' 8"	Furnace BTU Output .....	18,000
Overall Length.....	24' 8"		

## 2110RBS

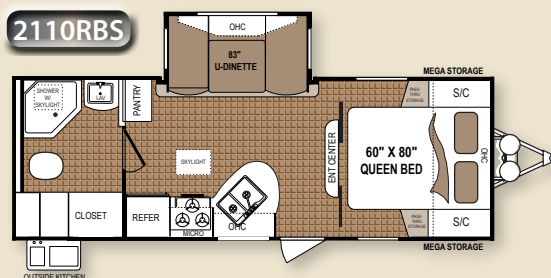

Hitch Weight (lbs).....	567	Fresh Water Capacity .....	52
Unloaded Weight (lbs) .....	5,446	Black Water Tank(s) .....	42
Cargo Capacity (lbs) .....	2,154	Gray Water Tank(s) .....	42
Overall Height w/AC .....	11' 3"	Furnace BTU Output .....	25,000
Overall Length.....	26' 6"		

## 2390RKS

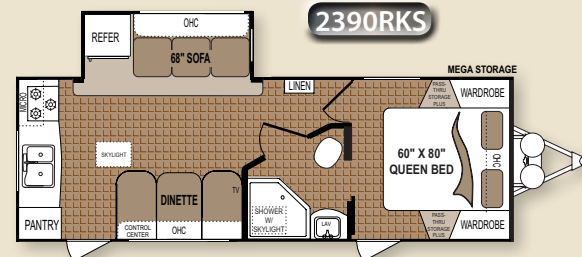

Hitch Weight (lbs).....	782	Fresh Water Capacity .....	52
Unloaded Weight (lbs) .....	5,495	Black Water Tank(s) .....	42
Cargo Capacity (lbs) .....	2,106	Gray Water Tank(s) .....	42
Overall Height w/AC .....	11' 4"	Furnace BTU Output .....	25,000
Overall Length.....	27' 2"		

## 2460RLS

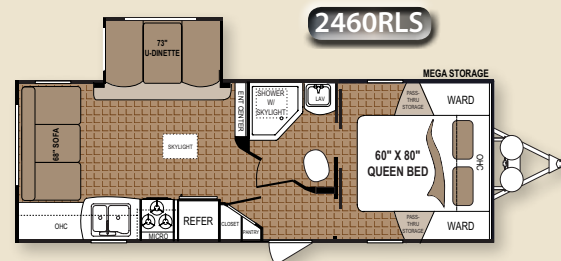

Hitch Weight (lbs).....	526	Fresh Water Capacity .....	52
Unloaded Weight (lbs) .....	5,479	Black Water Tank(s) .....	42
Cargo Capacity (lbs) .....	2,121	Gray Water Tank(s) .....	42
Overall Height w/AC .....	11' 2"	Furnace BTU Output .....	25,000
Overall Length.....	27' 9"		

## 2500BH

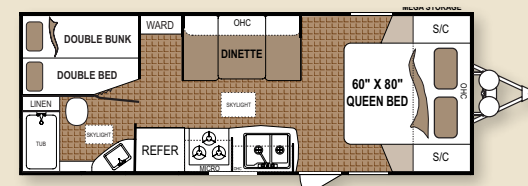

Hitch Weight (lbs).....	554	Fresh Water Capacity .....	52
Unloaded Weight (lbs) .....	4,290	Black Water Tank(s) .....	42
Cargo Capacity (lbs) .....	3,310	Gray Water Tank(s) .....	42
Overall Height w/AC .....	10' 7"	Furnace BTU Output .....	18,000
Overall Length.....	25' 7"		

## 2630BHS

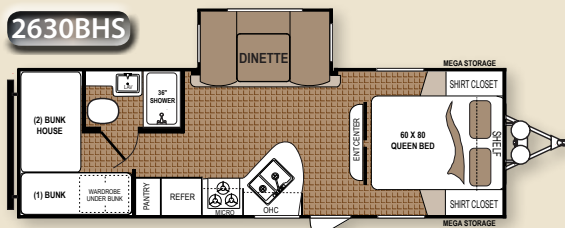

Hitch Weight (lbs)..... 616  
 Unloaded Weight (lbs) ..... 6,250  
 Cargo Capacity (lbs) ..... 3,430  
 Overall Height w/AC ..... 11' 3"  
 Overall Length..... 29'

Fresh Water Capacity ..... 52  
 Black Water Tank(s) ..... 42  
 Gray Water Tank(s) ..... 42  
 Furnace BTU Output ..... 25,000

## 2710BH

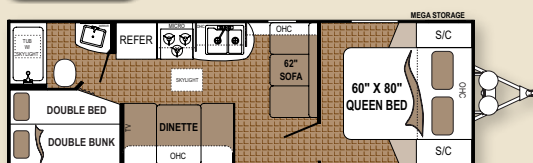

Hitch Weight (lbs)..... 543  
 Unloaded Weight (lbs) ..... 4,624  
 Cargo Capacity (lbs) ..... 2,976  
 Overall Height w/AC ..... 10' 7"  
 Overall Length..... 28' 7"

Fresh Water Capacity ..... 52  
 Black Water Tank(s) ..... 42  
 Gray Water Tank(s) ..... 42  
 Furnace BTU Output ..... 18,000

## 2810BHS

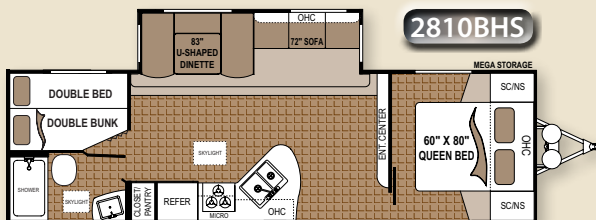

Hitch Weight (lbs)..... 814  
 Unloaded Weight (lbs) ..... 6,512  
 Cargo Capacity (lbs) ..... 3,168  
 Overall Height w/AC ..... 11' 4"  
 Overall Length..... 32' 4"

Fresh Water Capacity ..... 52  
 Black Water Tank(s) ..... 42  
 Gray Water Tank(s) ..... 42  
 Furnace BTU Output ..... 34,000

## 2910RLS

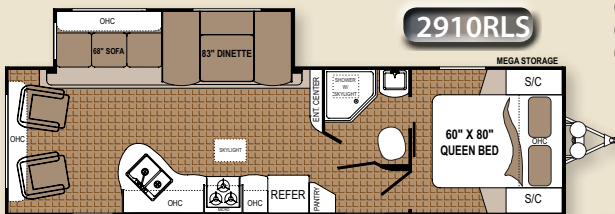

Hitch Weight (lbs)..... 682  
 Unloaded Weight (lbs) ..... 6,776  
 Cargo Capacity (lbs) ..... 2,904  
 Overall Height w/AC ..... 11' 5"  
 Overall Length..... 32' 10"

Fresh Water Capacity ..... 52  
 Black Water Tank(s) ..... 42  
 Gray Water Tank(s) ..... 42  
 Furnace BTU Output ..... 34,000

## 3010BHS

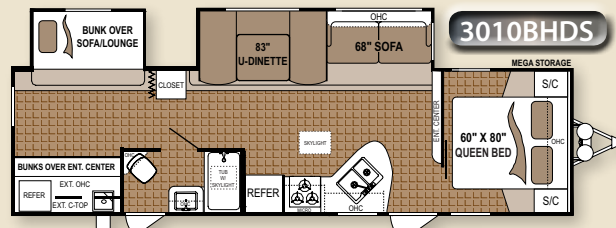

Hitch Weight (lbs)..... 944  
 Unloaded Weight (lbs) ..... 7,778  
 Cargo Capacity (lbs) ..... 1,902  
 Overall Height w/AC ..... 11' 7"  
 Overall Length..... 35' 9"

Fresh Water Capacity ..... 52  
 Black Water Tank(s) ..... 42  
 Gray Water Tank(s) ..... 42  
 Furnace BTU Output ..... 34,000

## 3100BHS

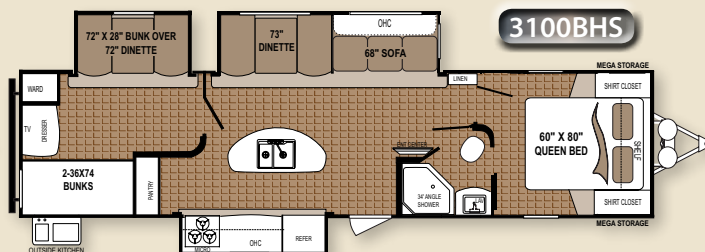

Hitch Weight (lbs)..... 986  
 Unloaded Weight (lbs) ..... 8,337  
 Cargo Capacity (lbs) ..... 2,839  
 Overall Height w/AC ..... 11' 8"  
 Overall Length..... 36' 11"

Fresh Water Capacity ..... 52  
 Black Water Tank(s) ..... 42  
 Gray Water Tank(s) ..... 78  
 Furnace BTU Output ..... 34,000

## 3117RLDS

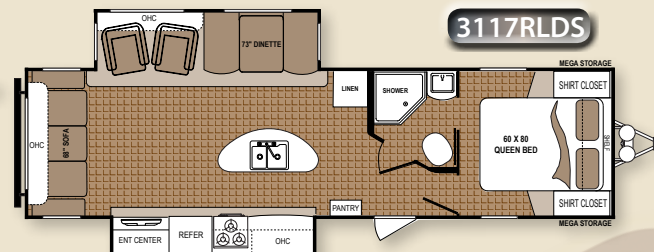

Hitch Weight (lbs)..... 992  
 Unloaded Weight (lbs) ..... 7,444  
 Cargo Capacity (lbs) ..... 2,236  
 Overall Height w/AC ..... 11' 4"  
 Overall Length..... 34' 7"

Fresh Water Capacity ..... 52  
 Black Water Tank(s) ..... 42  
 Gray Water Tank(s) ..... 42  
 Furnace BTU Output ..... 34,000

## 3125RLS

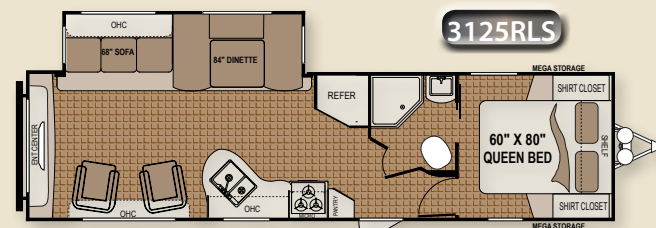

Hitch Weight (lbs)..... 853  
 Unloaded Weight (lbs) ..... 6,850  
 Cargo Capacity (lbs) ..... 2,830  
 Overall Height w/AC ..... 11' 4"  
 Overall Length..... 34' 2"

Fresh Water Capacity ..... 52  
 Black Water Tank(s) ..... 42  
 Gray Water Tank(s) ..... 42  
 Furnace BTU Output ..... 34,000

## 3130QBS

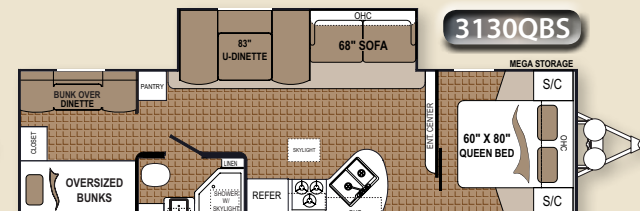

Hitch Weight (lbs)..... 827  
 Unloaded Weight (lbs) ..... 6,888  
 Cargo Capacity (lbs) ..... 2,792  
 Overall Height w/AC ..... 11' 6"  
 Overall Length..... 34'

Fresh Water Capacity ..... 52  
 Black Water Tank(s) ..... 42  
 Gray Water Tank(s) ..... 42  
 Furnace BTU Output ..... 34,000

## 3600BDS

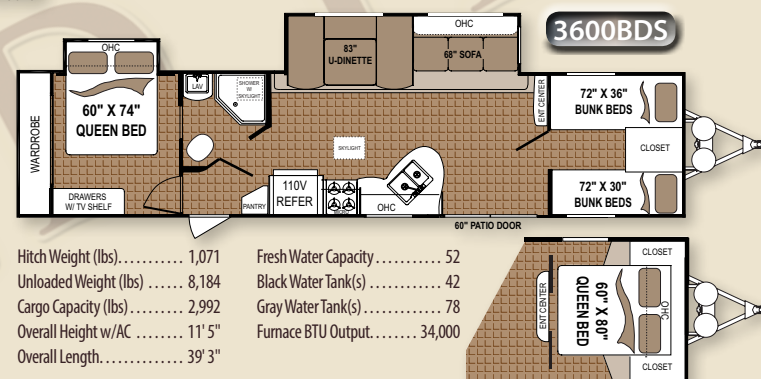

Hitch Weight (lbs)..... 1,071  
 Unloaded Weight (lbs) ..... 8,184  
 Cargo Capacity (lbs) ..... 2,992  
 Overall Height w/AC ..... 11' 5"  
 Overall Length..... 39' 3"

Fresh Water Capacity ..... 52  
 Black Water Tank(s) ..... 42  
 Gray Water Tank(s) ..... 78  
 Furnace BTU Output ..... 34,000

Queen Bed Option

# STANDARD AND OPTIONAL FEATURES

## ISLAND TRAIL VALUE ADDED PACKAGE

Aerodynamic Front Profile  
Front Diamond Plate Rock Guard  
Jensen® Stereo  
Interior and Exterior Speakers  
Central Command Center  
Full Extension Roller Ball Bearing Drawer Guides in Galley  
Cherry Glazed Hardwood Cabinet Doors  
Laundry Chute (See Floorplans) - Slide Models Only  
Evergreen 60" x 80" Deluxe Quilted Mattress  
Congoleum Wood Plank Premium Vinyl Flooring  
"Mega Storage" Pass Thru Storage  
Compartment (See Floorplans)  
82" Interior Ceiling Height  
"Super Slide" Slide Room with 72" Interior Height

## INTERIOR FEATURES

### KITCHEN

Residential Microwave Oven with Carousel  
Auto Ignition 3 Burner Range with  
Oven (Slide Models)  
3 Burner Cook Top (Non Slide Models)  
Large 6 Cubic Foot Double Door  
Gas/Electric Refrigerator  
Extra Large, Double Bowl Sink with High Rise Faucet  
Power Range Hood with 12 Volt Light and Exhaust Fan

## LIVING AREA FEATURES

Premium Residential Furniture  
Large Radius Corner Slide-Out Overhead Cabinets  
Premium Slide-Out Fascia  
12 Volt Lights Over Dinette  
Designer Window Treatments with  
Mini Blinds Throughout  
Swivel Chairs (See Floorplans)  
Fold-Down Sofa (See Floorplans)  
83" U-Shaped Convertible Dinette (See Floorplans)  
Wall Switches for Overhead Lights

## BEDROOM FEATURES

TV Hook-Ups In Bedroom (See Floorplans)  
Lift-Up Bed Storage (See Floorplans)  
Designer Bedding Package with Bedspread  
Reading Lights  
Privacy Curtain for Bunks  
Sliding Bedroom Doors

## BATHROOM FEATURES

ABS Tub & Shower Surround  
Shower/Exhaust Fan  
Glass Shower Door (See Floorplans)  
Designer Mirror  
110V GFI Outlet  
GFI Protected 110 Volt  
Duplex Receptacles  
Towel Hooks  
Foot Flush Toilet

## "STORE MORE" CABINETRY

Radius Corner - Full Access Cabinet  
Cherry Glazed Hardwood Panel Drawer Fronts and Cabinet Doors  
in Galley  
Deep Slide Room Cabinets with Decorative Glass Inserts

## APPLIANCES AND SAFETY EQUIPMENT

6 Gallon Gas DSI Water Heater  
Water Heater By-Pass  
34K BTU Furnace (Most Models - See Floorplans)  
13.5 BTU Roof Ducted Air Conditioning  
(Most Models - See Floorplans)  
Premium 12 Volt Water Pump  
55 Amp Electronic Converter  
Digital TV Antenna with Booster  
Wired for Cable  
Monitor Panel  
Smoke Detector  
Carbon Monoxide Detector  
LP Leak Detector

## CONSTRUCTION

### CHASSIS

Heavy Duty Steel I-Beam Frame  
Dual Battery Tray  
2 5/16" Coupler  
Break-Away Trailer Switch  
Heavy Duty Safety Chains  
(2) 20 lb. LP Bottles  
Rear Stabilizer Jacks  
Easy Lube Axles  
Steel Rims  
Folding Entry Steps  
Rear Bumper  
46 Gallon Fresh Water Tank

### FLOOR

16" on Center Studs  
5/8" Tongue and Groove Floor Decking

### ROOF

Walk-On Roof with Fiberglass Insulation R-7  
Seamless TPO Roof with 12 Year Mfg. Warranty  
3/8" Roof Decking  
Roof Ducted Air Conditioning  
(Most Models - See Floorplans)  
Extended Rain Gutters

### WALLS

Manual Awning with Adjustable Legs  
Detachable 30 Amp Power Cord  
Hurricane Straps Integrate Walls to Roof and Floor  
Heavy Duty .024" Mesa Sidewall Metal  
R7 Fiberglass Insulation  
Key-Locking, Radius Corner Exterior  
"Mega Storage" Compartments  
Pebble Finish Entry Door  
Patio Light  
Tinted Safety Glass Windows  
Large Picture Window at Dinette  
120V Exterior Outlet

## ACU-WEIGHT CERTIFICATION

Real Weights - All Units Weighed Before Leaving  
the Factory  
Weights Include Options - See Acu-Weight Decal on Unit

## OPTIONAL FEATURES

Tri-Fold Sofa  
Table & 4 Chairs  
Aztec Gray Fiberglass  
15,000 BTU A/C Upgrade  
Radial Tires (Mandatory)  
Spare Tire and Cover  
Front Stabilizer Jacks  
Sink Covers  
Oven (Non Slides)  
6 Gallon Quick Recovery Gas/Electric/DSI Water Heater  
Exterior Wash Station  
30 lb. LP Bottles with Deluxe ABS LP Bottle Cover  
Power Stabilizer Jacks  
Power Awning

Product information is as accurate as possible as of the date of publication of this brochure. Features, floorplans and specifications are subject to change without notice.  
Tow Vehicle Disclaimer CAUTION: Owners of Dutchmen Manufacturing, Inc., recreational vehicles are solely responsible for the selection and proper use of tow vehicles. All customers should consult with a motor vehicle manufacturer or their dealer concerning the purchase and use of suitable tow vehicles for Dutchmen products. Dutchmen disclaims any liability or damages suffered as a result of the selection, operation, use or misuse of a tow vehicle. Dutchmen's limited warranty does not cover damage to the recreational vehicle or the tow vehicle as a result of the selection, operation, use or misuse of the tow vehicle.

Dutchmen Manufacturing, Inc.  
PO Box 2164  
2164 Caragana Court  
Goshen, Indiana 46527  
(574)537-0600

## FABRICS

FRENCH ROAST



ENTOURAGE



PEPPERCORN



Your Local Dealer