

2006 FLOOR PLANS

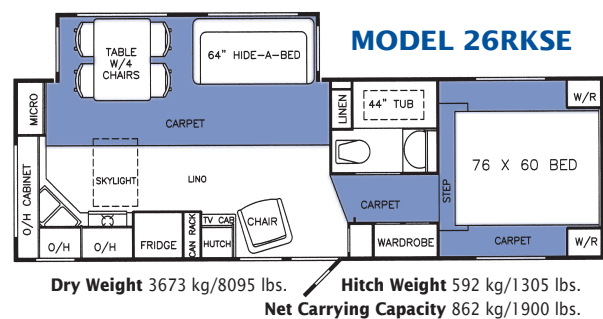

Flush Floor Slide Outs on all Models

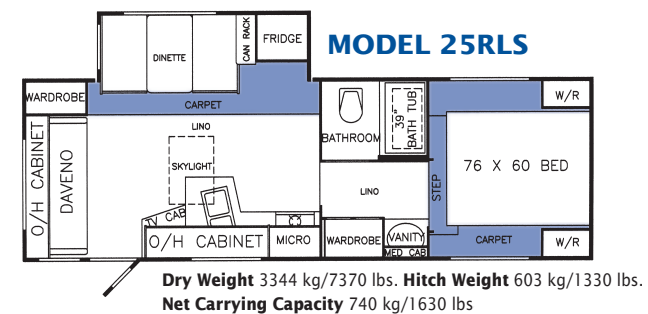
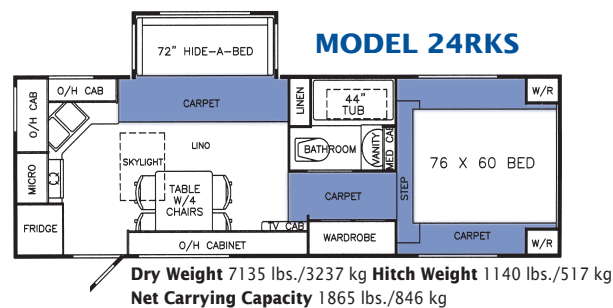
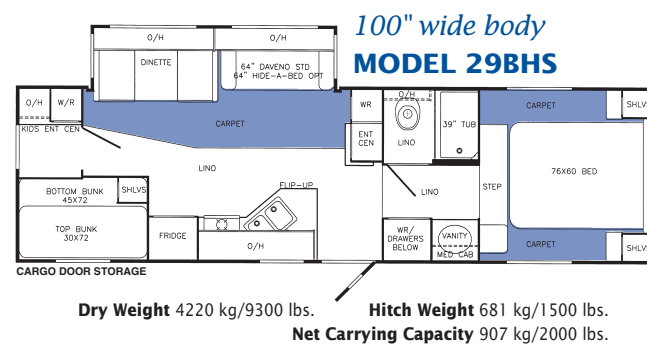
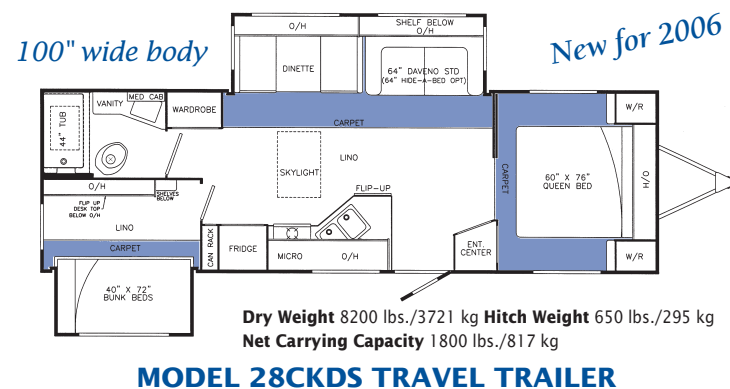

POLAR-PAK
THE SUB-ZERO SOLUTION



General Coach provides you with a two-year limited warranty on your fifth wheel trailer. Additionally, General Coach includes a six-year limited warranty which covers the structural integrity of your vehicle. This added warranty is unique to the recreational vehicle industry and should be one of your very serious considerations when choosing your next R.V.

2006 SPECIFICATIONS

	24RKS	25RLS	26RKSE	29BHS	28CKDS TT
Exterior Length	7.8 M/25'7"	8.1 M/26'7"	8.3 M/27'4"	9.3 M/30'6"	9.9M/32'6"
Exterior Width	2.4 M/8'0"	2.4 M/8'0"	2.4 M/8'0"	2.5 M/8'4" wide body	2.5 M/8'4" wide body
Exterior Height	3.4 M/11'2"	3.4 M/11'2"	3.5 M/11'6"	3.7 M/12'2"	3.4M/11'0"
Bedroom Height	1.7 M/5'8"	1.7 M/5'8"	1.7 M/5'8"	1.8 M/5'9"	2.0M/6'8"
G.V.W.R.	4083 kg/9000 lbs.	4083 kg/9000 lbs.	4537 kg/10,000 lbs.	5127 kg/11,300 lbs.	4537 kg/10,000 lbs.
Exterior Storage	62 Cu. Ft.	52 Cu. Ft.	66 Cu. Ft.	152 Cu. Ft.	35 Cu. Ft.
Fresh Water Capacity	173 L/44.5 US Gal.	173 L/44.5 US Gal.	173 L/44.5 US Gal.	241 L/ 64 US Gal.	218 L/58 US Gal.
Toilet Tank Capacity	137 L/35 US Gal.	137 L/35 US Gal.	137 L/35 US Gal.	203 L/ 53.4 US Gal.	137 L/35 US Gal
Grey Tank	137 L/35 US Gal.	137 L/35 US Gal.	137 L/35 US Gal.	194 L/51 US Gal.	137 L/35 US Gal
Radial Tire Size	ST225/75R15-D	ST225/75R15-D	ST225/75R15-D	ST235/80R16-D	ST225/75R15-D
Propane Capacity	2x30 lbs.	2x30 lbs.	2x30 lbs.	2x30 lbs.	2x30 lbs.
Axle Capacity	10,400 lbs.	10,400 lbs.	10,400 lbs.	10,400 lbs.	10,400 lbs.
Furnace Size (DSI)	25,000 BTU	25,000 BTU	31,000 BTU	35,000 BTU	35,000 BTU
Awning	15'	17'	15'	16'	18'

The manufacturer reserves the right to improve or modify the product which may change specifications, designs or prices. Information contained herein is from data available at time of printing. All products meet or exceed CSA and RVIA standards.



GENERAL COACH

P.O. Box 700, Oliver, B.C. V0H 1T0
Telephone: (250) 498-3471
Fax: (250) 498-3240
E-mail: gcsales@otvcablelan.net
Website: www.generalcoach.bc.ca



Printed in Canada by
Wayside Press Ltd.

Proudly Presented By



CANADA'S BEST! DON'T SETTLE FOR LESS!

Citation 2006



FIFTH WHEEL & TRAVEL TRAILERS



MODEL 29BHS WILLOW DECOR

INTERIOR

- Raised maple cabinet doors and drawer fronts
- Spring filled daveno - easy conversion for sleeping (Models 24RBS, 25RLS, 28CKDS & 29BHS)
- 40" wide dinettes with high density foam
- Exterior TV cable ready
- Co-ordinated valances and fabric blinds
- Residential steel drawer guides w/birch drawers
- Deep Stainless Steel kitchen sink
- Co-ordinated bedspread with pillows - residential coil spring mattress
- Queen and twin beds with gas lift struts and storage below
- Plywood counter tops with maple edge
- Seamless residential fiberglass tub enclosure
- Slide-out can rack in Models 25RLS, 26RKS, 28CKDS
- Maple knife block in counter
- Brushed nickel cabinet hardware

QUALITY BRAND NAME APPLIANCES

- Wedgewood three-burner high output range w/oven Piezo ignition on range top
- 8' Norcold double door LP/120V refrigerator
- Deluxe monitor panel in Jensen range hood
- Atwood fast recovery 6 US Gal. water heater w/electric ignition. (10 US Gal.-29BHS only)
- Aluminum laminate refrigerator door panels
- Hydroflame Excalibur DSI furnace - ducted forced air

- JVC AM/FM stereo-"CD Player" with bedroom shut-off switch

STANDARD FEATURES

- * A & E 8500 Series deluxe awning
- * Duo therm roof air 13,500 BTU w/heat strip
- * Duo therm Ceiling ducted roof air 13,500 BTU Model 26RKS, 29BHS & 28CKDS
- * Microwave oven
- * Winegard TV antenna with power boost
- * Chrome rear bumper cover
- * Black tank flush system
- * Electric front jacks with quick release pins
- * Propane Leak Detector
- * Residential hide-a-bed - Models 24RKS, 26RKS
- * CO Detector
- * Dayliter residential dual pane skylights - Lifetime warranty

AVAILABLE COMFORT OPTIONS

- ❖ Attic Ventilation System (28 & 29 only)
- ❖ Awning over bedroom slide, 28CKDS only
- ❖ Aluminum Wheels ❖ Battery tray - (n/a 25 & 28)
- ❖ Generator Compartment (29BHS only)
- ❖ Electric Rear Stabilizer Jacks
- ❖ Fantastic vent fan - reversible
- ❖ Thermopane "Stormite" windows
- ❖ Fold away assist rail
- ❖ Solar panel - 80W or 100W
- ❖ Twin beds ❖ Water filter
- ❖ Maple Fridge Panels
- ❖ Hide-a-bed - ILO Daveno - Models 29BHS, 28CKDS
- ❖ Daveno ILO Bunk Bed, Model 28CKDS
- ❖ Exterior shower
- ❖ Round dining table - exch
- ❖ FIS table ILO booth dinette - Models 25RLS, 29BHS, 28CKDS
- ❖ 12 Volt Disconnect
- ❖ 16" wheels, 28CKDS only
- ❖ Desk ILO Bottom Bunk Model 28CKDS only

We are General Coach, a western Canadian company that manufactures the well known Citation line of quality recreational vehicles. For over 55 years we have been consumer established as builders of high value, superior quality R.V.'s with proven high resale value. Your comfort and satisfaction are ensured. Residential quality components and residential style construction techniques are used by skilled, long term employees dedicated to quality workmanship.

Citation is designed for western Canadian climate and conditions with standard features second to none. Your peace of mind with your purchase decision is reinforced by Citation's **Six Year Limited Structural Integrity Warranty. Quality You Can Afford!**



Two Year Limited Component Warranty

Check & Compare These **75** Quality & Value Features Before You Buy

Unmatched liveability, cozy comfort and superior quality are foremost in the Citation. The Model 29 Bunkhouse is shown here in the rich Willow Decor. Quality crafted residential furniture is upholstered with woven, durable, high quality fabrics.

Kitchens feature abundant overhead cabinets, numerous drawers and spacious counters for maximum interior storage and easy food preparation. Citation utilizes customer proven name brand appliances and components, with two-year warranties for your worry-free travel.

You'll really appreciate the thoughtful design of Citation's bedrooms. Spacious headroom, large wardrobes and large maple drawers on quality, double steel guides and rollers is just the beginning. All beds have a lift-up feature to access valuable storage below and residential quality coil spring mattresses will ensure your sleeping comfort.

Outside, large exterior storage compartments accommodate all of your hobby and leisure items...and then some!

EXTERIOR

- Colour Co-ordinated fiberglass skirts
- "Filon Medallion" fiberglass with a 2 year warranty against fading or discoloring
- Vacuum laminated walls - framed and steel reinforced
- "Aerodynamic" seamless fiberglass front cap
- Fiberglass one piece fender skirts
- Fiberglass front compartment doors - "Dent Proof"
- Convenient retainer clips on all compartment doors
- Dual battery compartment
- Radius corner tinted windows
- Large front storage compartments
- 4'x4' cargo door on curbside - Model 29BHS

- Roadside and hitch lights
- Interior switched patio light
- Entrance door with secure deadbolt lock
- Automotive quality clearance and tail lights
- Retractable non-skid triple entrance steps
- Goodyear Marathon radial tires
- Radial spare tire
- Dexter axles with 4 shock absorbers and leaf springs
- Heavy duty electric brakes - 12"
- High performance polypropylene undersiding. Seamless and non-corrosive. Stronger than galvanized steel
- Roof rack and ladder
- "Dicor" seamless vinyl roof - 12 year warranty against weather damage
- **Adjustable Height Spring Hangers**

- Full 3/8" plywood roof deck - residential 2x3 stud (Crowned 5 1/4" Truss on Models 26, 28 & 29)
- Maxi-frame, heavy-duty steel chassis with superior number of 12 gauge full-width crossmembers
- Chassis protected w/full undercoating
- Steel frame welded to meet or exceed CSA specifications
- Adjustable extended pin box (5th Wheels)
- Canada's only framed vacuum bonded wall with a **6 Year Structural Warranty**
- Full frame floor w/5/8 plywood glued and screwed
- All plywood construction - no substitutes
- Vacuum bonded walls mounted directly on top of floor - dustproof seal
- Roof mounted directly on top of sidewall
- EPS block insulation - dimensionally stable - totally non-toxic, non-allergenic; No CFC's or HFC's - ultra high density - 16 PSI
- All interior and exterior components secured w/screws to stud reinforcing
- Electric gear driven rack and pinion slide with manual override - self locking for travel
- Solar panel pre-wire
- Rear and front stabilizer jacks, Model 28CKDS
- Rear stabilizer jacks, all fifth wheels
- Flush floor slide outs w/laminated aluminum framed and insulated floor
- **"Heated holding & fresh water tanks"** - Models 29 BHS & 28CKDS TT



MODEL 29BHS WILLOW DECOR