

2008



Corsair

excella

Fifth Wheel & Travel Trailers

North America's Best

POLAR-PAK ❄️
THE SUB-ZERO SOLUTION



Excellence You Deserve!

Guaranteed to -30° C



2008 Model 34.5 CKTS - Amaryllis Decor

Excelsa Livability

Experience the "At Home" comfort and livability that only Corsair Excelsa quality provides. Residential style, "All Season" features are endless! "Stormtite" double glazed thermopane windows, "Dayliter" dual-pane residential skylights, "Atwood" Dual furnaces and exclusive attic ventilation system keeps you warm and condensation free.

What you "can't see" is where Corsair excels with surprising features like Nev-R-Lube axles, "Whisper King" water pumps, XT 16 gal. water heaters. The expansive 34.5 CKTS Platinum features a large island kitchen and a living area that is a comfortable 352 sq.ft. Solid surface counters, Norcold 10 cu.ft. fridge, recessed stovetop and sink, slide-out garbage can, can racks and halogen lighting highlight the kitchen. A handy fold down desk, standard 32" LCD HD TV on a swivel arm with a DVD theatre surround sound system and optional fireplace accent the Entertainment Center area. Hydraulic disc brakes w/lube shackles and Mor-Ryde pin box provide towing safety and a utility compartment houses exterior conveniences such as pop-out hose reel, dump valves and exterior shower. Our unmatched features, quality construction and wide body design provide year round comfort, exclusive livability and worry-free travel.

Excellence You Deserve!



Model 34.5 CKTS Bedroom

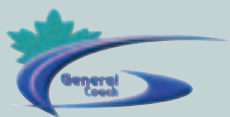

We are General Coach, a division of Thor Industries Inc., a western Canadian company that manufactures the well known Corsair brand of quality recreational vehicles. For over 57 years we have been consumer established as

builders of high value, superior quality RV's with proven high resale value.

Because we are a limited capacity production company we do not mass produce our products allowing us to ensure strict quality control standards which, in turn, ensures your comfort and satisfaction. Residential quality components and residential style construction techniques are utilized by skilled, conscientious, long term employees dedicated to quality workmanship.

Corsair by General Coach is designed for recreational use in western Canadian climate and conditions with "Polar Pak" features second to none. Your peace of mind with your purchase decision is reinforced by Corsair's **Six Year Limited Structural Integrity Warranty & Guaranteed to -30°.**

Why a Thor Product Is Your Best RV Value.

Thor industries, Inc., proudly traces its history back nearly seventy years to the pioneering days of the RV industry with the founding of Airstream, the industry's oldest and most renowned brand. Our total commitment to quality and our philosophy of putting our customers first has led to our continuous growth; today Thor is the largest manufacturer of travel trailers and fifth wheels, a major manufacturer of motorhomes and the largest builder of small and mid-size buses in North America. Thor's strong financial condition and years of solid growth are your assurance that we will be here to serve you for years to come. We think this extra peace of mind is important when you are making a significant investment. Our customers are always #1 with us.

“General Coach makes a top-line product. We just purchased our fifth General Coach 5th Wheel and are proud of the 34RLTS model - the quality is exceptional, the layout very functional and the decor warm and inviting. Needless to say, we would highly recommend a General Coach product over and above anything else on the market as you receive true value for your dollar. We go to the Calgary RV show every February and no other manufacturer, in our opinion, manufactures a product as good! Warranty and follow-up service at the dealer has always been excellent.

Don & Doreen W.
Calgary, Alberta



Table of Contents

FIFTH WHEELS

Model 26RKS	3
Model 29CKS	4
Model 29.5RLS	5
Model 29RKDS	6
Model 30RLDS	7
Model 31CKDS XL	8
Model 31.5RLS	9
Model 32.5TKS	10
Model 33RLTS	11
Model 34RLTS PLATINUM XL	12
Model 34.5CKTS PLATINUM XL	13
Model 38.RLQS PLATINUM XL	14

TRAVEL TRAILER

Model 30RLS	15
Polar Pak Your Subzero Solution ..	16
Feature Photos	17-18
Construction Detail	19

*Corsair Excella,
Excellence You Deserve!*

Production information, specifications, photography in this brochure were as accurate as possible at time of printing. Photographs may contain some features that are optional on your vehicle. Since we continually strive to improve our products, actual products may differ. Prices and specifications are subject to change without notice. All capacities are approximate and dimensions are nominal. All products meet or exceed CSA or RVIA standards.

Check with your local dealer for a complete list of options and features on the model you are considering.

**“Warranted For
Fulltime Living!”**



New For 2008 Model 38RLQS

The new for 2008 38 Rear Lounge Quad Slide sets the standard for full time all season living. Four separate areas ensure residential livability and complete privacy. This exceptional kitchen features a large counter of 'Karadon' solid surface, recessed residential stainless steel sink and range top with full height cabinets to maximize the usable space. The solid hardwood table has a handy 13" extension leaf and lifts up with storage. The ergonomic dining chairs have storage designed into the seat bases.

“Warranted For Fulltime Living!”

The private rear living room features opposing slide outs for 12' of interior width! Residential French doors ensure privacy and quiet with elegance. The entertainment center features a 32" LCD HD TV, home theatre and a 6' solid hardwood desk which provides a perfect work area for the full timer. The entertainment center is also available with a 42" LCD HD TV which replaces the chair and the windows in the slide. Residential skylights allow for natural lighting during the day.



Model 38 RLQS

FIFTH WHEEL MODEL 26RKS

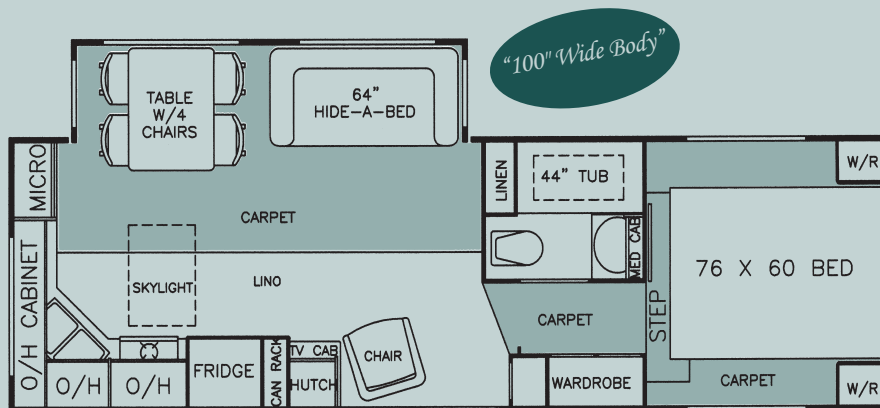

SPECIFICATIONS

GVWR	4991 Kg/11,000 lbs.
Dry Weight	4072 Kg/8,975 lbs.
Net Carrying Capacity	919 Kg/2,025 lbs.
Axle Capacity	4719 Kg/10,400 lbs.
Hitch Weight	628 Kg/1,385 lbs.
Height*	3.6 M/11'10"
Width	2.5 M/8'4"
Length	8.4 M/27'5"
Exterior Storage	65 cu. ft.

* Approximate height to top of air conditioner

POLAR-PAK
THE SUB-ZERO SOLUTION

Guaranteed to -30° C

STANDARD FEATURES

BATH/BEDROOM

- ◆ "Taymor" Vanity Faucet
- ◆ Power Vent in Bath
- ◆ CO Detector
- ◆ Residential Fiberglass Tub W/Glass Door
- ◆ Escape Window in Bedroom
- ◆ Porcelain Toilet
- ◆ "Eurotop" Mattress
- ◆ 5'9" Bedroom Height
- ◆ Co-ord. Bedspread & Pillows
- ◆ Day/Nite Fabric Blinds
- ◆ Tooth Brush Holder, Soap Dish
- * Residential Skylight with Moisture Control & Blind

KITCHEN

- ◆ Knife Block
- ◆ Range Cover
- ◆ Jensen Range Hood W/Systems Monitor
- ◆ "Atwood" High Output Range
- ◆ "Norcold" 8 cu.ft. Fridge W/Aluminum Laminate Door Panels
- * Residential Skylight with Moisture Control & Blind
- ◆ Raised Beech Cabinet Doors
- ◆ Polymer Kitchen Sink W/"Taymor" Faucet W/Spray
- ◆ Kitchen Drawers—Birch Plywood—Nylon Rollers & Steel Guides
- ◆ Hardwood Table w/ Leaf & 4 Chairs,
- ◆ Fluorescent Light in Ceiling
- ◆ Pull Out Can Rack

LIVING ROOM

- ◆ Cable/Telephone Hook Up
- ◆ Smoke Detector
- ◆ Fire Extinguisher
- ◆ AM/FM Stereo/CD Player W/4 Speakers
- ◆ Stressless Recliner w/Ottoman
- ◆ Hideabed 64" w/Footrest
- ◆ Day/Nite Fabric Blinds
- ◆ Raised Beech Cabinet Doors
- ◆ Fluorescent Light in Ceiling
- ◆ Solid Beech & Fabric Fascia - L.R. Slide

EXCELLA STANDARD FEATURES

- ◆ Central Roof AC—13.5
- ◆ 15' Awning A+E
- ◆ Microwave Oven
- ◆ TV Antenna
- * "Fantastic" Rain Sensor Vent Fan
- ◆ Black Tank Flush
- ◆ Fold Away Assist Rail
- ◆ Propane Leak Detector
- * "Stormtite" Thermopane Windows
- ◆ TV Shelf/BR
- ◆ 16" Aluminum Wheels (4)

EXTERIOR

- ◆ Solar Reflective Radius Corner Windows
- ◆ Aerodynamic Fuelsaver Fiberglass Cap
- ◆ Seamless Fiberglass Frt. & Rear Caps
- ◆ Fiberglass Skirts/Fenders
- ◆ Entrance Step Boot Shelf
- * Compartment Doors w/1" Insulation
- ◆ BBQ Quick Connect
- ◆ Roof Rack & Ladder
- ◆ Shock Absorbers (4)
- ◆ 2 Rear Stab. Jacks
- ◆ Elec. Front Jacks W/Quick Release Pins
- ◆ "MorRyde" Pin Box System
- ◆ "Dicor" Vinyl Roof
- ◆ Seamless Polypropylene Undersiding
- * 2" Vac-U-Lam Sidewalls W/DbI. Plywood
- ◆ Basement Storage—Full Width
- ◆ Dexter Nev-R-Lube Axles W/12" Brakes
- ◆ 16" Radials w/Spare
- * 3/8" Plywood Roof Deck
- ◆ 8' Sewer Hose Compartment
- ◆ Automotive Undercoat
- ◆ Curbside Scare Light
- ◆ Adjustable Height Spring Hangers
- ◆ Awning on Slide Out

MECHANICAL/CONSTRUCTION

- * Crowned Truss Roof R-11 Insulation
- * Attic Ventilation System
- * Excalibur 8535 IV Furnace
- * Heated & Encl. Holding & Fresh Water Tanks
- ◆ 12V Disconnect
- ◆ 45 Amp Power Converter W/Batt. Charger
- ◆ Detachable 30 Amp Power Cord
- ◆ Hot Water Bypass Valves
- ◆ XT9 Gas/Elec. Water Heater W/DSI—23 L (6 US Gal.)
- ◆ Whisper King Water Pump
- ◆ Fresh Water 232 L (61 US Gal.)
- ◆ Toilet Holding Tank 203 L (53.4 US Gal.)
- ◆ Grey Water 194 L (51 US Gal.)
- ◆ Dual Propane Bottles 13.6 Kg ea. (30 lbs. ea.)
- ◆ Electric "Sta-Tite" Slide Out W/Manual Override—"Flush Floor"
- ◆ Auto Change Over Propane Reg.
- ◆ Solar Panel Prewire
- ◆ Antifreeze Pick Up System
- * Insulated Slide Out Floor 2 3/8"

OPTIONS AVAILABLE

- ◆ "Weather Pro" Electric Awning*
- ◆ Awning Upgrade 9100 Electric
- ◆ Awning Upgrade 9000 Series
- ◆ Central Vacuum
- ◆ Dinette ILO F/S Table*
- ◆ Electric Rear Stabilizer Jacks*
- ◆ Exterior Shower*
- ◆ Hideabed w/Air Mattress
- ◆ Round Dining Table
- ◆ Twin Beds*
- ◆ Solar Panel* 120W
- ◆ Water Filter
- ◆ "Norcold" 10 cu. ft. Fridge
- ◆ 28" Recliner Leather or Fabric ILO Stressless

* Before Production Only.

Features & Specifications are subject to change without notice or obligation.

VEHICLE LOADING: Every effort has been made to provide the greatest number of options for the recreation vehicle owner. Along with these choices comes the responsibility to manage the loads that are imposed by the choices so that they remain within the manufacturer's specified chassis weight limits. Do not overload the recreation vehicle.

DRY WEIGHT is the total weight of the trailer with standard features included and all tanks empty.

NET CARRYING CAPACITY is calculated with standard features only and all tanks empty. Any options, fluids, or dealer added options must be subtracted from the Net Carrying Capacity to determine the remaining cargo allowance.

WARNING: This information is intended as a guide only. Weights of individual vehicles may vary. Consult your owner's manual for complete loading, weighing, and towing instructions.



FIFTH WHEEL MODEL 29 CKS

SPECIFICATIONS

GVWR

5672 Kg/12,500 lbs.

Dry Weight

4746 Kg/10,460 lbs.

Net Carrying Capacity

926 Kg/2040 lbs.

Axle Capacity

5430 Kg/12,000 lbs.

Hitch Weight

846 Kg/1,865 lbs.

Height*

3.9 M/12'8"

Width

2.5 M/8'4"

Length

9.2 M/30'3"

Exterior Storage

89 cu. ft.

* Approximate height to top of air conditioner

Warranted for Full Time Living!

"100" Wide Body"

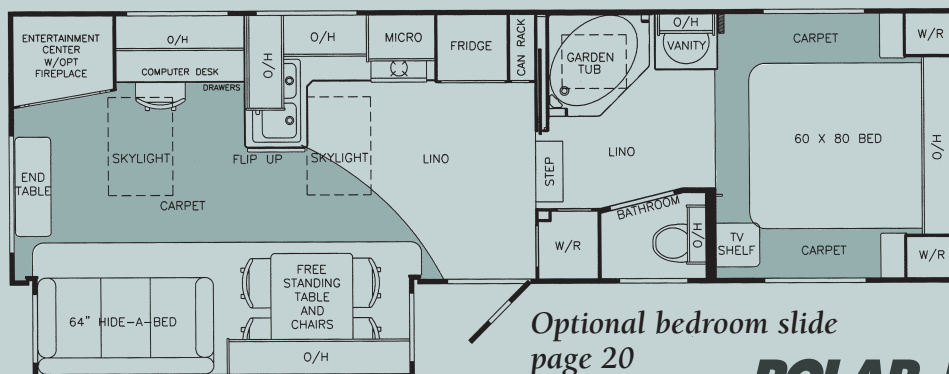

*Optional bedroom slide
page 20*

POLAR-PAK
THE SUB-ZERO SOLUTION

Guaranteed to -30° C

STANDARD FEATURES

BATH/BEDROOM

- ◆ "Taymor" Vanity Faucet
- ◆ Power Vent in Toilet Compartment
- ◆ CO Detector
- ◆ Residential Fiberglass Garden Tub W/Glass Door
- ◆ Escape Window
- * "Fantastic" Vent Fan Bathroom
- ◆ 6'0" Bedroom Height
- ◆ "Eurotop" Mattress
- ◆ Co-ord. Bedspread & Pillows
- ◆ Day/Nite Fabric Blinds
- ◆ TV Shelf in Bedroom
- ◆ Porcelain Toilet W/Pedal Flush
- * Residential Skylight with Moisture Control

KITCHEN

- ◆ Knife Block
- ◆ Range Cover
- ◆ Jensen Range Hood W/Systems Monitor
- ◆ "Atwood" High Output Range
- ◆ "Norcold" 8 cu. ft. Fridge W/Aluminum Laminate Door Panels
- ◆ Hardwood Table w/ Leaf & 4 Chairs
- ◆ Polymer Kitchen Sink W/"Taymor" Faucet W/Spray
- ◆ Kitchen Drawers-Birch Plywood-Nylon Rollers & Steel Guides
- ◆ Raised Beech Cabinet Doors
- ◆ Fluorescent Light in Ceiling
- ◆ Double Can Storage Rack
- * "Fantastic Rain Sensor" Vent Fan
- * Residential Skylight with Moisture Control & Blind
- ◆ Cental Vacuum w/Sweep

LIVING ROOM

- ◆ Cable/Telephone Hook Up
- ◆ Fire Extinguisher & Smoke Detector
- ◆ Residential CD & DVD Stereo with Surround Sound
- ◆ Computer Desk w/Chair
- ◆ Hide-a-bed w/ Footrest
- ◆ Day/Nite Fabric Blinds
- ◆ Raised Beech Cabinet Doors
- ◆ Beech End Table 36x13
- ◆ Co-ord. "C" Valances
- ◆ Fluorescent Light in Ceiling
- ◆ 26" LCD HDTV
- * Residential Skylight with Moisture Control & Blind

EXCELLA STANDARD FEATURES

- ◆ Central Roof AC-13.5 BTU
- ◆ 15' Awning A+E - 8500
- ◆ Microwave Oven
- ◆ TV Antenna
- ◆ Black Tank Flush
- ◆ Antifreeze Pickup System
- ◆ Propane Leak Detector
- ◆ TV Shelf/BR

EXTERIOR

- * Solar Reflective "Stormtite" Windows with Thermopane Glass
- ◆ Fiberglass Skirts/Fenders
- ◆ Aerodynamic Fuelsaver Front Fiberglass Cap
- * Compartment Doors w/1" Insulation
- ◆ Roof Rack & Ladder
- ◆ Entrance Step Boot Shelf
- ◆ Shock Absorbers (4)
- ◆ 2 Rear Stab. Jacks
- ◆ Elec. Front Jacks W/Quick Release Pins
- ◆ MorRyde Pin Box System
- ◆ Exterior Shower in Compartment
- ◆ "Dicor" Vinyl Roof
- ◆ Hitch Hook Up Light
- ◆ Seamless Polypropylene Undersiding
- * 2" Vac-U-Lam Sidewalls W/DbL. Plywood
- ◆ Basement Storage - Lighted
- ◆ Battery Compartment Quad Recessed
- ◆ Dexter Nev-R-Lube Axles W/12" Brakes
- ◆ 16" Radials w/Spare
- * 3/8" Plywood Roof Deck
- ◆ 8' Sewer Hose Compartment
- ◆ Automotive Undercoat
- ◆ Curbside Scare Light
- ◆ Adjustable Height Spring Hangers
- ◆ BBQ Quick Connect
- ◆ Awning on Slide Out

MECHANICAL/CONSTRUCTION

- * Crowned Truss Roof R-11 Ins.
- * Excalibur 8535 IV Furnace
- * Heated & Encl. Holding & Fresh Water Tanks
- ◆ 12V Disconnect
- ◆ 45 Amp Power Converter W/Batt. Charger
- ◆ 50 Amp Service with Detachable Cord
- ◆ Hot Water Bypass Valves
- ◆ XT16 Gas/Elec. Water Heater W/DSI-36 L (10 US Gal.)
- * Attic Ventilation System*
- ◆ Whisper King Water Pump
- ◆ Fresh Water 232 L (61 US Gal.)
- * Insulated Slide Out Floor 2 3/8"
- ◆ Toilet Holding Tank 203 L (53.4 US Gal.)
- ◆ Grey Water 194 L (51 US Gal.)
- ◆ Dual Propane Bottles 13.6 Kg ea. (30 lbs. ea.)
- ◆ Electric "Sta-Tite" Slide Outs W/Manual Override
- ◆ Auto Change Over Propane Reg.
- * Cable Ext. Terminal Valves
- ◆ Solar Panel Pre-wire
- ◆ Aluminum Wheels (4)

OPTIONS AVAILABLE

- ◆ Bedroom Slide Out - page 20
- ◆ Awning Upgrade 9000 Series
- ◆ Awning Upgrade 9100 Series Elec.
- ◆ Baseboard Heater LR & BR
- ◆ "Weather Pro" Electric Awning
- ◆ Dinette ILO F/S Table*
- ◆ Generator Compartment (25x33)*
- ◆ Round Dining Table
- ◆ Electric Rear Stabilizer Jacks*
- ◆ Electric Fireplace
- ◆ Coffee Table
- ◆ Recliner w/Flip Up Chair Shelf ILO Computer Desk*
- ◆ 2 Recliners ILO Hide-a-Bed
- ◆ Twin Beds* (N/A w/Br. Slide)
- ◆ Solar Panel* 120W
- ◆ Garden Shower ILO Bathtub*
- ◆ Water Filter
- ◆ "Norcold" 10 cu. ft. Fridge
- ◆ Hide-A-Bed w/Air Mattress
- ◆ Solid Surface Kitchen & Vanity Counters*
- ◆ Drawers in Entertainment Center ILO Fireplace
- ◆ 12V Stereo/DVD in Bedroom (Bed slides only)

* Before Production Only.

FIFTH WHEEL MODEL 29.5 RLS



Warranted for Full Time Living!
"100" Wide Body"

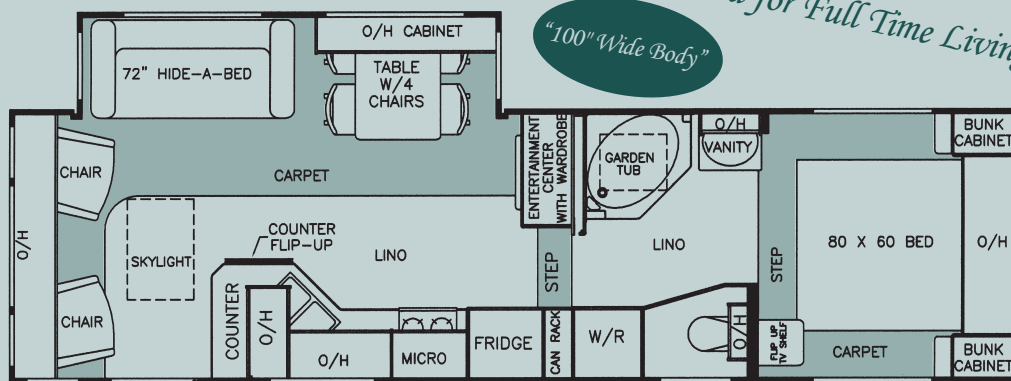

Optional bedroom slide
page 20

Guaranteed to -30° C

POLAR-PAK
THE SUB-ZERO SOLUTION

STANDARD FEATURES

BATH/BEDROOM

- ◆ "Taymor" Vanity Faucet
- ◆ Power Vent in Bath
- ◆ CO Detector
- ◆ Residential Fiberglass Garden Tub W/Glass Door
- * Residential Skylight with Moisture Control
- ◆ Escape Window
- * "Fantastic" Vent Fan
- ◆ 6'0" Bedroom Height
- ◆ "Eurotop" Mattress
- ◆ Co-ord. Bedspread & Pillows
- ◆ Day/Nite Fabric Blinds
- ◆ TV Shelf in Bedroom
- ◆ Porcelain Toilet W/Pedal Flush
- ◆ Tooth Brush Holder, Soap Dish

KITCHEN

- ◆ Knife Block
- ◆ Range Cover
- ◆ Jensen Range Hood W/Systems Monitor
- ◆ "Atwood" High Output Range
- ◆ "Norcold" 8 cu. ft. Fridge W/Aluminum Laminate Door Panels
- ◆ Hardwood Table w/ Leaf & 4 Chairs
- ◆ Central Vacuum w/Sweep
- ◆ Polymer Kitchen Sink W/"Taymor" Faucet W/Spray
- ◆ Kitchen Drawers-Birch Plywood-Nylon Rollers & Steel Guides
- ◆ Raised Beech Cabinet Doors
- ◆ Fluorescent Light in Ceiling
- ◆ Double Can Storage Rack
- * Residential Skylight with Moisture Control & Blind

LIVING ROOM

- ◆ Cable/Telephone Hook Up
- ◆ Fire Extinguisher & Smoke Detector
- ◆ Residential Home Theater CD & DVD Stereo System 120 V.
- ◆ 120 V. Receptacles in Slide Out
- ◆ 2 Stressless Recliners w/ Ottoman
- ◆ Day/Nite Fabric Blinds
- ◆ Raised Beech Cabinet Doors
- ◆ Beech End Table
- ◆ Fluorescent Light in Ceiling
- ◆ 26" LCD TV w/swivel arm
- ◆ Beech & Fabric Fascia - L.R. Slide
- * "Fantastic Rain Sensor" Vent Fan
- ◆ 72" Hideabed w/ Footrest

EXCELLA STANDARD FEATURES

- ◆ Central Roof AC-13.5 BTU
- ◆ 16' Awning A+E
- ◆ Microwave Oven
- ◆ TV Antenna
- ◆ Recessed Quad Battery Compartment
- ◆ Black Tank Flush
- ◆ Hide A Bed - 72" w/ Footrest
- ◆ Propane Leak Detector
- ◆ TV Shelf/BR

EXTERIOR

- * Stormtite Windows Thermopane Glass
- ◆ Fiberglass Skirts/Fenders
- * Compartment Doors w/1" Insulation
- ◆ Roof Rack & Ladder
- ◆ Shock Absorbers (4)
- ◆ 2 Rear Stab. Jacks
- ◆ Elec. Front Jacks W/Quick Release
- ◆ MorRyde Pin Box System
- ◆ Aerodynamic Fuel Saver Front Fiberglass Cap
- ◆ Entrance Step Boot Shelf
- ◆ Exterior Shower in Compartment
- ◆ "Dicor" Vinyl Roof
- ◆ Hitch Hook Up Light
- ◆ BBQ Quick Connect
- ◆ Awning on Slide Out
- ◆ Seamless Polypropylene Undersiding
- * 2" Vac-U-Lam Sidewalls W/DbL. Plywood
- ◆ Basement Storage-Lighted
- ◆ Dexter Nev-R-Lube Axles W/12" Brakes
- ◆ 16" Radials w/Spare
- * 3/8" Plywood Roof Deck
- ◆ 8' Sewer Hose Compartment
- ◆ Automotive Undercoat
- ◆ Curbside Scare Light
- ◆ Adjustable Height Spring Hangers

MECHANICAL/CONSTRUCTION

- * Crowned Truss Roof R-11 Ins.
- * Attic Ventilation System
- * Excalibur 8535 IV Furnace
- * Heated & Encl. Holding & Fresh Water Tanks
- ◆ 12V Disconnect
- ◆ 45 Amp Power Converter W/Batt. Charger
- ◆ 50 Amp Service with Detachable Cord
- ◆ Hot Water Bypass Valves
- ◆ XT16 Gas/Elec. Water Heater W/DSI-36 L (10 US Gal.)
- ◆ Whisper King Water Pump
- ◆ Fresh Water 232 L (61 US Gal.)
- ◆ Toilet Holding Tank 203 L (53.4 US Gal.)
- * Cable Ext. - Termination Valves
- ◆ Grey Water 194 L (51 US Gal.)
- ◆ Dual Propane Bottles 13.6 Kg ea. (30 lbs. ea.)
- ◆ Electric "Sta-Tite" Slide Out W/Manual Override-"Flush Floor"
- ◆ Auto Change Over Propane Reg.
- ◆ Slide Out Propane Tray
- ◆ Solar Panel Pre-wire
- ◆ Aluminum Wheels (4)
- ◆ Antifreeze Pick Up System
- * Insulated Slide Out Floors 2 3/8"

OPTIONS AVAILABLE

- ◆ "Weather Pro" Electric Awning*
- ◆ Awning Upgrade 9000 Series
- ◆ Awning Upgrade 9100 Electric
- ◆ Bedroom Slide-Out - page 20
- ◆ Baseboard Heaters LR & BR
- ◆ Dinette ILO F/S Table*
- ◆ Exterior Shower*
- ◆ Round Dining Table
- ◆ 28" Recliners Fabric or Leather Exch.
- ◆ Electric Rear Stabilizer Jacks*
- ◆ Electric Fireplace (in lieu of Wardrobe)
- ◆ Twin Beds* (N/A w/BR Slide)
- ◆ Solar Panel* 120W
- ◆ Garden Shower ILO Bathtub*
- ◆ Water Filter
- ◆ "Norcold" 10 cu. ft. Fridge
- ◆ Generator Compartment* (25x33)
- ◆ Solid Surface Kitchen & Vanity Counters*
- ◆ Hide-A-Bed w/Air Mattress
- ◆ 12V Stereo/DVD in Bedroom Bed Slides Only

* Before Production Only.

Specifications are subject to change without notice or obligation.



FIFTH WHEEL MODEL 29 RKDS

SPECIFICATIONS

GVWR

5898 Kg/13,000 lbs.

Dry Weight

4812 Kg/10,605 lbs.

Net Carrying Capacity

1087 Kg/2,395 lbs.

Axle Capacity

5430 Kg/12,000 lbs.

Hitch Weight

1069 Kg/2,355 lbs.

Height*

3.8 M/12'6"

Width

2.5 M/8'4"

Length

9.2 M/30'2"

Exterior Storage

97 cu. ft.

* Approximate height to top of air conditioner

Warranted for Full Time Living!

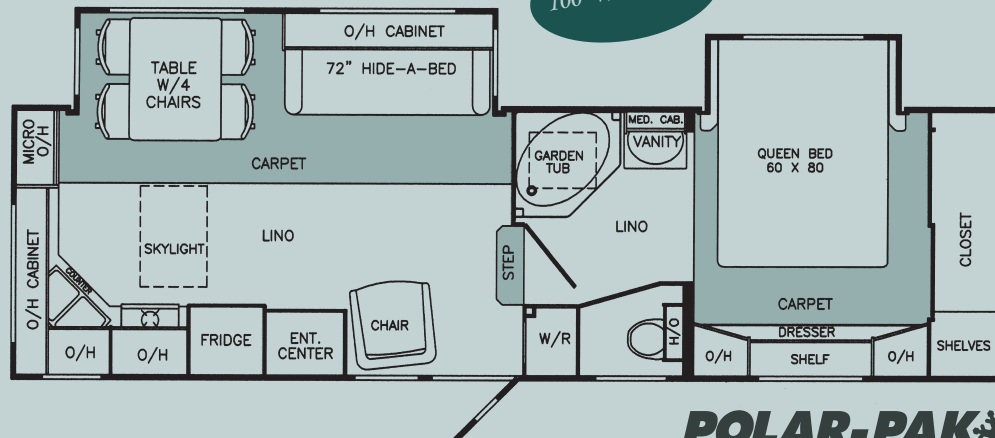

POLAR-PAK
THE SUB-ZERO SOLUTION

STANDARD FEATURES

BATH/BEDROOM

- ◆ "Taymor" Vanity Faucet
- ◆ Power Vent in Bath
- ◆ CO Detector
- ◆ Residential Fiberglass Tub W/Glass Door
- ◆ Porcelain Toilet W/Pedal Flush
- ◆ Escape Window
- ◆ 6'0" Bedroom Height
- * "Fantastic" Vent Fan
- ◆ "Eurotop" Mattress
- ◆ Co-ord. Bedspread & Pillows
- ◆ Color Co-ord. Valances
- ◆ Day/Nite Fabric Blinds
- ◆ TV Pre-Wire in Bedroom
- ◆ "Sta-Tite" Slide W/Manual Override
- ◆ Tooth Brush Holder, Soap Dish
- * Residential Skylight with Moisture Control over Tub

KITCHEN

- ◆ Knife Block & Range Cover
- ◆ Jensen Range Hood W/Systems Monitor
- ◆ "Atwood" High Output Range
- ◆ Norcold 8 cu. ft. Fridge W/Aluminum Laminate Door Panels
- ◆ Polymer Kitchen Sink W/"Taymor" Faucet W/Spray
- * "Fantastic Rain Sensor" Vent Fan
- ◆ Kitchen Drawers-Birch Plywood-Nylon Rollers & Steel Guides
- ◆ Hardwood Table w/ Leaf & 4 Chairs
- ◆ Fluorescent Light in Ceiling
- ◆ Double Can Storage Rack
- ◆ "Shaker" Beech Cabinet Doors
- ◆ Cental Vacuum w/Sweep

LIVING ROOM

- ◆ Cable/Telephone Hook Up
- ◆ Smoke Detector
- ◆ Fire Extinguisher
- ◆ Stressless Recliner w/ Ottoman
- ◆ Beech & Fascia Fascia - L.R. Slide
- ◆ Co-ord. "C" Valances
- ◆ Day/Nite Fabric Blinds
- ◆ Fluorescent Light in Ceiling
- ◆ Residential Home Theater Stereo System w/CD & DVD Player - 120 V
- ◆ 19" LCD HD TV

EXCELLA STANDARD FEATURES

- * Central Roof AC-15 BTU W/Heat Pump
- ◆ 18' Awning A+E
- ◆ Microwave Oven
- ◆ TV Antenna
- ◆ Battery Tray Quad
- ◆ Black Tank Flush
- ◆ Fold Away Assist Rail
- ◆ Hide A Bed - 72" w/ Footrest
- ◆ Propane Leak Detector
- * Residential Skylight/Kitchen with Moisture Control & Blind

EXTERIOR

- * Stormite Windows-Thermopane Glass
- ◆ Aerodynamic Fuel Saver Front Fiberglass Cap
- ◆ Fiberglass Skirts/Fenders
- * Compartment Doors w/1" Insulation
- ◆ Entrance Step Boot Shelf
- ◆ Exterior Shower in Compartment
- ◆ Roof Rack & Ladder
- ◆ BBQ Quick Connect
- ◆ Shock Absorbers (4)
- ◆ 2 Rear Stab. Jacks
- ◆ Elec. Front Jacks W/Quick Release Pins
- ◆ Awnings on LR & BR Slides
- ◆ MorRyde Pin Box System
- ◆ "Dicor" Vinyl Roof
- ◆ Curbside Scare Light
- ◆ Seamless Polypropylene Undersiding
- * 2" Vac-U-Lam Sidewalls W/Dbl. Plywood
- ◆ Full Width Storage-Lined & Lighted
- ◆ Dexter Nev-R-Lube Axles W/12" Brakes
- ◆ 16" Radials w/Spare
- ◆ 3/8" Plywood Roof Deck
- ◆ 8' Sewer Hose Compartment
- ◆ Automotive Undercoat
- ◆ Adjustable Height Spring Hangers

MECHANICAL/CONSTRUCTION

- * Crowned Truss Roof R-11 Insulation
- * Attic Ventilation System
- * Excalibur 8535 IV Furnace
- * Heated & Encl. Holding & Fresh Water Tanks
- ◆ 12V Disconnect
- ◆ 45 Amp Power Converter W/Batt. Charger
- ◆ 50 Amp Service with Detachable Cord
- ◆ Hot Water Bypass Valves
- ◆ XT16 Gas/Elec. Water Heater W/DSI-36 L (10 US Gal.)
- ◆ Whisper King Water Pump
- ◆ Fresh Water 241 L (64 US Gal.)
- * Cable Ext. - Termination Valves
- ◆ Toilet Holding Tank 203 L (53.4 US Gal.)
- ◆ Grey Water 194 L (51 US Gal.)
- ◆ Dual Propane Bottles 13.6 Kg ea. (30 lbs. ea.)
- ◆ Electric "Sta-Tite" Slide Outs W/Manual Override-"Flush Floor"
- ◆ Auto Change Over Propane Reg.
- ◆ Solar Panel & Pre-wire
- ◆ Aluminum Wheels (4)
- ◆ Antifreeze Pick Up System
- * Insulated Slide Out Floors 2 3/8"

OPTIONS AVAILABLE

- ◆ "Weather Pro" Electric Awning*
- ◆ Awning Upgrade 9000 Series
- ◆ Awning Upgrade 9100 Elec.
- ◆ Computer Shelf-Lift Up
- ◆ Baseboard Heaters LR & BR
- ◆ Dinette ILO F/S Table*
- ◆ Beech Coffee Table
- ◆ Solid Surface Kitchen & Vanity Counter*
- ◆ Bedroom Pocket Door
- ◆ Round Dining Table
- ◆ 12V Stereo/DVD In Bedroom
- ◆ Solar Panel* 120W
- ◆ Garden Shower ILO Bathtub*
- ◆ Water Filter
- ◆ "Norcold" 10 cu. ft. Fridge
- ◆ Generator Compartment* (25x33)
- ◆ Electric Rear Stabilizer Jacks*
- ◆ Hide-A-Bed w/Air Mattress
- ◆ 28" Recliner Fabric or Leather Exch.

* Before Production Only.

FIFTH WHEEL MODEL 30RLDS



Warranted for Full Time Living!

"This is an unbelievable unit! Due to relentless rain on our annual trek, the entire group of 10 was able to converge for meals and entertainment. The best unit in entire campsite."

Dan Olsen, Edmonton, AB

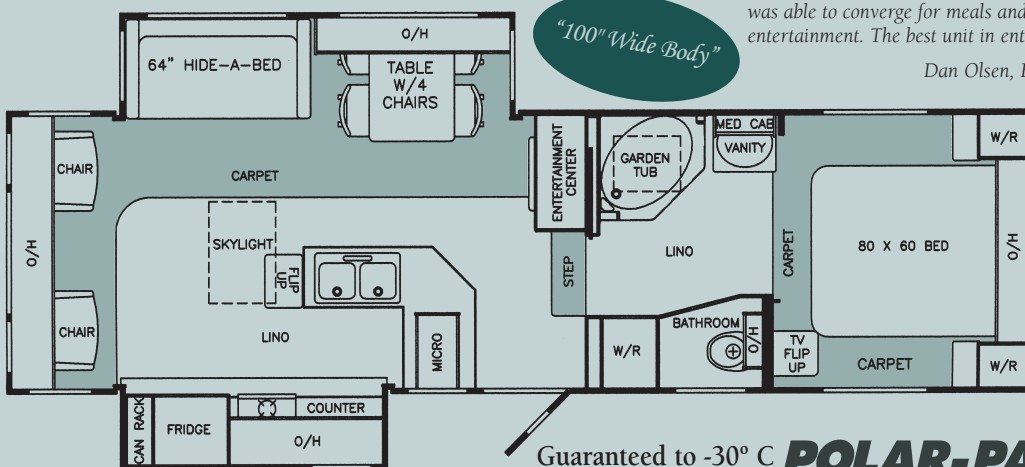

Guaranteed to -30° C **POLAR-PAK**
THE SUB-ZERO SOLUTION

STANDARD FEATURES

BATH/BEDROOM

- ◆ "Taymor" Vanity Faucet
- ◆ Power Vent in Bath
- ◆ CO Detector
- ◆ Residential Fiberglass Shower W/Glass Door
- ◆ Porcelain Toilet W/Pedal Flush
- ◆ Escape Window
- * "Fantastic" Vent Fan
- ◆ 6'0" Bedroom Height
- ◆ "Eurotop" Mattress
- ◆ Co-ord. Bedspread & Pillows
- ◆ Day/Nite Fabric Blinds
- * Residential Skylight with Moisture Control over Tub
- ◆ TV Pre-Wire in Bedroom W/TV Shelf
- ◆ Tooth Brush Holder, Soap Dish

KITCHEN

- ◆ Knife Block & Range Cover
- ◆ Jensen Range Hood W/Systems Monitor
- ◆ "Atwood" High Output Range
- ◆ "Norcold" 8 cu. ft. Fridge W/Aluminum Laminate Door Panels
- ◆ Hardwood Table w/ Leaf & 4 Chairs
- ◆ Polymer Kitchen Sink W/"Taymor" Faucet W/Spray
- ◆ Kitchen Drawers-Birch
- Plywood-Nylon Rollers & Steel Guides
- ◆ Raised Beech Cabinet Doors
- ◆ Fluorescent Light in Ceiling
- ◆ Beech & Fabric Fascia - Kitchen Slide
- * Residential Skylight with Moisture Control & Blind
- ◆ Central Vacuum w/Sweep

LIVING ROOM

- ◆ Cable/Telephone Hook Up
- ◆ Smoke Detector
- ◆ Fire Extinguisher
- ◆ 2 -Stressless Recliner w/ Ottoman
- ◆ Beech End Table
- ◆ Day/Nite Fabric Blinds
- ◆ Electric "Sta-Tite" Slide W/Manual Override-"Flush Floor"
- ◆ Fluorescent Light in Ceiling
- ◆ 26" LCD TV w/ Swivel Arm
- ◆ Beech & Fabric Fascia - L.R. Slide
- * "Fantastic Rain Sensor" Vent Fan

EXCELLA STANDARD FEATURES

- ◆ Central Roof AC-13.5 BTU
- ◆ Aluminum Wheels (4)
- ◆ 16" Awning
- ◆ Microwave Oven
- ◆ TV Antenna
- ◆ Recessed Quad Battery Compartment
- ◆ Black Tank Flush
- ◆ Fold Away Assist Rail
- ◆ Hide A Bed - 64" w/ Footrest
- ◆ Propane Leak Detector
- ◆ Residential Home Theater Stereo System w/CD & DVD Player - 120V

EXTERIOR

- * Stormite Windows--Thermopane Glass
- ◆ Aerodynamic Fuel Saver Front Fiberglass Cap
- ◆ Fiberglass Skirts/Fenders
- ◆ Entrance Step Boot Shelf
- * Compartment Doors w/1" Insulation
- ◆ Roof Rack & Ladder
- ◆ Shock Absorbers (4)
- ◆ 2 Rear Stab. Jacks
- ◆ "Dicor" Vinyl Roof
- ◆ Elec. Front Jacks W/Quick Release Pins
- ◆ MorRyde Pin Box System
- ◆ Hitch Hook Up Light
- ◆ BBQ Quick Connect
- ◆ Seamless Polypropylene Undersiding
- * 2" Vac-U-Lam Sidewalls W/Dbl. Plywood
- * 3/8" Plywood Roof Deck
- ◆ Locking Water Fill & Power Cord Compartment
- ◆ Exterior Shower in Compartment
- ◆ Dexter Nev-R-Lube Axles W/12" Brakes
- ◆ 16" Radials w/Spare
- ◆ 8' Sewer Hose Compartment
- ◆ Automotive Undercoat
- ◆ Curbside Scare Light
- ◆ Adjustable Height Spring Hangers
- ◆ Awnings on LR & Kitchen Slides

MECHANICAL/CONSTRUCTION

- * Crowned Truss Roof R-11 Insulation
- * Attic Ventilation System
- * Excalibur 8535 IV Furnace
- * Heated & Encl. Holding & Fresh Water Tanks
- ◆ 12V Disconnect
- ◆ 45 Amp Power Converter W/Batt. Charger
- ◆ 50 Amp Service with Detachable Cord
- ◆ Hot Water Bypass Valves
- ◆ XT16 Gas/Elec. Water Heater W/DSI-36 L (10 US Gal.)
- ◆ Whisper King Water Pump
- * Cable Ext. - Termination Valves
- ◆ Toilet Holding Tank 203 L (53.4 US Gal.)
- ◆ Fresh Water 232 L (61 US Gal.)
- ◆ Grey Water 194 L (51 US Gal.)
- ◆ Dual Propane Bottles 13.6 Kg ea. (30 lbs. ea.)
- ◆ Auto Change Propane Regulator
- ◆ Slide Out Propane Tray
- ◆ Solar Panel Pre-wire
- ◆ Antifreeze Pick Up System
- * Insulated Slide Out Floors 2 3/8"

OPTIONS AVAILABLE

- ◆ Awning Upgrade 9000 Series
- ◆ Baseboard Heaters LR & BR
- ◆ Beech Coffee Table
- ◆ Dinette ILO F/S Table*
- ◆ Bedroom Slide Out - page 20
- ◆ Solid Surface Kitchen & Vanity Counter*
- ◆ Round Dining Table
- ◆ Solar Panel* 120W
- ◆ Water Filter
- ◆ Shower ILO Garden Tub
- ◆ "Norcold" 10 cu. ft. Fridge
- ◆ 12V Stereo/DVD in Bedroom (Bedside Only)
- ◆ Generator Compartment* (25x33)
- ◆ Electric Fireplace in Ent. Center*
- ◆ Electric Rear Stabilizer Jacks
- ◆ Hide-A-Bed w/Air Mattress
- ◆ Recliner - 28" or 30" Exch. (Leather or Fabric)

* Before Production Only.



FIFTH WHEEL MODEL 31CKDS XL

SPECIFICATIONS

GVWR

6171 Kg/13,600 lbs.

Dry Weight

5113 Kg/11,270 lbs.

Net Carrying Capacity

1,057 Kg/2,330 lbs.

Axle Capacity

5430 Kg/12,000 lbs.

Hitch Weight

978 Kg/2,155 lbs.

Height*

4.0 M/13'1"

Width

2.5 M/8'4"

Length

9.9 M/32'4"

Exterior Storage

101 cu. ft.

* Approximate height to top of air conditioner

Warranted for Full Time Living!

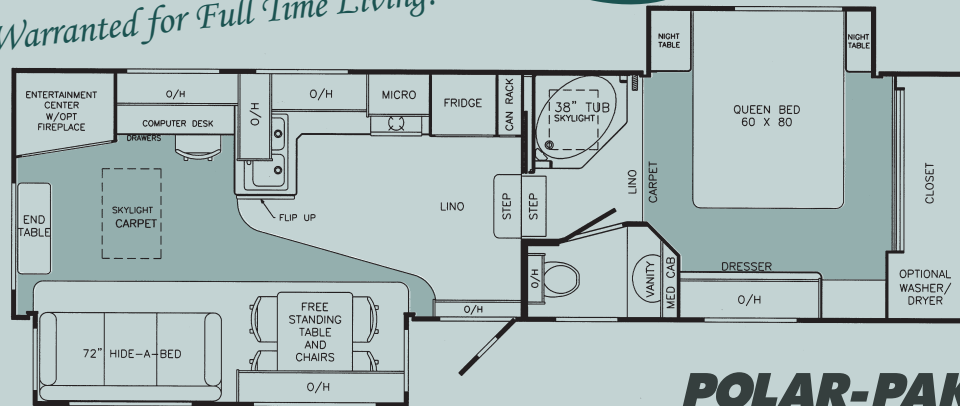

POLAR-PAK
THE SUB-ZERO SOLUTION

Guaranteed to -30° C

STANDARD FEATURES

BATH/BEDROOM

- ◆ "Taymor" Vanity Faucet
- ◆ Power Vent in Toilet Compartment
- ◆ CO Detector
- ◆ Residential Fiberglass Garden Tub W/Glass Door
- ◆ Porcelain Toilet W/Pedal Flush
- ◆ Escape Window
- * ◆ "Fantastic" Vent Fan
- ◆ Flat Floor Bath & Bedroom
- ◆ 6'6" Bedroom Height
- ◆ "Eurotop" Mattress
- ◆ Co-ord. Bedspread & Pillows
- ◆ Day/Nite Fabric Blinds
- ◆ "Sta-Tite" BR Slide W/Manual Override
- ◆ TV Pre-Wire in Bedroom
- ◆ Tooth Brush Holder, Soap Dish
- ◆ Clothes Hamper in Bedroom

KITCHEN

- ◆ Knife Block & Range Cover
- ◆ Jensen Range Hood W/Systems Monitor
- ◆ "Atwood" High Output Range
- ◆ Norcold 8 cu. ft. Fridge W/Aluminum Laminate Door Panels
- ◆ 7'7" Interior Height
- ◆ Fluorescent Light in Ceiling
- ◆ Hardwood Table w/ Leaf & 4 Chairs
- ◆ Polymer Kitchen Sink W/"Taymor" Faucet W/Spray
- ◆ Kitchen Drawers-Birch Plywood-Nylon Rollers & Steel Guides
- ◆ Raised Beech Cabinet Doors
- ◆ Central Vacuum w/Sweep

LIVING ROOM

- ◆ Cable/Telephone Hook Up
- ◆ Fire Extinguisher & Smoke Det.
- ◆ Co-ord. "C" Valances
- ◆ Day/Nite Fabric Blinds
- ◆ Electric "Sta-Tite" Slide W/Manual Override-"Flush Floor"
- ◆ Fluorescent Light in Ceiling
- ◆ Beech End Table 36x13
- ◆ 26" LCD HDTV
- ◆ Beech & Fabric Fascia - L.R. Slide
- * ◆ "Fantastic Rain Sensor" Vent Fan
- ◆ Computer Desk w/Chair
- ◆ 6'2" Height in Slide Out

EXCELLA STANDARD FEATURES

- * ◆ Central Roof AC-15 BTU W/Heat Pump
- ◆ 15' Awning
- ◆ Microwave Oven
- ◆ TV Antenna
- ◆ Black Tank Flush
- ◆ Fold Away Assist Rail
- ◆ Hide A Bed - 72" w/ Footrest
- ◆ Propane Leak Detector
- * ◆ Residential Skylights/Living Room & Kitchen w/Moisture Control
- * ◆ Residential Skylight/Tub w/Moisture Control
- ◆ Residential Home Theater Stereo System w/CD & DVD Player - 120V

EXTERIOR

- * ◆ Stormite Windows-Thermopane Glass
- ◆ Aerodynamic Fuel Saver Front Fiberglass Cap
- ◆ Fiberglass Skirts/Fenders
- ◆ Entrance Step Boot Shelf
- * ◆ Compartment Doors w/1" Insulation
- ◆ Exterior Shower in Compartment
- ◆ Roof Rack & Ladder
- ◆ Shock Absorbers (4)
- ◆ 2 Rear Stab. Jacks
- ◆ Rubber Membrane Roof
- ◆ Elec. Front Jacks W/Quick Release Pins
- ◆ MorRyde Pin Box System
- ◆ Hitch Hook Up Light
- ◆ BBQ Quick Connect
- ◆ Seamless Polypropylene Undersiding
- * ◆ 2" Vac-U-Lam Sidewalls W/Dbf. Plywood
- * ◆ 3/8" Plywood Roof Deck
- ◆ Locking Water Fill & Power Cord Compartment
- ◆ Dexter Nev-R-Lube Axles W/12" Brakes
- ◆ 16" Radials w/Spare
- ◆ 8' Sewer Hose Compartment
- ◆ Automotive Undercoat
- ◆ Curbside Scare Light
- ◆ Adjustable Height Spring Hangers
- ◆ Awnings on Slide Outs

MECHANICAL/CONSTRUCTION

- * ◆ Crowned Truss Roof R-11 Insulation
- * ◆ Attic Ventilation System
- * ◆ Heated & Encl. Holding & Fresh Water Tanks
- ◆ 12V Disconnect
- ◆ Recessed Quad Battery Compartment
- ◆ 45 Amp Power Converter W/Batt. Charger
- ◆ 50 Amp Service with Detachable Cord
- ◆ Hot Water Bypass Valves
- ◆ Pre-Plumb for Washer & Dryer
- ◆ XT16 Gas/Elec. Water Heater
- W/DSI-36 L (10 US Gal.)
- ◆ Whisper King Water Pump
- ◆ Aluminum Wheels (4)
- ◆ Cable Ext. - Termination Valves
- ◆ Toilet Holding Tank 203 L (53.4 US Gal.)
- ◆ Fresh Water 232 L (61 US Gal.)
- ◆ Grey Water 194 L (51 US Gal.)
- ◆ Dual Propane Bottles 13.6 Kg ea. (30 lbs. ea.)
- ◆ Auto Change Propane Regulator
- ◆ Solar Panel Pre-wire
- ◆ Antifreeze Pick Up System
- * ◆ Insulated Slide Out Floors 2 3/8"
- ◆ Excalibur III 8940 Furnace

OPTIONS AVAILABLE

- ◆ "Weather Pro" Electric Awning*
- ◆ Awning Upgrade 9000 Series
- ◆ Awning Upgrade 9100 Elec.
- ◆ Baseboard Heaters LR & BR
- ◆ Dinette ILO F/S Table*
- ◆ Electric Fireplace
- ◆ Solid Surface Kitchen & Computer Counters*
- ◆ "Norcold" 10 cu. ft. Fridge
- ◆ King Bed 72x80*
- ◆ Hideabed - Leather
- ◆ Hide-A-Bed w/Air Mattress
- ◆ Drawers in Entertainment Center
- ◆ Round Dining Table
- ◆ Washer & Dryer 1 piece Splendide
- ◆ Solar Panel* 120W
- ◆ Water Filter
- ◆ 19" LCD TV in Bedroom
- ◆ Recliner w/flip up shelf ILO Computer Desk & Chair*
- ◆ Generator Compartment* (25x33)
- ◆ Electric Rear Stabilizer Jacks*
- ◆ 12V Stereo/DVD in Bedroom*

* Before Production Only.

FIFTH WHEEL MODEL 31.5RLS



Warranted for Full Time Living!

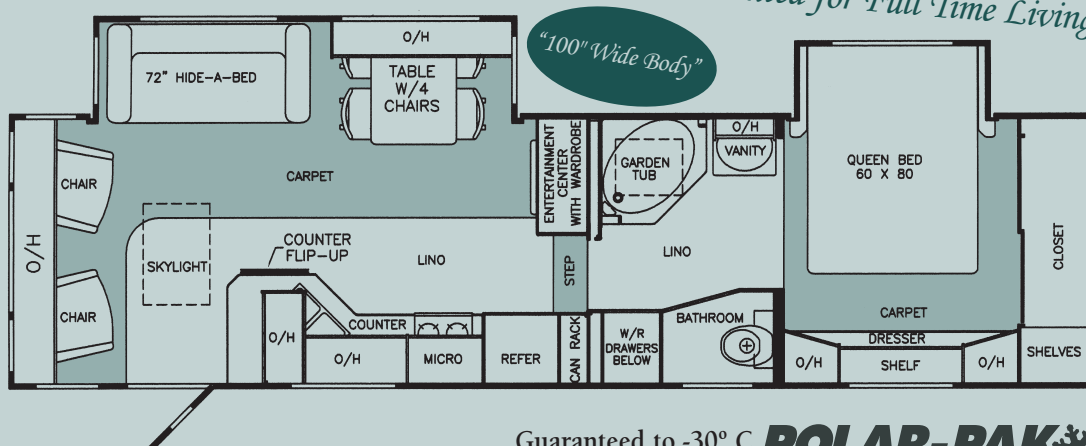

Guaranteed to -30° C **POLAR-PAK**
THE SUB-ZERO SOLUTION

SPECIFICATIONS

GVWR	6171 Kg/13,600 lbs.
Dry Weight	5225 Kg/11,515 lbs.
Net Carrying Capacity	946 Kg/2,085 lbs.
Axle Capacity	5430 Kg/12,000 lbs.
Hitch Weight	1125 Kg/2,480 lbs.
Height*	3.8 M/12'4"
Width	2.5 M/8'4"
Length	10.0 M/32'11"
Exterior Storage	107 cu. ft.

* Approximate height to top of air conditioner

STANDARD FEATURES

BATH/BEDROOM

- ◆ "Taymor" Vanity Faucet
- ◆ Power Vent in Bath
- ◆ CO Detector
- ◆ Residential Fiberglass Shower
- ◆ W/Glass Door
- ◆ Porcelain Toilet W/Pedal Flush
- ◆ Escape Window
- * "Fantastic" Vent Fan
- ◆ 6'0" Bedroom Height
- ◆ "Eurotop" Mattress
- ◆ Co-ord. Bedspread & Pillows
- ◆ Day/Nite Fabric Blinds
- ◆ "Sta-Tite" BR Slide W/Manual Override
- ◆ TV Pre-Wire in Bedroom
- ◆ Tooth Brush Holder, Soap Dish
- ◆ Clothes Hamper in Bedroom

KITCHEN

- ◆ Knife Block & Range Cover
- ◆ Jensen Range Hood
- ◆ W/Systems Monitor
- ◆ "Atwood" High Output Range
- ◆ Norcold 8 cu. ft. Fridge
- ◆ W/Aluminum Laminate Door Panels
- ◆ Fluorescent Light in Ceiling
- ◆ Hardwood Table w/ Leaf & 4 Chairs
- ◆ Polymer Kitchen Sink
- ◆ W/"Taymor" Faucet W/Spray
- ◆ Kitchen Drawers-Birch Plywood-Nylon Rollers & Steel Guides
- ◆ Raised Beech Cabinet Doors
- ◆ Central Vacuum w/Sweep

LIVING ROOM

- ◆ Cable/Telephone Hook Up
- ◆ Fire Extinguisher & Smoke Detector
- ◆ Beech End Table
- ◆ 2 - Stressless Recliners w/ Ottoman
- ◆ Co-ord. "C" Valances
- ◆ Day/Nite Fabric Blinds
- ◆ Electric "Sta-Tite" Slide W/Manual Override-"Flush Floor"
- ◆ Fluorescent Light in Ceiling
- ◆ 26" LCD TV on Swivel Arm
- ◆ Beech & Fabric Fascia - L.R. Slide
- * "Fantastic Rain Sensor" Vent Fan

EXCELLA STANDARD FEATURES

- * Central Roof AC-15 BTU W/Heat Pump
- ◆ 18' Awning
- ◆ Microwave Oven
- ◆ TV Antenna
- ◆ Black Tank Flush
- ◆ Fold Away Assist Rail
- ◆ Hide A Bed "72" w/ Footrest
- ◆ Propane Leak Detector
- * Residential Skylight/Living Room with Moisture Control & Blind
- * Residential Skylight/Tub with Moisture Control
- ◆ Residential Home Theater Stereo System w/CD & DVD Player - 120V

EXTERIOR

- * Stormtite Windows-Thermopane Glass
- ◆ Aerodynamic Fuel Saver Front Fiberglass Cap
- ◆ Fiberglass Skirts/Fenders
- ◆ Entrance Step Boot Shelf
- * Compartment Doors w/1" Insulation
- ◆ Exterior Shower in Compartment
- ◆ Roof Rack & Ladder
- ◆ Shock Absorbers (4)
- ◆ 2 Rear Stab. Jacks
- ◆ "Dicor Vinyl" Roof
- ◆ Elec. Front Jacks W/Quick Release Pins
- ◆ MorRyde Pin Box System
- ◆ Hitch Hook Up Light
- ◆ BBQ Quick Connect
- ◆ Seamless Polypropylene Undersiding
- * 2" Vac-U-Lam Sidewalls W/Dbl. Plywood
- * 3/8" Plywood Roof Deck
- ◆ Locking Water Fill & Power Cord Compartment
- ◆ Dexter Nev-R-Lube Axles W/12" Brakes
- ◆ 16" Radials w/Spare
- ◆ 8' Sewer Hose Compartment
- ◆ Automotive Undercoat
- ◆ Curbside Scare Light
- ◆ Adjustable Height Spring Hangers
- ◆ Awnings or Slide Outs

MECHANICAL/CONSTRUCTION

- * Crowned Truss Roof R-11 Insulation
- * Attic Ventilation System
- * Excalibur III 8940 Furnace
- * Heated & Encl. Holding & Fresh Water Tanks
- ◆ 12V Disconnect
- ◆ Recessed Quad Battery Compartment
- ◆ 45 Amp Power Converter W/Batt. Charger
- ◆ 50 Amp Service with Detachable Cord
- ◆ Hot Water Bypass Valves
- ◆ XT16 Gas/Elec. Water Heater W/DSI-36 L (10 US Gal.)
- ◆ Whisper King Water Pump
- ◆ Aluminum Wheels (4)
- * Cable Ext. - Termination Valves
- ◆ Toilet Holding Tank 203 L (53.4 US Gal.)
- ◆ Fresh Water 232 L (61 US Gal.)
- ◆ Grey Water 194 L (51 US Gal.)
- ◆ Dual Propane Bottles 13.6 Kg ea. (30 lbs. ea.)
- ◆ Auto Change Propane Regulator
- ◆ Pre-Plumbed for Washer/Dryer
- ◆ Slide Out Propane Tray
- ◆ Solar Panel Pre-wire
- ◆ Antifreeze Pick Up System
- * Insulated Slide Out Floors 2³/8"

OPTIONS AVAILABLE

- ❖ "Weather Pro" Electric Awning*
- ❖ Awning Upgrade 9000 Series
- ❖ Awning Upgrade 9100 Elec.
- ❖ Beech Coffee Table
- ❖ 19" LCD TV in Bedroom
- ❖ Dinette ILO F/S Table*
- ❖ Washer/Dryer Cabinet
- ❖ Washer/Dryer-1 pc. Splendide*
- ❖ Solid Surface Kitchen & Vanity Counter*
- ❖ "Norcold" 10 cu. ft. Fridge
- ❖ Baseboard Heaters LR & BR
- ❖ Round Dining Table
- ❖ "Leather or Fabric" Recliners 30" Exch.
- ❖ Solar Panel* 120W
- ❖ Water Filter
- ❖ Bedroom Pocket Door*
- ❖ Generator Compartment* (25x33)
- ❖ Electric Rear Stabilizer Jacks*
- ❖ Electric Fireplace in Ent. Center*
- ❖ Hide-A-Bed w/Air Mattress
- ❖ Hide-A-Bed Leather
- ❖ 12V Stereo/DVD in Bedroom
- * Before Production Only.

Specifications are subject to change without notice or obligation.



FIFTH WHEEL MODEL 32.5TKS

Warranted for Full Time Living!

SPECIFICATIONS

GVWR

6715 Kg/14,800 lbs.

Dry Weight

5730 Kg/12,630 lbs.

Net Carrying Capacity

985 Kg/2,170 lbs.

Axle Capacity

6352 Kg/14,000 lbs.

Hitch Weight

1173 Kg/2,585 lbs.

Height*

3.9 M/12'6"

Width

2.5 M/8'4"

Length

10.4 M/34'

Exterior Storage

106 cu. ft.

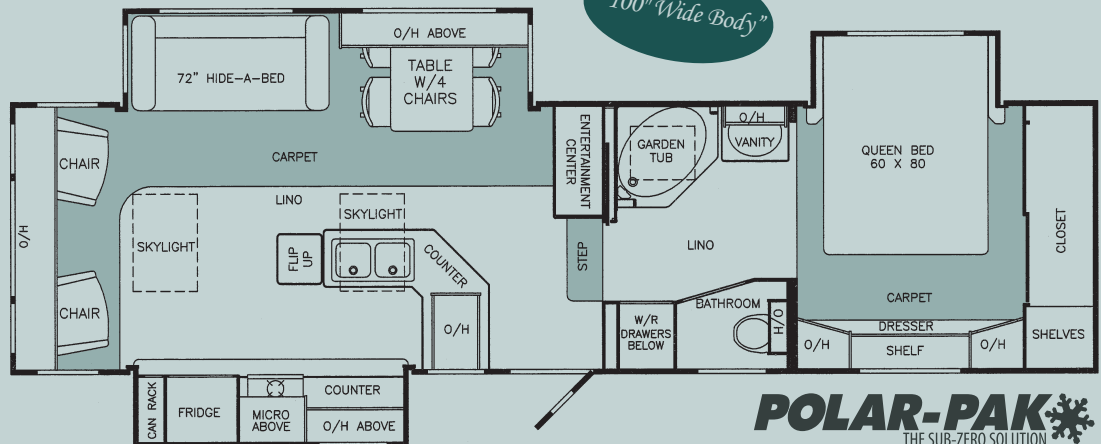

POLAR-PAK
THE SUB-ZERO SOLUTION

Guaranteed to -30° C

* Approximate height to top of air conditioner

STANDARD FEATURES

BATH/BEDROOM

- ◆ Fiberglass Garden Tub Enclosure W/Residential Faucet
- ◆ Porcelain Toilet W/Pedal Flush
- ◆ 6'0" Bedroom Height
- ◆ "Eurotop" Mattress
- ◆ Bedspread & Pillows
- ◆ Day/Nite Fabric Blinds
- ◆ "Fantastic" Vent Fan
- ◆ "Karadon" Solid Surface Vanity
- ◆ "Sta-Tite" Slide W/Manual Override

- ◆ Residential Skylight/Shower with Moisture Control
- ◆ Vanity W/Polymer Sink & "Taymor" Residential Faucet
- ◆ Fluorescent Light in Bath
- ◆ Tooth Brush Holder, Soap Dish
- ◆ CO Detector
- ◆ Clothes Hamper in Bedroom

KITCHEN

- ◆ Large Countertops W/ Stainless Steel Sink & Residential "Taymor" Faucet W/Spray
- ◆ Knife Block
- ◆ "Atwood" High Output Range Top - Recessed
- ◆ "Norcold" 10 cu. ft. Fridge W/Aluminum Laminate Door Panels
- ◆ Kitchen Drawers-Birch Plywood-Nylon Rollers & Steel Guides
- ◆ "Karadon" Solid Surface Countertop
- ◆ Raised Beech Cabinet Doors
- ◆ Hardwood Table w/ Leaf & 4 Chairs

- ◆ Fluorescent Lights in Ceiling
- ◆ "Fantastic Rain Sensor" Vent Fan
- ◆ Residential Skylight with Moisture Control & Blind
- ◆ Propane Leak Detector
- ◆ Clock
- ◆ Convection Microwave W/120V Range Hood
- ◆ Decorative Mirror
- ◆ Double Can Storage Rack (N/A w/ 12' fridge)
- ◆ Beech & Fabric Fascia - Kitchen Slide
- ◆ Central Vacuum w/Sweep

LIVING ROOM

- ◆ 26" LCD TV on Swivel Arm
- ◆ Residential Home Theater Stereo W/CD & DVD Player Surround Sound
- ◆ Cable/Telephone Hook Up
- ◆ Video Control Center
- ◆ Fire Extinguisher & Smoke Detector
- ◆ Day/Nite Fabric Blinds
- ◆ Beech End Table
- ◆ Electric "Sta-Tite" Rack & Pinion

- ◆ Super Slides-"Flush Floor"
- ◆ Fluorescent Lights in Ceiling
- ◆ Hide A Bed - 72" w/ Footrest
- ◆ TV Antenna
- ◆ 2 - Stressless Recliners w/ Ottoman
- ◆ Reading Lights
- ◆ Residential Skylight with Moisture Control & Blind
- ◆ Beech & Fabric Fascia - L.R. Slide

EXTERIOR

- ◆ Entrance Door - 30"
- ◆ Stormite Windows--Thermopane Glass
- ◆ Roof Rack & Ladder
- ◆ Shock Absorbers (4)
- ◆ "Dicor" Vinyl Seamless Roof
- ◆ 2 Rear Stab. Jacks
- ◆ Elec. Front Jacks W/Quick Release Pins
- ◆ MorRyde Pin Box System
- ◆ Aerodynamic Fuel Saver Front Fiberglass Cap
- ◆ Entrance Step Boot Shelf
- ◆ Exterior Shower in Compartment
- ◆ Aluminum Wheels (4)

- ◆ Hitch Hook Up Light
- ◆ BBQ Quick Connect
- ◆ Seamless Polypropylene Undersiding
- ◆ 8' Sewer Hose Compartment
- ◆ Automotive Undercoat
- ◆ Central Roof AC W/Heat Pump
- ◆ 18' Awning A&E
- ◆ Fold Away Assist Rail
- ◆ Underslung Tire
- ◆ Curbside Scare Light
- ◆ Compartment Doors w/1" Ins.
- ◆ Awnings on Slideouts

MECHANICAL/CONSTRUCTION

- ◆ 2" Vac-U-Lam Sidewalls
- ◆ 3/8" Plywood Roof Deck
- ◆ Tapered Truss Roof
- ◆ R-11 Insulation - Roof
- ◆ Attic Ventilation System
- ◆ 16" Radials - Load Range G
- ◆ Dexter Nev-R-Lube Axles w/ Hydraulic Disc Brakes & Lube Shackles
- ◆ "Dual" Excalibur 8535 Furnaces
- ◆ Heated & Insulated Holding Tank Compartments
- ◆ 12V Disconnect
- ◆ Recessed Quad Battery Compartment
- ◆ 45 Amp Power Converter W/Batt. Charger
- ◆ 50 Amp Service with Detachable Cord

- ◆ Cable Ext. - Termination Valves
- ◆ Insulated Slide Out Floors 2³/₈"
- ◆ XT16 Gas/Elec. DSI Water Heater 36 L (10 US Gal.) W/Bypass Valves
- ◆ Whisper King Water Pump
- ◆ Toilet Holding Tank 203 L (53.4 US Gal.)
- ◆ Fresh Water 232 L (61 US Gal.)
- ◆ Grey Water 194 L (51 US Gal.)
- ◆ Dual Propane Bottles 13.6 Kg ea. (30 lbs. ea.) W/Auto CO Reg.
- ◆ Slide Out Propane Tray
- ◆ Black Tank Flush
- ◆ Pre-Wire for Solar Panel
- ◆ Solar Panel & Satellite Pre-wire
- ◆ Antifreeze Pick Up System
- ◆ Adjustable Height Spring Hangers

OPTIONS AVAILABLE

- ◆ Awning Upgrade 9000 Series
- ◆ Coffee Table
- ◆ Baseboard Heaters LR & BR
- ◆ Dinette ILO F/S Table*
- ◆ Leather Recliners - 30" Exch.*
- ◆ Leather Hide-a-bed
- ◆ Range w/Deep Oven*
- ◆ Bedroom Pocket Door*
- ◆ Electric Rear Stabilizer Jacks
- ◆ Garden Shower ILO Garden Tub*
- ◆ Round Dining Table
- ◆ 12V Stereo/DVD in Bedroom

- ◆ Solar Panel* 120W
- ◆ "Norcold" 12 cu. ft. Fridge
- ◆ Washer/Dryer Cabinet
- ◆ Washer/Dryer-1 pc. Splendide*
- ◆ Water Filter
- ◆ Generator Compartment* (25x33)
- ◆ Hide-A-Bed w/Air Mattress
- ◆ 19" LCD TV in Bedroom
- ◆ * Before Production Only.

FIFTH WHEEL MODEL 33RLTS



Warranted for Full Time Living!

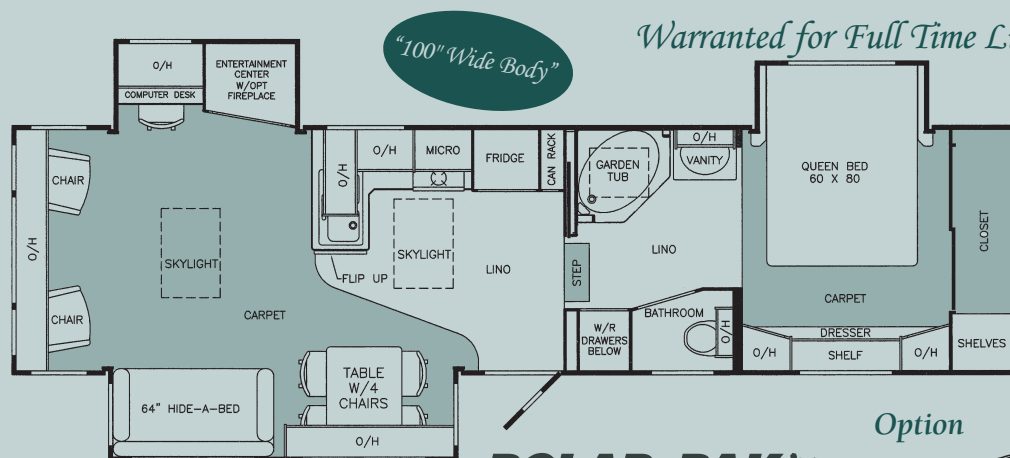

POLAR-PAK
THE SUB-ZERO SOLUTION

Guaranteed to -30° C

Option



STANDARD FEATURES

BATH/BEDROOM

- ◆ Fiberglass Garden Tub Enclosure W/Residential Faucet
- ◆ Porcelain Toilet W/Pedal Flush
- ◆ 6'0" Bedroom Height
- ◆ "Eurotop" Mattress
- ◆ Bedspread & Pillows
- ◆ Day/Nite Fabric Blinds
- * "Fantastic" Vent Fan
- ◆ "Karadon" Solid Surface Vanity
- ◆ "Sta-Tite" Slide W/Manual Override
- ◆ TV Pre-Wire in Bedroom
- * Residential Skylight/Shower w/Moisture Control
- ◆ Vanity W/Polymer Sink & Residential "Taymor" Faucet
- ◆ Fluorescent Light in Bath
- ◆ Tooth Brush Holder, Soap Dish
- ◆ CO Detector
- ◆ Clothes Hamper in Bedroom

KITCHEN

- ◆ Large Countertops W/ Stainless Steel Sink & Residential "Taymor" Faucet W/Spray
- ◆ Knife Block
- ◆ "Atwood" High Output Range Top - Recessed
- ◆ "Norcold" 10 cu. ft. Fridge W/Aluminum Laminate Door Panels
- ◆ Kitchen Drawers-Birch Plywood-Nylon Rollers & Steel Guides
- ◆ Double Can Storage Rack (N/A w/ 12' Fridge)
- ◆ "Karadon" Solid Surface Countertop - Recessed Range & Kitchen Sink
- ◆ Raised Beech Cabinet Doors
- ◆ Hardwood Table w/ Leaf & 4 Chairs
- ◆ Fluorescent Lights in Ceiling
- * Residential Skylight w/Moisture Control & Blind
- ◆ Propane Leak Detector
- ◆ Clock
- ◆ Convection Microwave W/120V Range Hood
- ◆ Decorative Mirror
- ◆ Central Vacuum w/Sweep

LIVING ROOM

- ◆ 26" LCD TV on Swivel Arm
- ◆ Residential Home Theater Stereo W/DVD Player & Surround Sound
- ◆ Cable/Telephone Hook Up
- ◆ Video Control Center
- ◆ Fire Extinguisher & Smoke Detector
- ◆ Day/Nite Fabric Blinds
- ◆ Chair at Computer Desk
- ◆ Beech End Table
- ◆ Electric "Sta-Tite" Rack & Pinion Super Slides-"Flush Floor"
- * Insulated Slide Floors 2 3/8"
- ◆ Fluorescent Lights in Ceiling
- ◆ Hide A Bed - 64" w/ Footrest
- ◆ TV Antenna
- ◆ 2 - Stressless Recliners w/ Ottoman
- ◆ Reading Lights
- * Residential Skylight w/Moisture Control & Blind
- ◆ Solid Beech Fascia - Entertainment Centre Slide
- * "Fantastic" Rain Sensor Vent Fan

EXTERIOR

- ◆ Entrance Door - 30"
- * Stormite Windows--Thermopane Glass
- ◆ Aerodynamic Fuel Saver Front Fiberglass Cap
- ◆ Roof Rack & Ladder
- ◆ Entrance Step Boot Shelf
- ◆ Shock Absorbers (4)
- ◆ "Dicor" Vinyl Seamless Roof
- ◆ 2 Rear Stab. Jacks
- ◆ Elec. Front Jacks W/Quick Release Pins
- ◆ MorRyde Pin Box System
- ◆ Aluminum Wheels (4)
- ◆ Hitch Hook Up Light
- ◆ BBQ Quick Connect
- ◆ Seamless Polypropylene Undersiding
- ◆ 8' Sewer Hose Compartment
- ◆ Automotive Undercoat
- * Central Roof AC w/Heat Pump
- ◆ 15' Awning
- ◆ Fold Away Assist Rail
- ◆ Underslung Tire
- ◆ Curbside Scare Light
- * Compartment Doors w/1" Ins.
- ◆ Exterior Shower in Compartment
- ◆ Awnings on Slide Outs

MECHANICAL/CONSTRUCTION

- * 2" Vac-U-Lam Sidewalls
- * 3/8" Plywood Roof Deck
- * Tapered Truss Roof
- * R-11 Insulation - Roof
- ◆ Attic Ventilation System
- ◆ 16" Radials - Load Range G
- ◆ Dexter Nev-R-Lube Axles w/ Hydraulic Disc Brakes & Lube Shackles
- * "Dual" Furnaces Excalibur IV 8535
- * Heated & Insulated Holding Tank Compartments
- ◆ 12V Disconnect
- ◆ Recessed Quad Battery Compartment
- ◆ 45 Amp Power Converter W/Batt. Charger
- ◆ 50 Amp Service with Detachable Cord
- * Cable Ext. - Termination Valves
- ◆ XT16 Gas/Elec. DSI Water Heater 36 L (10 US Gal.) W/Bypass Valves
- ◆ Whisper King Water Pump
- ◆ Toilet Holding Tank 203 L (53.4 US Gal.)
- ◆ Fresh Water 232 L (61 US Gal.)
- ◆ Grey Water 194 L (51 US Gal.)
- ◆ Dual Propane Bottles 13.6 Kg ea. (30 lbs. ea.) W/Auto CO Reg.
- ◆ Slide Out Propane Tray
- ◆ Black Tank Flush
- ◆ Aluminum Wheels (4)
- ◆ Solar Panel & Satellite Pre-wire
- ◆ Antifreeze Pick Up System
- ◆ Adjustable Height Spring Hangers

OPTIONS AVAILABLE

- ◆ "Weather Pro" Electric Awning*
- ◆ Awning Upgrade 9000 Series
- ◆ Awning Upgrade 9100 Series Elec.
- ◆ Coffee Table
- ◆ Dinette ILO F/S Table*
- ◆ Electric Fireplace
- ◆ Baseboard Heaters LR & BR
- ◆ Bedroom Pocket Door*
- ◆ Leather Recliners - 30" Exch.*
- ◆ Range w/Deep Oven*
- ◆ Garden Shower ILO Garden Tub*
- ◆ Round Dining Table
- ◆ "Norcold" 12 cu. ft. Fridge
- ◆ 12V Stereo/DVD in Bedroom
- ◆ Beech Fridge Panels
- ◆ Solar Panel* 120W
- ◆ Washer/Dryer Cabinet
- ◆ Washer/Dryer-1 pc. Splendide
- ◆ Water Filter
- ◆ Generator Compartment* (25x33)
- ◆ Electric Rear Stabilizer Jacks*
- ◆ Hide-A-Bed w/Air Mattress
- ◆ Hide-A-Bed Leather
- ◆ Drawers in Entertainment Center*
- ◆ 19 LCD TV in Bedroom

* Before Production Only.

Specifications are subject to change without notice or obligation.

FIFTH WHEEL MODEL 34.5CKTS PLATINUM XL



Warranted for Full Time Living!

"100" Wide Body"

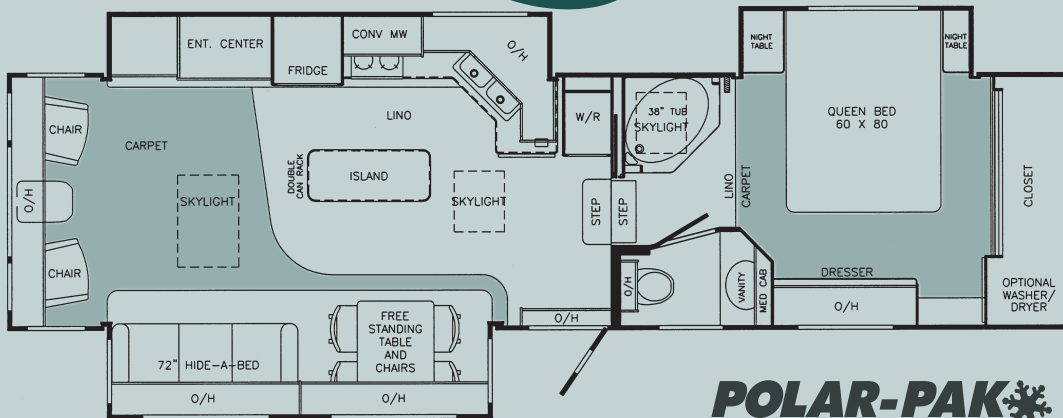

POLAR-PAK
THE SUB-ZERO SOLUTION

Guaranteed to -30° C

STANDARD FEATURES

BATH/BEDROOM

- ◆ Fiberglass Garden Tub Enclosure W/Residential Faucet
- ◆ Porcelain Toilet W/Pedal Flush
- ◆ 6'6" Bedroom Height
- ◆ "Eurotop" Mattress
- ◆ Bedspread & Pillows
- ◆ Day/Nite Fabric Blinds
- * "Fantastic" Vent Fan
- ◆ "Karadon" Solid Surface Vanity
- ◆ "Sta-Tite" Slide W/Manual Override
- ◆ TV & Satellite Pre-Wire in Bedroom
- * Residential Skylight with Moisture Control
- ◆ Vanity W/Polymer Sink & Taymor Faucet
- ◆ Fluorescent Light in Bath
- ◆ Tooth Brush Holder, Soap Dish
- ◆ CO Detector
- ◆ Clothes Hamper in Bedroom
- ◆ Preplumb for Washer/Dryer

KITCHEN

- ◆ Large Polymer Sink & "Taymor" Faucet W/Spray
- ◆ Undermounted Sink w/Solid Surface Covers
- ◆ Recessed "Atwood" High Output Range Top w/Solid Surface Cover
- ◆ Norcold 10 cu. ft. Fridge W/Aluminum Laminate Door Panels
- ◆ Kitchen Drawers-Birch Plywood-Nylon Rollers & Steel Guides
- ◆ "Karadon" Solid Surface Countertop
- ◆ 7'7" Interior Height
- ◆ Raised Beech Cabinet Doors
- ◆ Hardwood Table w/ Leaf & 4 Chairs
- ◆ Fluorescent Lights in Ceiling
- * "Fantastic Rain Sensor" Vent Fan
- * Residential Skylight with Moisture Control & Blind
- ◆ Propane Leak Detector
- ◆ Clock
- ◆ Convection Microwave W/120V Range Hood
- ◆ Decorative Mirror
- ◆ Double Can Storage Rack
- ◆ Central Vacuum w/Sweep
- ◆ Slide-Out Garbage Can

LIVING ROOM

- ◆ Residential Home Theatre Stereo W/CD & DVD Player & Surround Sound
- ◆ Cable/Telephone Hook Up
- ◆ Fire Extinguisher & Smoke Detector
- ◆ Day/Nite Fabric Blinds
- ◆ Beech & Fabric Fascia - L.R. Slides
- ◆ Electric "Sta-Tite" Rack & Pinion Super Slides-"Flush Floor"
- ◆ Fluorescent Lights in Ceiling
- ◆ 6'2" Height in Slide
- ◆ Hide A Bed - 72" w/ Footrest
- ◆ TV Antenna
- ◆ 2 - 30" Stressless Recliners w/ Ottoman
- ◆ Reading Lights
- * Residential Skylight with Moisture Control & Blind
- ◆ Fold Down Computer Desk in Entertainment Center
- ◆ Beech End Table
- ◆ Video Control Center
- ◆ 32" Toshiba LCD TV w/Swing Out Arm
- ◆ Recessed Halogen Lights

EXTERIOR

- ◆ Entrance Door - 30"
- * Stormite Windows-Thermopane Glass
- ◆ Aerodynamic Fuel Saver Front Fiberglass Cap
- ◆ Roof Rack & Ladder
- ◆ Entrance Step Boot Shelf
- ◆ Shock Absorbers (4)
- ◆ "Dicor" Vinyl Seamless Roof
- ◆ 2 Rear Stab. Jacks
- ◆ Elec. Front Jacks W/Quick Release Pins
- ◆ MorRyde Pin Box System
- ◆ Hitch Hook Up Light
- ◆ Seamless Polypropylene Undersiding
- ◆ 8' Sewer Hose Compartment
- ◆ Exterior Shower in Compartment
- ◆ Utility Compartment w/Hose Reel
- ◆ Automotive Undercoat
- ◆ Central Roof AC W/Heat Pump
- ◆ 15' Awning A&E
- ◆ Fold Away Assist Rail
- ◆ Underslung Tire
- ◆ Curbside Scare Light
- * Compartment Doors w/1" Ins.
- ◆ BBQ Quick Connect
- ◆ Awnings on Slideouts

MECHANICAL/CONSTRUCTION

- * 2" Vac-U-Lam Sidewalls
- * 3/8" Plywood Roof Deck
- * Tapered Truss Roof
- * R-11 Insulation - Roof
- * Attic Ventilation System
- ◆ 16" Radials - Load Range G
- ◆ Dexter Nev-R-Lube Axles W/Hydraulic Disc Brakes w/Lube Shackles
- * "Dual" Excalibur IV 8535 Furnaces
- * Heated & Insulated Holding Tank Compartments
- ◆ 12V Disconnect
- ◆ Recessed Quad Battery Compartment
- ◆ 50 Amp Service w/Detachable Cord
- * Insulated Slide Floors 2³/₈"
- ◆ XT16 Gas/Elec. DSI Water Heater 36 L (10 US Gal.) W/Bypass Valves
- ◆ Whisper King Water Pump
- ◆ Toilet Holding Tank 203 L (53.4 US Gal.)
- ◆ Fresh Water 232 L (61 US Gal.)
- ◆ Grey Water 194 L (51 US Gal.)
- ◆ Dual Propane Bottles 13.6 Kg ea. (30 lbs. ea.) W/Auto CO Reg.
- ◆ Slide Out Propane Tray
- ◆ Black Tank Flush
- ◆ Solar Panel & Satellite Pre-wire
- ◆ Adjustable Height Spring Hangers

OPTIONS AVAILABLE

- ◆ "Weather Pro" Electric Awnings
- ◆ Awning Upgrade 9000 Series
- ◆ Awning Upgrade 9100 Series Elec.
- ◆ Baseboard Heater LR & BR
- ◆ Coffee Table
- ◆ Dinette ILO F/S Table*
- ◆ Leather Recliners - 30" Exch.*
- ◆ Leather Hide-a-bed
- ◆ Range w/Deep Oven*
- ◆ Electric Rear Stabilizer Jacks
- ◆ Garden Shower ILO Garden Tub*
- ◆ Dishwasher*
- ◆ Round Dining Table
- ◆ Solar Panel* 120W
- ◆ King Bed 72x80 ILO Queen
- ◆ Washer/Dryer-1 pc. Splendide*
- ◆ Water Filter
- ◆ Generator Compartment* (25x33)
- ◆ Hide-A-Bed w/Air Mattress
- ◆ 19" LCD TV in Bedroom
- * Before Production Only.

Specifications are subject to change without notice or obligation.

TRAVEL TRAILER MODEL 30RLS



Warranted for Full Time Living!

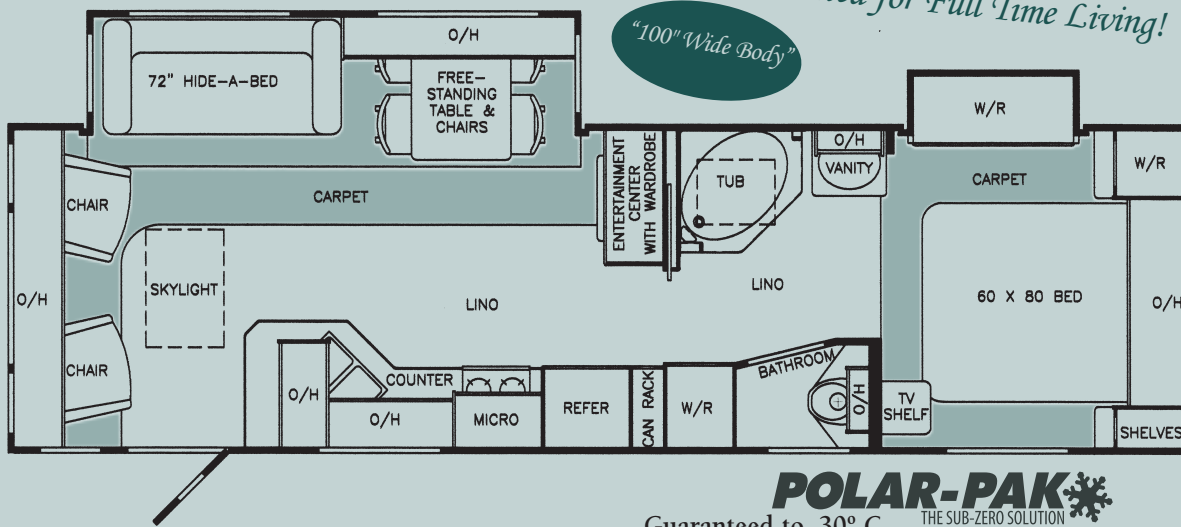

SPECIFICATIONS

GVWR	5263 Kg/11,600 lbs.
Dry Weight	4503 Kg/9,925 lbs.
Net Carrying Capacity	1150 Kg/2,530 lbs.
Axle Capacity	5445 Kg/12,000 lbs.
Hitch Weight	381 Kg/840 lbs.
Height*	3.4 M/11'4"
Width	2.5 M/8'4"
Length	10.7 M/35'4"
Exterior Storage	94 cu. ft.

* Approximate height to top of air conditioner

POLAR-PAK
THE SUB-ZERO SOLUTION

Guaranteed to -30° C

STANDARD FEATURES

BATH/BEDROOM

- ◆ "Taymor" Vanity Faucet
- ◆ Power Vent in Toilet Compartment
- ◆ GFI Receptacle/Bath
- ◆ Residential Fiberglass Garden Tub
- ◆ Wardrobe Slide Out
- ◆ Day/Nite Fabric Blinds
- ◆ "Eurotop" Mattress
- ◆ Co-ord. Bedspread w/Pillows
- ◆ Residential Skylight with Moisture Control
- ◆ Glass Shower Door
- ◆ CO Detector
- ◆ "Fantastic" Vent Fan
- ◆ Porcelain Toilet

KITCHEN

- ◆ Knife Block
- ◆ Jensen Range Hood W/Systems Monitor
- ◆ "Atwood" High Output Range
- ◆ "Norcold" 8 cu. ft. Fridge W/Aluminum Laminate Door Panels
- ◆ Raised Beech Cabinet Doors
- ◆ Polymer Kitchen Sink W/"Taymor" Faucet w/Spray
- ◆ Kitchen Drawers—Birch Plywood—Nylon Rollers & Steel Guides
- ◆ Hardwood Table w/ Leaf & 4 Chairs
- ◆ Fluorescent Light in Ceiling
- ◆ "Fantastic Rain Sensor" Vent Fan
- ◆ 6'8" Interior Height
- ◆ Central Vacuum w/Sweep

LIVING ROOM

- ◆ Cable/Telephone Hook Up
- ◆ Residential Skylight with Moisture Control
- ◆ Day/Nite Fabric Blinds
- ◆ Home Theatre Stereo w/CD, DVD & Surround Sound
- ◆ "Sta-Tite" Rack/Pinon Slide Mechanism—"Flush Floor"
- ◆ Raised Beech Cabinet Doors
- ◆ Beech End Table
- ◆ Fluorescent Light in Ceiling
- ◆ 2 - 28 Stressless Recliners w/ Ottoman
- ◆ 26" LCD HD TV

EXCELLA STANDARD FEATURES

- ◆ Central Roof AC—13.5
- ◆ Awning 17' A&E 8500
- ◆ Microwave Oven
- ◆ TV Antenna
- ◆ Black Tank Flush
- ◆ Fold Away Assist Rail
- ◆ Hide A Bed - 72" w/ Footrest
- ◆ 16" Aluminum Wheels (4)
- ◆ Antifreeze Pickup System
- ◆ Roof Rack & Ladder
- ◆ Stabilizer Jacks—Front & Rear
- ◆ TV Shelf/BR
- ◆ Propane Leak Detector

EXTERIOR

- ◆ Stormite Windows Thermopane Glass
- ◆ Aerodynamic Fiberglass Caps
- ◆ Propane Bottles Cover
- ◆ Fiberglass Radius Skirt & Fenders
- ◆ Compartment Doors w/1" Ins.
- ◆ "Dicor" Seamless Vinyl Roof
- ◆ Power Front Jack w/light
- ◆ Full Width Exterior Storage
- ◆ Hitch Hook Up Light
- ◆ Entrance Step Boot Shelf
- ◆ BBQ Quick Connect
- ◆ Polypropylene Undersiding
- ◆ Golf Club Storage
- ◆ Curbside Scare Light
- ◆ Awnings on Slideouts

MECHANICAL/CONSTRUCTION

- ◆ Crowned Truss Roof R-11 Insulation
- ◆ Attic Ventilation System
- ◆ Excalibur 8535 Furnace
- ◆ 45 Amp Power Converter W/Batt. Charger
- ◆ 30 Amp Service with Detachable Cord
- ◆ Hot Water Bypass Valves
- ◆ XT16 Gas/Elec. Water Heater W/DSI 36 L (10 US Gal.)
- ◆ Whisper King Water Pump
- ◆ Toilet Holding Tank 203 L (53 US Gal.)
- ◆ 12V Disconnect
- ◆ Fresh Water 232 L (61 US Gal.)
- ◆ Grey Water 194 L (51 US Gal.)
- ◆ Dual Propane Bottles 13.6 Kg ea. (30 lbs. ea.)
- ◆ Insulated Slide Floors 2 3/8"
- ◆ Auto Change Over Propane Regulator
- ◆ 2" Vac-U-Lam Sidewalls W/Dbl. Plywood
- ◆ Full Frame Construction
- ◆ 3/8" Plywood Decked Roof
- ◆ 16" Goodyear Radials
- ◆ 2-6,000 lbs. "Dexter Nev-R-Lube Axles" 100,000 Mile Warranty
- ◆ 4 Shock Absorbers & Leaf Springs
- ◆ Heated & Enclosed Holding & Fresh Water Tanks
- ◆ Solar Panel & Satellite Pre-Wire
- ◆ Antifreeze Pickup System

OPTIONS AVAILABLE

- ◆ "Weather Pro" Electric Awning
- ◆ Awning Upgrade 9000 Series
- ◆ Awning Upgrade 9100 Series Elec.
- ◆ Dinette ILO F/S Table*
- ◆ Exterior Shower*
- ◆ Electric Rear Stabilizer Jacks*
- ◆ Coffee Table
- ◆ "Norcold" 10 cu. ft. Fridge*
- ◆ Round Dining Table
- ◆ "Fabric or Leather" Recliners 28" exch.
- ◆ Solar Panel* 120W
- ◆ Garden Shower ILO Garden Tub*
- ◆ Water Filter
- ◆ Hide-A-Bed w/Air Mattress
- ◆ Hide-a-Bed Leather
- * Before Production Only.



PROUDLY BUILT IN CANADA!

*NORTH AMERICA'S BEST POLAR PAK! - YOUR SUB ZERO SOLUTION



General Coach has developed the best all season product available today. The exclusive Polar Pak Features are a combination of Canadian residential components and proven all season residential construction techniques. Our full wood frame Vacuum laminated walls are 2" thick, residential style truss roof and framed floor with 5/8" plywood will not sweat or conduct heat and cold as aluminum framing.



The "Dayliter" skylights from Richmond, BC are the best residential skylights on the market today. Only "Dayliter" skylights control interior moisture build up by catching the moisture in a drip rail and weeping the moisture to the exterior not back into the unit or into the roof cavity. Integral venting allows air to flow between the dual aircraft acrylic panes to prevent frost or moisture forming.

General Coach warrants all Polar Pak models for full time living.



Made in Canada "Stormtite" thermopane windows are proven to be the best all season windows with an extra heavy duty frame and the only framed sliding section that locks in the closed position for a positive seal against dust and moisture. The solar reflective glass also provides daytime privacy, eliminates UV rays and reduces heat build up by 10 to 15%.



The exclusive "Attic" ventilation system allows fresh air to be circulated through the ceiling cavity to reduce heat in the summer and condensation in the winter. The system consists of a fresh air intake at the rear of the unit and a 12 volt marine extraction fan on the roof above the bedroom. The fan is controlled by a 2 speed switch in the roadside cabinet. Efficient and quiet Excalibur Furnaces (35,000 or 40,000BTU) provide quick and quiet heat. The Models 32.5TKS and larger have 2 separate furnace systems for the best control of temperature through out the unit.

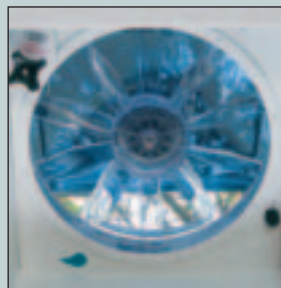

All models have the "Fantastic" Rain Sensor vent fans in the living area. The rain sensor is controlled from a wall thermostat that can be set according to temperature and humidity. Larger models also have a "Fantastic" vent fan above the vanity to control the bathroom humidity.

Optional baseboard heaters in the living room and bedroom provide a comfortable dry heat source.

Canada's only RV Guaranteed to -30° C



Holding Tanks are enclosed within a steel compartment that is insulated and heated with a direct duct from the furnace. Most models have the dump valve handles located above in a heated storage compartment, easy access and protected from road hazards. Compartment doors have 1" of High Density Foam Insulation.



POLAR-PAK ❄️
THE SUB-ZERO SOLUTION

Specifications are subject to change without notice or obligation.



The Model 32.5TKS rear lounge triple slide boasts an exceptionally open floor plan. The exclusive 100" wide body design allows for an extra large 'Karadon' solid surface kitchen counter. The convection microwave, recessed range and large residential stainless steel kitchen sink ensure all the comforts of home. The "Norcold" 1200 4 door refrigerator is available in lieu of the standard "Norcold" 10 cu. ft. and the pull out can rack. The 32.5TKS is shown in the rich Mocha Décor with the Seashore solid surface counters.



Hand-cranked stabilizing becomes a backache of the past with the optional Quick Draw Electric Stabilizer Jacks. Both jacks operate together and ensure equal pressure is on both legs. A touch of the switch results in a level and stable unit. The maximum support is 3200 lbs. A 3 Year warranty provides peace of mind.



Standard "Carefree" Awnings over all the Slide Outs provides extra protection from the elements. The Bedroom slide outs are optional in the Models 29CKS, 29.5RLS, 30RLDS and standard in Model 29RKDS, 31.5RLS and larger.



Model 38RLQS New for 2008 is the side aisle access to the bathroom and bedroom. Residential sliding frosted glass doors for privacy in the bedroom and bathroom. The oversized bathroom is accessible from the hall or the bedroom. The large solid surface vanity, residential fiberglass shower and linen closet ensure true at home comfort. A very spacious 6'9" Height for the Full Timer!

Model 38RLQS The private rear living room features an entertainment center with 32" LCD HD TV, optional fireplace and a 6' hardwood desk and chair. Pictured below is the optional Theatre seating in lieu of the hide-a-bed in the slide out.





The luxurious Model 31.5RLS Fifth Wheel in Mocha Decor with Optional Seashore Solid Surface Kitchen

EXCELLA CONSTRUCTION CROWNED ROOF

- 1 "Dicor" vinyl roof, seamless, overlaps the sidewall, 12 year warranty
- 2 3/8" plywood deck, screwed to truss
- 3 Fiberglass insulation R-11 full width
- 4 Engineered residential crowned truss, 5 1/4" thick in centre sloped to 3 1/2" on the ends
- 5 Insulated rigid air conditioning duct - 2"
- 6 Drip rail with down spouts
- 7 Interior ceiling panel - plywood

VACUUM BONDED WALL

- 8 "Filon" gelcoat panels
- 9 Plywood substrate
- 10 Kiln dried studs - 2x2, 2x4, 2x6
- 11 Ultra high density rigid polystyrene insulation

12 Interior panel - plywood
Walls on all models are framed utilizing 2" x 2", 2" x 3" and 2" x 6" kiln dried studs, steel reinforced and mounted directly on top of the foundation floor.

The sidewalls are individually laminated, cured under vacuum pressure and tear tested for a perfect bond prior to installation. Laminated to plywood, the Filon gelcoat panels are warranted for 2 years materials and labor and guarantees a high resale value as it retains colour and lustre and won't rust, corrode, ding or dent.

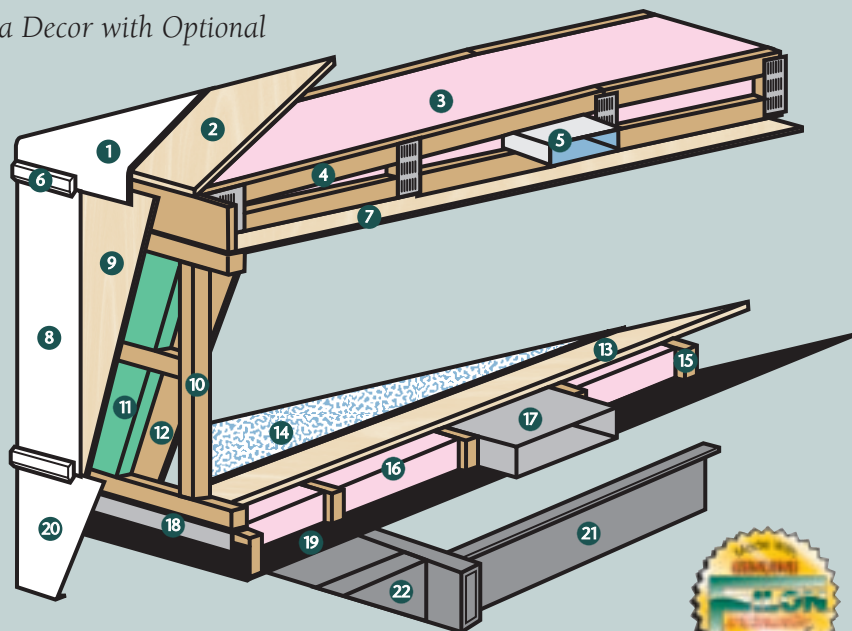

FOUNDATION FLOOR

- 13 5/8" plywood tongue & groove deck - glued and screwed to studs
- 14 Vinyl flooring residential installation
- 15 Kiln dried studs
- 16 Fiberglass insulation
- 17 Galvanized steel heat ducting (not all models)
- 18 Galvanized steel flashing

- 19 Seamless polypropylene undersiding complete wrap up sides, front and rear
- 20 Fiberglass radius skirt, double sealed at marriage
- 21 Floor is bolted to steel chassis. Steel is fully undercoated with automotive undercoat. **Holding tanks are enclosed, insulated and protected within the 12 gauge steel chassis members and heated directly from the furnace.**
- 22 12 gauge steel outriggers support full width of floor.



POLAR-PAK 
THE SUB-ZERO SOLUTION

Guaranteed to -30° C

Specifications are subject to change without notice or obligation.

Corsair Excella - Excellence You Deserve!!

General Coach is proud of our 99% customer satisfaction record.
But don't take our word for it, ask our owners for *their* opinions.

“I bought this fifth wheel to live in, as I first informed the salesperson. I said it gets d... cold up here in Fort Nelson, BC. He said no worries and recommended skirting. I did skirt it but not that great of a job. It had been 35 C to 40 C below for two to three weeks at a time and I was still toasty warm. There are likely cheaper trailers out there but if you need one to be well built and to withstand cold, this is the baby for you. I've put it to the test and all is good.

L. K.
Fort Nelson, BC



“We have been extremely pleased with the performance of our General Coach. We looked at many different brands of 5th wheel over the last few years and talked to many RVers. Your product certainly stood out in many ways and General Coach's reputation is very good in the RV community. There are many, many features that make our travels extremely comfortable and enjoyable.

Alan & Shirley N.
Surrey, British Columbia



“I have owned a General Coach product since 2001 and used it between nine and ten months a year since. The temperature outside has varied between +35 C to -50 C. The unit has stayed very comfortable in all conditions.

R. W.
Killam, AB



“The Model 33RLTS is an outstanding unit, with few if any features left out. Please thank all the engineers, designers and staff for a job well done.

Elaine & John P.
Fort McMurray, Alberta



“In 1989, we took five factory tours in BC and Alberta, including General Coach in Oliver. General Coach was the best quality and had the most attractive appearance. Although the price was slightly more than the others, we bought our first General Coach in 1991 and have never been sorry. In October of 2000, we bought our second General Coach Fifth Wheel. The quality is still excellent and with more features, we really enjoy our trailer. We get lots of compliments in campgrounds. We certainly appreciate the value for our dollars. Thanks for building a great fifth wheel.

Cleave & Diane B.
Maple Ridge, British Columbia



“We believe that the General Coach line is one of the top lines in North America. We have owned 7 General Coach products.

Heinz & Marlene L.
150 Mile House, British Columbia



“As we have had this unit 2 years now I believe this survey is now very complete. I am impressed with the warranty schedule offered by General Coach and appreciative of your warranty manager who has assisted us throughout. Thank you for a great coach.

Rex & Hazel B.
Saskatoon, Saskatchewan



“We have found after buying two new units from the same dealer and manufacturer that the service and quality is outstanding and we would have no problem recommending both.

Dave R.
Oliver, British Columbia



“Overall very satisfied, would like to see unit a little lighter but accept weight for solid construction. The quality is excellent both inside and out. I have recommended you to family and friends. Just love our fifth wheel.

Roy E.
Kelowna, British Columbia



“Having had considerable experience trailering with 6 different manufacturers' products, we are happy to say we are pleased with every aspect of our General Coach 5th Wheel. Perhaps the best comment is to simply state that the built-in quality of this product speaks to our comfort, enjoyment and the sense of pride we realize from our home away from home.

Don & Marg C.
Kamloops, British Columbia



“It is warm in the winter as I work in it all year round in the oil field.

Alan S.
Redcliffe, Alberta



“We owned the 1991 for 10 years. We had no problems at all with the 1991. So far we like our new 34RLTS.

Barb & Ray C.
Fort St. John, British Columbia



“We've travelled at least 4900 kms, east to Kenora, north to Meadow Lake and south to the border. The Mor-Ryde is a treat. It takes the road echo out of the truck. Manitoba and Saskatchewan roads are the test of this device. Finish of our unit is of a very high standard. My wife is so happy with the storage and arrangement of the unit. We were up north and had both furnaces going - worked great and quiet.

Clare C.
Penticton, British Columbia



The following is an excerpt from the "RV Times" magazine:

“We really do enjoy your publication. Our last trip was of three months duration: 16,200 miles, most of them in Canada. We would like to sing the praise of our new trailer built by General Coach in B.C. Our travel is always off-season and we looked for something that would be comfortable on the Alaska Highway in winter. More Canadians should know about this product.

Eva B.
Skagway, Alaska



Our Commitment to Customer Satisfaction

Corsair's full two-year limited warranty is reinforced by a limited six-year structural integrity warranty and a two-year component warranty. Quality assurance you can depend on! This added warranty is unique to the recreational vehicle industry and should be one of your very serious considerations when choosing your next R.V.

Corsair is backed by a national dealer and service network that is some 100 strong and stretches from coast-to-coast as well as affiliates in the U.S.A. for

Warranted for Full Time Living!

North American worry free travel. These dealers and dealer service technicians will gladly attest to the excellence of Corsair's construction and quality.

Join thousands of General Coach customers in North America and take command of the road with your Corsair. A buying decision you'll never regret.

We are very proud of our highly skilled people who exercise extreme care in the manufacture of every Corsair. We invite you to visit us at General Coach, see the quality process yourself. We know you'll be impressed and we know you'll love the Okanagan Valley.



Model 30 RLS Travel Trailer



GENERAL COACH

P.O. Box 700
Oliver, BC V0H 1T0
Telephone: (250) 498-3471
Fax: (250) 498-3240

gcsales@generalcoach.bc.ca
www.generalcoach.bc.ca

Proudly Presented By

POLAR-PAK ❄️
THE SUB-ZERO SOLUTION

Guaranteed to -30° C



THOR
CANADA'S BEST RV VALUE



Printed in Canada by
Wayside Press Ltd.



The Models 31CKDS, 34RLTS, 34.5CKTS and 38RLQS have a unique level floor throughout the bath and bedroom area. The units are pre-plumbed for an optional washer-dryer combination in the front wardrobe. Overhead cabinetry in these models allows for an optional 19" LCD TV and abundant storage is provided by deep drawers and large mirrored wardrobe.

Model 31CKDS XL Series
Ranch Decor

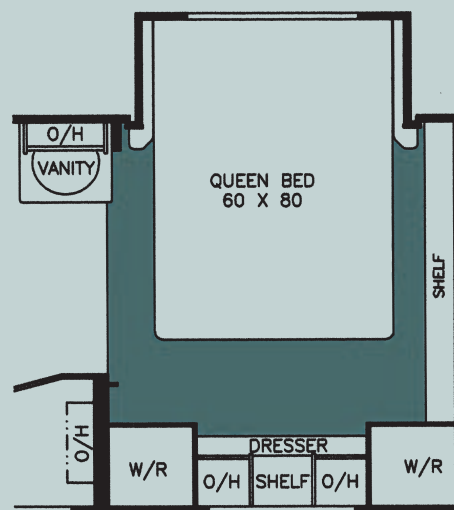

OPTIONAL BEDSLIDE

Models 29CKS, 29.5RLS, 30RLDS
FIFTH WHEEL



Most models with the Garden Tub can be ordered with the optional garden shower designed for ease of access. The optional pocket door improves bedroom privacy and is available in most walk thru bath models.

Excellence You Deserve!

Optional Pocket Door to Bedroom
& Optional Shower in lieu of Garden Tub.





FIFTH WHEEL MODEL 34RLTS PLATINUM XL

New for 2008

Warranted for Full Time Living!

"100" Wide Body"

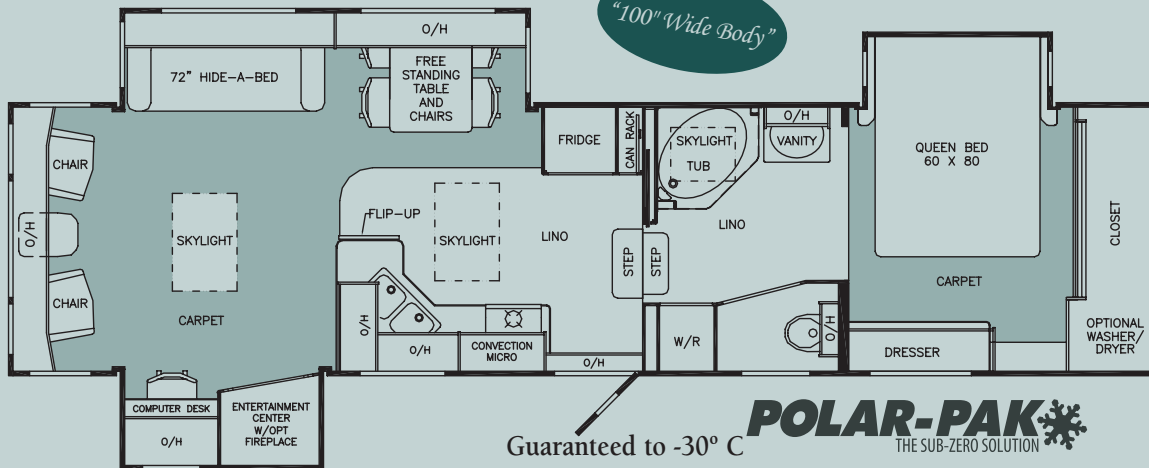

Guaranteed to -30° C

POLAR-PAK
THE SUB-ZERO SOLUTION

STANDARD FEATURES

BATH/BEDROOM

- ◆ Fiberglass Garden Tub Enclosure W/Residential Faucet
- ◆ Porcelain Toilet W/Pedal Flush
- ◆ 6'0" Bedroom Height
- ◆ "Eurotop" Mattress
- ◆ Bedspread & Pillows
- ◆ Day/Nite Fabric Blinds
- * "Fantastic" Vent Fan
- ◆ "Karadon" Solid Surface Vanity
- ◆ "Sta-Tite" Slide W/Manual Override
- ◆ TV Pre-Wire in Bedroom

- * Residential Skylight with Moisture Control
- ◆ Vanity W/Polymer Sink & Taymor Faucet
- ◆ Fluorescent Light in Bath
- ◆ Tooth Brush Holder, Soap Dish
- ◆ CO Detector
- ◆ Clothes Hamper in Bedroom
- ◆ 6'6" Bedroom Height
- ◆ Washer & Dryer Preplumb

KITCHEN

- ◆ Recessed Stainless Steel Sink & "Taymor" Faucet W/Spray
- ◆ Recessed "Atwood" High Output Range Top
- ◆ Norcold 10 cu. ft. Fridge W/Aluminum Laminate Door Panels
- ◆ Kitchen Drawers—Birch Plywood—Nylon Rollers & Steel Guides
- ◆ "Karadon" Solid Surface Countertop
- ◆ Raised Beech Cabinet Doors
- ◆ Hardwood Table w/ Leaf & 4 Chairs

- ◆ Fluorescent Lights in Ceiling
- * "Fantastic Rain Sensor" Vent Fan
- * Residential Skylight with Moisture Control & Blind
- ◆ Propane Leak Detector
- ◆ Clock
- ◆ Convection Microwave W/120V Range Hood
- ◆ Decorative Mirror
- ◆ Double Can Storage Rack (N/A w/ 12' Fridge)
- ◆ Central Vacuum w/Sweep
- ◆ Recessed Halogen Lights

LIVING ROOM

- ◆ 32" LCD TV w/ Swivel Arm
- ◆ Residential Home Theatre Stereo W/CD & DVD Player & Surround Sound
- ◆ Cable/Telephone Hook Up
- ◆ Fire Extinguisher & Smoke Detector
- ◆ Day/Nite Fabric Blinds
- ◆ Beech & Fabric Fascia - L.R. Slides
- ◆ 6'2" Height in Slide
- ◆ Electric "Sta-Tite" Rack & Pinion Super Slides—"Flush Floor"

- ◆ Fluorescent Lights in Ceiling
- ◆ Hide A Bed - 72" w/ Footrest
- ◆ TV Antenna
- ◆ 2 - Stressless Recliners w/ Ottoman
- ◆ Reading Lights
- * Residential Skylight with Moisture Control & Blind
- ◆ Chair at Computer Desk
- ◆ Beech End Table
- ◆ Video Control Center

SPECIFICATIONS

GVWR	7033 Kg/15,500 lbs.
Dry Weight	5817 Kg/12,820 lbs.
Net Carrying Capacity	1216 Kg/2,680 lbs.
Axle Capacity	6352 Kg/14,000 lbs.
Hitch Weight	1046 Kg/2,305 lbs.
Height*	4.0 M/13'1"
Width	2.5 M/8'4"
Length	10.7 M/35'3"
Exterior Storage	113 cu. ft.

* Approximate height to top of air conditioner

EXTERIOR

- ◆ Entrance Door - 30"
- * Stormtite Windows—Thermopane Glass
- ◆ Seamless Fiberglass Caps
- ◆ Aerodynamic Fuel Saver Front Fiberglass Cap
- ◆ Entrance Step Boot Shelf
- ◆ Roof Rack & Ladder
- ◆ Shock Absorbers (4)
- ◆ "Dicor" Vinyl Seamless Roof
- ◆ 2 Rear Stab. Jacks
- ◆ Elec. Front Jacks W/Quick Release Pins
- ◆ MorRyde Pin Box System

- ◆ Hitch Hook Up Light
- ◆ BBQ Quick Connect
- ◆ Seamless Polypropylene Undersiding
- ◆ 8' Sewer Hose Compartment
- ◆ Exterior Shower in Compartment
- ◆ Automotive Undercoat
- ◆ Central Roof AC W/Heat Pump
- ◆ 20' Awning A&E
- ◆ Fold Away Assist Rail
- ◆ Underslung Tire
- ◆ Curbside Scare Light
- * Compartment Doors w/1" Ins.
- ◆ Awnings on All Slideouts

MECHANICAL/CONSTRUCTION

- * 2" Vac-U-Lam Sidewalls
- * 3/8" Plywood Roof Deck
- * Tapered Truss Roof
- * R-11 Insulation - Roof
- * Attic Ventilation System
- ◆ 16" Radials - Load Range G
- ◆ Dexter Nev-R-Lube Axles w/ Hydraulic Discbrakes & Lube Shackles
- * "Dual" Excalibur IV 8535 Furnaces
- * Heated & Insulated Holding Tank Compartments
- ◆ 12V Disconnect
- ◆ Recessed Quad Battery Compartment
- ◆ Washer & Dryer Preplumb

- ◆ 50 Amp Service with Detachable Cord
- * Insulated Slide Floors 2³/₈"
- ◆ XT16 Gas/Elec. DSI Water Heater 36 L (10 US Gal.) W/Bypass Valves
- ◆ Whisper King Water Pump
- ◆ Toilet Holding Tank 203 L (53.4 US Gal.)
- ◆ Fresh Water 232 L (61 US Gal.)
- ◆ Grey Water 194 L (51 US Gal.)
- ◆ Dual Propane Bottles 13.6 Kg ea. (30 lbs. ea.) W/Auto CO Reg.
- ◆ Slide Out Propane Tray
- ◆ Black Tank Flush
- ◆ Solar Panel & Satellite Pre-wire
- ◆ Adjustable Height Spring Hangers

OPTIONS AVAILABLE

- ◆ "Weather Pro" Electric Awning*
- ◆ Awning Upgrade 9000 Series
- ◆ Awning Upgrade 9100 Series Elec.
- ◆ Coffee Table
- ◆ Baseboard Heaters LR & BR
- ◆ Dinette ILO F/S Table*
- ◆ Bedroom Pocket Door*
- ◆ Electric Fireplace
- ◆ Fabric Recliners - 30" Exch.*
- ◆ Leather Recliners - 30" Exch.*
- ◆ Leather Hide-a-bed - 72"
- ◆ Garden Shower ILO Garden Tub*
- ◆ Round Dining Table
- ◆ Electric Rear Stabilizer Jacks*

- ◆ Solar Panel* 120W
- ◆ "Norcold" 12 cu. ft. Fridge ILO 10 & Can Rack
- ◆ Washer/Dryer—1 pc. Splendide Generator Compartment* (25x33)
- ◆ Water Filter
- ◆ Range w/Oven*
- ◆ Hide-A-Bed w/Air Mattress
- ◆ Drawers in Entertainment Center
- ◆ 19" LCD TV in Bedroom
- * Before Production Only.



FIFTH WHEEL MODEL 38RLQS PLATINUM XL

New for 2008

SPECIFICATIONS

GVWR

7,668 Kg/16,900 lbs.

Dry Weight

6427 Kg/14,165 lbs.

Net Carrying Capacity

1241 Kg/2,735 lbs.

Axle Capacity

6806 Kg/15,000 lbs.

Hitch Weight

1028 Kg/2265 lbs.

Height*

4.0 M/13'3"

Width

2.5 M/8'4"

Length

12.4 M/40'9"

Exterior Storage

120 cu. ft.

* Approximate height to top of air conditioner



"100" Wide Body"

Warranted for Full Time Living!

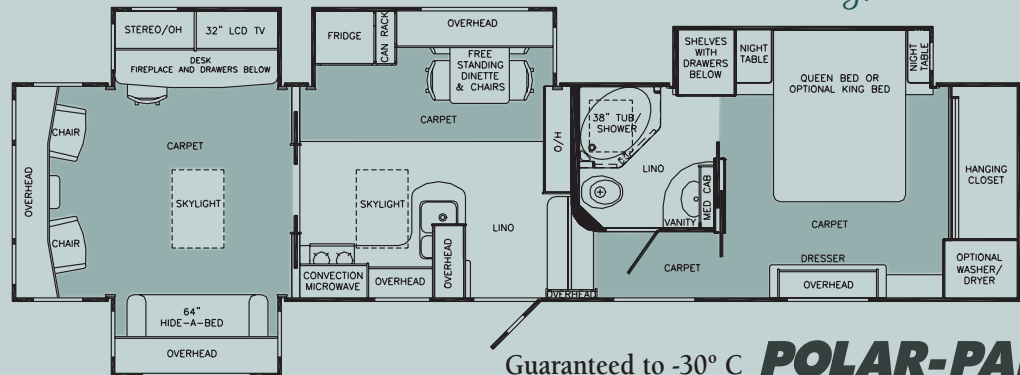

Guaranteed to -30° C

POLAR-PAK
THE SUB-ZERO SOLUTION

STANDARD FEATURES

BATH/BEDROOM

- ◆ Fiberglass Garden Tub Enclosure W/Residential Faucet
- ◆ Porcelain Toilet W/Pedal Flush
- ◆ 6'6" Bedroom Height
- ◆ "Eurotop" Mattress
- ◆ Bedspread & Pillows
- ◆ Day/Nite Fabric Blinds
- * "Fantastic" Vent Fan
- ◆ "Karadon" Solid Surface Vanity
- ◆ "Sta-Tite" Slide W/Manual Override
- ◆ Residential French Doors
- ◆ TV & Satellite Pre-Wire in Bedroom
- * Residential Skylight with Moisture Control
- ◆ Vanity Sink & Taymor Faucet
- ◆ Fluorescent Light in Bath
- ◆ Tooth Brush Holder, Soap Dish
- ◆ CO Detector
- ◆ Clothes Hamper in Bedroom
- ◆ Preplumb for Washer/Dryer
- ◆ Hardwood Dresser Top

KITCHEN

- ◆ Stainless Steel Sink & "Taymor" Faucet W/Spray
- ◆ Undermounted Sink w/Solid Surface Covers
- ◆ Recessed "Atwood" High Output Range Top w/Solid Surface Cover
- ◆ Norcold 10 cu. ft. Fridge W/Aluminum Laminate Door Panels
- ◆ Kitchen Drawers-Birch Plywood-Nylon Rollers & Steel Guides
- ◆ "Karadon" Solid Surface Countertop
- ◆ 7'7" Interior Height
- ◆ Raised Beech Cabinet Doors
- ◆ Hardwood Table w/ Leaf & 4 Chairs
- ◆ Fluorescent Lights in Ceiling
- * "Fantastic Rain Sensor" Vent Fan
- * Residential Skylight with Moisture Control & Blind
- ◆ Propane Leak Detector
- ◆ Clock
- ◆ Convection Microwave W/120V Range Hood
- ◆ Decorative Mirror
- ◆ Double Can Storage Rack (N/A w/ 12' Fridge)
- ◆ Central Vacuum w/Sweep

LIVING ROOM

- ◆ Residential Home Theatre Stereo W/CD & DVD Player & Surround Sound
- ◆ Cable/Telephone Hook Up
- ◆ Smoke Detector
- ◆ Day/Nite Fabric Blinds
- ◆ Beech & Fabric Fascia - L.R. Slides
- ◆ Electric "Sta-Tite" Rack & Pinion Super Slides-"Flush Floor"
- ◆ Fluorescent Lights in Ceiling
- ◆ 6'2" Height in Slide
- ◆ Hide A Bed - 64" w/ Footrest
- ◆ TV Antenna
- ◆ Residential French Doors
- ◆ 2 - Stressless Recliners w/ Ottoman
- ◆ Reading Lights
- * Residential Skylight with Moisture Control & Blind
- ◆ Computer Desk w/ Chair in Entertainment Center
- ◆ Beech End Table
- ◆ Video Control Center
- ◆ 32" Toshiba LCD TV w/Swing Out Arm
- ◆ Recessed Halogen Lights
- ◆ "Fantastic Rain Sensor" Vent Fan

EXTERIOR

- ◆ Entrance Door - 30"
- * Stormtite Windows-Thermopane Glass
- ◆ Aerodynamic Fuel Saver Front Fiberglass Cap
- ◆ Roof Rack & Ladder
- ◆ Entrance Step Boot Shelf w/ light
- ◆ Shock Absorbers (4)
- ◆ "Dicor" Vinyl Seamless Roof
- ◆ 2 Rear Stab. Jacks
- ◆ Elec. Front Jacks W/Quick Release Pins
- ◆ MorRyde Pin Box System
- ◆ Hitch Hook Up Light
- ◆ Seamless Polypropylene Undersiding
- ◆ 8' Sewer Hose Compartment
- ◆ Exterior Shower in Compartment
- ◆ Utility Compartment w/Hose Reel
- ◆ Automotive Undercoat
- ◆ Central Roof AC W/Heat Pump
- ◆ 20' Awning A&E 8500
- ◆ Fold Away Assist Rail
- ◆ Underslung Tire
- ◆ Curbside Scare Light
- * Compartment Doors w/1" Ins.
- ◆ BBQ Quick Connect
- ◆ Awnings on Slideouts

MECHANICAL/CONSTRUCTION

- * 2" Vac-U-Lam Sidewalls
- * 3/8" Plywood Roof Deck
- * Tapered Truss Roof
- * R-11 Insulation - Roof
- * Attic Ventilation System
- ◆ 16" Radials - Load Range G
- ◆ Dexter Nev-R-Lube Axles 8,000 lbs. W/Hydraulic Disc Brakes w/Lube Shackles
- * "Dual" Excalibur IV 8535 Furnaces
- * Heated & Insulated Holding Tank Compartments
- ◆ 12V Disconnect
- ◆ Recessed Quad Battery Compartment
- ◆ 50 Amp Service w/ Detachable Cord
- * Insulated Slide Floors 2 3/8"
- ◆ XT16 Gas/Elec. DSI Water Heater 36 L (10 US Gal.) W/Bypass Valves
- ◆ Whisper King Water Pump
- ◆ Toilet Holding Tank 203 L (53.4 US Gal.)
- ◆ Fresh Water 232 L (61 US Gal.)
- ◆ Grey Water 194 L (51 US Gal.)
- ◆ Dual Propane Bottles 13.6 Kg ea. (30 lbs. ea.) W/Auto CO Reg.
- ◆ Slide Out Propane Tray
- ◆ Black Tank Flush
- ◆ Solar Panel & Satellite Pre-wire
- ◆ Adjustable Height Spring Hangers

OPTIONS AVAILABLE

- ◆ "Weather Pro" Electric Awnings
- ◆ Awning Upgrade 9000 Series
- ◆ Awning Upgrade 9100 Series Elec.
- ◆ Baseboard Heaters
- ◆ Coffee Table
- ◆ Ceiling Fan in Kitchen
- ◆ Dinette ILO F/S Table*
- ◆ Leather Recliners - 30"*
- ◆ Leather Hide-a-bed
- ◆ Range w/Deep Oven*
- ◆ Electric Rear Stabilizer Jacks
- ◆ Garden Shower ILO Garden Tub*
- ◆ Norcold 12' Fridge ILO 10'
- ◆ Dishwasher*
- ◆ Round Dining Table
- ◆ Solar Panel* 120W
- ◆ King Bed 72x80 ILO Queen
- ◆ Washer/Dryer-1 pc. Splendide*
- ◆ Water Filter
- ◆ Generator Compartment* (25x33)
- ◆ Hide-A-Bed w/Air Mattress
- ◆ Storage Tray 300lb or 1000lb Capacity
- ◆ Hideabed 64" ILO Recliners
- ◆ Theatre Seating in Slide ILO Hideabed
- ◆ Entertainment Center w/ 42" LCD TV
- ◆ 12V Stereo/DVD in Bedroom
- ◆ 19" LCD TV in Bedroom

* Before Production Only.