

Scenic Cruiser

BY GULF STREAM®

11/96

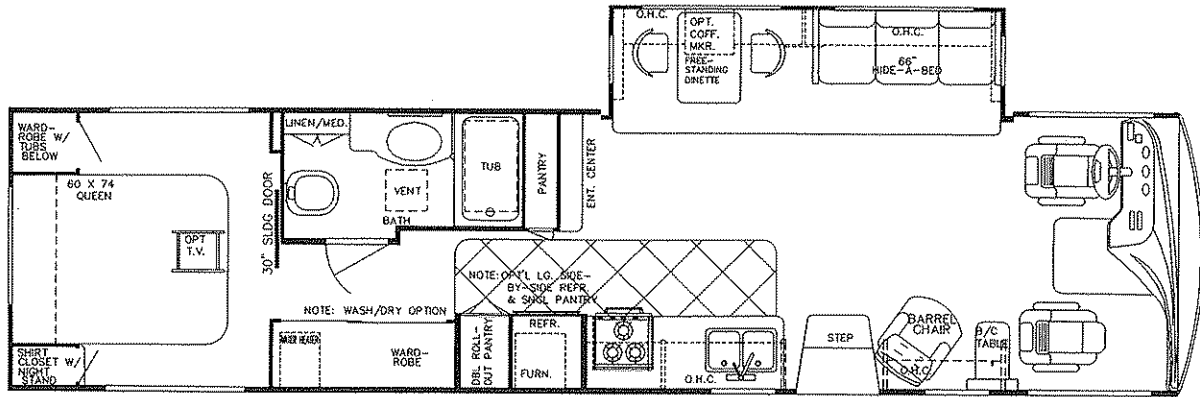

Model 8362 GAS

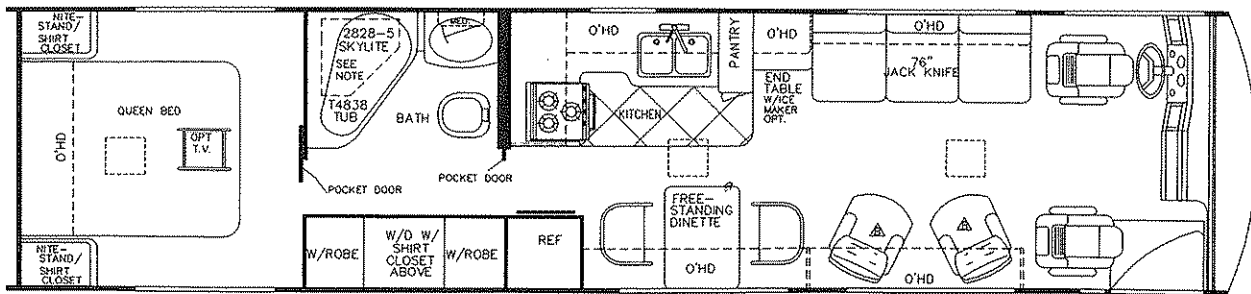

Model 8360 DIESEL

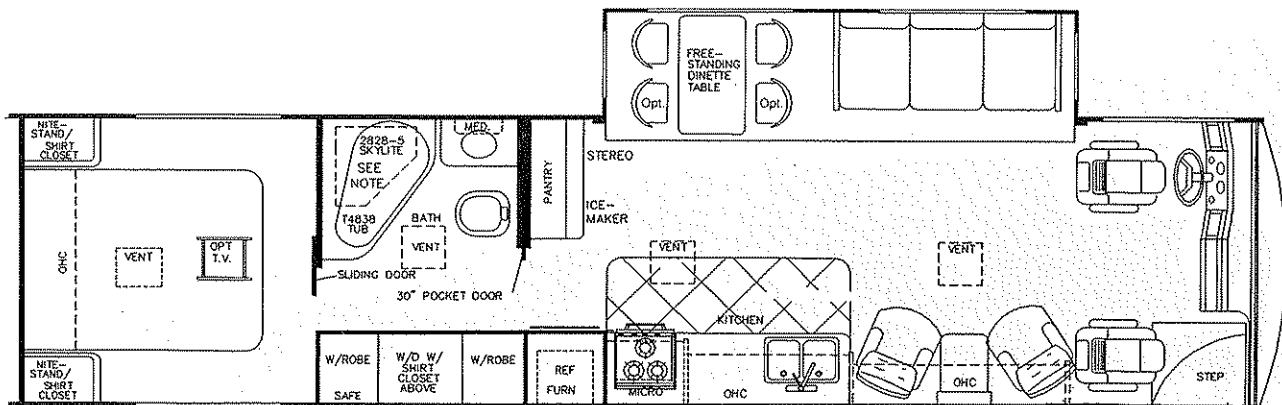

Model 8361 DIESEL

Scenic Cruiser

BY GULF STREAM®

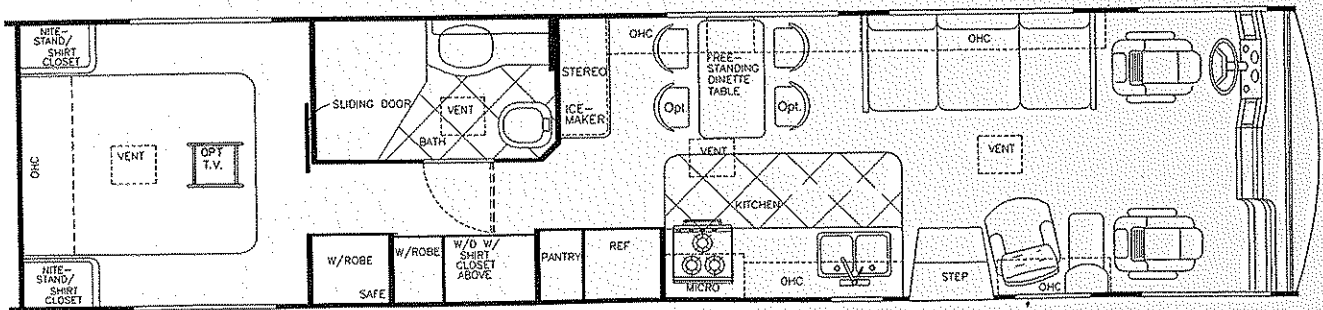

Model 8380 DIESEL

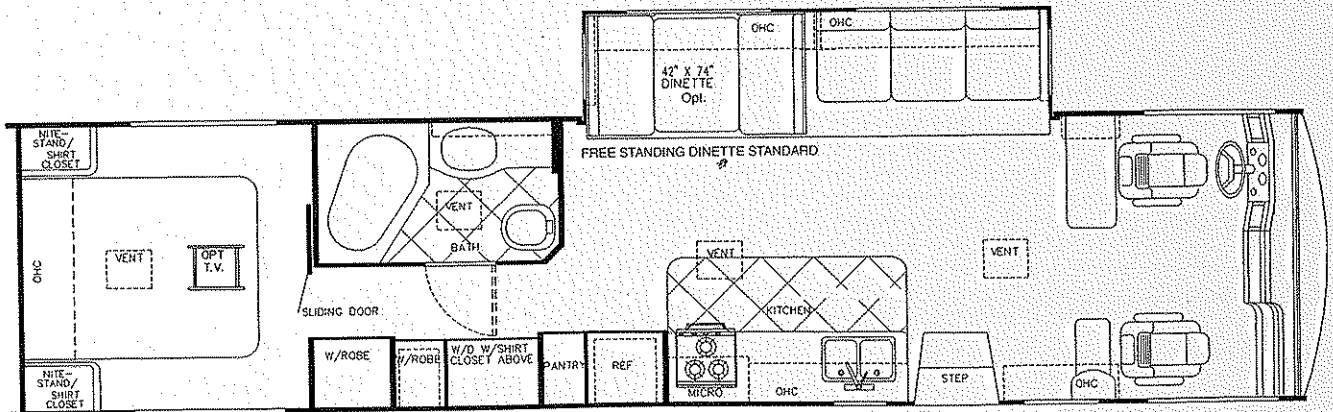

Model 8381 DIESEL



GULF STREAM COACH, INC.

P.O. Box 1005 • Nappanee, IN 46550

For further information and available floorplan options, contact your local dealer. Gulf Stream Coach, Inc. reserves the right to make changes in prices, colors, materials, components and specifications and to discontinue models at any time without notice or obligation. Gulf Stream Coach, Inc. assumes no responsibility for any error in type or print reproduction of specifications or floorplans in this brochure. TP 20M 11/96 © 1996 Gulf Stream Coach, Inc. - Nappanee, Indiana

SPECIFICATIONS

DIESEL MODELS	8362	8360	8361	8380	8381
Chassis:	FORD	SPARTAN	SPARTAN	FREIGHT LINER	FREIGHT LINER
Engine (HP)	460 CID	275	275	300	300
Wheelbase	208"+Tag	234"	234"	252"	252"
GVWR (lbs.)	19,500	24,000	24,000	26,000	26,000
Front Gross Axle Wt. Rating	6,000	9,000	9,000	10,000	10,000
Rear Gross Axle Wt. Rating	13,500 (tag)	15,000/17,000	15,000/17,000	16,000	16,000
DIMENSIONS:					
Overall Length (approx.)	36' 8"	37' 6"	37' 6"	39' 0"	39' 0"
Overall Height w/Roof A/C	12' 0"	12' 0"	12' 0"	12' 1"	12' 1"
Overall Width	101"	101"	101"	101"	101"
Interior Height	80"	80"	80"	80"	80"
Interior Width	97"	97"	97"	97"	97"
CAPACITIES:					
Fresh Water Tank (Gal.)	48	55	55	55	55
Grey Holding Tank (Gal.)	45	45	45	45	45
Black Holding Tank (Gal.)	45	45	45	45	45
Water Heater w/DSI (Gal.)	6	10	10	10	10
LP Gas Tank (lbs.)	115	115	115	115	115
Fuel Tank (Gal.)	75	100	100	150	150
Furnace (BTU's)	40K	40K	40K	40K	40K

Deluxe Std. Features

- Auto Dash Air Conditioner
- Auto Cruise Control
- Stainless Steel Wheel Inserts
- Rally Hook-Up
- Electric Step
- Rear Ladder
- Floor Mats
- Super Slick Exterior Fiberglass
- AM/FM Cassette w/4 Spkrs.
- Monitor Panel in Range Hood
- 115 lb. LP Tank (85 lb. on gas model)
- Radial Tires
- Tinted Windshield & Windows
- Wall Safe
- Lighted Entry Step
- Driving Lights

Chassis (Gas Models)

- Super Duty FORD w/460 CID V-8 and 4-Speed Automatic Transmission
- Power Steering w/Front and Rear Disc Brakes

Chassis (Diesel Models)

- Spartan ALPINE Chassis, w/Cummins 6CTA 8.3, 275HP, 660 ft.lb. Torque Turbo-Charged Rear Mounted Diesel Engine (300 HP Optional)
- Allison MD-3060P 6-Speed, Electronically Shifted Automatic Transmission
- Full Air-Ride Suspension
- Full Air Brakes
- High Capacity Automotive Heater
- Tilt Steering Wheel
- **38' Models ONLY:**
Freightliner Chassis Featuring Cummins 8.3 Litre, Turbo-Charged 300 HP Rear Mounted Diesel Engine

Bath and Water

- Super-Flow Manifold Water Distribution System
- Demand Water System
- City Water Hook-Up
- Double Stainless Steel Sink (Kitchen)
- White Single Lever Kitchen Faucet
- Sink Covers
- Gold Neo-Angle Shower Surround
- Sky Dome in Shower Area
- Brass Look Bath Fixtures
- Mirrored Medicine Cabinet
- Dual Pedestal Marine Toilet w/Sprayer
- One-Piece Fiberglass Tub

Heating and Air Conditioning

- Ducted Furnace w/Elect. Ignition 40,000 BTU (most models)
- Pre-Wired for Ducted Roof A/C

Interior and Decor

- Mirage Ivory or Oak Cabinetry w/Etched Glass Doors in Living Room & Bath
- Solid Surface Kitchen Countertop w/Backsplash and Knife Holder
- Custom Padded Dash w/Illuminated Gauges
- Day/Night Pleated Shades in LVRM & BDRM
- Pleated Privacy Curtain
- 3-Way, Feather Touch Captains Chairs
- Deluxe Furniture Package
- Deluxe Door and Window Drapes
- Coordinated Bedspread and Shams
- Generous Overhead Storage Compartments
- Free Standing Dinette and 2 Chairs (most models)
- Queen Size Bed w/Deluxe Innerspring Mattress
- Mini-Blinds in Kitchen
- Mirrored Closet Doors
- Heavy Duty Clear Vinyl Runner Over Carpet

Electrical Systems

- Easy-Access Dual Battery System
- Power Vent in Bath and Kitchen
- Electric Supply Cord
- Electric Overload Protection
- Automotive-Type, Color-Coded Wiring
- Lighted Entry & Aisle Lights

Appliances

- Deluxe 3-Burner High-Performance Range w/Oven
- Lighted Power Range Hood
- 19" Color TV (VCR Ready)
- TV Antenna w/Amp, Boost and 2 Jacks
- 2-Door, 2-Way Refrigerator
- LP Gas Leak Detector
- Carbon Monoxide Detector

Exterior and Construction

- Unified "New Generation" Body Structure
- 1-1/2" x 1-1/2" Tubular Steel Sub-Floor Trusses
- 1-1/2" x 1-1/2" Tubular Steel Floor Framing
- Vacuum-Bond Laminated Floor w/Metal Under-Belly
- Vacuum Bond Laminated Sidewalls w/Tubular Metal Framing and One Piece Fiberglass w/Mende Backer
- Vacuum Bond Laminated Roof w/Metal Framing, Bowled Roof Trusses and Block Foam Insulation
- One-Piece, Radiused Rubber Roof w/12 Year Warranty
- Virtually Seamless Weyerhaeuser Structurwood Floor Decking w/10 Year Warranty
- Angled Steel Sidewall-to-Roof Transition Member
- Hinged Exterior Storage Doors
- Heated & Fully Enclosed Holding Tanks
- High-Density Block Foam Insulation Throughout
- Molded Roof Brick Insulation, Surrounds Ducted Roof A/C
- Sidewalls Lag-bolted Every 8" to Floor Structure
- Fully Welded Steel Firewall
- Rear Fiberglass Cap with Integrated Bumper
- Outstanding Side-to-Side, Carpeted and Lighted Exterior Storage
- Radius Entry Door w/Deadbolt Lock
- Sealed Perimeter and Engine Compartment
- Large Panoramic Windshield
- Deluxe Outside Mirrors
- Jalousie Windows in Bedroom



IF YOU WANT A COACH THAT'S BUILT AS WELL AS A GULF STREAM...

1. Seamless Rubber Roof For Greater Energy Efficiency and Dependability.

2. Luan Decking for Additional Strength.

3. Molded E.P.S. Brick Insulation Provides Consistent Insulative Value As Well As Superior Dimensional Rigidity.

4. One-Piece Formed Aluminum Air Conditioning Duct, Completely Surrounded By Polystyrene Insulation.

5. Bubble-Wrapped Foil Insulation Provides Superior Insulation.

6. Rugged Welded Tube Roof Framing.

7. Soft Touch Ceiling Fabric for Added Sound Insulation.

8. Aluminum Cove Molding.

9. Bubble-Wrapped Foil Insulation Minimizes Thermal Transfer.

10. Rugged Roll-Formed Steel Roof-to-Sidewall Transition Member Insures Structural Integrity and Stability.

11. Die-Stamped Steel Transition Member Gusseting Provides Greater Strength and Structural Integrity.

12. Rugged Heavy-Gauge Tubing, Fixture Welded to Form the Sidewall Framing.

13. High-Density E.P.S. Insulation Provides Superior Laminating and Bonding Characteristics and Insures Greater Energy Efficiency.

14. Interior Wall Panels Securely Laminated to Sidewall Framing.

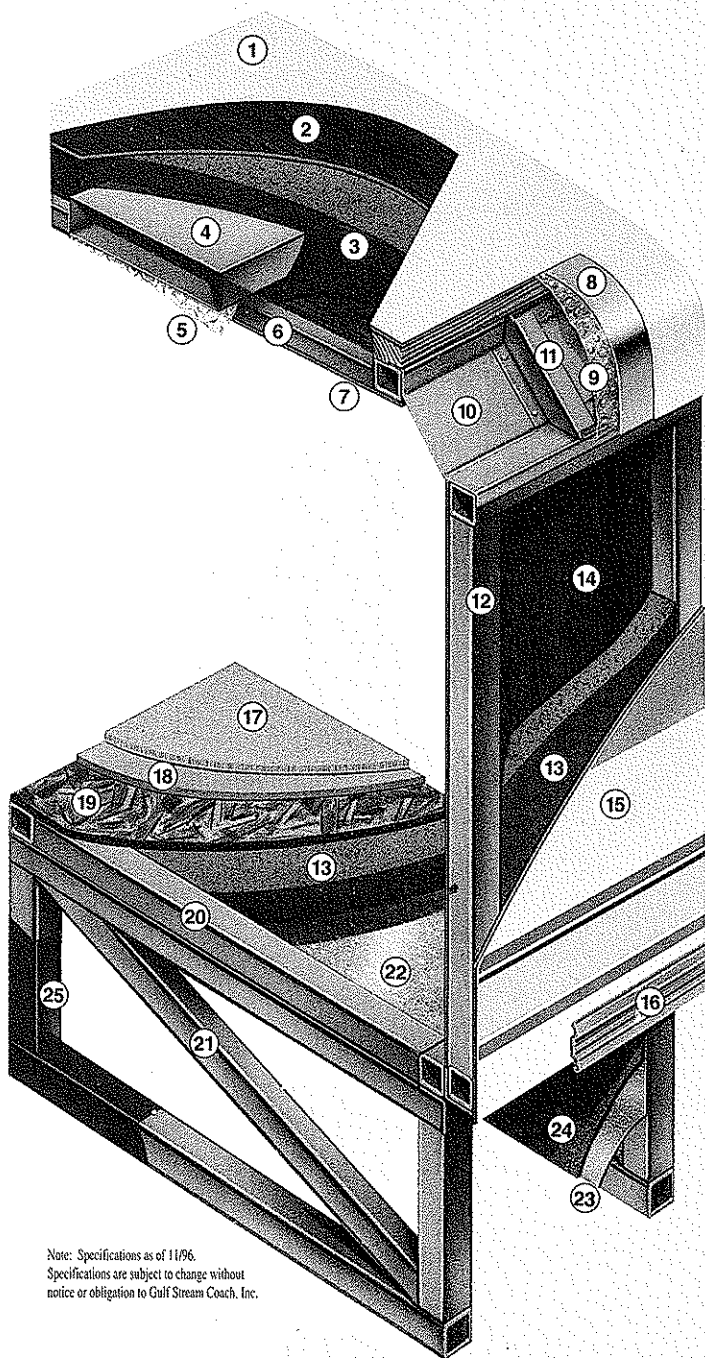

Note: Specifications as of 11/96. Specifications are subject to change without notice or obligation to Gulf Stream Coach, Inc.

15. "Mende" Fiberglass Exterior, Vacuum-Bond Laminated to Sidewall Framing for Lasting Beauty and Durability.

16. Aluminum Trunk Door Hinge Extrusion Provides A Tight Seal Discouraging Air or Water Infiltration.

17. High-Quality Stain-Resistant Carpeting Available in Designer-Coordinated Colors.

18. Extra-Thick Padding Under Carpet Provides Extra Comfort and Increases Carpet Durability.

19. Continuous Structurewood Floor Decking Laminated to Steel Floor Structure Assures a Quiet, Long-Lasting, Rigid Floor

20. Heavy-Gauge Steel Tube Floor Fixture Welded for Extra Strength and Stability.

21. Heavy-Gauge Steel Tube Framing, Fixture Welded Floor Truss System Provides the Strongest Motorhome Foundation in the Industry.

22. Seamless Layer of Galvanized Steel Securely Laminated to the Steel Floor Framing.

23. Galvanized Steel Used to Form Each Storage & Holding Compartment.

24. Durable All-Weather Carpeting Completes Each Accessible Storage Compartment, Providing Extra Protection for Luggage and Valuables.

25. Rust-Prohibitive Paint Coating Applied to All Steel Framing Assures Corrosion and Rust Protection.

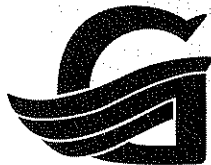

IT'S GOING TO HAVE TO BE A GULF STREAM!