

5/98

# FRIENDSHIP<sup>®</sup>

## GULF STREAM<sup>®</sup>

COACH, INC.

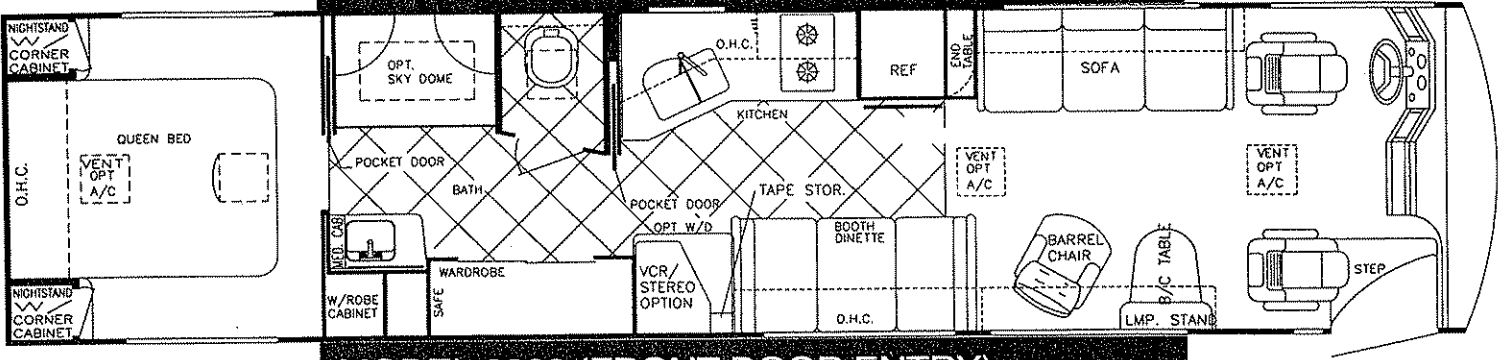

MODEL 8390 (FRONT DOOR ENTRY)

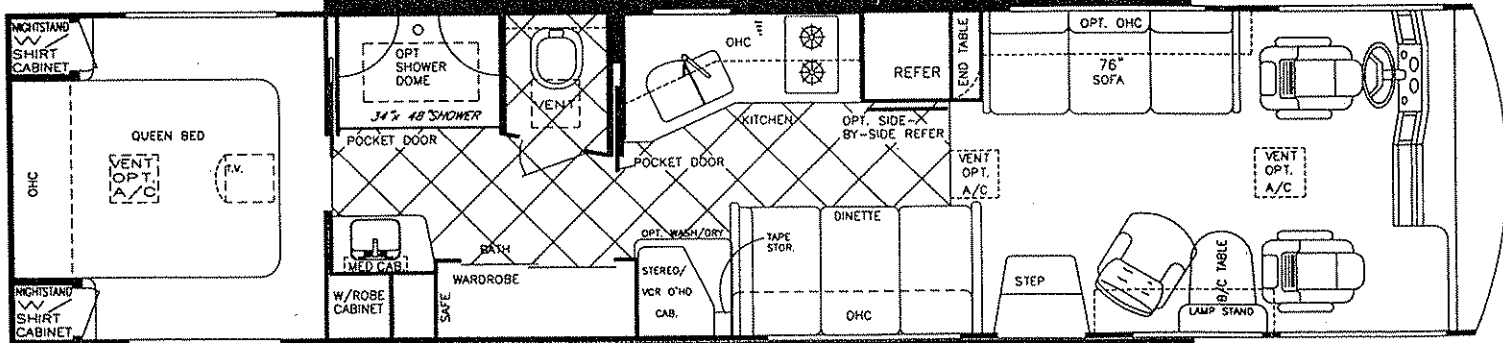

MODEL 8390 (SIDE DOOR ENTRY)

# FRIENDSHIP®

## GULF STREAM®

COACH, INC.

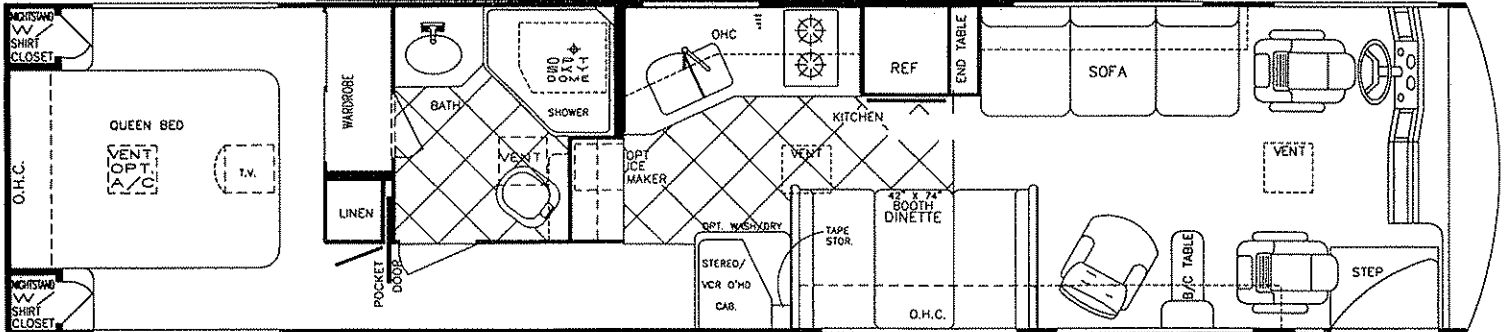

**MODEL 8391 (FRONT DOOR ENTRY)**

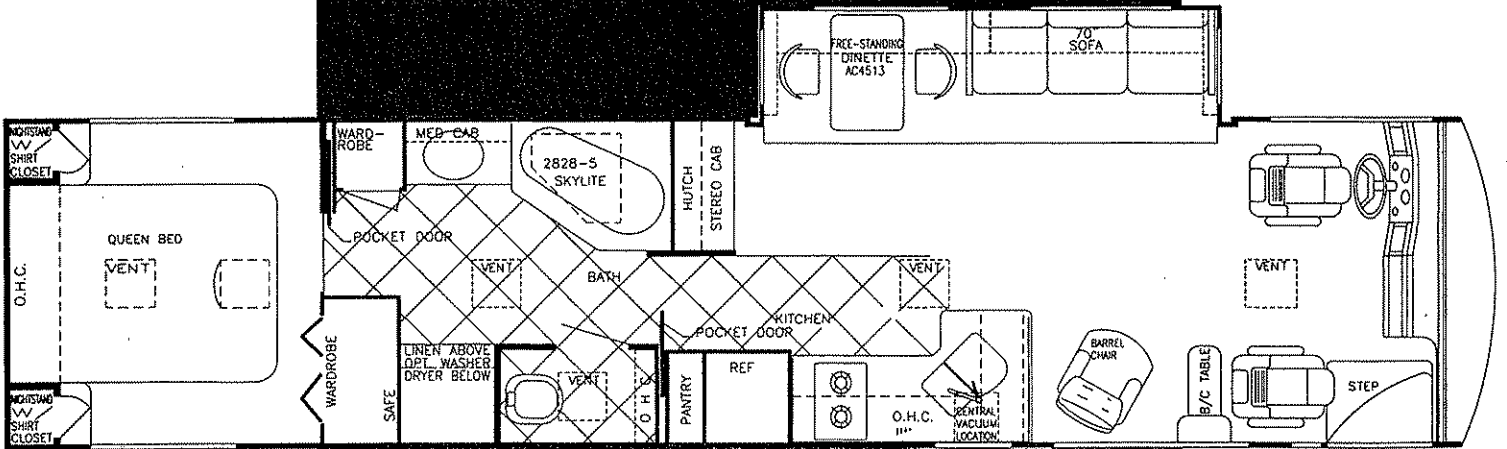

**MODEL 8393 (GLIDE-OUT EXPANDO)**

**GULF STREAM COACH, INC.**

P.O. Box 1005 • Nappanee, IN 46550

Call 1-800-289-8787, ext. 3288, or  
 Visit our Web Site at:  
[www.GULFSTREAMCOACH.com](http://www.GULFSTREAMCOACH.com)

For further information and available floorplan options, contact your local dealer or Gulf Stream Coach, Inc. Gulf Stream Coach, Inc. reserves the right to make changes in prices, colors, materials, components and specifications and to discontinue models at any time without notice or obligation. Gulf Stream Coach, Inc. assumes no responsibility for any error in type or print reproduction of specifications or floorplans in this brochure.  
 © 1997 Gulf Stream Coach, Inc. - Nappanee, Indiana TP ER 5M 5/98

# SPECIFICATIONS

## Interior and Decor

- Woodland Rose Laminated Cabinetry
- Cherry Hardwood Cabinetry (Optional)
- Laminated Formica Paneling
- Radius Cabinet & Wall Corners
- Fabric-Covered Shelving
- Solid Surface Countertops
- Custom Padded Dash w/Illuminated Gauges
- Deluxe Furniture
- 3-Way Driver & Passenger Seats with Leather Seating Surface
- Deluxe Carpet w/Pad
- Tile Floor in Kitchen
- Day/Night Shades Throughout
- Deluxe Privacy Drapes
- Coordinated Bedspreads & Shams
- Cedar-Lined Wardrobe
- Beveled Glass Decorator Mirrors in Living Area, Bedroom & Bathroom
- Carpeted Ceiling
- "Villa" Leather Driver & Buddy Seat w/Power Foot Rest (Optional)

## Bath and Water

- Super Flow Manifold Water Distribution System (N/A w/CSA)
- Demand Water System
- City Water Hook-Up
- Double-Bowl Solid Surface Sink
- Sink Covers
- Shower w/Gold-Tone Shower Stall and Fixtures

## Appliances

- 2-Burner High-Output Recessed Range
- Lighted Power Range Hood
- Large, 2-Way, Flush-Mounted Double-Door Refrigerator
- Side-by-Side, Double-Door 3-Way Refrigerator (Opt.)
- Microwave/Convection Oven
- Residential Telephone
- 19" Color TV w/VCR

## Electrical System

- Slide-Out Coach Batteries
- 12-Volt, 75-Amp Converter w/Battery Charger
- Electrical Supply Cord -- 50 Amp (30 Amp Cord on CSA)
- Electric Overload Protection
- Automotive-Type Color-Coded Wiring
- AM/FM Stereo Cassette in Dash
- Lighted Entry Way and Aisle Lights
- Directional Reading and Map Lights
- Positive Battery Shut-Off Switches
- Electric Step & Cover
- 7.5 Onan Diesel Generator (opt.) on Automatic Front Slide-Out Tray
- Optional Deluxe Rack-Mounted Stereo System with CD Player

SPARTAN DIESEL MODELS	8390	8391	8393
Engine (HP)	325	325	325
Wheelbase	252"	252"	252"
GVWR (lbs.)	31,000	31,000	31,000
GCWR (lbs.)	36,000	36,000	36,000
UVW (lbs.)	25,050	24,440	26,450
Payload Capacity	5,950	6,560	4,550
<b>DIMENSIONS:</b>			
Overall Length (approx.)	39' 0"	39' 0"	39' 0"
Overall Height w/Roof A/C	12' 0"	12' 0"	12' 0"
Overall Width	101"	101"	101"
Interior Height	80"	80"	80"
Interior Width	97"	97"	97"
<b>CAPACITIES:</b>			
Fresh Water Tank (Gal.)	100	100	100
Grey Holding Tank (Gal.)	50	50	50
Black Holding Tank (Gal.)	50	50	50
Water Heater w/DSI (Gal.)	10	10	10
LP Gas Tank (lbs.)	150	150	150
Fuel Tank (Gal.)	150	150	150
Dual Furnaces (BTU's)	35K/ea.	35K/ea.	35K/ea.

## Exterior and Construction

- Unified "New Generation" Body Structure, Providing a Cradle of Strength
- 1-1/2" x 1-1/2" Tubular Steel Cage Construction (Floor/Sidewalls/Roof)
- Laminated Floors w/Metal Underbelly
- Super-Structure Steel Floor Truss System
- Laminated 2" Thick Floor, Wall & Roof Construction
- R-7.5, 1 1/2" Block Foam Insulation in Floor, Walls & Roof
- Sidewalls Lag-Bolted Every 8" or Less to Floor Structure
- Full Fiberglass Front and Rear Caps
- Fiberglass Integrated Bumpers
- Exterior Entertainment Center (Opt.)
- Fully-Welded Steel Firewall
- Sealed Perimeter & Engine Compartment
- Seamless, One-Piece Radiused Rubber Roof
- Roof Lag-Bolted Every 8" or Less to Sidewalls
- Super-Slick Laminated Fiberglass Siding
- Tinted Windshield & Windows
- Color-Coordinated Paint Scheme w/Contemporary Painted Graphics & Clear Coat Finish
- Outstanding Side-to-Side, Carpeted, Lighted Exterior Storage
- Back-Up Alarm
- Convenient Rally Hook-Up System

## Diesel Chassis

- Channel-Type, Raised-Rail Frame
- Stemco Seals -- Bearings Lubricated w/Oil Instead of Grease
- 14-Gauge Ultra-High Temperature Wire w/Circuit Description Every 3"
- 4-Point V-Pad Engine Mount Greatly Reduces Vibration
- Side-Mounted Rochester Fuel Gauge
- Grau-Midland Anti-Lock Brake System
- Air Brakes w/Midland Pure Air Plus Heater Air Dryer
- Self-Leveling Air Suspension
- Cummins 325 HP, 8.3 Diesel Engine
- Turbo Charged and After Cooled
- Allison MD 3060P 6-Speed Electronically Shifted Automatic Transmission
- Tilt and Telescoping Douglas Steering Column
- High Capacity Automotive Heater
- Aluminum Wheel Inserts
- IFS Front Suspension

## Heating, Ventilation and Air Conditioning

- Dual 35,000 BTU Furnaces w/Residential Duct System
- Two 13,500 BTU Ceiling Ducted Air Conditioners
- 15,000 BTU Front Air Conditioner (Opt.)

# GULF STREAM'S NEW GENERATION CRADLE OF STRENGTH

1. Seamless Rubber Roof For Greater Energy Efficiency and Dependability.

2. Luan Decking for Additional Strength.

3. Molded E.P.S. Brick Insulation Provides Consistent Insulative Value As Well As Superior Dimensional Rigidity.

4. One-Piece Formed Aluminum Air Conditioning Duct, Completely Surrounded By Polystyrene Insulation.

5. Bubble-Wrapped Foil Insulation Provides Superior Insulation.

6. Rugged Welded Steel Tube Roof Framing.

7. Soft Touch Ceiling Fabric for Added Sound Insulation.

8. Aluminum Cove Molding.

9. Bubble-Wrapped Foil Insulation Minimizes Thermal Transfer.

10. Rugged Roll-Formed Steel Roof-to-Sidewall Transition Member Insures Structural Integrity and Stability.

11. Die-Stamped Steel Transition Member Gusseting Provides Greater Strength and Structural Integrity.

12. Rugged Heavy-Gauge Steel Tubing, Fixture Welded to Form the Sidewall Framing.

13. High-Density E.P.S. Insulation Provides Superior Laminating and Bonding Characteristics and Insures Greater Energy Efficiency.

14. Interior Wall Panels Securely Laminated to Sidewall Framing.

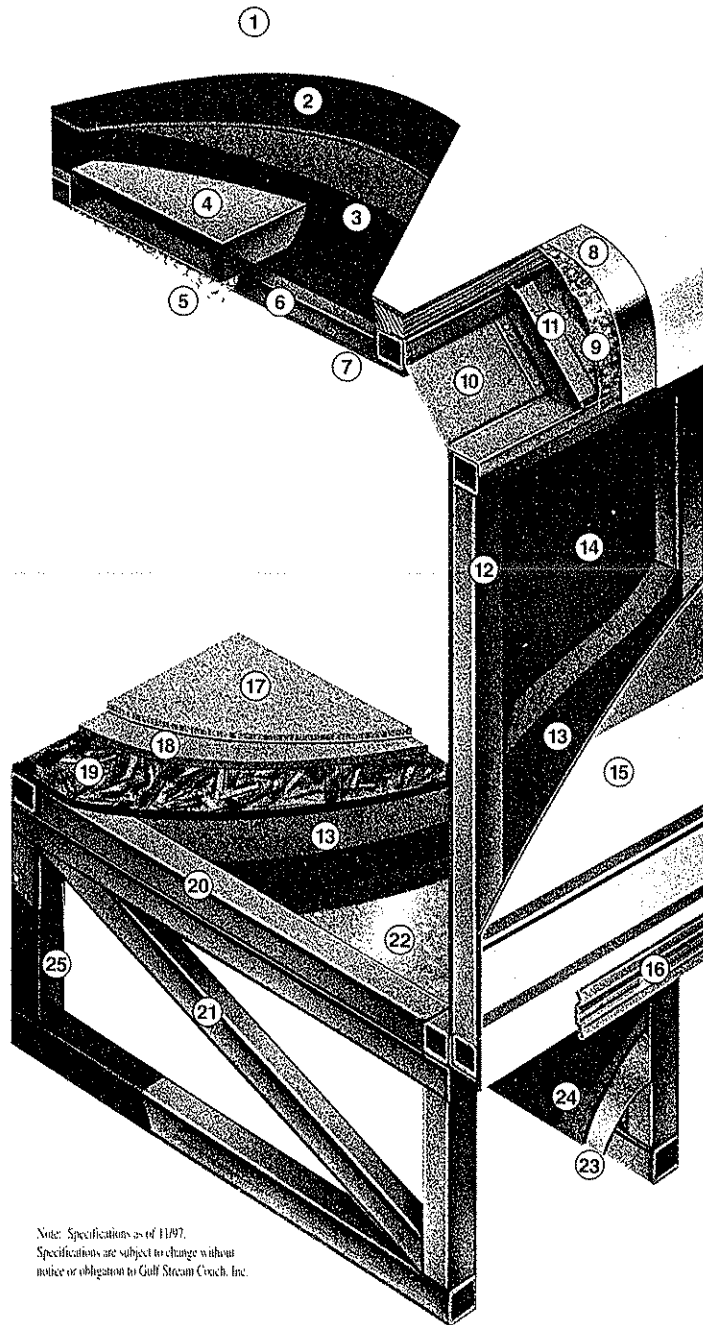

Note: Specifications as of 11/97.  
Specifications are subject to change without notice or obligation to Gulf Stream Coach, Inc.

15. "Mende" Fiberglass Exterior, Vacuum-Bond Laminated to Sidewall Framing for Lasting Beauty and Durability.

16. Aluminum Trunk Door Hinge Extrusion Provides A Tight Seal Discouraging Air or Water Infiltration.

17. High-Quality Stain-Resistant Carpeting Available in Designer-Coordinated Colors.

18. Extra-Thick Padding Under Carpet Provides Extra Comfort and Increases Carpet Durability.

19. Continuous Structurewood Floor Decking Laminated to Steel Floor Structure Assures a Quiet, Long-Lasting, Rigid Floor

20. Heavy-Gauge Steel Tube Floor Fixture Welded for Extra Strength and Stability.

21. Heavy-Gauge Steel Tube Framing, Fixture Welded Floor Truss System Provides the Strongest Motorhome Foundation in the Industry.

22. Seamless Layer of Galvanized Steel Securely Laminated to the Steel Floor Framing.

23. Galvanized Steel Used to Form Each Storage & Holding Compartment.

24. Durable All-Weather Carpeting Completes Each Accessible Storage Compartment, Providing Extra Protection for Luggage and Valuables.

25. Rust-Prohibitive Paint Coating Applied to All Steel Framing Assures Corrosion and Rust Protection.



# GULF STREAM - BUILT TO LAST!