

2/98

# Sun Voyager

## GULF STREAM

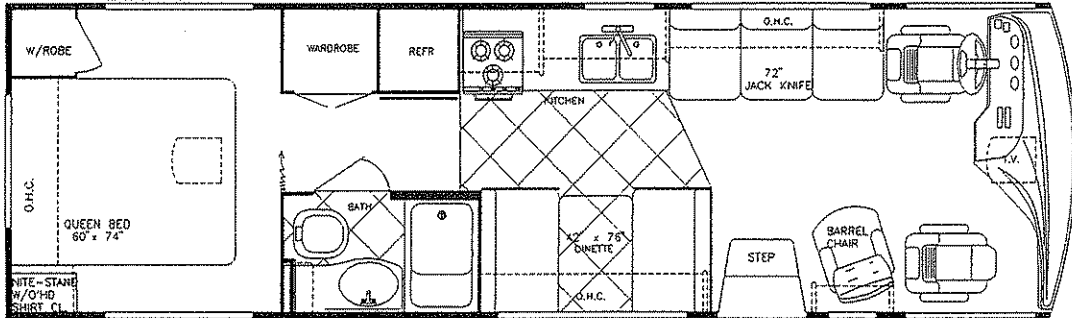

Model 8314 SYG (Approx 31'-0" 95" Wide)

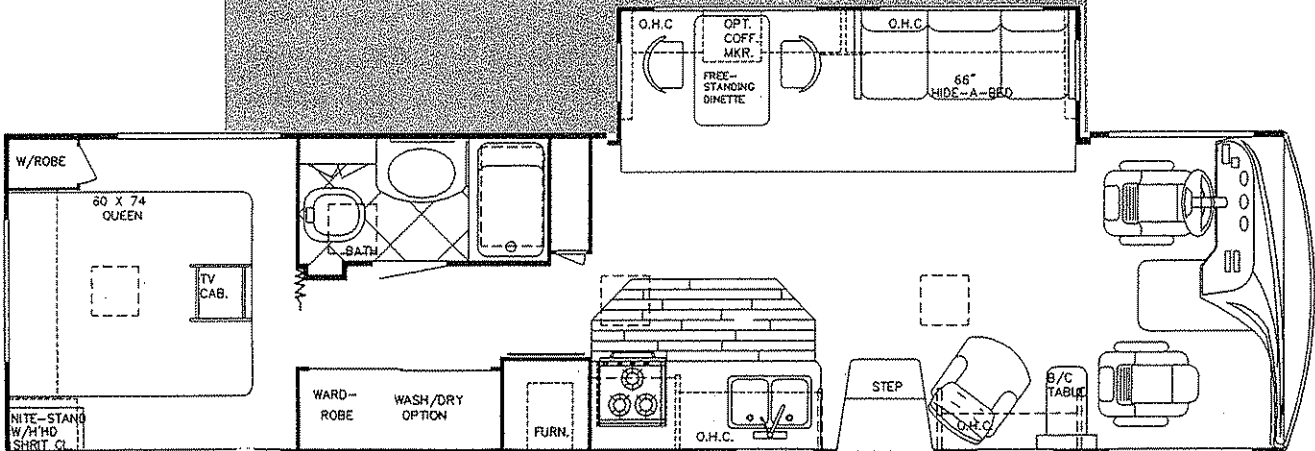

Model 8342 SYG (Approx 34'-8" 95" Wide)

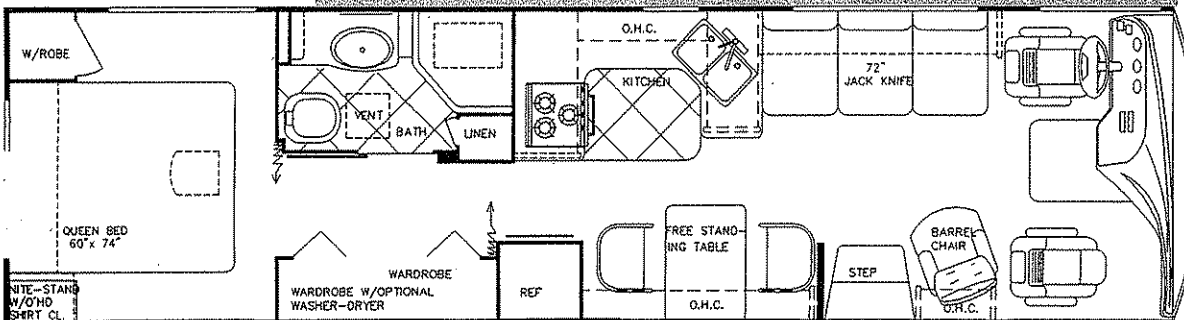

Model 8349 MXG (Approx 33'-8" 101" Wide)

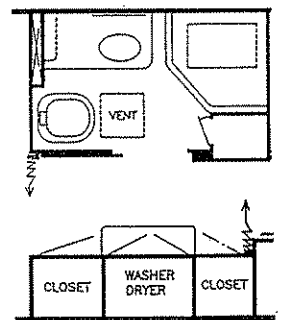

Optional Washer/Dryer

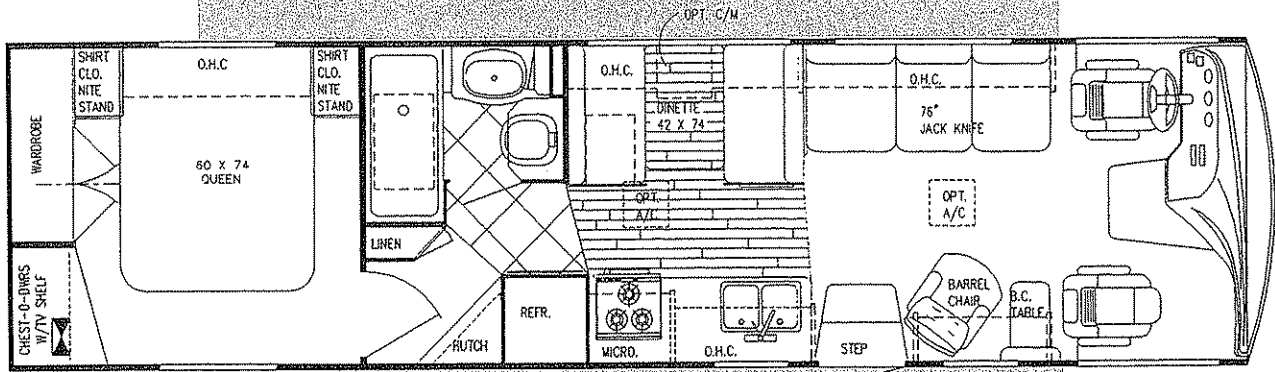

Model 8352 MGC (Approx. 34'6" x 101' Wide)

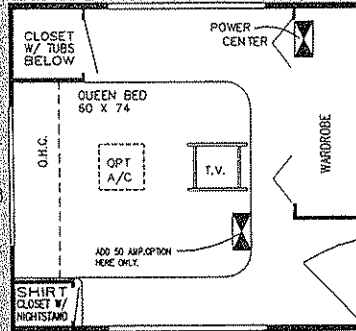

Opt. MGA

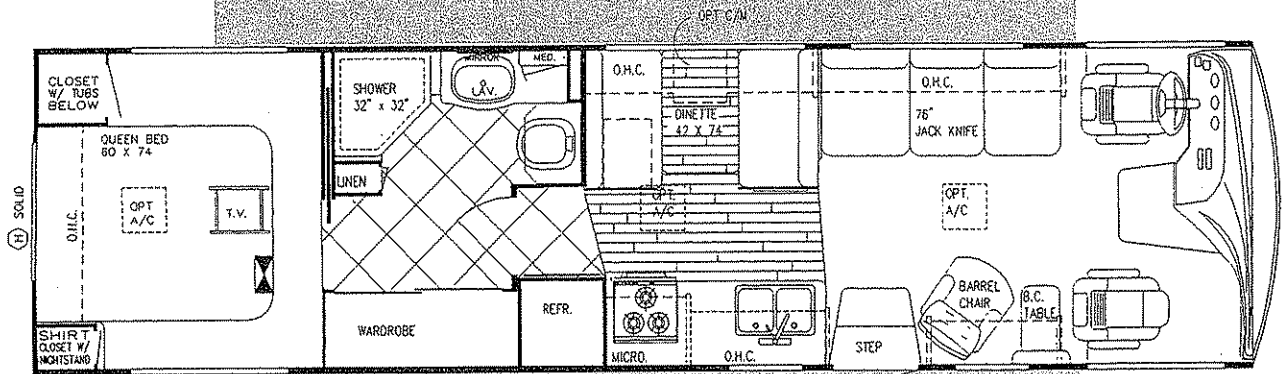

Model 8352 MGB (Approx. 34'6" x 101' Wide)

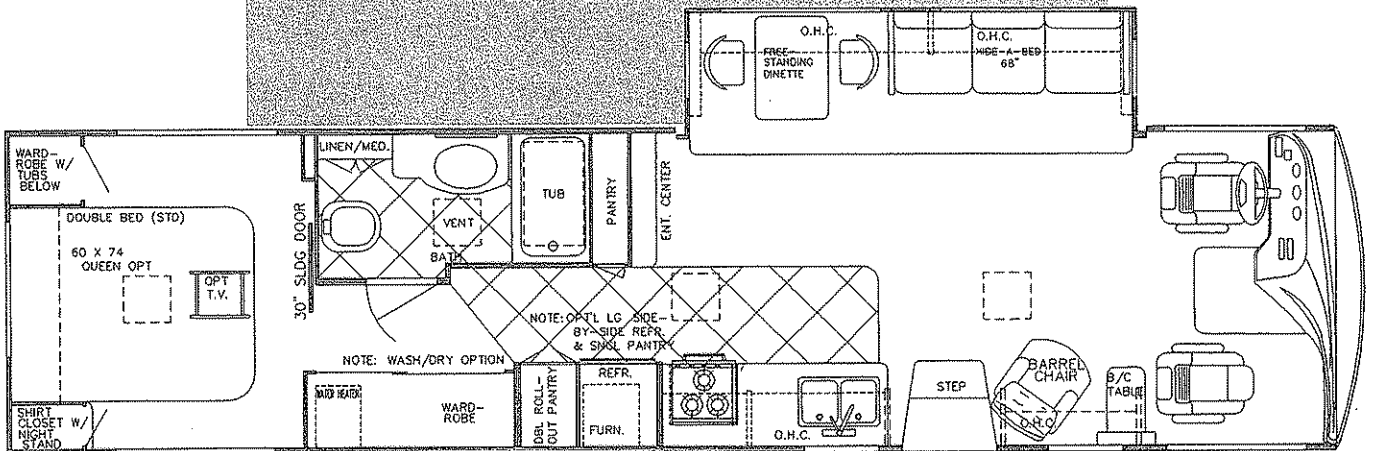

Model 8362 MXG (Approx. 37'6" x 101' Wide)

# Sun Voyager

3 MODELS	8314	8342	8349	8352	8362
<b>FORD Chassis:</b>					
Engine CID V8 (HP)	460	460	460	460	460
Wheelbase	190"	216"	208"	208"	208"+43"
GVWR (lbs.)	17,000	17,000	17,000	17,000	19,500
Front Gross Axle Wt. Rating	6,000	6,000	6,000	6,000	6,000
Rear Gross Axle Wt. Rating	11,000	11,000	11,000	11,000	13,500 (tag)
<b>CHEVROLET Chassis:</b>					
Engine (HP)	454	454	454	N/A	N/A
Wheelbase	190"	178"+43"	208"	N/A	N/A
GVWR (lbs.)	16,500	18,500	16,500	N/A	N/A
Front Gross Axle Wt. Rating	5,500	5,500	5,500	N/A	N/A
Rear Gross Axle Wt. Rating	11,000	13,500 (tag)	11,000	N/A	N/A
<b>DIMENSIONS:</b>					
Overall Length	31' 0"	34' 3"	33' 8"	34' 6"	37' 6"
Overall Height w/Roof A/C	11' 11"	11' 7"	11' 7"	11' 7"	11' 7"
Overall Width	95"/101"	95"	101"	101"	101"
Interior Height	80"	80"	80"	80"	80"
Interior Width	91"/97"	91"	97"	97"	97"
<b>CAPACITIES:</b>					
Fresh Water Tank (Gal.)	48	52	48	50	48
Grey Holding Tank (Gal.)	40	45	45	45	45
Black Holding Tank (Gal.)	40	45	45	45	45
Water Heater w/DSI (Gal.)	6	6	6	10	6
LP Gas Tank (lbs.)	85	85	85	85	85
Fuel Tank (Gal.) Ford/Chevy	75/60	75/60	75/60	75	75
Furnace (BTU's)	35K	40K	40K	40K	40K

## Interior and Decor

- Beautiful Oak Cabinet Doors & Paneling
- 22" Metal Drawer Guides w/Nylon Rollers
- Silverware Drawer and Drawer Front
- Knife Holder in Kit. Countertop
- Radius Cabinet & Wall Corners
- Windshield Privacy Drape
- Deluxe Furniture
- 3-Way Driver & Passenger Seats
- Deluxe Carpet W/Pad
- Coordinated Bedspread & Shams
- Lighted Closets
- Decorator Mirror
- Generous Overhead Storage
- Extra-Large Under-Bed Storage (most models)
- Pleated Shades

## Electrical Systems

- Easy-Access Dual Battery System
- 12-volt, 45-Amp Converter
- Electric Supply Cord
- Electric Overload Protection
- Automotive-Type, Color-Coded Wiring
- Lighted Entry & Aisle Lights
- Directional Reading/Map Lights
- Battery Disconnect

## Exterior and Construction

- **"Cradle of Strength" Construction:**
  - 1-1/2" x 1-1/2" Tubular Steel Sub-Floor Truss Superstructure
  - 1-1/2" x 1-1/2" Tubular Steel Laminated Floors w/Metal UnderBelly
  - Vacuum-Bond Laminated 2" Thick Floor and Wall Construction
- High-Density Block Foam Insulation Throughout
- Radiused Laminated Rubber Roof w/Tubular Aluminum Rafters
- Molded Roof Brick Insulation in Roof, Surrounding Ducted Roof A/C Vents
- Heated & Fully Enclosed Holding Tanks
- Automotive-Style Bumpers
- Generous Pass-Through Basement Storage
- Hinged Exterior Storage Doors
- Tri-Mark Exterior Storage Compartment Latches & Locks
- Fully Welded Steel Firewall
- Below Floor Storage Area's are Constructed of Galvanized Steel (not plywood or plastic)

## Bath and Water

- Demand Water System
- City Water Hook-Up
- Dbl. Stainless Steel Sink (Kitchen)
- Sink Covers
- Tub/Shower Combination - Most Models
- Mirrored Medicine Cabinet
- Super-Flow Manifold Water Distribution System
- Deluxe Pedal Stool w/Sprayer
- Sky Dome
- Glass Shower Enclosure (8293, 8324, 8352B)

## Appliances

- 3-Burner High-Performance Range
- Lighted Power Range Hood
- Dbl. Door, 2-Way Refrigerator
- Large Microwave Oven (Opt.)

## Heating & A/C

- Ducted Furnace w/Elect. Ignition (See Chart for BTU's)
- Pre-Wired for Ducted Roof A/C

# SPECIFICATIONS

DIESEL MODELS	8293	8313	8324	NOTES:
<b>SPARTAN Chassis:</b>				
Engine (HP)	210	210/275	210/275	
Wheelbase	172"	190"	190"	
GVWR (lbs.)	19,000	19,000/23,000	19,000/23,000	
Front Gross Axle Wt. Rating	7,000	7,000/8,000	7,000/8,000	
Rear Gross Axle Wt. Rating	12,000	12,000/15,000	12,000/15,000	
<b>DIMENSIONS:</b>				
Overall Length	31' 4"	33' 8"	33' 8"	
Overall Height w/Roof A/C	11' 11"	11' 11"	11' 11"	
Overall Width	95"	95"	95"	
Interior Height	80"	80"	80"	
Interior Width	91"	91"	91"	
<b>CAPACITIES:</b>				
Fresh Water Tank (Gal.)	52	52	52	
Grey Holding Tank (Gal.)	40	40	40	
Black Holding Tank (Gal.)	40	40	40	
Water Heater w/DSI (Gal.)	6	6	6	
LP Gas Tank (lbs.)	85	85/115	85/115	
Fuel Tank (Gal.)	80	80	80	
Furnace (BTU's)	35K	35K	35K	

## Gas Models

- Electronic Ignition
- Power Steering & Brakes
- High-Capacity Auto. Heater
- Tilt Steering Wheel
- Tag Axle System (8362, 8342)

## Diesel Models

- Spartan EC 2000, 19,000 lb. GVWR Chassis w/Cummins 6BT 5.9, 210HP @2500 RPM 520 ft.lb. Torque @1600 RPM Turbo-Charged Rear Mounted Diesel Engine
- Allison AT-542 4-Speed Automatic Transmission
- Air Over Hydraulic 15" Dia. Front & Rear Disc Brakes w/ Air Actuated, Spring-Applied Parking Brake
- Full Air-Ride Suspension
- 275 HP @ 2500 RPM, 605 ft. lb. Torque @ 1700 RPM, Turbo-Charged Rear Mounted Diesel Engine w/6-Speed Allison World Transmission (Opt. on 8313, 8324)

## Deluxe Standard Features

- Auto Dash Air Conditioner
- Auto Cruise Control
- Wheel Covers
- AM/FM Cassette w/4 Spkrs.
- Monitor Panel
- Power Vent in Commode
- Converter w/Battery Charger
- Auxiliary Battery
- 19" Color TV in Front Overhead
- Carbon Monoxide Detector
- TV Antenna
- LP Gas Leak Detector
- Awning Rail

## Popular Options

- Drivers Door (gas models)
- Exterior Radio/Cassette Compartment
- Wood Plank Flooring
- 6-Panel Oak Refrigerator Inlay
- Countertop Extension (formica only)
- Maple Cabinetry Interior
- SVB Package: Upgrade Exterior Graphics, Upgrade Front & Rear Caps, Solid Surface Countertops, Hardwood Flooring And More!

Your Dealer:

For further information and available floorplan options, contact your local dealer or Gulf Stream Coach, Inc. Gulf Stream Coach, Inc. reserves the right to make changes in prices, colors, materials, components and specifications and to discontinue models at anytime without notice or obligation. Gulf Stream Coach, Inc. assumes no responsibility for any error in type or print reproduction of specifications or floorplans in this brochure.

TP 20M 2/98 © 1998 Gulf Stream Coach, Inc. - Nappanee, Indiana



GULF STREAM COACH, INC.  
P.O. Box 1005 • Nappanee, IN 46550  
Visit our Web Site at:  
[www.GULFSTREAMCOACH.com](http://www.GULFSTREAMCOACH.com)