

# TOUR MASTER<sup>LC</sup><sup>®</sup>

## GULF STREAM

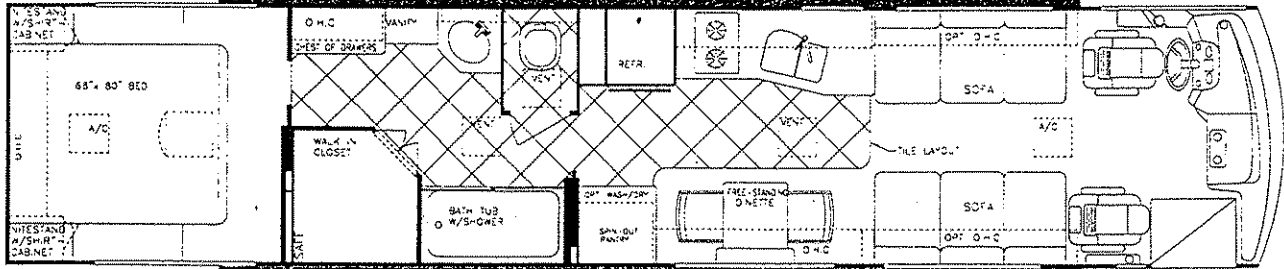

**MODEL 8400**

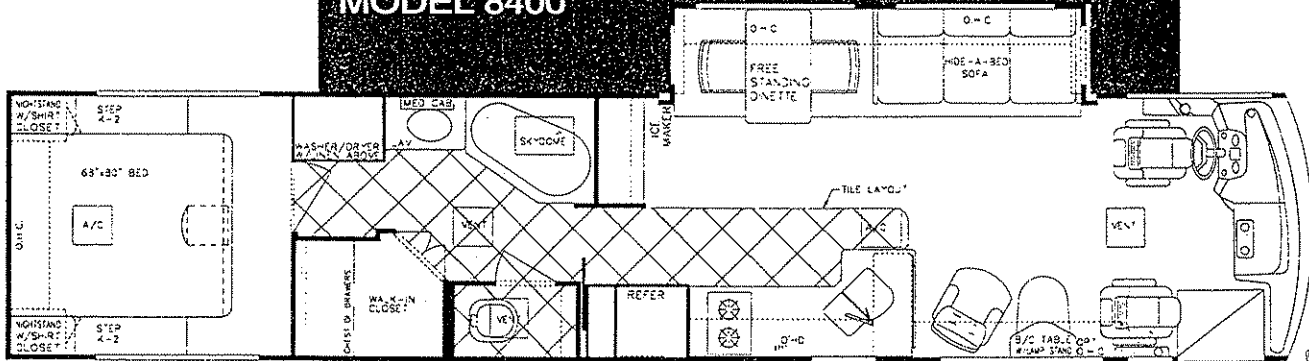

**MODEL 8403**

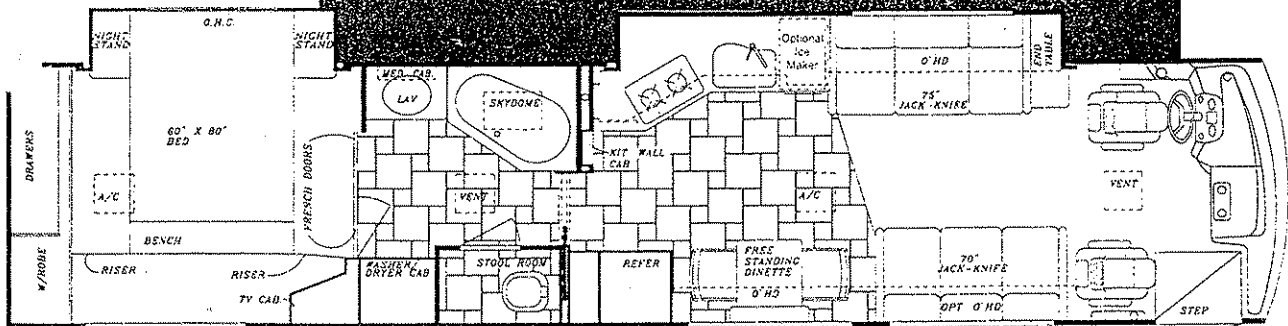

**MODEL 8404**



Opt. Barrel Chairs

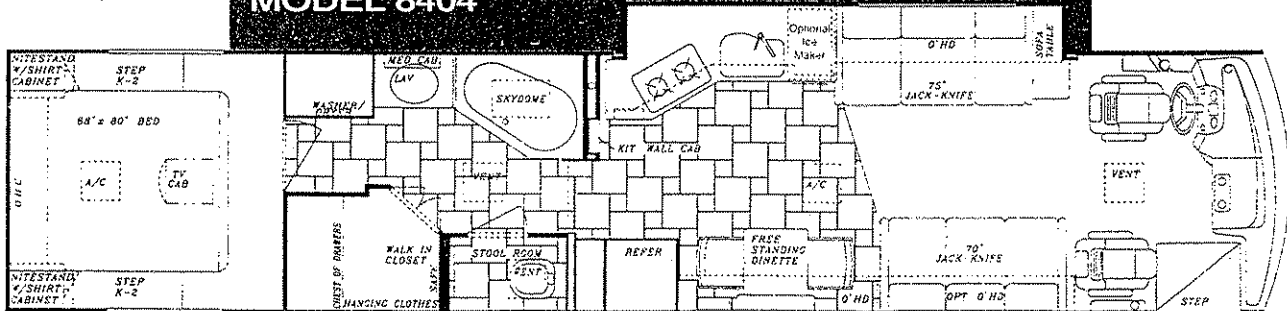

**MODEL 8405**

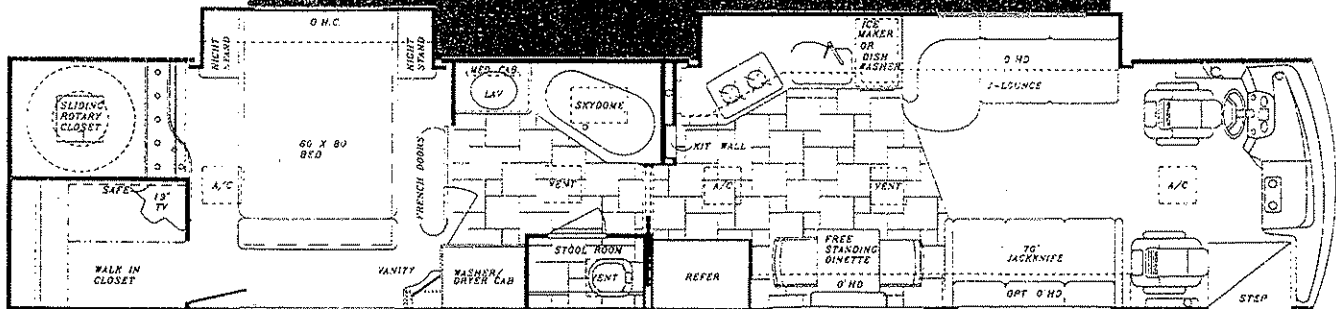

**MODEL 8430**

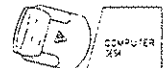

Opt. Computer Desk

# TOUR MASTER LUXURY COACH

## Exterior and Construction Cont'd.

- Full Body Undercoating
- Fully-Welded Steel Firewall
- Sealed Perimeter & Engine Compartment
- Seamless, One-Piece Radiused
- Rubber Roof w/Thick R-17 Insulation
- Roof Lag-Bolted Every 8" or Less to Sidewalls
- Super-Slick Gel-Coat Fiberglass Exterior
- Panoramic One-Piece, Clearview Windshield
- Tinted Windshield & Windows
- Deluxe 4-Color Paint Scheme w/Contemporary Graphics & Full Clear Coat
- Outstanding Side-to-Side, Pass-Through Carpeted and Lighted Exterior Storage
- Back-Up Alarm System
- Single Key Locks on All Exterior Doors
- Full Width Rear Mud Flap
- Power Front Entry Steps
- Hydraulic Power Unit w/Manual Override (Slide Models Only)
- Power Front Window Wiper System w/Delay
- Deluxe Black Vinyl Snap-On Front Bra
- Slide-Out Generator Panel
- Deep Tinted Exterior Windows w/Screens
- Chrome Exterior Vents for Radiator & Engine Compartment Doors

## Electrical System

- Slide-Out Coach & Chassis Batteries
- Electrical Supply Cord -- 50 Amp (30 Amp Cord on CSA)
- Electric Overload Protection
- Automotive-Type Color-Coded Wiring
- Deluxe AM/FM Stereo Cassette in Dash
- Lighted Entry Way
- Directional Overhead Reading Lights
- Positive Battery Shut-Off Switches for Coach and Chassis
- Electric Step w/Elec. Sliding Step Cover
- 7.5 Onan Quiet Diesel Generator on Automatic Front Slide-Out Tray
- Deluxe Stereo System with 10-CD Player
- Infrared Remote
- Individual Exterior Porch Lights
- Vista Mood Lights Throughout
- Enclosed Chassis & Exterior Fuse Centers
- Phone Jacks in LVRM, BDRM, & Bath

## Electrical System Cont'd.

- 2000 Watt Power Invertor
- Halogen Fog and Driving Lights
- Power TV Antenna w/Amp.
- Remote Generator Start Switches in Dash and Bedroom
- 12-Volt Solar Charge Panel
- Dual Slide Room Safety Switches
- Emergency Battery Start Switch
- Smoke Detector
- Carbon Monoxide Detector
- Electronic Holding Tank Monitor System
- Deluxe Electronic Entertainment Selector Switches
- Push Button Labeled Coach & Dash Switches
- 4 Speakers and Subwoofer
- Mirrored Ceiling w/Vista Mood Lights
- DSS Satellite Cable Prep

## Heating, Ventilation & A.C.

- Dual 35,000 BTU Furnaces
- Dual 13,500 BTU Ceiling Ducted A/C (3 on 8430)
- Built-In Overhead Defrost Fans
- Electronic Thermostat Control System
- In-Dash A/C and Heater w/Electronic Driver and Passenger Zone Controls
- Heated & Insulated Basement and Tanks

## Bath and Water

- Whirlpool Tub/Bath
- Storage Cabinet in Commode Area
- Porcelain Commode w/Spray Nozel
- Dual Holding Tanks -- Approx. 50 Gal. Each
- Fresh Water Tank -- Approx. 100 Gal.
- Manifold Water Distribution System (N/A w/CSA)
- Washer/Dryer Prep
- Demand Water System
- City Water Hook-Up
- Double-Bowl Solid Surface Sink
- Solid Surface Sink Covers in Kitchen
- Fiberglass Shower w/Gold-Tone Shower
- Mirrored Medicine Cabinet in Bath
- Gravity Drains on Fresh Water Lines
- 10 Gal. Gas/Electric Water Heater
- Water Purification System
- Holding Tank Power Flush System

# GULF STREAM'S NEW GENERATION CRADLE OF STRENGTH

1. Seamless Rubber Roof For Greater Energy Efficiency and Dependability.

2. Luan Decking for Additional Strength.

3. Molded E.P.S. Brick Insulation Provides Consistent Insulative Value As Well As Superior Dimensional Rigidity.

4. One-Piece Formed Aluminum Air Conditioning Duct, Completely Surrounded By Polystyrene Insulation.

5. Bubble-Wrapped Foil Insulation Provides Superior Insulation.

6. Rugged Heavy-Gauge Welded Metal Tubular Roof Framing.

7. Soft Touch Ceiling Fabric for Added Sound Insulation.

8. Aluminum Cove Molding.

9. Bubble-Wrapped Foil Insulation Minimizes Thermal Transfer.

10. Rugged Roll-Formed Steel Roof-to-Sidewall Transition Member Insures Structural Integrity and Stability.

11. Die-Stamped Steel Transition Member Gusseting Provides Greater Strength and Structural Integrity.

12. Rugged Heavy-Gauge Metal Tubing, Fixture Welded to Form the Sidewall Framing.

13. High-Density E.P.S. Insulation Provides Superior Laminating and Bonding Characteristics and Insures Greater Energy Efficiency.

14. Interior Wall Panels Securely Laminated to Sidewall Framing.

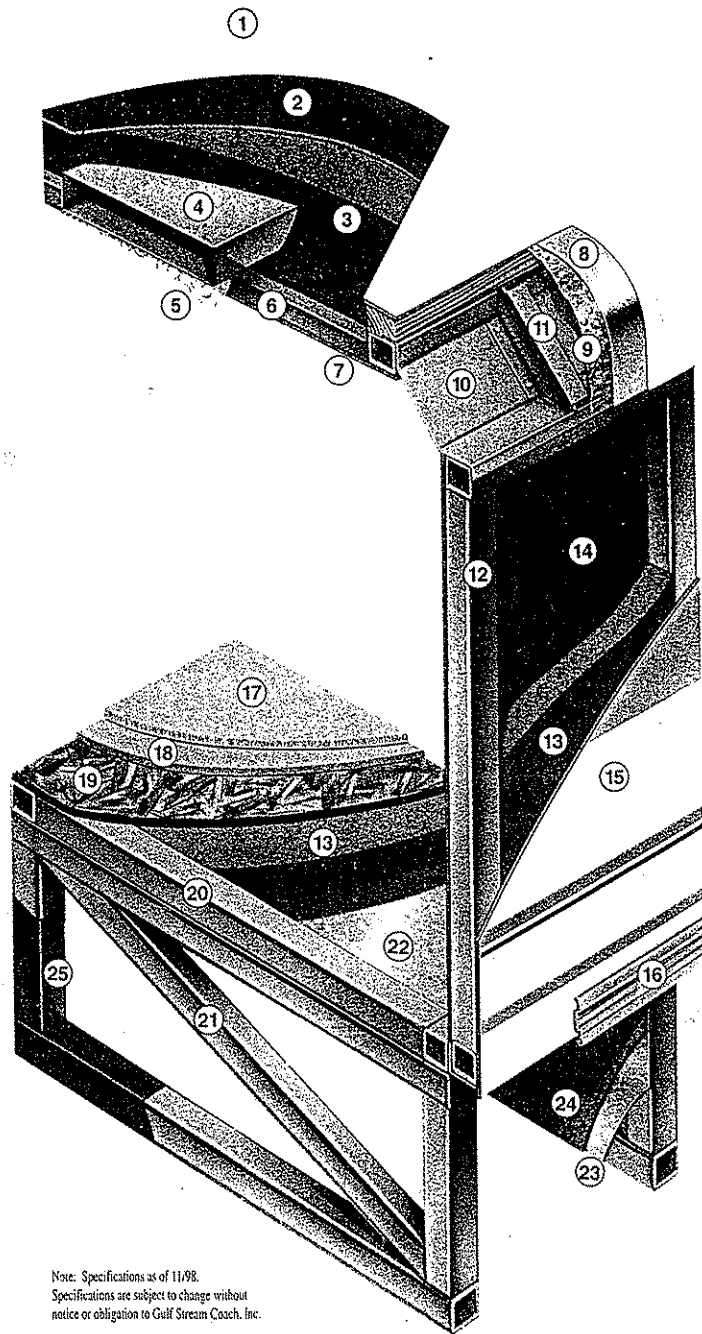

Note: Specifications as of 11/98.  
Specifications are subject to change without  
notice or obligation to Gulf Stream Coach, Inc.

15. "Mende" Fiberglass Exterior, Vacuum Bond Laminated to Sidewall Framing for Lasting Beauty and Durability.

16. Aluminum Trunk Door Hinge Extrusion Provides A Tight Seal Discouraging Air or Water Infiltration.

17. High-Quality Stain-Resistant Carpeting Available in Designer-Coordinated Colors.

18. Extra-Thick Padding Under Carpet Provides Extra Comfort and Increased Carpet Durability.

19. Continuous Structurewood Floor Decking Laminated to Steel Floor Structure Assures a Quiet, Long-Lasting, Rigid Floor

20. Heavy-Gauge Steel Tube Floor Fixture Welded for Extra Strength and Stability.

21. Heavy-Gauge Tubular Steel Framing, Fixture Welded Sub-Floor Truss System Provides the Strongest Motorhome Foundation in the Industry.

22. Seamless Layer of Galvanized Steel Securely Laminated to the Steel Floor Framing.

23. Galvanized Steel Used to Form Each Storage & Holding Compartment.

24. Durable All-Weather Carpeting Completes Each Accessible Storage Compartment, Providing Extra Protection for Luggage and Valuables.

25. Rust-Prohibitive Paint Coating Applied to All Steel Framing Assures Corrosion and Rust Protection.



# GULF STREAM - BUILT TO LAST!

# SPECIFICATION INFORMATION

## Apliances

- 2-Burner High-Output Recessed Range w/Covers
- Large, 4-Door, Flush-Mounted Refrigerator
- Microwave/Convection Oven w/Recirculation Kit
- 27" Color TV In Dash w/Power Lift Elevator
- 13" Color TV in Bedroom
- VCR in Front Overhead
- Coffee Maker
- CB Antenna

## Diesel Chassis

- Spartan (IFS) Independent Front Suspension
- C-Channel Type, Raised-Rail Steel Chassis Frame
- Stemco Seals - Bearings Lubricated w/Oil (not grease)
- 14-Gauge Ultra-High Temperature Wire w/Circuit Description Every 3"
- 4-Point V-Pad Engine Mount - Reduces Vibration
- Side-Mounted Rochester Fuel Gauge
- Grau-Midland Anti-Lock Brake System
- Air Brakes w/Midland Pure Air Plus Heated Air Dryer
- Full Air-Ride Suspension w/Automatic Leveling Sys. Cummins ISC 8.3 Engine w/ 330 HP, 950 ft./lb. Trq.
- Turbo Charged & After Cooled Air Injection Sys.
- Allison MD 3060P 6-Speed Electronically Shifted Automatic Transmission
- Tilt & Telescoping Douglas Steering Wheel Column
- High Capacity Automotive A/C & Heater
- Four 10-Stud, 11.25 BC Alcoa Aluminum Wheels w/265/75RX225 Radial Tires

## K2 Diesel Chassis

- 450 HP, 11 Liter Cummins Engine, 1450 Ft./Lb. Torque, Allison HD4060 6-Speed Electronic Transmission, 276" Wheel Base, 11R 22.5 Radial Tires (See Chart for K2's with tag axle info)

## Deluxe Standard Features

- Thermopane Windows
- Exterior Awnings Standard Throughout
- Electronic Cruise Control w/Power Speed Adjustments
- 3 Fantastic Fans w/Rain Sensors in Kitchen & Bath
- Auxiliary Batteries
- Keyless Front Door Entry (Key Fob)
- LPG Leak Detector
- Chrome Heated and Remote Mirrors
- Power Side-Mounted Sun Visors
- Power Up and Down Back-Up Monitor in Front Overhead Console
- Deluxe Passenger Side Console w/Drink Holder, Thermostat Control, Ashtray, Fire Extinguisher and Map Pocket
- French Doors in All Bedrooms w/Privacy Shades

## 43' Model Features (Only on 8430)

- AquaHot Hydronic Heating System
- One-Piece Fiberglass Roof
- Soft-Touch Interior Vinyl Ceiling
- Energy Management System
- Automatic Carousel Clothes Rack System

## POPULAR OPTIONS

- Wet Sand Buff Paint, 7 Color Paint Scheme w/Bird
- Storage Compartment Slide Trays
- Exterior Entertainment Center
- 50 Amp Power Cord Reel (n/a tag models)
- Sculptured Carpet w/Bird Logo
- Your Choice of Fine Villa Leather Furniture
- Overhead Cabinets in Living Room
- Combo Washer/Dryer
- Icemaker in Kitchen Cabinet
- Icemaker in 4-Door Refrigerator
- 50 lb. Freezer on Slide Tray in Basement
- Exterior Ladder
- Acrylic "Coach Armor" Front Bra
- Satellite Dish System
- Satellite In Motion System
- Camping Simulation P.D.I. (Ask Dealer...)

Your Dealer:

For further information and available floorplan options, contact your local dealer or Gulf Stream Coach, Inc. Gulf Stream Coach, Inc. reserves the right to make changes in prices, colors, materials, components and specifications and to discontinue models at any time without notice or obligation. Gulf Stream Coach, Inc. assumes no responsibility for any error in type or print reproduction of specifications or floorplans in this brochure. TP 2.5M 5/99 ER © 1999 Gulf Stream Coach, Inc. - Nappanee, Indiana

\*NOTE: GCWR's are limited by hitch weight capacities used by the manufacturer. Gulf Stream installs a 5,000 lb. hitch. Check your Spartan Owners Manual for additional towing weight capacities

For more information, call  
1-800-289-8787, ext. 3288

Visit our Web Site at:  
[www.GULFSTREAMCOACH.com](http://www.GULFSTREAMCOACH.com)



P.O. Box 1005 • Nappanee, IN 46550