



By
Open Range



Model: LF318RLS Shown with Diego Decor



FIFTH WHEELS







Model: LT308BHS Shown with Steel Decor



TRAVEL TRAILERS





LT305BHS



LT274RLS



LT274RLS



Model: LT308BHS



Outside Kitchen



LT274RLS Island Table on Castors





SLIDE-OUT SYSTEM

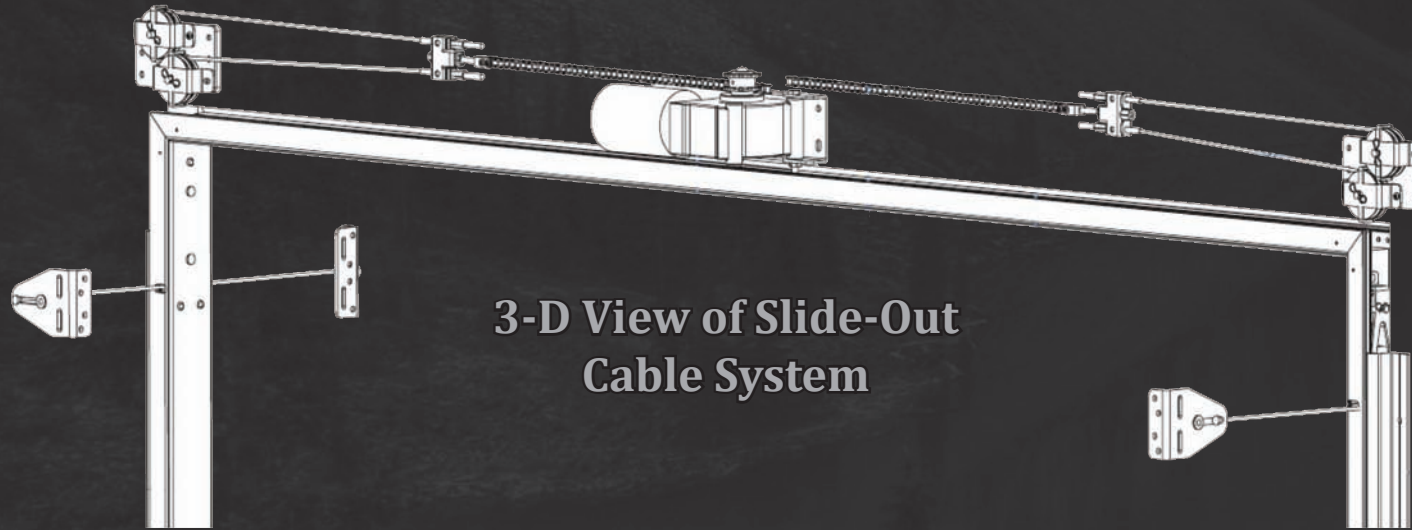

3-D View of Slide-Out
Cable System

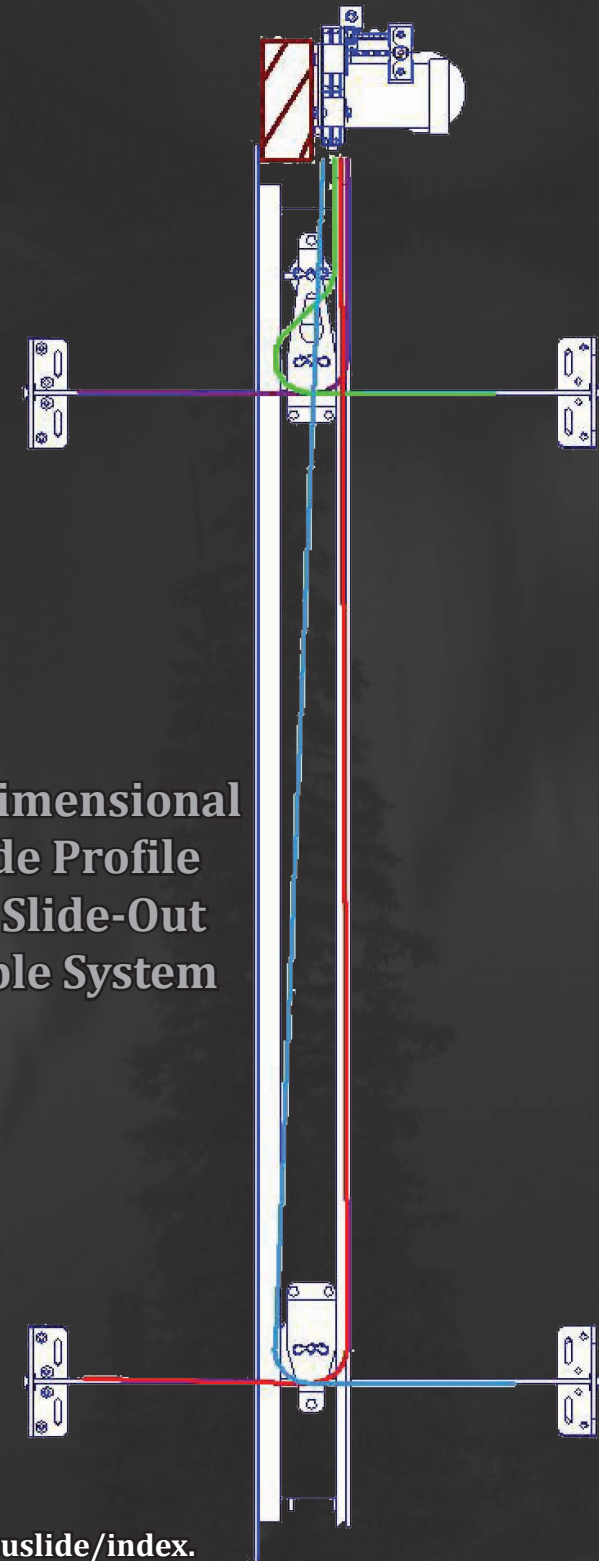

1- Dimensional
Side Profile
Of Slide-Out
Cable System

10 Reasons Why... Accu-Slide

1. Above floor design means more storage area for your RV
2. Lightweight design promotes fuel savings
3. High strength stainless steel aircraft cable is used for control
4. Cable control at all 4 room corners helps stop leaks
5. Working components are in your RV, safe from the elements
6. Locking motor secures room in or out to help stop leaks
7. Above floor design minimizes maintenance requirements
8. A clean system - no leaky hydraulic lines or greasy drives
9. Smooth, quiet room movement - no jumping or jerking
10. It's built in the U.S.A. and backed by BAL since 1972

For more information please visit: <http://norcoind.com/bal/products/oem/accuslide/index>.

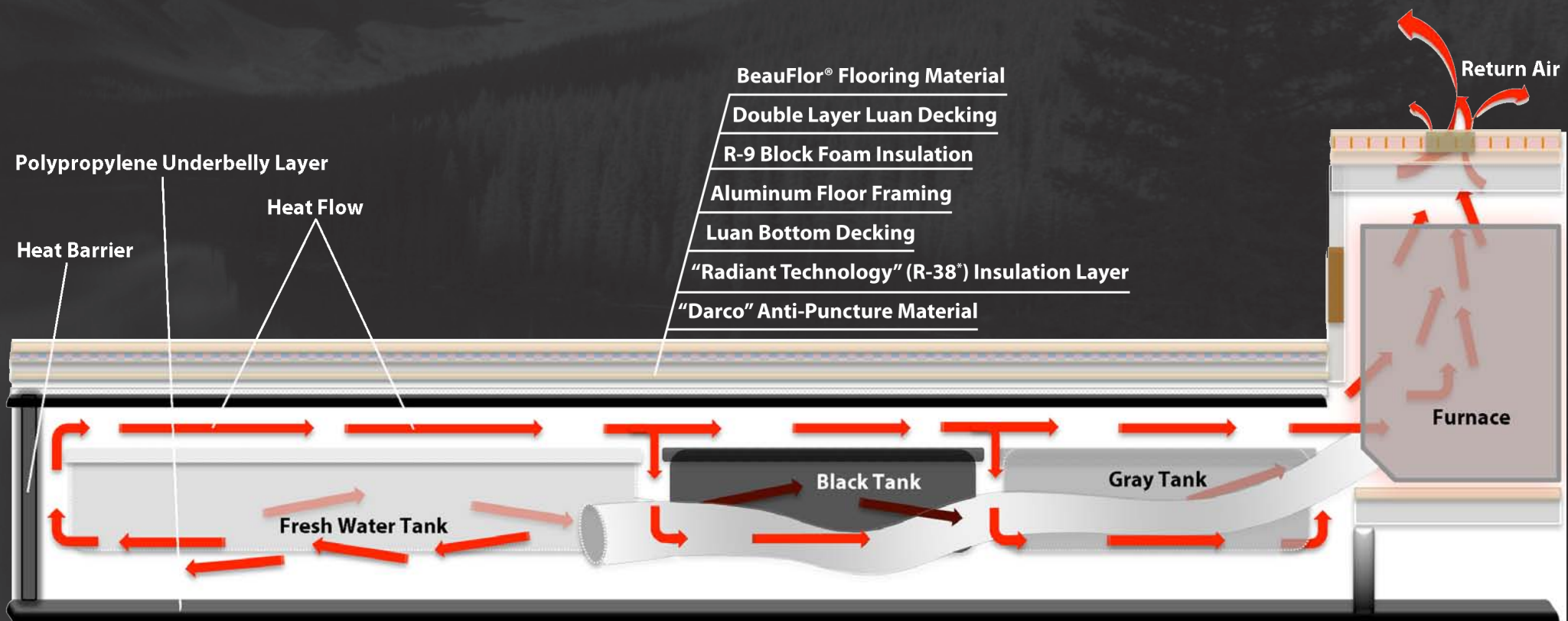

**Light Fifth Wheel Diagram Shown*

HEATING SYSTEM:

The Light product line has the most efficient heating system in the industry. The extra large 4" heat duct hose is placed right next to the fresh water tank. The suspended holding tanks are specifically designed to allow for heat to surround all sides adequately as it moves throughout the belly area. As the heat moves it reflects off of a "heat barrier" that is installed just behind the rear tank to keep the heat isolated to the tank area only. As the heat reflects, it moves its way forward where the heat naturally rises and then returns back into the camper through a return air vent. This system keeps the heat isolated, delivering as much heat to the tanks as possible while returning back into the camper for propane efficiency and maximum performance!

TRAVEL TRAILER CONSTRUCTION

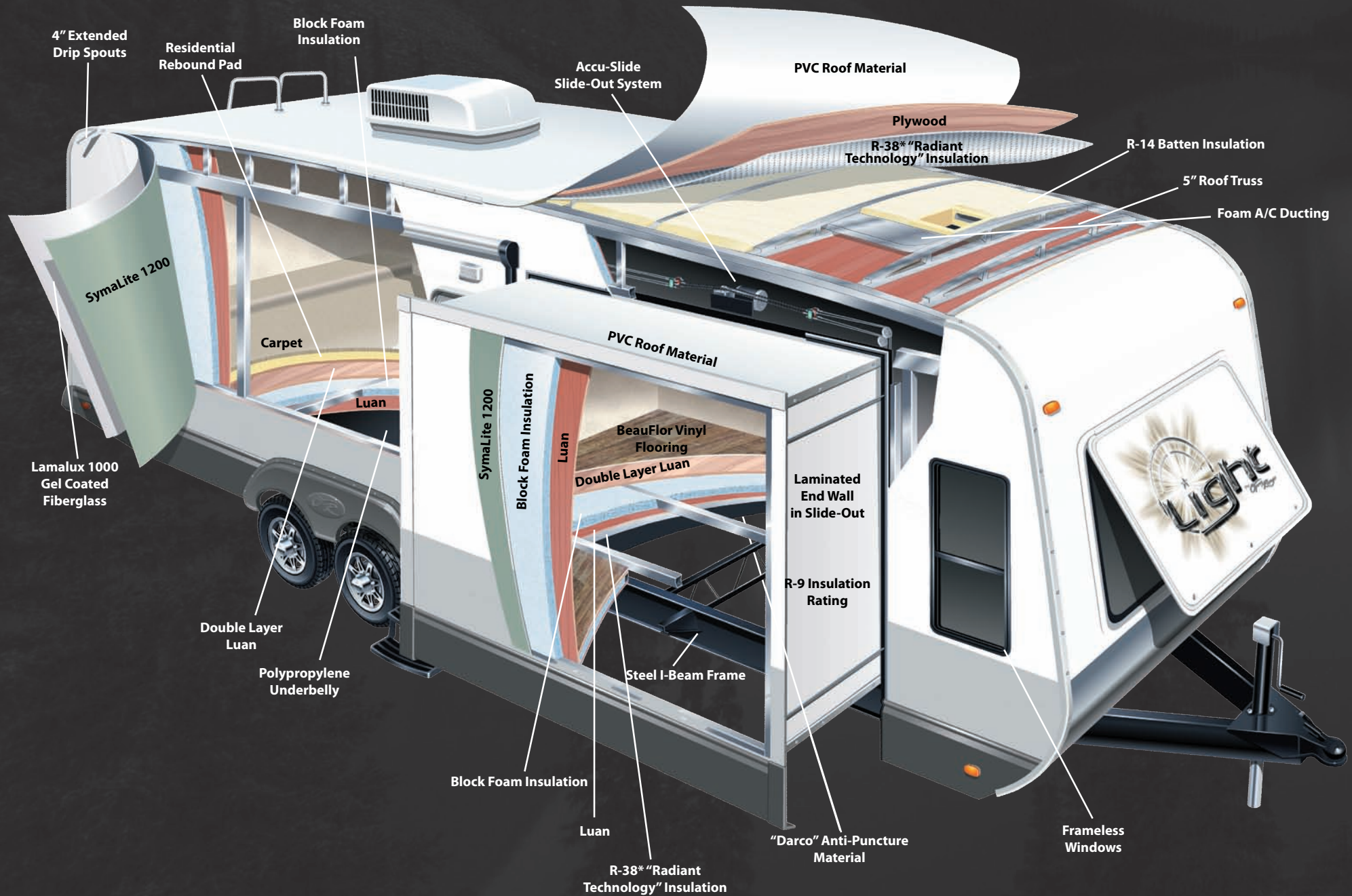

STANDARD FEATURES:

- EXTERIOR UTILITY CENTER W/ BLACK TANK FLUSH
- EQUA FLEX SUSPENSION
- CONTOURED FRONT CAP W/ 90° TURN IN 5.5' BED (LF, LX)
- FRONT & REAR STABILIZER JACKS
- GEL COATED FIBERGLASS WALLS
- 60 LBS OF LP CAPACITY (LT 40 Lbs)
- 100" WIDE BODY FRAME
- PVC ROOF MATERIAL
- 50 AMP SERVICE
- NITROGEN FILLED RADIAL TIRES
- "KING COMBO" PIN BOX (LF, LX)
- "MAXX AIR" VENT COVER
- 15" ALUMINUM WHEELS
- 42" DEEP MAIN SLIDE
- WASHER/DRYER PREP (SELECT FLOORPLANS)
- GENERATOR PREP CAPABLE (LF)

EXECUTIVE PACKAGE: (MANDATORY)

- FLAT SCREEN TV IN LIVING AREA
- 12v CD/DVD/MP3/AM/FM/iPod STEREO
- MULTI-PORT SATELLITE HOOK-UP
- DIGITAL TV ANTENNA W/ BOOSTER
- CAREFREE OF COLORADO POWER AWNING
- HEAVY DUTY FULL EXTENSION DRAWER GUIDES
- KNOTTY ALDERWOOD CABINET DOORS
- WIRED AND FRAMED FOR 2ND A/C IN BEDROOM
- LP QUICK CONNECT
- FULL VIEW VENTED ENTRANCE DOOR
- CONCEALED HINGES
- LED LIGHTING IN CEILING
- CROWN MOLDING
- LED TAILLIGHTS
- FRAMELESS WINDOWS

FOUR SEASONS PACKAGE: (MANDATORY)

- R-38* INSULATION IN ROOF & FLOOR
- R-9 INSULATION IN SIDEWALL
- ATWOOD® HIGH PERFORMANCE FURNACE
- HEATED AND ENCLOSED UNDERBELLY
- DOUBLE INSULATED BAGGAGE DOORS
- HEATED STORAGE AREA
- DIGITAL THERMOSTAT
- INSULATED SLIDE FLOORS
- HEATED DUMP VALVES

2-Year Limited Transferable Warranty

*CALCULATED

OPTIONS:

- 26" BEDROOM TV
- FIREPLACE (SELECT FLOORPLANS)
- DYSON VACUUM CLEANER
- ADDITIONAL FANTASTIC FAN
- 2 RECLINERS IPO SWIVEL ROCKERS (SELECT FLOORPLANS)
- ALL DARK WOOD
- TWO ADDITIONAL FOLDING CHAIRS (SELECT FLOORPLANS)
- 8 CU FT REFRIGERATOR
- OTTOMAN W/ STORAGE (U-LOUNGE OPTION)
- 15K BTU MAIN A/C
- 2ND A/C (13.5K BTU DUCTED)
- DUAL PANE WINDOWS
- LP GENERATOR PREP (LF)
- BBQ GRILL
- POWER TONGUE JACK (LT)
- POWER REAR STABILIZER JACKS
- LOCK ARM STABILIZER BARS
- U-LOUNGE IPO DINETTE/SOFA (SELECT FLOORPLANS)

Optional U-Lounge



**PLEASE CONTACT YOUR LOCAL DEALER TO ENSURE AVAILABILITY OF STANDARDS AND OPTIONS ON A SPECIFIC FLOORPLAN.

INTERIOR DECORS:



BLOOM



Sofa
Recliner
Booth Dinette
U-Booth/U-Lounge Seat



DIEGO



Sofa
Recliner
Booth Dinette
U-Booth/U-Lounge Seat



STEEL



Sofa
Recliner
Booth Dinette
U-Booth/U-Lounge Seat

FIFTH WHEELS



LX SERIES:



LF289RES



LF297RLS

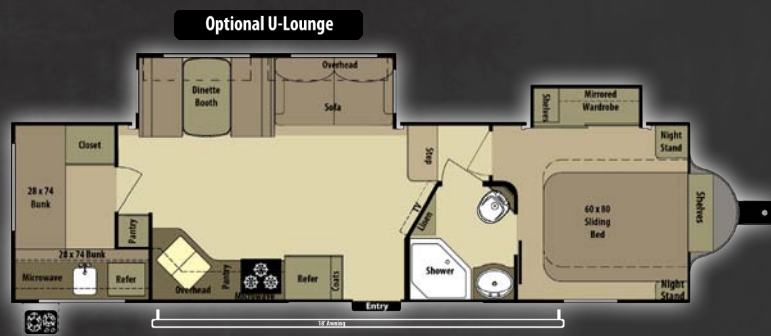

LF305BHS



LF318RLS

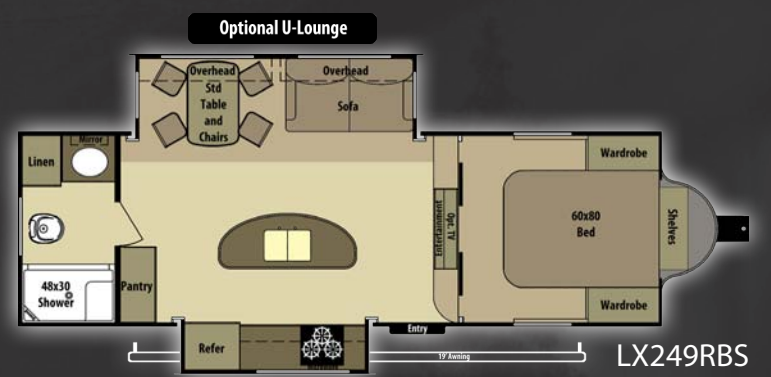

LX249RBS



LX269BHS

	GVWR	UVW	Hitch Wt.	Axle Wt.	Gross NCC	Ext. Length	Ext. Height	Fresh Water	Gray Water	Waste	Furnace (BTU's)
LF289RES	9995	7885	1320	6565	2110	31'3"	149"	50	62	31	34,000
LF297RLS	9995	7465	1265	6200	2530	31'3"	149"	50	62	31	34,000
LF305BHS	9995	7940	1400	6540	2055	34'8"	149"	50	62	31	34,000
LF318RLS	9995	7945	1510	6435	2050	33'5"	149"	50	62	31	34,000
LX249RBS	9875	7325	1075	6250	2550	30'9"	149"	50	62	31	34,000
LX269BHS	9880	7645	1080	6565	2235	31'11"	149"	50	62	31	34,000

TRAVEL TRAILERS

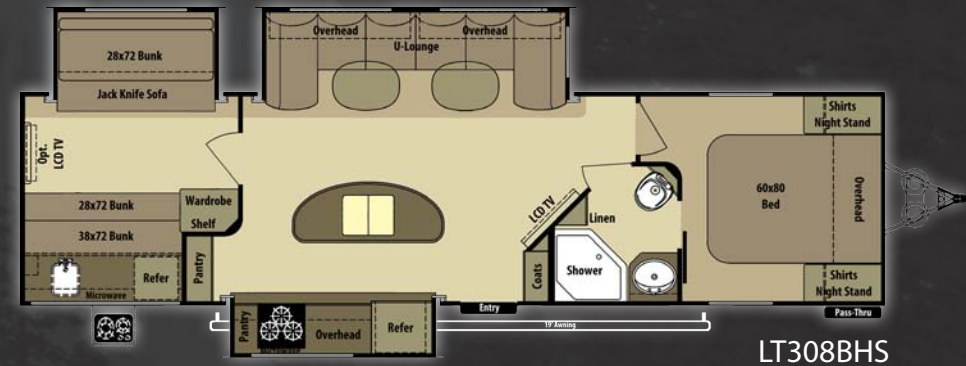
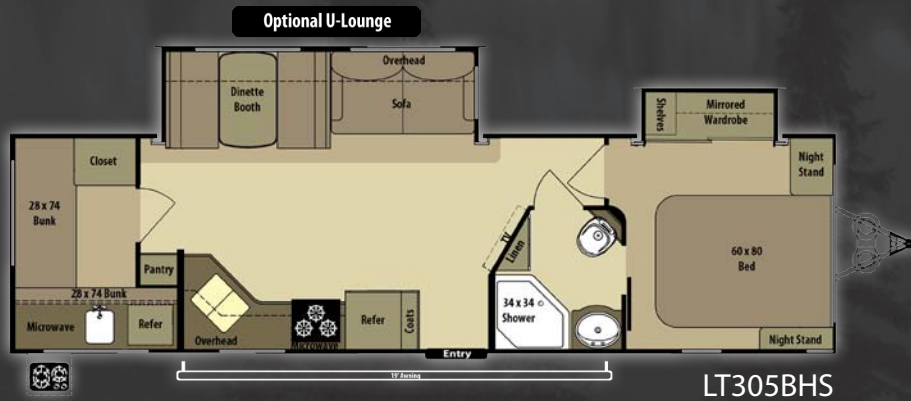

	GVWR	UVW	Hitch Wt.	Axle Wt.	Gross NCC	Ext. Length	Ext. Height	Fresh Water	Gray Water	Waste	Furnace (BTU's)
LT246RBS	8800	6480	615	5865	2320	29'6"	138"	50	62	31	30,000
LT274RLS	8800	6265	720	5545	2535	31'3"	138"	50	62	31	30,000
LT305BHS	9595	6805	795	6010	2790	34'4"	138"	50	62	31	30,000
LT308BHS	9995	8510	940	7570	1485	36'10"	138"	50	62	31	30,000

Visit Us @ www.OpenRangeRV.com

- "Build Your Own"
- Detailed Floorplans & Specs
- Contact Information
- Photo Galleries
- Frequently Asked Questions
- Customer Testimonials
- Virtual 360° Videos
- Dealer Locator
- And Much More



OPEN RANGE

Open Range RV Company 3195 N. St. Rd. 5 Shipshewana, IN 46565

Phone: (260) 768-7771 - www.OpenRangeRV.com

Due to continual research and advances, manufacturer reserves the right to change specifications, design, price, and equipment without notice, and assumes no responsibility for any error in the literature. Some items shown are not included as standard or optional equipment

©2012 Open Range RV Company, Shipshewana, Indiana

Published Date: Dec. 14th, 2012

PURCHASE LOCALLY

Open Range RV strongly encourages our retail customers to purchase from their local dealership whenever possible due to the following reasons:

1) Our Dealers are, as a rule, independently owned and operated businesses. Outside of those customers they personally sold products to, they are not obligated to perform warranty service on Open Range RV products that were purchased elsewhere. There may be an occasion that the customer will be required to return to the point of purchase to satisfy warranty requirements.

2) Although many dealerships will eventually service products not purchased at their dealership, they will usually take care of their customers and other Open Range RV customers who are traveling away from their local dealer as a priority.

3) Local purchases allow a customer to establish a relationship with a dealer close to home. This relationship provides the customer with a convenient location for service and support from a "local" professional.

4) The opportunity for a thorough PDI (Pre Delivery Inspection) and product orientation is an additional benefit of buying from a local dealer. The opportunity for refresher courses or the ability to get questions answered more promptly is another additional benefit of buying from a local dealer.

5) For our Canadian customers, there are also requirements which must be met to bring an RV purchased out of the country to their home. Although not impossible, these requirements may involve such things as additional inspections, certifications, taxes and fees. The local Canadian Dealer is a professional at meeting these requirements.

6) Open Range's goal is for all RV Owners to fully enjoy their RV experience. In light of this goal, and considering the advantages of buying locally, we encourage you to be thorough when determining what product to purchase and which dealer to purchase it from as both are key to your ultimate satisfaction.

Your Open Range Dealer: