

Roader





Model RF387RLS Shown with Pinto Decor

Roamer^s
FIFTH WHEELS





RF387RLS



RF337RLS



RF367BHS



Model: RF367BHS



Outside Kitchen



LED Awning Light





Model RT320RES Shown with Silt Decor

Roamer
TRAVEL TRAILERS





RT320RLS



RT320RLS



Model: RT291RLS



Outside Cook Center





SLIDE-OUT SYSTEM

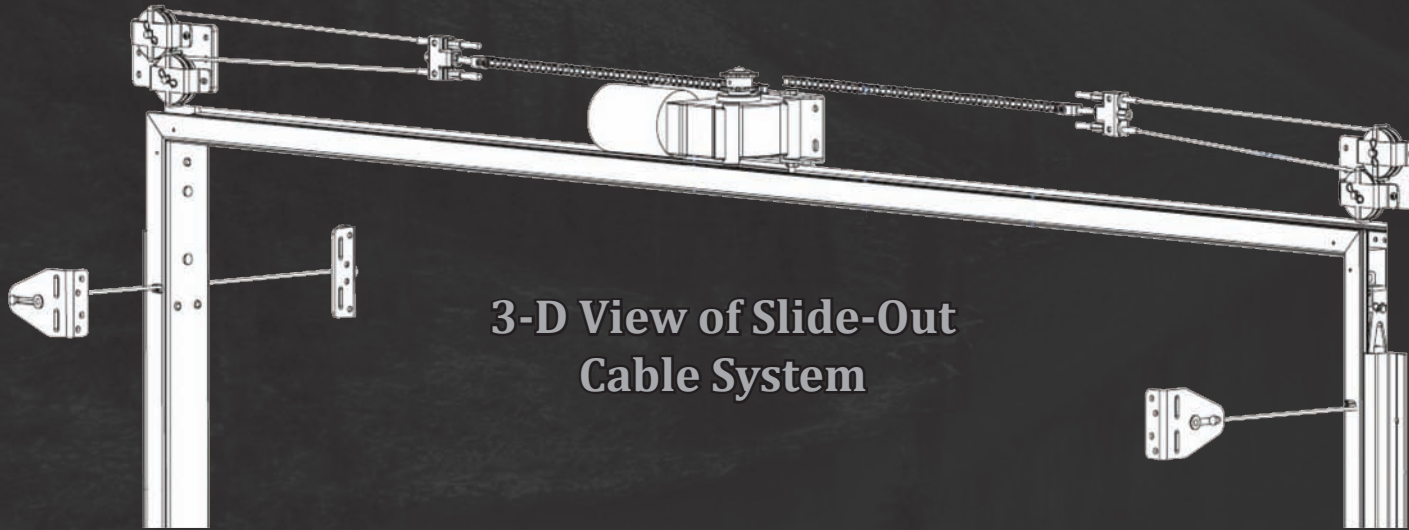

**3-D View of Slide-Out
Cable System**

10 Reasons Why... Accu-Slide

1. Above floor design means more storage area for your RV
2. Lightweight design promotes fuel savings
3. High strength stainless steel aircraft cable is used for control
4. Cable control at all 4 room corners helps stop leaks
5. Working components are in your RV, safe from the elements
6. Locking motor secures room in or out to help stop leaks
7. Above floor design minimizes maintenance requirements
8. A clean system - no leaky hydraulic lines or greasy drives
9. Smooth, quiet room movement - no jumping or jerking
10. It's built in the U.S.A. and backed by BAL since 1972

**1- Dimensional
Side Profile
Of Slide-Out
Cable System**

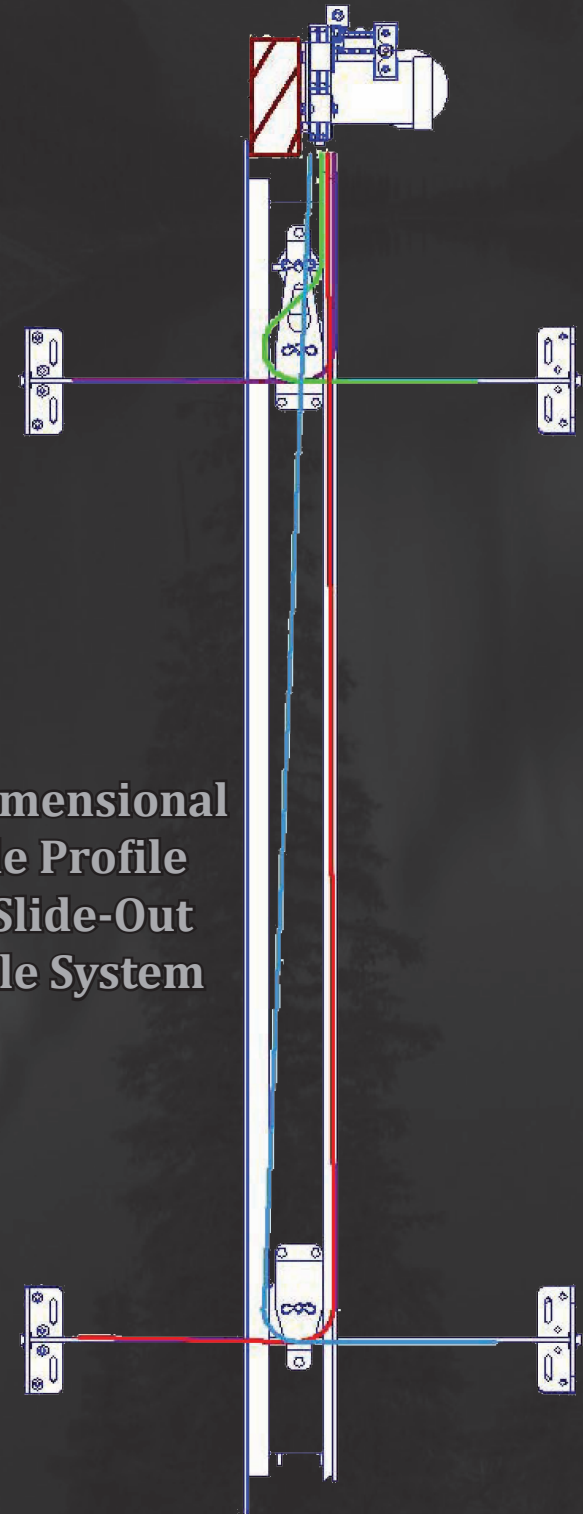

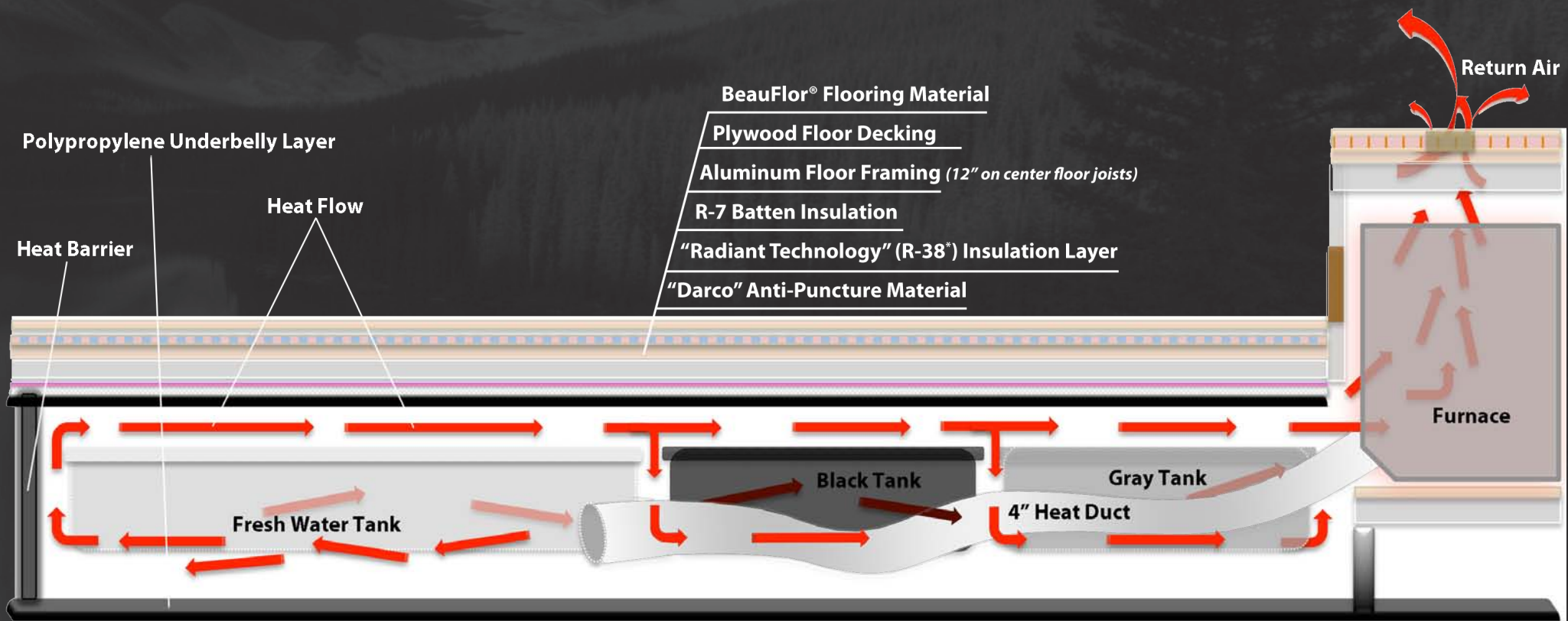

**Roamer Fifth Wheel Diagram Shown*

HEATING SYSTEM:

The Roamer product line has the most efficient heating system in the industry. The extra large 4" heat duct hose is placed right next to the fresh water tank. The suspended holding tanks are specifically designed to allow for heat to surround all sides adequately as it moves throughout the belly area. As the heat moves it reflects off of a "heat barrier" that is installed just behind the rear tank to keep the heat isolated to the tank area only. As the heat reflects, it moves its way forward where the heat naturally rises and then returns back into the camper through a return air vent. This system keeps the heat isolated, delivering as much heat to the tanks as possible while returning back into the camper for propane efficiency and maximum performance!

FIFTH WHEEL CONSTRUCTION

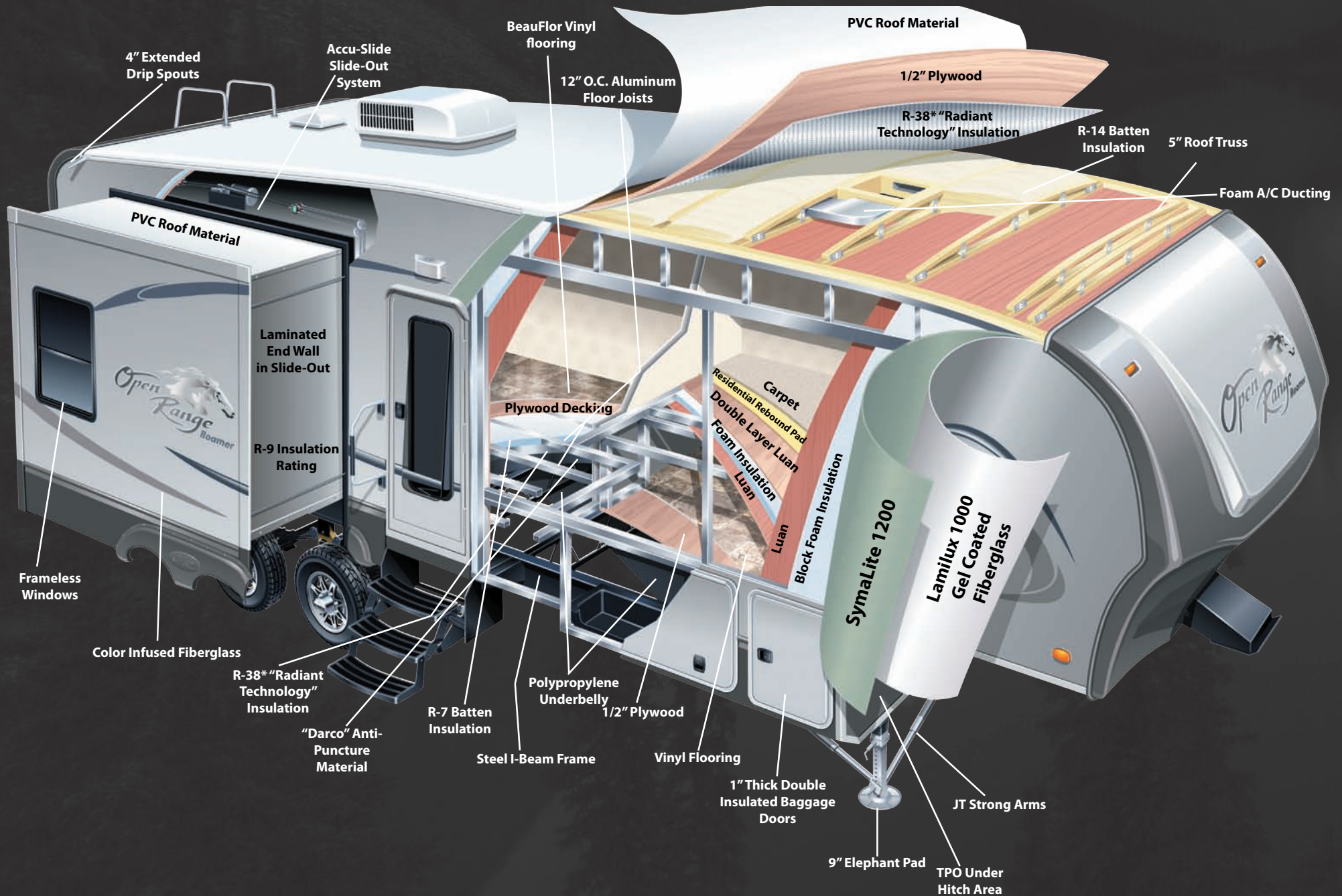

OPTIONS:

- **26" BEDROOM TV**
- **FIREPLACE** (Most Floorplans)
- **DYSON VACUUM CLEANER**
- **ADDITIONAL FANTASTIC FAN**
- **RECLINERS IPO SWIVEL ROCKERS** (Most Floorplans)
- **ALL DARK WOOD**
- **2 BAR STOOLS**
- **2ND A/C** (13.5k BTU Ducted)
- **DUAL PANE WINDOWS**
- **BBQ GRILL**
- **U-LOUNGE IPO TABLE & CHAIRS/SOFA**
(SELECT FLOORPLANS)

Optional U-Lounge



FIFTH WHEELS ONLY

- **LP GENERATOR PREP**
- **CEILING FAN**
- **DINETTE BOOTH IPO TABLE & CHAIRS**
- **CORIAN® ISLAND ON CASTORS**
- **12 CU. FT. REFER**

TRAVEL TRAILERS ONLY

- **8 CU. FT. REFRIGERATOR**
- **POWER TONGUE JACK**
- **POWER FRONT & REAR STABILIZER JACKS**
- **LOCK ARM STABILIZER BARS**
- **15k BTU MAIN A/C**

****PLEASE CONTACT YOUR LOCAL DEALER TO ENSURE AVAILABILITY OF STANDARDS AND OPTIONS ON A SPECIFIC FLOORPLAN.**

STANDARD FEATURES:

- **HEAVY DUTY FULL EXTENSION DRAWER GUIDES**
- **LARGE LAVATORY SINK**
- **PORCELAIN TOILET W/ FOOT PEDAL FLUSH**
- **EXTERIOR UTILITY CENTER W/ BLACK TANK FLUSH**
- **DEXTER EZ LUBE AXLES (FW)**
- **DEXTER EZ FLEX SUSPENSION (FW)**
- **LP QUICK CONNECT**
- **80 LBS OF LP CAPACITY (FW)**
- **100" WIDE BODY FRAME**
- **PVC ROOF MATERIAL**
- **NITROGEN FILLED RADIAL TIRES**
- **50 AMP SERVICE**
- **"MAXX AIR" VENT COVER**
- **FRONT & REAR STABILIZER JACKS (TT)**
- **60 LBS OF LP CAPACITY (TT)**

EXECUTIVE PACKAGE: (MANDATORY)

- **ONE-TOUCH AUTOMATIC LEVELING SYSTEM (FW)**
- **FLAT SCREEN TV IN LIVING AREA**
- **12v CD/DVD/MP3/AM/FM/iPod STEREO**
- **MULTI-PORT SATELLITE HOOK-UP**
- **DIGITAL TV ANTENNA W/ BOOSTER**
- **LARGE 8 CU FT REFRIGERATOR (FW)**
- **30" OTR MICROWAVE (FW)**
- **15,000 BTU A/C W/ "QUICK COOL" FEAT. (FW)**
- **10 GAL. GAS/ELECTRIC WATER HEATER (FW)**
- **CORIAN® COUNTERTOPS (FW)**
- **FANTASTIC FAN IN KITCHEN (FW)**
- **CAREFREE OF COLORADO POWER AWNING**
- **LED AWNING LIGHT (FW)**
- **CONCEALED HINGES**
- **KNOTTY ALDERWOOD CABINET DOORS**
- **LED LIGHTING IN CEILING**
- **CROWN MOLDING**
- **WIRED AND FRAMED FOR 2ND A/C**
- **FULL VIEW VENTED ENTRANCE DOOR**
- **FRAMELESS WINDOWS**

FOUR SEASONS PACKAGE: (MANDATORY)

- **R-38* INSULATION IN ROOF & FLOOR**
- **R-9 INSULATION IN SIDEWALL**
- **ATWOOD® HIGH PERFORMANCE FURNACE**
- **HEATED AND ENCLOSED UNDERBELLY**
- **DOUBLE INSULATED BAGGAGE DOORS**
- **HEATED STORAGE AREA**
- **DIGITAL THERMOSTAT**
- **INSULATED SLIDE FLOORS**
- **HEATED & ENCLOSED DUMP VALVES**

*CALCULATED

2-Year Limited Transferable Warranty

INTERIOR DECORS:



PINTO



Sofa
Recliner
Booth Dinette
U-Lounge Seat



SEDONNA



Sofa
Recliner
Booth Dinette
U-Lounge Seat



SILT



Sofa
Recliner
Booth Dinette
U-Lounge Seat



STORM



Sofa
Recliner
Booth Dinette Seat
U-Lounge Seat

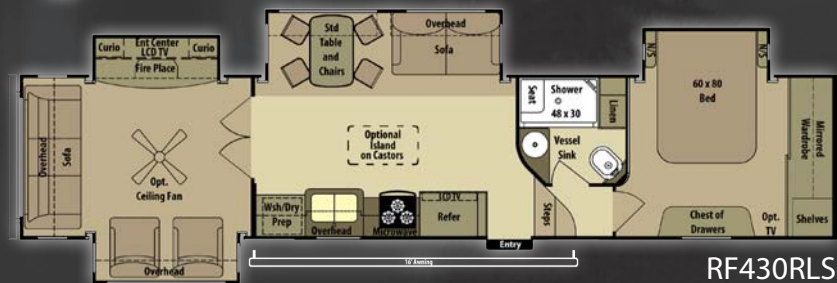
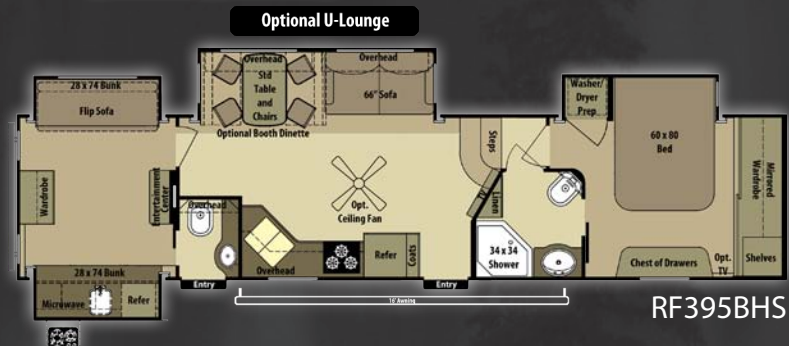

Roamer

Fifth Wheels

	GVWR	UVW	Hitch Wt.	Axle Wt.	Gross NCC	Ext. Length	Ext. Height	Fresh Water	Gray Water	Waste	Furnace (BTU's)
RF316RLS	10795	8570	1995	6575	2225	30'10"	155"	85	82	41	35,000
RF337RLS	12340	8840	1940	6900	3500	33'6"	155"	85	57	41	35,000
RF338RLS	12455	9640	2055	7585	2815	35'4"	155"	85	82	41	35,000
RF357RES	12575	9555	2175	7380	3020	35'2"	155"	85	57	41	35,000
RF367BHS	14060	10640	2060	8580	3420	36'10"	155"	85	62	41	35,000
RF387RLS	14281	10375	2281	8094	3906	37'	155"	85	82	41	35,000
RF395BHS	15995	11295	2010	9285	4700	39'4"	155"	85	74	74	40,000
RF430RLS	15600	11755	2425	9330	3845	39'4"	155"	85	82	41	40,000

Roamer Travel Trailers

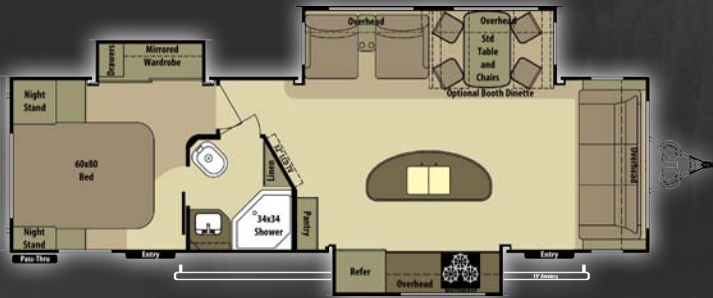

RT288FLR

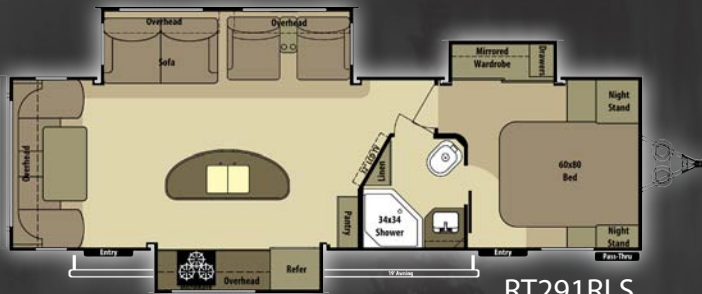

RT291RLS

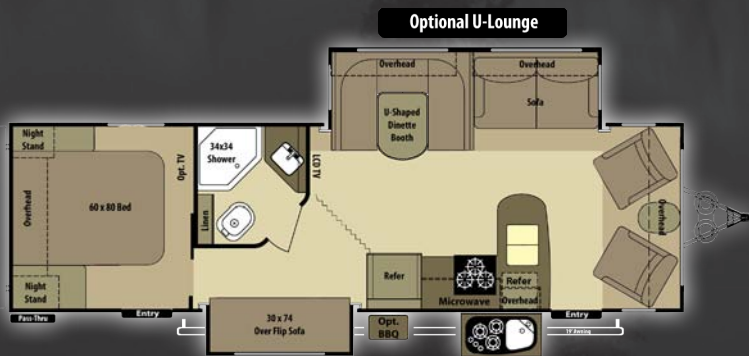

RT302BHS

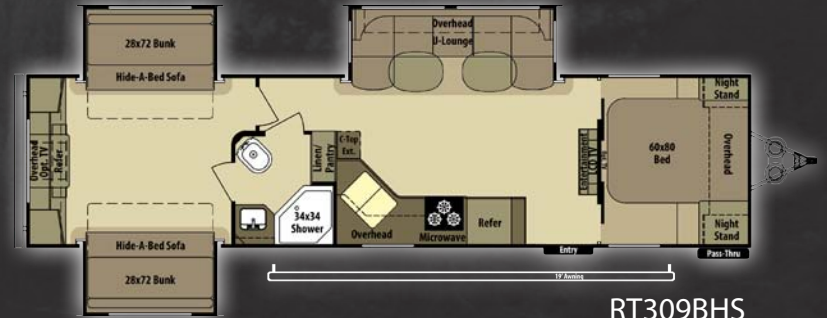

RT309BHS



RT316RLS



RT320RES

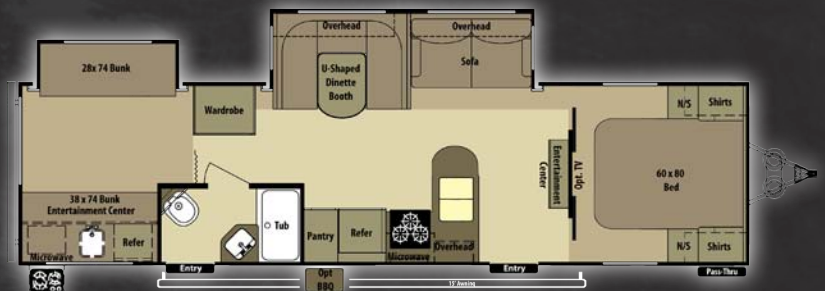

RT331BHS

	GVWR	UVW	Hitch Wt.	Axle Wt.	Gross NCC	Ext. Length	Ext. Height	Fresh Water	Gray Water	Waste	Furnace (BTU's)
RT288FLR	9800	7480	1000	6480	2320	33'6"	140"	50	60	30	30,000
RT291RLS	9795	7710	995	6715	2085	33'6"	140"	50	60	30	30,000
RT302BHS	9775	7655	975	6680	2120	33'	140"	50	60	30	30,000
RT309BHS	11375	8955	975	7980	2420	37'10"	140"	50	57	31	30,000
RT316RLS	9990	7760	1290	6470	2230	33'8"	140"	50	57	30	30,000
RT320RES	9990	7365	845	6520	2625	34'9"	140"	50	60	30	30,000
RT331BHS	10495	8140	875	7265	2355	36'8"	140"	60	60	30	30,000

Visit Us @ www.OpenRangeRV.com

- "Build Your Own"
- Detailed Floorplans & Specs
- Contact Information
- Photo Galleries
- Frequently Asked Questions
- Customer Testimonials
- Virtual 360° Videos
- Dealer Locator
- And Much More



OPEN RANGE

Open Range RV Company 3195 N. St. Rd. 5 Shipshewana, IN 46565

Phone: (260) 768-7771 - www.OpenRangeRV.com

Due to continual research and advances, manufacturer reserves the right to change specifications, design, price, and equipment without notice, and assumes no responsibility for any error in the literature. Some items shown are not included as standard or optional equipment

©2012 Open Range RV Company, Shipshewana, Indiana

Published Date: Dec. 14th, 2012

PURCHASE LOCALLY

Open Range RV strongly encourages our retail customers to purchase from their local dealership whenever possible due to the following reasons:

1) Our Dealers are, as a rule, independently owned and operated businesses. Outside of those customers they personally sold products to, they are not obligated to perform warranty service on Open Range RV products that were purchased elsewhere. There may be an occasion that the customer will be required to return to the point of purchase to satisfy warranty requirements.

2) Although many dealerships will eventually service products not purchased at their dealership, they will usually take care of their customers and other Open Range RV customers who are traveling away from their local dealer as a priority.

3) Local purchases allow a customer to establish a relationship with a dealer close to home. This relationship provides the customer with a convenient location for service and support from a "local" professional.

4) The opportunity for a thorough PDI (Pre Delivery Inspection) and product orientation is an additional benefit of buying from a local dealer. The opportunity for refresher courses or the ability to get questions answered more promptly is another additional benefit of buying from a local dealer.

5) For our Canadian customers, there are also requirements which must be met to bring an RV purchased out of the country to their home. Although not impossible, these requirements may involve such things as additional inspections, certifications, taxes and fees. The local Canadian Dealer is a professional at meeting these requirements.

6) Open Range's goal is for all RV Owners to fully enjoy their RV experience. In light of this goal, and considering the advantages of buying locally, we encourage you to be thorough when determining what product to purchase and which dealer to purchase it from as both are key to your ultimate satisfaction.

Your Open Range Dealer: