

Empress

Elite Series





www.tripleerv.com

2



Kitchen clean-up is faster and easier thanks to the optional built-in dishwasher.



Holiday in style.

Empress Elite is the cream of the crop of Triple E's deluxe recreation vehicles, boasting unparalleled design quality, deluxe comfort, distinctive furnishings and spacious floor plans. Powered by a mighty Cummins ISL 400 HP Diesel Engine on a robust Freightliner Chassis with independent front suspension, this model provides the driver with worry-free handling while passengers savour a quiet, smooth ride. With Empress Elite, don't be surprised if you enjoy the journey just as much or more than your destination.



The optional Danish Walnut cabinetry's classic rich finish adds warmth to your living space. Egyptian Sands Décor shown.



Turn out the light and sleep tight in this residential quality queen-sized bed, completely furnished with a decorative bedspread, matching throw pillows and a stylish, wood-accented headboard.



Make a reservation tonight at that cozy out-of-the-way place! The dining area's extendable solid surface table is complemented by wood-accented window treatments and pleated day/night shades.

- Danish walnut cabinetry
- Adjustable gas and brake pedals
- Rear view and side-turn cameras
- Keyless entry front entrance door
- Onan 8 KW quiet diesel generator with auto start system



Empress Elite is where casual elegance meets modern-day convenience. The generous living space and open-design galley area is as impressive as it is inviting, enhanced by optional natural cherry cabinetry. Egyptian Sands Décor shown.



The wraparound cockpit is designed to give the driver comfort, convenience and total control behind the wheel.



The traveling gourmet has plenty of room to cook in this spacious galley, featuring a solid surface countertop, slide-out counter extension, heated tile flooring and a 12-cubic foot stainless steel fridge with ice maker.



Subtle sophistication is evident in such accents as the galley's oil-rubbed bronze fixtures, stainless steel sink and solid surface countertop.



Restful and stylish, the master bedroom offers a large, cedar-lined wardrobe closet, plenty of drawer storage and a 20" LCD TV for your enjoyment.

Entertain outdoors with the optional exterior stereo and 20" LCD TV – on an extendable/swing-out mount in the extra-large exterior storage compartment.



The optional, space-saving washer/dryer combo is neatly tucked into the master bedroom.

6

www.tripleev.com



With a quick swivel of the sumptuous captain's chairs, the cockpit easily converts into a homey living area suitable for entertaining guests or for enjoying some quality relaxation.



The Empress bathroom is just as thoughtfully designed as the larger living areas, with its spacious medicine cabinet, oil-rubbed bronze fixtures, solid surface countertop and basin.

INTERIOR COMFORT AND EXTERIOR PROTECTION

Born of our northern heritage, Triple E's exclusive Climate Guard® system is quite simply the best interior comfort and exterior protection package available in the recreational vehicle industry today. The Climate Guard® system has been developed with today's motorhome enthusiast in mind. It provides year round climate controlled comfort for passengers as well as built in protection for the motorhome itself, ensuring years of trouble free operation and enjoyment.



The major considerations in building a top quality motorhome are long lasting beauty coupled with the ability to stand up to all weather conditions. The coach is an aluminium and steel framed structure with vacuum bonded gel coat fibreglass sidewalls and a domed roof finished with a seamless FRP Flexroof.

INTERIOR

- Dometic® roof air conditioners, ducted front to rear, control the temperature throughout the coach.
- High output chassis air conditioner provides travelling comfort.
- Electronic ignition furnaces designed to maintain requested interior temperatures through extreme exterior temperatures.
- High output chassis heater for quick windshield defrost.
- A rear auxiliary automotive heater – dashboard control switch – makes travel comfortable while heating the fresh water and holding tank compartments.
- Vacuum bonded, aluminium framed, insulated sidewall and roof construction provides structural strength and maintains warmth throughout the coach.
- Coach windows are designed with a dual pane construction – impeding the transfer of cold to make the interior of the window warmer and less subject to condensation.
- Optional insulated vent covers provide superior insulation for the fantastic fans and roof vents.

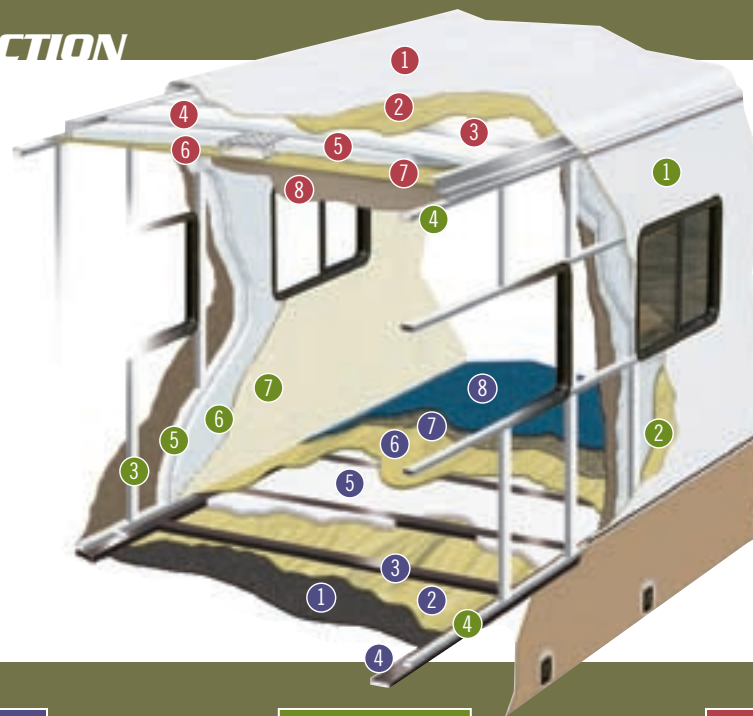

Floor

- 1 One Piece Woven Poly-Propylene Underbelly
- 2 Plywood (3/8")
- 3 Tubular Steel Framing (Welded)
- 4 Styrofoam Filled Wall Support Plates
- 5 Block Styrofoam Insulation (1")
- 6 Plywood (1/2")
- 7 Carpet Underlay
- 8 Carpeting (Floor covering)

Sidewalls

- 1 Seamless Gelcoat Fibreglass Exterior
- 2 Luan Structural Backer
- 3 Aluminium Framing (Welded)
- 4 Styrofoam Filled Floor and Roof Plate
- 5 Block Styrofoam Insulation (1")
- 6 Styrofoam Thermal Break Insulation (1/2")
- 7 Interior Decorative Luan Wall Panels

Roof

- 1 One Piece FRP Flexroof
- 2 Luan Backer
- 3 Aluminium Roof Truss
- 4 Block Styrofoam Insulation (1 1/2")
- 5 Enclosed/Insulated Climate Control Ducting
- 6 Block Styrofoam Thermal Break Insulation (2")
- 7 Plywood (3/8")
- 8 Padded Vinyl Headliner

EXTERIOR

- Scratch and hail resistant gel coat fibreglass sidewalls with all weather exterior finish are easy to maintain and will not rust, pit, or fade.
- A domed, seamless, insulated, one piece FRP Flexroof promotes quick water run off and minimizes exterior maintenance.
- Durable undercoating protects against dust and moisture and reduces stone and road noise.
- Steel enclosed, fibreglass insulated and heated fresh water and holding tanks assure extreme cold climate performance for your plumbing system. Tanks are heated from two different sources – the motorhome's ducted furnace while parked and the rear auxiliary automotive heater when travelling.
- Winterization system complete with potable antifreeze tank allows you to easily drain tanks and fill water lines with potable antifreeze.
- Steel, insulated, and sealed firewall protects the driver and passengers from the outside elements.
- Additional 1/2" thermal break insulation beyond the standard 1" Styrofoam block insulation separates the climate controlled interior from the outside elements.

COLOUR OPTIONS

8

www.tripleerrv.com



Driftwood



Riviera



Russet



Slate

Colours may not be exactly as shown due to the printing process. Please see your dealer for specific colours.

	Biltmore	Egyptian Sand	English Tudor	Whistler Lodge
Sofa				
Sofa Option				
Accent				
Captain Chairs				
Carpet				
Bedsread				

Cabinetry	
	<p>Danish Walnut</p> <p>Natural Cherry</p> <p>Golden Maple</p>

FLOOR PLANS

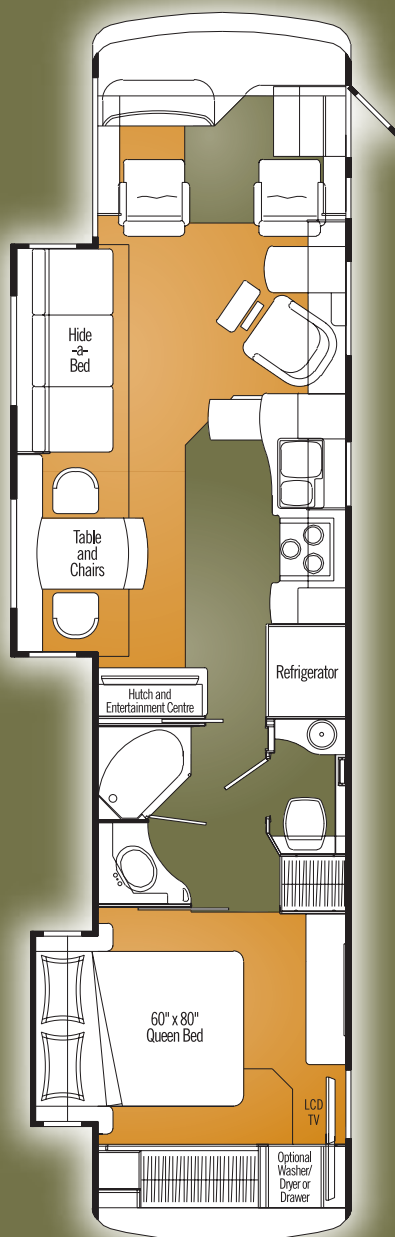

A4002 Elite

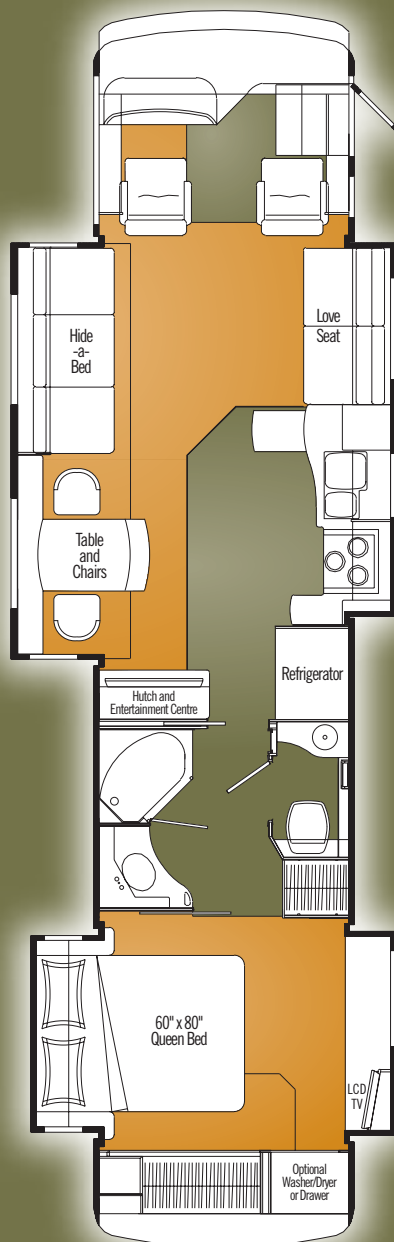

A4004 Elite

Carpet

Ceramic Tile

SPECIFICATIONS

EMPRESS 2007 Elite Series

	A4002 ELITE	A4004 ELITE
GVWR – lbs. (kg)	34,320 (15 567)	34,320 (15 567)
UVW – lbs. (kg)	25,783 (11 719)	28,133 (12 761)
NCC – lbs. (kg)	6,217 (2 826)	6,187 (2 806)
Wheelbase – in. (mm)	266" (6 756)	266" (6 756)
Length – ft. (mm)	40' 2" (12 243)	40' 2" (12 243)
Width – ft. (mm)	8' 4" (2 534)	8' 4" (2 534)
Height* – ft. (mm)	12' 4" (3 758)	12' 4" (3 758)
Water Tank Capacity** – U.S. gal. (L)	104 (393)	104 (393)
Water Heater – U.S. gal. (L)	10 (38)	10 (38)
Black Holding Tank Capacity – U.S. gal. (L)	57 (216)	57 (216)
Grey Holding Tank Capacity – U.S. gal. (L)	57 (216)	57 (216)
Fuel Capacity – U.S. gal. (L)	100 (379)	100 (379)
Propane Capacity – U.S. gal. (L)	32 (121)	32 (121)

*Includes air conditioner **Includes 10 U.S. gal. (38 L) (16 equivalent) water heater

GVWR (GROSS VEHICLE WEIGHT RATING)

The maximum permissible weight of this motorhome. The GVWR is equal to or greater than the sum of the unloaded vehicle weight (UVW) plus the net carrying capacity (NCC).

UVW (UNLOADED VEHICLE WEIGHT)

The weight of the motorhome as built at the factory with full fuel, engine oil, and coolants. The UVW does not include cargo, fresh water, LP gas, occupants, factory or dealer installed accessories.

NCC (NET CARRYING CAPACITY)

The maximum weight of all occupants, including the driver, personal belongings, food, fresh water, LP gas, tools, tongue weight of towed vehicle, factory and dealer installed accessories, etc., that can be carried by this motorhome. (NCC is equal to or less than GVWR minus UVW.) Please see your dealer for weights of factory installed options.

	A4002	ELITE	A4004	ELITE
CHASSIS AND SUSPENSION				
Air Brakes with Slack Adjusters	S	S	S	S
Air Suspension with Sachs Tuned Shock Absorbers	S	S	S	S
Alternator – 160 Amp	S	S	S	S
Block Heater (1,000 W) with Switch in Convenience Centre	S	S	S	S
07 Chassis – Freightliner XC with Cummins ISL 400 HP Turbo Diesel Raised Rail Side Radiator with 2 Stage Engine Brake	S	S	S	S
Fuel Fill – Concealed Locking Fuel Fill Access on Both Sides	S	S	S	S
Hitch – Trailer Hitch Receiver with Wiring and Plug, 1,000 lb./10,000 lb.	S	S	S	S
IFS – ZF Independent Front Suspension with Air Disc Brakes	S	S	S	S
Tires – Radial 275/80R22.5	S	S	S	S
Transmission – Allison 3000 MH Six Speed Automatic with Lock-Up and Transmission Cooler	S	S	S	S
Wheels – Aluminium Wheels (Front and Outer Duals)	S	S	S	S
DRIVERS AREA CONVENIENCES				
Blinds – Side Driver and Passenger Roller Blinds	S	S	S	S
Compass/Thermometer – Dash Mounted Directional Compass with Exterior Temperature	S	S	S	S
Cover – Hydraulic Powered Front Step Cover	S	S	S	S
Cruise Control	S	S	S	S
Dash Air and Heat – Dual Blower in Steel Cage	S	S	S	S
Fan – Overhead Blower Above Windshield	S	S	S	S
Mats – Driver/Passenger Floor Mats	S	S	S	S
Mirrors – Heated Remote Chrome Power Mirrors	S	S	S	S
07 Pedals – Adjustable Gas and Brake Pedal with Infinity Adjustable Tilt Telescopic Steering Column with Foot Pedal	S	S	S	S
07 Rearview and Side Turn Cameras with Monitor – Colour LCD Display Mounted in Dash	S	S	S	S
Seat – Ultra Leather Swivel Driver Captain Chair with Integral Seat Belt, 8-Way Power	S	S	S	S
Seat – Ultra Leather Swivel Passenger “Buddy Seat” with Integral Seat Belt and Power Foot Rest, 8-Way Power	S	S	S	S
Steering Wheel with Leather Cover, VIP Controls include Wiper and Washer	S	S	S	S
Sun Visor – Power Driver and Passenger Sun Visors	S	S	S	S
Switch – Battery Boost (Coach to Chassis Batteries)	S	S	S	S
Switch – Battery Selector for Radio	S	S	S	S
Transmission Temperature Gauge	S	S	S	S
Wipers – Wet Arm 28" Windshield Wipers with Intermittent Function	S	S	S	S
VEHICULAR				
Air Horns	S	S	S	S
Bumpers – Integrated Fibreglass, Steel Reinforced	S	S	S	S
Headlights – Styled with Halogen Bulbs	S	S	S	S
07 Jacks – “One Touch” Automatic HWH Levelling System with Automatic Air Dump	S	S	S	S
Light – High Mount Stoplight, LED Long Life	S	S	S	S
Lights – Halogen Automotive Driving Lights	S	S	S	S
Lights – LED Exterior Clearance Lights	S	S	S	S
Mud Guard – Monogrammed Triple E Rear Mudguard (Stainless Steel on Rubber)	S	S	S	S
Rust Protection	S	S	S	S
Undercoating – Automotive Type	S	S	S	S
CONSTRUCTION				
Baggage Doors – Aluminium Baggage Doors with Gas Struts and Slam Latches	S	S	S	S
Baggage Doors – Side Swing Aluminium Baggage Doors with Gas Struts and Slam Latches Under Curb Side Slide-Out	-	S	S	S
Fibreglass Molded Front and Rear Mask	S	S	S	S
Lined and Lit Baggage Compartments	S	S	S	S
Roof – Domed Kemlite FRP Flexroof	S	S	S	S
Steel Cab Floor, Firewall and Dash Structure	S	S	S	S

	A4002	ELITE	A4004	ELITE
CONSTRUCTION (CONTINUED)				
Vacuum Bonded Aluminium Framed Insulated Roof Construction	S	S	S	S
Vacuum Bonded Aluminium Framed Insulated Sidewall Construction with Thermal Break	S	S	S	S
Vacuum Bonded Fibreglass Sidewalls	S	S	S	S
Vacuum Bonded Steel Framed Insulated Floor Construction	S	S	S	S
Windows – Tinted Radius Corner Thermal Pane Windows	S	S	S	S
COACH EXTERIOR				
Cargo Slide – Mounted in Forward Baggage Bay	0	0	0	0
Cargo Slide – Mounted in Rear Baggage Bay	0	0	0	0
07 Diamondshield® Paint Protection Film on Front End	S	S	S	S
07 Door – Screened Entry Door with Deadbolt Lock and Remote Keyless Entry	S	S	S	S
Handle – Entry Door Assist Handle (Interior Mounted)	S	S	S	S
07 Handle – Exterior Assist, Monogrammed	S	S	S	S
Ladder – Exterior Ladder with Detachable Lower Section	S	S	S	S
Lights – Deluxe Patio Lights (2)	S	S	S	S
Lights – Docking Lamps (2 per Side)	S	S	S	S
Paint – Full Body Exterior Paint with Clear Coat	S	S	S	S
Step – Exterior Electric Retractable Entry Step	S	S	S	S
COACH INTERIOR				
Cabinet Doors – Mitred with Rope Inlay with European Hidden Hinges	S	S	S	S
07 Cabinetry – Danish Walnut Cabinetry, Walnut with Solid Walnut Face Frames and Panelling	0	0	0	0
Cabinetry – Golden Maple Cabinetry with Solid Maple Cabinet Face Frames and Panelling	S	S	S	S
Cabinetry – Natural Cherry Cabinetry with Solid Cherry Face Frames and Panelling	0	0	0	0
Ceiling – Flat with Padded Vinyl Headliner	S	S	S	S
Covers – Insulated Vent Covers	0	0	0	0
Detectors – Electronic Smoke, LP and CO Detectors	S	S	S	S
Drawers – Full Extension Ball Bearing Drawer Tracks with Snap Latches	S	S	S	S
Drawers – Slide-Out Drawer Option in Washer/Dryer Cabinet (N/A with Washer/Dryer Option)	0	0	0	0
Fire Extinguisher – Dry Chemical	S	S	S	S
Flooring – Ceramic Tile in Entrance Area	S	S	S	S
Latches – Snap Latches on all Cabinet Doors	S	S	S	S
Lighting – Courtesy Floor Lamps	S	S	S	S
Lighting – Halogen Lighting in Living Area with Dimmer Switch	S	S	S	S
Safe – Keylock Safebox	S	S	S	S
Shades – Day/Night Pleated in Living Area	S	S	S	S
Slide-Out – Electric Bed Slide-Out on Drivers Side	S	S	S	S
Slide-Out – Electric Slide, Dresser and Drawers	-	S	S	S
Slide-Out – Flush Floor HWH Hydraulic System in Living Area with Electric Travel Locks	S	S	S	S
07 Slide-Out – HWH Hydraulic Galley Slide on Passenger side	-	S	S	S
Wood Look window coverings in Living Area	S	S	S	S
FURNITURE				
07 Booth Dinette – Booth Dinette with Slide-Out Drawers and Wall Mount Solid Wood Table (Hutch Deleted)	0	0	0	0
Chair – Ultra Leather Recliner with Side Table	S	-	S	S
Chairs – Two Additional Solid Wood Chairs for Dining Table	0	0	0	0
Hide-A-Bed – Ultra Leather Hide-A-Bed on the Driver's Side with Air Coil Mattress	S	S	S	S
Sofa – Ultra Leather Easy Bed on Passenger's Side	0	S	S	S
Table – Solid Surface Extendable Cantilevered Wall Mount Table with Hutch with 2 Solid Wood Chairs and 2 Folding Chairs	S	S	S	S

		A4002 ELITE	A4004 ELITE
07	GALLEY FEATURES		
	Backsplash – Tiled backsplash in Galley with Decorative Inlay	S	S
	Cooktop – Recessed Cooktop with High Output Sealed Burner and Hinged Solid Surface Covers	S	S
	Counter Extension – Slide-Out Extension with Solid Surface Top and Storage	S	S
	Countertop – Solid Surface Countertop with Matching Cutting Board Sink Covers and Stainless Steel Sink	S	S
	Dishwasher (N/A with Gas Oven Option)	0	0
	Faucets – Deluxe Single Lever Faucet with Sprayer	S	S
07	Flooring – Heated Ceramic Tile Flooring with Decorative Inlay in Galley	S	S
	Light – Fluorescent Light on Ceiling in Galley	S	S
	Micro/Convection Oven – Stainless Steel Finish (OTR) with 110 Volt Range Hood and Light	S	S
	Oven – 21" LP Gas Oven (N/A with Dishwasher Option)	0	0
	Refrigerator – 4 Door 12 cu. ft. with Ice Maker LP/Electric, Stainless Steel Finish Doors	S	S
	Slide-Out Butcher Block on Locking Tracks with Knife Drawer in lieu of Top Drawer Under Cooktop (N/A with Oven option)	0	0
	LAVATORY		
	Countertop – Solid Surface Counter and Basin	S	S
	Faucet – Deluxe Faucets	S	S
	Flooring – Heated Ceramic Tile Flooring with Decorative Inlay	S	S
	Shower – Neo Angle Fibreglass Enclosed Shower with Glass Shower Doors	0	0
	Sink – Stainless Sink with Deluxe Faucet in Toilet Room	S	S
07	Skylight – Residential Neo Angle in Shower Compartment	S	S
	Toilet – Concerto China Toilet with Sprayer	S	S
	Tub – Enclosed Fibreglass Garden Tub with Glass Shower Doors	S	S
	Window with Valance and Venetian Blind in Toilet Room	S	S
	BEDROOM		
07	Bedspread – Decorative Bedspread with Throw Pillows	S	S
	Closet – Cedar Lined Wardrobe in Bedroom	S	S
	Dresser – Residential Style Dresser with Mirror and Tip-Out Laundry Hamper	S	
	Headboard – Wood Framed and Upholstered	S	S
	Mattress – Residential Premium Quality	S	S
	Shades – Day/Night Pleated with Blackout	S	S
	Storage – Under Bed Storage Drawer	S	S
	ENTERTAINMENT		
	CB Antenna – includes Labelled Coax Lead-In Under Dash	S	S
	CD Changer – 10 Stack CD Changer (N/A with GPS Option)	0	0
	GPS Navigation System with 6 Stack CD Changer with XM Satellite Pre-Wire (subscription not included)	0	0
	ILO Big Button Dash Stereo (N/A with 10 Stack CD Changer Option)	0	0
	Home Theatre System – 500 W, 6 Channel with Subwoofer with Combo DVD/VCR	S	S
	Master Control – Deluxe Audio/Video Master Control Switch Box with RCA Cables	S	S
	Pre-Wire – Satellite Dish Pre-Wire (with 12 Volt Power and Motosat Cable)	S	S
	Satellite Dish – Motosat 18" Executive with DVB Automatic Acquisition and Identification	0	0
07	Satellite Radio – Pre-Wire including Satellite Antenna (Subscription not Included) (replaced by XM with GPS Option)	S	S
	Stereo – Exterior AM/FM – CD Stereo with Shielded Speakers	0	0
07	Stereo – Separate AM/FM CD and DVD Stereo in Bedroom with Alarm	S	S
07	Stereo – Sirius Ready AM/FM Weather Band Receiver with CD Player in Dash with Big Buttons	S	S
	Telephone and Cable TV Hook-Up, Exterior	S	S
	TV – AC 20" Sharp LCD Colour Stereo TV with Remote in Bedroom in Dresser Slide-Out		S
07	TV – AC 20" Sharp LCD Colour Stereo TV with Remote in Bedroom in Pull-Out Cabinet	S	
	TV – AC 32" Sharp LCD Widescreen TV with Remote in Entertainment Cabinet Behind Slide-Out	S	
07	TV – AC 20" Sharp LCD on Extendable/Swing-Out Mount in Baggage Compartment	0	0
	TV Antenna – Roof Top Retractable Antenna with Booster, Dash Mounted "Antenna Up" Light	S	S

		A4002 ELITE	A4004 ELITE
	HEATING VENTILATING AND AIR CONDITIONING		
	Air Conditioner – Dual (2) Centrally Ducted 13,500 BTU with Heat Strip and Remote Return Air	S	S
	Air Conditioner – Dual (2) Centrally Ducted 13,500 BTU with Heat Pumps	0	0
07	Fan – Fantastic Non Reversible Thermostatically Controlled in Lavatory with Wall Switch and Rain Sensor	S	S
07	Fan – Fantastic Non Reversible Thermostatically Controlled in Toilet Room with Wall Switch and Rain Sensor	S	S
07	Fan – Reversible Thermostatically Controlled Fantastic Fan in Living Area with Wall Switch and Rain Sensor	S	S
	Furnaces – Front 35,000 BTU and Rear 25,000 BTU Central Furnaces with Electronic Ignition and in Floor Ducting	S	S
	Heater – Dual Rear Auxiliary Automotive Heaters with Electric Control Valves	S	S
	Fan – Reversible Thermostatically Controlled in Bedroom with Wall Switch and Rain Sensor	S	S
	ELECTRICAL		
	Alarm System with 2 Motion Detectors	S	S
	Batteries – 4 x 6 Volt Deep Cycle Auxiliary Battery with Slide-Out Tray	S	S
	Battery Disconnect – Chassis Batteries	S	S
	Bidirectional Isolator Relay Delay (BIRD) Battery Charging System	S	S
	Convenience Centre – Mounted Mid Ship, Level Monitor, Block heater, Thermostat, EMS Controls, Inverter Control	S	S
07	Generator – 8.0 KW Onan Quiet Diesel with Hour Meter in Convenience Centre	S	S
07	Inverter – 2000 Watt Inverter with 100 Amp Charger with Freedom Remote	S	S
	Energy Command 30 – Onan Automatic Generator Control	S	S
	Panel – 50 Amp Electrical Service with Energy Management System	S	S
	Power Cord Reel – 50 Amp Power Cord Reel	S	S
	Pre-Wire – 12/110 Volt Receptacles in Baggage Compartment (Freezer Prep)	S	S
	Pre-Wire for Solar Panel	S	S
	Pre-Wire – Satellite Dish with 12 Volt Power, Ground, RG-6 Coax and Fish Wire	S	S
	Pre-Wire for Power Main Awning	S	S
	Receptacle – Patio GFI Receptacle	S	S
	Switch – Electronic Battery Disconnect (Coach Batteries)	S	S
	PLUMBING AND LP SYSTEMS		
	Black Tank Flush System	S	S
	Exterior Shower	S	S
	Holder – Tip Down Underbody Sewer Hose Holder	S	S
	Holding Tanks – Enclosed and Insulated, Dual Heated Waste Holding Tanks	S	S
	LP Tank – Easy Access Propane Tank	S	S
	Washer/Dryer Prep Package	S	S
	Water Filter – Whole House Water Filter in Utility Module	S	S
07	Water Heater – 16 gal. Equivalent Electronic Ignition Gas/Electric/Motoraid Water Heater	S	S
	Water Hose Reel	S	S
	Water Pump – Variable Speed Water Pump with 3-Way Switching	S	S
	Water Tank – Enclosed and Insulated, Dual Heated Fresh Water Tank	S	S
	Winterization System with On-Board Potable Antifreeze Pick-Up Tank	S	S
	SYSTEMS		
	Central Vacuum with Outlet in Baggage Compartment	S	S
	Freezer/Refrigerator – On Slide-Out Tray 1.38 cu. ft. (AC/DC)	0	0
	Washer/Dryer (vented)	0	0
	OPTIONAL AWNING PACKAGES		
07	Power Awning Package – A&E Oasis Power Front Door Awning with Remote, Weathershield Equipped A&E Elite Slide Topper, 19 ft. Acrylic Weathershield Equipped Weatherpro Power with Remote and Wind Sensor	0	0
	Awning – Weathershield Equipped A&E Elite Window Awnings (Main Slide Windows and Bedroom Window)	0	0
	Factory PDI	0	0
07	New for 07 S Standard 0 Optional		

TWO YEAR LIMITED WARRANTY

Triple E is proud to offer a two year limited warranty on structure as well as most major components. Please see your dealer for further details.

COACH NET

Triple E is a proud partner of Coach Net, an extensive support program providing complete and fully paid roadside assistance, emergency road service, and special warranty support benefits that follow you throughout Canada and the U.S. Service is free for the first year of ownership and available at a nominal fee for subsequent years.

COACH NET'S 24-HOUR CUSTOMER CARE

- Emergency roadside assistance, including tow vehicle
- Toll free technician hotline for operation and service support
- Toll free nationwide service appointment assistance
- Free custom trip routing and colour maps
- Warranty service at over 6,800 locations throughout North America
- Benefits such as free jump starts, tire changes, fuel delivery and lock-out service



Triple E Recreational Vehicles P.O. Box 1230, Winkler, Manitoba, Canada R6W 4C4 Telephone: (204) 325-4361 Fax: (204) 325-5241

Triple E Recreational Vehicles meet or surpass CSA-CRVA-RVIA standards covering electrical services, gas services, plumbing services and vehicular safety. Empress Motorhomes exceed 96" in width. In some states, 96" is the maximum width of vehicles travelling some or all state roads. It is the responsibility of the owner to be familiar with the road usage laws of the states in which you travel. Product improvement is a continuing process at Triple E Recreational Vehicles. Thus, we reserve the right to change specifications on any or all products without prior notice; errors and omissions excepted. Triple E Recreational Vehicles is under no obligation to undertake modification to units manufactured prior to changes on specifications. Brochure pictures may be shown with optional equipment. Colours may not be exactly as shown due to the printing process. Please see your dealer for specific colours.

