



MONACO®

DRIVING YOUR DREAM.



## FOR THE JOURNEY AND THE DESTINATION

For those RV enthusiasts who wish to combine your appreciation for life's finer things with your passion for blazing a trail, the 2011 Dynasty was designed just for you. Your choice of three 45-foot floorplans, including two quad-slide bath-in-a-half plans and a roomy five-slide plan, along with three stunning décor and paint packages, including a Ralph Lauren package. Just the start to creating your perfect living environment, and the ultimate living experience. Like its historical namesake, Dynasty offers the best of all worlds — power, prestige, luxury and elegance. *(Pictured: Majestic V/Cognac Swirl/Glazed Cherry with Accent Door Trim)*







## A RECIPE FOR LIVING

State-of-the-art amenities and impeccable styling grace Dynasty's kitchen and dining area. Standards include a stainless steel residential refrigerator, high gloss solid surface countertops throughout, decorative tile backsplashes, ceramic tile flooring, and a central vacuum system for convenience. Nice optional touches include a stainless steel four-door refrigerator and dishwasher.

*(Pictured: Majestic V/Cognac Swirl/  
Glazed Cherry with Accent Door Trim)*





## AT THE END OF THE DAY

Dynasty's luxurious master suite is designed to give you standard and optional features that best suit you. Select a rear bedroom or a bath-in-a-half layout that features a full private bath beyond the bedroom. A queen or king Select Comfort air mattress. Manual or power solar screens with blackout shades. Ceramic tile or plush carpet. It's all up to you. (Pictured: Majestic V/Cognac Swirl/Glazed Cherry with Accent Door Trim)





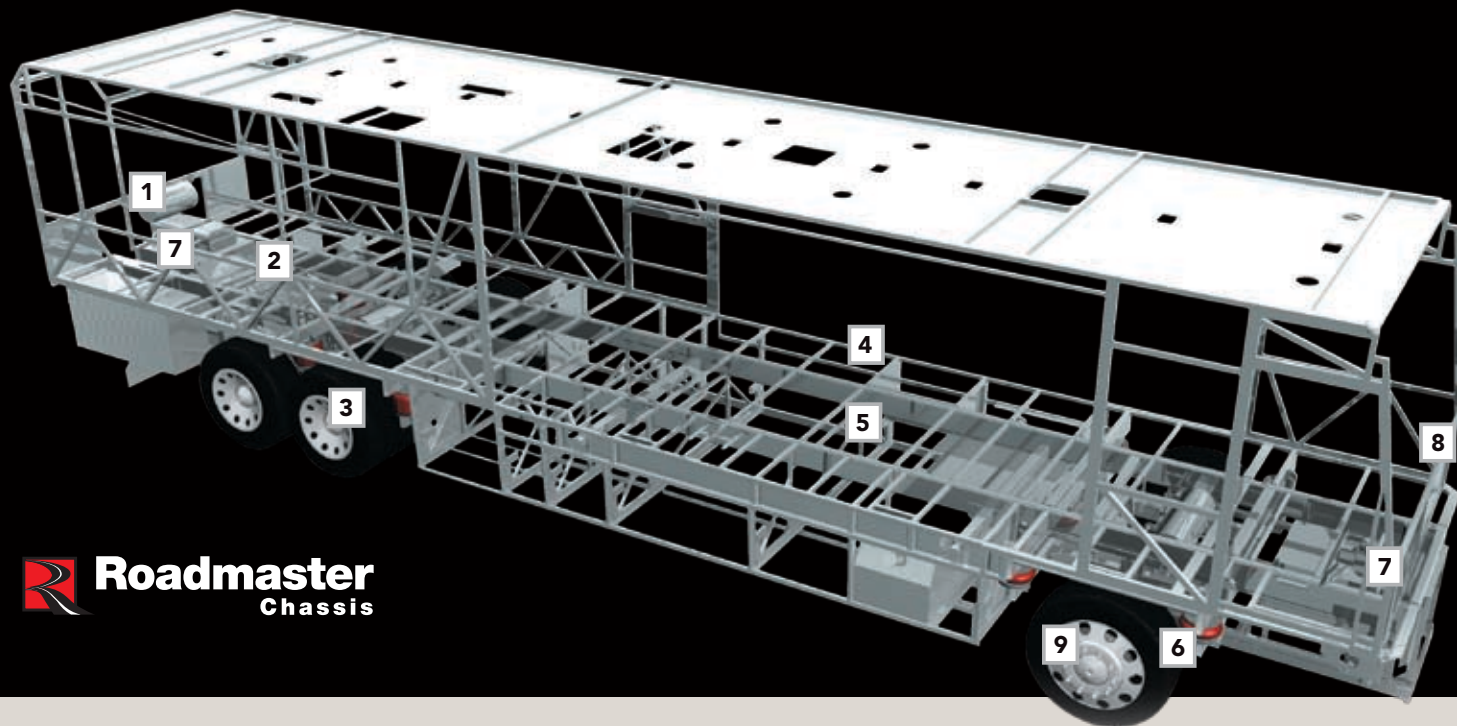

**Roadmaster**  
Chassis

## ROADMASTER S-SERIES SEMI-MONOCOQUE CHASSIS

**1** 10,000 lb. hitch receiver offers powerful towing capacity with 7/4-way trailer plug. Optional 15,000 lb. hitch receiver also available.

**2** Allison® 4000 MH 6-speed transmission for smooth shifting; our exclusive use of synthetic transmission fluid allows for up to three-year maintenance intervals.

**3** Cushion Air Glide suspension system positions ten shocks and ten air bags, eight of which are outboard-mounted with auto-leveling for greater stability, a smoother ride and the best handling in its class.



• **Unique three-degree rear axle tilt** perfectly aligns the engine, transmission and differential, minimizing stress on the drivetrain and

reducing noise in the coach.

• **Automatic Traction Control (ATC)** eliminates wheel slippage in slick conditions and heightens controls.

• **Tag axle lifts** for added maneuverability in tight spots.

**4** Full length frame rails fabricated from 3" by 8" by 1/4" 60,000 PSI structural steel; rails are spaced 44" on center for a wider stance and unmatched strength.

**5** The semi-monocoque design, with trussed superstructure, distributes stress evenly throughout the entire chassis and adds strength to sidewalls and bays.

**6** P295/80R/22.5 Goodyear steel-belted all-season tires ensure a safe and quiet ride (G670 RV tire).

**7** The power steering box allows for a 50-degree front wheel turn angle in both directions for better maneuverability and

returns the steering wheel to its center position to eliminate driver fatigue.

**8** All chassis are equipped with steel cage construction, steel firewall and steel stepwell and added safety.

**9** Accuride rim with AccuShield coating that cleans easily with soap and water.

## CUMMINS MUSCLE

Dynasty boasts a powerful Cummins® ISM 500 HP diesel engine with 1,550 lbs./ft. of torque standard on all three of its floorplans. Power you never dreamed possible.



## THE ULTIMATE FOUNDATION.

Take the wheel of a luxury motorhome, and you're taking the wheel of the chassis it rides on. That's why the Dynasty rides exclusively on a Roadmaster chassis that is custom built to deliver the very best diesel motorhome experience. Roadmaster's semi-monocoque construction utilizes advanced design and engineering to distribute stress evenly throughout the entire chassis, reducing the possibility of twisting and increasing durability and reliability. It's really the ultimate foundation for a luxury ride.

## MULTIPLEX WIRING

Multiplex wiring, used throughout the coach, replaces cumbersome bundles of wire with separate modules. These modules communicate via a single wire, making servicing easier and reducing the overall weight of the RV. A service technician can simply hook up a laptop directly to the modules for easy troubleshooting.

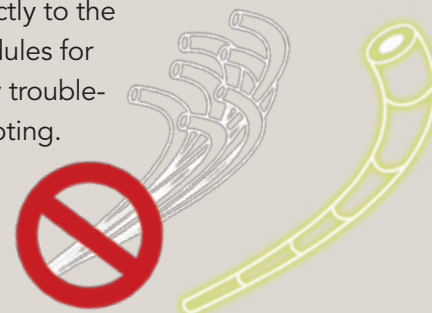

## ROOF CONSTRUCTION

(top to bottom)

- One-piece peaked fiberglass roof
- Luaun backing
- Thick, tapered bead foam insulation
- Tubular steel framework
- Vapor barrier
- Structure foam: thermal insulative barrier
- Marine grade plywood sheeting
- Foam padding for extra insulation
- Padded vinyl ceiling

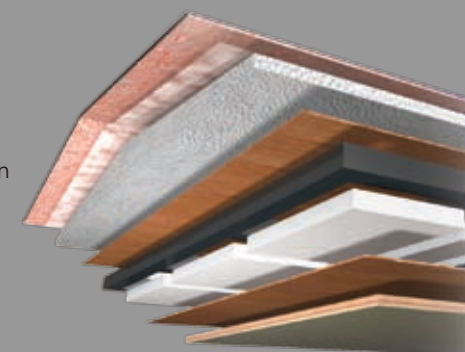

## SIDEWALL CONSTRUCTION

(left to right)

- Wallpaper
- Décor board
- Heavy-gauge tubular steel
- High performance thermal insulation
- Gel coat fiberglass composite sidewall



## FLOOR CONSTRUCTION

(top to bottom)

- Tile or carpet pad and carpeting
- Steel framed five layer flooring
- OSB flooring
- Decibal paper
- OSB flooring
- Waterproof underbelly

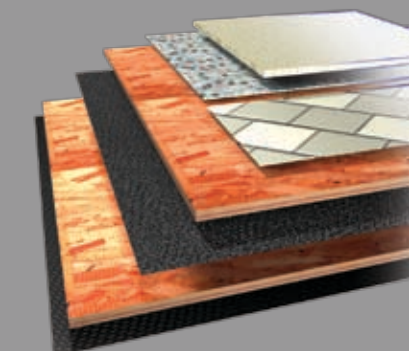

## AROUND-THE-CLOCK SERVICE AND SUPPORT

When you take delivery of your new recreational vehicle, it's just the beginning of our exclusive around-the-clock Owner Advantage Program. We offer an extensive support program that provides complete roadside assistance and special motor club benefits that follow you wherever your travels take you. We've teamed up with the largest RV emergency road service company in the country to give you immediate access to fast, dependable service when and where you need it. Add our toll-free service appointment assistance, plus a technical assistance hotline, and you have the security of full-time support at your fingertips.

For details, call toll-free (877) 211-8135

## WARRANTIES

12 month/24,000 mile basic limited warranty

5 year/50,000 mile limited warranty on aluminum or steel frame structure

3 year/50,000 mile limited warranty on Roadmaster Chassis

(\*Review your coach's limited warranty in full for complete terms and conditions.)





COGNAC SWIRL



ESPRESSO HAZE



RALPH LAUREN WINDERMERE



NATURAL CHERRY (STANDARD)



GLAZED NATURAL CHERRY WITH  
ACCENT TRIM (OPTIONAL)



STAINED CHERRY (STANDARD)



GLAZED STAINED CHERRY WITH  
ACCENT TRIM (OPTIONAL)

Note: Colors depicted  
are a reasonable  
representation though  
they may not be an  
exact match of the  
actual colors due to  
variances in processing  
and production. See  
your dealer for actual  
fabric and paint chip  
samples.

- A. BEDSPREAD
- B. SOFA
- C. ACCENT
- D. CARPET

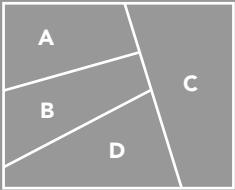

### RALPH LAUREN PACKAGE:

- Ralph Lauren fabrics, both living room and bedroom
- Villa furniture featuring 2-tone leather
- Upgraded tumbled stone galley/bath backsplashes
- Polished porcelain 14" X 14" floor tile
- Decorative carved headboard
- Upgraded carved slideout fascia

Carpet ☐ Tile ☐

MAJESTIC V

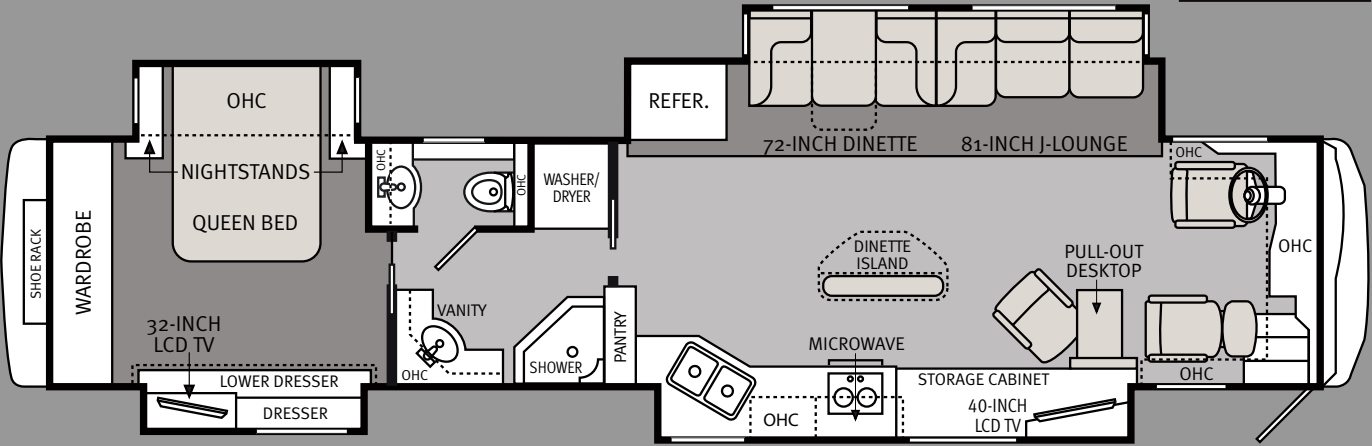

REGAL IV

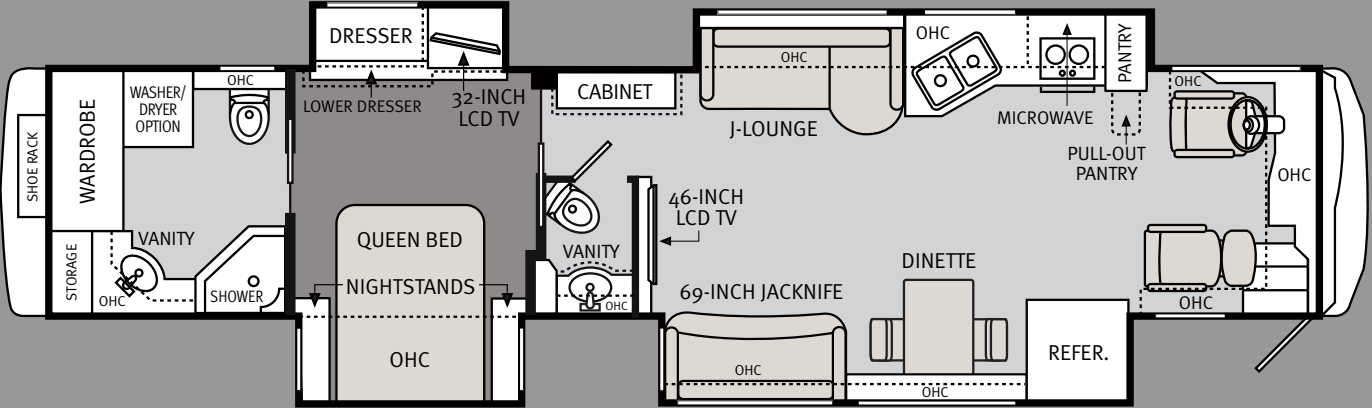

YORKSHIRE IV

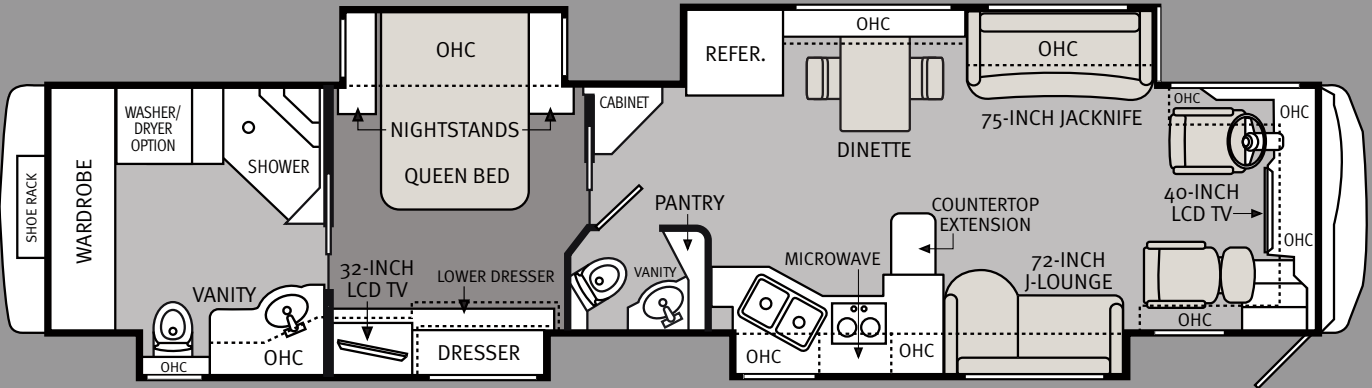

Due to continuous product improvement, please visit us online at [monacocoach.com](http://monacocoach.com) for the latest in standards and options, specifications, and technical data.

		MAJESTIC V	REGAL IV	YORKSHIRE IV
WEIGHTS	Gross Vehicle Weight Rating (Lbs.)	50,160	50,160	50,160
	Gross Combined Weight Rating <sup>1</sup> (Lbs.)	60,160	60,160	60,160
	Front Gross Axle Weight Rating (Lbs.)	15,160	15,160	15,160
	Rear Gross Axle Weight Rating (Lbs.)	23,000	23,000	23,000
	Tag Axle Weight Rating (Lbs.)	12,000	12,000	12,000
MEASUREMENTS	Wheelbase	286"	286"	286"
	Overall Exterior Length	44' 11"	44' 11"	44' 11"
	Overall Exterior Height (with AC)	12' 6"	12' 6"	12' 6"
	Exterior Width	100.5"	100.5"	100.5"
	Interior Height	84"	84"	84"
TANK CAPACITIES <sup>2</sup>	Gray Tank (Gal.)	70	70	70
	Black Tank (Gal.)	40	40	40
	Fresh Tank (Gal.)	100	100	100
	Diesel Fuel Tank (Gal.)	150	150	150
	LP Tank (Gal.)	25	25	25

<sup>1</sup>Towing capacity is limited by GCWR; your vehicle's towing capacity is the difference between the GCWR and the actual vehicle weight, including all water, fuel, passengers and cargo. Your towed vehicle should be equipped with auxiliary brakes if the weight of the towed vehicle exceeds 1,000 lbs. Consult your owner's manual for further towing information.

<sup>2</sup>All tank capacities are estimated based upon calculations provided by the tank manufacturers and represent approximate capacities. The actual "usable capacity" may be greater or less than the estimated capacities based upon fabrication and installation of the tanks.

<sup>3</sup>Actual filled LP capacity is 80% of listing due to safety shut-off required on tank.

The actual overall length of the recreational vehicle may differ from that indicated in the brochure due to variances in the manufacturing process and/or installed components. The actual length may be greater or less than that indicated. Due to the large variety of options and floorplan arrangements available to our customers, actual weights for each unit can differ significantly. Monaco provides a weight sticker on each unit we produce which includes that unit's tank capacities and approximate weight. Consult your local Monaco dealer for unit availability and further information. The information printed in this brochure reflects product design, fabrication, and component parts at the date of printing. The manufacturer reserves the right, at any time, to make changes in product design or material or component specifications

as its sole option, without notice. This includes the substitution of components of a different brand or trade name which will result in comparable performance. All information printed in this brochure is subject to change after the date of printing. Some features shown or mentioned in this brochure are optional and may only be available in selected floorplans. Photographs may depict a floorplan option that has been discontinued or is no longer available at the time of your purchase. Photographs may show props or decorations that are not standard equipment. Monaco, the Monaco logo and its design, are registered trademarks. Other products and company names are trademarks and/or registered trademarks of their respective holders. While the color of the motorhome's exterior and the interior fabrics depicted in this sales brochure are fair and

reasonable depictions, the colors depicted may not be an exact match of the actual colors because of the variances in photo-processing and printing. Due to product improvements, changes during the model year and/or transcription errors that may occur, information represented within this brochure may not be accurate at the time of your purchase. If certain information is significant to your purchasing decision, please confirm the information with your dealer. Component part and appliance manufacturers issue limited warranties covering portions of the recreational vehicle not covered under the Limited Warranties issued by Monaco RV, LLC. To learn specific details regarding warranty coverage, please contact your selling dealership or review the warranty packet inside the recreational vehicle.

Standards ☐ Options ☐

BODY CONSTRUCTION	<ul style="list-style-type: none"><li>› Heavy-Duty Steel Superstructure with Steel Cage Cockpit Construction</li><li>› Seamless One-Piece Molded Crowned Fiberglass Roof</li><li>› All-Season Foam Insulated Roof</li><li>› Laminated Gel Coat Fiberglass Sidewalls</li><li>› Five-Layer Flooring with Two Layers of OSB Flooring</li><li>› Deluxe Full-Body Paint</li><li>› 1-Piece Front Windshield</li></ul>	<ul style="list-style-type: none"><li>› Double Head Power Controlled Heated Chrome Exterior Mirrors with Cameras</li><li>› Halogen Fog Lamps</li><li>› Daytime Running Lights</li><li>› Recessed Side Docking Lights</li><li>› Roof-Mounted Dual Trumpet Air Horns</li><li>› Entry Step Storage</li><li>› Insulated Aluminum Baggage Doors with Power Locks</li><li>› Lined Pass-Through Storage Compartments</li></ul>	<ul style="list-style-type: none"><li>› Interlocking Aluminum Framed Slide-Out Houses</li><li>› Side-Hinged Baggage Doors with Electric Locks</li><li>› Rear Ladder</li><li>› Monaco Full-Length Mudflap with Stainless Steel Logo</li><li>› 3M Film Front Mask</li><li>› Storage Bay Slide-Out Tray (Complete Pass-Through)</li></ul>
CHASSIS / ENGINE / SUSPENSION	<ul style="list-style-type: none"><li>› Roadmaster S-Series Semi-Monocoque Chassis</li><li>› Multiplex Chassis Wiring</li><li>› Cummins® ISM '07 Emissions 500 HP (11.0L) Engine with Allison® 4000 MH 6-Speed World Transmission and Electronic Shifter</li><li>› Torque: (@ 1,300 RPM) 1,550 lbs./ft. Max. Net</li><li>› Engine Displacement: 661" / 11.0L</li><li>› Dual Fuel Fill with Locking Fuel Cap</li></ul>	<ul style="list-style-type: none"><li>› 200 Amp Alternator</li><li>› Rear Axle Ratio: 4.33:1</li><li>› Tires: 295/80R/22.5</li><li>› Remote Transmission Fill</li><li>› Polished Aluminum Wheels</li><li>› Full-Cushion Air Glide Suspension with Ten Air Bags and Ten Shock Absorbers</li><li>› Automatic Traction Control</li><li>› Anti-Locking Braking System with Front and Rear Disc Brakes</li></ul>	<ul style="list-style-type: none"><li>› Tag Axle with Anti-Lock Braking System and Drum Brakes</li><li>› Two-Stage Jacobs Engine Brake with Toggle Switch on Driver Console</li><li>› Prewire for Supplemental Braking System</li><li>› Engine Block Heater with Switch on Dash</li><li>› Automatic Air Leveling System</li><li>› 10,000 Lb. Hitch Receiver and 7/4-Way Trailer Plug</li><li>› Remote Inflation Connector</li></ul>
COCKPIT	<ul style="list-style-type: none"><li>› In-Dash AM/FM Stereo with Single CD Player</li><li>› SEE-Vision Coach Monitoring System</li><li>› In-Dash Driver's Message Center with Integrated Compass, Temperature Gauge and Cruise Control Light</li><li>› CB Radio with Antenna</li></ul>	<ul style="list-style-type: none"><li>› Recessed Slideout Dash Workstation</li><li>› Electric Cockpit Solar Screens with Blackout Shades</li><li>› Power Driver's Side Cab Window</li><li>› Adjustable Brake and Accelerator Pedals</li></ul>	<ul style="list-style-type: none"><li>› Lighted VIP Smartwheel® with Controls for Windshield Wipers, ICC and Cruise Control</li><li>› Six-Way Power Pilot and Co-Pilot Seats: With Electric Lumbar; Memory Capabilities on Pilot Side; Power Footrest on Co-Pilot Seat</li></ul>
	<ul style="list-style-type: none"><li>› GPS Navigation System</li><li>› Passenger-Side GPS Screen-View Only</li></ul>	<ul style="list-style-type: none"><li>› Sirius Satellite Radio Tuner with Antenna</li></ul>	<ul style="list-style-type: none"><li>› Bluetooth® Hands-Free Link</li></ul>
APPLIANCES / ACCESSORIES	<ul style="list-style-type: none"><li>› Stainless Steel Residential Refrigerator with Water/Ice Dispenser in Door</li><li>› Recessed High-Output 2-Burner Cooktop with Flush-Mounted Covers</li><li>› Spacesaver Stainless Steel Convection Microwave with Touch Control</li><li>› Electric TV Antenna</li></ul>	<ul style="list-style-type: none"><li>› Central Vacuum System with Under-Bed Storage Tray</li><li>› Prep for Satellite Receiver</li><li>› 40" LCD TV Mounted in Living Area Passenger Side Slideout (Majestic V Only)</li><li>› Fixed 40" LCD TV in Living Area Overhead (Yorkshire IV Only)</li></ul>	<ul style="list-style-type: none"><li>› 46" LCD TV in Living Area (Regal IV Only)</li><li>› 32" LCD TV with Remote in Bedroom</li><li>› Home Theater System with DVD/CD Player in Living Area</li><li>› Bedroom DVD Player</li></ul>
	<ul style="list-style-type: none"><li>› Swing-Down 40" LCD TV Mounted in Cockpit Ceiling (Yorkshire IV Only)</li><li>› 26" LCD TV in Living Area Overhead (N/A: Yorkshire IV)</li><li>› Stainless Steel 17 Cu. Ft. Four-Door Refrigerator</li></ul>	<ul style="list-style-type: none"><li>› Maytag® Stacked Washer/Dryer</li><li>› Stainless Steel Dishwashing Drawer</li><li>› KVH R6 In-Motion Digital Satellite System</li><li>› Multi-Satellite HD KU/KA Dish</li><li>› Winegard Stationary Dish-Star</li></ul>	<ul style="list-style-type: none"><li>› Exterior Entertainment Center: 40" LCD TV, with Single DVD Player in Storage Bay Ceiling</li><li>› Blu-ray DVD Player in Living Area</li></ul>



Standards ☐ Options ☐

INTERIOR	<ul style="list-style-type: none"><li>› Stained or Natural Cherry Cabinetry</li><li>› Built-In Storage Area for Galley Countertop Covers</li><li>› Low-Friction Roller Drawer Guides</li><li>› Detailed Wood and Laminate Ceiling with Recess in Living Room</li><li>› High-Gloss Solid Surface Countertops Throughout</li><li>› Integrated Sinks in Vanity and Galley</li><li>› Tumbled Stone Tile Backsplashes in Galley and Bath Areas with Accent Metal Tiles</li><li>› Solar Screens with Blackout Shades Throughout</li></ul>	<ul style="list-style-type: none"><li>› Drawer Organizer in Galley</li><li>› Designer Carpeting in Living Area Slideouts and Bedroom</li><li>› Ceramic Tile Flooring Throughout Except in Bedroom and Slideout Room</li><li>› Ceramic Tile Flooring in Cockpit Area</li><li>› Raised Panel Door for Private Bath (with Hidden Hinges)</li><li>› Bedspread and Pillows</li><li>› Nightstands with Solid Surface Countertops</li><li>› Solid Surface Windowsills in Living Area</li><li>› Recessed Galley Area Surround Sound Speakers in Ceiling</li></ul>	<ul style="list-style-type: none"><li>› Solid Surface/Hardwood Bedroom Dresser Base</li><li>› Wardrobe Closet with Mirrored Doors</li><li>› Hardwood Drawer Under Bed</li><li>› Decorative Hardwood Headboard in Bedroom</li><li>› Decorative Mirror on Refrigerator Wall with Wainscot Below Mirror</li><li>› Galley Island with Folding Bar Top (Majestic V Only)</li><li>› Oil-Rubbed Bronze Cabinetry Hardware Throughout</li><li>› Oil-Rubbed Bronze Bath Accessories</li></ul>
	<ul style="list-style-type: none"><li>› Décors: Cognac Swirl, Espresso Haze</li><li>› Ralph Lauren Décors: Windermere</li><li>› Power Solar Screens with Blackout Shades Throughout</li></ul>	<ul style="list-style-type: none"><li>› Cabinetry Options: Glazed Cherry Cabinets with Accent Door Trim; Glazed Stained Cherry Cabinets with Accent Door Trim</li></ul>	<ul style="list-style-type: none"><li>› Bedroom Tile Flooring</li><li>› Ceiling Fan in Bedroom</li><li>› Under-Mount Glass Bowl in Vanity (Majestic V Only)</li></ul>
FURNITURE	<ul style="list-style-type: none"><li>› Legless Side-Slide Dinette with Full-Length Wall Cabinet and Two Freestanding Chairs and Two Folding Chairs (N/A: Majestic V)</li><li>› Roadside: 36" Leather Sectional Booth Dinette Ensemble with Air Mattress and Two Pillows (Majestic V Only)</li></ul>	<ul style="list-style-type: none"><li>› Curbside: Full Wall Cabinet with Solid Surface Top (Majestic V Only)</li><li>› Roadside: Leather Jackknife Sofa with Two Pillows (Yorkshire IV Only)</li><li>› Curbside: Leather Hide-A-Bed with Air Mattress (Yorkshire IV Only)</li></ul>	<ul style="list-style-type: none"><li>› Roadside: Leather J-Lounge with Two Pillows (Regal IV Only)</li><li>› Curbside: Leather Hide-A-Bed with Air Mattress and Two Pillows (Regal IV Only)</li><li>› Queen Premier Select Comfort Air Mattress with Digital Remote</li></ul>
	<ul style="list-style-type: none"><li>› King Bed with Premier Select Comfort Mattress with Remotes</li><li>› Roadside: 42" Leather J-Lounge/Dinette Ensemble w/ Air Mattress (Majestic IV)</li><li>› Curbside: Leather Jackknife Sofa with Pull-Out Desk (Majestic IV Only)</li></ul>	<ul style="list-style-type: none"><li>› Roadside: Computer Desk with Leather Recliner, Ottoman (Yorkshire IV Only)</li><li>› Roadside: Leather J-Lounge/Dinette Ensemble (Yorkshire IV Only)</li><li>› Curbside: Computer Desk with Leather Recliner, Ottoman (Regal IV Only)</li></ul>	<ul style="list-style-type: none"><li>› Curbside: Leather J-Lounge/Dinette Ensemble w/ Air Mattress (Regal IV)</li><li>› Two Folding Chairs with Booth Dinette Ensemble</li><li>› Curbside: Leather Recliner with Ottoman (Majestic V Only)</li></ul>
HEATING / VENTS / AC	<ul style="list-style-type: none"><li>› Three Low-Profile Ducted 15M BTU Roof ACs w/ Wall Thermostat and Heat Pump</li><li>› Aqua-Hot® Heating System</li></ul>	<ul style="list-style-type: none"><li>› Electronic Dash AC/Heat Climate Control System</li><li>› Auxiliary Blower</li></ul>	<ul style="list-style-type: none"><li>› 12V Attic Fan with Wall Thermostat and Rain Sensors in Private Lavatory, Shower Area and Galley</li></ul>
	<ul style="list-style-type: none"><li>› Radiant Floor Heating in Living Room, Galley and Bath</li></ul>	<ul style="list-style-type: none"><li>› Radiant Floor Heating in Bedroom (Requires Bedroom Tile Flooring Option)</li></ul>	

ELECTRICAL / LIGHTS	<ul style="list-style-type: none"><li>› Onan® 10.0 kW Generator on Power Slide-Out Tray with Auxiliary Start Switch and Auto Temperature Start</li><li>› 2,800 Watt Pure Sine Wave Inverter with Auto Gen Start and Auto Temp Start</li><li>› Pilot and Co-Pilot Map Lights</li><li>› Switches for Bedroom Decorative Lights on Both Sides of Bed</li><li>› Lighted Exterior Storage Compartments</li></ul>	<ul style="list-style-type: none"><li>› Lighted Utility Center: Phone, Cable TV, Water, Electrical Hookups</li><li>› 120V Outlet in Private Bath, Bed Base</li><li>› 120V Receptacles in Outside Storage Compartment</li><li>› Four 6V House Batteries</li><li>› Two 12V Chassis Batteries</li><li>› Battery Remote Fill</li><li>› Vanity Soffit Lighting</li></ul>	<ul style="list-style-type: none"><li>› Surge Guard™ Auto Transfer Switch</li><li>› Power Cord Reel</li><li>› Multiplex 12V Wiring for Dash/ Instrument Panel Gauges, Coach Interior</li><li>› Oil-Rubbed Bronze Decorative Lighting in Living Room and at Dinette</li><li>› Vanity Soffit Lighting</li></ul>
	<ul style="list-style-type: none"><li>› Dual 65 Watt Solar Panels</li></ul>	<ul style="list-style-type: none"><li>› Four 65-Watt Solar Panels</li></ul>	<ul style="list-style-type: none"><li>› AGM Glass Mat Batteries</li></ul>
PLUMBING / LP SYSTEMS	<ul style="list-style-type: none"><li>› Power Water Hose Reel</li><li>› Central Water Filtration System in Service Bay</li><li>› Manabloc Water System for Entire Coach</li><li>› Oil-Rubbed Bronze Two Handle Bath Lav Faucet</li><li>› Oil-Rubbed Bronze Single Handle Kitchen Faucet with Spray and Soap Dispenser</li></ul>	<ul style="list-style-type: none"><li>› Insulated Systems Compartment with Easy Access to Hookup</li><li>› Water Pump Switch in Galley, Bathroom and Service Bay</li><li>› China Toilet</li><li>› Super Service Center</li><li>› RV Sanicon Tank Drainage System</li><li>› Insta-Hot Water System</li></ul>	<ul style="list-style-type: none"><li>› Solid Surface Shower w/ Clear Glass Door</li><li>› Oil-Rubbed Bronze Single Shower Faucet with Slide Bar</li><li>› Black and Gray Holding Tank Rinsing System</li><li>› Outside Faucet with Hot and Cold Water</li><li>› Fresh Water Tank with Electric Fill Valve</li><li>› Tank Monitoring System</li></ul>
	<ul style="list-style-type: none"><li>› Bathtub</li></ul>		
WINDOWS / DOORS / AWNINGS	<ul style="list-style-type: none"><li>› Flush-Mounted Radius Dual Pane Safety Glass Dark Tinted Windows</li><li>› Front Entry Door with Air Seal and Removable Top Screen</li></ul>	<ul style="list-style-type: none"><li>› Keyless Remote Entry System with Pocket Remote</li><li>› Topper Awnings on Slideout Houses</li><li>› Girard® 12V Electric Front Door Awning</li><li>› 12V Electric Patio Awning</li></ul>	<ul style="list-style-type: none"><li>› Window Awnings on All House Windows (Except Windows Under Patio Awning)</li></ul>
	<ul style="list-style-type: none"><li>› Girard 12V Electric Patio Awning (N/A: Majestic V)</li></ul>	<ul style="list-style-type: none"><li>› Apex 12V Electric Patio Awning with Remote</li></ul>	<ul style="list-style-type: none"><li>› Girard 12V Electric Window Awning</li></ul>
SAFETY	<ul style="list-style-type: none"><li>› Backup Alarm</li><li>› Fire Extinguisher</li><li>› Deadbolt Lock on Entrance Door</li><li>› Lighted Interior and Exterior Grab Handles</li></ul>	<ul style="list-style-type: none"><li>› 120V GFI Protected Circuit (Galley, Bathroom, Storage Bay)</li><li>› LP Gas Detector</li><li>› Smoke Detector</li><li>› Carbon Monoxide Detector</li></ul>	<ul style="list-style-type: none"><li>› Integrated Pilot and Co-Pilot Three-Point Seatbelts (Lap and Shoulder)</li><li>› Third Brake Safety Light</li><li>› Egress Windows</li></ul>
	<ul style="list-style-type: none"><li>› Security Safe</li></ul>	<ul style="list-style-type: none"><li>› Security Alarm System</li></ul>	<ul style="list-style-type: none"><li>› Safety Cruise</li></ul>

BUY LOCALLY. ENJOY EVERYWHERE.

Monaco RV strongly encourages its retail customers to purchase from their local dealerships whenever possible. Buying a new Monaco RV locally allows a customer to establish a relationship with a dealer close to home and provides convenient service and support from product-trained technicians. On our end, Monaco RV will continue to provide our dealer partners and customers with the finest recreational vehicles in the industry.

ALL ROADS LEAD TO MONACOCOACH.COM

Wherever the road takes you, you're never more than a click away from your friends at Monaco. Just go to **monacocoach.com** for all the latest product news, club dates and destinations, a dealer locator function, and factory tour information. You can also e-mail us directly through the site at any time.







MONACO®

DRIVING YOUR DREAM.

91320 Coburg Industrial Way, Coburg, OR 97408 | [monacocoach.com](http://monacocoach.com) | 877 252 4666

**NAVISTAR**

## STRONGER THAN EVER.

When you buy a new Monaco RV, you get all the great things you expect: state-of-the-art products, innovative floorplans and first-class customer service. You also get the confidence that comes with being part of a 175-year-old parent company like Navistar, a world leader in transportation. To learn more about Navistar and its affiliates, visit [navistar.com](http://navistar.com).