

# DOLPHIN

---



## Fifth Wheel

---





# Dolphin's Light Weight Fifth Wheels



Dolphin's Lightweight 5th Wheel is designed for fuel economy while not sacrificing on comfort. Downsized and light in weight, the aerodynamic styling of this trailer adds to the fuel efficiency of the mini-pickup which pulls the unit.

From the first time you step into this engineering masterpiece, you'll be pleasantly surprised at the interior richness, spaciousness and ceiling height that you would normally associate with a large trailer.

Dolphin's Fifth Wheels are made with the same craftsmanship that have helped to make its Toyota Mini Motorhomes famous.

## Specifications

**INTERIOR:** Shower Room w/Phone Type Shower Head • Flush Toilet • Wash Basin • Medicine Cabinet • 4 cu.ft. LPG/Elec. Refrigerator • 3-Burner Range/Optional Oven • Exhaust Hood w/Fan & Light • 12,000 BTU Wall Heater w/Blower & Thermostat • 6 Gal Hot Water Heater • Demand Water System • City Water Hookup w/Pressure Regulator • 110 Volt Converter System with Battery Charger & 25' Extension Cord • Pre-Wired for Roof Air, Speakers and T.V. Antenna • Bullet Reading Lights • Low Voltage Clock • Systems Monitor Panel • Custom Laminated 5" Foam Seating w/Pillow Back Rests • Custom Pleated Drapes w/Sheers • Mini Blind Over Stove • Optional Exclusive Hidden Folding Bunk • Carpeted Throughout • Fire Extinguisher.

**EXTERIOR:** Large Radius Sliding Windows (Safety Glass) • Front Rockguard • Deluxe Wheel Covers • 2 Rear Stabilizer Jacks • Skid Bars • 4 Grab Handles • Battery Compartment • Hitch Light • Lighted Grab Rail • Backup Lights • Locking Water Inlet & Power Cord Outlet Door • Ext. Fuse Box • Separate Screen Door • Hose Carrying Rear Bumper w/Sewer Drain Hose.

**OPTIONAL EQUIPMENT:** Spare Tire • 4-Burner Range w/Oven • Heavy Duty Auxiliary Battery • Refrigerated Air Conditioner • Evaporative Cooler • AM/FM Stereo 8-Track or Cassette • Straight Axle (Increased Ground Clearance).

Length	19'	Tongue Weight	450 approx.
Interior Width	78"	GVW	4000
Interior Height	72"	LPG Tanks	7 1/2 Gal. w/Sight Gauge
Axle	Tandem	Fresh Water Tanks	25 Gal.
Dry Weight	2460	Waste Holding Tanks	32 Gal. Total

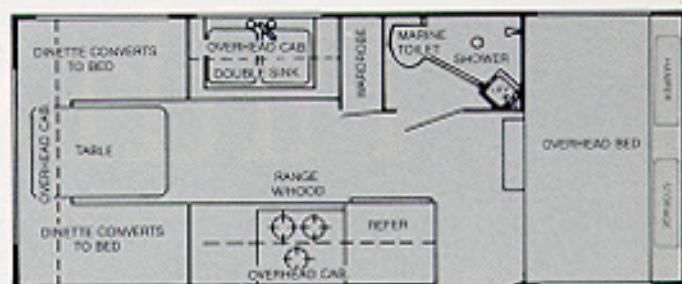

Model 5000



15372 COBALT ST., SYLMAR, CA 91342

(213) 362-5847 (213) 875-0398