

DOLPHIN



Toyota Series

1984



Dolphin...The Key to Quality

In this day of imitations and copies, there is one thing that cannot be substituted. Experience. For over 20 years now, Dolphin has established itself as the trendsetter in the industry. And in 1976, Dolphin revolutionized the motorhome industry by first introducing the timely and highly successful Micro-Mini Motorhomes that were the forerunners of today's self-contained units.

Today's smaller motorhome has established itself as a popular alternative for the RV'er. Gas prices are higher, but we still find that you want the freedom and independence of getting away without the unreasonable sacrifices. And the key

to today's recreational enjoyment is owning a quality motorhome at a cost that doesn't put you in the poorhouse. A Dolphin/Toyota Mini-Motorhome is the answer.

From the first time you step into this engineering wonder, you'll be pleasantly surprised. You'll marvel at the interior richness, spaciousness, and ceiling height that you would normally associate with a large motorhome. A lowered floorline gives you extra headroom, better handling, and a low exterior profile. This cuts down wind resistance for better performance and added gas mileage to the already economically proven power plant.

Time for personal relaxation and entertainment is at a premium these days, therefore every dollar you spend must be worthwhile. The Dolphin motorhome is a way to stretch your investment now and for the future by going with a quality, proven product. The key to Dolphin's success story is that when our name goes on, we're putting our reputation on the line.

Four m
300 D

one of the
(comes with
economical

500 R
and experi
rounding l

600 F
sized rear
down tub,
toilet and

700 R
a large fix
up, and a



Models to choose from

The cozy den-like atmosphere becomes evident as you sit in comfortable barrel chairs or divan (optional twin facing divans) of this model.

Dinette Dine in this unique model experience the spaciousness that the surge radius tinted windows provide.

Bath This unusually designed model features a full-bath complete with shower and sit cabinet space, sink, separate flush and full-sized wardrobe.

Bedroom offers the convenience of a bed that doesn't have to be made and a wardrobe.



700 Rear Bedroom



500 Rear Dinette



600 Full Bath

Specifications

CAB & CHASSIS SECTION: 4825 lbs. Gross Vehicle Weight • Toyota Chassis w/132" Wheelbase • 2367cc Engine (2.4 liter) • 4 Speed Transmission • Dual Rear Wheels • 7.50 x 14 x 6 Ply Tires or Equivalent All Around • Heavy Duty Springs • Heavy Duty Gabriel Gas Shocks • Spare Tire & Wheel • Custom Side Rear View Mirrors • Deluxe Carpeting in Cab • Bucket Seats w/Custom Upholstery • Custom Door Panels • Hose Carrying Rear Bumper • Gauges • Large Radiator for Extra Cooling • Custom Stripes on Cab • Tilt Steering Wheel

MOTOR HOME SECTION: (Standard All Models) Fully Self Contained • Telephone Type Shower Head for Water Conservation • Flush Toilet • Wash Basin • Fast Recovery 6 Gal. Hot Water Heater • 7 1/2 Gal. Propane Tank w/Sight Gauge • 21 Gal Fresh Water Tank • Systems Monitor Panel • Demand Water System • City Water Hookup • Carpeted Throughout • Large Radius Sliding Windows • Large Wardrobe with Aromatic Cedar Floor • Wooden Drawers on Steel & Nylon Glides • Custom Drapes with Sheers • Custom 5" Polyfoam Cushions • Low Voltage Clock • Separate Screen Door • Entry Step • Porch Light • Fire Extinguisher • 110V Converter w/Battery Charger and Integrated 12V Fusing and 25 ft. Power Cord • Sewer Drain Hose • Ladder and Roof Rack w/Integrated TV Antenna • Pre-Wired for 110V Roof Air • Bullet Reading Lights • 3 cu. ft. 2-Way Refrigerator • 3-Burner Range & Range Hood • Insulated Baggage Outside Access Doors

300 Standard: Shower Room w/Flush Toilet & Wash Basin • Dual Waste Holding Tanks • Large Stainless Steel Sink in Kitchen • 4 Roof Vents • Side Lounge That Makes Into Bed • Deluxe Swivel Barrel Chairs & Snack Table • Dining Table • Large Trunk Storage

500 & 700 Standard: Shower Room w/Wash Basin • Separate Flush Toilet • Dual Waste Holding Tanks • Double Stainless Steel Sinks in Kitchen • 4 Roof Vents • Large Rear Dinette w/Spacious Window • Large Trunk Storage

600 Standard: Shower Room w/Sit Down Tub & Wash Basin • Separate Flush Toilet • Dual Waste Holding Tanks • Double Stainless Steel Sinks in Kitchen • 5-Shelf Enclosed Pantry • 3 Roof Vents

OPTIONAL EQUIPMENT: Cab Dash Air Conditioning • Evaporative Cooler • 7,000 BTU Refrigerated Roof Air Conditioner • 12,000 BTU Wall Heater w/Thermostat & Blower • Dual Battery System • 4 cu. ft. 2-Way Refrigerator • 4-Burner Range & Oven • Awning • AM/FM Cassette Stereo • Cruise Control

300 Model: Twin Lounge

STANDARD CONSTRUCTION: Insulated Floor • Sheet Fiberglass Underbelly • 1 1/2" Fiberglass Insulation in Roof, Side-walls and Backwall • Tapered Roof Rafter w/High Center for Proper Drainage • All Glued & Screwed Construction • Sandwich Panel Styrofoam Insulation Under Mattress Floor

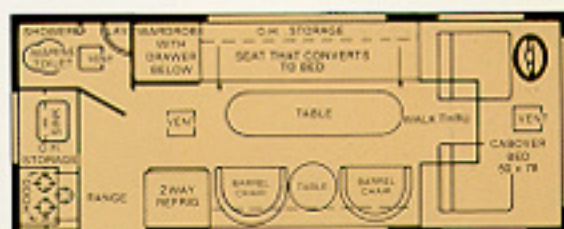

300 Den

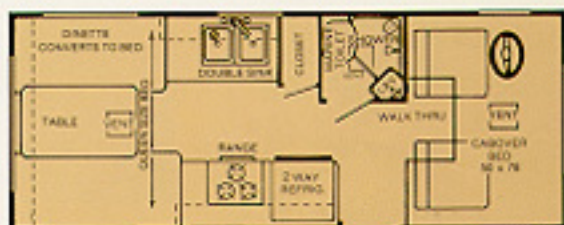

500 Rear Dinette

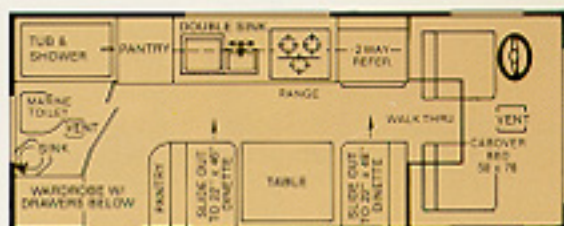

600 Full Bath

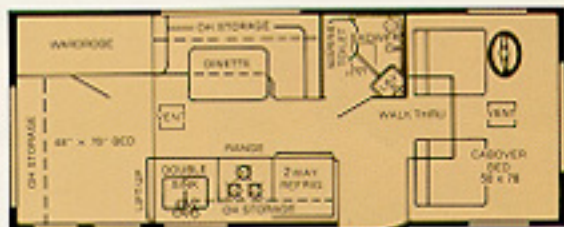

700 Rear Bedroom

Due to continual product improvement, we reserve the right to change materials, colors, specifications, and prices at any time without notification.

DIMENSIONS: Interior Height - 72"
Interior Width - 78"
Overall Length - 20'6"



We use Dometic Refrigerators in all our units to keep your fresh food truly fresh.

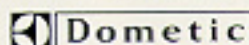

DOLPHIN
DOLPHIN R.V. PRODUCTS

15372 COBALT ST., SYLMAR, CA 91342

(818) 362-5847

(818) 875-0398