

DOLPHIN



MICRO-MINI
MOTORHOMES



The First Choice In Micro-Minis

One look at these outstanding motorhomes, and you'll see why over 15,000 smart buyers prefer Dolphin. Fact is, we created the micro-mini category in 1976. Since then, more Dolphins have taken to the road than all other micro-mini brands combined!

Innovation and value are what make Dolphin Number One. Brimming with spaciousness and luxury, these richly featured RVs combine a reasonable purchase price with economical operation for value down the road.

Interior richness and roominess are advantages you'll quickly appreciate. Dolphin's inviting floor plans provide the headroom normally associated with much larger units, plus wide-open galleys and generously sized aiseways. Interior highlights include designer-quality fabrics, mini-blinds, and deep pile carpeting.

Another important benefit is the way Dolphins handle. These powerful, nimble compacts drive like a car, and they're great on hills! Thanks to a 150 HP fuel-injected Toyota V6, Dolphin has the best power-to-weight ratio of any size motorhome. Equally important, the efficient engine teams with a wind-cutting front for impressive fuel economy. Lots of Dolphin owners enjoy driving their micro-mini so much that they use it as a second car. Surprisingly, a Dolphin actually costs less than many of today's automobiles.

Built better and backed better, your Dolphin now comes with a 12 month/18,000 mi. warranty as well as a 24-hour toll-free helpline warranty system and road service assistance. And so it won't leave you flat, a spare tire is standard equipment. (Compare!)

Now's the best time to own the motorhome of your dreams. Dolphins are very affordable to own and operate. And for bonus savings, interest is tax deductible since your Dolphin is classified as a second home. Visit your authorized dealer soon for a personal tour!



Power Pak Option

Exclusive on Model 900 is a special optional Power-Pak package with a 2.8 KW Onan generator, Dometic 11,000 BTU roof-mounted air conditioner, and 700 watt microwave oven.



Exterior Storage

Dolphin's generous payload capacities mean you never have to leave the comforts of home at home. You can pack more with the confidence that you're not overloading your motorhomes.



Step into one of the most pleasant motorhomes in the Dolphin line — the Model 900. From the moment you enter, you're sure to feel right at home. Comfortable seating and sleeping areas are well provided for.

Enjoy conversation on a large sofa that invites you to stretch out. Opposite the sofa is additional seating in the form of a dinette with a large table — or you can select the option of a pair of barrel chairs. There

are also plenty of sleeping accommodations.

MODEL 900

In addition to the overhead bed, both the sofa and dinette convert into sleepers.

Surrounded by windows, you'll thoroughly enjoy the open-air feeling that lets you experience the great outdoors even when cozily inside. Yes, here are all the conveniences of home.

You'll find a fully carpeted rear bath with shower, vanity and large wardrobe. Typical of all Dolphin models, the 900 has loads of storage space for food, clothing, and personal belongings. On the 900 and 400, there's even a large exterior storage compartment for large and bulky items.

As a value-added option, you can equip your Model 900 with Dolphin's Power-Pak which includes a generator, roof-mounted air conditioner and microwave oven.

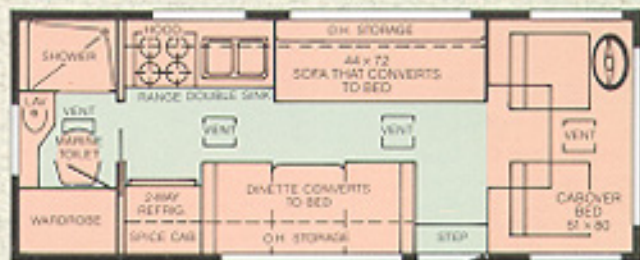

Model 900 — Rear Bath

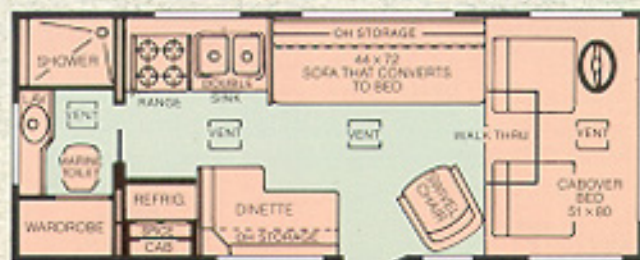

Model 400 — L-Shaped Dinette



L-Shaped Dinette

The powerful 150 HP fuel-injected V6 engine is a pure pleasure to drive. And the fuel-saving automatic over-drive transmission will keep pit stops few and far between.

**V6
POWER**



MODEL 400

Welcome inside the Model 400! You're greeted by an L-shaped dinette that's ideal for entertaining friends or just plain relaxing. If you'd like, you can set up two tables to create conversation areas. The table by the dinette is shown here, and a second can be placed in front of the sofa.

To pamper your party of four, the 400 is all-around comfortable with two beds — one's the convertible sofa and the other is a full-size 51" x 80" bed over the cab. You'll get a good night's rest on our 5" thick mattresses.

Dolphin's Value Leader

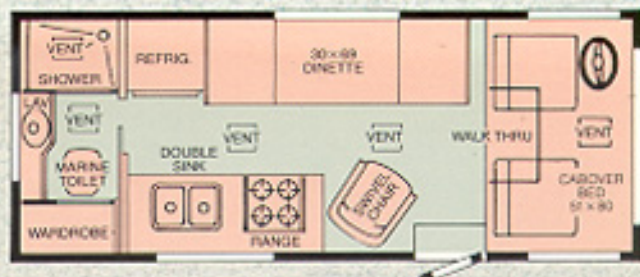

MODEL 200

Check the long list of features (back page) to see how much luxury is standard on Dolphin's lowest priced motorhome. The completely self-contained Model 200 has a fully equipped bath with separate shower, plus accommodations to sleep four in comfort. We feel it's the best value on the road!

Model 200 provides more drawer space than its competition, a standard spare tire, and some great choices. For instance, you can specify a barrel chair option to replace the storage cabinet in the galley.

Specifications

CAB & CHASSIS

	200	400	900
Toyota 6,000 lbs. GVW w/137" Wheelbase	S	S	S
3 Ltr. V6 (150 HP) Fuel Inj. Engine	S	S	S
4-Speed Automatic Transmission	O	S	S
5-Speed Transmission	S	O	O
Transmission Oil Cooler (Autom. Transmission Only)	S	S	S
Tilt Steering Wheel	S	S	S
Cruise Control	O	S	S
All Wheels Interchangeable	S	S	S
Spare Tire and Wheel	S	S	S
Reclining Bucket Seats	S	S	S
Heavy Duty Springs	S	S	S
Adjustable Air Suspension		S	S
Dual Rear Wheels	S	S	S
Dual Head Rear View Mirrors	S	S	S
Large Radiator for Extra Cooling	S	S	S

GALLEY

4 Burner Range	S	S	S
LP Gas Oven	O	S	S
Range Hood w/Fan & Light	S	S	S
4 Cu. Ft. Combination Gas/LPG/110V Refrig. (Dometic)	S	S	S
Stainless Steel Double Sink	S	S	S

INTERIOR FEATURES

Nylon Carpeted Throughout w/Pad	S	S	S
Mini Blinds on Windows	S	S	S
Quality Drapes in cabover	S	S	S
Wooden Drawers on Steel Guides w/Travel Locks	S	S	S
Rear Seat Belts	S	S	S
Low Voltage Clock		S	S
Aromatic Cedar Wardrobe		S	S
Separate Shower Area	S	S	S
Wash Basin (Lavatory)	S	S	S
Power Vent In Bath		S	S
Vents In Shower & Bath	S	S	S
12V Demand Water Pump	S	S	S
16,000 BTU Forced Air Furnace w/Thermostat	S	S	S
City Water Hook-Up	S	S	S
Low Point Drains for Winterizing	S	S	S
Windsurf Interior Color Scheme	S	S	S

EXTERIOR FEATURES

Side Door Entry Step	S	S	S
Large Storage Compartment	S	S	S
Outside Water Outlet	S	S	S
5 Roof Vents	S	S	S
Large Tinted Radius Corner Windows	S	S	S
ABS Skirts for Styling	S	S	S

S = Standard, O = Optional

FOOTNOTES

Add 12" from roof-line to overall height if equipped w/Air conditioning. Overall length is from front bumper to back bumper. Due to continual product improvement, we reserve the right to change materials, colors, specifications, and prices at any time, without notification.



24 Hour Toll-Free Help Line
As an original Dolphin owner, you can call free, anytime for expert advice for any problem you might have. (Good for 1 year from date of purchase. Non-Transferable Program can be extended for nominal fee.)



DOLPHIN

NATIONAL RV INC. 3411 North Perris Boulevard • Perris, CA 92370 • (714) 943-6007

ELECTRICAL

	200	400	900
12 Volt Interior Lighting	S	S	S
Door Entrance Light	S	S	S
Systems Monitor Panel	S	S	S
90 AMP House Battery	S	S	S
Pre-Wired for Speakers	S	S	S
4-110V Outlets	S	S	S
Cable TV Hook-Up	S	S	S
Dual Batteries	S	S	S
110 to 12V Conv. w/Battery Charger & 25' Power Cord	S	S	S
Electrical Control Centralized Breakers & Fusing	S	S	S
Ground Fault Interrupter (GFI)	S	S	S

OPTIONAL EQUIPMENT*

Roof Mounted Air Conditioner	O	O	O
Cab Dash Air Conditioning	O	O	O
DSI Hot Water Heater		O	O
AM/FM Stereo w/Cassette	O	O	O
A&E Awning	O	O	O
Power Pak Package**			O
Cruise Control	O		
LP Gas Oven	O		
Microwave	O	O	O
TV Antenna	O	O	O
Swivel Chair (In Place of Cabinet)	O		
Upgraded Interior Fabrics	O	O	O

CONSTRUCTION FEATURES

Insulated Floor with Polymax Underbelly	S	S	S
Steel Reinforced Construction	S	S	S
Vacuum Bonded Fiberglass Sidewalls, Flr. & Ceiling	S	S	S
Block Foam Insulation in Roof, Sidewalls, Back & Flr.	S	S	S
Tapered Roof for Proper Drainage	S	S	S
Reinforced & Wired for Future Air Conditioner Install.	S	S	S

CAPACITIES & DIMENSIONS

	20' 6"	22' 1"	22' 1"
Overall Length	83"	83"	83"
Overall Width	8' 6"	8' 9"	8' 9"
Overall Height	6' 1"	6' 1"	6' 1"
Interior Height	80"	80"	80"
Fuel Capacity (Gallons)	17.2	17.2	17.2
Fast Recovery Water Heater (Gallons)	6	6	6
Propane Tank w/Sight Gauge (Gallons)	5	5	5
Waste Holding Tank (Gallons)	17.5	19	19
Gray Water Waste Holding Tank (Gallons)	17	17.5	17.5
Fresh Water Tank (Gallons)	14	17	17

WEIGHTS/LBS***

Dry Weight (lbs)	4800	5010	5010
Available Payload (lbs)	1200	990	990
GVWR (lbs)	6000	6000	6000

*Options add additional weight

**Power Pak Package Includes: 2.8 Kw Onan Generator, 11,000 BTU Roof Air, 700 W. Microwave Oven (Replaces gas oven), 14 Gallon Water Tank

***w/Dash Air & Automotive Radio

Take An Armchair Tour!

Informative "Features & Benefits" VHS video tape provides a wealth of details on the Dolphin Micro-Mini. Send \$4.95 to the address below.

