

T W O T H O U S A N D T H R E E

Dolphin



Live the Legend.



THE LEGACY CONTINUES



▲ DOLP 5355 COCKPIT AREA IN FLEUR BOUQUET GARDEN



▲ DOLP 5355 WONDER BED IN FLEUR BOUQUET GARDEN



▲ DOLP 5342 GALLEY IN PACIFIC BLUE



▲ DOLP 5355 BOOTH DINETTE IN FLEUR BOUQUET GARDEN



▲ DOLP 5342 WONDER BED FOLDED OUT IN PACIFIC BLUE

For nearly 40 years, Dolphin® has been one of the most beloved brands in recreational vehicles. A relentless drive to innovate has continually reinvented Dolphin® to suit the needs of each generation, while the guiding principles of value, comfort, quality and style have endured without compromise. That's why Dolphin® owners are among the

most loyal repeat buyers around.

The 2003's are the roomiest Dolphin®'s ever, with all double-slideout floorplans and clever use of space to maximize livability throughout the coach. All models feature expansive Corian®-topped

angled galleys, with a truly magnificent double-angled slide-out galley in the spacious 5356 model. Speaking of galleys, some of the most well-equipped are found in a Dolphin with its high-output cooktop, standard convection microwave oven and broad, deep cabinets.

Usable storage space is found in every nook and cranny, such as a wide storage drawer under the 74" Wonder-Bed sleeper sofa, slide-out storage bins under the dinette seats and extra large overhead cabinets. In the bedroom, an array of drawers, cabinets, wardrobes and even an under-bed storage compartment keep everything in its place. The exclusive Sandpiper Deluxe pillow-top mattress—the only such mattress available in Dolphin®'s class—assures a great night's rest.

Check out the 2003s and you'll see why Dolphin is one of the most enduring—and *endearing*—recreational vehicle brands on the market.

CLICK ON
www.nationalrv.com
FOR MORE INFORMATION

TWO
THOUSAND
3

ADD YOUR OWN TOUCH

Personalize your Dolphin with your choice of three rich interior decors. Complement the decor with your choice of genuine hardwood cabinetry.

RICH INTERIOR FABRICS

▼ FLEUR BOUQUET GARDEN



▼ PACIFIC BLUE



▼ SANDALWOOD BEACH



GENUINE HARDWOOD CABINETRY

▼ OAK

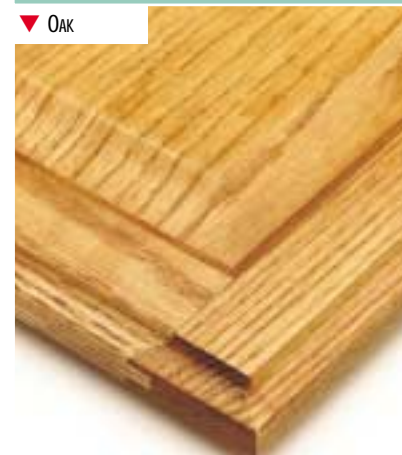

▼ MAPLE



▲ DOLP 5342 LIVING AREA IN PACIFIC BLUE



▲ DOLP 5342 BEDROOM IN PACIFIC BLUE



▲ DOLP 5355 BEDROOM IN FLEUR BOUQUET GARDEN



CHOOSE YOUR COLOR:



▲ DOLPHIN IN CABERNET



▲ DOLPHIN IN TEAL

BEST BUILT...

The entire coach body—floor, sidewalls, roof—is constructed of a rugged tubular steel framework, high density foam insulation and the highest quality interior and exterior surfaces. Each component is vacuum-bonded to form a solid, rigid structure. Every coach component is manufactured with adherence to the latest processes and the strictest quality standards. After nearly 40 years of building some of America's favorite recreational vehicles, **we know how to do it right!**

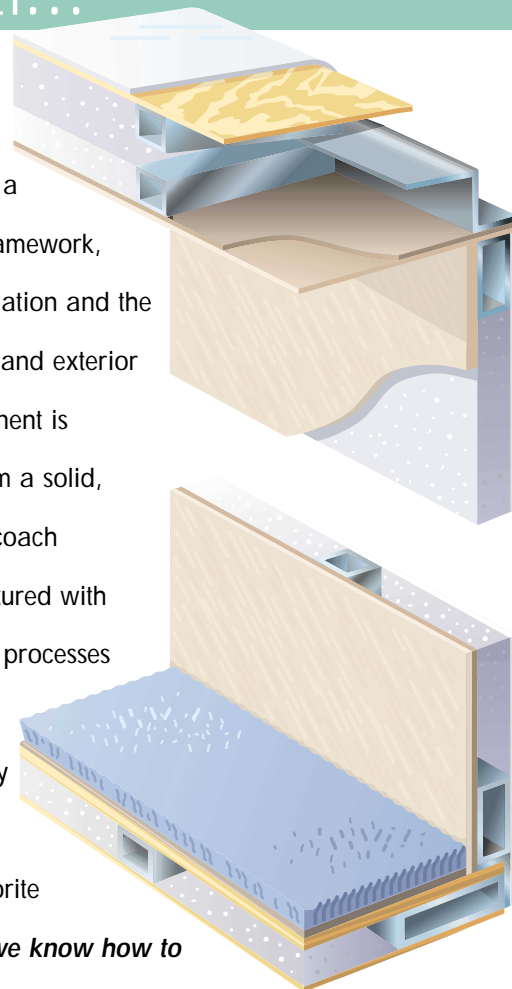

...BEST BACKED.

Peace of Mind is standard equipment with all National RV motorhomes. Our **3-years/ unlimited miles warranty** against structural defects to the coach body and subfloor structure leads the industry. Our professional



Owner Services staff, National RV's extensive dealer network as well as factory service centers on both coasts stand ready to assist with any warranty issues.

And we back you on the road against any unforeseen problems with full-featured Coach Net® emergency roadside assistance, service scheduling assistance and a host of extra travel benefits, free to you for your first year of owning your new National RV motorhome.

Coach Net.

THE TWIN PILLARS OF ULTIMATE COACH STRENGTH...



W-22 CHASSIS

The 2003, Dolphin® is built exclusively on the awesome Workhorse® W-22 chassis. The W-22 is truly the most innovative gasoline motorhome platform to come along in years as it brings diesel coach features to gasoline motorhomes—and Dolphin® was the first motorhome designed specifically for it! An impressive 22,000 lb. GVWR provides plenty of cargo and towing



capacity. Higher frame rails yield a diesel-height beltline, with increased basement storage space underneath. Large 22.5"



wheels and wide track suspension give the coach the impressive stance of a diesel motorhome. The engine is mounted lower in the frame to provide a lower center of

gravity, optimal driveline angles and an extremely low profile engine cover in the cockpit. At 340 horsepower, the GM Vortec



8100 engine is the most powerful available in a gasoline motorhome. The smooth, electronic shift 5-speed Allison automatic is the same heavy duty transmission found in many high-end diesel motorhomes. Test drive a Dolphin on the W-22, and discover the next generation of gasoline performance.



NATIONAL R.V., INC.
3411 N. Perris Boulevard
Perris, California 92571
(909) 943-6007 - Fax (909) 943-8498

www.nationalrv.com

© 2002 National R.V., Inc. Due to continuing product improvements, colors, specifications and equipment are subject to change without notice.

DURAFRAME®

Every National RV gasoline motorhome is built with patented Duraframe® technology. This patented all-steel truss-frame design imparts brute strength to the chassis to help it resist the forces of traveling, thereby relieving stresses from the sidewalls and other coach body components. This results in less squeaks and rattles and longer lasting structural integrity.

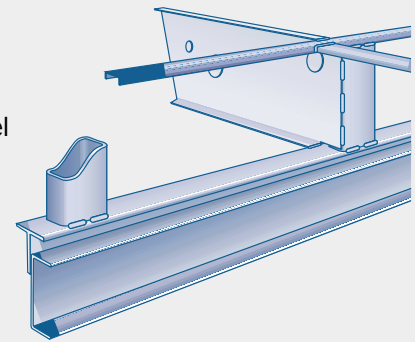

Duraframe® also makes the large, diesel-style pass-through basement storage bays possible. Duraframe® and Uni-Cage®, our all welded steel coach body construction, combine their strengths into one of the most durable motorhomes on the road.

CLICK ON www.nationalrv.com FOR MORE INFORMATION

UNI-CAGE®



YOUR AUTHORIZED DOLPHIN DEALER IS: