

# Dolphin

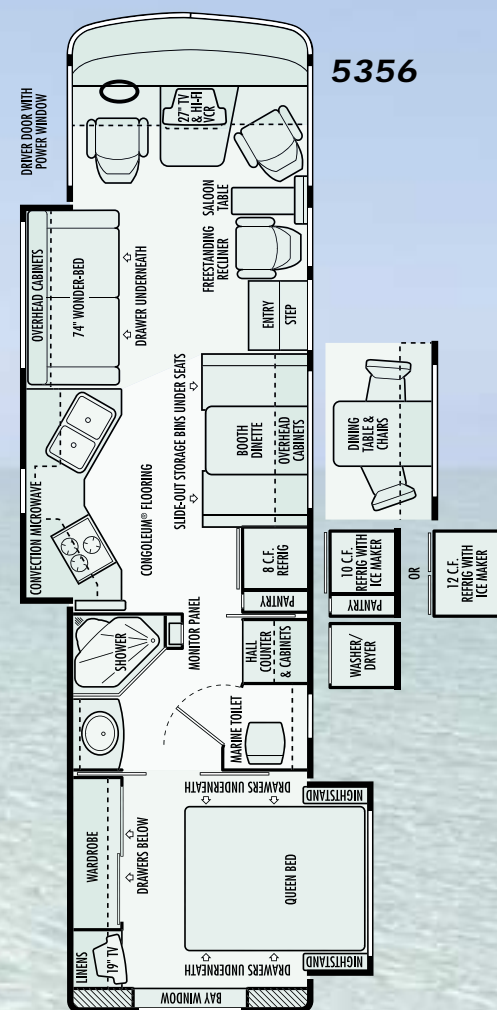
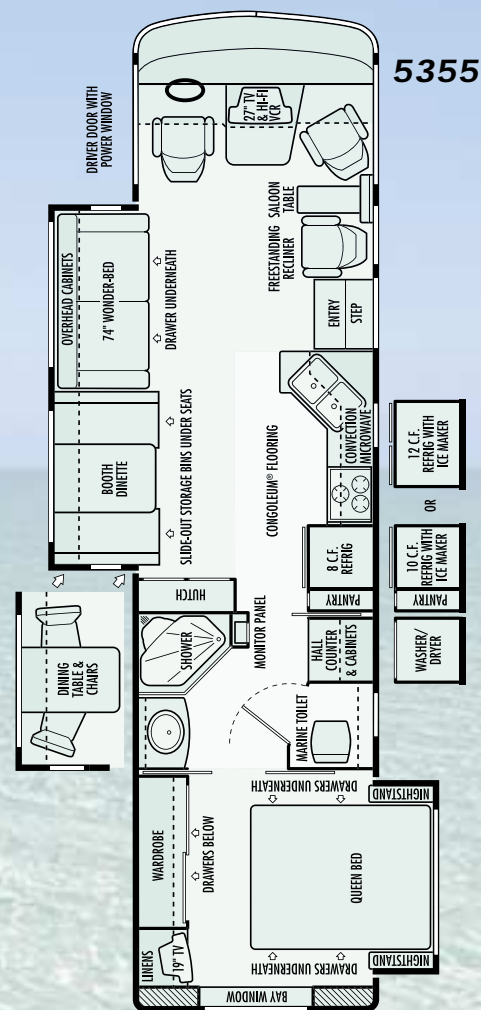
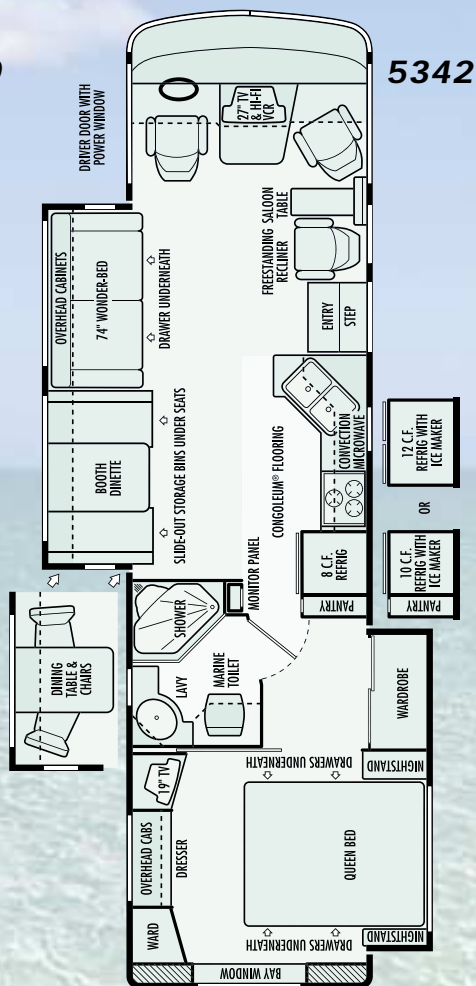
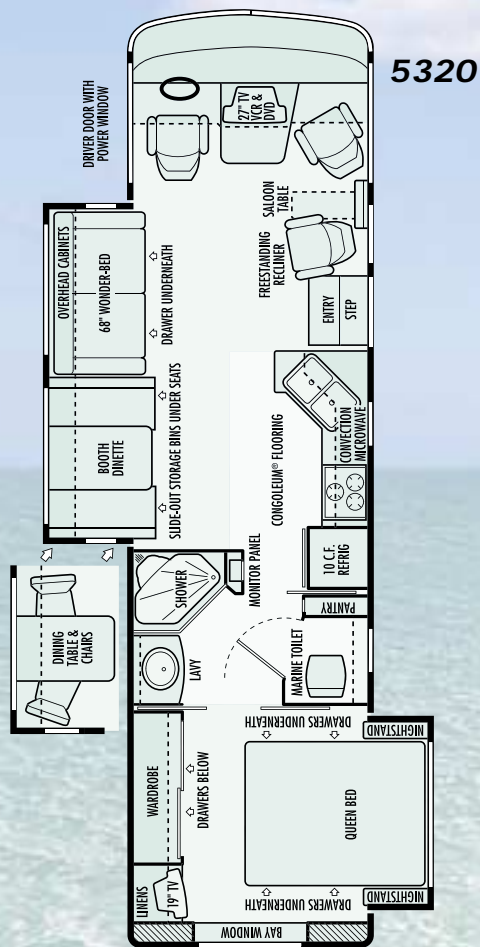

TWO THOUSAND

Due to continued product improvement, National R. V., Inc. reserves the right to change materials, colors, specifications and prices at any time without notification. Copyright © 2002 by National R. V., Inc. 07/02

3411 N. Perris Blvd. • Perris, CA 92571 • (909)943-6007

CLICK ON  
www.nationalrv.com  
FOR MORE INFORMATION

DOLPHIN FEATURES & SPECIFICATIONS

| CHASSIS SPECIFICATIONS | WORKHORSE                     |
|------------------------|-------------------------------|
| <b>Chassis</b>         | W-22 (22,000 GVWR)            |
| Tires                  | Michelin® XRV 235/80 R22.5G   |
| Wheels                 | 22.5X7, 8-Lug Steel, SS Liner |
| Brakes                 | Hydro-Boost, 4-Wheel Disc ABS |
| Drive Axle Gear Ratio  | 5.38:1                        |
| Alternator             | 130 Amp                       |
| Chassis Batteries      | (1) 690 CCA                   |
| Shock Absorbers        | Tuned Monroe®                 |
| Fuel Tank Capacity     | 75 Gallons                    |
| Hitch Capacity         | 5,000 lbs. Class III          |
| Chassis Warranty       | 3 years/36,000 miles          |
| <b>Engine</b>          | GM® Vortec® 8100              |
| Displacement           | 8.1 Liters (496 cu. in.)      |
| Peak Horsepower        | 340 HP @4,200 RPM             |
| Peak Torque            | 455 ft./lbs. @ 3,200 RPM      |
| Engine Warranty        | 3 years/36,000 miles          |
| <b>Transmission</b>    | Allison® 1000 Series          |
| Transmission Type      | 5-Speed Automatic Overdrive   |
| Transmission Warranty  | 3 years/Unlimited miles       |

| BODY CONSTRUCTION                                                                                     |
|-------------------------------------------------------------------------------------------------------|
| Duraframe® patented steel sub floor construction                                                      |
| Steel framed laminated floor                                                                          |
| Steel framed crowned laminated fiberglass roof                                                        |
| Steel framed laminated fiberglass high gloss walls                                                    |
| Front and rear molded fiberglass caps                                                                 |
| Fiberglass front and rear molded bumpers                                                              |
| Full panoramic tinted windshield                                                                      |
| Soft fabric ceiling material                                                                          |
| Electric slide-out room with overhead cabinets (flush floor on lounge slide models only)              |
| Insulated fiberglass exterior storage compartment doors with integrated paddle latches and gas struts |
| Steel framed exterior storage compartment with insulated bottoms                                      |
| Lighted storage compartments and service area                                                         |
| Exterior assist handle                                                                                |
| Aluminum rear ladder                                                                                  |
| Awning rail/rain gutter with drip spouts                                                              |
| Automotive undercoating as required                                                                   |
| Steel insulated front bulkhead                                                                        |
| Custom vinyl exterior graphics with choice of two colors                                              |

| COCKPIT FEATURES                                                       |
|------------------------------------------------------------------------|
| JVC® AM/FM stereo and CD with four speakers                            |
| Driver and passenger gooseneck reading lights                          |
| Custom dash in gray matte diamond brush finish with full gauge package |
| Convenience tray                                                       |
| Audible turn signals                                                   |
| Pantographic windshield wipers                                         |
| Power steering                                                         |

|                                                            |
|------------------------------------------------------------|
| Cruise control                                             |
| Tilt steering wheel                                        |
| Rear vision system with built-in microphone                |
| Overhead dash fans (2 speed)                               |
| Power heated rear view mirrors with double convex          |
| Passenger work station with 12V/120V receptacle in console |
| Aviation style sun visors                                  |
| Hydraulic leveling jacks with dash mounted controls        |
| Generator hour meter and auxiliary start switch on dash    |
| Wraparound privacy curtain with easy reach wand            |
| CB radio ready                                             |

| APPLIANCES & ACCESSORIES                                                       |
|--------------------------------------------------------------------------------|
| Multi-speaker TV sound                                                         |
| 8 cu. ft. double door refrigerator                                             |
| High output three burner cook top with flush mount Corian® range cover         |
| GE® SpaceSaver convection microwave oven with carousel, built-in light and fan |
| Systems monitor panel                                                          |
| Cable TV hook-up and multiple telephone jacks                                  |
| TV antenna                                                                     |
| RCA® 27" TV with front A/V jacks in cockpit                                    |
| RCA® Hi-Fi VCR in cockpit                                                      |
| RCA® 19" TV with front A/V jacks in bedroom                                    |
| Video control box with antenna booster                                         |

| FURNITURE                                                                                                   |
|-------------------------------------------------------------------------------------------------------------|
| Kustom Fit® fabric 6-way power driver recliner seat with swivel base                                        |
| Kustom Fit® fabric passenger recliner seat with swivel base                                                 |
| Kustom Fit® 74" Wonder-Bed® fabric sleeper sofa with slide-in armrests and drawer underneath (68" for 5320) |
| Freestanding Kustom Fit® fabric swivel recliner chair with footrest                                         |

| INTERIORS                                                           |
|---------------------------------------------------------------------|
| <b>Throughout Coach</b>                                             |
| Oak paneling and doors                                              |
| Telestrut hardware on overhead doors and positive catches on others |
| Drawers with ball bearing roller guide design                       |
| <b>Cockpit Area</b>                                                 |
| Floormats                                                           |
| <b>Living Area</b>                                                  |
| Booth dinette with slide-out storage drawers                        |
| Deluxe nylon carpet and pad                                         |

|                                               |
|-----------------------------------------------|
| Day/night shades with designer valances       |
| Hutch and overhead with beveled mirror (5355) |
| Solid raised panel cabinet doors              |

|                                                                        |
|------------------------------------------------------------------------|
| <b>Kitchen Area</b>                                                    |
| Slide-out pantry (not available with side-by-side refrigerator option) |
| Angled Corian® kitchen countertop with Corian® flush mount stove cover |
| Porcelain sink with wood cutting block                                 |
| sink cover                                                             |
| Wastebasket                                                            |
| One piece designer Congoleum® vinyl floor                              |
| Venetian mini-blind with valance                                       |
| Molded ABS silverware organizer                                        |

|                                                                       |
|-----------------------------------------------------------------------|
| <b>Bath Area</b>                                                      |
| One piece designer Congoleum® vinyl floor                             |
| Decorative shower glass etching                                       |
| Flat panel doors                                                      |
| Laminate lavy top with woodgrain edge                                 |
| Medicine cabinet                                                      |
| Towel bars                                                            |
| Residential doorknob for toilet room door                             |
| Dresser cabinet with four drawers (washer/dryer prep) (5355 and 5356) |

|                                                                        |
|------------------------------------------------------------------------|
| <b>Bedroom Area</b>                                                    |
| Deluxe nylon carpet and pad                                            |
| Venetian mini-blinds with valances                                     |
| Solid flat panel cabinet doors                                         |
| Cedar lining in wardrobe                                               |
| Sliding mirrored wardrobe doors with "Dolphin design" etching          |
| Color coordinated bedspread, pillows and shams                         |
| Radius padded headboard                                                |
| Wall dresser with drawers and laundry hamper (5342)                    |
| Slide-out queen bed with four pull out drawers and storage compartment |
| "Sandpiper Deluxe" residential-style pillow top mattress               |
| Laminate top nightstands with woodgrain edge                           |
| Residential style closet rods                                          |

| ELECTRICAL SYSTEMS & LIGHTS                   |
|-----------------------------------------------|
| 50 Amp MagneTek® power converter and charger  |
| 50 Amp 120V distribution panel and cord       |
| Onan® Marquis Gold™ 5.5 kW generator          |
| 400 watt inverter                             |
| Two 6V deep cycle house batteries             |
| Battery disconnect switch for house batteries |
| Porch light with interior switch              |
| 110V patio receptacle                         |
| Recessed fluorescent lights in ceiling        |
| Designer lights in living and bedroom areas   |
| Cosmetic light in bathroom                    |
| Two water pump switches (kitchen and bath)    |

|                                           |
|-------------------------------------------|
| 10 Watt solar panel (mounted on roof)     |
| GFI protected electrical circuit          |
| Courtesy light at entry-door switch panel |

| PLUMBING & LPG SYSTEMS                                  |
|---------------------------------------------------------|
| <b>Coach Exterior</b>                                   |
| Heated systems compartment with easy access to hook-ups |
| Variable rate water pump                                |
| Holding tank rinse system (black tank only)             |
| Manual dump valves                                      |
| Winterization antifreeze inlet to pump                  |
| Outside shower                                          |
| Water heater by-pass valve                              |
| Pressurized water fill with integrated regulator        |
| 10 gallon gas/electric water heater                     |

|                                                     |
|-----------------------------------------------------|
| <b>Kitchen Area</b>                                 |
| Water filter                                        |
| Delta® single lever chrome faucet with side sprayer |

|                                                                           |
|---------------------------------------------------------------------------|
| <b>Bath Area</b>                                                          |
| One-piece fiberglass angled shower with seat                              |
| Residential single lever pressure balancing shower faucet with fixed head |
| Porcelain toilet with sprayer                                             |
| Single lever brass faucet with crystal handle                             |

| SAFETY FEATURES                                             |
|-------------------------------------------------------------|
| Extra large rear view mirrors with double convex            |
| Driver and passenger three point lap and shoulder seatbelts |
| Deadbolt lock on entry door                                 |
| Fire extinguisher                                           |
| Smoke, carbon monoxide (CO) and LPG detectors               |
| Egress window                                               |

| WINDOWS, DOORS & AWNINGS                                                                                        |
|-----------------------------------------------------------------------------------------------------------------|
| Radius tinted safety glass windows (sliding windows in living area and jalousie windows in kitchen and bedroom) |
| Bedroom rear picture window                                                                                     |
| Radius entrance door with clear glass, shade and screen door                                                    |
| Power double entrance step with light and anti-skid                                                             |
| Ventilated windows on sides of slide-out rooms (lounge slides only)                                             |
| Slide-out rooms topper awnings*                                                                                 |
| Private toilet room window (5320, 5355 & 5356)                                                                  |
| Tinted skylight in bathroom                                                                                     |

| VENTILATION                                                                              |
|------------------------------------------------------------------------------------------|
| Dual 13,500 BTU Duo-Therm® low profile Penguin® air conditioners with in-ceiling ducting |
| 35,000 BTU electronic ignition furnace                                                   |

|                                                                                 |
|---------------------------------------------------------------------------------|
| Ducted heating system                                                           |
| 12V Fan-Tastic® Vent with wall thermostat and rain sensor in galley/living area |
| 12V roof exhaust fan in bathroom                                                |
| Dash automotive heating and A/C system with defroster                           |

| OPTIONAL FEATURES                                                                                                       |
|-------------------------------------------------------------------------------------------------------------------------|
| <b>Coach Exterior</b>                                                                                                   |
| Chrome electric horns                                                                                                   |
| Dual pane windows                                                                                                       |
| Manual patio awning with metal cover*                                                                                   |
| Manual living room and bedroom window awning package*                                                                   |
| Dual 13,500 BTU Duo-Therm® low profile Penguin® air conditioners with heat pumps, two-speed fans and in-ceiling ducting |

|                          |
|--------------------------|
| <b>Throughout Coach</b>  |
| Maple paneling and doors |

|                                                                      |
|----------------------------------------------------------------------|
| <b>Cockpit Area</b>                                                  |
| Oversized steering wheel with power steering                         |
| Driver door with power window                                        |
| Pioneer® AM/FM stereo with CD player, XM receiver and remote control |
| RCA® DVD player                                                      |
| JVC® multi-disc CD changer (for use with JVC® receiver)              |
| Pioneer® multi-disc CD changer (for use with Pioneer® receiver)      |
| Kingdome® automatic stationary satellite dish                        |

| WEIGHTS                             | 5320        | 5342        | 5355        | 5356        |
|-------------------------------------|-------------|-------------|-------------|-------------|
| <b>Workhorse Chassis</b>            |             |             |             |             |
| Gross Vehicle Weight Rating         | 22,000 lbs. | 22,000 lbs. | 22,000 lbs. | 22,000 lbs. |
| Gross Combined Weight Rating        | 26,000 lbs. | 26,000 lbs. | 26,000 lbs. | 26,000 lbs. |
| Front Gross Axle Weight Rating      | 8,000 lbs.  | 8,000 lbs.  | 8,000 lbs.  | 8,000 lbs.  |
| Rear Gross Axle Weight Rating       | 14,500 lbs. | 14,500 lbs. | 14,500 lbs. | 14,500 lbs. |
| Unloaded Vehicle Weight             | 18,110 lbs. | 17,980 lbs. | 18,960 lbs. | 18,810 lbs. |
| Maximum Carrying Capacity           | 3,890 lbs.  | 4,020 lbs.  | 3,040 lbs.  | 3,190 lbs.  |
| Cargo Carrying Capacity (CCC)       | 2,548 lbs.  | 2,487 lbs.  | 1,507 lbs.  | 1,657 lbs.  |
| MEASUREMENTS                        | 5320        | 5342        | 5355        | 5356        |
| Wheelbase                           | 208"        | 228"        | 228"        | 228"        |
| Overall Length                      | 33' 9"      | 34' 9"      | 36' 0"      | 36' 0"      |
| Exterior Height (Workhorse Chassis) | 12'         | 12'         | 12'         | 12'         |
| Exterior Height (with Satellite)    | 12' 6"      | 12' 6"      | 12' 6"      | 12' 6"      |
| Interior Height                     | 79 1/2"     | 79 1/2"     | 79 1/2"     | 79 1/2"     |
| Interior Width                      | 98 1/2"     | 98 1/2"     | 98 1/2"     | 98 1/2"     |
| Exterior Width                      | 102"        | 102"        | 102"        | 102"        |
| TANK CAPACITIES                     | 5320        | 5342        | 5355        | 5356        |
| Water Heater                        | 10 gal.     | 10 gal.     | 10 gal.     | 10 gal.     |
| Gray Tank                           | 50 gal.     | 60 gal.     | 60 gal.     | 60 gal.     |
| Black Tank                          | 40 gal.     | 50 gal.     | 50 gal.     | 50 gal.     |
| Fresh Water Tank(s)                 | 67 gal.     | 90 gal.     | 90 gal.     | 90 gal.     |
| LP-Gas Tank (Volume W.C.)           | 24.2 gal.   | 24.2 gal.   | 24.2 gal.   | 24.2 gal.   |

|                                                                                                                                                   |
|---------------------------------------------------------------------------------------------------------------------------------------------------|
| <b>Furniture</b>                                                                                                                                  |
| Kustom Fit® leather 6-way power driver recliner seat with swivel base and Kustom Fit® leather passenger recliner seat with swivel base            |
| Kustom Fit® leather 6-way power driver recliner seat with swivel base and Kustom Fit® leather extra-wide passenger recliner seat with swivel base |
| Kustom Fit® 74" Wonder-Bed® leather sleeper sofa with slide-in armrests and drawer underneath                                                     |
| Freestanding Kustom Fit® leather swivel recliner chair with footrest                                                                              |

|                                                             |
|-------------------------------------------------------------|
| <b>Living Area</b>                                          |
| Freestanding dinette table with four low-back wooden chairs |

|                                                                    |
|--------------------------------------------------------------------|
| <b>Kitchen Area</b>                                                |
| 10 cu. ft. double door refrigerator with icemaker (with pantry)    |
| 12 cu. ft. side-by-side refrigerator with icemaker (delete pantry) |
| 21" high output three-burner range with oven (surface mounted)     |
| Corian® countertop extension (5342 and 5355)                       |

|                                          |
|------------------------------------------|
| <b>Bathroom Area</b>                     |
| Combination washer/dryer (5355 and 5356) |
| <b>Bedroom Area</b>                      |
| Pleated day/night shades                 |

\*Not available on CSA units

Due to continued product improvement. National R. V., Inc. reserves the right to change materials, colors, specifications and prices at any time without notification. Copyright © 2002 by National R. V., Inc. 07/02