



for the "Resourceful RVer"

**the perfect RV
for the first time buyer**



TECHNOLOGY SURROUNDED BY TRADITION

BY **Newmar Corp.** 



1991

Travel Trailers & Fifth Wheels



*Newmar Corporation:
A sound company backed by
23 years of experience.*



Dutch Star...for the "Resourceful RVer"

"At last we found an affordable RV that was created for folks just like us, first time buyers on a budget. Not only did we find the perfect floorplan and size, we also discovered a handsome, well-equipped towable: **The Dutch Star**. Best of all, it's manufactured by the company that *knows* recreational vehicles: Newmar Corporation!"

"That's all the insurance we needed to make the choice for our first RV. Newmar has been manufacturing all types of recreational vehicles for over 23 years and they know how to build experience and quality into every product they offer."

"***Affordable enjoyment and reliability*** is what it's all about in our family and **Dutch Star** has opened the door to a whole new world of recreation for us."

"If you are confused by the overwhelming number of brands, models and sizes of RVs being offered, especially for the first time buyers like us, do what we did and see your nearest **Dutch Star** dealer soon. He'll take all the confusion out of buying your first RV. He'll also leave you with confidence in your decision and a balance in your checkbook!"

STANDARDS

- Air Cond. Prep (w/Wiring)
- Furnace 20M Electronic Ignition (22'-26')(TT only)
- Furnace 25M Electronic Ignition (28'-36')
- Heat in Floor Ducted
- LP Gas Bottles 2-30# Steel w/Auto Reg
- Bath Acc. (1-towel bar, tis hldr, 1-towel ring) Brass
- Faucet for Lavatory Dbl Handle Mixing
- Faucet for Shower Dbl Handle Mixing w/Spigot
- Faucet for Sink Dbl Handle
- Microwave Prep 22 1/4" W x 15" H
- Range Larger 4-Burner Porcelain, Blk Glass Door w/Pilot Top & Oven (except 20')
- Range Hood w/Light & Fan
- Refri Norcold Single Door 442 2-Way
- Sink Dbl Porcelain
- Stool Aqua Magic III
- Tub ABS w/Curtain
- Tub Surround
- Water Heater Gas 6 Gal
- Cabinetry Oak w/Hardwood Frame Doors
- Drawers Wood w/Metal Guides & Side Rollers
- Lifts for Convenient Storage Under Fixed Beds (ea)
- Converter 45 AMP w/Charger
- Electrical Service 30 AMP
- Monitor Panel
- Radio/Ant, AM/FM Stereo Cass, Clock
- Receipt 110V GFI (interior & exterior)
- TV Antenna w/Power Booster & Jack
- Bumper w/Sewer Hose Storage
- One Piece Aluminum Roof
- Step Double Manual (FW only)
- Bedspread Quilted w/Matching Shams (1 Dbl or 1 pr Twins)
- Floor Covering, Carpet w/Pad in Living Room
- Tank Gray Water 30 Gal (Approx)
- Tank Sewage Holding 30 Gal (Approx)
- Water Capacity 30 Gal (Approx)
- Water System Demand w/12V Pump & 5/8" Polybutylene Lines
- Frame Size 5" Tube
- Frame Size 6" Tube (30' & up)(TT only)
- Insulation Foil Core Roof Underlayment
- Insulation Fiberglass (R5 Sidewalls & Floor, R7 Roof)
- Tires Radial 15" w/White Spoke Wheels
- Awning Front
- Door 30" Entrance (where applic)
- Lock Dead Bolt (ea)
- Vent 12V in Bath Area w/Wall Switch
- Vent in Ceiling Non-Power
- Windows Radius Torque Reg Glass



TRAVEL TRAILER FLOOR PLANS

DUTCH STAR 22 CBD-TT

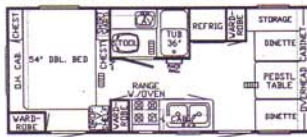

DUTCH STAR 24 DB-TT

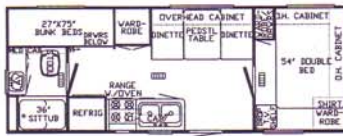

DUTCH STAR 26 FKD-TT

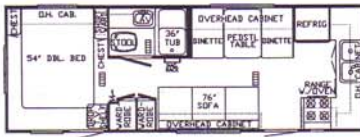

DUTCH STAR 28 CBD-TT

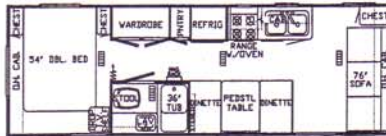

DUTCH STAR 31 FKD-TT

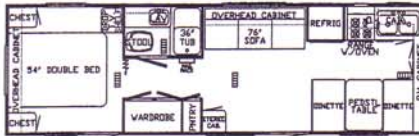

DUTCH STAR 36 DB-TT

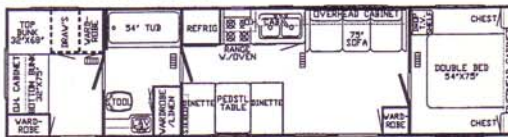

FIFTH WHEEL FLOOR PLANS

DUTCH STAR 28 RBD-FW



DUTCH STAR 28 SB-FW

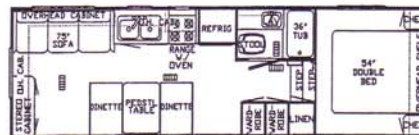

DUTCH STAR 30 WRKD-FW

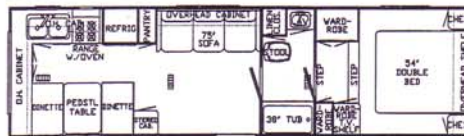

OPTIONS

OPTION A

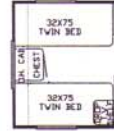

OPTION C

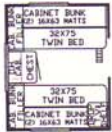

OPTION E



OPTION F



OPTION G

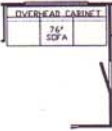

OPTION H



OPTIONS

- \$659 Air Cond 13.5 BTU
- \$40 Cover for LP Gas Bottles - ABS(TT only)
- \$396 Microwave Oven 22"
- \$276 Refri Norcold Double Door 462 ILO 442
- \$122 Tub Enclosure
- \$83 Water Heater Gas/Elec 6 Gal
- \$87 Bed Base 5" w/Lifts (FW only)
- \$110 Bed Queen (60" x 75") (where applic)
- \$132 Bed Twin (32" x 75") ILO Double
- \$151 Bunk Triple (36DB)
- \$152 Bunk Cabinet Over Twin Bed (ea) (TT only)
- \$250 Chair Swivel Rocker
- \$179 Roof Rack & Ladder
- \$35 Step Double Manual ILO Single
- \$124 Floor Covering, Carpet w/Pad Bedroom
- Floor Covering, Vinyl in Living Room
- \$333 12000 LB Hitch Plate & Bracket Center Mount (FW only)
- \$282 Jack(s) for Hitch 12V Power (FW only)
- \$103 Spare Tire ST205
- \$126 Spare Tire ST225 (36' only) State Seal
- \$109 Awning Rear (where applic)
- \$827 Awning Side A & E 8500

Newmar Kountry Klub

"Don't forget to check out the Klub...the Newmar Kountry Klub that is. All you need to be eligible is to be the proud owner of any one of the fine Newmar products!"

Dutch Star was created for the Resourceful RVer!



Your nearest Dutch Star dealer:

**Newmar Corporation, 355 N. Delaware St.
Nappanee, IN 46550-0030, (219) 773-7791**

Scheduled plant tours Monday - Friday
Prices and specs are subject to change without written notice at Newmar's discretion with no obligation.

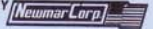

1991 TRAVEL TRAILERS & FIFTH WHEELS

BY 

MODEL	FACTORY WEIGHT* GVWR'	AXLE WEIGHT* HITCH WEIGHT*	TIRES	WHEELS	HEIGHT W/AC	LENGTH	WIDTH		
22 CBD-TT	4,300	5,800	3,850	450	205-75 R-15-C	15 X 6	10'	23' 4"	95"
24 DB-TT	4,600	6,100	4,000	600	205-75 R-15-C	15 X 6	10'	25' 9"	95"
26 FKD-TT	4,800	6,300	4,050	750	205-75 R-15-C	15 X 6	10'	26' 11-1/2"	95"
28 CBD-TT	4,700	6,200	3,750	450	205-75 R-15-C	15 X 6	10'	28' 4"	95"
31 FKD-TT	4,900	6,400	3,780	750	205-75 R-15-C	15 X 6	10' 1"	30' 8"	95"
36 DB-TT	6,850	8,350	6,200	650	225-75 R-15-D	15 X 6	10' 1"	36' 2"	95"
28 RBD-FW	4,500	6,000	3,650	850	205-75 R-15-C	15 X 6	10' 2"	27' 9-1/4"	95"
28 SB-FW	5,450	6,950	4,550	900	205-75 R-15-C	15 X 6	10' 2"	27' 9-1/4"	95"
30 WRKD-FW	6,250	7,750	5,275	975	205-75 R-15-C	15 X 6	11'	30' 5-3/4"	95"

* NO OPTIONS
SOME OPTIONS MAY ALLOW GREATER RATINGS

10-90
Printed in U.S.A.