



Palomino

Travel Trailers



1992 Thoroughbred Travel Trailers

1992 Thoroughbred Travel Trailers

Three floor plans are offered with this exciting new concept in travel trailers. Standard features include three burner stove, radius windows, ice box and a deluxe innerspring mattress. The 19-SH model includes a shower and cassette toilet as standard equipment. A full height entrance door is also standard on all models.

The crank up raisor system raises the roof in seconds and allows easy closing for travel and fuel efficiency.

Now is the time to start enjoying camping in a Thoroughbred Travel Trailer

Standard and Optional Equipment

	T-17	T-19	T-19SH
Electric Brakes.....	S	S	S
Independent Suspension.....	S	S	S
13" Tires - Radial.....	S	S	S
One Piece Floor.....	S	S	S
Stabilizer Jacks (4).....	S	S	S
Radius Windows.....	S	S	S
Water Tank.....	16 Gal.	33 Gal.	33 Gal.
Three-Burner Stove.....	S	S	S
Four-Burner Stove w/Oven.....	0	0	0
15 Amp Converter.....	S	S	-
25 Amp Converter w/Battery Charger.....	-	-	S
4 Cubic Ft. Refrigerator.....	-	0	0
3 Cubic Ft. Refrigerator.....	0	-	-
Hot Water Heater.....	0	0	S
14" x 14" Roof Vent.....	(1)	(1)	(2)
Roof A/C Ready.....	S	S	S
75# Ice Box.....	S	S	S
Full Height Entrance Door.....	S	S	S
Awning Window (Curb Side).....	S	S	S
Front Sliding Window w/Awning.....	S	S	S
Cassette Toilet.....	-	-	S
Deluxe Innerspring Mattress (52" x 82").....	(1)	(1)	(1)
Second Deluxe Innerspring Mattress.....	0	0	0
4" Deluxe Dinette & Mat.....	S	S	S
Shower.....	-	-	S
2" Coupler.....	S	S	S
Awning by A & E.....	0	0	0
Outside Storage Compartments.....	S	S	S
Outside Receptacle.....	S	S	S
Patio Light.....	S	S	S
Overhead Cabinet.....	S	S	S
Entrance Step.....	S	S	S
Double 20# Gas Bottle Hookup.....	0	0	0

S = STANDARD O = OPTIONAL — = NOT AVAILABLE

ALL PALOMINOS BUILT TO COMPLY WITH RVI CODES, AND AMERICAN NATIONAL STANDARDS INSTITUTE REGULATIONS. SPECIFICATIONS SUBJECT TO CHANGE WITHOUT NOTICE. SPECIFICATIONS IN THIS BROCHURE ARE BASED ON INFORMATION AT TIME OF PUBLICATION. VANGUARD INDUSTRIES OF MICHIGAN, INC., RESERVES THE RIGHT TO MAKE CHANGES IN MATERIALS, COMPONENTS AND SPECIFICATIONS AND TO DISCONTINUE MODELS AT ANY TIME WITHOUT NOTICE OR OBLIGATION. DEPENDING ON MATERIALS, FROM TIME TO TIME, WEIGHTS MAY VARY PLUS OR MINUS FIVE PERCENT.

LIFETIME LIMITED WARRANTY - Vanguard Industries warrants lifetime limited warranties for the lifetime of the original owner for : Lifter Systems • Beds • Frames • Floors.

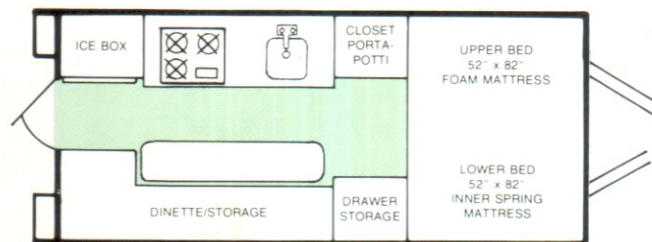

THOROUGHbred-17 (T-17)

Approx. Hitch Weight: 175#
 Approx. Axle Weight: 1675#
 Length: 16' 5"
 Travel Height: 6' 9"
 Width: 7' 2"

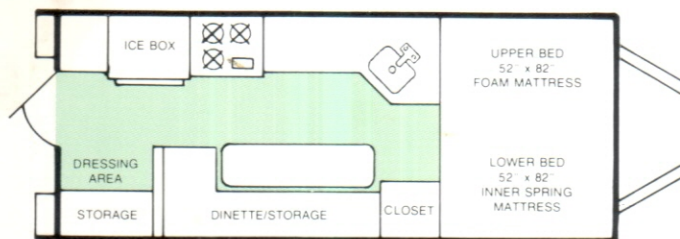

THOROUGHbred-19 (T-19)

Approx. Hitch Weight: 235#
 Approx. Axle Weight: 2075#
 Length: 18' 7"
 Travel Height: 6' 9"
 Width: 7' 2"

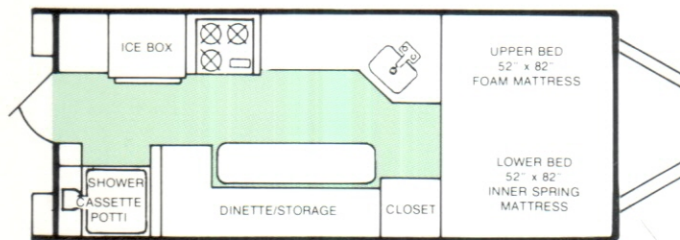

THOROUGHbred-19SH (T-19SH)

Approx. Hitch Weight: 235#
 Approx. Axle Weight: 2075#
 Length: 18' 7"
 Travel Height: 6' 9"
 Width: 7' 2"

TENT WARRANTY - Vinyl Tents manufactured by Vanguard Industries warranted for 5 years to original owner to be free from defects in materials and workmanship under normal use and service.



Palomino

Established in 1968
 VANGUARD INDUSTRIES
 OF MICHIGAN, INC.
 Colon, Michigan 49040
 Phone (616) 432-3271