

1 9 9 3

TRAVEL  
TRAILERS  
&  
TRUCK  
CAMPER



P A L O M I N O



## MATCH YOUR TRUCK WITH A PALOMINO BRONCO

Palomino pop-up truck campers—one of the industry's lightest weight lines—are the ideal match for today's trucks. The B-500 fits virtually all mini trucks—both imported and domestic—while the B-1000 is perfectly suited for most half-ton trucks.

Both models are well-equipped for maximum comfort. Standards include a full-height entrance door, complete kitchen, port-a-potti storage, a comfortable innerspring mattress and underbed storage. Vinyl tent fabric with tinted windows, an ice chest and combination sliding/jalousie glass windows are also standard equipment.

When closed, Palomino truck campers have a low profile for greater fuel efficiency. A smooth-operating crank-up system raises and lowers the roof quickly and easily.

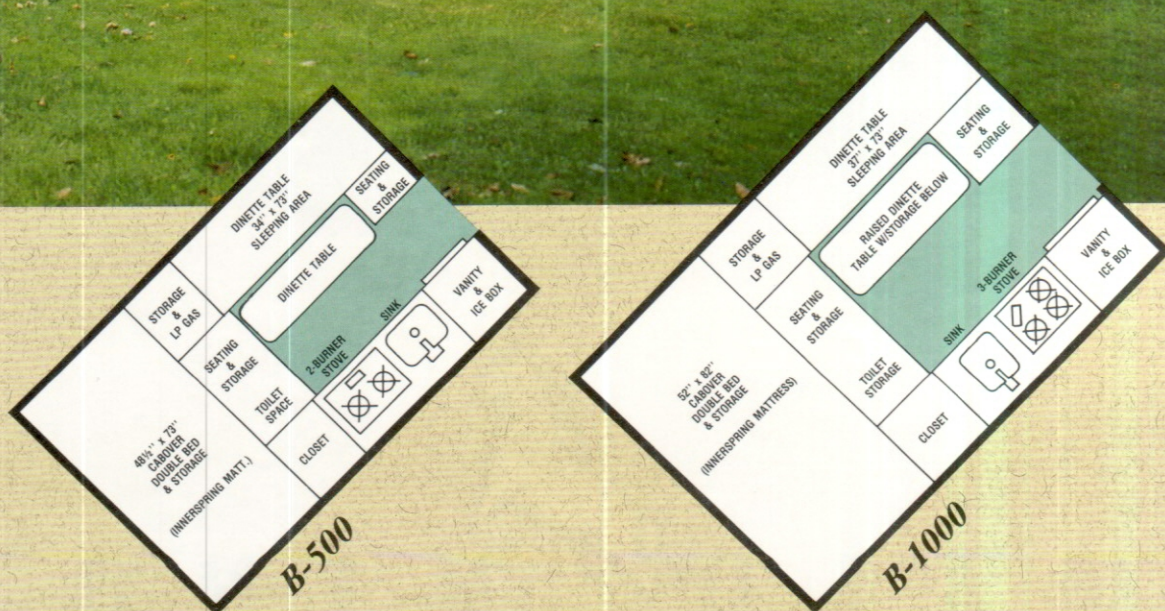

# TRUCK CAMPERS



## PALOMINO THOROUGHbred—THE NAME TO REMEMBER

Palomino's travel trailers fold down to provide a low profile for easy, fuel efficient towing and raises in just a few seconds for full-size, full-height camping comfort.

Choose a 16- or 18-footer, or the fully loaded luxury 20-foot model. Well-equipped for total enjoyment, all Thoroughbred models offer an innovative full-height, easy access side entrance door.

Included on the long list of standard features applicable to all models are 13-inch tires, a three burner stove, radius windows with shades and a side-loading ice box. The 18-footer has an optional toilet with holding tank; this feature is standard on the 20-footer. All three models have a comfortable pull-out couch to provide additional sleeping space.



Photography sites courtesy of **FUNCTION JUNCTION** Mendon, Michigan

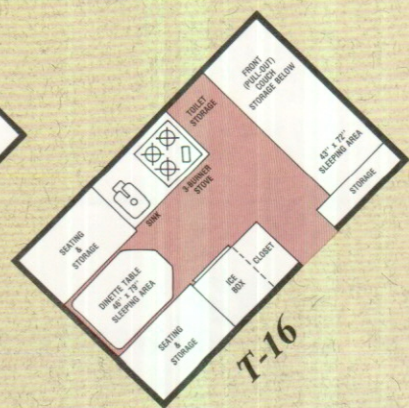
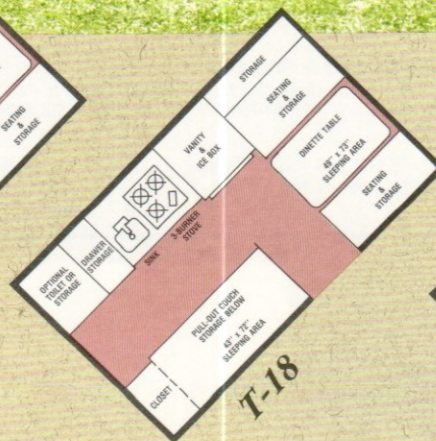
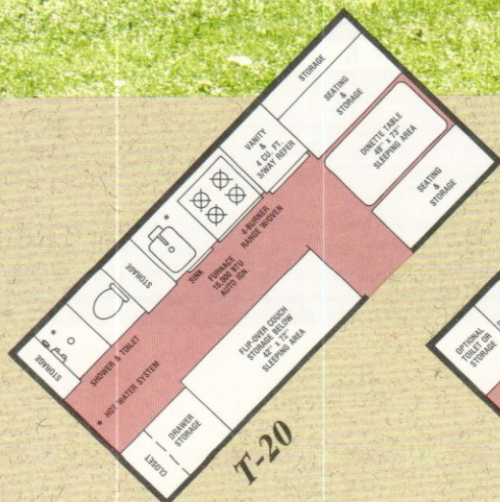

# TRAVEL TRAILERS



## BRONCO TRUCK CAMPERS

	B-500	B-1000
WEIGHT - POUNDS	740	935
BOX LENGTH	7'4"	8'
TOTAL LENGTH	10'7"	11'10"
WHEEL WELL WIDTH	36"	48"
TOTAL HEIGHT CLOSED	4'8"	5'4"
INTERIOR HEADROOM	6'4"	6'4"
BED SIZE	45" X 75"	49" X 83"
BED SIZE DINETTE	35" X 70"	36" X 73"
ENTRANCE DOOR HEIGHT	5'6"	5'7"

## THOROUGHbred TRAVEL TRAILERS

	T-16	T-18	T-20
CLOSED BODY	81"	85"	85"
CLOSED OVERALL	15'6"	17'8"	19'4"
CLOSED HEIGHT	6'7"	6'7"	6'7"
OPEN HEIGHT	6'5"	6'5"	6'5"
HITCH WEIGHT - POUNDS	175	195	250
AXEL WEIGHT - POUNDS	1,315	1,695	2,235
ELECTRIC BRAKES	0	S	S
INDEPENDENT SUSPENSION	S	S	S
13" TIRES - RADIAL	S	S	S
ONE PIECE FLOOR	S	S	S
STABILIZER JACKS (4)	S	S	S
RADIUS WINDOWS	S	S	S
WATER TANK - GALLONS	10	16 (25 HW)	33
THREE BURNER STOVE	S	S	—
THREE BURNER STOVE W/OVEN	0	0	S
9 AMP CONVERTER	S	S	—
25 AMP CONVERTER W/BATTERY CHARGER	—	—	S
4 CUBIC FT. REFRIGERATOR	—	0	S
3 CUBIC FT. REFRIGERATOR	0	—	—
HOT WATER HEATER	—	0	S
14" X 14" ROOF VENT	(1)	(1)	(2)
ROOF A/C READY	0	S	S
75# ICE BOX	S	S	S
FULL HEIGHT ENTRANCE DOOR	S	S	S
AWNING WINDOW (CURB SIDE)	S	S	S
FRONT SLIDING WINDOW W/AWNING	S	S	S
TOILET WITH HOLDING TANK	—	0	S
FURNACE 16,000 BTU AUTO IGNITION	—	0	S
FURNACE 12,000 BTU AUTO IGNITION	0	0	—
4" DELUXE DINETTE & MAT	S	S	S
SHOWER	—	—	S
2" COUPLER	S	S	S
AWNING BY A & E	0	0	0
OUTSIDE STORAGE COMPARTMENTS	—	S	S
OUTSIDE RECEPTACLE	S	S	S
PATIO LIGHT	S	S	S
OVERHEAD CABINET	S	S	S
ENTRANCE STEP	S	S	S
DOUBLE 20# GAS BOTTLE HOOKUP	0	0	S
SINGLE BOTTLE TANK WITH HOOKUP	S	S	—

S=STANDARD 0=OPTIONAL —=NOT AVAILABLE

ALL PALOMINOS BUILT TO COMPLY WITH RVI CODES, AND AMERICAN NATIONAL STANDARDS INSTITUTE REGULATIONS. SPECIFICATIONS SUBJECT TO CHANGE WITHOUT NOTICE. SPECIFICATIONS IN THIS BROCHURE ARE BASED ON INFORMATION AT TIME OF PUBLICATION. VANGUARD INDUSTRIES OF MICHIGAN, INC., RESERVES THE RIGHT TO MAKE CHANGES IN MATERIALS, COMPONENTS AND SPECIFICATIONS AND TO DISCONTINUE MODELS AT ANY TIME WITHOUT NOTICE OR OBLIGATION. DEPENDING ON MATERIALS FROM TIME TO TIME, WEIGHTS MAY VARY PLUS OR MINUS FIVE PERCENT.

**LIFETIME LIMITED WARRANTY** - Vanguard Industries warrants a lifetime limited warranty to the original owner for: Lifter Systems, Beds, Frames and Floors.

**TENT WARRANTY** - Vinyl Tents manufactured by Vanguard Industries are warranted for 5 years to original owner. Free from defects in materials and workmanship under normal use and service.



**Palomino**  
Established in 1968  
VANGUARD INDUSTRIES  
OF MICHIGAN, INC.  
Colon, Michigan 49040  
Phone (616) 432-3271