

STAMPEDE TRAVEL TRAILERS

2000  
*Palomino*





**Features-** EPDM Rubber Roof • Aluminum Framed Laminated Construction • Laminated, Smooth Fiberglass Exterior • Foam Insulated Walls/Floor/Roof • Laminated Under Belly • Four Screw Down Style Stabilizer Jacks (two Jacks Standard on S-15) • DBL. 20 LB. LP Gas Bottles with Reg. • Alko Torsion Axle (10" Brakes) • Slide Away Step • Sewer Hose Storage Compartment • TV Shelf • Vented Battery Box (Optional on S-15) • Vinyl Floor Covering • Fabric Window Shades • TV Cable Ready • Toilet and Shower • Medicine Cabinet with Mirror (N/A on S-15) • Power Range Hood with Fan & Light • Dometic 5 CU. FT./2-Way Refrigerator (3 CU. FT./ 3-Way Standard on S-15) • Three-Burner Range • Double Stainless Steel Sink (Single Sink on S-15) • Six Gallon Quick Recovery Water Heater • Demand Water Pump • 20,000 BTU

Ducted Furnace (16,000 BTU Furnace on S-15) • Pre-Wired For Optional Microwave • Pre-Wired For Optional Air Conditioner • Stereo Pre-Wired • 110 Volt Outside Receptacle with GFI • 28 FT. Power Cord-30 AMP. • Converter with Charger • GFI Protected Receptacles • Smoke Detector • LP Gas Detector • Patio Light with Interior Switch • Keyed Dead Bolt Entry Lock • Fire Extinguisher • Radius Safety Glass Windows • Breakaway Switch

**Optional-** Awning • Microwave • Three-Burner Stove with Oven (N/A on S-15) • Air Conditioner (13.5) • AM/FM Stereo with Cassette • AM/FM Stereo with CD Player • TV Antenna • Spare Tire with Cover • Systems Monitor Panel • Range Cover • Sink Covers • Outside Stove • Bunk Lights • Outside Shower



SPECIFICATIONS													
MODEL	GROSS DRY WEIGHT	AXLE WEIGHT	HITCH DRY WEIGHT	GVWR	CARRYING CAPACITY	INTERIOR HEIGHT	EXTERIOR HEIGHT	EXTERIOR WIDTH	EXTERIOR LENGTH	OPEN LENGTH	FRESH WATER CAPACITY	GRAY WATER CAPACITY	BLACK WATER CAPACITY
STAMPEDE-15	1877 LBS.	1577 LBS.	300 LBS.	3020 LBS.	1143 LBS.	76"	102"	90"	14'10"	18'2"	16 GAL.	30 GAL.	9 GAL.
STAMPEDE-17	2453 LBS.	2118 LBS.	335 LBS.	3335 LBS.	882 LBS.	76"	102"	90"	17'2"	22'	25 GAL.	30 GAL.	30 GAL.
STAMPEDE-19	2936 LBS.	2666 LBS.	270 LBS.	4670 LBS.	1734 LBS.	76"	102"	90"	19'8"	24'6"	25 GAL.	30 GAL.	30 GAL.
STAMPEDE-21	3097 LBS.	2737 LBS.	360 LBS.	4760 LBS.	1663 LBS.	76"	102"	90"	21'6"	26'6"	25 GAL.	30 GAL.	30 GAL.
STAMPEDE-21SL	3197 LBS.	2817 LBS.	380 LBS.	4780 LBS.	1283 LBS.	76"	102"	90"	21'8"	26'6"	25 GAL.	30 GAL.	30 GAL.

## Floor Plans

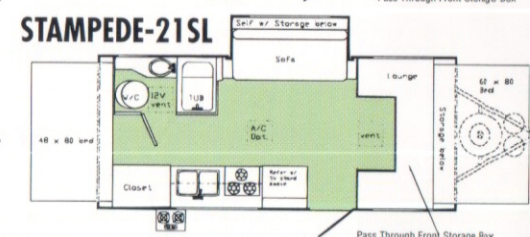
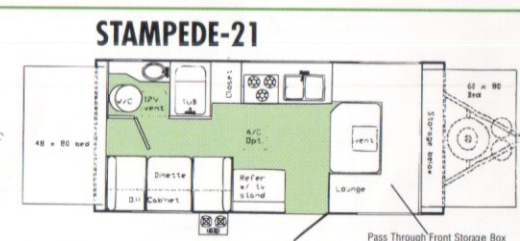
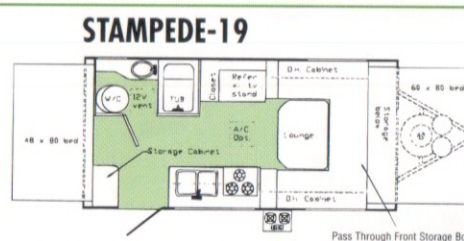
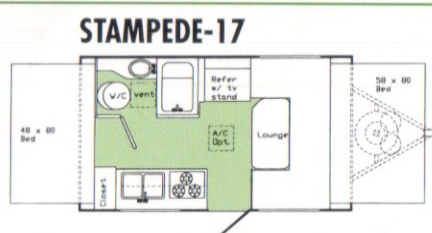
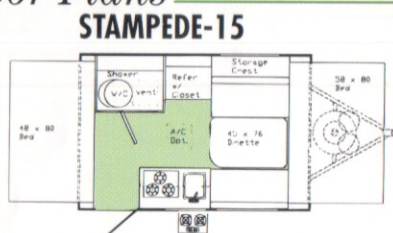

All Palominos built to comply with RVIA codes, and American National Standards Institute regulations. Specifications subject to change without notice. Specifications in this brochure are based on information at time of publication. Vanguard Industries of Michigan, Inc., reserves the right to make changes in materials, components and specifications and to discontinue models at any time without notice or obligation. Depending on materials from time to time, weights may vary plus or minus five percent.

### General Warranty Information\*\*

Rubber Roof...12 years • Fiberglass Skin...2 years • Chassis Frame...5 years • Structure...3 years • Al-Ko Torsion Suspension...5 years • Tent Fabric...5 years • General Camper Coverage...1 year

\*\* Refer to actual printed warranty statement for details.



VANGUARD INDUSTRIES OF MICHIGAN, INC., COLON, MICHIGAN 49040, (616) 432-3271 [www.palominorv.com](http://www.palominorv.com)