

Palomino



2001 ULTRA-LITE FIFTH WHEELS



Features- EPDM Rubber Roof ● Aluminum Framed Laminated Construction ● Laminated, Smooth Fiberglass Exterior ● Foam Insulated Walls/Floor/Roof ● Laminated Under Belly ● Rear Screw Down Stabilizer Jacks ● DBL. 30 lb. LP Gas Bottle with Regulator (20 lb./f-21) ● ALKO Torsion Axle (10" Brakes)

- Slide Away Step ● Sewer Hose Storage Compartment
- TV Cable Ready ● Vented Battery Box ● Fabric Window Shades ● 12 Volt Power Roof Vent ● Medicine Cabinet with Mirror ● Power Range Hood with Fan & Light ● Dometic 6 Cu. Ft./2-Way Refrigerator (5 Cu. Ft./F-21)
- Electric Slide (F-25RLS & F-25RBS Only) ● Double Sink ● Six Gallon Quick Recovery Water Heater ● Demand Water Pump ● 20,000 BTU Ducted Furnace ● Sink Covers ● Pre-Wired For Optional Air Conditioner ● 110 Volt Outside Receptacle with GFI ● 28 FT. PowerCord—30 AMP.
- 45 AMP. Converter with Charger ● GFI Protected Receptacles ● Smoke Detector ● LP Gas Detector ● Keyed Dead Bolt Entry Lock ● Radius Safety Glass Windows ● Breakaway Switch ● Under Bed Storage

Accessory Package- TV Antenna ● Outside Shower ● Systems Monitor Panel ● Spare Tire & Cover ● Three Burner Stove W/Oven & DSI Water Heater ● CD Player ● Microwave ● Safety Glass ● Awning ● Range Cover

Options- Air Conditioner ● Roof Rack and Ladder ● Electric Fifth Wheel Jacks ● Slide Topper (Except F-21RL)

Floor Plans

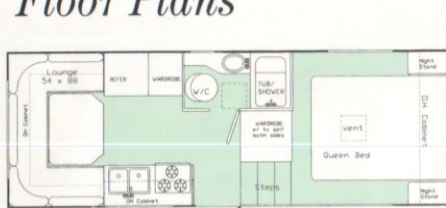

F-21RL

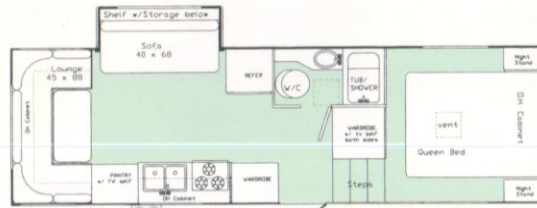

F-25RLS

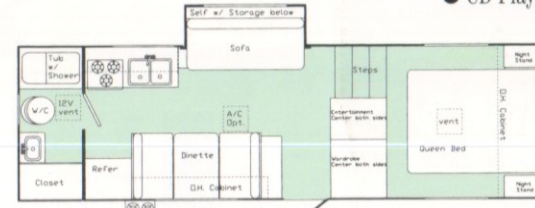

F-25RBS

S P E C I F I C A T I O N S

MODEL	GVWR	HITCH DRY WEIGHT	GROSS DRY WEIGHT	CARRYING CAPACITY	TIRE SIZE	INTERIOR HEIGHT	BED AREA HEIGHT	EXTERIOR HEIGHT	EXTERIOR WIDTH	OVERALL LENGTH	FRESH WATER CAPACITY	GRAY WATER CAPACITY	BLACK WATER CAPACITY
F-21RL	6640 LBS.	1061 LBS.	4035 LBS.	1991 LBS.	13"	7'2"	46"	9'10"	91"	22'6"	25 GAL.	30 GAL.	30 GAL.
F-25RLS	7000 LBS.	957 LBS.	4729 LBS.	1617 LBS.	14"	7'2"	46"	9'10"	91"	26'6"	25 GAL.	30 GAL.	30 GAL.
F-25RBS	7000 LBS.	947 LBS.	4878 LBS.	1468 LBS.	14"	7'2"	46"	9'10"	91"	26'6"	25 GAL.	30 GAL.	30 GAL.

General Warranty Information**

- Rubber Roof...12 years ● Fiberglass Skin...2 years ● Chassis Frame...5 years
- Structure...3 years ● Al-Ko Torsion Suspension...5 years ● Tent Fabric...5 years
- General Camper Coverage...1 year

** Refer to actual printed warranty statement for details.

All Palominos built to comply with RVIA codes, and American National Standards Institute regulations. Specifications subject to change without notice. Specifications in this brochure are based on information at time of publication. Vanguard Industries of Michigan, Inc., reserves the right to make changes in materials, components and specifications and to discontinue models at any time without notice or obligation. Depending on materials from time to time, weights may vary plus or minus five percent.

Palomino Fifth Wheels are designed to meet the varied needs of the customer. It is the responsibility of the owner to select the proper load combination for their individual needs without exceeding the listed axle weight capacities.

Palomino

VANGUARD INDUSTRIES OF MICHIGAN, INC., COLON, MICHIGAN 49040, (616) 432-3271 www.palominorv.com