



2009 TRUCK CAMPERS

DISCOVER A NEW WORLD



Bronco | Maverick | Winter Creek



Discover a whole new world of fun and adventure with the Bronco folding truck camper. This lightweight truck camper features a pop-up roof that raises with an easy-to-operate crank system, creating a spacious interior with full stand-up room and lots of convenient features. The exterior is constructed with sturdy laminated sidewalls on the lower portion of the unit and durable vinyl coated canvas on the upper portion. Most importantly with today's gas prices, the Bronco's lightweight, low profile design gives you better fuel efficiency and on-the-road handling.



Model B-1251 SB

BRONCO STANDARDS & OPTIONS

STANDARDS

- 12 Volt Interior Lights
- 12 Volt Patio Light
- 120 Volt Outside Receptacle/GFI
- 14" x 14" Roof Vent
- 25 AMP Converter with Charger
- 30 Ft. Detachable Power Cord (30 AMP)
- Armstrong® Vinyl Floor Covering
- Bedspread
- Carbon Monoxide/LP Gas Detector
- City Water Hookup
- Demand Water System
- Entry Assist Handle

- Hot Water System with Outside Shower (N/A on B-600 and B-800; Opt. on B-1200 and B-1250 SB)
- Ice Box – 35 Lbs.
- Innerspring Mattress
- Laminated Construction
- Overhead Storage Cabinet
- Pleated Fabric Window Shades
- Porta-Potti Storage (N/A on B-1251 SB and B-1500 LB)
- Privacy Drape/Cab Over
- Roof Air Ready
- Steel Floor Supports
- Three Burner Cook Top (2 on B-600 and B-800)

- Toilet with Holding Tank (B-1251 SB and B-1500 LB Only)
- Under Bed Storage
- Vinyl Coated Canvas
- Wheel Well Access Doors
- Zippered Escape in Cab Over

OPTIONS

- 16,000 BTU Furnace
- Air Conditioner (13,500 BTU)
- Air Conditioner (Low Profile 13,500 BTU)
- AM/FM CD Player
- Backup Camera
- Camper Dolly
- Create-A-Breeze™ Fan (Mandatory Option)

- Dakota Option (B-800, B-1200, B-1250 SB and B-1250 SB)
- Dometic® Refrigerator — 2 Cu. Ft. 3-Way (B-600 Only)
- Dometic® Refrigerator — 3 Cu. Ft. 3-Way (N/A on B-600)
- Dually Brackets (N/A on B-600)
- Electric Jacks
- Entry Step (4 Step)
- Hot Water System with Outside Shower (N/A on B-600 and B-800; Std. on B-1251 SB and B-1500 LB)
- Side Awning
- Solar Panel (5 Watt)
- Thule™ Boat/Bike Rack

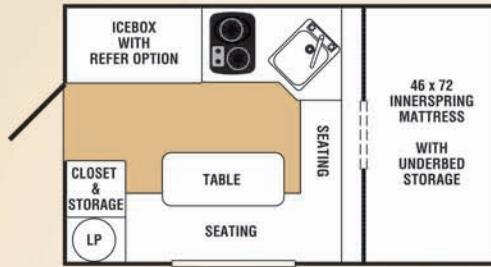

B-600

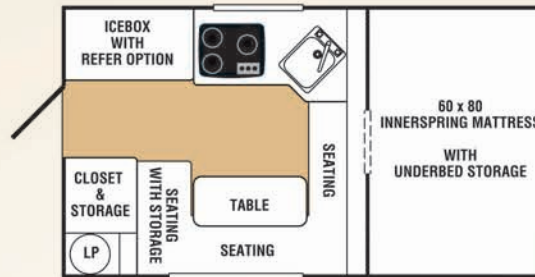

B-1200 and B-1250 SB

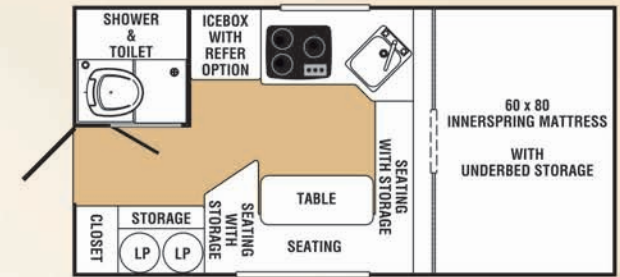

B-1500 LB

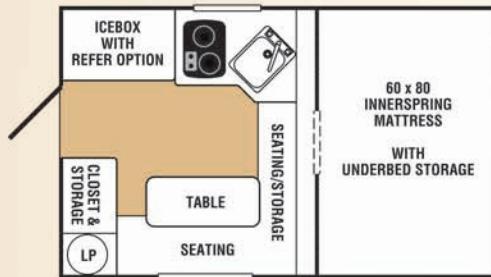

B-800

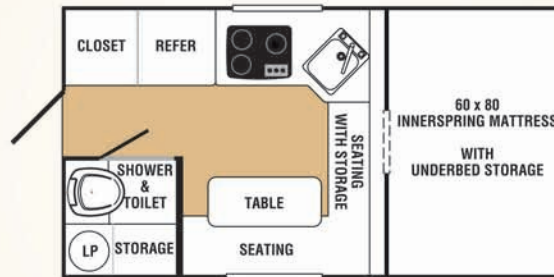

B-1251 SB



Bronco Fabric

Be ready
for adventure.



BRONCO SPECIFICATIONS	B-600	B-800	B-1200	B-1250 SB	B-1251 SB	B-1500 LB
Total Exterior Length	11' 0"	11' 4"	12' 10"	12' 10"	13' 4"	14' 4"
Total Exterior Width	6' 5"	7' 2"	7' 2"	7' 2"	7' 2"	7' 2"
Floor Length	7' 4"	6' 9"	8' 0"	8' 0"	8' 6"	9' 6"
Wheel Well Width	36"	48"	48"	48"	48"	48"
Opt. Dakota Wheel Well Width	N/A	44"	44"	44"	N/A	N/A
Height Closed with Vent	4' 11"	5' 5"	5' 5"	5' 5"	5' 5"	5' 5"
Interior Open Height	6' 4"	6' 4"	6' 4"	6' 4"	6' 4"	6' 4"
Dry Weight (lbs.)	1004	1126	1265	1325	1463	1577
Fresh Water Capacity (Gals.)	10	16	16	16	22	22
Black Water Capacity (Gals.)	N/A	N/A	N/A	N/A	7	7
LP Gas Capacity	20 lbs.	20 lbs.	20 lbs.	20 lbs.	20 lbs.	Two - 20 lbs.
Cab Over Bed Size	46 x 72	60 x 80	60 x 80	60 x 80	60 x 80	60 x 80
Dinette Bed Size	20 x 69	36 x 62	36 x 72	36 x 72	36 x 62	36 x 72
Full Size Entrance Door (5' 7")	Std.	Std.	Std.	Std.	Std.	Std.

Palomino
Maverick

Take to the road with abandon. Maverick has all you need for your traveling pleasures. The Maverick offers all the amenities of a travel trailer in an easy, on-the-go truck mounted unit. With a handsome smooth fiberglass exterior, the efficiently designed interior is fully furnished with features not usually found in other truck campers. A queen size bed with pillow top mattress, fully equipped galley, complete bathroom facilities, storage closets, and even a slide-out for expanded living space give you comfort and value.

Experience
the freedom.





Model M-1000 SLLB



M-1000 SLLB Kitchen



M-1000 SLLB includes a booth dinette that converts into a bed for additional sleeping space.



Yamaha® 2400 Portable Generator
(Optional on all models)



Maverick Fabric



STANDARDS

- 12 Volt Power Vent in Bath
- 16,000 BTU Furnace with Auto Ignition
- 2,000 Lbs. Manual Ball Screw Jacks
- 45 AMP Converter with Charger
- 6 Gal. Water Heater with Outside Shower (N/A on M-700)
- AM/FM CD Player with Cassette
- Amplified TV Antenna
- Armstrong® Vinyl Floor Covering
- Bedspread
- Carbon Monoxide and LP Gas Detectors
- Detachable 30 Ft. Power Cord — 30 AMP
- Dometic® 5 Cu. Ft. Refrigerator

- Egress Vent/Cab Over
- Entry Assist Handle
- EPDM Rubber Roof
- Ladder
- Laminated Smooth Fiberglass Exterior
- Lower Door Window
- Overhead Storage Cabinet
(N/A on M-1000 SLLB)
- Pillow Top Mattress
- Pre-Wired for Optional Electric Jacks
- Steel Floor Supports
- System Monitor Panel
- Three-Burner Range with Oven
and Range Cover (Oven N/A on
M-700, M-800 and M-6601)

- TV Cable Ready
- Vented Battery Box
- White Radius Safety Glass Windows

- Air Conditioner (11,000 BTU)
- Backup Camera
- Camper Dolly
- Create-A-Breeze™ Fan (Mandatory Option)
- Dually Brackets
- Electric Jacks with Remote
- Entry Step (4 Step Scissor)
- Folding Sofa Bed (M-1000 LB, M-7701, M-8801 and M-9901)
- Low Profile A/C

- Microwave Oven
- Overhead Bunk (N/A on M-700, M-800 and M-1000 SLLB)
- Raised Refrigerator Panel
- Rear Awning (N/A on M-700 and M-800)
- Rear Bumper
- Serta® Mattress Upgrade
- Short Bed Package (N/A on M-1000 and M-1000 SLLB)
- Side Awning
- Solar Panel (5 Watt)
- Stainless Steel Package
- Yamaha® 2400 Portable Generator

[illegible]

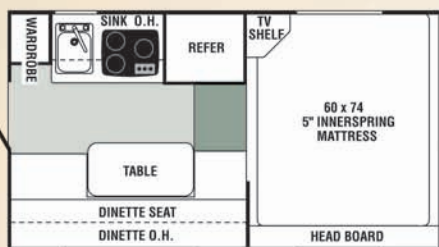

M-700

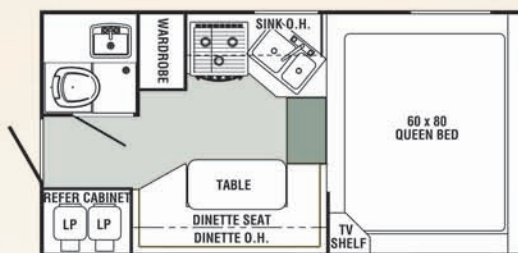

M-7701*

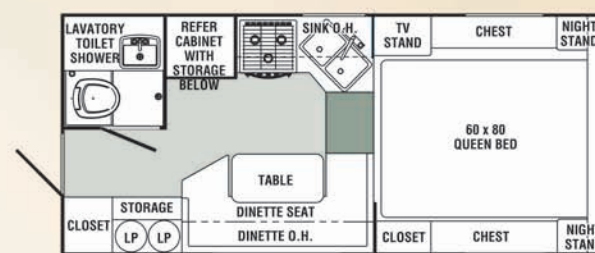

M-1000 LB

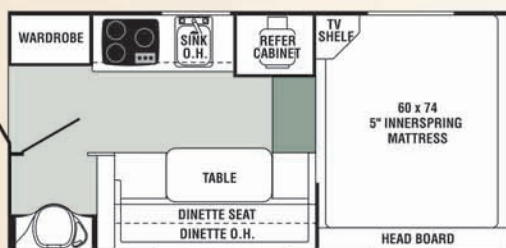

M-800

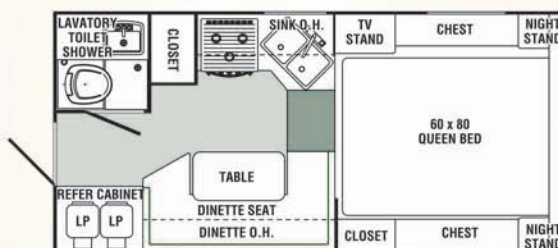

M-8801*

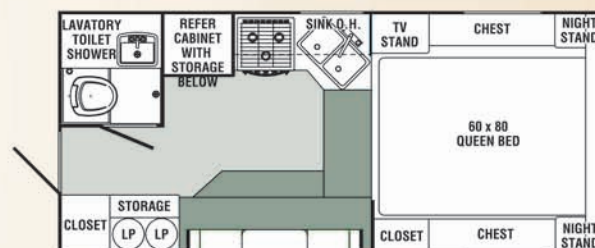

M-1000 SLLB

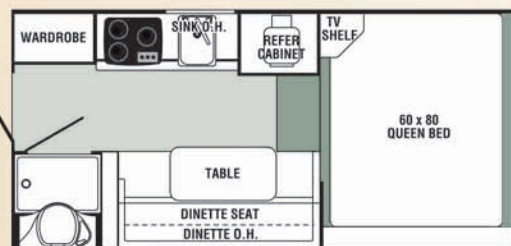

M-6601*

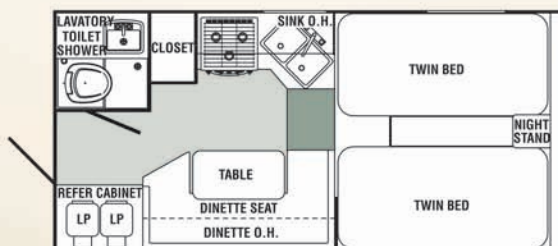

M-9901*

*Long-bed or short-bed models



WINTER CREEK

by Palomino

Enjoy the secluded beauty of the back roads in luxury. Winter Creek truck-mounted campers are designed for those who love adventure along with the good things in life. These beautiful units come in three spacious models, each completely furnished with an abundance of convenient features and extra amenities to give you quality, comfort, and pleasure.

Take the
back roads.



Model 115 RS



Fold-down counter space

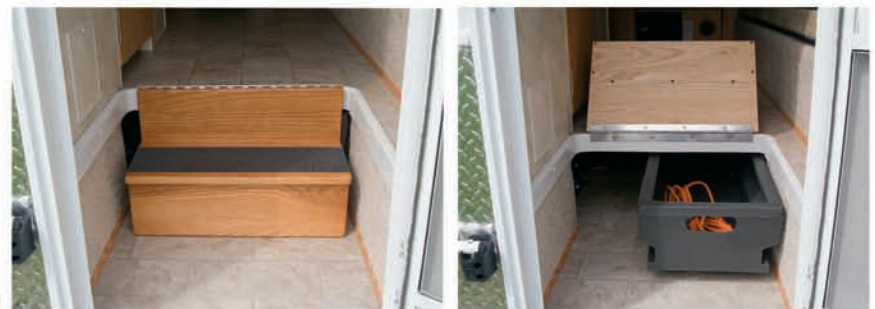

Flip-up steps with convenient storage space



Model 11 RD



Model 115 RS

WINTER CREEK STANDARDS & OPTIONS

STANDARDS

- 12 Volt Power Vent in Bath
- 19" LCD Flat Screen TV with Digital Surround Sound
- 20,000 BTU Furnace with Auto Ignition
- 6 Gal. Gas/Elec. DSI Water Heater
- Amplified TV Antenna
- Armstrong® Vinyl Floor Covering
- Bedspread
- Carbon Monoxide and LP Gas Detectors
- 55 AMP Converter with Charger
- Detachable 30 Ft. Power Cord - 30 AMP
- Dometic® 6 Cu. Ft. Refrigerator
- Dually Brackets
- Egress Vent/Cab Over
- Electric Jacks with Remote
- Entry Assist Handle
- EPDM Rubber Roof
- Ladder
- Laminated Smooth Fiberglass Exterior
- Lower Door Window
- Outside Shower
- Pillow Top Mattress
- Power Range Hood with Light and Fan

- Raised Refrigerator Panel
- Smoke Detector
- Stainless Steel Package
- Steel Floor Supports
- System Monitor Panel
- Three-Burner Range with Oven and Range Cover
- TV Cable Ready
- Vented Battery Box
- White Radius Dual Pane Safety Glass Windows

OPTIONS

- 2500 Watt LP Generator
- Air Conditioner (11,000 BTU)
- Backup Camera
- Camper Dolly
- Create-A-Breeze™ Fan (Mandatory Option)
- Microwave Oven
- Overhead Bunk Cabinet (N/A 115 RS)
- Rear Awning
- Side Awning
- Serta® Mattress Upgrade
- Solar Panel (5-Watt)

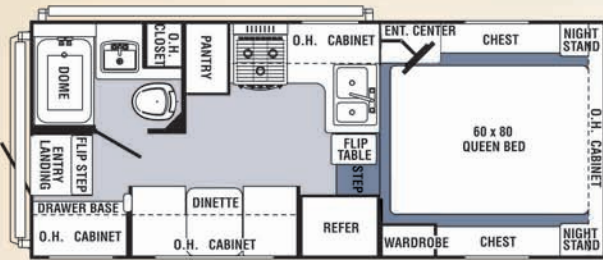

11-RD



11-FWSL

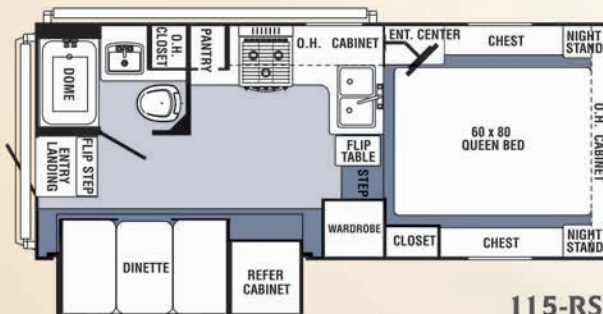
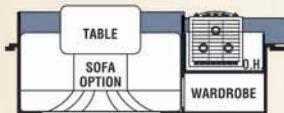

115-RS

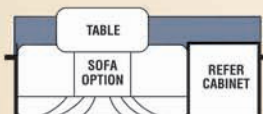

WINTER CREEK SPECIFICATIONS

	11-RD	11-FWSL	115-RS
Total Exterior Length	20'	20'	20'
Total Exterior Width	96"	96"	96"
Floor Length	11' 8"	11' 8"	11' 8"
Wheel Well Width	48"	48"	48"
Exterior Height with Ladder	9'	9'	9'
Interior Height	6' 7"	6' 7"	6' 7"
Dry Weight (lbs.)	3624	3762	3634
Fresh Water Capacity (Gals.)	40	40	40
Black Water Capacity (Gals.)	27	27	27
Gray Water Capacity (Gals.)	27	27	27
LP Gas Capacity	Two - 20 lbs.	Two - 20 lbs.	Two - 20 lbs.
Cab Over Bed Size	60 x 80	60 x 80	60 x 80
Dinette Bed Size	28 x 69	40 x 62	40 x 62



Green



Marble



'09 Palomino | Truck Camper Features and Options

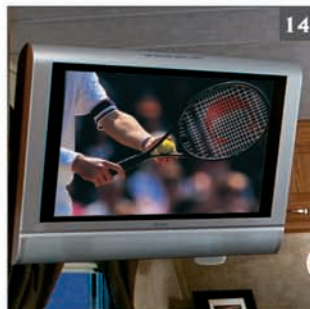

1. Optional 11,000 BTU air conditioner will keep you cool on hot days.
2. 16,000 BTU furnace takes the chill off cold nights. (20,000 BTUs on all Winter Creek models.)
3. Optional 10 bladed, 3 speed Create-A-Breeze™ Fantastic Vent keeps fresh air circulating.
4. The standard outside shower keeps any mess outside.
5. In-line water filter ensures your safety.

6. Push button slide-out control
7. Front rubber bumpers protect the front of the truck bed.
8. Optional Rieco Titan® electric jacks (2,000 lbs.) make set-up quick and easy.
9. AM/FM CD/DVD player with 5.1 Dolby® Digital Surround Sound
10. Digital AM/FM CD player
11. Four 2,000 lbs. manual ball screw jacks allow for easy leveling.
12. Sturdy ladder offers easy roof access.

13. Large size appliances enhance the function and efficiency of the kitchen (available stainless steel package).
14. Optional 19" LCD TV
15. Slide-out storage
16. Pass-thru storage conveniently accessible from inside or outside
17. Yamaha® 2400 Portable Generator (only available on Maverick models)
18. Battery storage
19. Optional LP generator

PALOMINO RV ENCOURAGES YOU TO BUY LOCALLY

Palomino RV strongly encourages our retail customers to purchase from their local dealership whenever possible due to the following factors:

- Our Dealers are, as a rule, independently owned and operated businesses. Outside of those customers they personally sold products to, they are not contractually obligated to perform warranty service on Palomino products that were purchased elsewhere. There may be an occasion that you would be required to return to the point of purchase to satisfy warranty requirements.
- Although many dealerships will eventually service products not purchased at their place of business, they will usually take care of their customers and other Palomino customers who are traveling away from their local dealer as they would their own.
- Local purchases allow a customer to establish a relationship with a dealer close to home. This relationship provides the customer with a convenient location for service and support from a "home town" professional.

- The opportunity for a thorough PDI (Pre-Delivery Inspection) and product orientation is an additional benefit of buying from your local dealer, further providing the opportunity for refresher courses or the ability to get questions answered much more conveniently.
- For our Canadian customers, there are also requirements which must be met to bring an RV purchased out of the country to their home. Although not insurmountable, these requirements may involve such things as additional inspections and certifications, taxes and fees. Your local Canadian Dealer is a professional at meeting these requirements.

Palomino RV's goal is for all RV Owners to fully enjoy their RV experience. In light of this goal, and considering the advantages of buying local, we encourage you to be thorough when determining what product to purchase and which dealer to purchase it from as both are key to your ultimate satisfaction and the realization of your dreams.



Palomino RV

1047 East M-86 • Colon, MI 49040

Phone: (269) 432-3271 • Fax: (269) 432-2516

www.palominorv.com

Palomino RV can not know the GVWR or features of your truck nor the purpose you have in mind for the use of your Truck Camper. Therefore, Palomino RV makes no warranties or representation, expressed or implied, as to the performance or reliability of your truck with a Palomino Truck Camper.

All illustrations and specifications contained in this literature are based on the latest product information at time of publication. Forest River reserves the right to make changes in prices, colors, materials, equipment and specifications at anytime, without notice, and assumes no responsibility for any error in this literature. All units are shipped F.O.B. point of manufacture.

LIFETIME LIMITED WARRANTY – Palomino RV offers a lifetime limited warranty to the original owner for: Lifter Systems, Bed Boards, and Floor Board.

TENT WARRANTY – Palomino RV warrants its vinyl tents to be free from defect in materials and workmanship for 5 years, under normal use and service, to the original owner.

LIMITED ROOF WARRANTY – Palomino RV warrants the Palomino Roof Assembly to be free from substantial defects in materials and workmanship for a period of 5 years, excluding any modification or alterations. There are certain other exclusions to this limited warranty, details of which are included in the actual printed warranty statement. Ask your dealer to let you inspect it.

Discover a new world.



Free Emergency Roadside Assistance Service
Administered by Coach-Net®.
Ask your dealer for more information.

Dealer