

# SABRE *Silhouette*



BY PALOMINO



ON THE PROWL.



VOL. V

Fifth Wheels & Travel Trailers | By Palomino

[www.palominorv.com](http://www.palominorv.com)

SABRE  
*Silhouette*

# *Interior*

Model 290REDS  
shown with Coffee Decor

## DISCOVER THE BEST

Your search for RV comfort ends here! The Silhouette by Sabre has all you need plus lots of extra features you desire. Open floor plan designs create roomy interiors that include flush floor slide rooms for expanded living space.

Attractive stylish decors, quality residential furnishings, and convenient built-in features come together in a truly innovative fifth wheel.





Shown with optional air mattress hide-a-bed and free-standing dinette.



# DECOR OPTIONS



Spice



Basil



Coffee



Caramel



Autumn Harvest

## Travel Trailer Floorplans

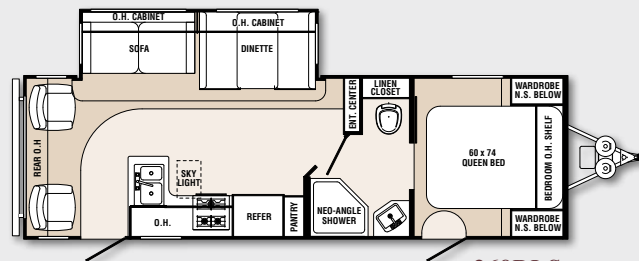

260RLS

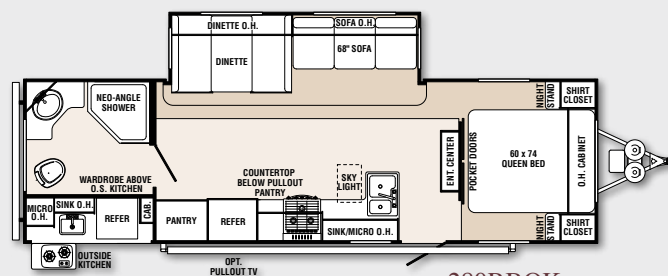

280RBOK

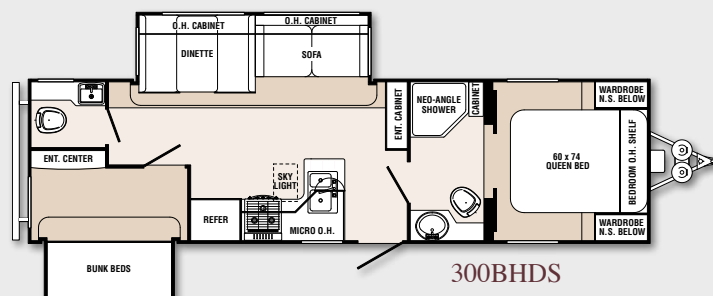

300BHDS

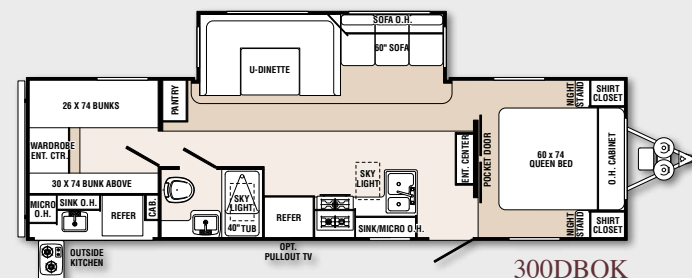

300DBOK

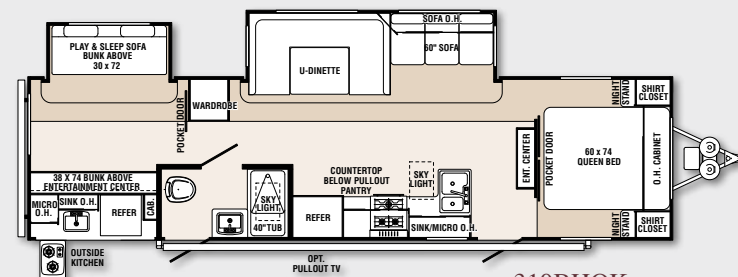

310BHOK

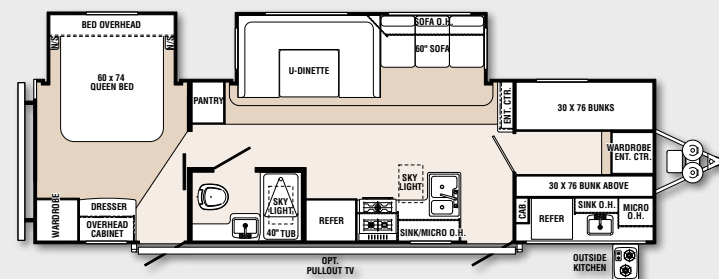

310TBOK

## Travel Trailer Specs

MODEL	260RLS	280RBOK	300BHDS	300DBOK	310BHOK	310TBOK
Hitch Weight	908	TBD	935	830	876	1,231
Axle Weight	6,012	TBD	6,848	6,445	7,009	6,552
Dry Ship Weight	6,920	TBD	7,783	7,275	7,885	7,783
GVWR	11,068	TBD	11,095	10,990	11,036	11,391
CCC (Cargo Cap.)	4,098	TBD	2,828	3,665	3,101	3,558
Ext. Length	30'-8"	32'-2"	34'-6"	33'-8"	35'-4"	34'-3"
Fresh Water Cap. (gal.)	42	42	42	42	42	42
Black Water Cap. (gal.)	42	42	42	42	42	42
½ Bath— Grey Water/Black Water Waste (gal.)	—	—	42	42*	42*	42*
Grey Water Cap. (gal.)	84	84	84	84	84	84
Tire Size (in.)	15"	15"	15"	15"	15"	15"
Awning Size (ft.)	21'	19'	16'	19'	21'	19'

\*Outside Kitchen Grey Water Tank

## HARDWOOD CABINETS

### 3 YEAR LIMITED WARRANTY

Standard on all hardwood cabinet doors



Your Sabre Silhouette comes with residential Shaw® nylon carpet with R2X® — the industry's most innovative carpet stain and soil repelling system.



# Fifth Wheels

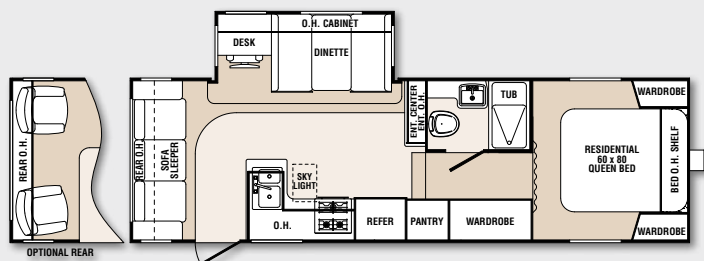

250RLBD

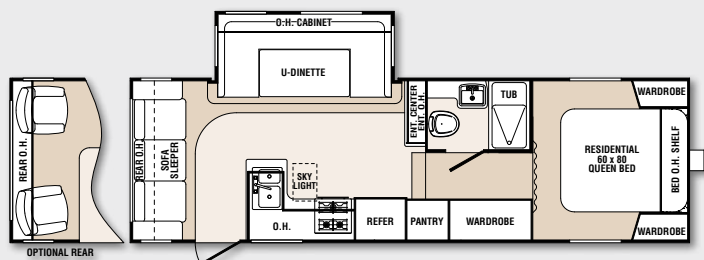

250RLUD

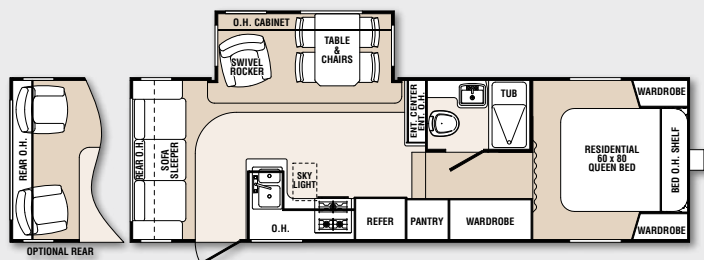

250RLFD

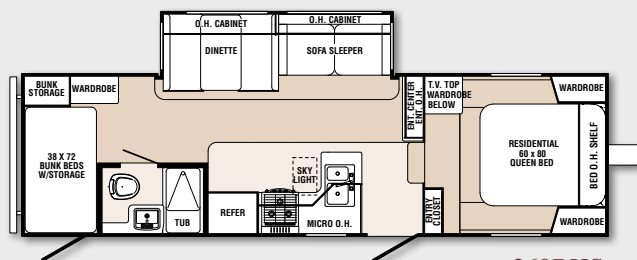

260BHS

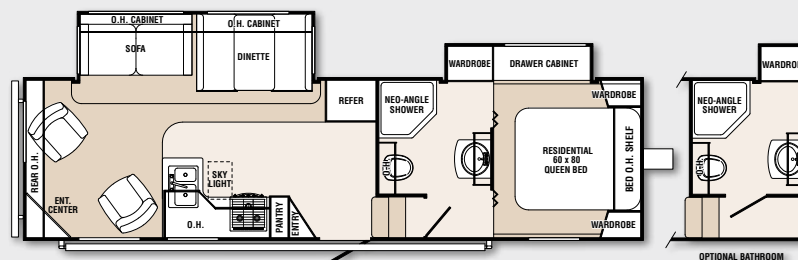

290REDS

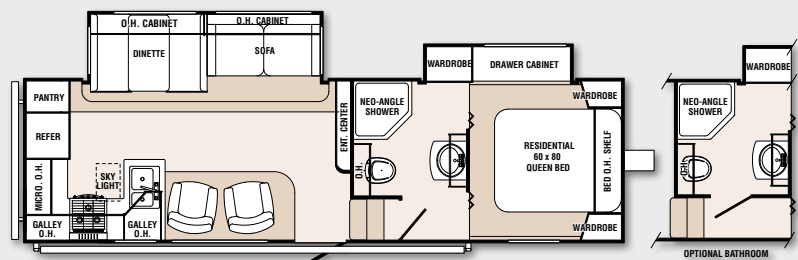

290RKDS

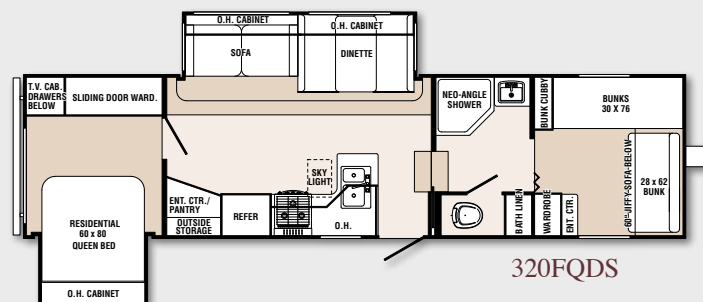

320FQDS

## Fifth Wheels

MODEL	250RLBD	250RLUD	250RLFD	260BHS	290REDS	290RKDS	320FQDS
Hitch Weight	1,143	1,151	1,140	1,361	1,631	1,694	1,550
Axle Weight	6,125	6,050	5,971	6,355	6,645	6,302	7,179
Dry Ship Weight	7,268	7,201	7,111	7,716	8,276	7,996	8,729
GVWR	11,303	11,311	11,300	11,521	11,791	11,854	11,710
CCC (Cargo Cap.)	3,585	3,660	3,739	3,321	3,031	3,808	2,931
Ext. Length	29'-0"	29'-0"	29'-0"	31'-6"	32'-9"	31'-7"	34'-5"
Fresh Water Cap. (gal.)	42	42	42	42	42	42	42
Black Water Cap. (gal.)	42	42	42	42	42	42	42
½ Bath— Grey Water/Black Water Waste (gal.)	—	—	—	—	—	—	—
Grey Water Cap. (gal.)	84	84	84	84	84	84	84
Tire Size (in.)	15"	15"	15"	15"	15"	15"	15"
Awning Size (ft.)	17'	17'	17'	17'	21'	19'	17'

# SABRE SILHOUETTE COMPETITIVE ADVANTAGES

## INTERIOR



## EXTERIOR



1. Optional free standing dinette with leaf extension and flip-up storage
2. 22" oven
3. Cell phone charging/organizer station
4. Optional air mattress hide-a-bed sofa with linen drawer
5. 32" HD LCD TV

6. Queen bed with machine washable quilted bedspread
7. Self-edged countertops with under-mounted American Stonecast galley sink that withstands up to 450 degrees
8. CD/DVD/AM/FM player with surround sound and includes USB port

9. Residential full extension drawer guides
10. 6 Cubic foot refrigerator with residential wood front
11. LP quick disconnect
12. PlatTform™ slide-out floors are moisture resistant
13. Axles with Super Lube® bearings

14. Radial tires, chrome wheel trim rings with stainless steel hub covers
15. Detachable 30 amp cord for easy storage
16. Pass thru storage with docking station (FW)
17. "Within Reach" water heater bypass valve

# FEATURES

**S** = Standard | **O** = Option | **SF1** = Silhouette Feature Package 1 (Mandatory) | **SF2** = Sabre Feature Package 2 (Mandatory)  
**SC** = Sabre Cage Construction (Mandatory) | **FW** = Fifth Wheel | **TT** = Travel Trailers

<b>KITCHEN</b>	Large 6 cubic foot Dometic® refrigerator	S
	Raised hardwood front refrigerator panels	SF1
	Residential-style, self-edged countertop	S
	Residential American Stonecast sink, under-mount: withstands 450 degrees	S
	Pull-out faucet with sprayer	S
	Food grade sink cover & cutting board	S
	Full extension drawers	S
	Ball bearing roller guides	S
	Magic Chef® microwave	S
	22" Oven	S
	Installed conveniences: knife holder and silverware drawer	S
	Residential size trash can location	S
	Residential size pantry (most floorplans)	S
	110v outlets mounted in dinette and sofa area for convenience	S
	Free standing dinette with leaf extension and flip-up storage (chairs include seat storage)	O

<b>BATHROOM</b>	12v ceiling vent & fan	S
	Sky dome over shower	S
	Waterproof shower light	S
	Residential-style, wood medicine cabinet	S
	Porcelain toilet with foot flush and "power flush jets"	S
	Installed conveniences: towel ring, soap dish and toothbrush holder	S
	Air conditioning vent in ALL bathrooms	S

<b>BEDROOM</b>	Machine washable quilted bedspread with (2) pillow shams	S
	Prewired for bedroom TV	S
	60"x 80" queen innerspring mattress (FW)	S
	Dual reading lights over bed	S
	Large opposing windows for cross ventilation	S
	Storage under all beds	S

<b>AUDIO &amp; VIDEO</b>	32" HD LCD TV, living room	SF1
	CD/DVD/AM/FM player (12v for dry camping)	SF2
	Stereo inputs include: 3.5 mm audio, SD card and USB	SF2
	Surround sound speaker system	SF2
	(2) Marine grade exterior patio speakers	SF2
	Digital TV antenna with amplifier booster	S
	RG-6 satellite prep	S
	Satellite and cable hook-up	S
	Exterior mounted radio antenna for improved reception	S
	Slide-out patio LCD TV (FW, select floorplans)	O

<b>INTERIOR</b>	Top cabinet doors: solid hardwood, mortise and tenon with arched <b>raised panels</b>	SF2
	Lower cabinet doors: solid hardwood, mortise and tenon with square <b>raised panels</b>	SF2
	All cabinet doors utilize Teflon spacers to prevent warping, bending and cracking	S
	Cabinet face frames are screwed and not stapled together	S
	6'1" slide-out room height	S
	Residential Armstrong® linoleum	S

	Residential Shaw® nylon carpet with R2X™	S
	Carpet pad	S
	Residential ball bearing drawer guides	S
	Flush floor slide rooms in living area	S
	Pleated night shades throughout	S
	Cell phone charging/organizer station	S
	Swivel rocker chair(s) (per floorplan)	S
	Euro style chair with ottoman IPO swivel rocker chair	O
	Beauflor® linoleum, plank wood pattern	O
	Air mattress hide-a-bed sofa with linen drawer	O

<b>EXTERIOR</b>	6-sided welded aluminum structure; sidewalls, rear wall, front wall, floor, roof, slide-outs	SC
	3/8" thick walk on roof decking	SC
	Fold away entry door handle	SF2
	Deep tint safety glass windows	SF1
	Heated and enclosed underbelly	S
	Aerodynamic fiberglass front cap/fifth wheel docking lights	S
	Attic vents for roof ventilation	S
	Quick release snap jack pins mounted forward	S
	A&E electric awning with adjustable arms	S
	(2) Patio safety lights	S
	Safety step light at main entrance	S
	Nitrous filled steel belted radial tires with roadside assistance	S
	Axles with Super Lube® bearing system	S
	Electric powered front jacks (FW)	S
	30" entry door (most floorplans)	S

	Switchable interior light at each luggage door	S
	Outside LP gas hook up with quick connect	S
	Crank down stabilizer jacks	S
	Flexible 4" rain spouts	S
	Rear roof ladder	O
	15" HiSpec aluminum wheels with ICF: improved clamp force technology	O

<b>UTILITIES</b>	35,000 BTU furnace with automatic ignition	SF1
	6 gal. DSI gas/electric water heater with quick recovery	SF1
	Hot & cold water exterior shower	SF1
	13,500 BTU air conditioner with Quick Cool dump	SF1
	"Within Reach" water heater bypass valve	S
	Independent electric slide-outs	S
	Dual 30 lb. LP bottles	S
	Convenience center for hook-ups (FW)	S
	High capacity in-floor heat ducting	S
	Digital thermostat	S
	65 amp power converter with smart fan cooling & LED "bad fuse" indicator	S
	30 amp service with detachable marine power cord	S
	Central command center with tank monitor enclosed in cabinet (most floorplans)	S
	Black tank flush	S
	15,000 BTU air conditioner with Quick Cool	O

*All specifications contained in this literature are based on the latest product information at time of publication. Forest River Inc. reserves the right to make changes at anytime without notice and assumes no responsibility for any error in this literature.*

# Sabre Silhouette TRUE SIX-SIDED ALUMINUM CAGE



1. Aluminum welded rafters
2. Aluminum welded floor
3. Aluminum welded front frame
4. Aluminum welded rear frame
5. Aluminum welded door-side frame
6. Aluminum welded off door-side frame

## PEACE OF MIND



### Emergency Roadside Assistance

Forest River Roadside Assistance Card provides free jump starts, tire changes, fuel delivery and lock-out service.



## PRE-DELIVERY INSPECTION FACILITY

20,000 square feet of quality assurance.  
The bare essentials for a premium product.

## Palomino RV Encourages You to Buy Locally

Palomino RV strongly encourages our retail customers to purchase from their local dealership whenever possible due to the following factors:

Our Dealers are, as a rule, independently owned and operated businesses. Outside of those customers they personally sold products to, they are not contractually obligated to perform warranty service on Palomino products that were purchased elsewhere. There may be an occasion that you would be required to return to the point of purchase to satisfy warranty requirements.

Although many dealerships will eventually service products not purchased at their place of business, they will usually take care of their customers and other Palomino customers who are traveling away from their local dealer as they would their own.

Local purchases allow a customer to establish a relationship with a dealer close to home. This relationship provides the customer with a convenient location for service and support from a "home town" professional.

The opportunity for a thorough PDI (Pre-Delivery Inspection) and product orientation is an additional benefit of buying from your local dealer, further providing the opportunity for refresher courses or the ability to get questions answered much more conveniently.

For our Canadian customers, there are also requirements which must be met to bring an RV purchased out of the country to their home. Although not insurmountable, these requirements may involve such things as additional inspections and certifications, taxes and fees. Your local Canadian Dealer is a professional at meeting these requirements.

Palomino RV's goal is for all RV Owners to fully enjoy their RV experience. In light of this goal, and considering the advantages of buying local, we encourage you to be thorough when determining what product to purchase and which dealer to purchase it from as both are key to your ultimate satisfaction and the realization of your dreams.

## YOUR SABRE SILHOUETTE DEALER:



Scan this barcode  
using a QR Reader  
on your smart phone  
to learn more about  
Forest River.

## Sabre Silhouette by Palomino

Forest River Inc.  
2412 Century Drive, Goshen, IN 46528  
Phone: 269-432-3271  
[www.palominorv.com](http://www.palominorv.com)

All illustrations and specifications contained in this literature are based on the latest product information at time of publication. Forest River, Inc. reserves the right to make changes in prices, colors, materials, equipment and specifications at anytime without notice and assumes no responsibility for any error in this literature. All weights shown are approximate. All units are shipped F.O.B. Goshen, Indiana. CONSULT YOUR LOCAL DEALER FOR WARRANTY INFORMATION.