

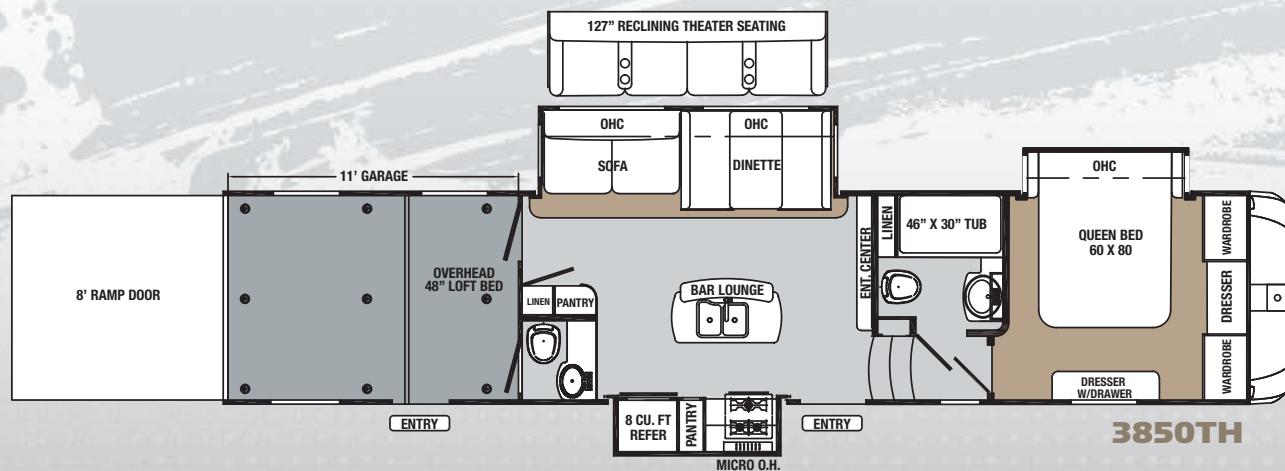

FIFTH WHEEL TOY HAULERS

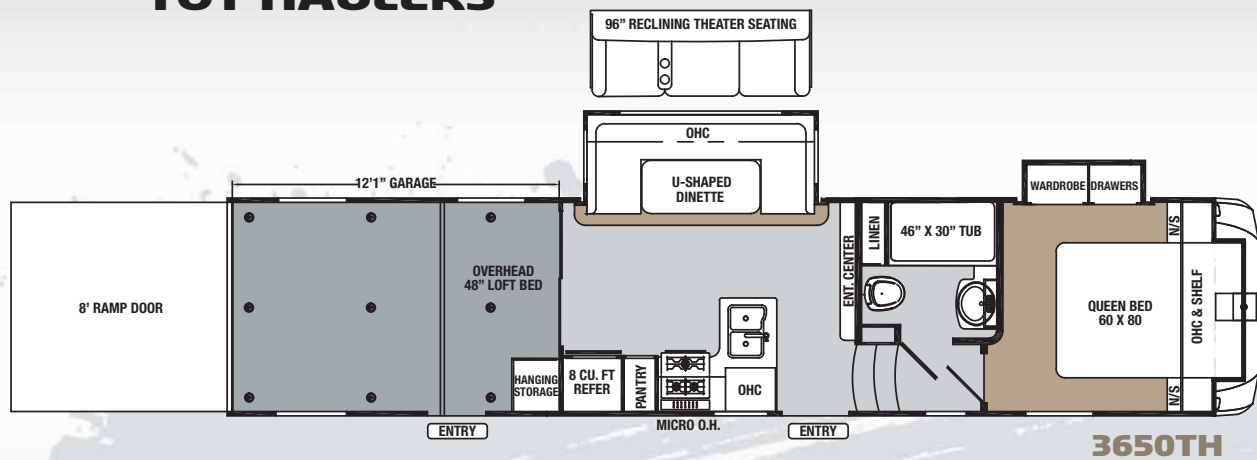

SPECIFICATIONS

	3650	3850
HITCH WEIGHT	2,650	TBD
AXLE WEIGHT	8,163	TBD
DRY SHIP WEIGHT	10,813	TBD
GVWR	14,900	TBD
CARGO CAPACITY	4,037	TBD
EXTERIOR LENGTH	38' 4"	40' 9"
FRESH WATER (gal.)	100	100
BLACK WATER (gal.)	42	TBD
GREY WATER (gal.)	84	TBD
TIRE SIZE (in)	16	16
AWNING SIZE	21' LIT	TBD



DECOR Select your favorite from two designer fabrics.



COCOA



BEECHWOOD

TOY HAULER STANDARD FEATURES AND OPTIONS

INTERIOR

8 Cu. Ft. Refrigerator
6-Gal. Gas/Electric DSI Water Heater with Quick Recovery
Residential Microwave
3-Burner Range with 22 inch Oven
Large 60/40 Under Mount Stonecast Kitchen Sink
High Rise Faucet
Solid Surface Counter Tops
Ash Mortise and Tenon Hardwood Cabinetry
100# Full Extension Ball Bearing Drawer Guides
Night Shades
Power Vent in the Master Bathroom
Porcelain Foot Flush Toilet
Bedroom TV Hook-Up
Fiberglass Shower
Skylight in Shower
Residential Interior Door with Glass Insert (Select models)
Cable/Sat. Prep
TV Antenna with Booster
Braced and Wired for Second A/C
50 AMP Automatic Transfer Switch with Generator Prep
Ducted A/C into Garage
1/4" x 8" Frame Integrated Tie Down Reinforcement
Cargo Plates
Beauflor-Plankwood Flooring

EXTERIOR

Convenience Center
(All System Hook-Ups Located In One Area)
High Pressure Spray Port
Black Tank Flush
Exterior Cable / Sat Hook Up
Rear Spotlights
Outdoor LED Activity Light
One Touch Electric Awning
Easy Glide Radius Steps
Large Tinted Safety Glass Windows with 80% Tint
Pass-through Storage
Collapsible Aluminum Roof Ladder
Rain Gutters with Extended Drip Spouts
"RAM" Air Ventilation System in Garage
Fiberglass Front Cap
Spare Tire
7,000 Lbs. Ultra Lube Axles
Heated and Enclosed Underbelly
Double Welded Aluminum Construction
Rack in Pinion Slide Rooms
5" Pre-Engineered Truss Roof Rafters
Battery Quick Disconnect
50 Amp Service
15,000 BTU Air Conditioner
Premium 8 Lug 16" "E" Rated Radial Tires with Aluminum Rims
One Piece Roof (12 year warranty)

Filon Exterior Sidewalls
Fully Walkable Roof
Electric Front and Rear Jacks
10" - 12" I-Beams (Select models)
Large Entry Assist Grab Handle
8' Tall Ramp Door
6'6" Interior Slide Height
Backup Camera Ready

ENTERTAINMENT SYSTEM

40" LED HDTV
Jensen Theater Wall Mount Stereo with HDMI and Blue Tooth
8-Interior Speakers with Amplified Sub Woofer
2-Exterior Marine Speakers

SAFETY PACKAGE

Carbon Monoxide Detector
Smoke Detector
LP Gas Detector
(2) Fire Extinguisher

EXTERIOR OPTIONS

2nd A/C 13.5 Master Bedroom
Low Profile 2nd A/C 13.5 Master Bedroom
10 Gal. Gas/110V/DSI Water Heater IPO 6 Gallon
6-Point Auto Leveling, Electric Ground Control
Trail Air Rota Flex Rubberized Pin Box
JT's Strong Arm Jack Stabilizers (Front Jacks Only)
Frameless Windows

Dual Pane Windows (Non-Frameless)
(2) Slide Toppers
(3) Slide Toppers
Zip Screen In Cargo Area
Hide-A-Screen In Cargo Area
Rear Patio Deck
Onan 5.5 KW Generator with 30 Gal. Fuel Station
30 Gal. Fuel Pump Station

INTERIOR OPTIONS

LG Solid Surface Galley Extension
Stainless Steel Appliance Package (Range Hood, Oven Front, Refer Front, Micro)
6-Panel Refer Door Inserts
20 Cu Ft. Residential Refer W/Inverter
Electric Fireplace
98" Reclining Theater Sofa IPO U-Dinette (3650)
127" Reclining Theater Sofa IPO Dinette and Sofa (3850)
Serta Mattress Upgrade 60"x 80"
Eureka Central Vacuum
24" LED Bedroom TV
Happi Jac Rollover Sofas with Electric Queen Bed Above
Single Queen Electric Bed
Double Queen Electric Bed

MISC

Z240 Canadian Standards



Revelation by Palomino ■ Forest River, Inc.
2412 Century Drive ■ Goshen, IN 46528
(269) 432-3271 ■ www.palominorv.com



All illustrations and specifications contained in this literature are based on the latest product information at the time of publication. Forest River, Inc. reserves the right to make changes in prices, colors, materials, equipment and specifications at anytime, without notice, and assumes no responsibility for any error in this literature. All weights shown are approximate. All units are shipped F.O.B. point of manufacture. ©2014 Revelation by Palomino, a Division of Forest River, Inc., a Berkshire Hathaway company. All Rights Reserved 12/14

YOUR REVELATION DEALER