



SAHARA04

Adventures as colorful as the people you meet.





The call of the wilderness.

You hear it. Maybe it started from far away at first, but now it's getting louder, more persistent. It's the voice that's nudging you toward new experiences — daring you to rekindle your spirit of adventure — telling you that now's the time to live the life you've always dreamed about. And for all who hear it, Safari has a motorcoach just for you.

You see, the passion for adventure is at the heart of every coach we build. You feel it in the powerful performance of our big Cummins® engine and exclusive Roadmaster chassis. You find it in dozens of high-tech features and innovations. And you experience it in the unmatched livability of our plush, stylish interiors. Yes, these are just some of the things that make adventures in a Safari so alluring. And once you've heard the call, you'll know it's time to take a closer look.

Welcome to the 2004 Sahara by Safari.



The Safari Pride



There's more to owning a Safari motorcoach than just driving. There's also the fun and camaraderie that comes from sharing your adventures with other Safari owners. Because, like you, they know life is to enjoy. And best of all, no matter where you go, you're part of the Safari family. So, sit back and let the good times roll.





Sahara 40PBT shown in African Sunset.



**You're not
afraid to bend our ear.
We're not afraid
to listen.**

The 2004 Sahara is a product of years of listening to our owners, taking their suggestions, and understanding the things that contribute to a superior motorhome experience. This year, we've given the Sahara's exterior a sleek new look with full body paint. The coach now features smooth gel coat fiberglass sidewalls and fiberglass fender skirts, as well as polished aluminum wheels.



The completely redesigned front cap features contemporary headlamps and fog lights, as well as a new windshield. In short, it's a new look for a new year — all to help you take on the road in style.



New docking lights add convenience, safety and gracious styling to the exterior of the coach.

Loading and unloading is easier than ever, thanks to these new baggage doors with single-handle latches.

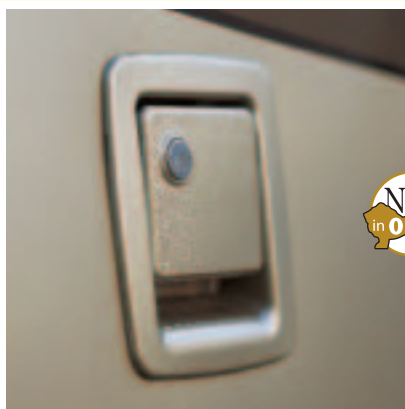



At the helm of a Sahara, you're the captain of every adventure. This year, we've redesigned the driver's side console and dash to feature an attractive burl instrumentation panel, tan gauges with black lettering, and gun metal bezels. All the controls are ergonomically situated within easy reach, and some of the advanced features include a color rear vision system with audio, a dash stereo with optional Sirius radio system, optional power sunvisors, and an optional 10-disc CD changer. Plus, drivers of all sizes will be comfortable behind the wheel, thanks to our adjustable brake and accelerator pedals.

- It's easy to find the switch you need, because they're all conveniently grouped to the left of the steering wheel.
- The air dump switch aids in leveling and helps you get the coach closer to the ground for easier entry and exit.
- The Sahara features ICC flasher lights, located topside.
- Heated side mirrors offer full visibility in all weather conditions.
- The rear color vision system gives you sight and sound at the rear of the coach for added safety and security.
- Stopping to enjoy the scenery is never a problem with Safari's automatic power gear, a 3-point hydraulic leveling system that keeps your coach level, no matter what the terrain.



For your convenience, the gauges and switches are both easy to see and easy to reach.



From coast to coast, Safari coaches are recognized by our distinctive optional wildlife murals. Each mural is hand-painted by Dame family craftsmen, and you have your choice of hundreds of designs. Or if you prefer, custom designs are also available.



The beautiful burl wood adds a touch of luxury to the instrumentation panel on the dash.



It's all about you.
COME ON IN.





Look toward the front of the coach, and you'll see the best seats in the house. The Sahara features vinyl cockpit seats with six-way power controls on the pilot's side. You also have the option of plush, durable Ultraleather™, shown here on the optional Euro recliner, as well as an optional extra-wide six-way power co-pilot seat with footrest (not available on side entry models). Overhead, you'll find the large 25" color TV with remote control, as well as a digital satellite system prep and cable TV jacks. For enhanced audio, the TV's sound is wired through the ceiling speakers. And in the galley, the solid surface countertop is both stylish and easy to clean.



Sahara 40PBT shown in African Sunset with Alder cabinetry.

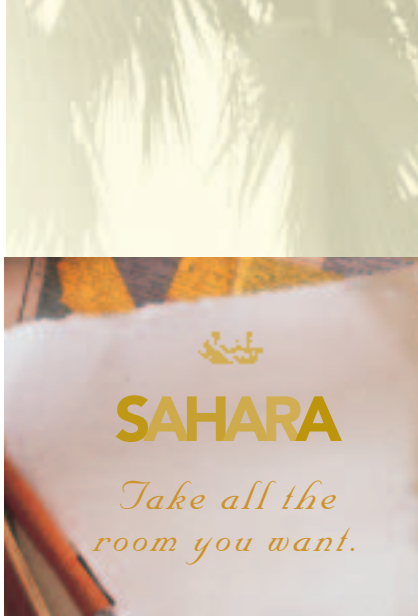

SAHARA

*Take all the
room you want.*

You can conveniently check and adjust the coach's systems, including slide-outs, climate controls and tank monitoring gauges, right here in this Systems Control Center.



To help you keep the coach tidy, we've added this new wooden clothes hamper (N/A on 40PBT).



A visual delight.

You've just entered a whole new world of creature comforts. Where form and function combine to give you a feast for the senses. And numerous optional features let you customize your coach to suit you perfectly. This year, you have your choice of four beautiful interior color schemes, each with exquisite color-coordinated fabrics, carpeting and window treatments. The cabinetry comes standard in alder finish, with optional regal cherry or natural maple finishes. And no matter which style you choose, you have the added option of having your cabinetry crafted completely from solid hardwood. In addition, the living room and bedroom slide-outs now feature attractive hardwood fascia with cane inserts, which coordinate beautifully with the cabinet design. For your dining pleasure and convenience, the Sahara offers this ingenious legless dinette table with two freestanding chairs. Or, you have the option of a cozy booth dinette.





Sahara 40DST shown in Tucan Blue with Natural Maple cabinetry and an optional Ultraleather™ recliner.



Sahara 40PBT shown with Alder cabinetry.



Step inside the galley, and you'll find everything you need to create a family feast or simply a midnight snack. This year, beautiful ceramic tile flooring graces both the kitchen and bath, and the solid surface countertops and sinks give the coach a sleek, contemporary look. The top-notch appliances include a double-door refrigerator with ice maker, a high-output three-burner cooktop, and a spacesaver convection microwave with touch control. You may also choose the expanded capacity of the optional large four-door refrigerator, as well as the unbeatable versatility of the optional three-burner range with oven.



The kitchen is made even more attractive by the fashionable detailing of the hardware and color-coordinated counter trim.

The stylish and comfortable bedroom features a wood top dresser, decorative wall lights and beautifully coordinated bedspread and pillows. A queen-size bed is standard, with a king-size optional. And for added convenience, the built-in 19" stereo color TV swings out for easy positioning. For extra comfort, you'll also enjoy padded nylon carpeting and pleated day/night shades with blackouts. You'll have plenty of storage space, too, and the bedroom desk offers a convenient place to jot notes or work on your computer.



Sahara 40PBT shown in Palm Island with Alder cabinetry.

SAHARA04





AFRICAN SUNSET



ELEPHANT WALK



PALM ISLAND



TUCAN BLUE

NATURAL
MAPLE

ALDER

REGAL
CHERRY

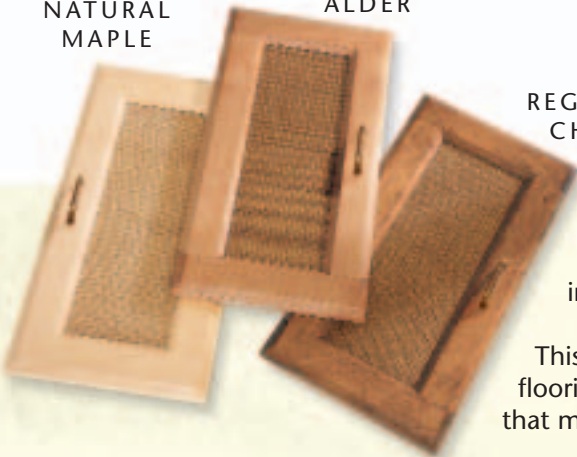

The Sahara's hardwood cabinet doors feature designer-inspired decorative cane inserts and stylish new brass finished hardware.



This year, you also have the option of plank flooring in the kitchen and bathroom, in a style that matches your choice of cabinetry.



Showing our colors.

Our designers have created exquisite color combinations for your 2004 Sahara. Now, you get to choose the one that's right for you.



AFRICAN SUNSET



ELEPHANT WALK



PALM ISLAND



TUCAN BLUE



BETTER
STAIN
PROTECTION

Manufactured in, not added on. 3M Scotchgard™ Carpet Stain Release is applied during the carpet manufacturing process for a higher level of protection. Dupont Teflon® soil repellent is applied to virtually all upholstery fabric during the finishing process for superior coverage.*

*Brand and application of carpet or upholstery fabric protection may vary depending on date recreational vehicle was manufactured.

A whole new level of comfort.

This year, the coach features a new suspension system, designed especially for Safari. IPD sway bars in the front and rear help control body roll, while customized KONI adjustable shock absorbers may be fine-tuned to produce a damping action that's most comfortable for you.



The SmartStructure steel truss system is engineered as part of the chassis, creating a strong foundation for your coach and providing large pass-through storage compartments. To ensure its longevity, the entire structure is pre-primed and coated with a rust inhibiting paint.



RR4R-Series Chassis

Roadmaster Chassis

For superior front-to-rear balance and overall performance, you can't beat the Roadmaster RR4R. Roadmaster chassis are customized to the exact specifications of each Safari coach model and include many distinguishing features that make them the right chassis for your luxury motorhome.

- Cushion Air Glide suspension provides a smoother ride with excellent handling and cornering.
- The Sahara's rear-mounted aluminum radiator, charged-air cooler and external transmission cooler significantly increase cooling capacity.
- The SmartStructure basement truss system, combined with the raised rail chassis, provides greater strength and structural integrity while reducing weight and increasing storage capacity.

- A larger, 34" spacing between the frame rails offers greater side-to-side stability. The rails also widen in the rear of the coach to accommodate engine access.
- The full air brakes with Automatic Traction Control (ATC) eliminate wheel spin during acceleration, and the anti-lock braking system (ABS) maintains traction and steering when braking on slick surfaces.
- A PAC exhaust brake system allows the driver to use engine exhaust braking on long downhills, saving brake wear and enhancing safety.
- Dual fuel fills provide the convenience of filling the fuel tank from either side of the coach.
- A 10,000-lb. hitch receiver gives the coach powerful towing capacity.

The strength of Alumaframe®

Thanks to our Alumaframe® Superstructure, your Safari coach is built to take on anything the road can dish out. We revolutionized the industry by replacing outdated wood and tubular aluminum construction with our exclusive system of aluminum C-Channel crossmembers. These run the full length of the coach, with double-welded intersections for superior strength. This makes your Safari lighter and sturdier than other coaches and gives you reliability you can count on down the road.

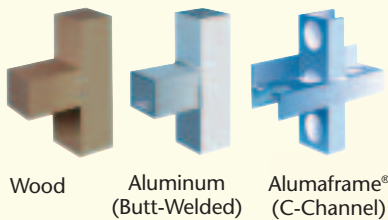

5-Layer Floor:

- A 5/8" Structurwood™
- B 1-1/2" steel tube
- C Blue foam
- D Luaun
- E Darco

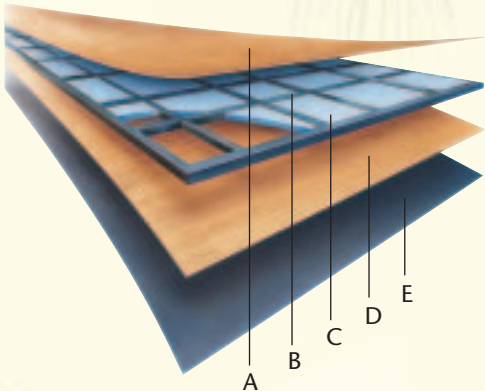

5-Layer Exterior Wall:

- A High-gloss gel coat fiberglass
- B Interlocking C-Channel filled with 1-1/2" fiberglass insulation bonded in place so it doesn't sag or leave spaces uninsulated
- C Vapor barrier
- D Bead foam adds comfort, saves energy and provides a thermal insulative barrier
- E Interior paneling



9-Layer Roof Construction:

- A Peaked aluminum roof
- B Luaun backing
- C Thick, tapered bead foam insulation
- D Aluminum double I-beam superstructure filled with fiberglass insulation
- E Vapor barrier
- F Structure foam: thermal insulative barrier
- G 1/2" bead foam insulation
- H Foam padding for extra insulation
- I Padded vinyl ceiling

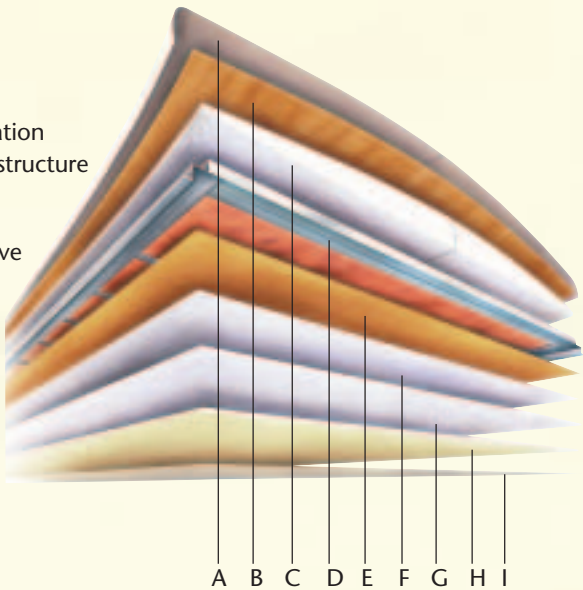

Even the toughest mountain climbs are a breeze, thanks to the Sahara's gutsy Cummins® ISC 350 HP diesel engine and Allison® 3000 MH 6-speed electronic transmission.



The perfect finish.

Safari coaches are painted in our own state-of-the-art facility using a multi-step paint process to help lengthen the life of your motorhome's exterior. The process includes sanding, application of sealer and base coat, hand-applied graphics, spray painting, and three applications of clear coat.

Convenience in all the right places.



1. The exterior appeal of your motorcoach is enhanced by the sleek design of the headlights.



2. Getting rid of road debris is no problem with our polished aluminum wheels. They're lightweight and easy to clean, and more chip resistant.



3. Every square inch of the coach is put to good use, including this handy entry step storage, perfect for muddy shoes, flashlights, first-aid kits, etc. In addition, our power step well covers, on both side-entry and front-entry floorplans, increase the overall floor space of the coach.



4. For easier hook-ups, the coach features this optional power water hose/power cord reel. And this year, we've also added sewer hose storage.



5. The powerful Onan® 6.5 kW generator (or optional 7.5 kW QD diesel generator) is easily serviced thanks to this manual slide-out tray, located in the front of the coach.

On the front of the coach you'll find power controlled heated mirrors and an optional 3M® film front mask.

**This is the face of a coach that's built
to take on any adventure.**

Weight Rating (Lbs.)	36PDD	38PDQ	40SMD	40DST	40PBT	40SRT
Gross Vehicle	32,000	32,000	32,000	32,000	32,000	32,000
Gross Combined	42,000	42,000	42,000	42,000	42,000	42,000
Gross Axle (Front)	12,000	12,000	12,000	12,000	12,000	12,000
Gross Axle (Rear)	20,000	20,000	20,000	20,000	20,000	20,000
Measurements						
Wheelbase	228"	252"	270"	270"	270"	270"
Overall Length	36' 11"	38' 11"	40' 5"	40' 5"	40' 5"	40' 5"
Height (with A/C)	12' 2"	12' 2"	12' 2"	12' 2"	12' 2"	12' 2"
Interior Height	78"	78"	78"	78"	78"	78"
Interior Width	94.5"	94.5"	94.5"	94.5"	94.5"	94.5"
Exterior Width	100.5"	100.5"	100.5"	100.5"	100.5"	100.5"
Tank Capacities* (Gal.)						
Water Heater	10	10	10	10	10	10
Gray Tank	55	55	55	55	55	55
Black Tank	39	39	39	39	39	39
Fresh Tank	95	95	95	95	95	95
LP Tank**	38	38	38	38	38	38
Fuel Tank	90	90	90	90	90	90

* All tank capacities are estimated based upon calculations provided by the tank manufacturers and represent approximate capacities. The actual "usable capacity" may be greater or less than the estimated capacities based upon fabrication and installation of the tanks.

** Actual filled LP capacity is 80% of listing due to safety shut-off required on tank.

Due to the large variety of options and floorplan arrangements available to our customers, actual weights for each unit can differ significantly. Safari provides a weight sticker on each unit we produce which includes that unit's tank capacities and approximate weight. Consult your local Safari dealer for unit availability and further information. The information printed in this brochure reflects product design, fabrication, and component parts at the date of printing. The manufacturer reserves the right, at any time, to make changes in product design or material or component specifications as its sole option, without notice. This includes the substitution of components of a different brand or trade name, which will result in comparable performance. All information printed in this brochure is subject to change after the date of printing. Some features shown or mentioned in this brochure are optional and may only be available in selected floorplans. Photographs may show props or decorations that are not standard equipment on Safari models. Safari, the Safari logo and its design, are registered trademarks. All other products and company names are trademarks and/or registered trademarks of their respective holders.

While the color of the motorhome's exterior and the interior fabrics depicted in this sales brochure are fair and reasonable depictions, the colors depicted may not be an exact match of the actual colors because of the variances in photo-processing and variances caused by inserting the photographs within the sales brochure. Due to product improvements, changes during the model year and/or transcription errors that may occur, information represented within this brochure may not be accurate at the time of your purchase. If certain information is significant to your purchasing decision, please confirm the information with your dealer prior to submitting your order.

The actual overall length of the recreational vehicle may differ from that indicated in the brochure due to variances in the manufacturing process and/or installed components. The actual length may be greater or less than that indicated.

BODY CONSTRUCTION

Standard Features

Aluminum Superstructure
Peaked Aluminum Roof with
Fiberglass Insulation
Smooth Gel Coat Fiberglass
Exterior Walls
Front and Rear Molded Fiberglass
Caps with Integrated Bumpers
Laminated Structurwood™ Flooring
with Aluminum Framing
Power Step Well Cover
Foam Insulated Underbelly
with Luaun Backer
Chrome Power Heated Remote
Exterior Mirrors
Baggage Doors with Integrated
Single Handle Latches
Wheel Mud Flaps
Deluxe Full Body Paint
Entry Step Storage

Options

3M® Film Front Mask
Full Length Safari Mud Flap
Mural
Rear Ladder

COCKPIT

Standard Features

Fiberglass Automotive Dash with
Burl Instrumentation Panel
Dash 12V Chassis Battery Gauge
CD Player with Six Speakers
Multi-Positioned Sunvisors
Color Rear Vision System
Intermittent Windshield Wipers
Tilt and Telescoping Steering
Wheel with Cruise Control
Power Steering
Dual Roof Mounted Air Horns
Cup Holder
Vinyl Pilot and Co-Pilot Seats
with Six-Way Power Pilot Seat
Carpet Driver and Passenger
Floor Mats
Adjustable Accelerator
and Brake Pedals
CB Prep with Antenna

Options

Ultraleather™ Pilot and Co-Pilot
Seats with Inserts
Six-Way Power Co-Pilot Seat
Extra-Wide, Six-Way
Power Co-Pilot Seat with
Power Footrest (N/A with
Side Entry Floorplans)
Power Sunvisors

Sirius Satellite Radio System
(Requires Subscription)
AM/FM Stereo/Cassette Player
(Deletes CD)
Ten-Disc CD Changer
CB Radio

APPLIANCES AND
ACCESSORIES

Standard Features

Double-Door Refrigerator with Ice
Maker and Raised Panel Doors
Recessed High-Output 3-Burner
Cooktop without Oven
Spacesaver Convection Microwave
with Touch Control
25-Inch Stereo Color TV with
Remote in Living Area
Living Area Stereo TV Wired
through Ceiling Speakers
19-Inch Stereo Color TV with
Remote in Bedroom
TV Antenna and Booster
Stereo VCR with Video
Switching Box
Cable TV Hook-Up and
Telephone Jacks
Washer/Dryer Prep

Options

Four-Door Refrigerator with
Ice Maker
High-Output 3-Burner Range
with Oven
Combination Washer/Dryer
Fully Automatic Digital
Satellite System
Home Theater System
with DVD Player

INTERIOR

Standard Features

Alder Cabinetry
Solid Wood Square Cane Insert
Cabinet Doors
Low Friction Roller Drawer Guides
Brass Finished Cabinet Hardware
Solid Surface Kitchen Countertop
with Solid Surface Sinks and
Two Sink Covers
Tip Out Tray under Kitchen Sink
Waste Basket Storage
Four-Compartment
Drawer Organizer
Slide-Out Wire Pantry
Ceramic Tile Flooring in Kitchen
and Bathroom
Padded Vinyl Ceiling
Nylon Carpeting and Pad in
Living Area and Bedroom

Pleated Day/Night Shades with
Black Outs in Bedroom
Solid Surface Bathroom
Countertop with Integrated Sink
Medicine Cabinet with Shelves
Bathroom Mirror
Towel Bars in Bathroom
Nightstands with Wood Tops
Bedroom Dresser with Wood Top
Clothes Hamper (N/A: 40PBT)
Bedspread with Pillows

Options

Hardwood Cabinetry
Regal Cherry Cabinetry
Maple Cabinetry
Laminated Plank Flooring in
Kitchen and Bath

FURNITURE

Standard Features

Queen Bed
Fabric Easy Bed Sofa with
Drawer – Curbside (38PDQ,
40DST, 40PBT)
Fabric Easy Bed Sofa with
Drawer – Driver's Side
(N/A: 40DST, 40PBT)
Fabric Recliner – Curbside
(N/A: 38PDQ, 40DST, 40PBT)
Fabric Recliner – Driver's Side
(40DST, 40PBT)
Round Hardwood Dinette Table
with Two Freestanding Chairs
Computer Table (38PDQ, 40DST,
40PBT)
Two Folding Dinette Chairs

Options

King Bed
Ultraleather™ Recliner – Curbside
(N/A: 38PDQ, 40DST, 40PBT)
Ultraleather™ Recliner – Driver's
Side (40DST, 40PBT)
Ultraleather™ Euro Recliner with
Ottoman – Curbside
(N/A: 38PDQ, 40DST, 40PBT)
Ultraleather™ Euro Recliner with
Ottoman – Driver's Side
(N/A: 40DST, 40PBT)
Ultraleather™ Easy Bed Sofa
with Drawer – Curbside
(40DST, 40PBT)
Ultraleather™ Easy Bed Sofa
with Drawer – Driver's Side
(N/A: 40DST, 40PBT)
Fabric Magic Bed Sofa – Curbside
(40DST, 40PBT)
Fabric Magic Bed Sofa – Driver's
Side (N/A: 40DST, 40PBT)

Fabric Hide-A-Bed with Air Mattress
Ultraleather™ Magic Bed Sofa – Curbside (40DST, 40PBT)
Ultraleather™ Magic Bed Sofa – Driver’s Side (N/A: 40DST, 40PBT)
Ultraleather™ J-Lounge – Curbside (40DST, 40PBT)
Ultraleather™ J-Lounge – Driver’s Side (N/A: 40DST, 40PBT)
Booth Dinette (N/A: 40SMD)

ELECTRICAL SYSTEMS AND LIGHTS

Standard Features
50 Amp 120V Distribution Panel and Power Cord
Onan® 6.5 kW LP Generator on Slide-Out Tray
Four 6V Deep Cycle Batteries
Two 12V Heavy Duty Chassis Batteries
Battery Disconnect Switches
1500 Watt Inverter
Porch Light
Side Docking Lights
Pilot and Co-Pilot Map Lights
Power Entry Step with Light
Water Pump Switch
Lights in Outside Storage Compartment
110V Receptacles inside Storage Compartment
Underhood Utility Light
110V/12V/Phone Receptacle in Dash Area
Recessed Systems Control Center
Fluorescent Ceiling Lights in Kitchen
Decorative Dining Light
Cosmetic Vanity Lights in Bathroom
Decorative Wall Lights in Bedroom
Decorative Wall Lights in Living Area

Options
Energy Management System
Solar Panel
Power Cord/Water Hose Reel
Onan® 7.5 kW Quiet Diesel Generator on Slide-Out Tray

HEATING, VENTS, AND AIR CONDITIONING

Standard Features
Dual 13.5M BTU Air Conditioner with Ducted Air, Wall Thermostat and Heat Pumps
40M BTU Electronic Ignition Furnace
Electronic AC/Heat Climate Control System
In-Floor Ducted Heating System
12V Attic Fan in Kitchen
12V Roof Vents in Bath Area
12V Wet Bay Heater

Options
12V Attic Fan in Bath

PLUMBING AND LP SYSTEMS

Standard Features
Demand Water System and Water Pump
10-Gallon LP Gas/Electric Water Heater with Electronic Ignition
Winterization Valving System
Gravity and Pressurized Water Fill
Water Purifier in Kitchen
Pull-Out Kitchen Faucet
One-Piece Fiberglass Shower (N/A: 40DST)
Bath Tub (40DST)
Glass Shower Door with Brass Frame
China Toilet
Insulated Systems Compartment with Easy Access to Hook-Up
Service Bay Faucet

Options
Bath Tub (Std. in 40DST)

SAFETY

Standard Features
Fire Extinguisher
Deadbolt Lock on Entrance Door
120V GFI Protected Circuit (Kitchen, Bathroom, Exterior)
LP Gas Detector
Smoke Detector
Carbon Monoxide Detector
Integrated Pilot and Co-Pilot
Three-Point Seat Belts (Lap and Shoulder)
Third Brake Safety Light
Egress Window

WINDOWS, DOORS, AND AWNINGS

Standard Features
Radius Dual Pane Safety Glass
Dark Tinted Slider Windows
Entry Door with Removable Screen with Fabric Valance and Roller Shade
Entry Assist Handle
Tinted Skylight in Bathroom
Patio Awning with Color Coordinated Hardware
Omega Slide-Out Awnings

Options
Carefree® Automatic Patio Awning
Carefree® Front Door Awning
Bedroom Window Awning
Mirage Automatic Patio Awning

CHASSIS/ENGINE/ SUSPENSION

Standard Features
Roadmaster RR4R-Series Chassis (Raised Rail, 4 Air Bags, Rear Radiator)
Cummins® ISC 350 HP Diesel Engine with Allison® 3000 MH 6-Speed World Transmission and Electronic Shifter
Torque: 1,050 lbs./ft. Max. Net at 1,424 RPM
Cubic Inch Displacement: 504.5"/8.3L
160 Amp Alternator
Rear Axle Ratio: 4.30:1
Dual Fuel Fill
Radial Tires: 275/70R/22.5
Polished Aluminum Wheels
Four Air Bag Suspension with Four Gas Shocks
Anti-Lock Braking System with Full Air Brakes (Drum)
Automatic Traction Control
Pac Exhaust Brake
Auto Slack Adjusters
Fuel and Water Separator
Fuel Filter
Rear Side Air Intake
Engine Block Heater
Air Cleaner Restriction Indicator
Hydraulic Leveling System
10,000 Lb. Hitch Receiver* with Six-Point Connector
Undercoating

Options
Deluxe Suspension Package

* Your towed vehicle should be equipped with auxiliary brakes if the weight of the towed load exceeds 1,000 lbs.

Floorplans for the way you live.

With Sahara’s six terrific floorplans, you’ll have only one problem — deciding which one you like best. And just wait until you see all the options. Like the Ultraleather™ Magic Bed sofa, four-door refrigerator with ice maker, and booth dinette. Choosing the floorplan you want may not be easy, but you’ll have fun doing it — and even better, living with it.

36PDD SAHARA

TILE CARPET FURNITURE

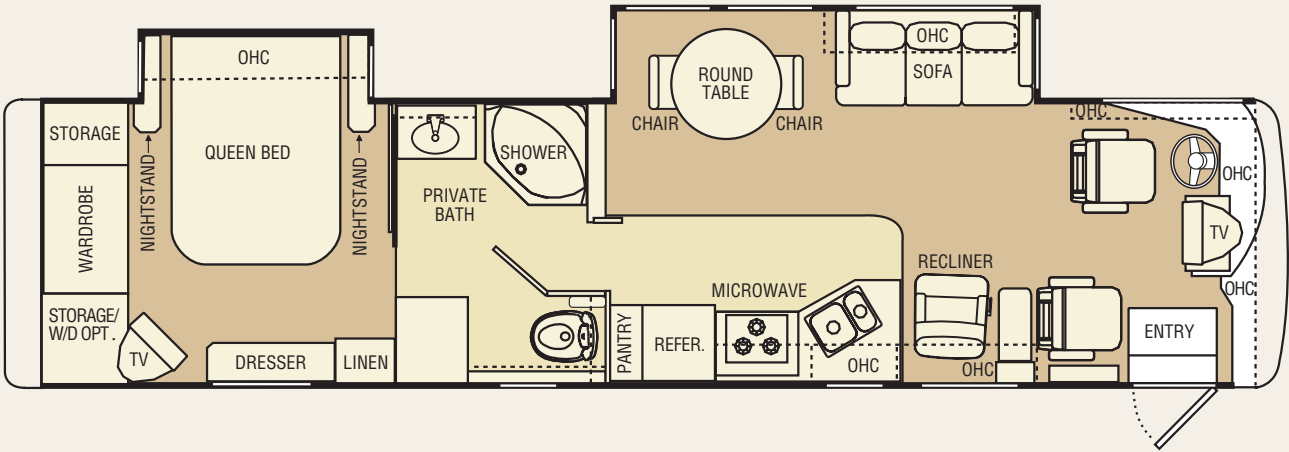

38PDQ SAHARA



Introducing the new Sahara quad slide.

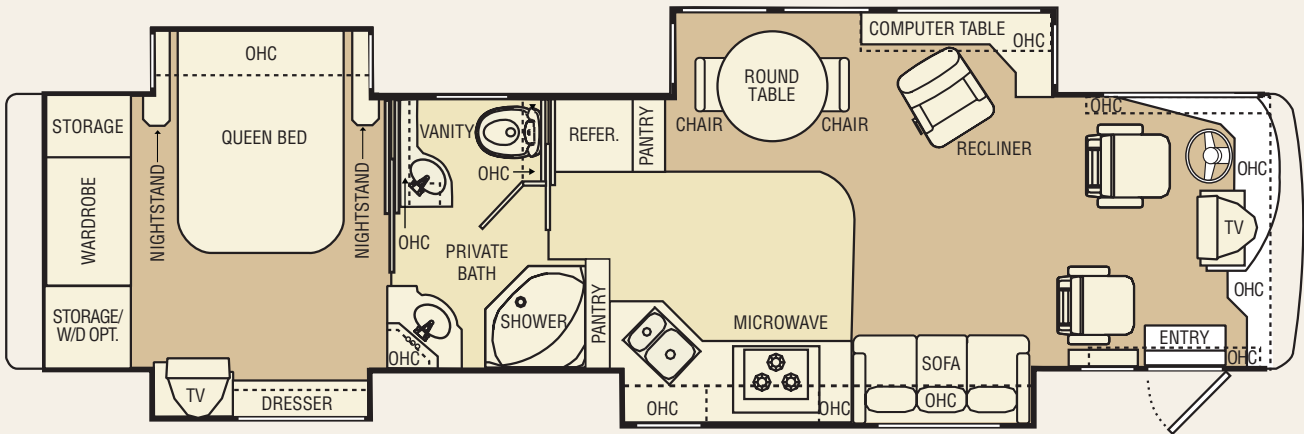

40SMD SAHARA

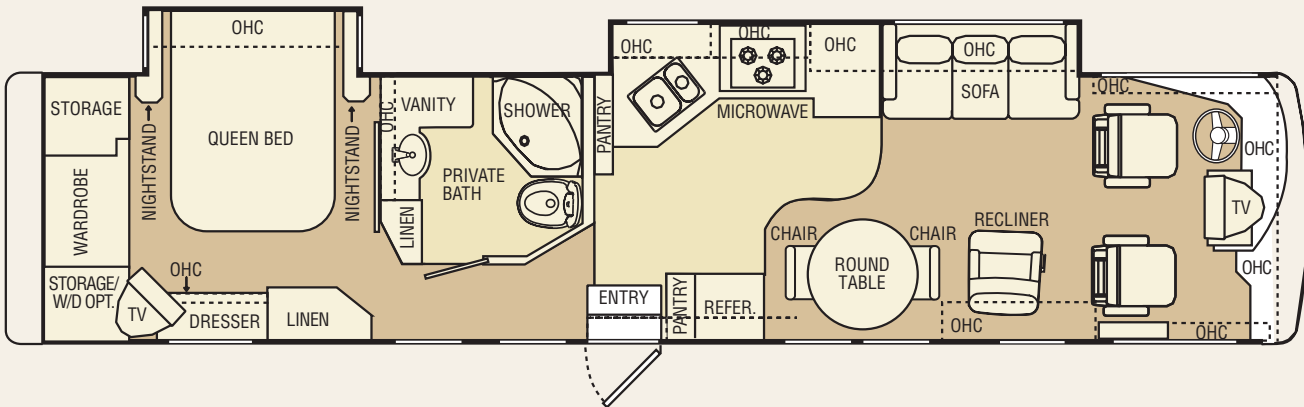

40DST SAHARA

TILE CARPET FURNITURE

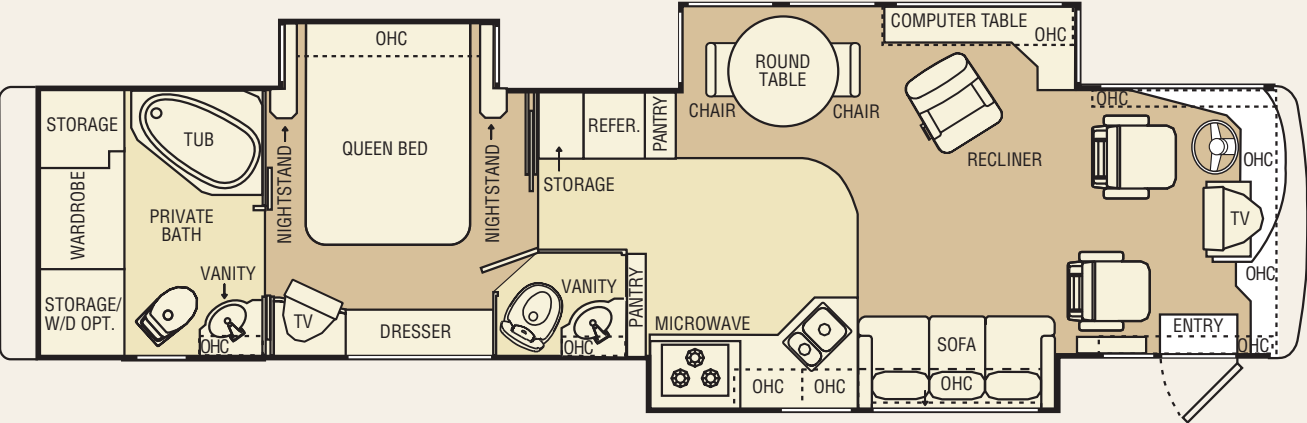

40PBT SAHARA

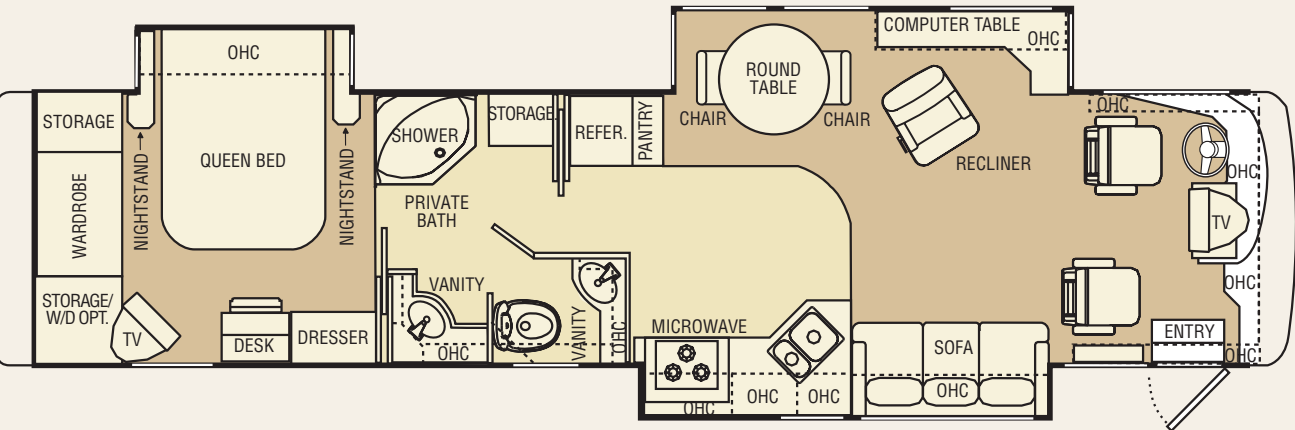

40SRT SAHARA

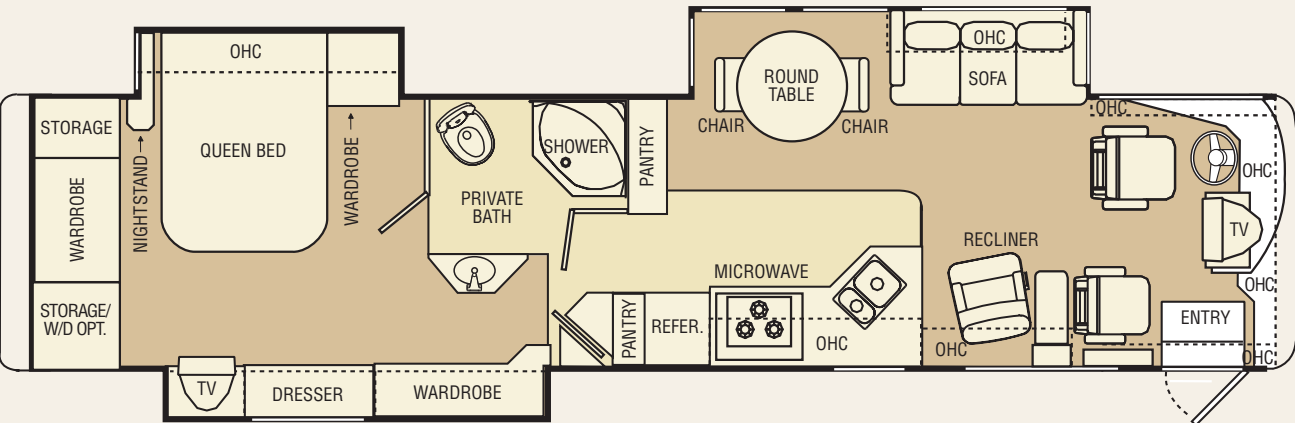



SAHARA04



Adventures worth sharing.



As a Safari owner, you're entitled to join us throughout the year for rallies designed just for you. You'll meet freedom-loving folks from across the country, all celebrating the adventure of the open road. In addition, you'll enjoy sharing travel information and tips about your coach in our Safari Adventures magazine,

published six times per year. And at www.safarimotorcoaches.com, you'll find a world of information online, right at your fingertips.



Safari's "Women's Only" seminars provide the opportunity for us to get the feminine perspective, which helps us continue designing great motorcoaches.



**No matter where you roam,
the Safari Family Advantage travels with you.**

When you purchase a coach from Safari, you become part of an industry-leading family of companies called Monaco Coach Corporation. What does that mean for you?



It means you have access to a wider array of benefits. To begin with, your coach is built by a level of expertise that could only be achieved through the teamwork and combined experience of all our companies. Like, for example, such exclusive innovations as the Roadmaster chassis — designed specifically for each individual model of our diesel coaches. You also get the benefit of our White Glove factory



inspection program, for a higher level of quality assurance and added peace of mind. And your dealer will be happy to tell you about our other innovative programs, including our Extended Care service agreements. Of course, once you're on the road, you'll have access to our nationwide network of more



than 350 service facilities, meaning wherever you travel, you're never far from a friend. Ready to roll? In a 2004 Safari, the strength of our entire family is behind you every mile of the way.

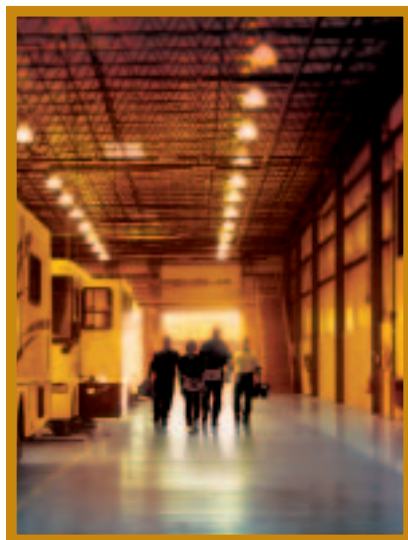

350 | Service
and growing | Facilities
Nationwide

WARRANTIES

12 MONTH/24,000 MILE
basic limited warranty

5 YEAR/50,000 MILE
limited warranty on aluminum or
steel frame structure of sidewall,
roof, front and rear cap

3 YEAR/36,000 MILE
limited warranty on
Roadmaster chassis

See owner's manual for complete details.



MONACO COACH CORPORATION



Everything but ordinary.

Every Safari comes with the ability to roam free.

There's a spirit in the air. One that whispers freedom — gently urging you to break out and go exploring on your own terms. At Safari, our coaches are bred with a passion for adventure. Whether it takes you to remote mountain hideaways, winding coastal roads or simply across the Midwest to visit



your kids. We've combined the very best in engineering and innovation to give you feature-packed coaches at some of the best values in the industry. But in the end, don't just take our word for it. Visit a Safari dealer near you, and get a real taste of the adventure that lies ahead.

The 2004 Safari Lineage

PANTHER

ZANZIBAR

SAHARA

CHEETAH

TREK

YOUR SAFARI MOTORCOACH DEALER:

Visit our web site at www.safarimotorcoaches.com for the dealer nearest you or call 1-800-634-0855.

BY MONACO COACH CORPORATION • 91320 Coburg Industrial Way • Coburg, OR 97408

© 2003 Monaco Coach Corporation (NYSE: MNC) Printed in USA

0803 NPN: BROSSAH