



Hornet

Hornet Mini Motorhomes • By Damon Corporation





Hornet Mini Motorhomes. Compact, without compromising quality.

Whoever said big things come in small packages would certainly be pleased with the Hornet Mini Motorhome. If you're like most RV enthusiasts, you've been stung searching for a mini-motorhome that combines affordability with a host of popular RV features. Well, look no further. The Hornet from Damon Corporation is your nest away from home.

Incorporating the latest in lamination-construction technology and the expanded space of new wide-bodied units, Hornet is truly a recreational vehicle that must be seen to be appreciated. You're sure to notice the space optimizing floor plans and deluxe furniture. In addition, wonderful meals are at your fingertips with appliances that include a three-burner, high-output range, microwave oven, double-door refrigerator (optional on LE) and bright double-bowl porcelain kitchen sink.

And if that doesn't whet your appetite, how about hardwood framed cabinet doors in the kitchen. A dinette with four seatbelts. A large skylight shower. An LP-gas detector and carbon-monoxide detector — all standard. There's even spacious storage for pots and pans under the dinette. The innerspring bedroom mattress has a coordinating bedspread. Optional amenities include an electronically tuned AM/FM stereo cassette and heated holding tanks.

Nine floor plans—each meticulously designed to offer a warm, inviting atmosphere—are available, with models 26 feet and longer featuring basements with pass-through storage. Moreover, the supple colonial white exterior is durable, yet handsomely attractive and easy to clean.

Engineered to deliver value and exceptional comfort at an affordable price, Hornet blends Old World craftsmanship with new-age technology.

So take the sting out of your next mini-motorhome purchase. Beeline to your nearest Damon dealer for unmatched quality and affordability.

(Above) Every day is a great one in the Hornet, shown here in Model 2907B with Sandstorm decor. Everything is plush — from the upholstered couches to the cozy captain's chairs. (Below) Everything from snacks to four-course meals comes out of this galley, with appliances and plenty of storage space. Oak cabinet doors make the look both warm and elegant.



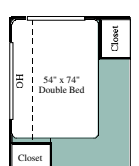
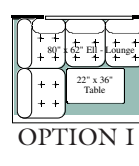
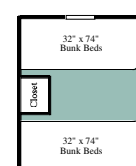
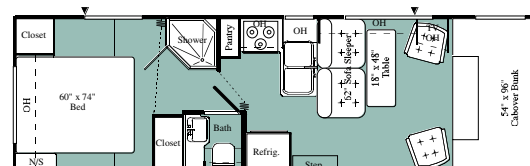
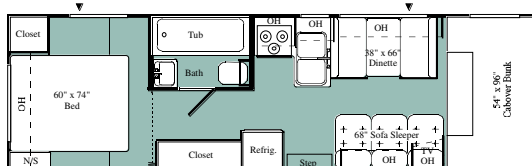
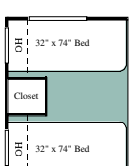
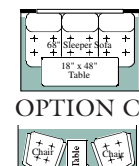
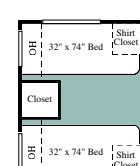
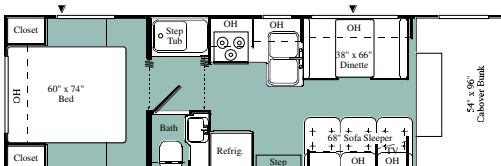
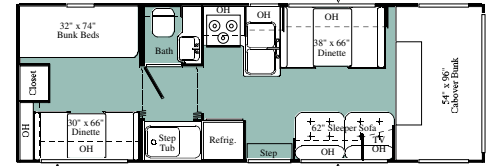
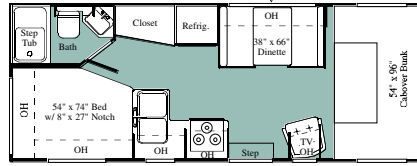
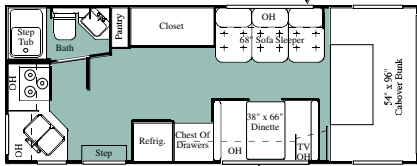
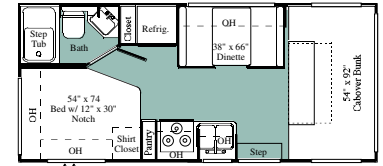
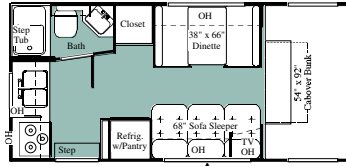
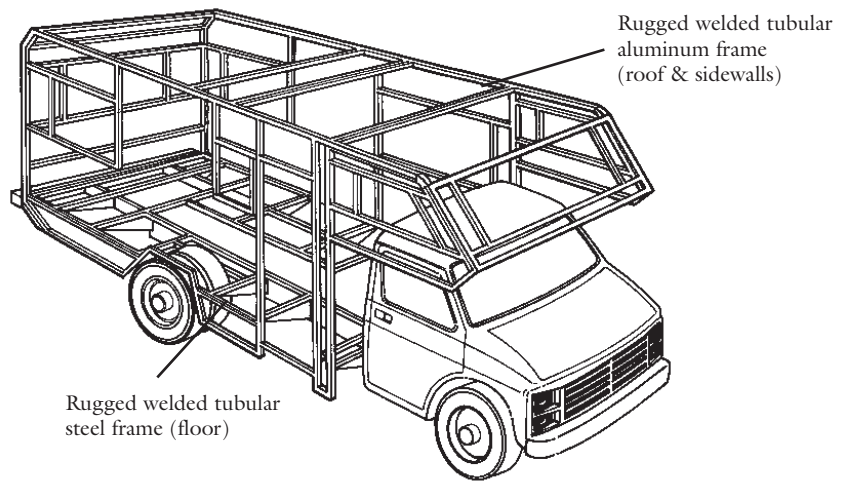
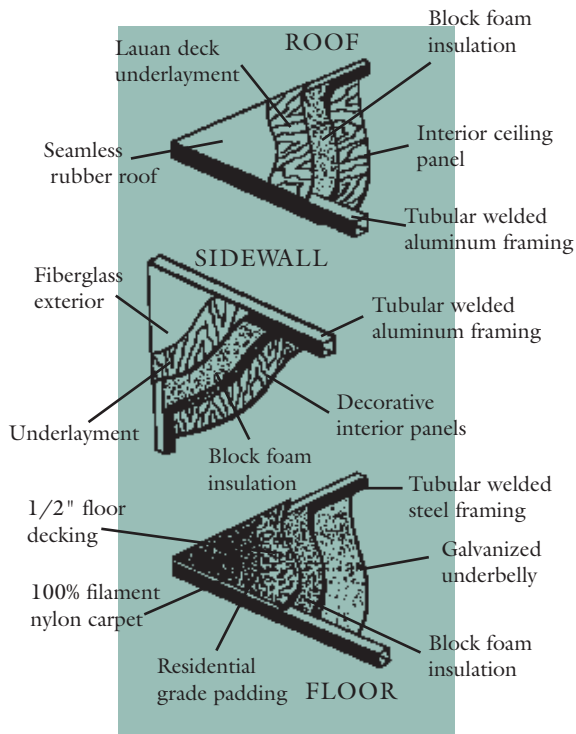

▲ = UNDERFLOOR STORAGE

W e i g h t s a n d D i m e n s i o n s									
Model	2002LE	2003LE	2305	2402	2604B	2754B	2907B	3000B	3001B
Chassis	Chevy/Ford	Chevy/Ford	Chevy	Chevy	Ford	Ford	Ford	Ford	Ford
Wheelbase (inches)	125"/138"	125"/138"	146"	146"	176"	188"	188"	218"	218"
GVWR	10200/10500	10200/10500	10500	10500	11500	12200	12200	12200	12200
EFI Engine (cu.in.)	350/460	350/460	454	454	460	460	460	460	460
Fuel Capacity (gal.)	33/35	33/35	33	33	55	55	55	55	55
Overall Length	20'11"/21'8"	22'2"/22'11"	24'6"	24'6"	27'8"	29'3"	29'3"	31'1"	31'1"
Overall Width	8'2"	8'2"	100"	100"	100"	100"	100"	100"	100"
Overall Height w/roof A/C	10'10"/11'1"	10'10"/11'1"	11'1"	11'1"	11'1"	11'1"	11'1"	11'1"	11'1"
Base Weight (lbs.)	NA	NA	NA	NA	NA	NA	NA	NA	NA
Fresh Water System (approx. gal.)	33	33	26	33	33	33	33	33	33
Grey/Black Water (approx. gal.)	25/27	25/27	35/39	35/39	32/32	32/32	32/32	32/32	32/32
Sleeping Capacity	4	4	4	5	5	5	5	5	4

Cristal

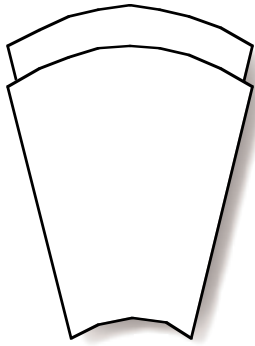

Sandstorm

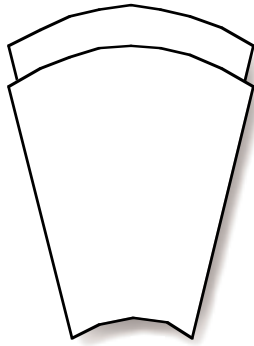

Keylime

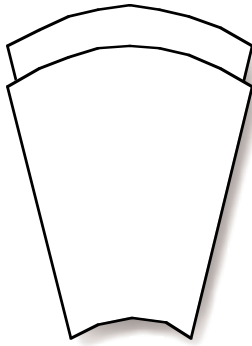

Standard Features

Chassis Features: Anti-sway bar (N/A 2002LE, 2003LE) • Auto transmission • Power steering • Dash air conditioner • Cruise control • Tilt steering wheel • AM/FM cassette stereo • Reclining captain's chairs • Chevy: Power hydraulic front disc/rear drum with 4-wheel anti-lock brakes, electronic fuel injected engine with HD cooling system • Ford: Power and rear wheel anti-lock brakes, electronic fuel injected engine, gas engines include HD auxiliary transmission cooler • Upgrade mirrors including convex mirror • Drink tray

Exterior Features: Entrance door with screen door and dead bolt lock • Radius corner slider windows • Radius corner baggage doors • Spare tire • Entry-assist handle • Rugged, colonial white, ribbed fiberglass exterior • Aluminum running boards (opt. on LE) • Bumper cover (opt. on LE) • Luggage ladder • Stainless steel wheel covers (opt. on LE)

Construction: Rugged, welded aluminum-framed and laminated sidewalls and roof • Steel-framed and laminated floor • One piece E.P.D.M. rubber roof • Rugged metal undercarriage • Undercoating

Electrical: Systems monitor panel (including LPG readout) • Generator prep: fuel line, start cable, 120-volt pre-wire • 45 amp, 12-volt power converter w/generator auto change over switch • Roof air conditioner (opt. on LE) • 12-volt demand water pump • TV antenna w/booster (opt. on LE) • Power vent in bath

Heating and Appliances: 60# LP gas tank • 3-burner high-output cooktop • Microwave oven • Lighted power-range hood • Flush-mount double-door refrigerator (opt. on LE) • 6-gallon gas water heater w/electronic ignition (electronic ignition opt. on LE) • Electronic-ignition ducted furnace (20M BTU-2002LE, 2003LE; 25M BTU-2305, 2402; 31M BTU-2604B, 2754B, 3000B, 3001B)

Interior Features: Self-edged countertops • Double-bowl porcelain kitchen sink • Cab-over privacy curtain • 100% continuous filament nylon carpeting w/Scotchgard treatment and residential padding • Hardwood-framed cabinet doors • Bedspread (NA on 2002LE, 2305) • Fabric/upholstery-trimmed valances in living room • Roller shades w/drapes & tiebacks in living room, dining room and bedroom • Mini-blinds in kitchen • Clock and mirror • Innerspring mattress (NA 2002LE, 2305) • Skylight in shower (where available) • Interior entry-assist hand rail • Carbon monoxide detector • Fire extinguisher

Popular Options

Air cushioned suspension • Solid oak cabinet doors • Oak plank kitchen flooring • Day/night shades throughout • Upgrade innerspring mattress (N/A 2002LE and 2305) • Bi-fold shower door • Generator • Microwave oven w/convection oven • 3-burner high-output range and oven w/piezo ignition, black top and black glass front • Stainless steel folding range cover • Sink cover • LP gas detector • Cable TV hook-up • AM/FM cassette stereo upgrade w/LCD readout, clock, electronic tuning and station presets • Foot-flush toilet • Luggage rack • Water heater by-pass kit • Smooth fiberglass exterior • For additional options see your dealer

Thistle

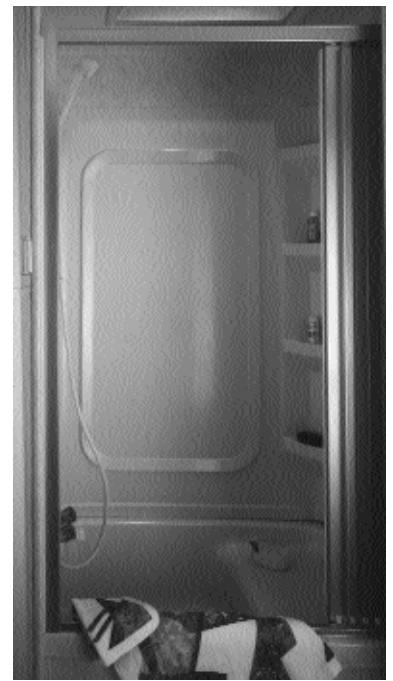
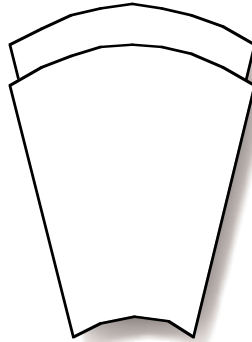

(Above) Skylights (std. where available) can certainly brighten your morning routine, and attractive accents make every Hornet bathroom shine. (Below) Bunk up for extra fun with coordinated twin beds. This particular floor plan also offers an additional dinette table, perfect for playing board games on those rainy days.



Your nearest dealer:



P.O. Box 1107 • Elkhart, IN 46515 (219) 262-2624

Due to constant product improvements, the equipment, specifications, component parts and standard/optional equipment are subject to change without notice or obligation. Product photography or diagrams may show equipment that is optional. Damon Corporation reserves the right to make changes in prices, and models, and to discontinue models without notice or obligation. Components, parts, or chassis may have been manufactured at times other than the model year indicated. All capacities are approximate and dimensions are nominal. See your Damon dealer for full details. DC 6/95. © Damon Corporation - 1995 Printed in the USA.