

TUSCANY XTE

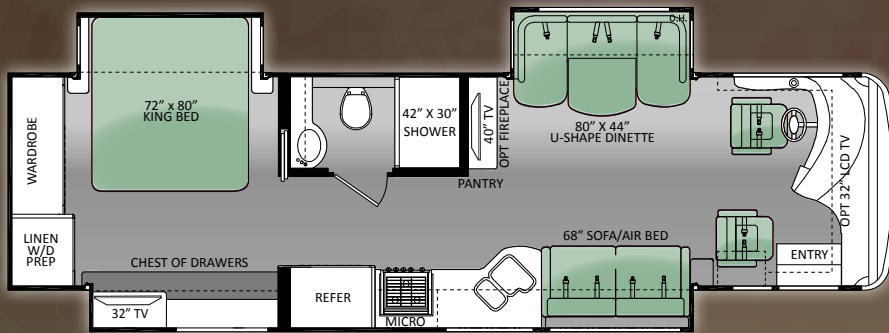

MODEL

Chassis	Freightliner XC
Gross Vehicle (GVWR)	32,400
Gross Combined (GCWR)	42,400
Wheel Base	208"
Exterior Length (w/o ladder)*	35'-4"
Exterior Height (w/ AC)	12'-9"
Exterior Width (w/o mirrors)	101"
Interior Height	85"
Awning Size	16'-5"
Fuel (gal)	100
LPG (lbs)	126
Fresh/Waste/Grey Water (gal)	91/51/51
Water Heater (gallons)	10
Furnace (BTUs)	(2) 20,000
Exterior Storage Capacity (cu. ft.)	140

MODEL

36MQ

Chassis	Freightliner XC
Gross Vehicle (GVWR)	32,400
Gross Combined (GCWR)	42,400
Wheel Base	236"
Exterior Length (w/o ladder)*	37'-8"
Exterior Height (w/ AC)	12'-9"
Exterior Width (w/o mirrors)	101"
Interior Height	85"
Awning Size	13'
Fuel (gal)	100
LPG (lbs)	126
Fresh/Waste/Grey Water (gal)	91/51/51
Water Heater (gallons)	10
Furnace (BTUs)	(2) 20,000
Exterior Storage Capacity (cu. ft.)	185

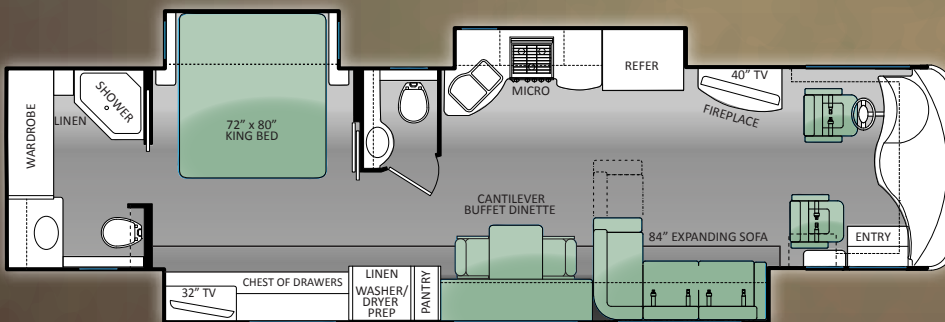
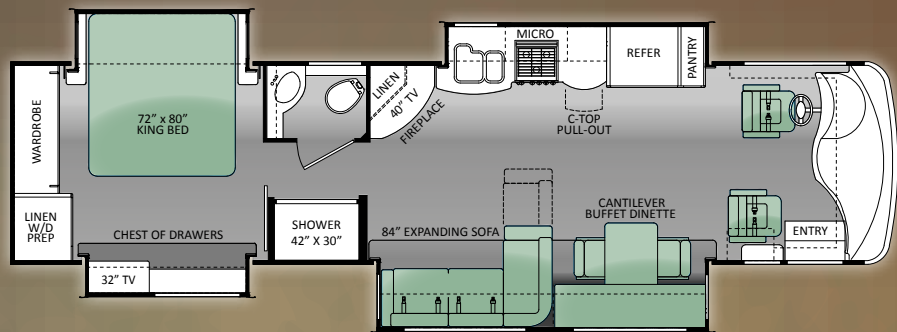

MODEL

40EX

Chassis	Freightliner XC
Gross Vehicle (GVWR)	32,400
Gross Combined (GCWR)	42,400
Wheel Base	266"
Exterior Length (w/o ladder)*	40'-2"
Exterior Height (w/ AC)	12'-9"
Exterior Width (w/o mirrors)	101"
Interior Height	85"
Awning Size	16'-5"
Fuel (gal)	100
LPG (lbs)	126
Fresh/Waste/Grey Water (gal)	91/51/51
Water Heater (gallons)	10
Furnace (BTUs)	(1) 20,000 / (1) 25,000
Exterior Storage Capacity (cu. ft.)	215

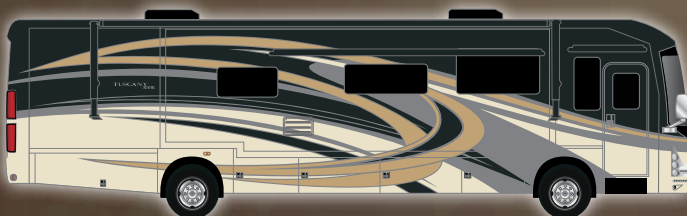

GLAMOUR FULL BODY PAINT

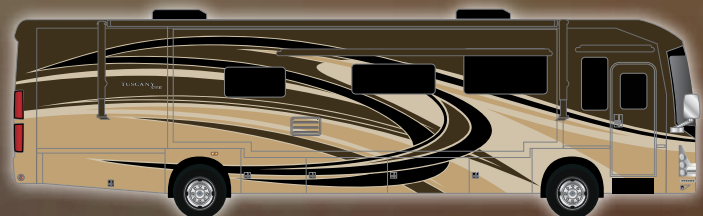

MIRAGE FULL BODY PAINT

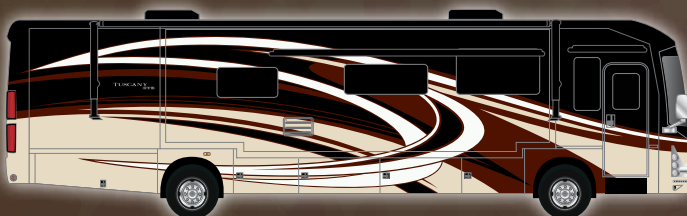

PALISADE FULL BODY PAINT

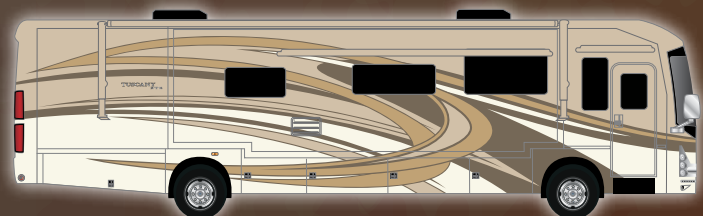

VERONA FULL BODY PAINT

STANDARD & OPTIONS

CHASSIS

- Freightliner XC Raised Rail Chassis
- ISB-XT 360-hp Cummins Engine with 800 ft lb of Torque
- 6 Speed Allison MH-3000 Automatic Transmission
- 22.5" Radial Tires with Aluminum Wheels
- Front Axle with Air Disc Brakes and 55" Wheel Cut
- Air-Ride Suspension
- Exhaust Brake
- Under-Hood Light
- Dual Fuel Fills
- Emergency Start Circuit
- 10,000 lb Trailer Hitch
- Automatic Leveling Jacks with Touch Pad Controls

CONSTRUCTION & EXTERIOR

- Fiberglass Front and Rear Caps
- Tinted One Piece Windshield
- Frameless Dual Pane Windows
- Full Body Paint with Gel Coat Wall
- Invisible Bra
- Electric Entry Door Awning
- Lateral Arm Electric Patio Awning
- Slide Out Topper Awnings
- Fog Lights
- Pass-Through Storage
- Easy Slide Storage Tray
- Side-Hinged Aluminum Compartment Doors
- Rear Ladder

AUTOMOTIVE & COCKPIT

- Electric Windshield Day / Night Privacy Shade

- Manual Side Day / Night Privacy Shades
- Ultra Leather Reclining Driver and Passenger Seats with 6-Way Power Adjustment
- Driver and Passenger Overhead Storage Cabinetry
- Chrome Power Mirrors with Heat and Integrated Side View Camera System
- Touch Screen Dash Radio with CD Player and Back-up Monitor
- Electronic Cruise Control
- Air Horn
- Dash Fans
- Electric Step Cover

INTERIOR

- Hardwood Raised Panel Cabinet Doors & End Panels
- Day / Night Roller Shades in Living Area & Bedroom
- Porcelain Tile Throughout
- Halogen Lighting Throughout
- Ultra Leather Sofa/Air Bed [34ST]
- Ultra Leather Expanding L-Sofa (N/A 34ST)
- U-Shaped Dinette [34ST]
- Cantilever Buffet with Computer Workstation and Two Chairs (N/A 34ST)
- Two Folding Chairs

INTERIOR OPTIONS

- Ultra Leather Sofa/Air Bed on Passenger Side [36MQ & 40EX]
- Dream Dinette [36MQ Only]

BEDROOM & BATHROOM

- King Size Denver Mattress "RV Supreme Euro Top"
- Bedsprad with Throw Pillows
- 12-volt Attic Fan in Bedroom
- Full Height shower with Door
- Foot Flush Porcelain Toilet with Sprayer

KITCHEN

- Stainless Steel Residential Refrigerator with In-Door Ice & Water Dispenser
- 3-Burner Cooktop
- 30" Stainless Steel Over-the-Range Convection Microwave Oven
- Solid Surface Kitchen Countertop, Range Cover, Sink Covers and Lavatory Countertop
- Tile Kitchen Backsplash
- 12-volt Attic Fan

MULTIMEDIA

- 40" HDTV in Living Area
- 32" HDTV in Bedroom
- Surround Sound Home Theater
- Blu-Ray Disc/DVD Player
- Satellite Dish Prep

MULTIMEDIA OPTIONS

- 32" HDTV in Cockpit Overhead
- 32" HDTV in Exterior Entertainment Center (N/A with Dream Dinette Option on 36MQ)
- In-Motion Satellite Dish

ELECTRICAL & PLUMBING

- Dual 13.5K BTU Ducted Central Air Conditioners with Heat Pumps

- (2) 20,000 BTU Ducted Electronic Ignition Furnace
- 50-amp, 120-volt Service
- Onan RV QD 8000 Diesel Generator
- Auto Gen Start
- 2000-watt inverter / 100-amp Converter
- (4) 6-volt Auxiliary House Batteries
- Energy Management System
- 10-gallon Gas/Electric Water Heater with Electric Ignition
- Stackable Washer and Dryer Prep
- Enclosed Heated Potable and Holding Tanks
- Black Tank Flush
- E-Z Flow Water Panel with Whole-House Water Filtration
- Exterior Shower
- Central Vacuum System
- Manual Power Cord Reel

ELECTRICAL & PLUMBING OPTIONS

- Stacking Washer and Dryer

INTERIOR DECORS



OLYMPIC CHERRY



VINTAGE MAPLE



IVORY SONATA



SAND CASTLE

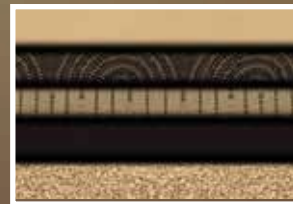

KONA BEAN

IMPORTANT - PLEASE READ: Information published within this brochure reflects product design, fabrication, material, components and specifications at the date of printing. If your vehicle was manufactured before this brochure was published this information may not be accurate because vehicles assembled before the brochure was published may not have the same design, fabrication, materials, components and specification as represented in the brochure. If your vehicle was manufactured after this sales brochure was published the representations may not be accurate because, for product improvement reasons, we reserve the unilateral right, at any time, without prior notice, to make changes in product design, material, components and specifications. The date the brochure was published (i.e. "Julian date") is set forth on the last page of the brochure. IF CERTAIN INFORMATION PUBLISHED WITHIN THIS BROCHURE IS SIGNIFICANT TO YOUR PURCHASING DECISION, PLEASE CONSULT WITH YOUR SELLING DEALERSHIP TO CONFIRM THAT THE INFORMATION IS ACCURATE WITH RESPECT TO THE VEHICLE YOU ARE CONSIDERING PURCHASING. Photographs in the brochure may depict optional equipment or may only be available in certain floor plans. We reserve the right to make changes in prices and models and to discontinue models without notice or obligation. Components, appliances and the chassis may have been manufactured in a calendar year before the vehicle's designated model year. All capacities are approximate. The actual length of the vehicle may differ from that indicated in the brochure due to variances in the manufacturing processes and/or installed components. All dry weights are based on standard model features and do not include optional features or equipment. Components, appliances and features may differ to conform to local codes. Due to EPA environmental restrictions, engine power and torque ratings may change during any model year. The Thor Motor Coach logo and its design are registered trademarks. Other products and company names are trademarks and/or registered trademarks of their respective manufacturer. While the color of the motorhome's exterior and the interior fabrics depicted in this brochure are fair and reasonable depictions, the colors depicted may not be exact match of the actual colors because of variances in photo processing and printing. Component part and appliance manufacturers issue limited warranties covering portions of the vehicle not covered under the limited warranty we issue. To learn specific details regarding warranty coverage please consult your selling dealership or review the warranty packet inside the vehicle.

TUSCANY XTE

YOUR LOCAL TMC DEALER:



Go RVing.