

THOR
MOTOR COACH

VEGAS



THOR
MOTOR COACH



VEGAS

RUV

RECREATIONAL UTILITY VEHICLE



FUDGE SWIRL DECOR / OLYMPIC CHERRY WOOD



STUNNING BEAUTY & FEATURES



A HD MAX™

Costing thousands of dollars less than full body paint schemes, the revolutionary HD-MAX™ gel-coat colored fiberglass with graphics package turns heads wherever you travel.

B POWER PATIO AWNING

The expansive patio awning spans the length of the sidewall maximizing coverage and also helps to shield you from the elements.

C SIDE VIEW CAMERAS

Integrated seamlessly into the exterior mirrors, the side view camera system helps you to change lanes or take the turn with confidence.

D WINDSHIELD

A beautifully designed curved windshield provides a modern look, sweeping large panoramic views and improved visibility.

E SIZED JUST RIGHT

At just 25 feet in length and only 8 feet wide this motorhome allows you to go where you want to go.

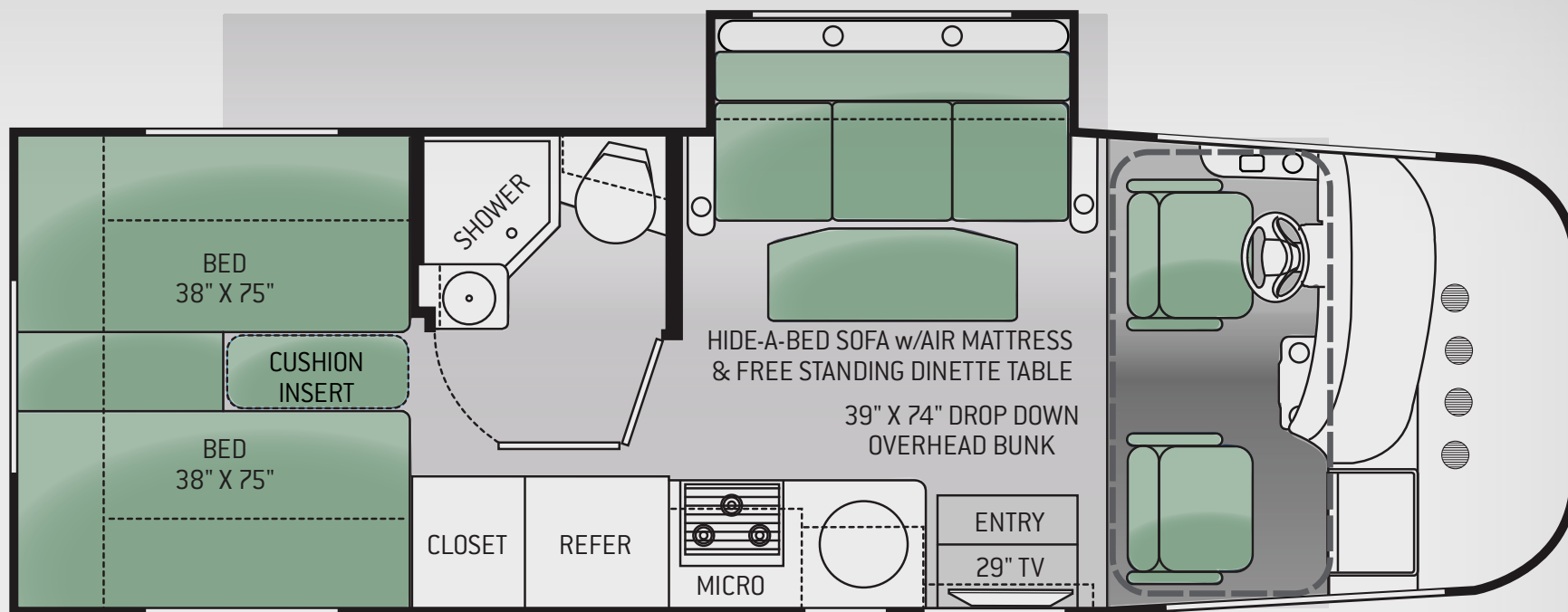

THERE'S A NEW CLASS OF VEHICLE OUT THERE AND WE CALL IT THE VEGAS RUV. THE VEGAS IS A NEW RECREATIONAL UTILITY VEHICLE, OR RUV FOR SHORT. THIS IS THE VEHICLE YOU'VE DREAMED ABOUT, BECAUSE IT FITS YOUR LIFE. IT PROVIDES ALL THE AMENITIES THAT MAKE TRAVELING SO GREAT, IN A COMPACT, FUNCTIONAL AND FUN WAY. AN RUV MAKES TODAY'S SUV LOOK, WELL, INSIGNIFICANT...

Chassis	Ford
Gross Vehicle (GVWR)	12,500
Gross Combined (GCWR)	18,500
Wheel Base	188"
Exterior Length (w/o ladder)	25'-6"
Exterior Height (w/ AC)	11'-3"
Exterior Width (w/o mirrors)	94"
Interior Height	82"
Awning Size	16'
Fuel (gallons)	55
LPG (pounds)	40.9
Fresh Water (gallons)	42
Grey Water (gallons)	37
Waste Water (gallons)	30
Water Heater (gallons)	6
Furnace (BTUs)	30,000
Exterior Storage Capacity (cu. ft.)	63.5

SPECIFICATIONS

MORE THAN SKIN DEEP

THE VEGAS IS EVERYTHING A TRAVEL COMPANION SHOULD BE. IT'S A NEW BREED OF VEHICLE, BUILT TO TAKE ON THE CHALLENGES OF TODAY'S BUSY LIFE. IF YOU ARE LOOKING FOR THE PERFECT WAY TO TRANSPORT THE KIDS BACK AND FORTH TO WEEKEND SOCCER TOURNAMENTS OR CHEERLEADING COMPETITIONS, OR YOU'RE SEARCHING FOR THE BEST WAY TO MAKE THE TRIP TO YOUR WINTER HOME DOWN SOUTH, THE VEGAS IS THE TICKET!

EXTERIOR GRAPHIC CHOICES

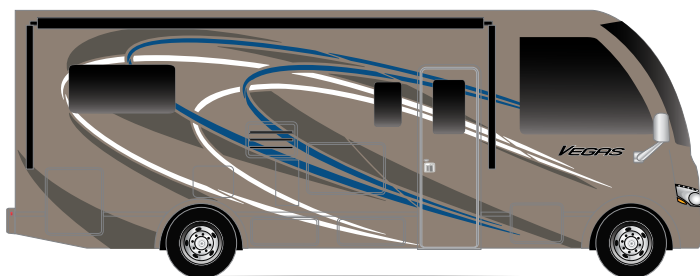

MARQUEE HD-MAX™

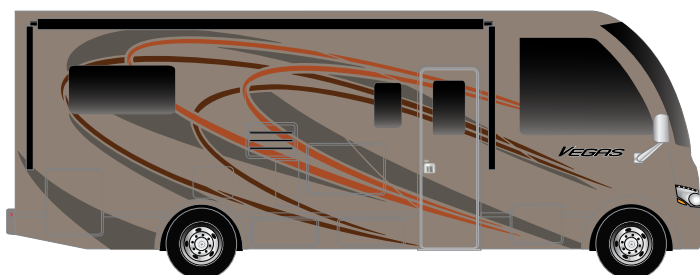

TROPICANA HD-MAX™

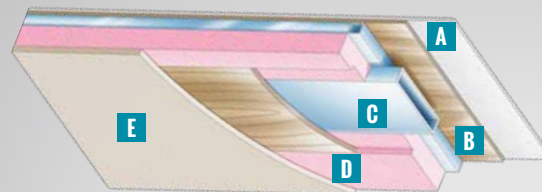

ROOF

- A One-piece exterior TPO membrane
- B Luan panels
- C Aluminum structure with bowed framing
- D Block foam insulation
- E Interior décor panel with reflective vinyl covering

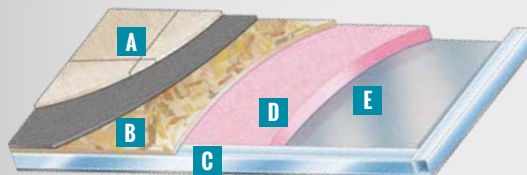

FLOOR

- A Residential vinyl flooring or carpet
- B OSB structure wood base
- C Structural steel framing
- D Block foam insulation
- E Luan with woven plastic exterior finish

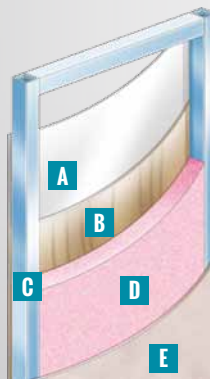

SIDEWALLS

- A High-gloss or gel-coat fiberglass
- B Luan panels
- C Aluminum structure with framing at all opening
- D Block Foam insulation
- E Interior panel with designer wall covering

All roof, wall and floor structures are vacuum bond laminated. This process ensures constant and consistent glue coverage over all layers of the structure. This time sensitive process is necessary to provide stronger and more secure motorhomes with increased longevity.



DECOR CHOICES





IT STARTS WITH A SOLID FOUNDATION

RUV

RECREATIONAL UTILITY VEHICLE



A IFS

Independent Front Suspension provides a superior ride due to the ability of each wheel to address the road undisturbed by activities of the other wheels on the vehicle.

B FLAT CAB FLOOR

Entering and exiting the cockpit area is smooth and seamless. The forward placement of the engine eliminates the inconvenient step-up you find in other motorhomes.

C LOWER CENTER OF GRAVITY

Helps increase the handling and drivability of the motorhome, making the ride feel more connected to the road.

D EXTRA-WIDE FRAME RAILS

Durable, heavy-duty frame rails reduce flex, bowing and vibration to minimize coach stress and lessen noise.

STANDARD FEATURES & OPTIONS

CONSTRUCTION & EXTERIOR

- Ford Chassis - 6.8L Triton V-10 Engine with 5 Speed TorqueShift® Automatic Transmission with Overdrive
- One-Piece Fiberglass Front Cap
- One-Piece Windshield
- Slick Fiberglass Exterior Sidewalls
- HD-Max™ Exterior with Graphics Package
- Seamless Roto-Cast Storage Compartments
- Flush Mount Radius Luggage Doors
- Electric Patio Awning
- Frameless Windows
- Roof Ladder
- Rubber Tread Entry Steps
- Outside Shower

AUTOMOTIVE & COCKPIT

- Touchscreen Dash Radio with CD Player & Back-up Monitor

- Generator Start Switch
- Reclining/Swivel Leatherette Captain's Chairs
- Stow-Away Table Between Captain's Chairs
- Heated/Remote Exterior Mirrors with Integrated Side View Cameras
- Fog Lights
- 16" Tires with Stainless Steel Wheel Liners
- 5,000 lbs Trailer Hitch
- Valve Stem Extenders on Rear Tires

INTERIOR

- Residential Linoleum Throughout (Except Cockpit Area)
- Metal Entry Grab Handle
- 13,500 BTU Roof Air Conditioner
- Olympic Cherry or Vintage Maple Cabinetry
- Hardware with Nickel Finish
- LED Ceiling Lights
- Leatherette Hide-A-Bed

Sofa with Air Mattress & Removable Dinette Table

- Electric Drop Down Overhead Bunk
- Night Shades

INTERIOR OPTIONS

- 15,000 BTU Roof Air Conditioner - IPO 13,500 BTU Roof Air Conditioner
- 12-volt Attic Fan in Living Area

KITCHEN

- Double-Door Refrigerator
- 3-Burner High-Output Gas Cooktop
- Convection Microwave Oven
- Laminate Countertops
- Oversized Bowl Sink with Single Lever Gooseneck Faucet
- Ball Bearing Drawer Guides
- Flip-up Countertop Extension
- Full Extension Metal Drawer Guides

KITCHEN OPTIONS

- 3-Burner High-Output Gas Range & Microwave Oven

MULTIMEDIA

- 29" Television in Living Area
- Multiple 12-volt & USB Charging Ports
- Cable Television Prep
- HD/DSS Satellite Prep

MULTIMEDIA OPTIONS

- 22" Television with DVD Player in Bedroom
- Exterior 32" Television

BEDROOM & BATHROOM

- Twin Beds with Upholstered Covers (Convert to King Size Bed)
- Bedspread & Pillow Shams
- Designer Headboard
- Foot Flush Porcelain Toilet
- Power Vent
- Shower with Skylight

BEDROOM & BATHROOM OPTIONS

- 12-volt Attic Fan in Bedroom

ELECTRICAL & PLUMBING

- Onan RV QG 4000 Gas Generator
- 30-amp Service with Marine Type Detachable Power Cord
- Automatic Shoreline-to-Generator Transfer Switch
- Battery Disconnect Switch
- 6-gallon Gas/Electric Water Heater
- Water Heater Bypass System
- Systems Control Center

ELECTRICAL & PLUMBING OPTIONS

- Second Auxiliary Battery
- Holding Tanks with Heat Pads



P.O. BOX 1486 • ELKHART, IN 46515 • CUSTOMER SERVICE: 800-860-3812 • SALES DEPARTMENT: 800-860-5658 • VEGAS-MOTORHOMES.COM

COPYRIGHT THOR MOTOR COACH, INC. © 2013

