

Invitation





www.tripleerrv.com



Featuring the warmth of ginger spice oak cabinetry throughout, Invitation's quad slide-out instantly expands the generously-sized living and galley area. The cook will appreciate the galley's ample counter space, tile-look laminate flooring, microwave, range and optional stainless steel refrigerator. Biltmore decor shown.



A 20" flat screen TV overlooks the bedroom cleverly designed for optimum space and storage, including a four-drawer dresser and window-seat bench with extra drawer. The pleated day/night shade can easily be drawn to effectively block out light.

The good life awaits you.

When rubber meets the road, Invitation's Freightliner XC chassis and powerful 330 horsepower engine with 1,000 foot pounds of torque deliver dependable performance; where design and convenience matter most, its spacious, home-style interior ensures your comfort. With an extensive list of driving features, including side turn cameras, and a generous selection of living amenities from the sliding pantry to Sirius-ready satellite radio, consider this your best Invitation to travel in style.



Breakfast ready? Set the table in this attractive dining area, complete with a hutch for convenient dish storage and two optional folding chairs for extra seating.



Elegance and comfort have been designed into Invitation's spacious bedroom which features two slide-outs with more than adequate space to insure that all your apparel and accessories are with you.



Invitation's luxurious cockpit easily converts into living room appeal. Feel right at home in the ultra-comfortable Optima leather-look captain chairs and matching love seat, perfect for a quiet evening of leisure or to enjoy a favourite program on the 26" flat screen LCD TV.



COLOUR OPTIONS

	Biltmore	Egyptian Sand	English Tudor	Whistler Lodge
Sofa				
Accent				
Captain Chairs				
Carpet				
Bedspread				

Cabinetry	 Ginger Spice Oak Cabinetry Maple Cabinetry
-----------	---

SPECIFICATIONS

INVITATION 2007	A391Q
GVWR – lb. (kg)	31,000 (14 061)
UVW – lb. (kg)	TBD
NCC – lb. (kg)	TBD
Wheelbase – in. (mm)	252" (6 401)
Length – ft. (mm)	39' 4" (11 989)
Width – ft. (mm)	8' 4" (2 534)
Height* – ft. (mm)	12' 4" (3 758)
Water Tank Capacity** – U.S. gal. (L)	102 (386)
Water Heater	10 (38)
Black Holding Tank Capacity – U.S. gal. (L)	57 (216)
Grey Holding Tank Capacity – U.S. gal. (L)	57 (216)
Fuel Capacity – U.S. gal. (L)	100 (379)
Propane Capacity – U.S. gal. (L)	32 (121)
*Includes Air Conditioner **Includes Water Heater	

FLOOR PLAN

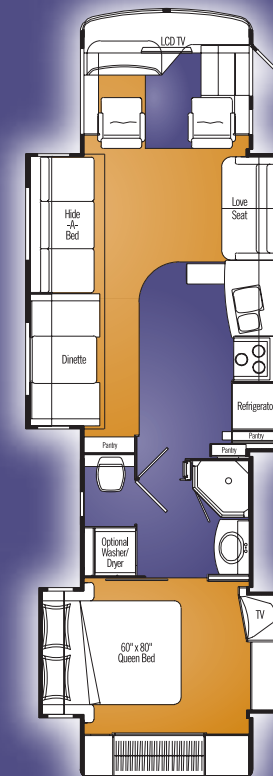

A391Q

Carpet
Laminate



This bathroom features a roomy neo angle shower alongside a well appointed vanity with a wood framed mirrored medicine cabinet and a separately enclosed water closet.

STANDARDS AND OPTIONS

	DISC A9910
CHASSIS AND SUSPENSION	
Air Brakes with Automatic Slack Adjusters	S
Air Suspension with Sachs Tuned Shock Absorbers	S
Alternator 160 Amp	S
Block Heater (1000 Watt)	S
Chassis – Freightliner XC with CAT C7 330 HP/860 ft./lb. Turbo Diesel Raised Rail Rear Radiator with PAC Exhaust Brake	0
Chassis – Freightliner XC with Mercedes MBE 926 330 HP/1,000 ft./lb. Turbo Diesel Raised Rail Rear Radiator with Engine Brake	S
Clutched Radiator Fan	S
Front Air Disc Brakes	S
Fuel Fill – Concealed Locking Fuel Fill Access on Both Sides	S
Hitch – Trailer Hitch Receiver with Wiring and Plug – 1000 lb./10,000 lb.	S
Tires – Radial, 255/80R22.5	S
Transmission – Allison 3000 MH Six Speed Automatic with Lock Up and Transmission Cooler	S
Wheels – Aluminium Wheels (Front and Outer Duals)	S
DRIVERS AREA CONVENIENCES	
Cameras – Side Turn Cameras	0
Cover – Fold-Out Front Step Well Cover	S
Cruise Control	S
Dash Air and Heat – Dual Blower in Steel Cage	S
Mirrors – Heated Remote Power Mirrors	S
Power Sun visors	S
Rearview Camera/Monitor – Black & White Display Mounted in Dash	S
Seat – Optima Leather Driver Captain's Chair with 3-Point Seat Belt and 6-Way Power	S
Seat – Optima Leather Passenger Captain's Chair	S
Steering Wheel – Tilt Telescopic	S
Switch – Battery Boost Switch (coach to chassis batteries)	S
Switch – Battery Selector Switch for Radio	S
Wipers – Wet Arm 28" Windshield Wipers with Intermittent Function	S
VEHICULAR	
Air Horns	0
Bumper – Integrated Steel Reinforced Fibreglass Bumpers	S
Headlights – Halogen Styled	S
Jacks – HWH "One Touch" Automatic Levelling System with Manual Air Dump	S
Light – High Mount Stoplight, LED Long Life	S
Lights – Halogen Automotive Driving Lights	S
Mud Guard – Monogrammed Triple E Rear Mudguard (Stainless Steel on Rubber)	0
Undercoating – Automotive Type	S
CONSTRUCTION	
Baggage Compartments – Lined Floor, Lit	S
Baggage Doors – Aluminium Baggage Doors with Gas Struts and Slam Latch	S
Gelcoat Fibreglass Molded Front and Rear Mask	S
Roof – Domed Kemplite FRP Flexroof	S
Steel Cab Floor, Firewall and Dash Structure	S
Vacuum Bonded Aluminium Framed Insulated Roof Construction	S
Vacuum Bonded Aluminium Framed Insulated Sidewall Construction with Thermal Break	S
Vacuum Bonded Gelcoat Fibreglass Sidewalls	S
Vacuum Bonded Steel Framed Insulated Floor Construction	S
Windows – Tinted Radius Corner Thermal Pane Windows	S

	DISC A9910
EXTERIOR	
Diamondshield® Paint Protection Film on Front End	
Door – Screened Entry Door with Deadbolt Lock	S
Handle – Entry Door Assist Handle (Interior Mounted)	S
Handle – Exterior Assist Handle, Monogrammed	S
Ladder – Exterior Ladder with Detachable Lower Section	S
Lights – Deluxe Patio Light	S
Lights – Side Docking Lights	S
Paint – Full Body Exterior Paint with Clear Coat	0
Step – Electric Retractable Entry Step	S
INTERIOR	
Cabinetry – Solid Maple Cabinet Doors with European Hidden Hinges and Fridge Inserts	0
Cabinetry – Solid Oak Cabinet Doors with European Hidden Hinges and Fridge Inserts	S
Ceiling – Flat with Padded Vinyl Headliner	S
Detectors – Electronic Smoke, LP and CO	S
Drawers – Full Extension Ball Bearing Drawer Tracks	S
Drawers – Slide-Out Drawer Option in Washer/Dryer Cabinet (N/A with Washer/Dryer Option)	0
Fire Extinguisher – Dry Chemical	S
Flooring – Wood Look Laminate Flooring in Galley in Lieu of Linoleum	S
Insulated Vent Covers	0
Keylock Safe Box	S
Latches – Snap Latches on all Cabinet Doors and Drawers	S
Lighting – Courtesy Floor Lamps	S
Lighting – Halogen Lighting in Living Area	S
Shades – Day/Night Pleated Shades in Living Area	S
Slide-Out – Electric Slide, Armoire and Window Seat	S
Slide-Out – Electric Bedroom Slide-Out System	S
Slide-Out – HWH Flush Floor Hydraulic Slide-Out System	S
Slide-Out – HWH Hydraulic Galley Slide (Dinette and Hide-A-Bed)	S
FURNITURE	
Booth Dinette with Slide-Out Drawers	S
Chairs – Two Additional Fixed Chairs	0
Hide-A-Bed – Cloth Hide-A-Bed on Driver's Side	S
Hide-A-Bed – Optima Leather Hide-A-Bed on Driver's Side	0
Love Seat – Optima Leather	S
Mattress – Air Coil Mattress Upgrade on Hide-A-Bed (with 110 Volt Air Pump)	0
Table – Solid Oak Extendable Free Standing Table, 2 Fixed and 2 Folding Chairs	0
GALLEY	
Bi-fold Solid Surface Range Cover	S
Convection Microwave – OTR with Light and 110 Volt Vent Fan with Cooktop and Drawers	0
Countertop – Solid Surface Counter in Galley with Stainless Steel Undermount Sink	S
Microwave – OTR with Light and 110 Volt Vent Fan	S
Range – Recessed 3 Burner Cooktop with High Output Burner and 21" Glass Door Oven	S
Refrigerator – Dometic LP/Electric 9 cu. ft. with Temp Control and Wood Finished Raised Fridge Inserts with Sliding Pantry	S
Refrigerator – 4 Door 12 cu. ft. with Ice Maker LP/Electric, Stainless Steel Finish Doors (deletes pantry)	0
LAVATORY	
Cabinet – Wood Finish Medicine Cabinet with Mirror	S
Porcelain Sink	S
Shower – Fibreglass Enclosed Neo Angle Shower with Glass Enclosure	S
Skylight – Residential Neo Angle in Shower	S
Toilet – Sealand 510, China, Foot Flush with Sprayer	S
Window with Valance and Venetian Blind in Toilet Room	S

STANDARDS AND OPTIONS (CONTINUED)

	A391Q		A391Q
BEDROOM			
Bedspread – Decorative Bedspread and Throw Pillows	S		
Headboard – Fabric Wrapped	S		
Lights – Wall Switched Lights on Ceiling	S		
Mattress – Residential Quality Queen (60" x 80")	S		
Mattress – Upgrade	O		
Shades – Day/Night Pleated Shades with Blackout	S		
Storage – Under Bed Storage Drawer	S		
ENTERTAINMENT			
CD Changer – 10 Stack CD Changer	O		
Satellite Dish – Motosat 18" Executive with DVB Automatic Acquisition and Identification	O		
Satellite Dish – Winegard with Electronic Elevation Sensor	O		
Satellite Radio – Pre-Wire including Satellite Antenna (subscription not included, N/A with AM/FM/CD/Cassette Option)	O		
Stereo – AM/FM CD and DVD Stereo in Bedroom with Alarm Clock	O		
Stereo – AM/FM Weather Band Receiver with Cassette/CD Player with Big Button	O		
Stereo – DHS Mobile Theatre System, 5 Channel Stereo with Subwoofer	S		
Stereo – Exterior AM/FM, CD Stereo with Shielded Speakers	O		
Stereo – Sirius Ready AM/FM Weather Band Receiver with CD Player in Dash with Big Buttons	S		
Telephone and Cable TV Hook-Up – Exterior	S		
TV – AC 20" Flat Screen Colour Stereo with Remote in Bedroom	S		
TV – AC 26" Flat Screen LCD TV with Remote in Overhead Cabinet	S		
TV Antenna – Roof Top Retractable Antenna with Booster, Dash Mounted "Antenna Up" Light	S		
HEATING VENTILATING AND AIR CONDITIONING			
Air Conditioner – Dual Centrally Ducted 13,500 BTU with Heat Strip and Remote Return Air	S		
Fan – Fantastic Non Reversible in Lavatory with Wall Switch	S		
Fan – Fantastic Non Reversible in Toilet Room with Wall Switch	S		
Furnace – Central Forced Air Furnace, 40,000 BTU	S		
Heater – Dual Rear Auxiliary Automotive Heaters with Electric Control Valves	S		
Fan – Fantastic Reversible in Bedroom with Wall Switch	S		
ELECTRICAL			
Batteries – Deep Cycle Coach Batteries, 2 x 6-Volt on Sliding Tray	S		
Bidirectional Isolator Relay Delay (BIRD) Battery Charging	S		
Converter – 120/12 Volt with Charger and Automatic Changeover Relay	S		
Generator – 5.5 KW Onan Quiet Diesel on Slide-Out Tray with Hour Meter in Convenience Centre	S		
Inverter – 2000 Watt Inverter with 100 Amp Charger with Freedom Remote	O		
Inverter – 400 Watt (for Front TV, Bedroom TV, DVD/VCR Combo, Satellite Receiver)	S		
Panel – 50 Amp Electrical Service with Energy Management System	S		
Pre-Wire – 110/12 Volt Receptacles in Baggage Compartment (Freezer Prep)	S		
Pre-Wire for Solar Panel	O		
Pre-Wire for Electric Awning	S		
Receptacle – Patio GFI Receptacle	S		
Switch – Electronic Battery Disconnect (Coach Batteries) above Entrance Door	S		
PLUMBING AND LP SYSTEMS			
Black Tank Flush System	S		
Exterior Shower	S		
Holding Tanks – Enclosed and Insulated, Dual Heated Waste Holding Tanks	S		
LP Tank – Easy Access Propane Tank	S		
Rough-In for Washer/Dryer	S		
Systems Monitor Panel in Convenience Centre	S		
Water Filter – Whole House Water Filter in Utility Module	S		
Water Heater – Electronic Ignition LP/Electric/ Motoraid Water Heater (10 U.S. gal.)	S		
Water Heater By-Pass Valve	S		
Water Tank – Enclosed and Heated Fresh Water Tank	S		
Water Tank Gravity Fill Water Tank	S		
Winterization System with Pick-Up Kit	S		
SYSTEMS			
Central Vacuum with Outlet in Baggage Compartment	O		
Washer/Dryer (vented)	O		
OPTIONAL AWNING PACKAGES			
Manual Awning Package – A&E Oasis Manual Front Door Awning, Weathershield Equipped A&E Elite Slide Toppers, Weathershield Equipped 2 Step (Acrylic, 19')		3	
Power Awning Package – A&E Oasis Power with Remote Front Door Awning, Weathershield Equipped A&E Elite Slide Toppers, Weathershield Equipped Weatherpro Power (Acrylic with Remote and Wind Sensor, 19'), Weathershield Equipped A&E Elite Window Awnings (Main Slide Windows and Bedroom Window)		3	
PACKAGE			
Customer Value Package (Mandatory Option) – CB Antenna – Includes Coax Lead-In under Dash, DVD/VCR Combination Unit, Overhead Blower Fan above Windshield, Reversible Thermostatically Controlled Fantastic Fan in Living Area with Wall Switch, Coordinated Pillows for Living Area, Pre-Wire Satellite Dish (12/110 Volt), Rust Protection			M
Factory PDI			O
S Standard O Optional M Mandatory			



Triple E Recreational Vehicles P.O. Box 1230, Winkler, Manitoba, Canada R6W 4C4 Telephone: (204) 325-4361 Fax: (204) 325-5241 www.tripleerv.com

Triple E Recreational Vehicles meet or surpass CSA-CRVA-RVIA standards covering electrical services, gas services, plumbing services and vehicular safety. Invitation Motorhomes exceed 96" in width. In some states, 96" is the maximum width of vehicles travelling some or all state roads. It is the responsibility of the owner to be familiar with the road usage laws of the states in which you travel. Product improvement is a continuing process at Triple E Recreational Vehicles. Thus, we reserve the right to change specifications on any or all products without prior notice; errors and omissions excepted. Triple E Recreational Vehicles is under no obligation to undertake modification to units manufactured prior to changes on specifications. Brochure pictures may be shown with optional equipment. Colours may not be exactly as shown due to the printing process. Please see your dealer for specific colours.

