

SPECIFICATIONS

Model	FS2600	FS3000
Capacity		
Sleeping	4-8	4-8
Furnace	30k BTU	30k BTU
Fresh Water	110 gal.	110 gal.
Water Heater	6 gal.	6 gal.
Holding Tank Black	35 gal.	35 gal.
Holding Tank Gray	35 gal.	35 gal.
Tire & Load Range	225 75/15 load E	225 75/15 load E
Weights		
Overall Weight	6,820	7,500
Hitch Weight	760	950
GVWR	11,400	12,000
Carrying Capacity	4,500	4,500
Ramp Door Rating	2,500	2,500
Size		
Length	30' 8"	34' 8"
Width	102"	102"
Height	11' 0"	11' 0"
Interior Width	98"	98"

OPTIONS

- » 4KW Onan™ generator and 40 gallon fuel tank

» Fiberglass exterior (hand-laid gel coat)

» 40 gallon fuel station w/ road side pump system

» Dual picture windows and captain swivel rockers

» Kicker™ sound system w/exterior controls

» Mega dinette w/flip over back rest & connecting pillows

» Spare tire and under-chassis mount

» Bal stabilizer jacks (2-4)

» Flat screen TV, DVD player, & lift storage
- » Curbside flood lights (2)

» Coin seal floor covering—cargo & ramp

» Roof rack and retractable ladder

» Rear ramp roll up drape w/ window

» Pre-wired for game system

» Aluminum wheels w/ matching spare tire

» Heat pads for water tanks

» Inverter system—(12v to 110v)

» Locator flag & pole

» Multi-state dot tags

» CSA (Canada)

» Outside speakers

» Roll over sofa

FEATURES

CHASSIS

- » Wide body—(98" interior width)
- » Beaver tail—5/22
- » Low profile—(low ramp angle)(low cg)
- » Steel radius Zero gravity—rear ramp w/hidden springs and hinges (w/2,500 lb per axle rating (5,000 lb vehicle)
- » I-beam chassis main rails w/full depth cross members
- » All steel grid floor support
- » Elect tongue jack heavy duty w/work light and manual override
- » Protected tail lights
- » 5200 lb spring drop axles w/heavy duty brakes
- » Chrome wheels w/metal stems & over-rated radial tires
- » Grease fittings to maintain bearings
- » Grease fittings to maintain suspension
- » Internal axle brake wires—protected
- » Curb side fresh water pump draw
- » 1 ½ quick—fresh water tank drain
- » Green algae-resistant fresh water tanks
- » Stainless-tipped radius entry step

EXTERIOR

- » All LED exterior running lights
- » Automotive baked enamel aluminum exterior
- » Radius windows, compartment doors
- » Designer entry door features pad/kick & stainless strip
- » Designer fenders & LPG tank cover
- » Tribal blue/black graphics
- » Custom front aluminum rock guard
- » Designer hitch features (chrome tips)
- » Low profile, lower center of gravity for fuel efficiency towing
- » AGE™ Awning

INTERIOR

- » 98" interior width (wide body)
- » Walk in & around bed w/privacy curtain
- » Clothes hamper w/exterior access & removable carpet
- » Radius walls in bed, bath & lav
- » Designr window coverings and accents
- » Bedroom includes heat, ventilation, privacy, lighting & storage
- » Hollow core cabinet construction
- » Private bath
- » 80/20 shower pan/tub combo
- » Durable retracting shower door & deluxe shower head
- » Porcelain toilet & dual TP roll holder
- » Bathroom includes heat, ventilation, privacy, lights & storage
- » Private shower/toilet & hallway lav station & medicine cab
- » Lighted closets

GALLEY & CARGO AREA

- » Designer area overheads w/vinyl inlays & struts
- » Designer galley overhead w/open shelf storage
- » Flush stove and sink cover w/deluxe pull out faucet
- » Extra large galley window and blind
- » Slide out pantry and extra deep galley drawer
- » Corner galley counter space
- » Reversible dinette tables (games or dinner)
- » Convertible dinette cushions & beds w/table storage
- » Full dinette skirts w/designer accents
- » Removable carpet w/bordered edges
- » Fabric day shades w/designer window boxes
- » Double queen beds w/privacy curtain & designer accents
- » Living room heat, ventilation, privacy, lights & storage

APPLIANCES & MISC

- » 6cu ft double door 2-way full auto refer (gas & 110V)
- » Electronic ignition & gal quick recovery water heater
- » 30,000 BTU ducted thermostat controlled furnace
- » Built in convection microwave oven
- » 3 burner flush mount covered cook top
- » 30 amp high output converter battery charger
- » 15,000 BTU thermostat controlled air conditioner
- » Control/panel w/ functions, features & monitoring
- » Stereo Head Unit/CD player (exterior speakers & switches optional)

OTHER

- » Integrated construction w/hi-tensile glue bonds
- » Hollow core walls cabinets and partitions
- » All screw and lag bolt assembly
- » Trussed double seal roof
- » Flush steel mounted tie downs
- » 30 amp auto reset circuit breaker for brake system
- » Trailer break away—brake switch
- » Trailer running lights manual on switch
- » Circulation gaps in headers (allows heat and A/C to flow)
- » Wired for satellite system, cable, and local TV
- » Flush mount glass ceiling and cabinet lighting
- » Magazine rack
- » Exterior hot & cold water station & dump hose carrier
- » One piece rubber roof w/ backing
- » Twin 55 gallon fresh water tanks
- » Twin 5 gal LPG tanks (exchange ready)



THE TOY HAULER LEGEND RETURNS



*Manufacturer's Notice: All weights, measurements, specifications, equipment, models and prices subject to change without notice due to continual product improvements and availability of components. Production of all models subject to seasonal scheduling. Extreme Warrior RVs, LLC reserves the right to improve models without incorporating these changes in similar models produced at an earlier date. Consult your automobile dealer and your recreational vehicle dealer to assure the proper match between tow vehicle and trailer. Tow vehicle and recreational unit must be properly equalized for efficient product performance and safety. Before you purchase your recreational vehicle, carefully consider the number of people it will accommodate and it's end use. For winter travel below 25° F or summer travel 100° F or higher, consult your dealer for appropriate additional equipment to make your travel accommodations more comfortable. Manufacturer's load capacity restrictions and recommendations must be followed for safe and efficient product performance. All RV manufacturers are required to build to the national RVIA standard/code for recreational vehicles. If RVs are to be used for purposes other than recreational use, your RV dealer should be consulted for any additional appropriate equipment or accessories, such as storm windows or other types of upgrades.

710 W. Simplot Blvd. | Caldwell, ID 83605

(208) 806-0243

www.ExtremeWarrior.com

Your Authorized Extreme Warrior Dealer



FLOOR PLANS

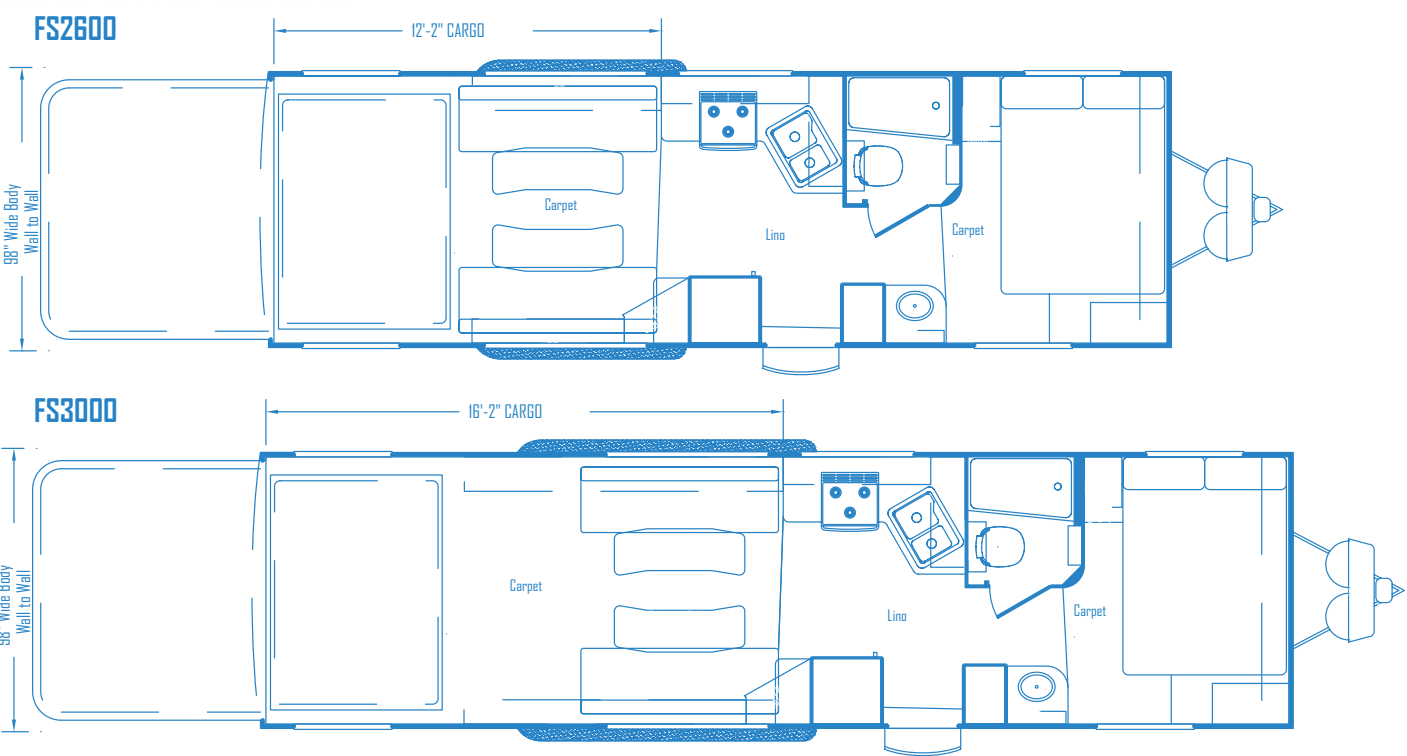

OPTIONAL CONFIGURATIONS

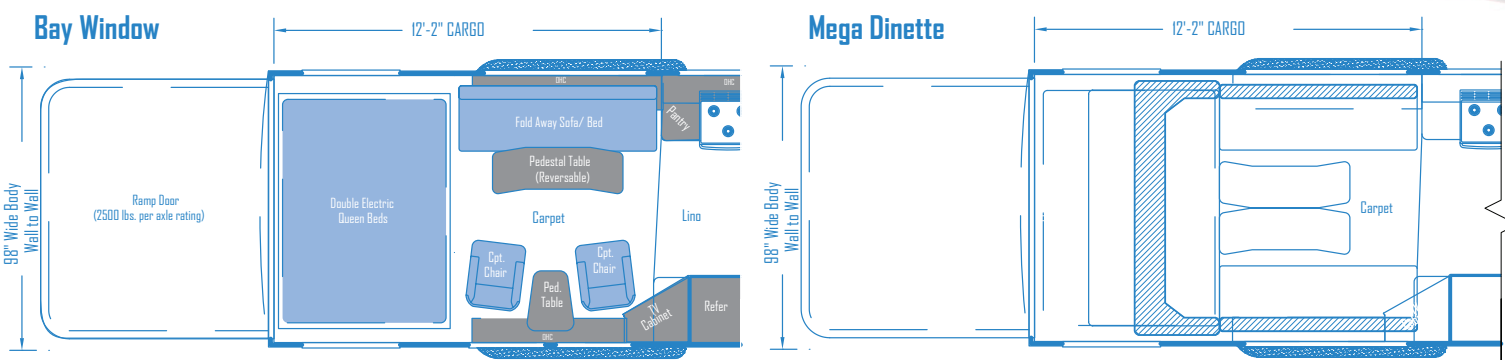

INTRODUCTION

My name is Mark Warmoth, and after 2 ½ years, I have started to build trailers again! I still have the passion to build the best product available, with fresh lessons in life, business, and humility. I am of healthy mind, and motivated to do the kind of business, that will reassure you, my customers, as well as the business community, of my resolve, and my continued commitment to excellence & integrity.

We are now Extreme Warrior,™ and I promise to build trailers that exceed your expectations, to only do business with other companies & people that do the same, to keep innovating and refining the products, to make them more affordable, more dependable, and the highest in resale value. We have the burning desire to build and to be the best, and in the process, I want to do the things that make all our lives a little better. In essence, “We are here to serve our families by serving your family.”

THANK YOU

First off—thank you—for everything—I couldn’t be more proud of the brands we built and the relationships we have developed. I have witnessed firsthand, the extreme ups and downs of business, and life in general. “From zero to hero and back to zero” again—what a great country we live in! I am a better person for the journey and hopefully a better business man. For those customers or businesses that got caught up in my wake, when we so suddenly closed, I am truly sorry and would love to hear firsthand your stories.

I do understand the principles that made Warrior the amazing company it was, and the mistakes I made that caused the kinks in what seemed like flawless armor. To my customers—thank you from the bottom of my heart. All that warrior ever was I owe to you, to the vendors that helped us, and to the dealers that took care of the warrior customers after we were forced to close our doors. I look forward to hearing those stories as well.

THE NEW TRAILER

When I built the first Warrior in 1988, I had over 14 years of experience building RVs, and now, 35 years of experience. The new generation of Warriors is a team effort with some of the most experienced people in the industry, each of us over 30 years. We have, from the ground up, and with pain staking scrutiny, chosen each and every item that makes up the new generation of trailers—every component, and every feature. The new generation of Warriors are well thought-out, affordable, comfortable and dependable, hand-built with care, and Warrior’s signature attention to detail and style. My desire is to recapture the best of the best, offering only the most popular models and only working with dealers known for their family atmosphere and attention to customer service. I want to build the company lean & streamlined, and take all the extra effort and pour it into product refinement and customer satisfaction. If there is a perfect trailer—affordable, dependable comfortable, and with high resale value, this is it. The new Extreme Warrior.™

For monthly (Warrior News) past, present and future, leave your email at: www.warriormfg.com

Mark Warmoth
-Mark E. Warmoth
(Founder & CEO-Weekend Warrior™ Trailers, 1988-2008)
General & Product Consultant Extreme Warrior