

# FUN FINDER X

Ultra-Lightweight

by CruiserRv



Best of  
the Best

Let the  
Fun Begin



Just Got Better



*X210WBS*

Enjoy comfort on the go with coordinated décors that set the stage for good times and lasting memories.



Attention to detail is one of the many things that sets Fun Finder X apart. From the stainless appliances to upscale interiors, the X is clearly a notch above!

*X189FBR*





The jack-knife sofa sleeper adds space for an overnight guest while providing a comfortable sitting area by day.



A queen sized walk-around bed with upgraded mattress and down comforter also lifts up to offer great under bed storage.

Our Contemporary cabinetry, adds just a touch of the "Euro" look and surrounds you with beautiful contrasting wood tones.



# FUN FINDER X



All dinettes are easily converted into sleeping areas, allowing you to maximize all space.



Our ever-popular Harmony White cabinetry is the perfect backdrop for your choice of décor color. Our front dinette models convert into true 60" x 80" queen beds.

X139

# Construction/Aerodynamic Features

## The Fun Finder X Advantage

Cruiser RV has designed our lightweight travel trailers to be towable by today's lighter weight trucks and SUVs.

Our narrower and lower design, plus a sweeping aerodynamic front profile all help minimize excess wind drag which means greater fuel economy for you.

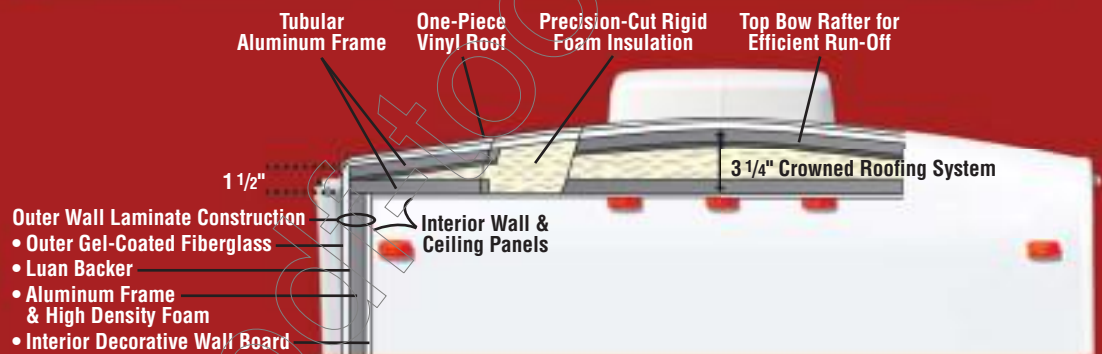

The narrower seven-foot-width also eliminates the necessity for extended width side mirrors adding comfort and safety to your travel.

### Walls

1. Gel coat fiberglass
2. Luan wood backer
3. Polystyrene block foam insulation
4. Luan wood backer
5. Decorative wall vinyl
6. Tinted safety glass windows

### Roof

7. One piece felt-backed vinyl membrane
8. Luan wood decking
9. Aluminum truss rafters
10. Solid block foam insulation
11. Luan wood backer
12. Decorative ceiling vinyl

### Floor

13. One piece residential grade linoleum
14. 5/8" tongue and groove plywood
15. R7 fiberglass batten insulation
16. 1 1/2" aluminum frame stringers on 16" centers
17. Darco underbelly wrap
18. Powder coated 6" solid I-beam frame
19. Frame mounted roto-cast holding poly-tanks
20. Galvanized wheel wells



*Cut-A-Way*

**The Leader in Lightweight Aerodynamic Recreational Vehicles**

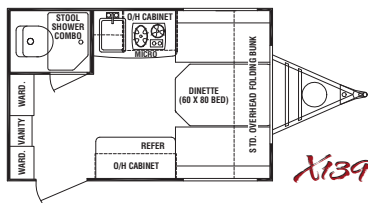

X139

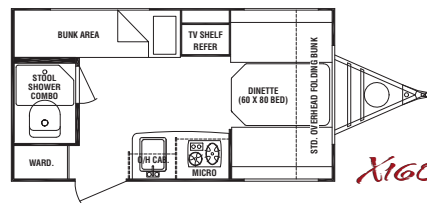

X160

Model Coming Soon

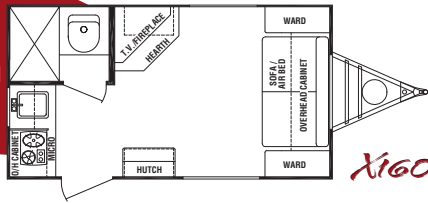

X160FS

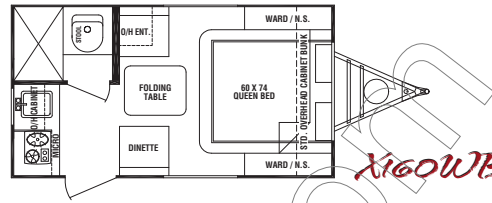

X160WB

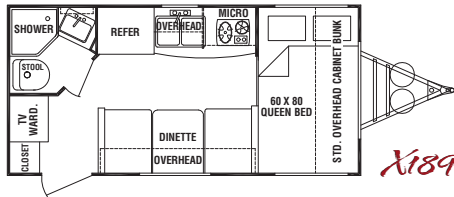

X189FBR

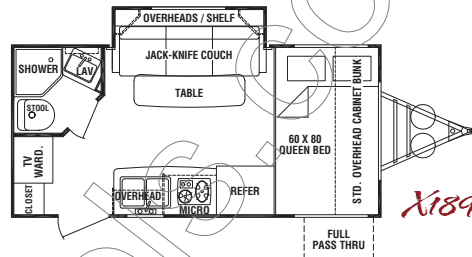

X189FBS

Model Coming Soon

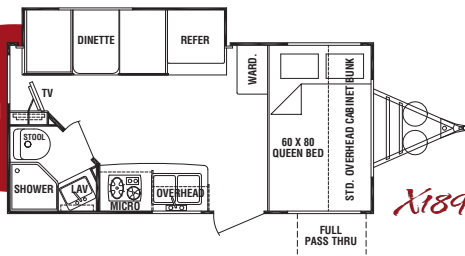

X189FDS

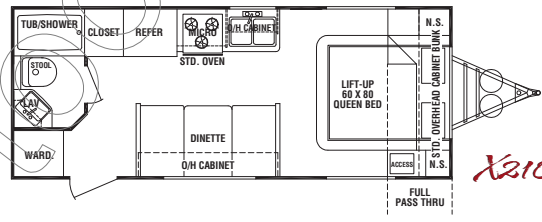

X210

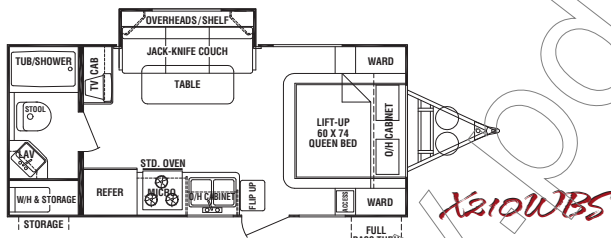

X210WBS

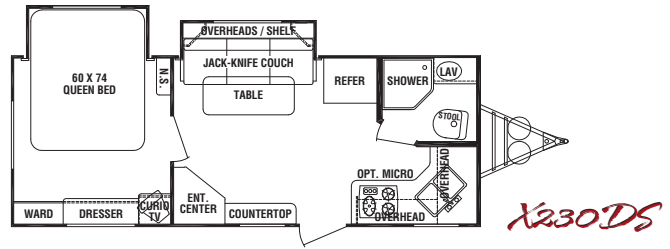

X230DS

Fun Finder X	X139	X160	X160FS	X160WB	X189FBR	X189FBS	X189FDS	X210	X210WBS	X230DS
Exterior Length	14'9"	16'6"		16'11"	18'3"	18'9"		23'6"	21'9"	24'7"
Exterior Width	84"	84"		84"	84"	84"		90"	90"	90"
Exterior Height	8'2"	8'2"		8'2"	8'2"	8'2"		8'4"	8'4"	8'4"
Interior Height	6'4"	6'4"		6'4"	6'4"	6'4"		6'4"	6'4"	6'4"
Bed Size	N/A	N/A		60 x 74	60 x 80	60 x 80		60 x 80	60 x 74	60 x 80
Dinette Bed Size	60 x 80	60 x 80		N/A	33 x 72	N/A		40 x 72	N/A	N/A
Gaucha/Couch Size	N/A	N/A		N/A	N/A	35 x 66		N/A	35 x 66	35 x 66
Axle Weight (lbs.)	2,038	2,308		2,293	2,748	3,113		3,385	3,355	3,710
Hitch Weight (lbs.)	215	220		290	260	255		260	375	650
Dry Weight (lbs.)	2,253	2,528		2,583	3,008	3,368		3,645	3,730	4,360
GVWR (lbs.)	3,315	3,320		3,390	5,860	5,855		5,860	5,975	6,250
Cargo Capacity (lbs.)	1,062	792		807	2,852	2,487		2,215	2,245	1,890
Fresh Water Tank (gal.)	25	25		25	25	25		36	36	36
Gray Water Tank (gal.)	32	32		32	32	25		38	38	40
Black Water Tank (gal.)	25	25		25	25	25		38	38	25
LP Bottle (lbs.)	20	20		20	40	40		60	60	60
Power Converter (amps)	35	35		35	55	55		55	55	55
Elect. Ign. Furn. (BTUs)	16K	16K		16K	16K	16K		20K	20K	20K

For specs on this model check out [www.cruiserrv.com](http://www.cruiserrv.com)

For specs on this model check out [www.cruiserrv.com](http://www.cruiserrv.com)

\*Cargo capacity does not include weight of water or LP gas.

**NOTE:** Weights are approximate and based on standard features. Optional equipment is not included. Cruiser RV, LLC constantly strives to improve its product. All specifications are subject to change without notice or obligation. See your local Cruiser RV dealer today to review a current model.

# Décors



Carbon Stone



Platinum



Bon Fire Blaze

# Interior Features



Upgraded mattress with down comforter



Box valances with night shades



Attractive clock



In-ceiling speakers



Optional flatscreen TV



CD/DVD stereo with i-Pod hookup



Optional stainless steel microwave



Stainless Steel Refrigerator Front



Oven



Roller bearing drawer guides



Hidden hinges



Cabinet bunk

# Exterior Features



Waterproof speakers and optional awning



Above floor slideout with storage door



Front window with rockguard



Double step entry step



Front diamond plate rockguard



Keep the mess outside with this handy outside spray-away hose.



Detachable 30 amp power cord for easy storage.



Optional Flatscreen TV on swivel bracket allows for exterior viewing (210WBS only)



Optional stainless steel BBQ grill



Pass-Thru storage



Dependable Equa-Flex<sup>®</sup> suspension by Trail-Air<sup>®</sup> delivers a smooth ride.



Cast aluminum wheels with radial tires

# FUN FINDER X

Your Dealer

## Cruiser RV, LLC

7805 North SR 9 • PO Box 130 • Howe, IN 46746

Ph. 260-562-3500 • Fax 260-562-2210

Toll Free 866-277-5630

[www.cruiserrv.com](http://www.cruiserrv.com)

MEMBER  
RVIA