

YOU ONLY LIVE ONCE.
BUT DONE PROPERLY, ONCE IS ENOUGH.



2007
PACE ARROW
CLASS A GAS

 **FLEETWOOD**

Luxurious Styling | Revolutionary Full-Wall Slide | Power Platform Construction | Finest Furnishings | Upscale Cabinetry



Pace Arrow 36D shown in Obsidian interior décor with Plantation Cherry wood finish.



- **A COMPUTER WORKSTATION**, integrated into the dash, makes e-mail a virtual reality. Just add a laptop. Includes a 12V, 120V and telephone outlets.



- **THE DRIVER'S AREA** is equipped for long-haul comfort with an Ultraleather™ captain's chair and power controls. With cup holders, dash fans and swiveling sun visors, everything you need is within reach.



- **THE PASSENGER AREA** makes the co-pilot job even more fun. It contains a drawer for supplies, a cup holder for drinks, a rack for magazines, and storage for maps for those times the pilot refuses to ask for directions.



PACE ARROW



THE “GREAT WIDE OPEN” IS NOW BETWEEN YOUR MASTER SUITE AND THE STEERING WHEEL.

When the entire 23-foot full wall slide-out is extended, you’ve got an amazing 340 square feet of space to explore inside your Pace Arrow 36D. This engineering marvel is just one more reason why the Pace Arrow has captured America’s heart and soul. Others appreciate the unrivaled luxury of the furnishings and drop-dead gorgeous interior décor. Or, the new Power Platform Plus chassis (select models) that provides unrivaled storage space. Whatever their reasons, many people aspire to own a Pace Arrow – has your time come?

- **THE ENTERTAINMENT AREA** may become your favorite spot, even when you’re not traveling. The swivel chairs sit near the overhead entertainment area, featuring a 26" flat screen LCD TV, hooked up to a home theater sound system.





○ **THE OPTIONAL DINETTE** is the spot for a feisty game of cards, dinner for four, or sightseeing out the big picture window.



○ **THE PANTRY WITH PULL-OUT BASKETS**, located underneath the galley counter, puts food at your fingertips. No more rummaging for your midnight snack



PACE ARROW

IT'S LIKE JULIA CHILD MEETS LEWIS & CLARK.

The Pace Arrow caters to gourmet cooks who blaze new trails in the kitchen and on the road. The spacious, well-appointed galley boasts the finest name brand appliances and solid surface countertops. And the upscale cabinetry features the natural grain of wood on raised panel doors. It's worthy of a picture postcard by itself.



- **THE LARGE STAINLESS STEEL REFRIGERATOR** by Dometic® holds 12 cubic feet of food and an icemaker that's always ready for cocktail hour.



- **THE STAINLESS STEEL SINK** features two extra-deep bowls, a single-lever Moen® faucet with a sprayer, and a soap dispenser. Because the sooner you finish the dishes, the more time you'll have for socializing.



- **FULL EXTENSION DRAWERS** slide out all the way to provide room for all your pots, pans and anything else you need to store.





SO LUXURIOUS, YOU ALMOST EXPECT A MINT ON YOUR PILLOW EVERY NIGHT.

For pure indulgence, simply walk to the rear of your Pace Arrow to your private suite. Enjoy your 20" flat screen LCD TV, or the soothing spray of your showerhead adjusted just for your height. It's a great place to end the day. And start a new one. But just remember, there's no maid to make your bed.



- **THE GLASS-ENCLOSED SHOWER** features an adjustable showerhead and a skylight, so you can shower with hot water and natural sunlight.



- **THE BATHROOM** offers every amenity to pamper yourself. You'll enjoy the large, sparkling mirror and the curvaceous solid surface vanity top.



PACE ARROW



- **THE BEDROOM WARDROBE** is sizable enough for any clotheshorse. The wardrobe is lined with cedar to keep clothes fresh and moth-free.



- **20" Flat Screen LCD TV** is positioned perfectly for watching in bed, where you can cuddle up in the softest of sheets for pure decadence.



- **THE WASHER/DRYER COMBO** (available on select models) makes collecting quarters a thing of the past. It's cleverly hidden in a bedroom cabinet.

EVEN THE EXTERIOR MAKES A STATEMENT.

With incredible full-body paint standard and stylish exterior graphics, Pace Arrow makes a big impression.

A 2-STAGE DUPONT® PAINT PROCESS is carefully applied for maximum durability and a sleek exterior look. This process helps to ensure only the best in quality and appearance.

STORAGE COMPARTMENTS are lighted and include single paddle latches, gas-lift strut supports, stainless steel hinges, and insulated aluminum doors.

TUFF-PLY ROOF is UV resistant, durable, easy to clean, and doesn't scratch like many competitors' fiberglass or aluminum roofs.

TUFF-COAT® EXTERIOR FIBERGLASS SIDEWALLS are Vacu-bonded® into a strong composite structure, as opposed to competitors' thin fiberglass laminate.

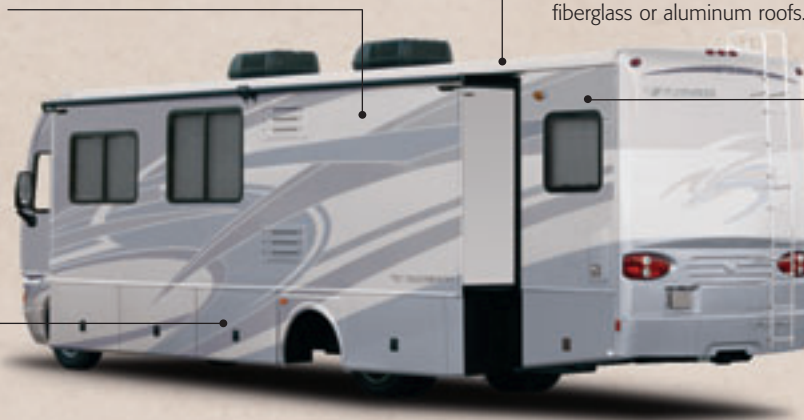

Vehicle shown in Shalestone full-body paint.



○ **THE DRIVER'S DOOR** has convenient steps so you can gracefully enter the cockpit.



○ **THE EZ STORE COMPARTMENT** lets you store lots of bulky, oversized items, and easily access them, even with the slide-out. See, you can take it with you!



○ **DISTINCTIVE TAILLIGHTS** warn tailgaters before it's too late. And they're visible even when towing most types of vehicles.



○ **THE REAR VISION CAMERA** takes the fear out of reverse. It features a live video feed to the driver's area to help you back up safely. Suddenly, your travel world is expanded to more than just pull-through sites.



○ **THE TEMPERATURE GAUGE AND COMPASS** are crucial navigational tools, even if you're going wherever the road takes you.

THE POWER PLATFORM. BECAUSE YOU HAVE A LOT RIDING ON THIS.

Fleetwood's patented Power Platform begins with two 10-inch steel I-beams welded to the chassis, with steel outriggers. Together, they create a basement for the fluid tanks and storage, while supporting the floor, walls and roof with a rigid metal frame. This complements the chassis to make it even stronger.

HOLDING TANKS are enclosed between the upper and lower basement floors so they can be heated in cold weather to help prevent freezing.

BASEMENT STORAGE features aluminum doors, lined with molded plastic so you can hose the compartments out. They are also individually lit for after sunset.

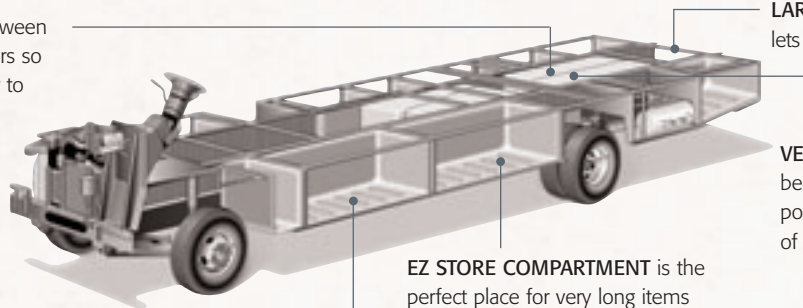

LARGE TOWING CAPACITY † lets you tow most vehicles with ease.

VEHICLE STABILITY is enhanced because the holding tanks are positioned in the bottom center of the platform.

EZ STORE COMPARTMENT is the perfect place for very long items such as fishing poles or ladders. It moves with the slide-out so you don't have to stoop underneath.

† The chassis manufacturer recommends the installation of a supplemental brake control system to activate the brakes on the vehicle or trailer you are towing. Hitch receiver ratings expressed are maximum for the hitch receiver installed and may require the purchase of additional equipment that is dependent on the weight of the towed load. Consult with hitch receiver manufacturer for further information.

STRENGTH AND EVEN MORE STORAGE. THAT'S OUR POWER PLATFORM **PLUS.**

Our Power Platform Plus construction delivers the best of both worlds — an ultra-strong chassis along with a ton of storage space. We carved out every available space for extra storage, and reinforced the framing around the storage areas. Each storage area is lined with molded plastic so it can be hosed out easily, and individually lit so you can retrieve your gear after dark. The Power Platform Plus (available on select models) delivers all the benefits of the Power Platform, plus:

PASS-THROUGH STORAGE COMPARTMENT maximizes every inch of space so you can store large bulky items, such as folding tables. The pass-through design allows you to take your gear out from either side.

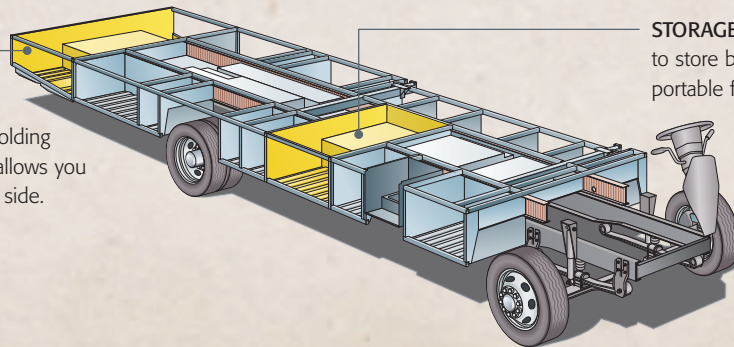

STORAGE MAXIMIZER is another great place to store bulky items such as folding chairs or portable fire pits.

Drawings are for illustrative purposes only to highlight aspects of motor home construction. Actual motor home design depends on model and is subject to change.



INTERLOCKING FLOOR-TO-SIDEWALL CONNECTION locks tightly to keep out water, dust and noise, and helps eliminate squeaks and rattling.



INTERLOCKING CEILING-TO-SIDEWALL CONNECTION helps keep the box square. This ensures a proper cabinet fit.



VACU-BOND® SIDEWALL CONSTRUCTION creates a strong, weather-resistant structure. All sidewalls, floors and ceilings are vacu-bonded to a durable steel or aluminum frame.

FIVE PAINT CHOICES.

Mix and match any full-body paint exterior with any interior combination to customize your Pace Arrow.



GOLD RUSH



IRON



PLATINUM



SHALESTONE



WHITE PEARL

FOUR INTERIORS, THREE WOOD FINISHES, THE CHOICE IS YOURS.

When it comes to sheer beauty, the Pace Arrow is second to none inside. You'll have a hard time choosing from the four deluxe interior décor motifs, and three wood finishes.

OBSIDIAN

LIVING/DINING ROOM



Throw Pillows & Dinette Cushions

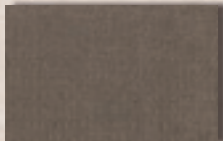

Sofa, Recliner & Dinette Cushions



Ultraleather™ Driver/Passenger Seats and Optional Sofa & Recliner

BEDROOM

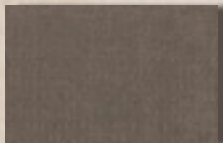

Headboard

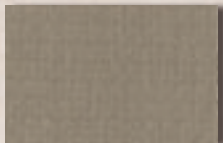

Bedsread

TIGER EYE

LIVING/DINING ROOM



Throw Pillows & Dinette Cushions

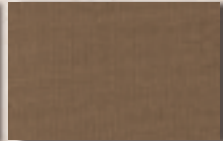

Sofa, Recliner & Dinette Cushions

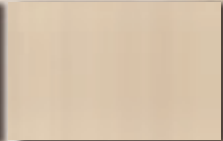

Ultraleather™ Driver/Passenger Seats and Optional Sofa & Recliner

BEDROOM

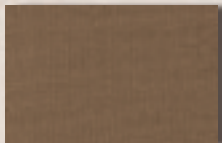

Headboard

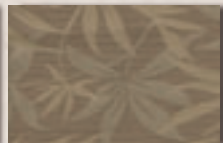

Bedsread

PEWTER

LIVING/DINING ROOM

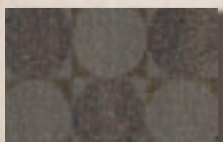

Throw Pillows & Dinette Cushions

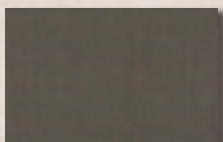

Sofa, Recliner & Dinette Cushions

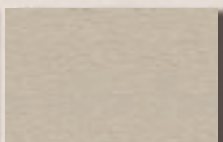

Ultraleather™ Driver/Passenger Seats and Optional Sofa & Recliner

BEDROOM



Headboard

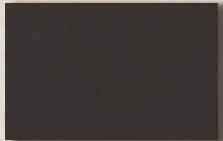

Bedsread

TAUPE

LIVING/DINING ROOM



Throw Pillows & Dinette Cushions

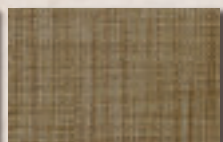

Sofa, Recliner & Dinette Cushions

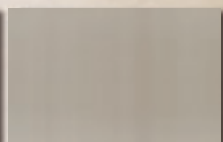

Ultraleather™ Driver/Passenger Seats and Optional Sofa & Recliner

BEDROOM



Headboard



Bedsread

INTERIOR WOOD FINISHES



Plantation Cherry

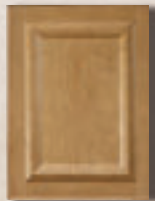

Summit Ash

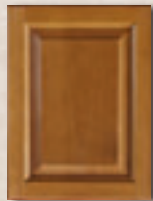

Windsor Birch

WHY FLEETWOOD?



PASSION

We're truly passionate about the RV lifestyle. Fleetwood was founded by RV enthusiasts, and that tradition continues today.



QUALITY

There's no cutting corners. Skilled craftsmen build every Fleetwood RV for maximum durability and longevity.



SERVICE

Help is nearby. When you need an upgrade or repair, you'll find facilities all across North America and more than 1,100 dealers ready to assist you.



WARRANTY

Breathe easier with RV Ownercare, one of the best warranties in the industry. See your Fleetwood dealer for details.



TRUST

More people trust Fleetwood. After all, we've spent over 50 years perfecting RVs, earning the loyalty of generations of RVers.

PACE ARROW FLOOR PLANS

33V

Double Slide-Out

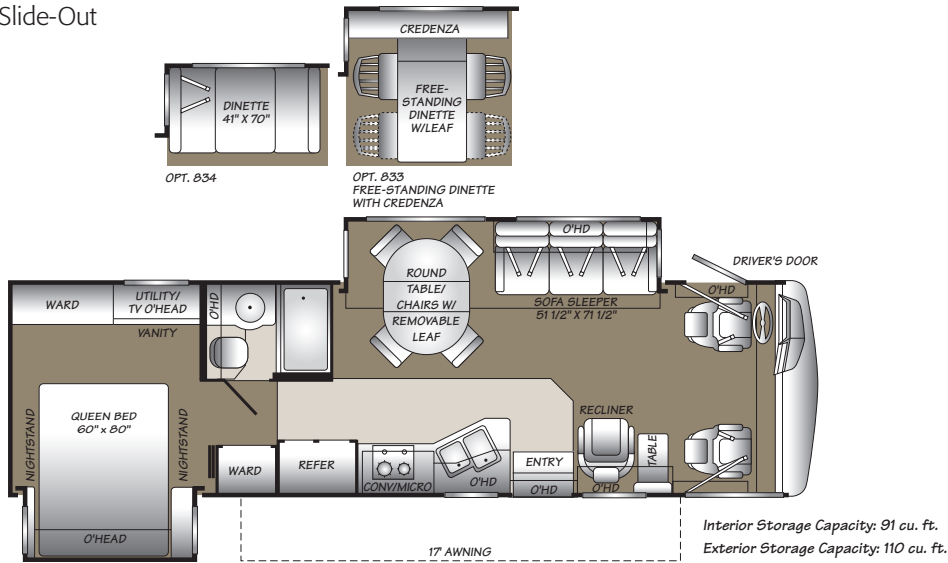

35A

Triple Slide-Out

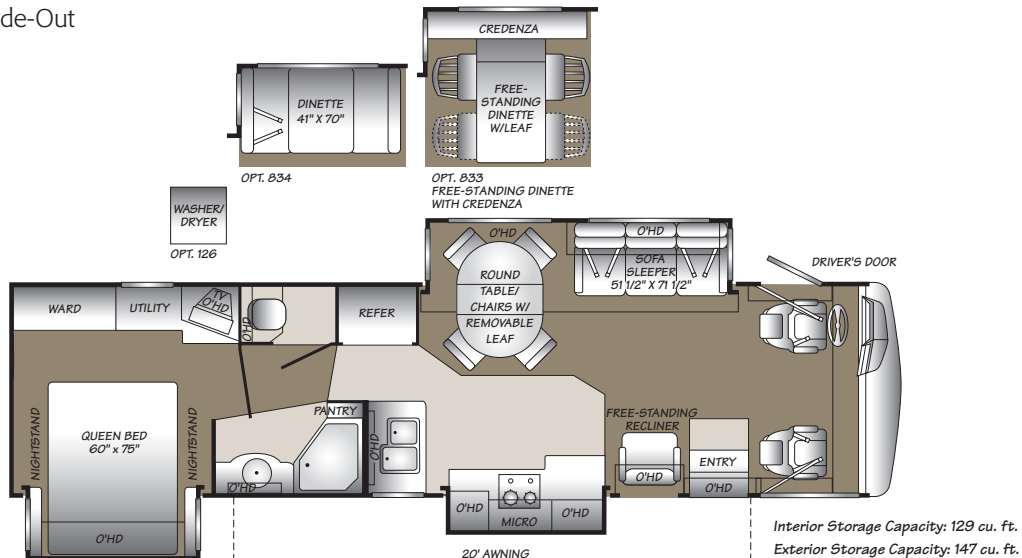

Seat belt configuration may vary depending on options chosen.

36D

Featuring A Full-Wall Slide Double Slide-Out

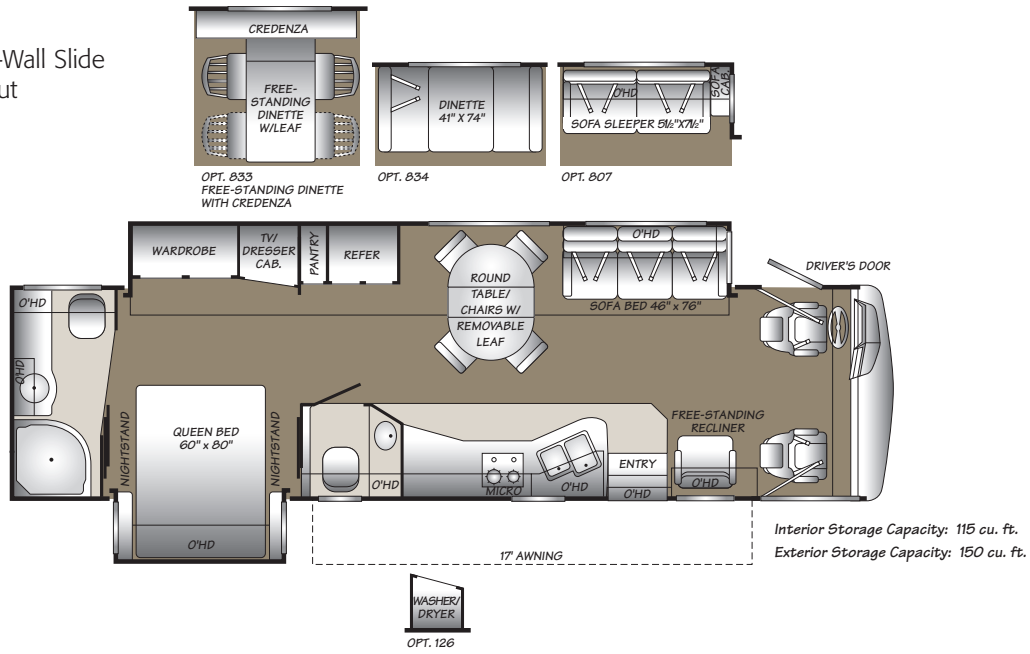

37C

Triple Slide-Out

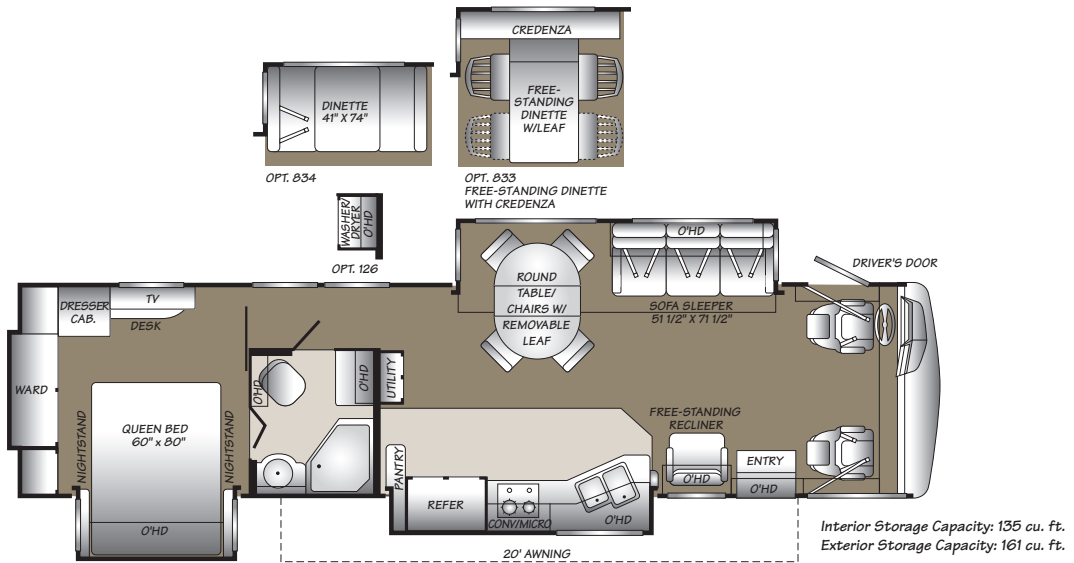

38P

Triple Slide-Out

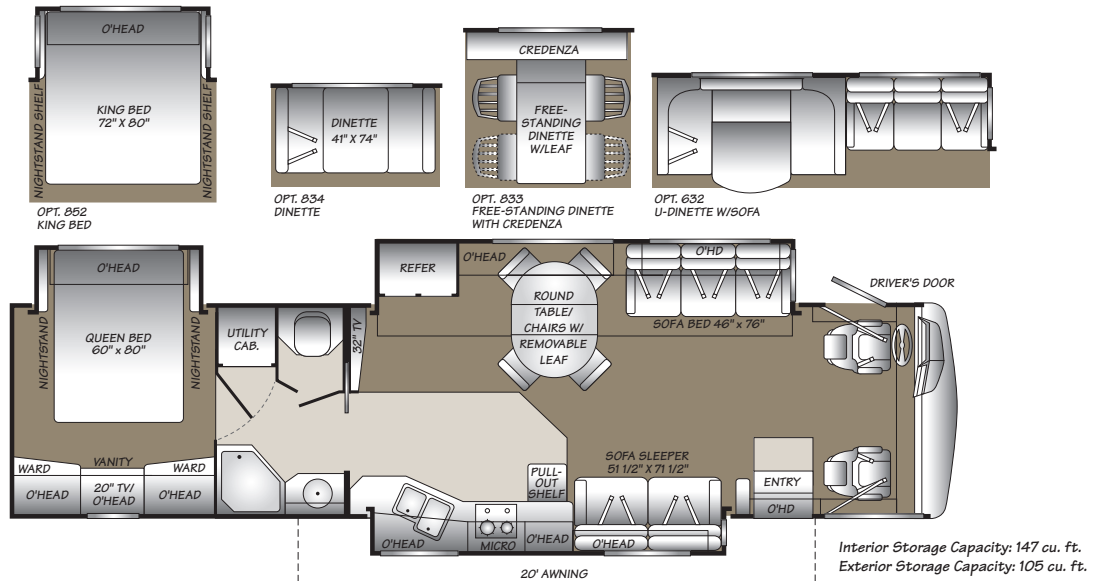

Standard Features & Options

INTERIOR

INTERIOR – THROUGHOUT

- 10-Gallon Quick-Recovery Water Heater w/Direct Spark Ignition (Gas/Electric) S
- 120V/12V AC/DC Converter Central Electrical Panel S
- 20,000/30,000 BTU Dual Furnaces (36D, 37C, & 38P) S
- 3-Way Water Pump Switch S
- 4 Striking Interior Theme Décor S
- 5.5kW Onan® Quiet Generator S
- 50 AMP Service S
- **Alder-Stained Drawer Fronts & Raised Panel Cabinet Doors, Arched Designs** S
- Armstrong® Solarian® Vinyl Floor Covering S
- Automotive Wire Harnesses S
- Battery Disconnect System S
- Brushed Nickel Finish Cabinet Hardware S
- Centralized Monitor Panel w/Slide-Out Controls S
- Décor Lighting S
- **Deluxe Roller Bearing, Full Extension Drawer Guides & Transit-Ship Locks** S
- Dual 6V/Deep-Cycle House Batteries S
- **Dual Roof A/C High Efficiency w/Solar Panel and Chill Grills** S
- Engine Cover Convenience Tray S
- Fabrica® Nylon Carpet w/Pad S
- Fluorescent Ceiling Lights w/Dual Bulbs S
- Incandescent Lighting S
- Solid Divider Doors S
- Telephone Jack in Dash S
- Vinyl Ceiling, Cushioned S
- Wall Switches S
- Water Heater Bypass S
- **Whole Coach Water Filtration System** S
- Wood Drawers S

DRIVER CONVENIENCE

- 3-Point Seat Belts at Driver & Front Passenger Seats S
- **AM/FM Radio w/CD Player, Satellite Radio Ready** S
- Auto A/C Heater Combo S
- Auto Locating Satellite Dish S
- Auxiliary Start Circuit S
- Computer Workstation in Dash S
- Cruise Control S
- Dash Fans S
- Denso® Intermittent Wiper Controls S
- Digital Compass & Outside Temperature Gauge S
- Double Swivel Sun Visors w/Map Pockets S
- Driver's Door w/Power Window Lift S
- **Driver/Front Passenger Ultraleather™ Captain's Chairs w/Reclining Back/Slide Controls w/Power Driver Seat** S
- DSS Manual Lift Satellite Dish S
- ICC Switch S
- Low Profile Engine Cover S
- Radio Switch-Main/Auxiliary Power O
- Sirius® Satellite Radio O
- Tilt Steering Wheel O
- Driver/Passenger Shades w/Electronic Sun Visor O

LIVING ROOM

- **26" LCD TV in Front Overhead** S
- Dual Glazed Slider Windows w/Day/Night Shades S
- **DVD Home Theater Sound System** S
- Flush Floor Living Room Slide-Out S
- Free-Standing Reclining Chair w/Security Bracket S
- TV Antenna S
- Ultraleather™ Furniture w/Throw Pillows O
- Sofa Sleeper (W/36D) O

GALLEY

- **12 cu. ft. Stainless Steel Dometic® Refrigerator w/Ice Maker** S
- Solid Surface Countertops S

- Built-In Galley Cutting/Bread Board (Select Models) S
- Coffee Maker S
- Free-Standing Dinette Table w/Leaf & Four Chairs (2 Folding Chairs) S
- Ironing Board Conveniently Slides into Galley, Stores Under Bed (Select Models) S
- **Large Double Stainless Steel Sink** S
- Mirrored Galley Backsplashes S
- Over the Range Convection Microwave Oven, Stainless w/Built-in Rangehood & Light S
- Radius Corner Cabinetry S
- Single Lever Moen® Galley Faucet w/Pullout Sprayer S
- Soap Dispenser S
- Solid Wood Dinette Table Tops S
- Waste Basket S
- Fan-Tastic® Power Roof Vent S
- 2-Burner Cooktop with Sealed Burners S
- Fixed Dinette w/Solid Wood Table & Ultraleather™ High Resiliency Foam Cushions O
- Free-Standing Dinette w/Credenza O
- Slide-Out Dinette Bins w/Optional Fixed Dinette O

BEDROOM

- **20" LCD TV** S
- Bedspread w/Deluxe Fabric Headboard S
- Rear Speakers S
- **Restonic® Deluxe Pillow Top Innerspring Mattress** S
- Second Phone Jack S
- Wardrobe Lighting S
- Wardrobes w/Mirrored Doors, Cedar Lining & Wire Shelf S
- Washer/Dryer (Select Models) O
- Queen Bed Air Mattress O

BATHROOM

- Beveled Mirror in Lavy (Select Models) S
- Brushed Nickel Bath Accessories S
- Metal Designer Moen® Lavy Faucet S
- Fan-Tastic® Power Roof Vent S
- Molded Acrylic Shower S
- Porcelain Toilet w/Water Saver S
- **Shower Dispenser for Lotion, Shampoo, Soap, Etc.** S
- **Single Lever Shower Control, Brushed Nickel, w/Slide Adjustable Shower Head & Soap Dish** S
- Skylight in Tub/Shower S
- Solid Wood Lavy Door S
- Toilet Tank San-T-Flush™ System S

SAFETY/CONVENIENCE

- 10 ABC Fire Extinguisher S
- Carbon Monoxide Detector/Alarm S
- Entry Assist Handle S
- Propane Detector/Alarm S
- Smoke Detector/Alarm S

EXTERIOR

EXTERIOR – THROUGHOUT

- 5 Colorways w/Full-Body Paint S
- Accessory Propane Supply w/Hose S
- Aluminum Tube Front Grille S
- Aluminum Wheels (Select Models/Chassis) S
- **Awning Rail/Drip Molding (Both Sides)** S
- Coach Vibration Isolators S
- Dual Battery Charge Control S
- Dual Chrome Electric Horns S
- Dual Patio Receptacles S
- Electric Awning S
- Fiberglass Front/Rear Caps S
- Fiberglass Wheel Well Trims S
- Flush Mounted Furnace & Water Heater S
- Park Cable Receptacle S
- Patio Awning S
- **Utility Compartment w/Exterior Shower** S
- Wrap-Around Euro Design Taillights S

- Heated Water & Holding Tank Compartments S
- Large, Curved Aerodynamic Windshield S
- Mud Flaps S
- Dual A/C w/Heat Pump w/Solar Panel on Front A/C O
- Front Mask Shield O

AUTOMOTIVE

- **4-Point Automatic Leveling Jacks** S
- 5,000 lb. Trailer Hitch w/7-Point Electrical Hook-Up† (6,000 lb. w/W24 Chassis) S
- Ford® Chassis w/6.8L Triton® V10 Engine O
- Workhorse™ Chassis 8.1L Vortec™ V8 Engine-W22 or W24 O
- CSA Package** O

SAFETY/CONVENIENCE

- Double Power Entry Step w/Light S
- Dual Halogen Headlights S
- Entry Door w/Screen Door & Deadbolt Lock S
- Large, Heated Remote Rear View Mirrors S
- Porch Light (Doorside & Roadside) S
- **Rear Vision Camera w/One-Way Audio** S
- Roof Ladder S
- Single Motor Windshield Wipers w/Wet Arm S
- Swing-Up Engine Access Door S
- Underhood Utility Lights S
- Winterizing Pick Up Tube S

STORAGE

- Continuous One-Piece Compartment Bulb Seal S
- Gas-Lift Strut Supports S
- Insulated Aluminum Luggage Doors w/Single Paddle Metal Latches & Stainless Steel Hinges S
- Lighted Luggage Compartments S
- **Rotomolded Polyethylene Luggage Compartments** S
- Steel Luggage Door Seal Frames S

BODY STRUCTURE

- Aluminum Interlocking Floor/Wall/Ceiling Framing S
- Basement Floor Configuration S
- **Royal Tuff-Ply Radius Roof w/Ducted A/C** S
- Steel Surface on Bulkhead S
- **Vacu-bond® Upper/Lower Floors** S
- **Vacu-bond® Walls w/Smooth, High-Gloss Exterior Fiberglass** S

FLEETWOOD ADVANTAGES

- Complete TuffPEX® Plumbing System
- Power Platform Construction*
- Royal Tuff-Ply UV-Resistant Heat/Cold Insulated Roofing Technology
- The Full Wall Slide is Fleetwood's Patent Pending Structural Design and Exclusively Uses PowerGear's Slide System Technology. Validated by Extensive Durability, Laboratory and Track Testing to Ensure High Reliability and High Quality.*
- Vacu-Bond® Upper/Lower Floors
- Vacu-Bond® Walls w/Smooth High-Gloss Exterior Tuff-Coat® Fiberglass

Pace Arrow®

Weights & Measurements

WORKHORSE™ CHASSIS

MODELS	33V (W22)	35A (W22/W24)	36D (W22/W24)	37C (W22/W24)	38P (W24)
Engine Displacement (Liters)	8.1	8.1	8.1	8.1	8.1
Wheelbase (Inches)	208"	228"	228"	242"	242"
GVWR (lbs) ¹	22,000	22,000/24,000	22,000/24,000	22,000/24,000	24,000
Front GAWR (lbs) ²	8,000	8,000/9,000	8,000/9,000	8,000/9,000	9,000
Rear GAWR (lbs) ²	14,500	14,500/15,500	14,500/15,500	14,500/15,500	15,500
Base Weight (lbs) ³	18,020	18,570/18,880	19,380/19,260	19,420/19,530	19,950
GCWR (lbs) ⁴	26,000	26,000/30,000	26,000/30,000	26,000/30,000	30,000
Hitch Rating Weight (lbs) [†]	5,000	5,000/6,000	5,000/6,000	5,000/6,000	6,000
Tongue Weight (lbs) [†]	500	500/600	500/600	500/600	600
Fuel Capacity (gal)	75	75	75	75	75

FORD® CHASSIS

MODELS	33V	35A	36D	37C	38P
Engine Displacement (Liters)	6.8	6.8	6.8	6.8	N/A
Wheelbase (Inches)	208"	228"	228"	242"	N/A
GVWR (lbs) ¹	22,000	22,000	22,000	22,000	N/A
Front GAWR (lbs) ²	7,500	7,500	7,500	7,500	N/A
Rear GAWR (lbs) ²	14,500	14,500	14,500	14,500	N/A
Base Weight (lbs) ³	17,320	18,810	19,150	19,220	N/A
GCWR (lbs) ⁴	26,000	26,000	26,000	26,000	N/A
Hitch Rating Weight (lbs) [†]	5,000	5,000	5,000	5,000	N/A
Tongue Weight (lbs) [†]	500	500	500	500	N/A
Fuel Capacity (gal)	75	75	75	75	N/A

DIMENSIONS & CAPACITIES

MODELS	33V	35A	36D	37C	38P
Overall Length ⁵	33' 2"	36' 2"	36' 2"	37' 8"	38' 8"
Overall Height (with A/C)	12' 10"	12' 10"	12' 10"	12' 10"	12' 10"
Overall Width (maximum) ^{6,7}	102"	102"	102"	102"	102"
Interior Height (maximum)	84"	84"	84"	84"	84"
Interior Width (maximum)	96"	96"	96"	96"	96"
Fresh Water Holding Tank (gal)	80	80	80	80	80
Grey Water Holding Tank (gal)	58	58	58	58	58
Black Water Holding Tank (gal)	42	42	42	42	42
Appliance Propane Tank (gal) (WC) ⁸	25	25	25	25	25
Water Heater Tank (gal)	10	10	10	10	10

Liquid Weight Reference: Water (gal) = (8.3 lbs/3.8 kgs) Fuel (gal) = (6.1 lbs/2.8 kgs) Propane (gal) = (4.2 lbs/1.9 kgs)

Metric Conversion: Multiply pounds x 0.453 to obtain kilograms. Multiply gallons x 3.785 to obtain liters. Multiply liters x 61 to obtain cubic inches.

CHASSIS

Model: Ford®/Workhorse™

Engine: 6.8L Triton® V10/8.1L Vortec™ V8

Torque: 457 lb-ft @ 3250 RPM/
455 lb-ft @ 3200 RPM

Alternator Amps: 130 Amp/145 Amp

Horsepower: 362 HP @ 4750 RPM/340 HP @ 4200 RPM

Transmission: TorqShift™ 5-Speed Automatic Overdrive w/Tow/Haul Mode/
6-Speed Automatic with Overdrive – Allison® 1000 (W22) 2100 (W24) Series

1. GVWR (Gross Vehicle Weight Rating) is the maximum permissible weight of this fully loaded motor home. The GVWR is equal to or greater than the sum of the (UVW) unloaded vehicle weight plus the (CCC) cargo carrying capacity.*

2. GAWR (Gross Axle Weight Rating) is the maximum permissible loaded weight a specific axle is designed to carry.

3. Base Weight is the estimated weight of the motor home without fuel, options, water, cargo or passengers.

4. GCWR (Gross Combined Weight Rating) is the value specified by the motor home manufacturer as the maximum allowable loaded weight of this motor home with its towed vehicle. Towing and braking capacities may be different. Refer to Fleetwood and chassis manufacturer's manuals for complete information.

5. Length taken from front bumper to rear bumper (excludes accessories).

6. Excludes safety equipment and awnings.

7. Motor homes feature a body-width over 96" which will restrict your access to certain roads. Before purchasing, you should research any state and/or province road laws which may affect your usage.

8. Tank manufacturer's listed water capacity (WC). Actual propane capacity is 80% of water listing as required by the safety code.

† The chassis manufacturer recommends the installation of a supplemental brake control system to activate the brakes on the vehicle or trailer you are towing. Hitch receiver ratings expressed are maximum for the hitch receiver installed and may require the purchase of additional equipment that is dependent on the weight of the towed load. Consult with hitch receiver manufacturer for further information.

N/A = Not applicable.

*UVW and CCC are found on the cargo carrying capacity label in each RV.

IMPORTANT – PLEASE READ: Product information, photography and illustrations included in this publication were as accurate as possible at the time of printing. For further product information and changes, please visit our website at www.fleetwoodrv.com or contact your local Fleetwood dealer. Prices, materials, design and specifications are subject to change without notice. All weights, fuel, liquid capacities and dimensions are approximate. Fleetwood has designed its recreational vehicles to provide a variety of uses for its customers. Each vehicle features optimal seating, sleeping, storage and fluid capacities. The user is responsible for selecting the proper combination of loads (i.e. occupants, equipment, fluids, cargo, etc.) to ensure that the vehicle's capacities are not exceeded.



RV OWNERCARE*

Limited one-year/15,000-mile coach warranty and three-year/50,000-mile structural warranty, whichever occurs first, and it is fully transferable for the first 12 months. RV OWNERCARE is one of the RV industry's most comprehensive programs and includes systems, appliances, components and construction, with no deductible and no service charge. RV OWNERCARE coverage is provided from a company that will be around in the future to service your needs. See your nearest Fleetwood dealer for a full explanation of benefits and restrictions.

CONTACT US

To locate a dealer near you, visit our website at www.fleetwoodrv.com or call 1-800-444-4905. We can also be contacted at Fleetwood Customer Relations, P.O. Box 1007, Decatur, IN 46733.

FLEETWOOD TRAVELCADE CLUB

As a Fleetwood owner, you're eligible to become a member of the Fleetwood Travelcade Club. It's a perfect way to meet other Fleetwood owners who love to travel across America and share in the RV lifestyle. Call (877) 577-2560, or visit our website at www.fleetwoodrv.com/owners_clubs to learn more, and join the fun.

YOUR LOCAL FLEETWOOD DEALER IS:

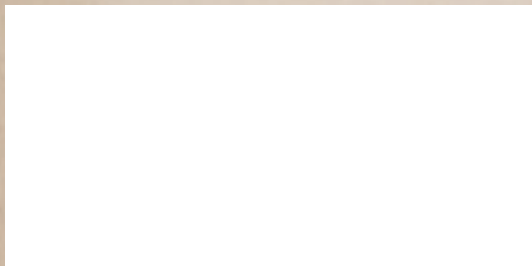

IMPORTANT—PLEASE READ

Product information, photography and illustrations included in this publication were as accurate as possible at the time of printing. For further product information and changes, please visit our website at www.fleetwoodrv.com or contact your local Fleetwood dealer. Prices, materials, design and specifications are subject to change without notice. All weights, fuel, liquid capacities and dimensions are approximate. Fleetwood has designed its recreational vehicles to provide a variety of uses for customers. Each vehicle features optimal seating, sleeping, storage and fluid capacities. The user is responsible for selecting the proper combination of loads (i.e. occupants, equipment, fluids, cargo, etc.) to ensure that the vehicle's capacities are not exceeded.



treadlightly!
LEAVING A GOOD IMPRESSION



*For complete info see your Fleetwood dealer.

©2006. Fleetwood Enterprises, Inc.
Printed in the USA. Inventory Control Number PA07B2, 11/06.
Model Year 2007, Second Edition.