

ALUMA-LITE®  
2008



HOLIDAY RAMBLER®

*This is Living®*





# ALUMA-LITE®

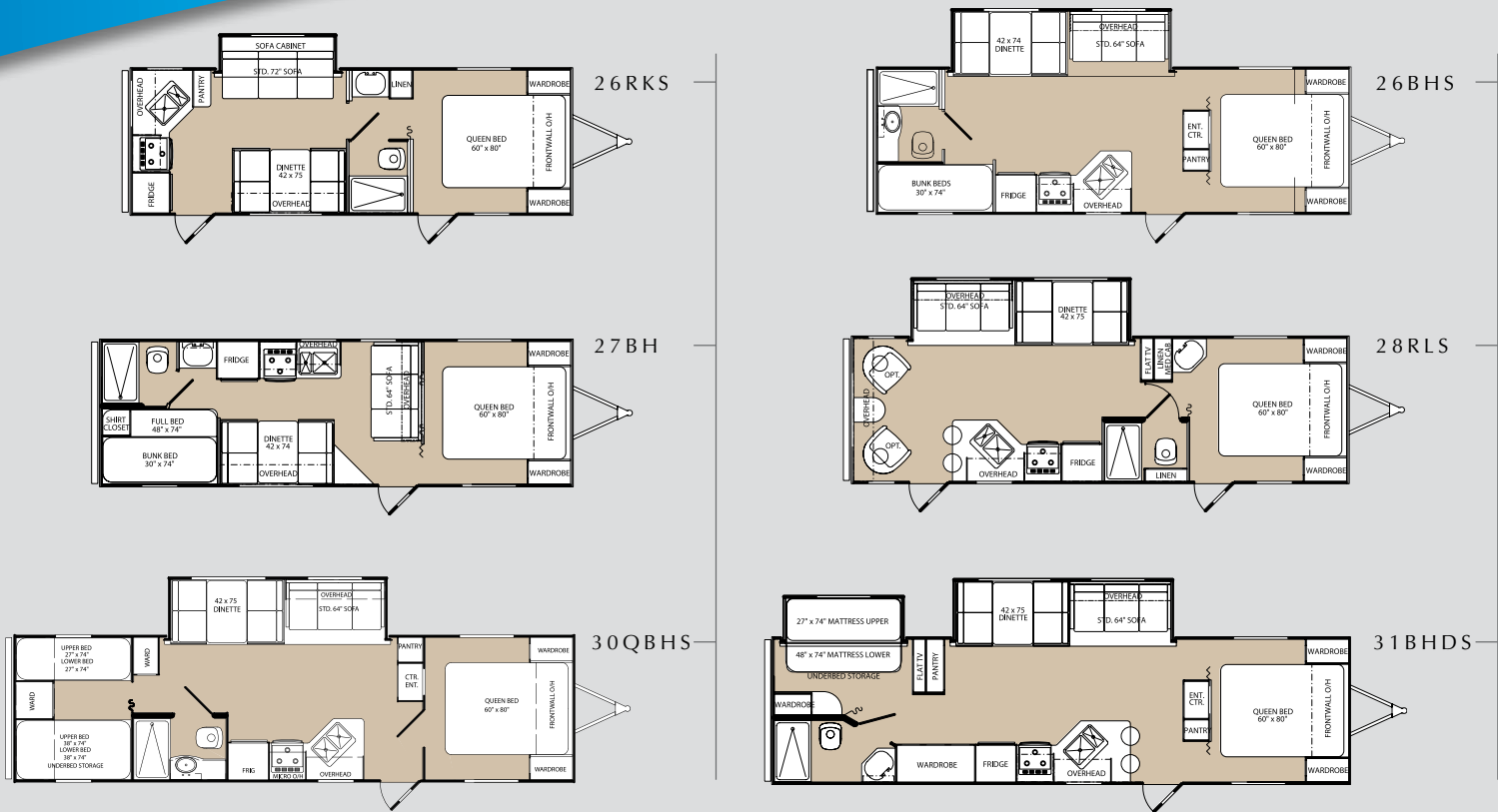

| Weights*                       | 26RKS  | 26BHS  | 27BH   | 28RLS  | 30QBHS  | 31BHDS |
|--------------------------------|--------|--------|--------|--------|---------|--------|
| Gross Vehicle Weight Rating    | 7,526  | 7,600  | 7,539  | 7,625  | 10,893  | 10,976 |
| Axle(s) Weight                 | 4,000  | 4,612  | 3,992  | 4,964  | 5,674   | 5,874  |
| Unloaded Vehicle Weight        | 4,526  | 5,212  | 4,531  | 5,589  | 6,407   | 6,690  |
| Hitch Weight                   | 526    | 600    | 539    | 625    | 733     | 816    |
| Net carrying Capacity (NCC)    | 3,000  | 2,388  | 3,008  | 2,036  | 4,486   | 4,286  |
| Tire Size and Load Range       | 14" C  | 14" C  | 14" C  | 14" C  | 15" D   | 15" D  |
| Measurements                   |        |        |        |        |         |        |
| Overall Length                 | 27' 5" | 29'    | 29' 2" | 30' 3" | 33' 10" | 34' 8" |
| Overall Height (Including A/C) | 10' 5" | 11' 3" | 10' 5" | 11' 3" | 11' 3"  | 11' 3" |
| Exterior Width                 | 98"    | 98"    | 98"    | 98"    | 96"     | 98"    |
| Awning Length                  | 19'    | 15'    | 14'    | 18'    | 21'     | 17'    |
| Tank Capacities                |        |        |        |        |         |        |
| Grey Tank                      | 40     | 40     | 40     | 40     | 40      | 40     |
| Black Tank                     | 40     | 40     | 40     | 40     | 40      | 40     |
| Fresh Tank                     | 40     | 40     | 40     | 40     | 40      | 40     |

- 1 Weights may vary by options.  
 2 All tank capacities are estimated based upon calculations provided by the tank manufacturers and represent approximate capacities. The actual "usable capacity" may be greater or less than the estimated capacities based upon fabrication and installation of the tanks.  
 3 Actual filled LP capacity is 80% of listing due to safety shut-off required on tank.

The actual overall length of the recreational vehicle may differ from that indicated in the brochure due to variances in the manufacturing process and/or installed components. The actual length may be greater or less than that indicated. Due to the large variety of options and floor plan arrangements available to our customers, actual weights for each unit can differ significantly. Monaco Coach provides a weight sticker on each unit we produce which includes that unit's tank capacities and approximate weight. Consult your local Monaco Coach dealer for unit availability and further information. The information printed in this brochure reflects product design, fabrication, and component parts at the date of printing. The manufacturer reserves the right, at any time, to make changes in product design or material or component specifications as its sole option, without notice. This includes the substitution of components of a different brand or trade name which will result in comparable performance. All information printed in this brochure is subject to change after the date of printing. Some features shown or mentioned in this brochure are optional and may only be available in selected floor plans. Photographs may show props or decorations that are not standard equipment on Monaco Coach models. Monaco Coach, the Monaco logo and its design, are registered trademarks. All other products and company names are trademarks and/or registered trademarks of their respective holders. While the color of the motorhome's exterior and the interior fabrics depicted in this sales brochure are fair and reasonable depictions, the colors depicted may not be an exact match of the actual colors because of the variances in photo-processing and variances caused by inserting the photographs within the sales brochure. Due to product improvements, changes during the model year and/or transcription errors that may occur, information represented within this brochure may not be accurate at the time of your purchase. If certain information is significant to your purchasing decision, please confirm the information with your dealer prior to submitting your order. Component part and appliance manufacturers issue limited warranties covering those portions of the recreational vehicle not covered by the Limited Warranties issued by Monaco Coach Corporation. To learn which specific component parts and appliances are excluded from the Limited Warranties issued by Monaco Coach Corporation, please contact your selling dealership or Monaco Coach Corporation directly, or review the warranty packet inside the recreational vehicle.





#### INTERIOR: FEATURES

- 82" Interior Height (Super Slide Models)
- 72" Interior Height Slide Room (Super Slide Models)
- Overhead Cabinet in Slide
- Large Galley Countertops
- 60" x 80" Queen Bed
- Entertainment Centers Designed for LCD TV's
- Rich Cherry Cabinets
- Toe Kicks on Galley
- Large Stainless Steel Sink
- Picture Window at Dinette
- Skylight
- Power Vent in Bathroom
- 5" Arched Dinette Cushion
- Residential Style Sofa
- Tub Surround
- Mortise and Tenon Cabinet Doors
- Full Wardrobes with Drawers in Bedroom
- Two Interior Decors—Windsor Blue and Vintage Moss
- Water Heater Bypass
- Doubled Door Refrigerator

#### OPTIONS

- 12 Volt AM/FM CD/DVD Player
- Bedroom Carpet and Pad
- Living Area Carpet and Pad
- Chair (28RLS Only)
- TV Antenna
- Free Standing Dinette (4 Chairs)
- Hide-A-Bed (Super Slides Only)
- Microwave
- Outside Shower
- Oven with 3 Burner Range
- Sink Covers (2)
- Stove Cover

#### BODY CONSTRUCTION: FEATURES

- 8" I-Beam Frame (N/A 26RKS, 27BH)
- .024 Aluminum Skin
- 16" on Center 2 x 2 Aluminum Stud
- Foamcore Insulation
- R-7 Insulation with Foamcore
- 5/8 Flooring
- 40 Gallon Fresh Water Capacity
- 40 Gallon Grey Water Capacity
- 40 Gallon Back Water Capacity
- Radius Clamp – Ring Windows
- Rubber Roof
- 5" Aluminum Truss Rafters with 3/8 Decking
- Ducted A/C
- 6 Sided Aluminum Structure
- Enclosed Underbelly
- Radial Entry Door

#### OPTIONS

- Awning
- A/C 13.5 BTU Ducted
- High Capacity Ducted A/C
- 30# Propane Tanks
- Gas/Electric DSI Water Heater
- Carrier A/C with Remote Control
- Roof Ladder
- RVQ Grill
- Safety Glass
- Spare Tire/Carrier/Cover
- Stabilizer Jacks
- TV Antenna
- 19" LCD TV



ALUMA-LITE®  
2008

## BEING DIFFERENT MAKES ALL THE DIFFERENCE.

At Monaco Coach Corporation, we always strive to be the best. And that means thinking outside the box. Giving you more of what you want in an RV. Programs like Monaco Financial Services and 24/7 emergency technical support. No other manufacturer can match Monaco's offerings. No one even comes close. Why not discover the difference for yourself? Visit [www.monacodifferent.com](http://www.monacodifferent.com)

**"No other manufacturer can match Monaco's offerings.  
No one even comes close."**



*Kay*  
KAY TOOLSON, CEO

### WARRANTIES

12 MONTH basic limited warranty  
2 YEAR limited warranty on aluminum  
or steel frame structure



HOLIDAYRAMBLER.COM

Log on to our website anytime, night or day. It's your link to everything Holiday Rambler, including product news and updates, club events, dealer and service center info and much more. Take it for a test drive today.

606 Nelson's Parkway Wakarusa, IN 46573  
[www.holidayrambler.com](http://www.holidayrambler.com) | 800-245-4778

**24/7**  
**ASSISTANCE**  
SALES • TECH • ROADSIDE

**WE'RE HERE. ANYTIME, EVERY TIME.**

- Reach us anytime — literally — via our live customer support line.
- Drive in to one of our 350 Service Centers.
- Enjoy the first year free when you enroll in our Owner Advantage Roadside Assistance Program.
- See where it all begins with a tour of one of our facilities in Indiana or Oregon. Call 1-800-650-7337 or 1-800-634-0855 to find out more.



HOLIDAY RAMBLER®

*This is Living®*



MONACO COACH CORPORATION



Monaco is traded on the New York Stock Exchange under the listing MNC.  
© 2007, Monaco Coach Corporation 01/08 9112ALUM Litho in USA.