

Class C Motorhome

Atlantis
By Holiday Rambler



ATLANTIS
BY HOLIDAY RAMBLER



The Adventure Awaits

25SB

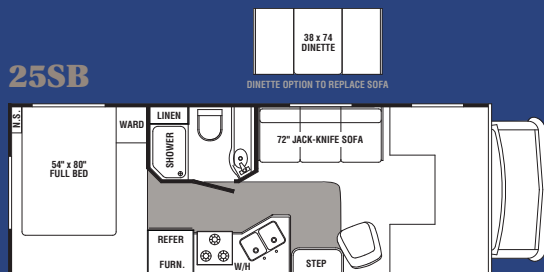

25SR

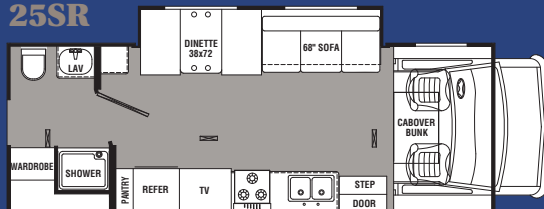

28QS

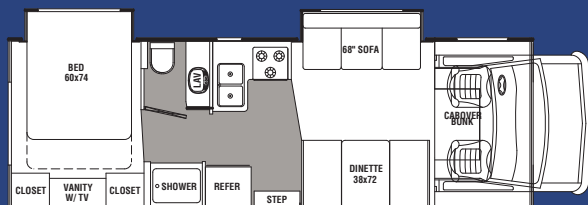

31SL

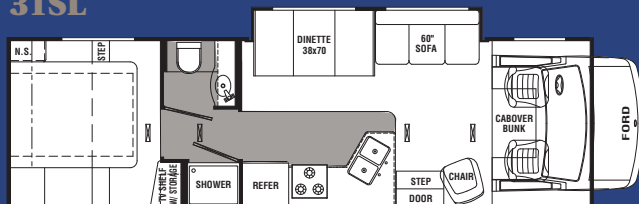

29RQ

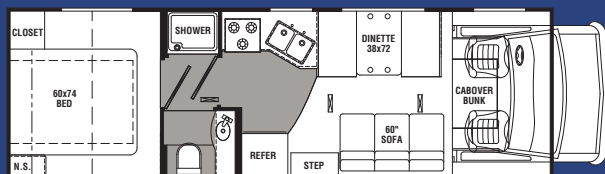

Floor Plans & Specifications

SPECIFICATIONS	25SB	25SR	28QS	29RQ	31SL
Ford Engine	6.8L	6.8L	6.8L	6.8L	6.8L
Wheel Base	185"	185"	191"	191"	214"
GVWR	14,050	14,050	14,050	14,050	14,050
GAWR (Front)	4600	4600	4600	4600	4600
GAWR (Rear)	9450	9450	9450	9450	9450
GCWR	*	*	*	*	*
Exterior Length w/o Ladder (+6")	25'-11"	27'-5"	28'-6"	29'-1"	31'-0"
Exterior Height w/AC	10'-8"	10'-8"	10'-8"	10'-8"	10'-8"
Exterior Width	99"	99"	99"	99"	99"
Interior Width	95 1/2"	95 1/2"	95 1/2"	95 1/2"	95 1/2"
Interior Height	79"	79"	79"	79"	79"
Awning Size	16'-0"	18'-0"	18'-0"	14'-0"	16'-0"
Fuel Ford (Gal.)	55	55	55	55	55
LPG (Pounds)	42	42	42	42	42
Fresh Water (Gal.)	38	58	38	38	38
Waste Water (Gal.)	35	48	35	35	35
Gray Water (Gal.)	35	45	35	35	35
Furnace BTU's	30,000	30,000	30,000	30,000	30,000

Note: GCWR weights vary depending on engine size and rear end ratios.

Weights are approximate and based on standard features. Optional equipment is not included.

*Ford- 18,500 w/6.8 V10 & 4.56 rear axle ratio, 20,000 w/6.8 V10 & 4.63 rear axle ratio.



Fully equipped galley



Dash mounted backup monitor with 7" LCD color screen (optional)

Large pass thru storage



Get ready for an adventure in comfort and luxury with the Atlantis class C motorhome. It's packed with all the amenities usually found only in full size class A's, but without the cumbersome size and high price. It's affordable value that makes RVing fun and easy.

Quality. Value. Comfort.



Spacious living quarters loaded with amenities

Standards & Options

Kitchen & Appliances

- 3 Burner Range Top, High Output
- Double Bowl Stainless Steel Kitchen Sink
- Flush Mount, Single Door Refrigerator
- Lighted Power Range Hood
- Mortise and Tenon Cabinet Doors
- Raised Panel Overhead Cabinet Doors
- Self Edge Countertop (Kitchen/Dinette)

Interior

- Barrell Chair(s) (Where Applicable)
- Bedspreads, Pillows and Pillow Shams
- Decorator Mirror
- Mini Blinds with Valances and Lambrequins
- Mirrored Cabinet Doors (Living Area)
- Pedestal Dinette Table
- Plush Sofa and/or Dinette
- Soft Touch Padded Vinyl Ceiling
- Stain Resistant Carpeting
- Wall Clock
- Welded Aluminum Dinette Frame

Bath

- 6 Panel Bath Door
- 12V Power Roof Vent
- Hand Flush Commode
- Shower or Tub w/Curtain
- Skylight

Entryway

- Large Upgraded Assist Grab Handle
- Deadbolt Door Lock
- Integrated Manual Step
- Porch Light
- Radius Entry Door

Construction

- .070 Filon Plus Fiberglass
- Fully Laminated Roof, Walls, and Floors with High-Density Block Foam Insulation
- Fully Welded Tubular Aluminum Roof and Sidewalls
- One Piece Rubber Roof

Chassis

- Big Button AM/FM/Cassette/CD Radio with Weather Band and Sirius® Satellite Radio Ready

- Drink Tray
- Electric Door Locks and Windows
- Emergency Start Switch
- Factory Air Conditioning, Cruise Control and Tilt Wheel with Power Steering
- Ford Chassis with V-10 Engine (E450)
- Heavy-Duty 4 Speed Automatic, Overdrive Transmission
- Intermittent Windshield Wipers
- Map Light
- Radial Tires
- Rear Mud Flaps
- Reclining Captain's Chairs
- Stainless Steel Wheel Covers

Exterior

- Automotive Style Rear Bumper
- Exterior Recept - GFI Protected
- High Line Graphics Package
- Locking Exterior Storage Doors
- One-Piece Rubber Roof
- Pass-Through Basement Storage Areas
- Roto-Cast Storage Compartments
- Smooth White Fiberglass (.070 Filon Plus)
- Tinted Radius Corner Slider Windows

Utilities

- 6 Gallon Gas Water Heater
- 12V Auxiliary Battery
- 12V Water Pump
- 30 Amp, 120V Power Supply
- 30,000 BTU Elect. Ign. Furnace
- Battery Disconnect
- Carbon Monoxide Detector
- City Water Hook-Up
- "Command Central" Systems Monitor/Switch Panel
- Exterior Utility Center
- Fire Extinguisher
- Generator Prep (Wire and Plumb)
- In-Floor Ducted Heat (All Models)
- LP Gas Detector
- Pre-Wired for Ceiling Ducted A/C
- Satellite Dish Prepped
- Shore Line Power Cord

- Smoke Detector
- Solid State 55 Amp 12V Power Converter
- Water Heater Bypass

Options

- 4.0 Onan Micro-Lite Generator with Auto Change Over
- 6 Gallon Gas/Elect. Water Heater and Elect. Ign.- DSI
- 8 Cubic Foot Refrigerator
- 13" Color TV (Where Available)
- 13,500 BTU Air Conditioner (Ducted)
- 15,000 BTU Air Conditioner (Ducted)
- AM/FM/CD SIRIUS Satellite Ready Stereo with Motorized 7" LCD Backup Monitor with Color Camera (Late May 2006. Option Replaces Standard Radio)
- Automatic Electric Entrance Step
- Awning
- Bi-Fold Shower Door
- Cabover Ent. Center with 24" RCA TV
- CSA Approval
- Day/Night Shades
- Deluxe Heated/Remote Breakaway Exterior Mirrors
- Double Electric Entrance Step
- DVD/VCR Video Package
- Exterior Entertainment Center with CD Player
- Fantastic™ Fan
- Fiberglass Running Boards
- Folding Range Cover
- Front Cabover Window
- Gas/Electric DSI Water Heater
- HAB Sofa with Innerspring Mattress (25SR)
- Half Time Microwave Oven
- Heated Holding Tanks
- Helwig Helper Springs
- Holding Tanks with Heat Pads
- Home Theatre Surround Sound System with 5 Omni-Directional Speakers and Sub-woofer
- Large Double Door Refrigerator
- Lower Paint

- Motor Sports Package (25SR Required)
- Outside Shower
- Oven
- Rear Ladder
- Refer Front – Black Plexi-Glass
- Refer Front – Raised Panel
- Single 12V Auxiliary Battery with 2 Battery Capacity Slide Out Tray
- Sink Covers (2)
- Slide Out Awning (Forced Option)
- Spare Tire
- Stainless Steel Wheel Inserts
- Telephone Jack
- Thermopane Windows
- Trailer Hitch with Wire
- Tub Surround
- TV Antenna/Booster/Jack, Cable Ready
- Wood Grain Dash Treatment

Warranty

- 12 Months/18,000 Miles Basic Limited Warranty
- 2 Year Structural – *See Dealer for Complete Coverage*
- 3 Years/36,000 Miles Chassis Warranty



HOLIDAY RAMBLER®

This is Living®

606 Nelson's Parkway, Wakarusa, IN 46573

1.800.245.4778 • www.holidayrambler.com



MONACO COACH CORPORATION

Monaco is traded on the New York Stock Exchange under the listing MNC. ©2006, Monaco Coach Corporation



Your Dealer:

1 Towing capacity is limited by GCWR; your vehicle's towing capacity is the difference between the GCWR and the actual vehicle weight, including all water, fuel, passengers and cargo. Your towed vehicle should be equipped with auxiliary brakes if the weight of the towed vehicle exceeds 1,000 lbs. Consult your owner's manual for further towing information.

2 All tank capacities are estimated based upon calculations provided by the tank manufacturers and represent approximate capacities. The actual "usable capacity" may be greater or less than the estimated capacities based upon fabrication and installation of the tanks.

3 Actual filled LP capacity is 80% of listing due to safety shut-off required on tank.

The actual overall length of the recreational vehicle may differ from that indicated in the brochure due to variances in the manufacturing process and/or installed components. The actual length may be greater or less than that indicated. Due to the large variety of options and floorplan arrangements available to our customers, actual weights for each unit can differ significantly. Monaco Coach provides a weight sticker on each unit we produce which includes that unit's tank capacities and approximate weight. Consult your local Monaco Coach dealer for unit availability and further information. The information printed in this brochure reflects product design, fabrication, and component parts at the date of printing. The manufacturer reserves the right, at any time, to make changes in product design or material or component specifications as its sole option, without notice. This includes the substitution of components of a different brand or trade name which will result in comparable performance. All information printed in this brochure is subject to change after the date of printing. Some features shown or mentioned in this brochure are optional and may only be available in selected floorplans. Photographs may show props or decorations that are not standard equipment on Monaco Coach models. Monaco Coach, the Monaco logo and its design, are registered trademarks. All other products and company names are trademarks and/or registered trademarks of their respective holders. While the color of the motorhome's exterior and the interior fabrics depicted in this sales brochure are fair and reasonable depictions, the colors depicted may not be an exact match of the actual colors because of the variances in photoprocessing and variances caused by inserting the photographs within the sales brochure. Due to product improvements, changes during the model year and/or transcription errors that may occur, information represented within this brochure may not be accurate at the time of your purchase. If certain information is significant to your purchasing decision, please confirm the information with your dealer prior to submitting your order. Component part and appliance manufacturers issue limited warranties covering those portions of the recreational vehicle not covered by the Limited Warranties issued by Monaco Coach Corporation. To learn which specific component parts and appliances are excluded from the Limited Warranties issued by Monaco Coach Corporation, please contact your selling dealership or Monaco Coach Corporation directly, or review the warranty packet inside the recreational vehicle.