

AUGUSTA™
2010



HOLIDAY RAMBLER®

This is Living®



Augusta



*Augusta*TM
2010

THE SPICE OF LIFE

Augusta embodies Holiday Rambler's legacy of universal appeal. With three different floorplans and two dependable chassis (Ford or Chevy) from which to choose, Augusta brings both variety and spice to life. (Augusta B-Plus 29PBT pictured.)







WEIGHTS AND MEASUREMENTS

Due to continuous product improvement, please visit www.holidayrambler.com for the latest in standards and options, specifications, and technical data.

AUGUSTA B-PLUS

	23RBS	28PBD	29PBT
Weights – Ford	6.8L	6.8L	6.8L
Gross Vehicle Weight Rating	11,500	14,500	14,500
Gross Combined Weight Rating*	18,500	20,000	20,000
Front Gross Axle Weight Rating	4,600	5,000	5,000
Rear Gross Axle Weight Rating	7,800	9,500	9,500
Weights – Chevy	6.0L	6.0L	6.0L
Gross Vehicle Weight Rating	12,300	14,050	14,050
Gross Combined Weight Rating**	16,000	17,600	17,600
Front Gross Axle Weight Rating	4,600	4,600	4,600
Rear Gross Axle Weight Rating	8,300	9,450	9,450
Measurements			
Wheelbase – Ford	158"	191"	198"
Wheelbase – Chevy	159"	192"	199"
Overall Length, Without Ladder & Spare Tire – Ford	22' 7"	28' 1"	29' 3"
Overall Length, Without Ladder & Spare Tire – Chevy	23' 6"	28' 7"	30' 2"
Overall Height, Including AC	10' 8"	10' 8"	10' 8"
Interior Height	82"	82"	82"
Interior Width	95.5"	95.5"	95.5"
Exterior Width	99"	99"	99"
Tank Capacities			
Water Heater (gal.)	6	6	6
Grey Tank (gal.)	32	32	32
Black Tank (gal.)	27	27	27
Fresh Tank (gal.)	35	35	34
LP Tank (lbs./gal.)	42/9.8	42/9.8	42/9.8
Fuel – Chevy/Ford (gal.)	35/37	57/55	57/55

* Towing capacity is limited by GCWR; your vehicle's towing capacity is the difference between the GCWR and the actual vehicle weight, including all water, fuel, passengers and cargo. Your towed vehicle should be equipped with auxiliary brakes if the weight of the towed vehicle exceeds 1,000 lbs. Consult your owner's manual for further towing information.

** All tank capacities are estimated based upon calculations provided by the tank manufacturers and represent approximate capacities. The actual "usable capacity" may be greater or less than the estimated capacities based upon fabrication and installation of the tanks.

*** Actual filled LP capacity is 80% of listing due to safety shut-off required on tank.

The actual overall length of the recreational vehicle may differ from that indicated in the brochure due to variances in the manufacturing process and/or installed components. The actual length may be greater or less than that indicated. Due to the large variety of options and floorplan arrangements available to our customers, actual weights for each unit can differ significantly. Holiday Rambler provides a weight sticker on each unit we produce which includes that unit's tank capacities and approximate weight. Consult your local Holiday Rambler dealer for unit availability and further information. The information printed in this brochure reflects product design, fabrication, and component parts at the date of printing. The manufacturer reserves the right, at any time, to make changes in product design or material or component specifications as its sole option, without notice. This includes the substitution of components of a different brand or trade name which will result in comparable performance. All information printed in this brochure is subject to change after the date of printing. Some features shown or mentioned in this brochure are optional and may only be available in selected floorplans. Photographs may depict a floorplan option that has been discontinued or is no longer available at the time of your purchase. Photographs may show props or decorations that are not standard equipment. Holiday Rambler, the Holiday Rambler logo and its design, are registered trademarks. Other products and company names are trademarks and/or registered trademarks of their respective holders. While the color of the motorhome's exterior and the interior fabrics depicted in this sales brochure are fair and reasonable depictions, the colors depicted may not be an exact match of the actual colors because of the variances in photo-processing and printing. Due to product improvements, changes during the model year and/or transcription errors that may occur, information represented within this brochure may not be accurate at the time of your purchase. If certain information is significant to your purchasing decision, please confirm the information with your dealer. Component part and appliance manufacturers issue limited warranties covering portions of the recreational vehicle not covered under the Limited Warranties issued by Monaco RV, LLC. To learn specific details regarding warranty coverage, please contact your selling dealership or review the warranty packet inside the recreational vehicle.

CARPET LINOLEUM

23RBS

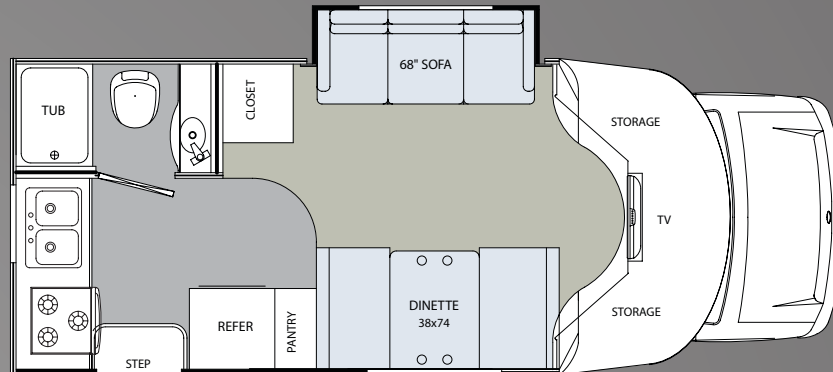

28PBD

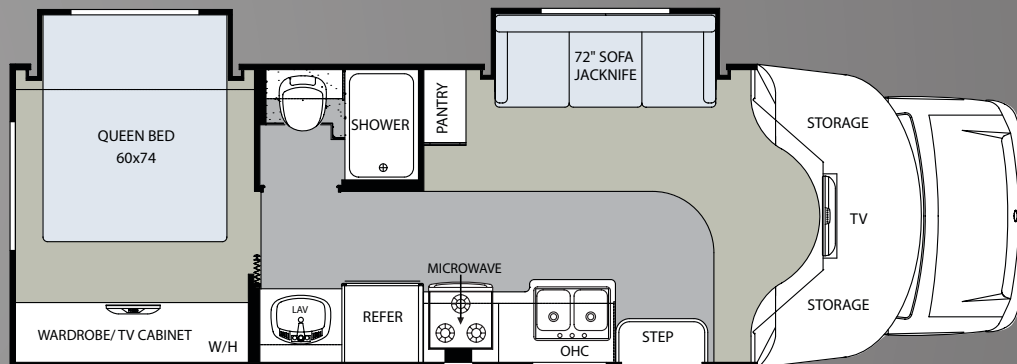

29PBT

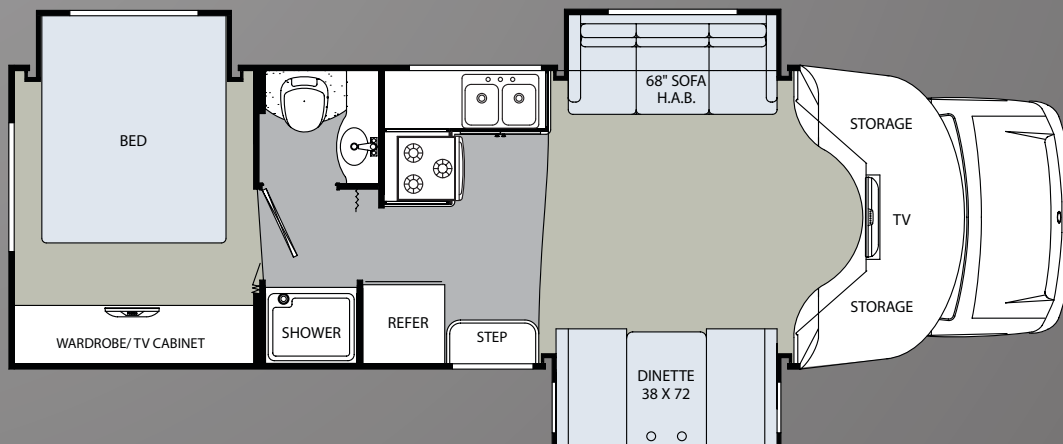

Augusta B-Plus

2010



AUGUSTA B-PLUS STANDARDS

BODY CONSTRUCTION

- Fully Welded Tubular Aluminum Roof and Sidewall Construction
- Fully Laminated Roof, Walls and Floors w/ High-Density Block Foam Insulation
- One Piece Roof
- One-Piece Fiberglass Rear Cap
- Smooth White Fiberglass Sidewalls
- Exterior Storage Compartments
- Integrated Rear Bumper
- Locking Exterior Storage Doors
- Integrated Manual Entrance Step
- Rear Wheel Mud Flaps
- Slide-Out Battery Tray
- Automotive Step Well
- Deluxe Graphics Package

FORD CHASSIS / ENGINE (GAS) / SUSPENSION

- Ford E350 Chassis (23RBS)
- Ford E450 Chassis (28PBD, 29PBT)
- 6.8L Triton® V-10 Gasoline Engine with Sequential Electronic Fuel Injection (SEFI), 305 HP @ 4,250 RPM / 420 lbs./ft. Torque @ 3,250 RPM
- 5-Speed TorqShift® Automatic Transmission with Overdrive; In-Tank Oil Cooler
- 115 Amp Alternator (Gas Engine)
- Rear Axle Ratio 4.10:1 (E350 Chassis) (23RBS)
- Rear Axle Ratio 4.56:1 (E450 Chassis) (28PBD, 29PBT)
- Stainless Steel Wheel Covers
- Hellwig® Helper Springs (29PBT)
- Rear Multi-Leaf Spring Suspension with Stabilizer Bar
- ABS Brake System
- One 12V Chassis Battery
- Emergency Start Circuit

FORD CHASSIS / ENGINE (DIESEL) / SUSPENSION (N/A 23RBS)

- 6.0L Power Stroke® V-8 Turbo Diesel, Direct Injection 235 HP @ 3,150 RPM / 440 lbs./ft. Torque @ 2,000 RPM
- Power Pilot Seat
- 100 Amp Alternator (Diesel Engine)
- Rear Axle Ratio 4.10:1 (E450 Diesel Chassis)

CHEVY CHASSIS / ENGINE (GAS) / SUSPENSION

- Vortec 6.0L V-8 Sequential Fuel Injection (SFI), 300 HP @ 4,400 RPM, 360 lbs./ft. Torque @ 4,000 RPM

- 4-Speed Automatic, Heavy Duty Transmission, Electronically Controlled with Overdrive; Internal Transmission Oil Cooler
- 145 Amp Alternator
- Rear Axle Ratio 4.10:1
- Stainless Steel Wheel Covers
- Hellwig® Helper Springs (29PBT)
- Rear Multi-Leaf Spring Suspension with Stabilizer Bar
- ABS Brake System
- One 12V Chassis Battery
- Emergency Start Circuit

COCKPIT

- In Dash AM/FM/CD Stereo Radio, SIRIUS® Satellite Ready w/ SD Card Slot and Weather Band
- Dual Air Bags
- Multi-Positioned Sun Visors
- Reclining Captain's Chairs

APPLIANCES AND ACCESSORIES

- Flush-Mount, Single-Door Refrigerator
- 3-Burner Range Top
- Lighted Power Range Hood
- 26" LCD TV w/ Antenna Hookup in Cabover
- Satellite Dish Prep

INTERIOR

- Newport Cherry II Cabinetry
- Raised Panel Cabinet Doors Living Area and Bedroom, Flat Panel on Lower Cabinet Doors
- Woodgrain Panel Refrigerator Front
- Fabric Covered Dinette Back, Side and Top
- Laminate Countertops with Wood Edge – Kitchen and Dinette
- Pantry with Adjustable Shelves (N/A 29PBT)
- Mini Blinds Throughout with Decorative Box Valances
- Bedsprad, Pillows and Pillow Shams (28PBD, 29PBT)
- Carpet with Padding
- Windshield Privacy Curtain
- Hardware with Brushed Nickel Finish
- Soft-Touch Vinyl Ceiling
- Medicine Cabinet w/ Mirror (Bathroom)
- Residential Linoleum in Bath, Galley and Entryway

FURNITURE

- Queen Bed (28PBD, 29PBT)

- Booth Dinette (23RBS, 29PBT)
- Radius Booth Dinette (28PBD)
- Fabric Plush Sofa with Residential Style Arms (23RBS)
- Fabric Hide-A-Bed Sofa (29PBT)

ELECTRICAL SYSTEMS AND LIGHTS

- 30 Amp 120V Distribution Panel
- Shore Line Power Cord
- Solid State 55 Amp 12V Power Converter
- Battery Disconnect Switch
- 12V Auxiliary Battery
- Generator Prep
- Porch Light

PLUMBING AND LP SYSTEMS

- 6 Gallon Gas Water Heater
- 12V Water Pump
- Large Double Bowl Stainless Steel Kitchen Sink with High-Rise Faucet
- City Water Hookup
- Water Heater Bypass Valve
- Tub/Shower with Curtain (23RBS)
- Tub/Shower w/ Surround and Glass Shower Door (28PBD)
- Shower w/ Surround and Glass Door (29PBT)

HEATING, VENTS AND AIR CONDITIONING

- Pre-Wire for Ducted AC
- 12V Power Roof Vent

WINDOWS, DOORS AND AWNINGS

- White Trimmed Entrance Door
- Large Assist Grab Handle
- Radius Corner Slider Windows
- Skylight in Bathroom
- Topper Slide-Out Awnings

SAFETY

- Fire Extinguisher
- Deadbolt Lock on Entrance Door
- GFI Protected Circuit, Exterior
- LP Gas Detector
- Smoke Detector
- Carbon Monoxide Detector
- Command Central Systems Monitor / Switch Panel
- Pilot and Co-Pilot Three-Point Seat Belts

BUY LOCALLY. ENJOY EVERYWHERE.

Holiday Rambler strongly encourages our retail customers to purchase from their local dealerships whenever possible. Buying a new Holiday Rambler locally allows a customer to establish a relationship with a dealer close to home and provides convenient service and support from product-trained technicians. On our end, Holiday Rambler will continue to provide our dealer partners and customers with the finest recreational vehicles in the industry.

Augusta B-Plus

2010

AUGUSTA B-PLUS OPTIONS

BODY CONSTRUCTION

- Rear Ladder
- Heated Power Mirrors
- Automatic Electric Entrance Step (Side Entrance Only)
- High-Gloss Gel-Coat Fiberglass
- Lower Paint Package
- Full Body Paint Colors: Black Cherry, Champagne and Majestic Blue
- Touring Package: Front Spoiler, Chrome Wheels, Fog Lights, Carbon Fiber Dash/Steering Wheel and Drink Tray

FORD & CHEVY CHASSIS/ENGINE/SUSPENSION

- Hellwig® Helper Springs (Standard 29PBT, N/A 28PBD)
- 5,000 lb. Hitch Receiver w/ Dual Connector 4-Pin or 7-Pin (Included In Value Package)
- Spare Tire with Continental Tire Cover
- Stainless Steel Wheel Inserts (N/A w/ Touring Package)

COCKPIT

- In Dash AM/FM/CD Radio, SIRIUS® Satellite Ready, USB Port for MP3 Player/Flash Drives, LCD Back-Up Monitor System with DVD Player
- Woodgrain Dash Treatment (N/A w/ Touring Package)
- Value Package: Leatherette Driver/Passenger Seats and Sofa, TV Antenna, Hitch and Wire, Gas/Electric Water Heater, Half-Time Microwave and Day/Night Shades

APPLIANCES AND ACCESSORIES

- Large Double-Door Refrigerator

- 3-Burner Range w/ Oven
- Half-Time Microwave Oven (Included In Value Package)
- Folding Range Cover (N/A w/ Deluxe Décor Package)
- Stainless Steel Folding Range Cover (Deluxe Décor Package Only)
- Sink Covers (2)
- 19" LCD TV – Bedroom (28PBD, 29PBT)
- Home Theater Surround Sound System with Sub-Woofer (Requires Option Selection of LCD Back-Up Monitor System with DVD Player)
- TV Antenna / Booster / Jack, Cable Ready (Included In Value Package)
- Exterior Entertainment Center, CD Player/Radio with Two Speakers (N/A 23RBS)

INTERIOR

- Décor: Honeycomb II, Tabasco and Timber Ridge (N/A w/ Deluxe Décor Package)
- Deluxe Décor Package (Brass Ring): Solid Surface Countertops, Upgraded Carpet and Linoleum, Faucet w/ Sprayer, Porcelain Toilet, and Stainless Steel Appliances (Select Comfort Mattress for 28PBD and 29PBT)
- Day/Night Shades (Included In Value Package)
- Black High Gloss Plexiglass Refrigerator Front
- Raised Panel Refrigerator Front

FURNITURE OPTIONS

- Select Comfort Mattress (Required Option; Only Available w/ Deluxe Décor Package; N/A 23RBS)

ELECTRICAL SYSTEMS AND LIGHTS

- Onan 4.0 kW Micro-Lite Generator w/ Auto Changeover
- Onan 3.6 kW Micro-Lite Generator w/ Auto Changeover – LP for Diesel (N/A 23RBS)

PLUMBING AND LP SYSTEMS

- 6 Gallon Gas/Electric Water Heater with DSI (Included In Value Package)
- Tub/Shower or Shower w/ Surround (23RBS)
- Outside Shower

HEATING, VENTS AND AIR CONDITIONING

- 13,500 BTU Air Conditioner
- 15,000 BTU Air Conditioner
- Heat Pads for Holding Tanks
- Fantastic Fan
- Fantastic Fan w/ Rain Sensor

WINDOWS, DOORS AND AWNINGS

- Main Patio Awning (N/A 29PBT)
- Box Awning (29PBT)
- Dual Pane Windows

ALL ROADS LEAD TO WWW.HOLIDAYRAMBLER.COM

Wherever the road takes you, you're never more than a click away from your friends at Holiday Rambler. Just go to www.holidayrambler.com for all the latest product news, club dates and destinations, a dealer locator function, and factory tour information. You can also e-mail us directly through the site at any time.





HOLIDAY RAMBLER®

This is Living.

At Holiday Rambler, a brand of Monaco RV, it's our goal for all our customers to enjoy their RV experience from the beginning. We have forged strong, reliable relationships with our dealer partners, and we encourage our customers to do the same. We're proud to boast a network of over 350 dealership partners and service centers across North America. We're confident that this relationship will only enhance your RV experience and provide the added peace of mind you desire, so you can focus on the important stuff. After all, we're not just selling a world-class product, we're selling "fun." You can rest assured, Holiday Rambler and Monaco RV will be along for the ride, every mile your RV adventure takes you.

NAVIGATOR®



SCEPTER®



ENDEAVOR®



NEPTUNE®



ADMIRAL®



ARISTA®



ALUMA-LITE®



AUGUSTA™

