



HOLIDAY RAMBLER®

This is Living®

**Laminated Sidewall at
Stick-&-Tin Price**

**Lightweight
1/2 Ton Towable**

Aggressively Priced



NEW 2007 SAVOY LE

Savoy
BY HOLIDAY RAMBLER
LE



Body and Frame Construction

- 2" Laminated Sidewall Construction
- Welded Tubular Aluminum Studs
- I-Beam Frame
- Vinyl Exterior Graphics
- Smooth Fiberglass Exterior Walls
- Lockable, Radius Exterior Storage Doors
- ABS Fender Skirts
- Pass-Thru Storage Under Master Bed
- Gutter Rail Above Slide-Out Room
- 5/8" Sturdy-wood Flooring
- 3/8" Full Walk-on Roof
- 5" Roof Trusses, 16" on Center
- Electric Powered Slide-Out(s)
- Seamless One-Piece Exterior Roof Membrane
- Super Lube Axles w/Electric Brakes
- Stabilizer Jacks (2 Pair)
- Frame Mounted Entry Steps
- Insulated, Heated and Enclosed Undercarriage
- Stylized 15" Radial White Sport Wheels w/Chrome Center Hub Cap

Appliances

- 6 cu. Ft. Refrigerator
- 6 Panel Refrigerator Insert
- Microwave w/Touch Control
- Wedgewood High Output Range w/Oven

- Range Hood w/Light and Exhaust Fan
- Home Theater Surround Sound System Dolby Digital 5.1
- Systems Monitor Panel: Battery Charge, Holding Tank Levels, Gas/Electric Water Heater and Water Pump Switch

Interiors

- Hardwood Cabinets
- Brushed Nickel Cabinet Hardware and Accessories

Furniture

- Queen Bed
- Bunk Beds
- Angled Double Bed w/Bunk
- Bottom Bed in Bunk Area w/Hinges and Gas Struts
- Color Coordinated Quilted Bedspread
- Shirt Wardrobe in Bedroom
- Wood Booth Dinette w/Arched Back Cushions

Electrical Systems and Lights

- Electrical Management System: 12V w/55AMP Converter
- 30-amp Power Cord
- Decorative Lighting Throughout
- TV Antenna w/Signal Booster
- Cable TV Hook-Up

Plumbing

- Stainless Steel Kitchen Sink w/High Profile Double Handle Brushed Nickel Faucet
- Demand Water System w/Shurflo Pump
- 6-Gallon L.P. Gas/Electric Water Heater w/Electronic Ignition
- Extra Large Lavatory w/Double Handle Faucet
- Brushed Nickel Plumbing Fixtures
- Systems Monitor Panel
- Hook-up for City Water
- Outside Shower
- Water System Winterization Kit
- Tub with Surround
- Two 30 lb. L.P. Tanks with Automatic Changeover and Full LP Bottle Cover
- Water Heater By-pass Kit
- Zurn PEX Water Lines

Heating, Vents and Air Conditioning

- 30M BTU Electronic Ignition Furnace
- One Carrier Central 13,500 BTU A/C w/Dehumidifier & Remote Control

Windows and Doors

- Tinted Safety Glass Radius Windows
- Tinted Skylight in Bathroom
- Radius Entrance Door w/Anti-Skid Steps
- Mini Blinds Throughout

Weights	28SKS	29SKS	Measurements	28SKS	29SKS	Tank Capacities	28SKS	29SKS
GVWR	7,800	7,800	Overall Length	30' 8"	31' 8"	Water Heater	6	6
Hitch Weight	480	560	Overall Height	10' 3"	10' 3"	Grey Tank	40	40
Axle(s) Weight	3,500	3,500	Exterior Width	98"	98"	Black Tank	40	40
Unloaded Vehicle Weight	5,168	5,308				Fresh Tank	40	40
Net Carrying Capacity	2,632	2,492				L.P. Tank	30 (2)	30 (2)
Tire Size/Load Range	15" C	15" C						

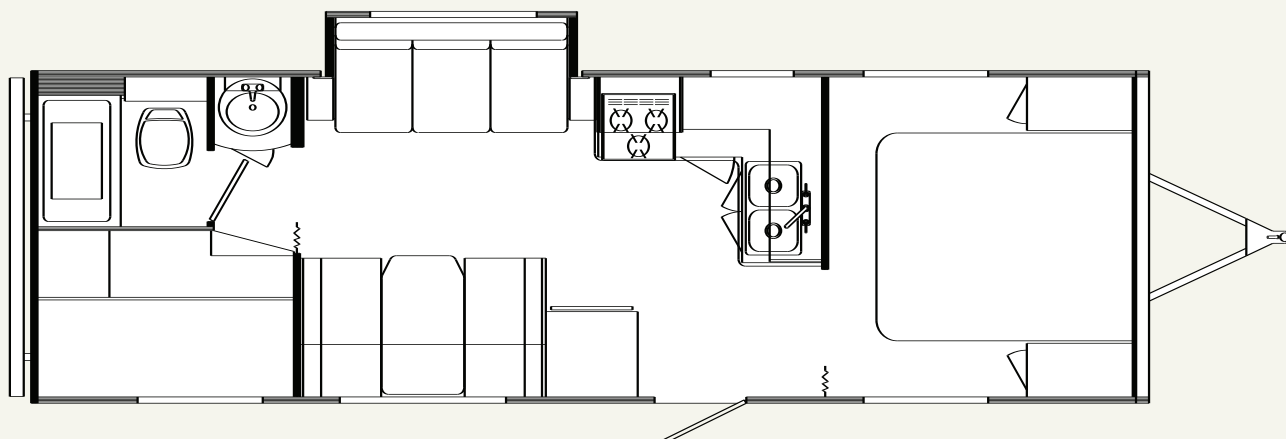

28SKS

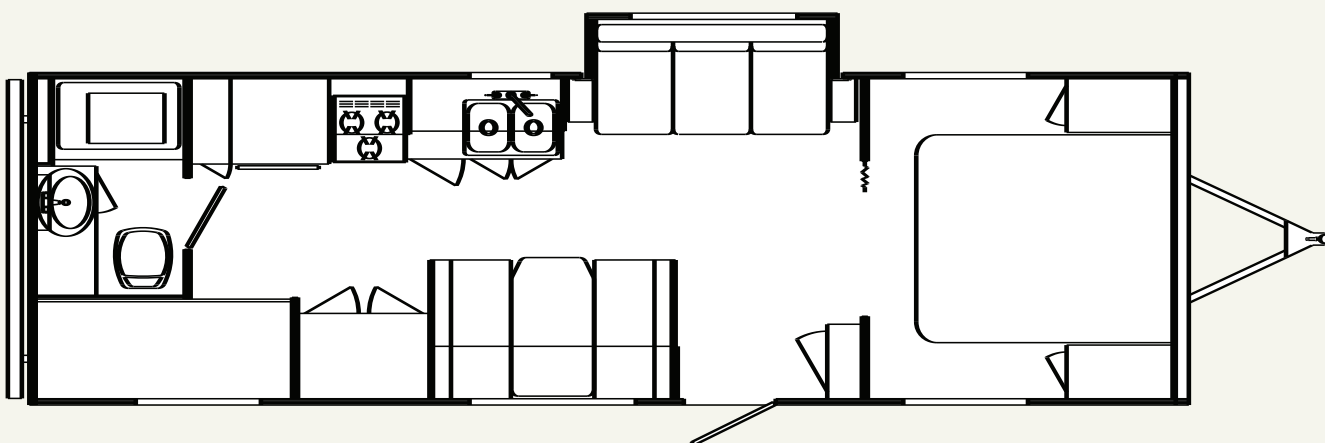

29SKS